

CERTIFICATE OF LOCATION OF GOVERNMENT CORNER

SOUTHWEST SIXTEENTH Corner of Section 14, Township 144, Range 29, 5th P.M.

STATE OF MINNESOTA, County of CASS

At the corner location shown on the sketch:

On 1/14/80 found a GLO brass cap monument as set in 1926.
DATE

left monument as found, lowered monument, removed monument (explain)

On _____ placed a _____
DATE

SKETCH OF REFERENCE TIES

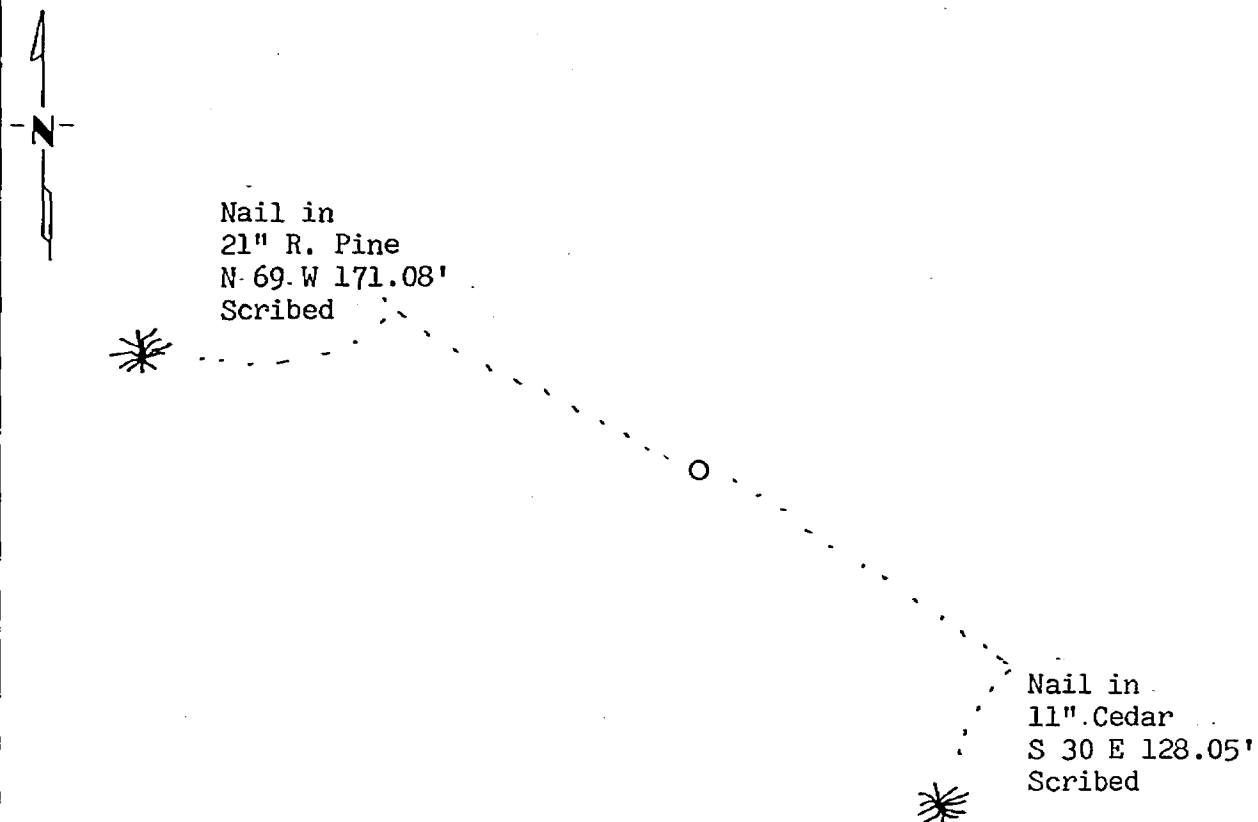

BEARINGS ARE APPROXIMATE

Statement of evidence relative to this corner location is on back of page.

I hereby certify that this document and the data contained herein was prepared by me or under my direct supervision.

Amy H. Stevenson 9-13-82
SIGNATURE DATE

Registration No. 12684

Land Surveyor, Professional Engineer

County Surveyor, County Engineer

264945
 OFFICE OF THE COUNTY RECORDER
 County of Cass

I hereby certify that this document was filed in the Co. Recorders office at 9:58 A. M. on the 14 day of Sept. A.D., 19 82

County Recorder Beresh Handiker

By M.S., Deputy

DOCUMENT NO. 264945

Statement of Evidence:

- 1926 U.S. General Land Office dependent resurvey established this corner and an iron pipe with a marked brass cap was set to mark the corner. The following bearing trees were marked: 10" Maple S 68 E 22 links and 8" W. Pine N 80 W 35 links.
- 1980 U.S. Forest Service technician G. Brama found the corner monumented with a GLO brass cap monument in place in good condition up 12" above ground. The following bearing trees were found: 24" W. Pine stump N 80 W 23.0' and Rotted Maple stump S 68 E 14.5'. Three new bearing trees were marked and are shown on this certificate. Steel sign posts were set 3.1' north and 2.55' south of the corner.
- 1982 County Surveyor's Records in the Recorder's Office were checked and no resurvey information was found on this corner.
- 1982 On Sept. 3 I visited the corner and found items as per the 1980 USFS reports. Accepted monument as marking the same location as when set in 1926 based on bearing tree evidence. One bearing tree marked in 1980 was found as a windfall - 23" W. Pine S 82 E 135.88'.