

# CERTIFICATE OF LOCATION OF GOVERNMENT CORNER

CENTER SOUTH SIXTEENTH Corner of Section 31, Township 142, Range 30, 5th P.M.

STATE OF MINNESOTA, County of CASS

At the corner location shown on the sketch:

On 3/12/81 found a GLO brass cap monument as set in 1917.  
DATE

left monument as found,  lowered monument,  removed monument (explain)

On \_\_\_\_\_ placed a \_\_\_\_\_  
DATE

### SKETCH OF REFERENCE TIES

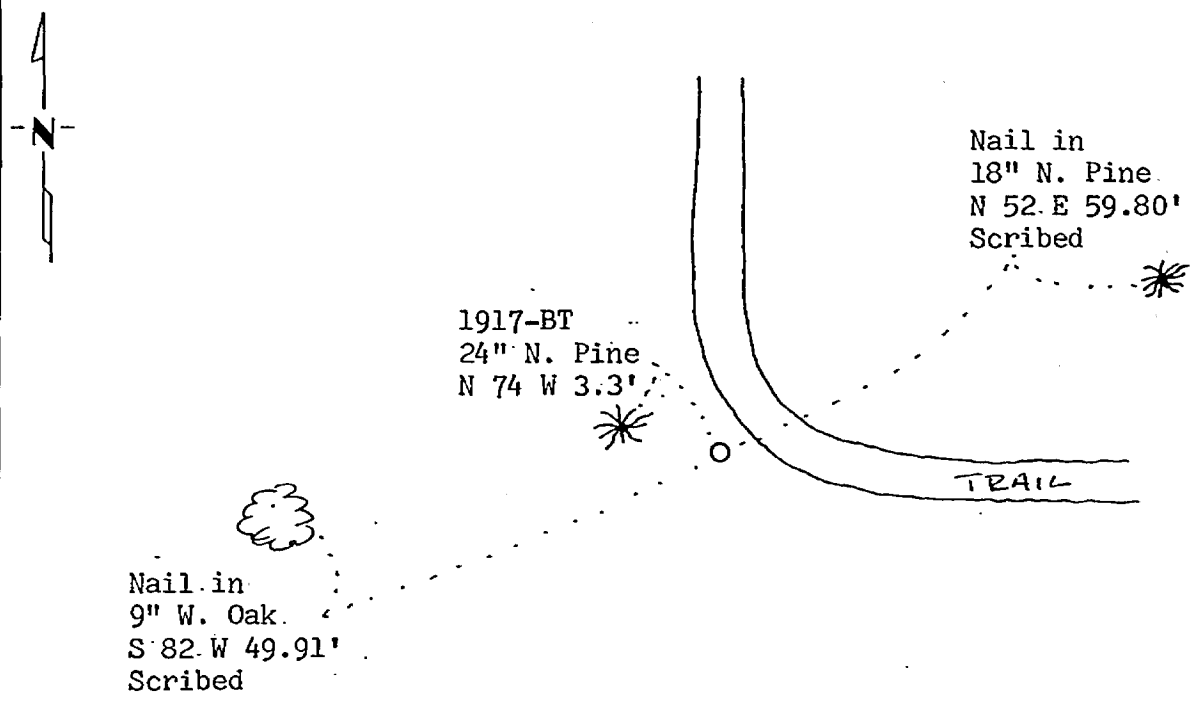

BEARINGS ARE APPROXIMATE

Statement of evidence relative to this corner location is on back of page.

I hereby certify that this document and the data contained herein was prepared by me or under my direct supervision.

Larry H. Stevenson 9-13-82  
SIGNATURE DATE

Registration No. 12684

- Land Surveyor,  Professional Engineer
- County Surveyor,  County Engineer

264934  
OFFICE OF THE COUNTY RECORDER  
County of Cass

I hereby certify that this document was filed in the Co. Recorders office at 9:35 A.M. on the 14 day of Sept. A.D., 1982

County Recorder Beverly Hardin  
By MS, Deputy

DOCUMENT NO. 264934

Statement of Evidence:

- 1917 U.S. General Land Office dependent resurvey established this corner and an iron pipe with a marked brass cap was set to mark the corner. The following bearing trees were marked: 7" N. Pine N 74 W 5 links and 5" N. Pine N 60 E 5 links.
- 1981 U.S. Forest Service technician W. Olsen found the corner monumented with a GLO brass cap monument in good condition up 0.4'. The following bearing trees were found: 24" N. Pine N 74 W 3.3' with overgrown scar facing the corner. Two new bearing trees were marked and are shown on this certificate. Steel sign posts were set 4.0' north and 4.0' east of the corner.
- 1982 County Surveyor's Records in the Recorder's Office were checked and no resurvey information was found on this corner.
- 1982 On Sept. 9 I visited the corner and found items as per the 1981 USFS reports. I accepted the monument as marking the same position as when set in 1917 based on the one bearing tree found.