

# CERTIFICATE OF LOCATION OF GOVERNMENT CORNER

NORTH SIXTEENTH Corner of Sections 29&30, Township 142, Range 30, 5th P.M.

STATE OF MINNESOTA, County of CASS

At the corner location shown on the sketch:

On 3/12/81 found a GLO brass cap monument down 0.5' in road.  
DATE

left monument as found,  lowered monument,  removed monument (explain)

On \_\_\_\_\_ placed a \_\_\_\_\_  
DATE

### SKETCH OF REFERENCE TIES

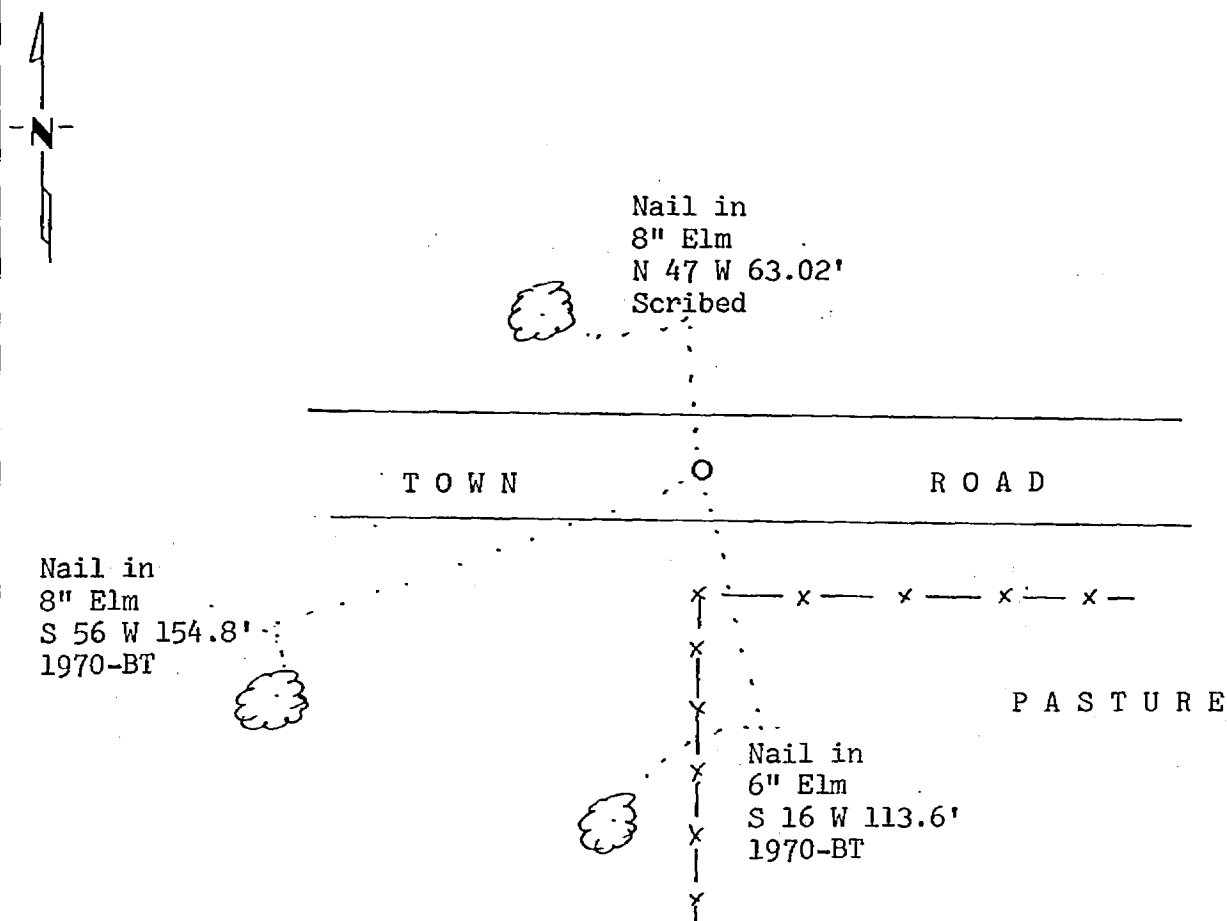

BEARINGS ARE APPROXIMATE

Statement of evidence relative to this corner location is on back of page.

I hereby certify that this document and the data contained herein was prepared by me or under my direct supervision.

Amy H. Stevenson 9-13-82  
SIGNATURE DATE

Registration No. 12684

Land Surveyor,  Professional Engineer

County Surveyor,  County Engineer

264930  
 OFFICE OF THE COUNTY RECORDER  
 County of Cass

I hereby certify that this document was filed in the Co. Recorders office at 9:19 A. .M. on the 14 day of Sept. A.D., 19 82

County Recorder Bessie Hardinger

By MS, Deputy

DOCUMENT NO. 264930

Statement of Evidence:

- 1917 U.S. General Land Office dependent resurvey established this corner and an iron pipe with a marked brass cap was set to mark the corner. The following bearing trees were marked: 6" Aspen S 9 E 116 links and 6" Aspen N 80 W 148 links.
- 1970 Corner Certificate filed by William Okerman, RLS #6807, shows GLO brass cap monument found tipped over in roadway. Found rotted Aspen stump at S 9 E 116 links. Monument was straightened and reset. Two new bearing trees marked: 5" Elm S 16 W 116.0' and 7" Elm S 56 W 155.1'. A 4"x4"x7' Cedar post was set 18.3' south.
- 1977 Bruce Buxton, RLS #11309, surveyed plat of FIRST ADDITION TO HEATHMAN ESTATES, filed in April 1977. The plat shows this corner in place and marked with a GLO brass cap monument.
- 1981 U.S. Forest Service technician W. Olson found the corner monumented with a GLO brass cap monument down 0.5' in east-west road. The following bearing trees were found: The two Elms listed in the 1970 Corner Certificate, with small discrepancy in the distances. One bearing tree was marked and is shown on this certificate.
- 1982 On Sept. 9 I visited the corner and found items as per the 1981 USFS reports. I accepted monument as marking the same position as when set in 1917 based on the 1970 Corner Certificate and Buxton's traverse information.