

# CERTIFICATE OF LOCATION OF GOVERNMENT CORNER

NORTHEAST Corner of Section 4, Township 142, Range 28, 5th P.M.

STATE OF MINNESOTA, County of CASS

At the corner location shown on the sketch:

On 8/30/82 found a GLO brass cap monument as set in 1928.  
DATE

left monument as found,  lowered monument,  removed monument (explain)

On \_\_\_\_\_ placed a \_\_\_\_\_  
DATE

### SKETCH OF REFERENCE TIES

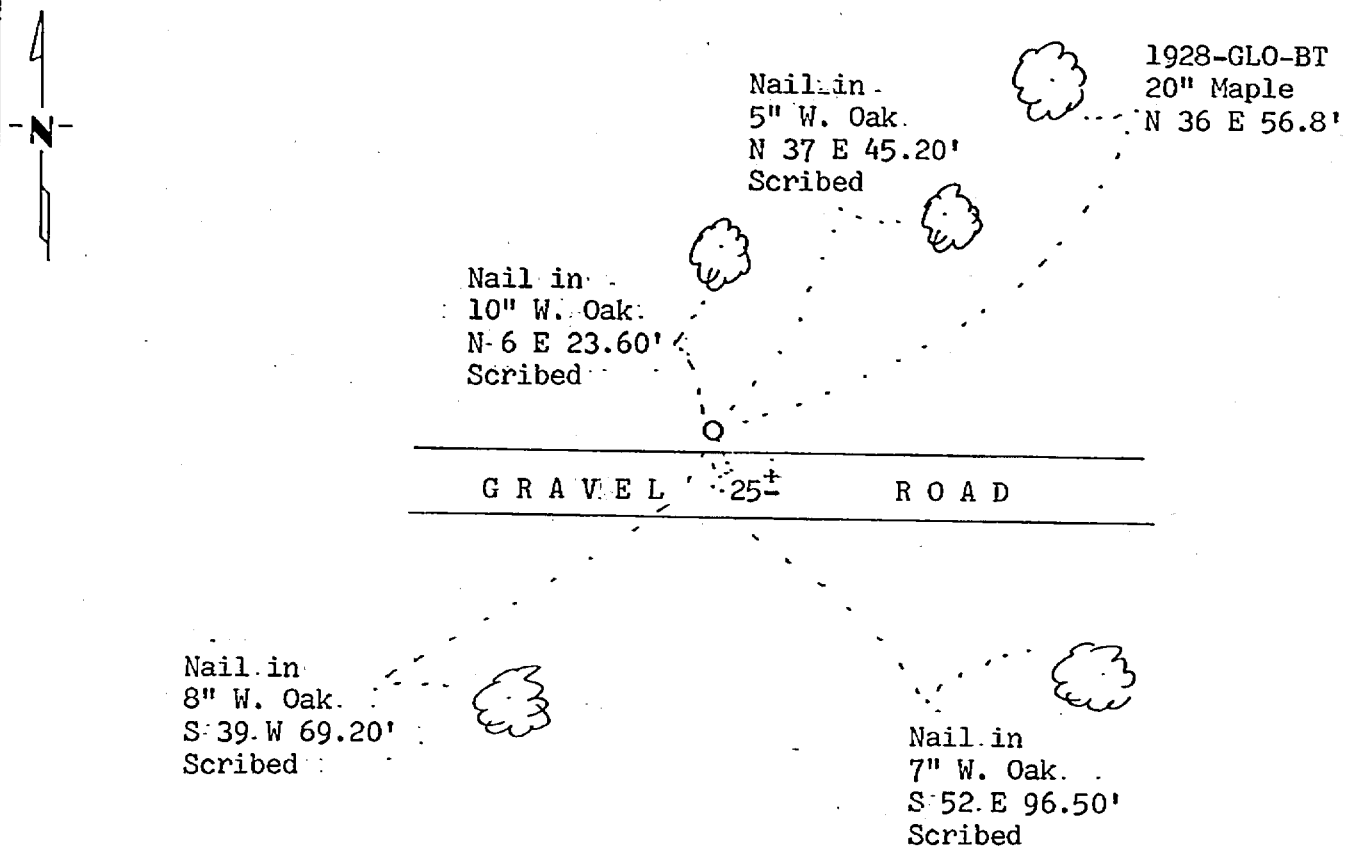

BEARINGS ARE APPROXIMATE

Statement of evidence relative to this corner location is on back of page.

I hereby certify that this document and the data contained herein was prepared by me or under my direct supervision.

Nancy H. Stevenson 9-13-82  
SIGNATURE DATE

Registration No. 12604

- Land Surveyor,  Professional Engineer  
 County Surveyor,  County Engineer

264927  
 OFFICE OF THE COUNTY RECORDER  
 County of Cass

I hereby certify that this document was filed in the Co. Recorders office at 9:16 A. .M. on the 14 day of Sept. A.D., 1982

County Recorder Dorothy Herdich  
 By MS, Deputy

DOCUMENT NO. 264927

Statement of Evidence:

- 1873 U.S. General Land Office survey set wood post for this corner and marked the following bearing trees: 24" Oak N 74 E 10 links, 10" Sugar Maple S 60 E 10 links, 8" Sugar Maple S 33 W 28 links, and 15" Lind N 32 W 41 links.
- 1928 U.S. General Land Office dependent resurvey found the corner marked by a square wood stake with scribe marks set at corner of fences running north, east, and west. An iron pipe with a marked brass cap was set to mark the corner. The following bearing trees were marked: 14" W. Oak N 36 E 86 links, 12" Maple S 81 E 154 links, and 10" Basswood N 47 W 123 links.
- 1982 U.S. Forest Service technician C. Krause found the corner monumented with a 2" iron pipe with brass cap broken off and laying beside. Iron pipe was bent. Straightened pipe and put cap back on and lowered to flush with road. The following bearing trees were found: 20" Maple (called Oak in GLO notes) N 36 E 56.8' with scar and half dead stub in Basswood clump N 47 W 81.2', no scribe. Other bearing tree position falls in road. Four new bearing trees were marked and are shown on this certificate. Set steel sign post 4.0' north and 4.0' west of the corner. Place large rocks around the monument. Corner sets 5'± north of north edge of east-west road.
- 1982 County Surveyor's Records in the Recorder's Office were checked and no resurvey information was found on this corner.
- 1982 On Sept. 10 I visited the corner and found items as per the 1982 USFS reports. I accepted corner as marking the perpetuated position of the original corner based on the 1928 bearing tree evidence.