

# CERTIFICATE OF LOCATION OF GOVERNMENT CORNER

NORTH QUARTER Corner of Section 17, Township 142, Range 27, 5th P.M.

STATE OF MINNESOTA, County of CASS

At the corner location shown on the sketch:

- On 8/31/79 found a GLO iron pipe broken into two pieces.  
DATE
- left monument as found,  lowered monument,  removed monument (explain) .
- On 8/31/79 placed a 2" x 24" galvanized iron pipe with a 3"  
DATE  
marked brass cap.

### SKETCH OF REFERENCE TIES

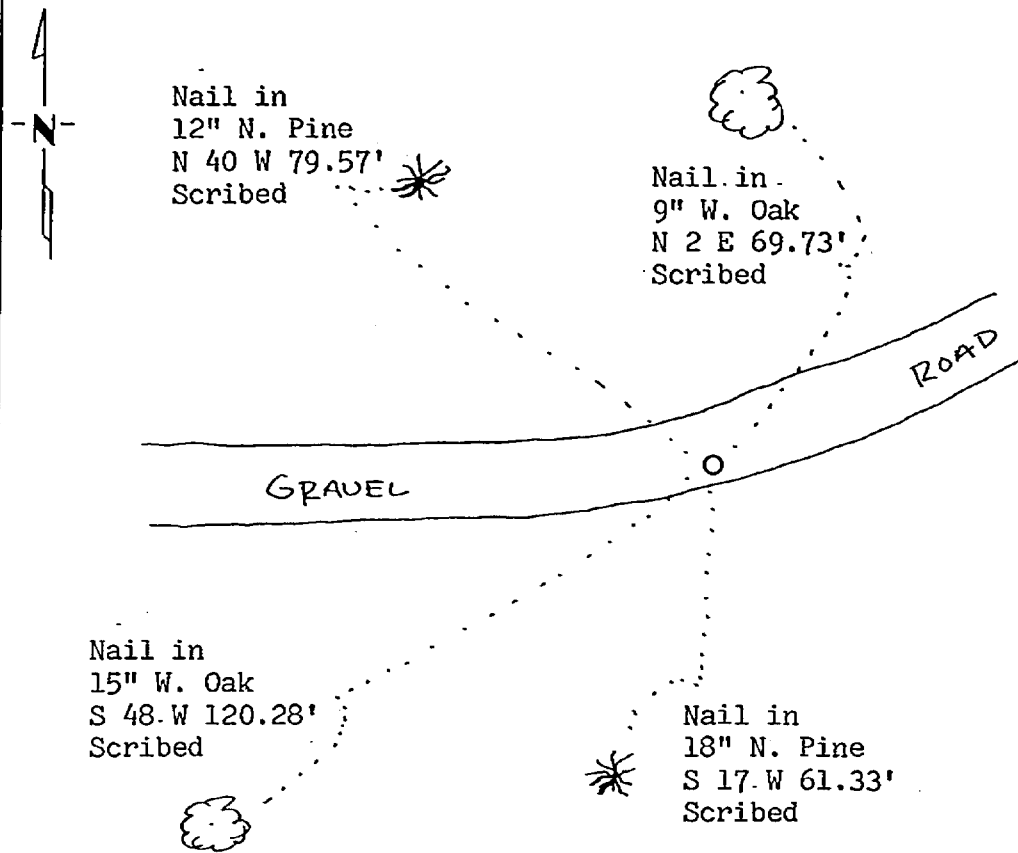

MONUMENT MARKED:

T142N R27W  
 $\frac{1}{4}$   $\frac{S 8}{S 17}$   
 1979  
 RLS No. 12261

BEARINGS ARE APPROXIMATE

Statement of evidence relative to this corner location is on back of page.

I hereby certify that this document and the data contained herein was prepared by me or under my direct supervision.

Mary H. Stevenson 9-13-82  
SIGNATURE DATE

Registration No. 12604

- Land Surveyor,  Professional Engineer
- County Surveyor,  County Engineer

264919  
 OFFICE OF THE COUNTY RECORDER  
 County of Cass

I hereby certify that this document was filed in the Co. Recorders office at 9:00 A.M. on the 14 day of Sept. A.D., 1982

County Recorder Burlah Hendrick  
 By MS, Deputy

DOCUMENT NO. 264919

Statement of Evidence:

- 1873 U.S. General Land Office survey marked a 5" Poplar for this corner and marked the following bearing trees: 5" Poplar N 41 W 23 links and 5" Poplar S 50 E 8 links.
- 1919 U.S. General Land Office dependent resurvey reestablished this corner by proportionate distance. No evidence was found of the original corner or bearing trees. An iron pipe with a marked brass cap was set to mark the corner. The following bearing trees were marked: 5" N. Pine N 10½ E 60 links and 6" N. Pine S 67 ¾ W 53 links.
- 1979 U.S. Forest Service technician C. Krause found the corner monumented with a GLO iron pipe broken into two pieces buried in an east-west road with both bottom flanges of pipe firmly in place down 36". No brass cap was found. The following bearing trees were found: N. Pine stump N 10 E 39.6' with scribe "8 BT" visible. No evidence of other bearing tree found as its position now falls in road ditch. Four new bearing trees were marked and are shown on this certificate. A 2" x 24" galvanized iron pipe was set in place of the found base of the GLO pipe. The pieces of old pipe were placed on the north side of the new monument. Monument was placed down 12" below road surface.
- 1982 County Surveyor's Records in the Recorder's Office were checked and no resurvey information was found on this corner.
- 1982 On Sept. 10 I visited the corner and found items as per the 1982 USFS reports. I accepted the monument as marking the same position as when set in 1919 by the GLO resurvey.