

CERTIFICATE OF LOCATION OF GOVERNMENT CORNER

WEST 1/16th Corner of Section 16&21, Township 141, Range 29, 5th P.M.

STATE OF MINNESOTA, County of CASS

At the corner location shown on the sketch:

On 7/3/80 found a marked GLO brass cap monument in place as set in 1918.
DATE

left monument as found, lowered monument, removed monument (explain)

On _____ placed a _____
DATE

SKETCH OF REFERENCE TIES

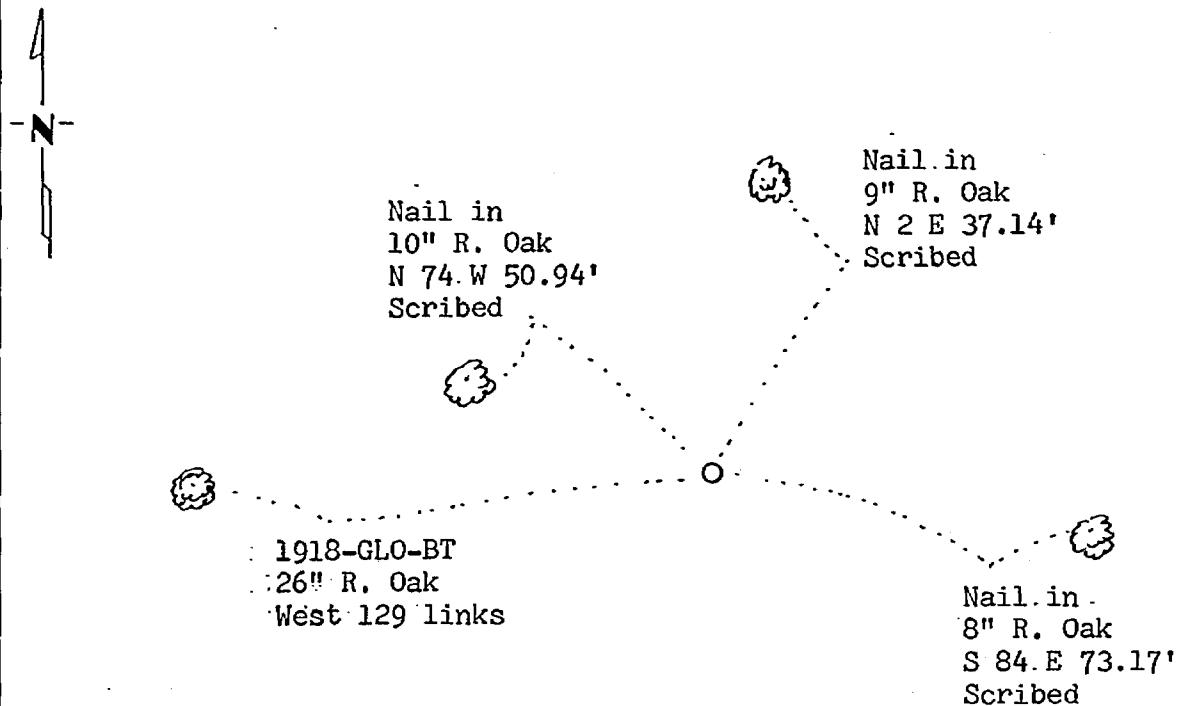

BEARINGS ARE APPROXIMATE

Statement of evidence relative to this corner location is on back of page.

261005

I hereby certify that this document and the data contained herein was prepared by me or under my direct supervision.

Mary H. Atkinson
SIGNATURE

12-29-81
DATE

Registration No. 12684

Land Surveyor, Professional Engineer

County Surveyor, County Engineer

OFFICE OF THE COUNTY RECORDER

County of Cass

I hereby certify that this document was filed in the Co. Recorders office at 9:43 A.M. on the 31 day of Dec. A.D., 1981

County Recorder Beverly Hendricks

By MS, Deputy

DOCUMENT NO. 261005

Statement of Evidence:

- 1918 U.S. General Land Office dependent resurvey established this corner and an iron pipe with a marked brass cap was set to mark the corner. The following bearing trees were marked: 12" Oak West 129 links and 8" Maple N 21 W 250 links.
- 1980 USFS technician Gary Brama found the GLO brass cap monument in place up 4" in good condition. The Oak bearing tree was found alive. No evidence was found of the Maple. Three new bearing trees were marked and are shown on this certificate. A steel sign post was set 2.5' east of the corner.
- 1981 County Surveyor's Records in the Recorder's Office were checked and no resurvey information was found on this corner.
- 1981 On Dec. 22, I visited the corner and found items as per the 1980 USFS report. The 1918 Oak BT had visible scar. I accepted the found monument as marking the same position as when originally set in 1918.