

Boy River
Road

TRANSIT-LEVEL

161 No 2

Book # 2.

MINING
TRANSIT BOOK

363

KEUFFEL & ESSER CO.

DRAWING MATERIALS

AND

SURVEYING INSTRUMENTS.

NEW YORK.

CHICAGO. ST. LOUIS. SAN FRANCISCO. MONTREAL.

Tables for Excavations and Embankments.

DISTANCES FROM CENTER OF ROADWAY FOR CROSS-SECTIONING.

ROADWAY 18 FEET WIDE. SIDE SLOPES 1 TO 1.

FOR SINGLE TRACK EXCAVATION.

"Copyright, 1895, by Keuffel & Esser Co."

	0	.1	.2	.3	.4	.5	.6	.7	.8	.9	
0	9.0	9.1	9.2	9.3	9.4	9.5	9.6	9.7	9.8	9.9	0
1	10.0	10.1	10.2	10.3	10.4	10.5	10.6	10.7	10.8	10.9	1
2	11.0	11.1	11.2	11.3	11.4	11.5	11.6	11.7	11.8	11.9	2
3	12.0	12.1	12.2	12.3	12.4	12.5	12.6	12.7	12.8	12.9	3
4	13.0	13.1	13.2	13.3	13.4	13.5	13.6	13.7	13.8	13.9	4
5	14.0	14.1	14.2	14.3	14.4	14.5	14.6	14.7	14.8	14.9	5
6	15.0	15.1	15.2	15.3	15.4	15.5	15.6	15.7	15.8	15.9	6
7	16.0	16.1	16.2	16.3	16.4	16.5	16.6	16.7	16.8	16.9	7
8	17.0	17.1	17.2	17.3	17.4	17.5	17.6	17.7	17.8	17.9	8
9	18.0	18.1	18.2	18.3	18.4	18.5	18.6	18.7	18.8	18.9	9
10	19.0	19.1	19.2	19.3	19.4	19.5	19.6	19.7	19.8	19.9	10
11	20.0	20.1	20.2	20.3	20.4	20.5	20.6	20.7	20.8	20.9	11
12	21.0	21.1	21.2	21.3	21.4	21.5	21.6	21.7	21.8	21.9	12
13	22.0	22.1	22.2	22.3	22.4	22.5	22.6	22.7	22.8	22.9	13
14	23.0	23.1	23.2	23.3	23.4	23.5	23.6	23.7	23.8	23.9	14
15	24.0	24.1	24.2	24.3	24.4	24.5	24.6	24.7	24.8	24.9	15
16	25.0	25.1	25.2	25.3	25.4	25.5	25.6	25.7	25.8	25.9	16
17	26.0	26.1	26.2	26.3	26.4	26.5	26.6	26.7	26.8	26.9	17
18	27.0	27.1	27.2	27.3	27.4	27.5	27.6	27.7	27.8	27.9	18
19	28.0	28.1	28.2	28.3	28.4	28.5	28.6	28.7	28.8	28.9	19
20	29.0	29.1	29.2	29.3	29.4	29.5	29.6	29.7	29.8	29.9	20
21	30.0	30.1	30.2	30.3	30.4	30.5	30.6	30.7	30.8	30.9	21
22	31.0	31.1	31.2	31.3	31.4	31.5	31.6	31.7	31.8	31.9	22
23	32.0	32.1	32.2	32.3	32.4	32.5	32.6	32.7	32.8	32.9	23
24	33.0	33.1	33.2	33.3	33.4	33.5	33.6	33.7	33.8	33.9	24
25	34.0	34.1	34.2	34.3	34.4	34.5	34.6	34.7	34.8	34.9	25
26	35.0	35.1	35.2	35.3	35.4	35.5	35.6	35.7	35.8	35.9	26
27	36.0	36.1	36.2	36.3	36.4	36.5	36.6	36.7	36.8	36.9	27
28	37.0	37.1	37.2	37.3	37.4	37.5	37.6	37.7	37.8	37.9	28
29	38.0	38.1	38.2	38.3	38.4	38.5	38.6	38.7	38.8	38.9	29
30	39.0	39.1	39.2	39.3	39.4	39.5	39.6	39.7	39.8	39.9	30
31	40.0	40.1	40.2	40.3	40.4	40.5	40.6	40.7	40.8	40.9	31
32	41.0	41.1	41.2	41.3	41.4	41.5	41.6	41.7	41.8	41.9	32
33	42.0	42.1	42.2	42.3	42.4	42.5	42.6	42.7	42.8	42.9	33
34	43.0	43.1	43.2	43.3	43.4	43.5	43.6	43.7	43.8	43.9	34
35	44.0	44.1	44.2	44.3	44.4	44.5	44.6	44.7	44.8	44.9	35
36	45.0	45.1	45.2	45.3	45.4	45.5	45.6	45.7	45.8	45.9	36

Calculated by Julien A. Hall, M. Am. Soc. C. E.

597+89.4

R. 94°45'

Map.
6197+72.0 Var. from line = 6°45'E

L. 75°00'

R.P. Aspen 10" S. 70°15' W. 33.6 ft.

" " 10" S. 12°30' W. 53.2 ft.

142-28

SECS 14, 15, 22,
23, 24, 25, 26, 36

142-27

SECS 30, 31

NE 141/28

1/41/28 & 4/41/27

INDEX

Bay River State Road,
Second Book.

	Page
Transit Notes Sta. 405 to 754	1-20.
Level Notes Sta. 455 to 754	21-43.
Offtake from 513+34.4 N. to Bay Lake	50.
Time sheet	20
Transit Notes, Offtake Ditch	51.

1
Transit Notes.

- Sta.
~~425~~
~~424~~
~~423~~
 422+60 Dry ditch. Natural drain to swp.
~~422~~
 421+320 Left 51°00'
~~421~~
~~420~~
 419+397 Right 32°00' Cedar swamp 30ft.
~~419~~
 418+349 1/4 S. cor bet. secs. 14-15
~~418~~
~~417~~
~~416~~
~~415~~
~~414~~
~~413~~
~~412~~
 411+96! U.S. 1/4 cor. wood post.
~~411~~
~~410~~
~~409~~
~~408~~
~~407~~
~~406~~
 405+66.5 U.S. N 1/2 cor. (wood post) secs. 14 & 15.

Culvert.

Birch 10" N.W. 47.1 ft.
 R.P.s. Birch 15" S.W. 57.6 ft.

Left. R.P.s. Tamck 12" S. 51° E. 44.1 ft.
 Cedar 8" East 43.4 ft.

447

446 leave Tamck swamp, enter high

445

444

443

442

441

440

scattering 8" Tamck dead.

439 enter Tamck swamp.

U.S. 169 Cor. I.M. Birch 10" N. 80 W. ft
 438+865 Left 45° 45', R.P. Balsam 6" S 98° W.

438

437

436

435

434

433

432+18.9 U.S. site cor. bet. secs 14-15

432

431

430

429

428

427

426

425+034 Right 17° 37' (True bearing)
 S. 0° 12' W. on sec. line

land heavy brush. Timber medium.

U.S. sec. Cor. secs. 14-15-22-23 sets S. 6671.6 ft (N.M.)

R.P. Birch 14" N.E. 34.7 ft.
 Birch 10" S.E. 53.0 "

465 " ft. " Boy Lake
 464 " ft. " "
 463 Seawall ft. Left.
 462+17.7 on low seawall. Left, 16°57'
 462
 461
 460+18 Leave creek.
 460+10 edge of small creek, 3 ft. to sand
 460
 459 Enter open swamp.
 458+56.8 Left 52°23' R.P. Pop. 5" S. 24.7 ft.
 458 Pop. 8" NE. 46.8 ft.
 457
 456+32.0 Left 7°00'
 456 Seawall Left. 8 ft.
 455
 454
 453 Enter swp. heavy brush. Seawall of
 452+89.0 Right 43°15' R.P. Oak 9" East 36.0 ft.
 452 Aspen 12" N. 53.2 "
 451
 450
 449
 448+56.2 Sec. line. Secs. 14-23. N.W. < 43°30' .
 448

35 ft. Left.

Boy Lake 160 ft. Left.

bottom.

Station 375 to 459
 heavy timber & heavy brush
 large stumps

Boy Lake 50' Left.

487

486+29.7 Left $89^{\circ}09'$ ^{Aspen 6" W. 48.5'}
R.P. ^{Aspen 8" S. 42.9'}

486

485

484

483

482

481

480

479 enter cedar lowland

478

477+32.5 Right $54^{\circ}05'$ ^{Aspen 20" SE, 38.4'}
R.P. ^{Ash 5" NE, 39.1'}

477

76

75

74

73

72

71

470 Dead cedar + Tamck, heavy Willow brush

469

468

467 Small scattering dead Tamck.

466

465+95.3 Right $23^{\circ}45'$ U.S. 1.M. $9/14$, cor. sec. 23, East on Cent. line.

South on Centre line of sec. 23. Box Lake N. 180 ft.

509

508

507

506

505

504

503

502

+85 Leave open meadow. Enter heavy

501

500

499

498

497

496

495

+75 Enter open meadow. Dry.

494 Leave heavy Aspen timber.

493

492

491 in small hand dug drainage ditch.

490+30 Field 15ft. Right. (NW cor.)

490

489

488

Aspen timber

530

529

528

527

526+260 U.S.I.M. S $\frac{1}{4}$ S. Cor. secs. 23-24.

524

525

524

523

522

521

520

Enter spruce swamp. Leave Log

Road

519

518

517

Log Road cleared and
stumped 20 ft.
wide on R. of Way Road

516+50 centre of Log Road N.E. & S.W.

516

515

514+98 E. & W. Wagon Road.

514

Enter scattering Aspen - Balsam. Small

brush. + Tag Alders.

Aspen 8" N.W. 55.0 ft.

R.P. Aspen 10" N.E. 74.9 ft.

513+24.4 Right 87° 58' U.S.I.M. $\frac{1}{4}$ S. Cor. to

secs. 23 & 24 - 142-28, Old logging Road 40' E.

513

512

511

510

552+87⁰ Left 91°10' US.L.M. N $\frac{1}{2}$ S. Cor. 25-26.

552 Leave swamp, enter Aspen Timber.

551

550

549 Enter Large Tamck + cedar.

548

547

546

545

544

543

542

541 Enter Tamck + Spruce swamp.

540

539+27⁰ Right 0°29' US.L.M. sec. cor. 23-24-25-26.

539

538 Intersect Aspen Ridge. Heavy

537

536

535

534 Enter Tamck swamp

533

532

531 cross E+W. Logging Road

R.P. Aspen 12" W. 39.2 (ft)
" 12" S.W. 40.9. ← also B.M. (E, on N $\frac{1}{2}$ line)

Thick second growth Tamck + Spruce.

Timber.

8

+28 Wagon trail crosses line again

570

+10 Wagon trail N.W. & S.E. crosses line.

569

+03.0 N+S. wire fence.

568

567

+45.4 U.S. I.M. © N.W. to S. Cor. Sec. 25.

566

565

+73 Fence. Enter Medge of clearing.

564

563

562

+41 N+S. Wagon Trail.

561

560

559

558

557

556

555

+54 Cent. of N+S. Road. Not graded.

+42 Wire fence N+S.

554

553

N.E. S.W.

Wagon trail
8 ft. wide.

clearing.

Clearing 20 ft. Right.

wire fence,

9

" Wagon trail L. 15 ft. N. 1/2 of
+17 U.S. I.M. N.E. 1/4 S. cor.

593

592

591

590 to 598 1/2 of Rt. of way

589

588

587

586

585

584

583

582

581

+08.0 fall 4.70 ft. N. of U.S. I.M. @ C.N. 1/4 S.

580

579

578

577

576

575

574

573 " " " " 25 " "

572 E. + W. Wagon trail 15 ft Left.

571

Rt. of way cleared of timber.

Timber
Cut off.
Logs + stumps
still on ft.
of way

Cleared of timber

Partly cleared

Sec. 25. Set over cor. L. 0°47' East on N. 1/2 line.

10

758 Creek 5-ft. wide flows E,

617 Low land. cedar + Jamck

614

615

614

613

612

611

610

609

608

607

606

605

604

603

602

601

600

599

598 ↗ Change of Line
↙ Right. 94°48' R.R. Oak 20" E, 58.5 "

597

596

595

594

timber.

Also B.M.

619+72.0 L. 45°00' R.R. { Aspen 10°S, 70°15' W 33.6' ft
" " S. 12°30' W 53.2 "

619

+50 Leave lowland.

618

- 617
616
615 Heavy timber
+63 Huffmans Road N.W. SE. 15' wide
+01.2 Δ Left $22^{\circ}05'$. Point on E. + W. cont. line.
614
613
612 Enter scattering timber.
611
610 Leave field. 8' brush.
609
608
607
+84.6 Right $58^{\circ}20'$ R.P. Maple $12^{\circ}N. 58^{\circ}E. 63.4'$
+70. E + W. wire fence. " $14^{\circ}S. 55^{\circ}E. 94.0'$
404
605 edge of J.C. Huffmans field.
+08.0 N.E. + S.W. Wire fence.
604
603
602
601
600
599
+10 Enter heavy timber.
598
597+89.7 R. $63^{\circ}00'$
Change of line, see page 10.

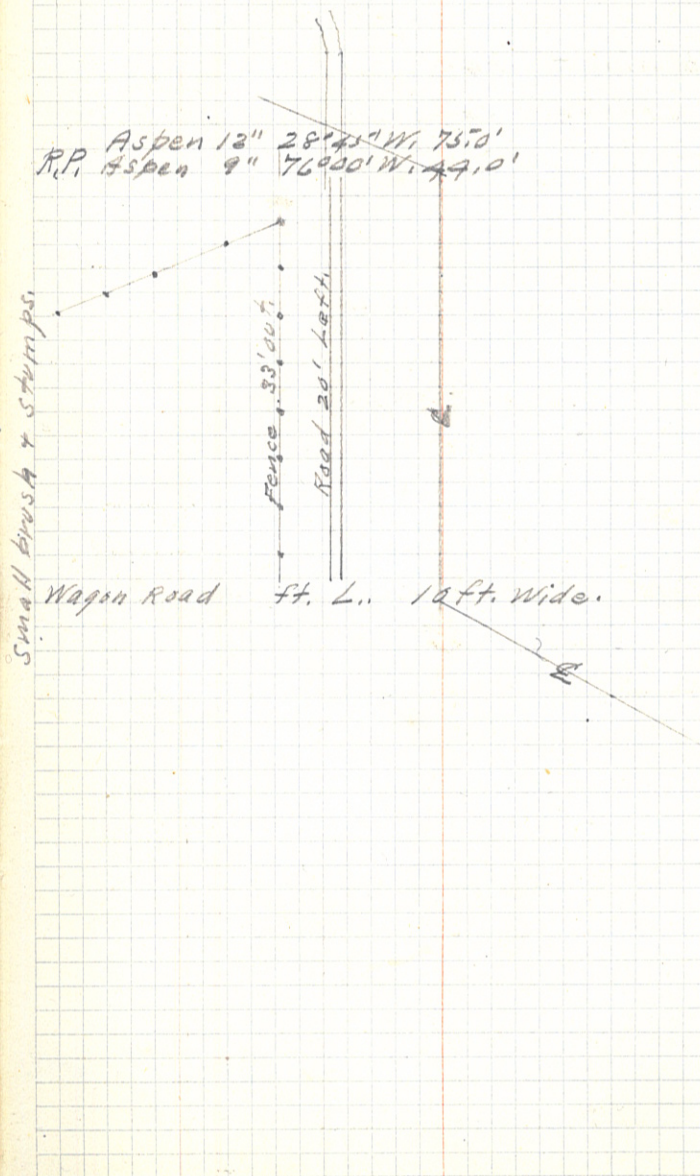

- 635 Timber on Rt. of way cut 66ft.
 +93.0' Δ Right $44^{\circ}44'S$, on Range line bet.
 +64 old road, NW-SE
 634
 633
 632
 631
 630
 629
 628
 +70 old road, N.E.-S.W.
 627
 +50 Enter heavy hardwood timber.
 626
 625
 624
 +75 Enter heavy cedar, W. side
 623
 +69.2 Δ Left $49^{\circ}28'$ R.P. Aspen $5^{\circ}N 77^{\circ}30' W$ 57.5' ^{Balsam $5^{\circ}S 39^{\circ}45' W$ 35.3'}
 622
 621
 620 S. side of swamp.
 +52 cent. of small plank bridge, creek 5'
 619 N. edge of swamp.
 618

Road 10' wide near cent. line. Partly graded.
 Wide. Logs + stumps + 8' brush not removed.
 Secs. 25 + 30 - Rges. 27 + 28. R.P. Balsam $10^{\circ}N E$ 51.4'.
 R.P. Aspen $12^{\circ}S E$ 62.0'

Wide flows E.

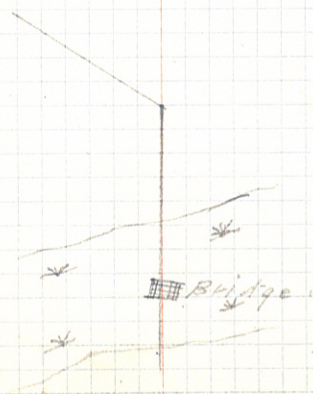

- 657
 656
 655⁻ N. edge of swamp. N. end of cord
 654
 653
 652
 651
 650 Log culvert.
 649
 648
 647
 646
 645
 +93.6 County I.M. sets W. left
 +90.0 U.S. I.M. @ sec. cor. secs. 25-30-31-36.
 644
 643
 642
 641
 640
 639
 638
 +95.5 @ U.S. I.M. $\frac{1}{4}$ cor.
 637
 636

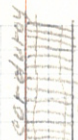
Tamm
SWPTamm
Swamp

uroy road 10' wide. E. edge on R.

Left 1°02' R.R. { W. Pine 10" N.E. 92.7'
 W. Pine 8" N.W. 94.8'

678

677

676

675

674

673

672 Enter Tamck Swamp.

+89.7 US. I.M. @ 1/4 S. 31-36. Right 0°29'

671

670

669

668

667

666

+14.3 @ U.S. I.M. 1/4 Cor.

665

664

+25 S. end of corduroy. Leave swamp

663

662

661

660

659

+40 @ U.S. I.M. N. to Cor. (U.S. B.T.S. cedar 8"
elm 16")

658

672 to 693
in E. edge of
cut timber,
E. 1/2 of Pt of way
timber not cut.R.P. { Nor. Pine 8" N.E. 5-74'
Birch 6" N.W. 10-8.3' } wagon
Road 19 ft W.

Timber cut from Pt of way to this line

30 ft.

Corduroy Road

Partly graded Road

1 foot above swamp level.

S.E. 36.2'
S.W. 60.9'

+96.4 © U.S. I.M. Twp. Cor. $\left. \begin{matrix} 142-27-28 \\ 141-27-28 \end{matrix} \right\} L. 0^{\circ}43'$

700

699

698

697

696

695

694

693+20 Wedge of farmers' clearing stam bed + cultivated. $\frac{1}{2}$ of Road 16" ft. W

+75 Leave pit hole

692

691

690 Edge of shallow pit hole

689

688

687

+91.8 © U.S. I.M. Sth cor.

686

685

684

683

682

681

680

679 Leave Tamck swamp.

R.P. Aspen 7" N. 80° E. 51.0'
R.P. Aspen 7" S. 44° E. 71.4'

724
 723
 722
 721
 720
 719
 718
 717
 716
 715
 + 20.6 © U.S. IM. M. & Co.
 714
 713
 712
 711
 710
 709
 708
 707
 706
 705
 704
 703
 702
 701

Station 693 to Sta 734 Very little clearing.
 Small amount of scattering timber & brush.
 12' Road way cleared & stumped & partly graded.
 Large stumps on both sides.

18

745

744

743

742

741 Wagon road returns to Rt. of way.

+56.5 @ U.S. 1M. $S\frac{1}{2}$ cor. in a hollow

740

+30 E & W. Wagon road. Not graded.

739

738

737

736

735

734

733

+50 Leave pot hole.

732

731 Enter dry pot hole.

+50 Road turns SW. Leaves Rt. of way.

730

729

728 School house about 125' L.

+46.0 @ U.S. 1M. $\frac{1}{4}$ cor. S. 1-6. Right 1° 10'.

727

726

725

Longville ↑

Road to

Bears S.E.

← To Bob Phillips

High elev.
scattering timber



R.P. stakes 33 ft. E + 33 ft. W.

(Mar. Pine stump ^{30"} SW, 103.0 ft.
R.P. (US, BT, R. OAK 18" SE, 238.2 "

+70.8 © U.S. I.M. Sec, Cor. to secs. 1-6-7-

753

752

751

750

749

748

747

746

12 141 142-27-28. End of line.

21

	+ S	H.I.	- S	Elev.	⊕ Ground Elev.
B.M.		205.32	10.83	194.49	
T.P.			0.58	204.74	
	0.06	204.80			
406			8.7	195.98	196.1
T.P.		196.08	8.82	203.98	
	0.10	204.08			
407.			10.4	185.6	
408.			7.5	193.6	
409			5.6	188.5	
410			8.2	196.5	
411			7.5	190.4	
412			4.2	198.4	
413			10.5	187.8	
T.P.			7.67	195.8	
	0.48	188.89		188.5	
		196.89		196.5	
414			7.10	191.8	
415			6.6	189.8	
416			6.8	182.3	
417			8.9	190.3	
418			9.6	182.1	
419			9.5	190.1	
T.P.			9.10	179.0	
	6.35	186.14		188.0	
		194.14		179.3	
419+39.2			9.4	178.4	
420			7.8	187.4	
				179.79	
				187.79	
				176.7	

Left
30 20 10 10 20 30
on Oak 30" 33 ft. L. Sta. 403+50
on top of stump. W of line

Right
14.4 X 5.5

14.8 X 4.8

13.0 3.3

in SWAMP

10.9 X 6.0

10.9 6.4

22

Ground

Elev.

180.6
~~188.6~~

Right

30 20 10 10 20 30

421

186.14
~~191.14~~

5.5

182.00
~~190.00~~

on top of Hub sta 421 + 37

T.P.

9.90

191.90
~~199.90~~

4.14

182.9

421+37

9.0

~~190.9~~

422

12.6

179.3

~~187.3~~

422+60

14.5

177.4

~~185.4~~

423

8.2

183.7

~~191.7~~

423+50

4.9

187.0

~~195.0~~

424

6.4

185.5

~~193.5~~

T.P.

191.37

~~199.37~~

9.26

200.63
~~208.63~~

0.53

193.9

5.0

X

11.6

425

6.7

~~201.9~~

425+40

4.0

196.6

3.1

9.8

426

5.8

~~204.6~~

194.8

~~202.8~~

427

17.6

183.0

~~191.0~~

T.P.

188.60

~~196.60~~

1.33

189.93
~~197.93~~

12.03

182.3

428

7.6

~~190.3~~

429

10.4

179.5

~~187.5~~

430

9.0

180.9

~~188.9~~

431

9.0

180.9

~~188.9~~

T.P.

182.43

~~190.43~~

5.75

188.18
~~196.18~~

7.50

183.1

432

5.1

~~191.1~~

432+19

5.7

182.5

~~190.5~~

				ground Elev.
		188.18		
		196.18		
B.M.			6.15	182.03
433				190.03
		186.48	6.14	181.8
	4.45	194.48		189.8
434			6.8	179.7
435			6.5	187.7
436			6.9	179.9
T.P.				187.9
		180.28	6.20	180.28
	5.02	193.30		188.28
437			1.5	183.8
438			3.3	191.8
438+86.5			5.2	182.0
439			5.7	190.0
440			6.7	180.1
441			5.9	188.1
442			6.7	178.6
443			6.6	187.6
T.P.			5.30	178.6
	7.40	195.40		186.6
444			9.0	178.4
445			8.8	186.4
446			9.0	178.6
447			6.5	186.6
448			2.5	178.4
448+56.2			3.6	186.4
				180.9
				188.9
				184.9
				192.9
				183.8
				191.8

53 ft. L. of sta 432+19 (B.M. Birch 10")

on B.M.

edge of Tamck Swamp

edge of swamp, leave same.

sec. line between secs 14 + 23

			ground Elev.
		187.40 195.40	184.6 192.6 183.3 191.3
449			2.8
450			4.1
T.P.			183.85 191.85
	0.05	183.90 191.90	
451			3.5
452			4.1
B.M.			181.06 189.06
453			2.84
454			4.9
455			6.2
T.P.			3.8
			180.80 188.80
	3.80	184.60 192.60	
456			4.9
457			5.0
458			5.5
T.P.			179.38 187.38
	4.32	183.70 191.70	
B.M.			181.20 189.20
458+90			2.50
459			4.0
460			6.6
460+15			8.5
			8.4
			175.3 183.3 172.9 180.9 176.0 184.0
461			10.9
			7.7

Left Right
30 20 10 10 20 30

Aspen 12" N. 53.2 from Sta. 452 + 89.0

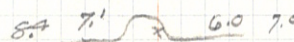

on Hub. 458 + 55.8

46.8 N.E. on Gill Pippie from Hub 458 + 55.5

Water level of creek
bottom of creek.

25

				Ground Elev.
		183.70		176.2
		191.70		184.2
462			7.5	177.70
T.P.			6.00	185.70
	57.50	183.20		
		191.20		
463			5.4	177.8
				185.8
464			4.6	178.6
				186.6
465			5.2	178.0
				186.0
			6.9	176.3
				184.3
466			5.5	177.7
				185.7
467			4.9	178.3
				186.3
468			5.3	177.9
				185.9
469			5.0	178.2
				186.2
470			5.1	178.1
				186.1
471			5.2	178.0
				186.0
T.P.			3.40	179.80
	3.80	183.60		187.80
		191.60		
472			4.5	179.1
				187.1
473			4.4	183.6
				187.2
474			4.7	178.9
				186.9
475			4.3	179.3
				187.3
476			4.3	179.3
				187.3
477			4.0	179.6
				187.6
477+32.5 T.P.			2.60	181.00
	6.00	187.00		189.00
		195.00		
478			6.1	180.9
				188.9

L R
30 20 11 13 20 30

on Hub

5.5 x 5.5
5.5 ~~~~~ 5.4
5.5 5.4

Water level of Boy Lake

on Hub

	+S	H.I.	-S	Elev
		187.00 195.00		
479			6.1	180.9 188.9
480			6.2	180.8 188.8
481			5.7	181.3 189.3
482			5.7	181.3 189.3
483			4.9	182.1 190.1
484			4.9	182.1 190.1
485			3.6	183.4 191.4
486			2.2	184.8 192.8
+29.7 T.P.			0.50	186.50 194.50
	11.30	197.80 205.80		
487			11.1	186.7 195.7
488			8.2	189.6 197.6
489			5.1	192.7 200.7
490			5.7	192.1 200.1
491			9.4	188.4 196.4
			12.1	185.7 193.7
T.P.			7.30	190.50 198.50
	5.45	195.95 203.95		
491+50			6.2	189.7 197.7
492			3.1	192.8 200.8
493			6.2	189.7 197.7
494			4.4	191.5 199.5
495			7.5	188.4 196.4
496			7.7	188.2 196.2

Cedar lowland. Heavy cedar timber.

on I.M. C 1/4 con.

Bottom of Drainage ditch

3.0	X	7.5
2.0	X	6.0
3.5	X	7.5

		195.95 208.95			188.2 196.2
497			7.7	189.20	
T.P.			6.75	197.20	
	10.70	199.90 207.90			188.2 196.2
498			11.7		188.1 196.1
499			11.8		188.1 196.1
500			11.8		188.5 196.5
501			11.4		188.5 196.5
+85			11.4		191.9 199.9
502			8.0		198.9 206.9
+35			1.8		196.7 204.7
503			3.2		194.1 202.1
504			5.8		
T.P.			4.05	195.85 203.85	
	0.00	195.85 203.85			188.6 196.6
505			7.3		185.7 193.7
506			10.2		190.3 198.3
506 ⁵⁰			5.6		190.9 198.9
507			5.0		186.7 194.7
508			9.2		186.0 194.0
509			9.9		187.7 195.7
510			8.2		192.9 200.9
511			3.0		191.8 199.8
512			4.1		187.1 195.1
513			8.8		

Leave open meadows

			<u>Elev.</u>	
	195.85			186.5
	203.81			194.45
513+24.4		9.4	187.10	
T.P.	195.85	8.75	195.10	
	8.75			
	203.85			
B.M.		9.40	186.5	
			194.45	
514		8.6	187.3	
			195.3	
515		5.0	190.9	
			198.9	
516		6.5	189.4	
			197.4	
517		6.0	189.9	
			197.9	
518		5.3	198.6	
			198.6	
519		4.1	191.8	
			199.8	
520		3.4	192.5	
			200.5	
T.P.		2.5	193.35	
	197.00		201.35	
	3.65			
	205.00			
521		4.6	192.4	
			200.4	
522		4.3	192.7	
			200.7	
523		4.7	192.3	
			200.3	
524		4.1	192.9	
			200.9	
525		3.8	193.2	
			201.2	
526		4.1	192.9	
			200.9	
527		4.0	193.0	
			201.0	
528		3.8	193.2	
			201.2	
529		3.6	193.4	
			201.4	
T.P.		2.45	194.55	
	198.20		202.55	
	3.65			
	206.20			

L.

P.

Ontop of 1.M. 1/4 S. cor. Log road 38 ft. E

Q.M. N.E. R.P. Tree

7.1

x

2.5

	198.20			192.8
	206.20			200.8
530		5.4		193.3
531		4.9		201.9
532		4.8		193.4
533		4.6		201.4
533+53		4.1		193.6
534		5.1		194.1
535		5.4		202.1
536		5.2		193.1
537		5.0		201.1
538		3.8		192.8
T.P.		2.5	195.70	200.8
	2180		203.70	193.0
				201.0
539		4.0		193.2
540		5.1		201.2
541		4.7		194.4
542		4.4		202.4
543		4.4		194.5
544		4.6		202.5
T.P.		2.90	195.60	193.4
	230		203.60	201.4
				193.8
545		3.8		201.8
546		4.2		194.1
547		4.3		202.1
548		4.4		194.1
				202.1
				193.9
				201.9
				194.1
				202.1
				193.7
				201.7
				193.6
				201.6
				193.5
				201.5

Φ
Elev.

on popple Ridge 50 ft. wide. Brs. E+W.

	+S	HI	-S	Elev.
549		197.90 204.90	4.0	193.9 204.9
550			4.6	193.3 201.30
551			4.0	193.9 201.9
T.P.			2.60	195.30 203.30
	7.00	202.30 210.30		
552			8.7	193.6 201.6
552+87			5.0	197.3 205.3
553			5.1	197.2 205.2
B.M.			0.40	201.90
554			4.9	197.4 205.4
555			1.1	201.20 209.2
T.P.			0.28	202.02 210.02
	12.33	214.35 222.35		
556			10.6	203.8 199.8
557			8.4	206.09 201.9
558			7.9	206.5 202.4
559			5.5	208.9 204.8
T.P.			0.27	214.08 222.08
	13.40	227.48 235.48		
560			13.0	214.5 222.5
561			12.4	215.1 223.1
562			11.1	216.4 224.4
563			4.3	223.2 231.2
564			1.1	226.4 234.4
T.P.			0.72	226.76 234.76

On Aspen 12" also R.P. S.W. 40.2' from N.T. cor.

		239.56		226.76	
	12.80	247.56		234.76	
565			7.60	232.0	
566			4.0	240.0	
T.P.			3.63	235.6	
	7.20	243.13		243.16	
		251.13			
567			4.00	239.1	
568			14.3	247.1	
569			14.5	228.8	
T.P.			12.23	238.6	
	2.64	233.52		236.6	
		241.52			
570			5.8	227.7	
571			7.0	235.7	
572			6.4	220.5	
T.P.			5.32	234.5	
	0.54	228.74		235.1	
		236.74			
572 + 50			9.2	228.20	
573			9.4	236.20	
574			10.9	219.5	
575			10.0	227.5	
576			13.3	219.3	
T.P.			13.25	227.3	
	2.68	218.17		217.8	
		226.17		223.8	
+25			4.5	218.7	
577			9.6	221.7	
578			9.7	208.6	
				216.6	
				208.5	
				213.7	

L.

R

0.5

X

11.1

579	218.17			207.6
	226.17	10.6		215.6
580		8.2		218.0
T.P.		7.30	210.87	218.8
	5.68	216.55	218.87	
		224.55		210.6
580+10		6.0		218.6
581		7.0		209.6
582		3.9		217.6
583		10.4		216.6
T.P.		5.10	211.45	220.6
			219.45	206.2
	12.07	223.52		214.1
		231.52		
584		5.9		217.6
+40		0.6		225.6
T.P.		0.00	223.52	222.9
	11.40	235.12	231.52	230.9
		243.12		
585		11.9		223.2
586		8.3		231.2
587		3.6		226.8
588		7.4		234.8
589		2.4		231.5
T.P.		1.10	234.02	229.5
	3.15	237.17	242.02	227.7
				235.7
590		7.0		232.7
591		7.8		240.7
592		11.4		
593		11.3		237.2

L.

R

Top of I.M. C.Nite Cor. S. 25.

0.3

x

8.6

culvert needed, In Ravine, SWP.S.W. 200'

9.0

x

3.5

± S	H.I.	- S	Elev.
	237.17 245.17		
594		10.5	226.4 234.4
595		12.3	224.9 232.9
596		7.1	230.1 237.1
T.P.		5.76	231.41 239.41
	5.03	236.44 244.44	
597		5.3	231.1 239.1
T.P.			231.41 239.41
	3.60	235.01 243.01	
597+89.4		5.0	230.0 238.0
B.M.		9.15	225.86 233.86
Change of line see pages 10-12.			
Levels on 2nd line (Right 63°00').			
NB (Levels not taken on line to be changed.)			
B.M.	8.51	234.37 242.37	225.86 233.86
598		5.5	228.9 236.9
599		4.3	230.1 238.1
600		7.9	226.5 234.5
601		12.7	221.7 229.7
T.P.		10.28	224.09 232.09
	0.32	224.41 232.41	
602		13.4	211.0 219.0
+80		11.9	212.5 220.5
603		13.8	210.6 218.6
T.P.		12.90	211.51 219.51

L. R.
30 20 10 10 20 30

Same T.P. as above different set up

on 20" Oak 58.5 ft E. of Sta. 597+89.4

597+89.4 Oak 20" E. 58.6 ft

14.7 x 8.0

		188.55			179.0
619		196.55	9.4		187.0
+52			9.4		179.2
			11.4		187.2
			11.9		177.2
620			9.3		185.2
621			3.2		176.7
T.P.			3.4	185.15	184.6
	1240	197.55		193.15	179.2
		205.55			187.2
621			12.0		185.5
+40			1.7		193.5
+70			0.9		185.8
T.P.			0.0	197.55	203.8
	2.27	199.82		205.55	196.76
		247.82			204.6
622			4.0		195.8
+69.			10.8		203.8
623			8.8		189.0
T.P.	6.20	193.30		187.10	191.0
		211.20	12.72	195.10	197.0
623+55			8.8		184.5
624			12.3		202.5
625			11.7		181.0
626			8.6		199.0
627			3.5		181.6
628			2.9		189.6
629			7.6		184.7
+50			0.5		202.7
					189.8
					207.8
					190.4
					208.4
					185.7
					203.7
					193.8
					218.8

L.

R.

Top of Bridge
Water level
Bottom of creek.

	13.5	x	14.7
	1.0	x	13.8
		x	2.6
	4.8	x	15.6
	7.7	x	10.0

18' down

Culvert needed.

0.2

5.3

		193.30			190.1
630		211.30	3.2	192.85	208.1
T.P.			9.45	210.85	
	8.10	200.95			
		218.15			
631			11.8		189.2
					207.2
632			1.7		199.3
		208.75		200.05	216.13
	8.70	216.75	0.9	216.85	
633			4.9		203.9
					221.9
634			6.8		202.0
					220.0
635			5.5		203.3
					221.3
B.M.				205.05	
T.P.		211.30	3.70	222.85	
	6.25	224.30	4.70		
636			4.7		206.6
					224.6
637			5.0		206.3
					224.3
638			8.3		203.0
					221.0
639			6.1		205.2
					223.2
640			4.9		206.4
					224.4
641			8.3		203.0
					221.0
642			5.9		205.4
					223.4
643			4.5		206.8
					224.8
644			3.8		207.5
					225.5
+55			3.6		207.7
					225.7
T.P.	12.70	222.70		209.40	
		240.30	1.9	237.40	
645			9.0		213.3
					231.3
T.P.			3.77	218.53	
	12.57	231.10		236.53	
		249.10			

L.

R.

On Aspen 12" SE. 62'

Top of Hub 634 + 93.0

3.0

9.7

6.0

3.4

		231.10			
		249.10			
645+50			12.2		218.9
					238.9
646			7.2		223.9
					241.9
+70			3.6		227.5
					245.5
647			6.9		224.5
					242.2
T.P.	6.25	224.85	12.50	218.60	
		242.85		234.60	
647+50			5.0		219.8
					237.8
648			10.2		214.6
					232.6
T.P.	1.25	215.93	10.17	214.68	
		232.93		222.68	
T.P.			12.35	203.58	
				221.58	
	1.87	205.45			
		223.45			
649			4.3		199.2
					217.2
650.			11.4		194.1
					212.1
651			5.1		200.4
					218.4
T.P.			3.70	201.75	
				219.75	
	10.25	212.00			
		230.00			
+25			10.0		202.0
					220.0
652			5.1		206.9
					224.9
653			6.2		205.8
					223.8
T.P.			12.10	200.00	
				218.00	
	0.40	200.40			
		218.40			
654			5.0		195.4
					213.4
655			12.1		188.3
					206.3
656			13.2		187.2
					205.2
T.P.			12.10	188.30	
				206.30	

L

R

9.6	*	13.2
7.5		11.3
2.6		7.4

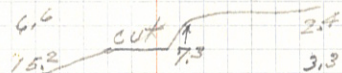

9.2	*	10.5
-----	---	------

Culvert needed



	7.5	192.80		188.30
	4.50	218.80		206.30
657			6.4	186.4
				204.4
658			6.6	186.2
				204.2
659			6.5	186.32
				204.32
660			6.4	186.4
				204.4
T.P.			3.00	189.80
	9.50	199.30		207.50
		217.30		
661			13.4	185.9
				203.9
662			12.3	187.0
				205.0
663			12.4	186.9
				204.9
664			5.9	193.4
				201.4
665			1.7	197.6
				215.6
T.P.			0.80	198.50
	13.25	211.75		215.50
		224.75		
666			7.1	205.7
				222.7
667			2.9	208.9
				226.9
668			4.2	206.6
				225.6
669			11.2	200.6
				218.6
670			5.0	206.8
				224.6
T.P.			1.20	210.55
	6.10	216.65		228.55
		224.65		
671			2.8	213.8
				231.8
+50			4.9	211.7
				229.7
672			10.8	205.8
				223.8
673			11.4	205.2
				223.2

on top of stump, 18' L. Sta. 660710

on top of 1M. $\frac{1}{4}$ cor.

3.6 x 0.0

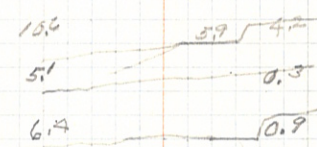

Culvert.

3.1 5.3 5.9



on top of stump

674	216.65		205.4
	234.45	11.2	223.4
675		11.0	205.6
676		11.0	223.6
677		11.0	205.6
678		11.5	223.6
+75		4.0	205.1
680		5.2	223.6
T.P.		3.0	205.1
	11.80		223.6
	225.45		202.6
	249.45		230.6
681		6.4	201.4
682		10.2	229.4
683		7.8	219.0
684		9.4	237.0
685		9.4	215.2
+50		7.9	233.2
686		2.8	217.6
687		4.2	235.6
688		17.0	216.8
689		17.8	234.8
690		18.6	221.0
691		16.0	232.0
692		11.7	217.6
693		13.0	236.0
T.P.		2.65	222.6
			240.4
			251.2
			239.2
			208.4
			226.4
			207.6
			225.6
			206.4
			224.9
			209.5
			227.5
			213.8
			231.8
			212.5
			230.5
			212.0
			240.0
			222.80
			240.80

205.4
~~223.4~~
 205.6
~~223.6~~
 205.6
~~223.6~~
 205.6
~~223.6~~
 205.1
~~223.1~~
 202.6
 230.6
 201.4
~~229.4~~

219.0
~~237.0~~
 215.2
~~233.2~~
 217.6
~~235.6~~
 216.8
~~234.8~~
 221.0
~~232.0~~
 217.6
~~236.0~~
 222.6
~~240.4~~
 251.2
~~239.2~~
 208.4
~~226.4~~
 207.6
~~225.6~~
 206.4
~~224.9~~
 209.5
~~227.5~~
 213.8
~~231.8~~
 212.5
~~230.5~~
 212.0
~~240.0~~

~~7.6 cat~~

~~cat 11.0~~

edge stamp

in ink

		223.20			214.2
713		241.20	9.0		232.2
714			1.3		221.9
T.P.			0.40	222.80	239.7
	12.50	235.30			
715			11.50		223.8
716			0.7		241.8
T.P.			0.20	235.10	234.6
	13.05	248.15		258.10	252.6
717			9.4		238.8
718			2.7		256.8
T.P.			1.0	246.55	243.5
	9.70	256.25		264.50	263.5
719			7.5		248.8
720			7.1		266.17
721			7.1		249.1
722			4.0		267.1
723			8.5		249.1
724			10.9		267.1
725			11.6		252.2
726			11.0		270.2
727			6.4		247.6
T.P.			4.5	251.75	265.7
+ 44				269.70	245.3
					263.3
					244.6
					262.4
					245.2
					263.2
					249.6
					267.6
B.M.	3.10 ⁽²⁾	253.85			
728		241.80	4.3		249.5
					267.5

Top of stone

Top of 1/4 in.

N. end of threshold of school house door.

729		253.85 271.80	7.8		246.0 264.0
730			12.6	240.75	241.2 259.2
T.P.		247.45 265.40	13.10	258.70	
	6.70				
731			10.8		236.6 254.6
732			14.6		232.8 250.8
+10			10.5	237.1	255.1
733			11.0	236.4	254.4 232.9
+65			13.5		261.9 235.5
734			11.6		253.8 243.9
735			4.5		260.9
T.P.			0.80	246.65	
	9.95	256.60 274.55		264.60	
736			4.8		251.8 269.8
737			6.8		249.8 267.8
738			9.1		246.4 265.2
T.P.			11.15	245.45	
	1.00	246.45 264.40		263.40	
739			15.1		231.3 249.3
T.P.			10.95	235.50	
	4.70	240.20 258.15		253.45	
740			18.9		221.3 239.3
741			16.9		223.3 241.3
742			13.6		226.6 244.6
743			6.5		233.7 251.7
744			2.2		238.0 256.0

N 16 20 '30 R.

Top of stump L. of 4

Cent. of dry pot hole
Ridge W of pot hole.

Culvert.

4.3	X	6.9
		9.5
8.3		12.9

Culvert needed. X

X

X

10.

10.7 X 3.5

8.0 X 0.4

	240.20			239.2
745	258.16	1.0		257.2
T.P.		0.20	240.00	
	254.05		257.95	
17.05	272.00			
746		13.3		240.1
747		13.0		258.7
748		13.0		241.0
749		5.9		259.0
750		3.5		241.0
751		2.8		259.0
752		3.3		248.1
B.M.		6.80	247.25	266.1
753		10.2	265.20	258.5
+ TP		6.45	247.60	268.5
	251.60		265.55	251.2
4.00	269.55			269.2
+ 70		4.0		250.4
754		2.4		268.7

L. R.
30 20 10 10 30 30
4.2 0.0

Stamp 43 ft. ln of Sta. 752 + 52'

8 in top of sec. com I.M.

3.7

7.0