

Notes on Corners &
Section Line Surveys in
Bull-Moose Township
138 - 31

From County Surveyor's
Office.

MINING
TRANSIT BOOK
363

For use on Location
survey of Co. Ditch #16.

108
ENGINEERING DEP'T.
CASS COUNTY

108

KEUFFEL & ESSER CO.

DRAWING MATERIALS

AND

SURVEYING INSTRUMENTS.

NEW YORK.

CHICAGO. ST. LOUIS. SAN FRANCISCO. MONTREAL.

Tables for Excavations and Embankments.

DISTANCES FROM CENTER OF ROADWAY FOR CROSS-SECTIONING.
ROADWAY 18 FEET WIDE. SIDE SLOPES 1 TO 1.
FOR SINGLE TRACK EXCAVATION.

" Copyright, 1895, by Keuffel & Esser Co."

	0	.1	.2	.3	.4	.5	.6	.7	.8	.9	
0	9.0	9.1	9.2	9.3	9.4	9.5	9.6	9.7	9.8	9.9	0
1	10.0	10.1	10.2	10.3	10.4	10.5	10.6	10.7	10.8	10.9	1
2	11.0	11.1	11.2	11.3	11.4	11.5	11.6	11.7	11.8	11.9	2
3	12.0	12.1	12.2	12.3	12.4	12.5	12.6	12.7	12.8	12.9	3
4	13.0	13.1	13.2	13.3	13.4	13.5	13.6	13.7	13.8	13.9	4
5	14.0	14.1	14.2	14.3	14.4	14.5	14.6	14.7	14.8	14.9	5
6	15.0	15.1	15.2	15.3	15.4	15.5	15.6	15.7	15.8	15.9	6
7	16.0	16.1	16.2	16.3	16.4	16.5	16.6	16.7	16.8	16.9	7
8	17.0	17.1	17.2	17.3	17.4	17.5	17.6	17.7	17.8	17.9	8
9	18.0	18.1	18.2	18.3	18.4	18.5	18.6	18.7	18.8	18.9	9
10	19.0	19.1	19.2	19.3	19.4	19.5	19.6	19.7	19.8	19.9	10
11	20.0	20.1	20.2	20.3	20.4	20.5	20.6	20.7	20.8	20.9	11
12	21.0	21.1	21.2	21.3	21.4	21.5	21.6	21.7	21.8	21.9	12
13	22.0	22.1	22.2	22.3	22.4	22.5	22.6	22.7	22.8	22.9	13
14	23.0	23.1	23.2	23.3	23.4	23.5	23.6	23.7	23.8	23.9	14
15	24.0	24.1	24.2	24.3	24.4	24.5	24.6	24.7	24.8	24.9	15
16	25.0	25.1	25.2	25.3	25.4	25.5	25.6	25.7	25.8	25.9	16
17	26.0	26.1	26.2	26.3	26.4	26.5	26.6	26.7	26.8	26.9	17
18	27.0	27.1	27.2	27.3	27.4	27.5	27.6	27.7	27.8	27.9	18
19	28.0	28.1	28.2	28.3	28.4	28.5	28.6	28.7	28.8	28.9	19
20	29.0	29.1	29.2	29.3	29.4	29.5	29.6	29.7	29.8	29.9	20
21	30.0	30.1	30.2	30.3	30.4	30.5	30.6	30.7	30.8	30.9	21
22	31.0	31.1	31.2	31.3	31.4	31.5	31.6	31.7	31.8	31.9	22
23	32.0	32.1	32.2	32.3	32.4	32.5	32.6	32.7	32.8	32.9	23
24	33.0	33.1	33.2	33.3	33.4	33.5	33.6	33.7	33.8	33.9	24
25	34.0	34.1	34.2	34.3	34.4	34.5	34.6	34.7	34.8	34.9	25
26	35.0	35.1	35.2	35.3	35.4	35.5	35.6	35.7	35.8	35.9	26
27	36.0	36.1	36.2	36.3	36.4	36.5	36.6	36.7	36.8	36.9	27
28	37.0	37.1	37.2	37.3	37.4	37.5	37.6	37.7	37.8	37.9	28
29	38.0	38.1	38.2	38.3	38.4	38.5	38.6	38.7	38.8	38.9	29
30	39.0	39.1	39.2	39.3	39.4	39.5	39.6	39.7	39.8	39.9	30
31	40.0	40.1	40.2	40.3	40.4	40.5	40.6	40.7	40.8	40.9	31
32	41.0	41.1	41.2	41.3	41.4	41.5	41.6	41.7	41.8	41.9	32
33	42.0	42.1	42.2	42.3	42.4	42.5	42.6	42.7	42.8	42.9	33
34	43.0	43.1	43.2	43.3	43.4	43.5	43.6	43.7	43.8	43.9	34
35	44.0	44.1	44.2	44.3	44.4	44.5	44.6	44.7	44.8	44.9	35
36	45.0	45.1	45.2	45.3	45.4	45.5	45.6	45.7	45.8	45.9	36

Calculated by Julien A. Hall, M. Am. Soc. C. E.

ENGINEERING DEP'T.
CASS COUNTY

Ditch Box 4, B~~Notes~~ Notes on Sec line Surveys.
TWP 138-31.

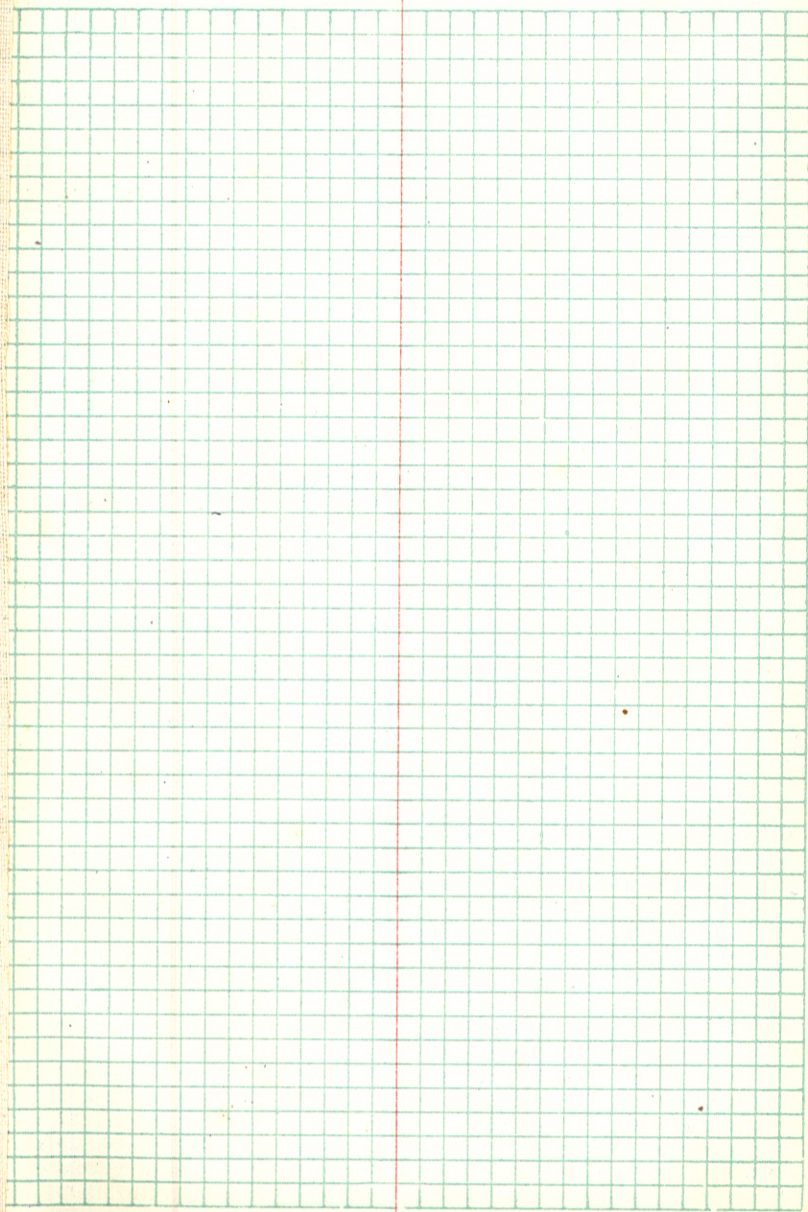

2 Random line W. var. $9^{\circ}30'$ Ditch Box 4, Bk 108 Between Secs 24 & 25 #310

1320 hub stake

2640 stake B.T.s gone.

5280 stake

5280 Cor sets N. $33^{\circ}30'$ W 59'

Find old SE B.T. Tam. 8" & set. Cor from that.

↑
Curo 1906.

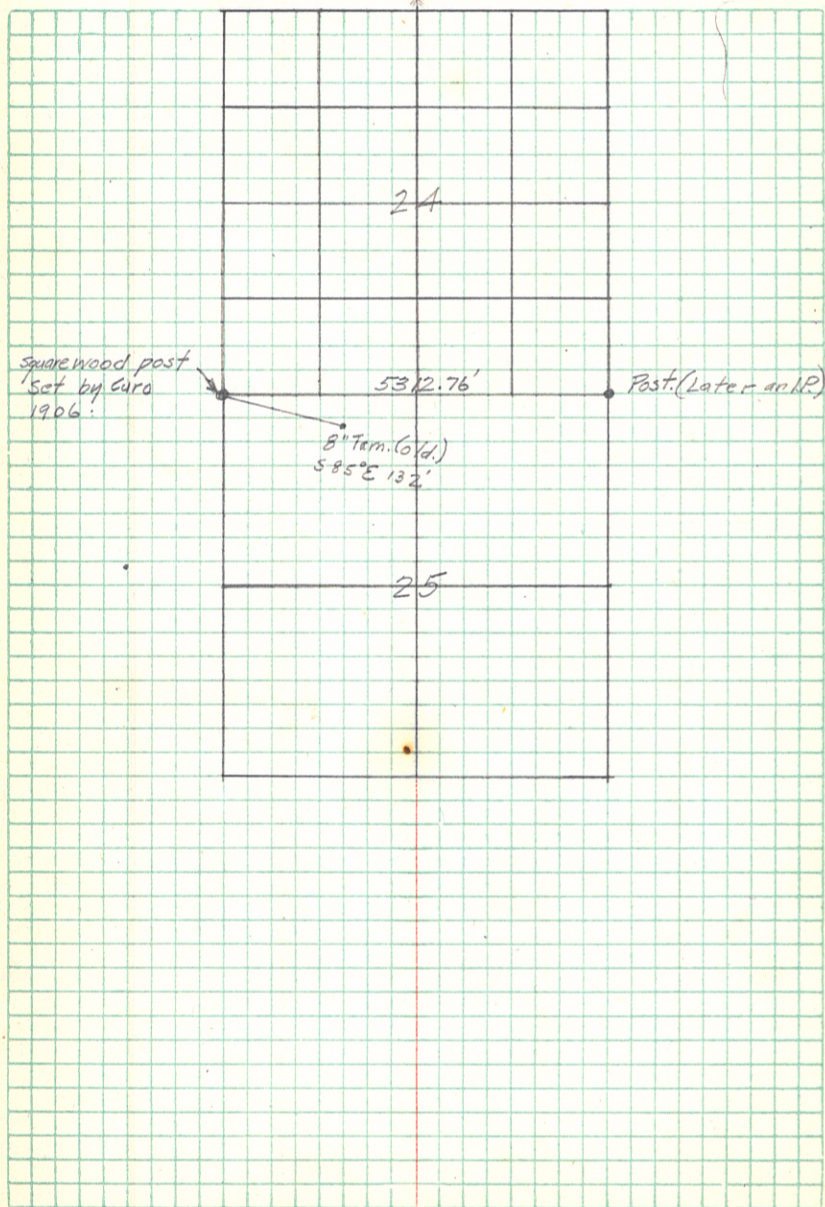

Running West From SE Cor Sec 23.

Bryant. May 1915.

				Correction
At 273'	Enter Pine River			
295'	leave " "			Runs S.W.
704.5	hub			2.5'
1126.5	hub	1320	4.8'	4.1'
1906.1	hub			7.0
2562.2	hub	2640	9.7'	9.4
3280.2	hub			12.1
3886.4	hub	3960	14.6	14.3
4333.1	hub			
4766	Enter Halverson Creek.			
4775	leave " "			
4796	Enter Creek.			
4810	leave " "			
5280	set pin			19.4'
5280.3	Cor sets N. 19.4 ft.			
U.S. B.T.s				
N.P. 14	S 27 E ⁸³ 54.78 ft.	- N. Pine 8 N 7° W 31 -		
N.P. 8	S 15 W 66	- N.P. 20 S 45 E. 150		

4

Random Line West - 10° Kar

Ditch Box 4,

Bk 108

Bet. Sta 22 & 27.
Bryant. 1915. May 12th, 13th

#297

715.2 hub.

1320 hub.

7765 hub.

2640 hub.

3251.1 hub.

4048.4 hub.

4551.9 hub.

4615.6 hub. "A" East side Lake.

set hub on W. side of Lake "B"

5387.3 hub. "D"

5387.3 Cor. sets. 557.0'

Found B.T.s down but found Original
Post.

W.

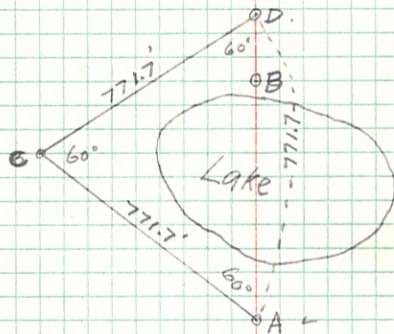

5

Random Line South Ditch Box 4, BR 108 Sec. 27-28

var. 7'45"

#297.

Bryant - May 13-1915
174

140.7 hub. Taphill.

955.5 hub.

1320 hub.

2000 hub.

2640 hub.

Quit.

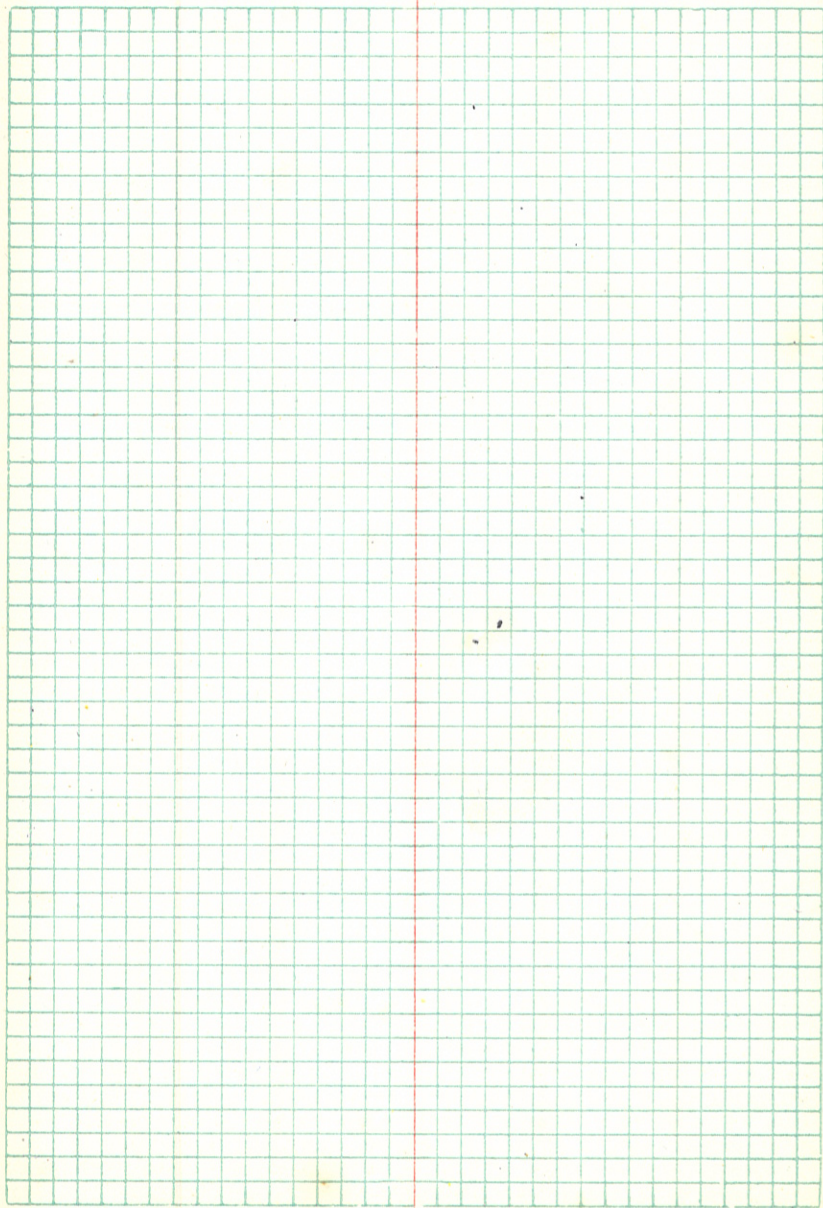

Notes on Cor. "I."

4 inch hub + tack set here by Moulster from old B.T.s. Checked up by Curo + Donner on Aug 29th 1914.

Set new B.T.s as follows. Tack in.

Green N.P. stump 14" S 65° 36' W 36.02' Var 7°

~~Green N.P. stump 14" S 65° 36'~~

Notes on 1/4 Cor. "i"

Curo finds both old Govt B.T.s stumps plainly marked, as follows.

Tam 6 N 48 1/2° W 42; Tam 5 N 22° E 20.

Also found old sq. stone which checks O.K.

Set new B.T.s as follows.

Dead Tam 8" S 63° 45' E. 81.9' } To tack heads.

Dead Tam 10" S 28° 09' W 78.95'

Var. 6° 45'

Iron Monuments set by Curo as follows.

1/4 East side Sec. 13.

Cor. "K." ^{{ New B.T.s}
 aspen 5 N 48° 45' E 56.4' } Tack hds.
 aspen 7 N 66° 30' W 60.35' }
 Var 6° 30'

Cor. "L." ^{{ New B.T.s}
 N.P. 14 S 66° E. 45.18' } Tack heads
 N.P. 12 S 36° 15' W 84.08' }
 Var 6° 30'

Ditch Box 4, Bk 108

R. _____ M. _____

A	a	B	b	C	c	D	d	E	e	County	F	f	G
y	6		5		4		3		2		6	1	g
Y													H
x	7		8		9		10		11		5	12	h
X													I
w	18		17		16		15		14		4	13	i
W													K
v	19		20		21		22		23		3	24	k
V													L
u	30		29		28		27		26		2	25	l
U	6		5		4		3		2		1		M
t	31		32		33		34		35		1	36	m
T	v	S	r	R	q	Q	p	P	o	O	n		N

Copyright © 1988 by E. J. Sponner

