

A. W. Houston

91

CROSS SECTION BOOK

No. 391 T.

A. W. Moulton

Dec. 1915

PROPOSED BRIDGE
 # 779
 At Inguado Narrows
 Sec. 32-T. 141, R. 27

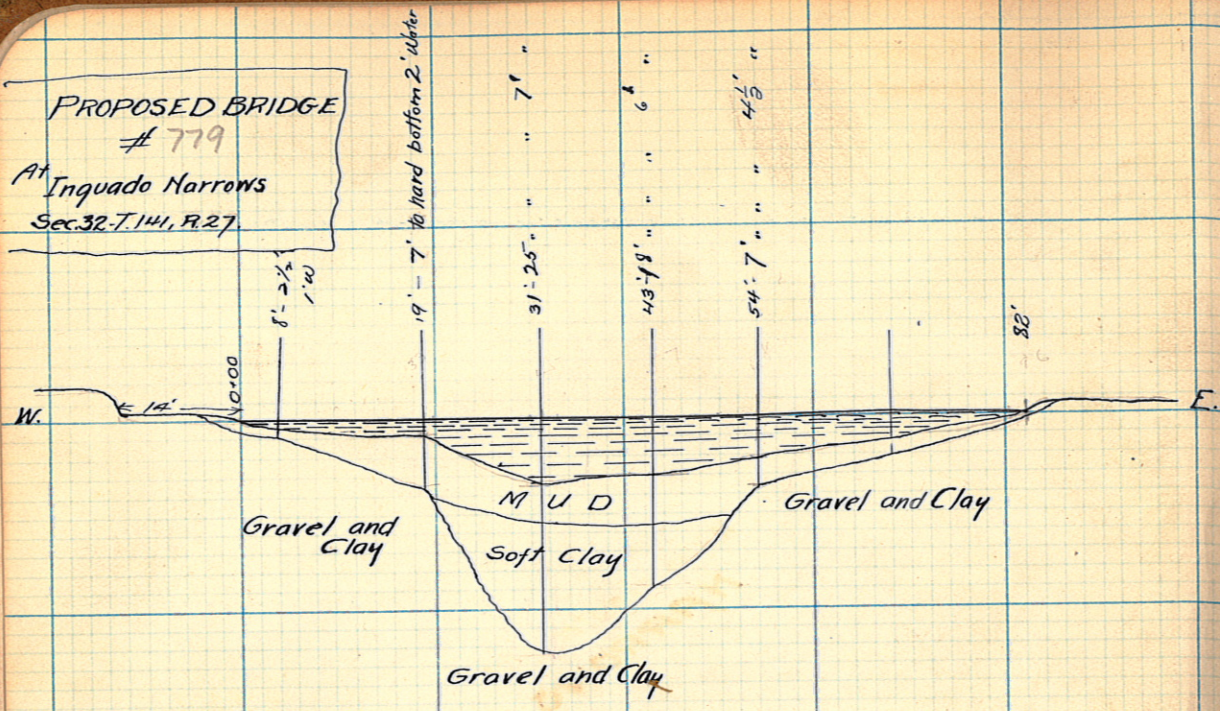

Cross Section of Narrows - Main Channel.

Surveyed - Jan. 16-17, 29-30 - 1913.

PROPOSED BRIDGE #779
At Inquado Narrows

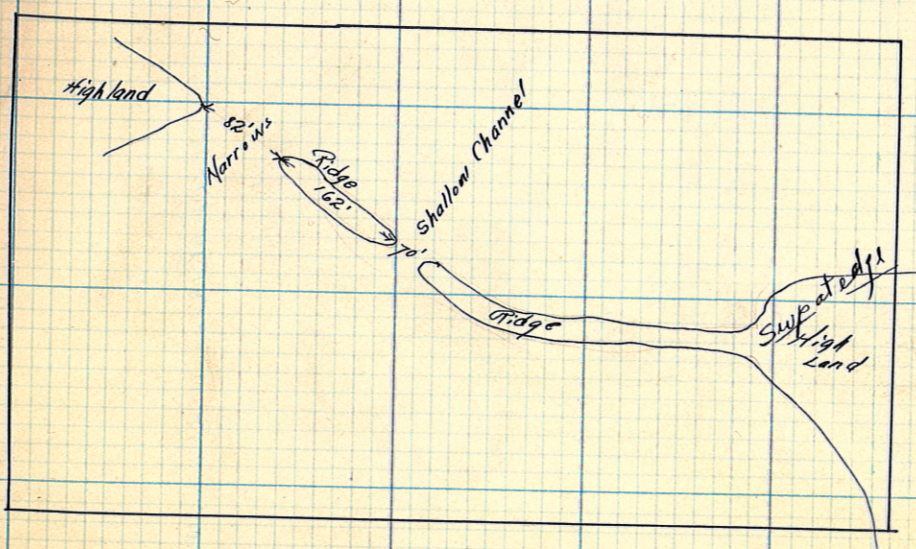
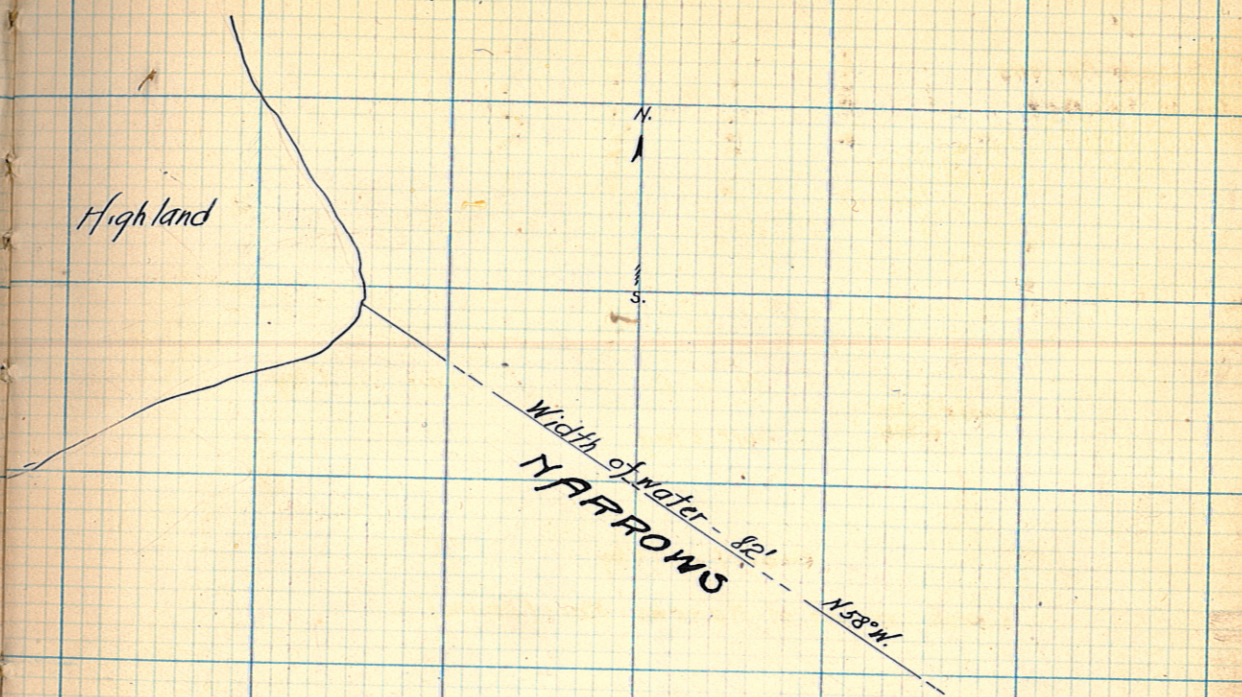

Rock and Sand Ridge
6' to 8' wide