

Book No 1  
TRANSIT & LEVEL  
STATE ROAD No 12

(13)

Jenkins to SRH 80  
(From SE (or. Sec 29 to SW (or. Sec 30)

(13)

FIELD BOOK

361

56

End of survey.

+ 47.7 Sec. Cor.

- 105
- 104
- 103
- 102
- 101
- 100
- 99
- 98
- 97
- 96
- 95
- 94
- 93
- 92

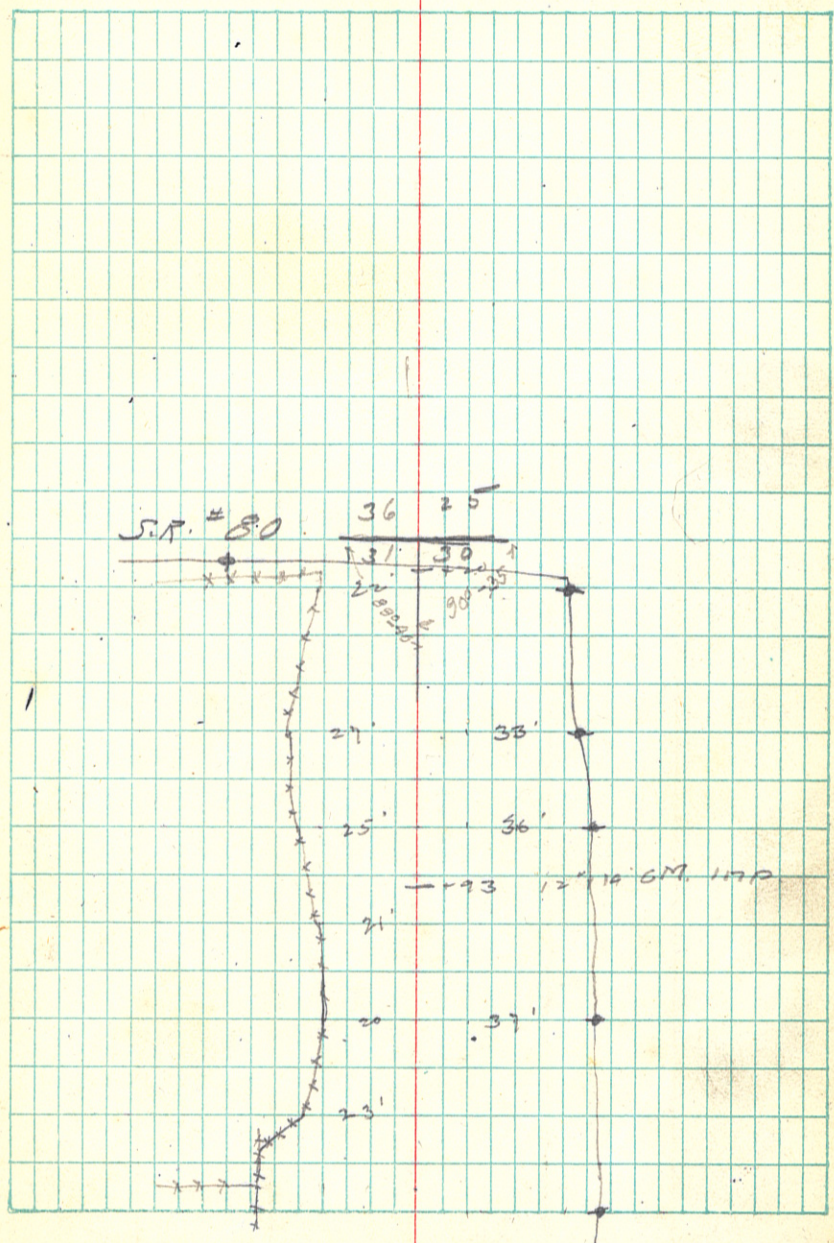

8-19-20  
 G. Westman 3  
 R. Peterson  
 B. Westman

Sta.  $\Delta$  Mag. bear

- 18
- 17
- 16
- 15
- +915 P.O.T.
- 14
- 13
- 12
- 11
- 10
- 9
- 8
- 7
- 6
- 5
- 4
- 3
- 2
- 1

0+00 = 373 + 89.5 P.R. Jenkins road.  
 Start at cor. of sec. 29 + 28 T137-29  
 32 / 33

1st. clearing  
 2rds. cut  
 3rds. light brush

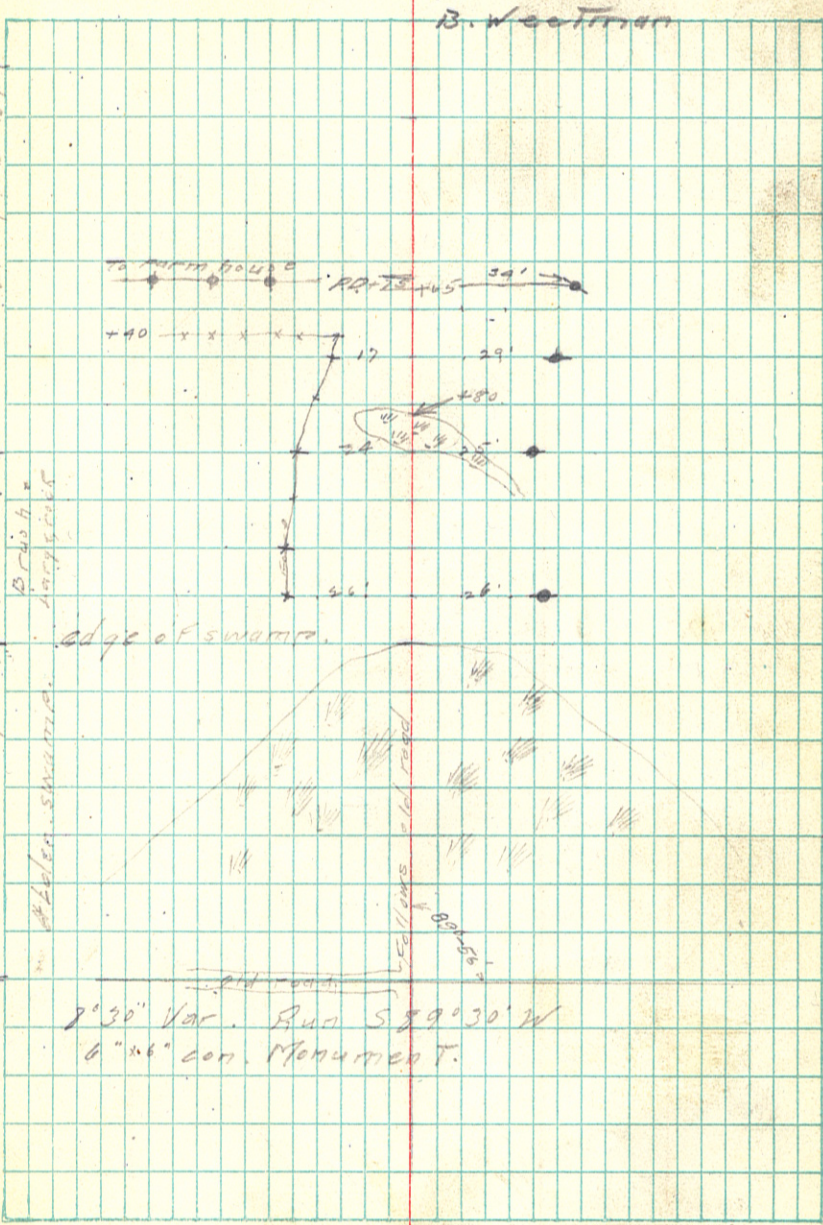

8°30' Var. Run S 89°30' W  
 6" x 6" con. Monument.

Sta. Mag. bear

- 43
- 42
- 41
- 40
- 39
- 38
- 37
- 36
- 35
- 34
- 33
- 32
- 31
- 30 P.O.T. S 89° 30' W
- 29
- 28
- 27
- 26
- 25
- 24
- 23
- 22
- 21
- 20
- 19

No. 6 & 9  
 \* Sub. very moist clearing  
 brush very dense  
 keep records

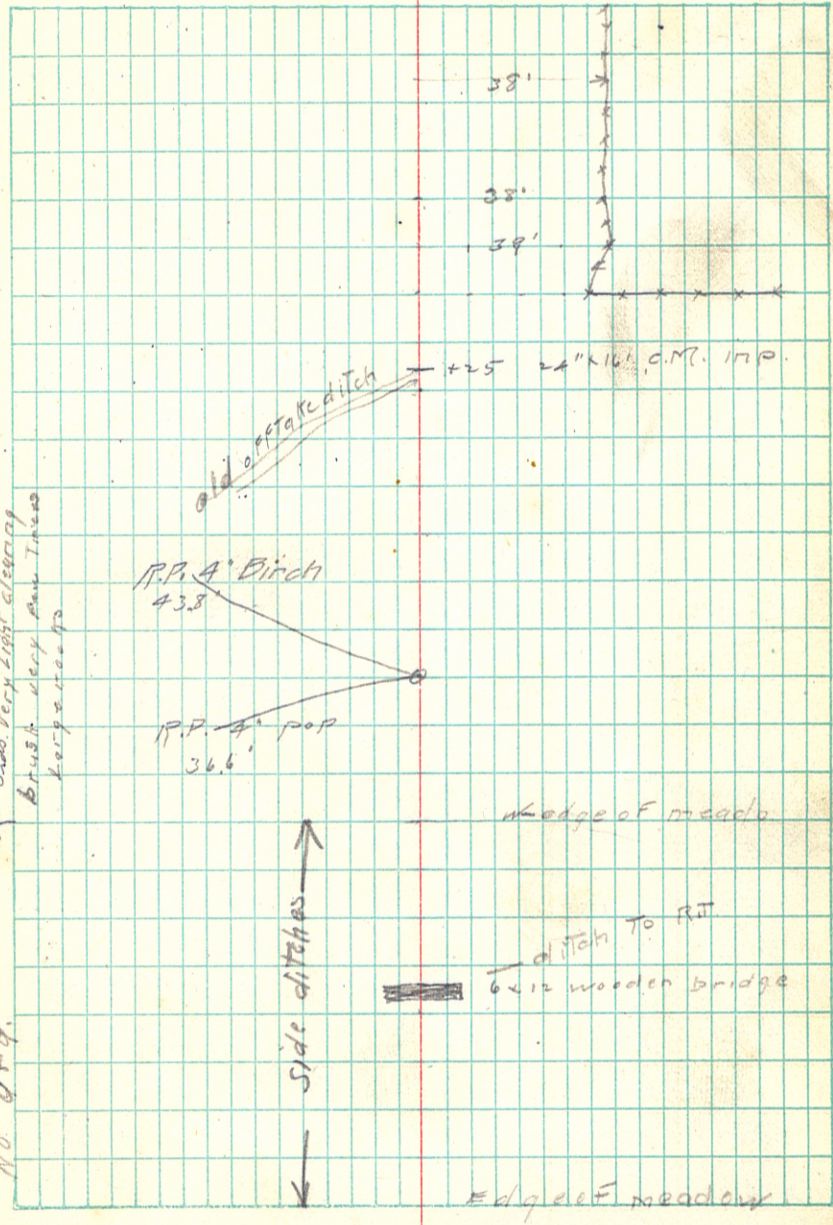

Sta.	Δ	Mag. bear.
+587	P.O.T.	
66		
65		
64		
63		
62		
61		
60		
59		
58		
57		
56		
55		
54		
53		
+963	$\Delta 0^{\circ}12' R$	$589^{\circ}42' W$
52		
51		
50		
49		
48		
47		
46		
45		
44		

8-23-20  
G. Weetman  
R. Peterson  
B. Weetman

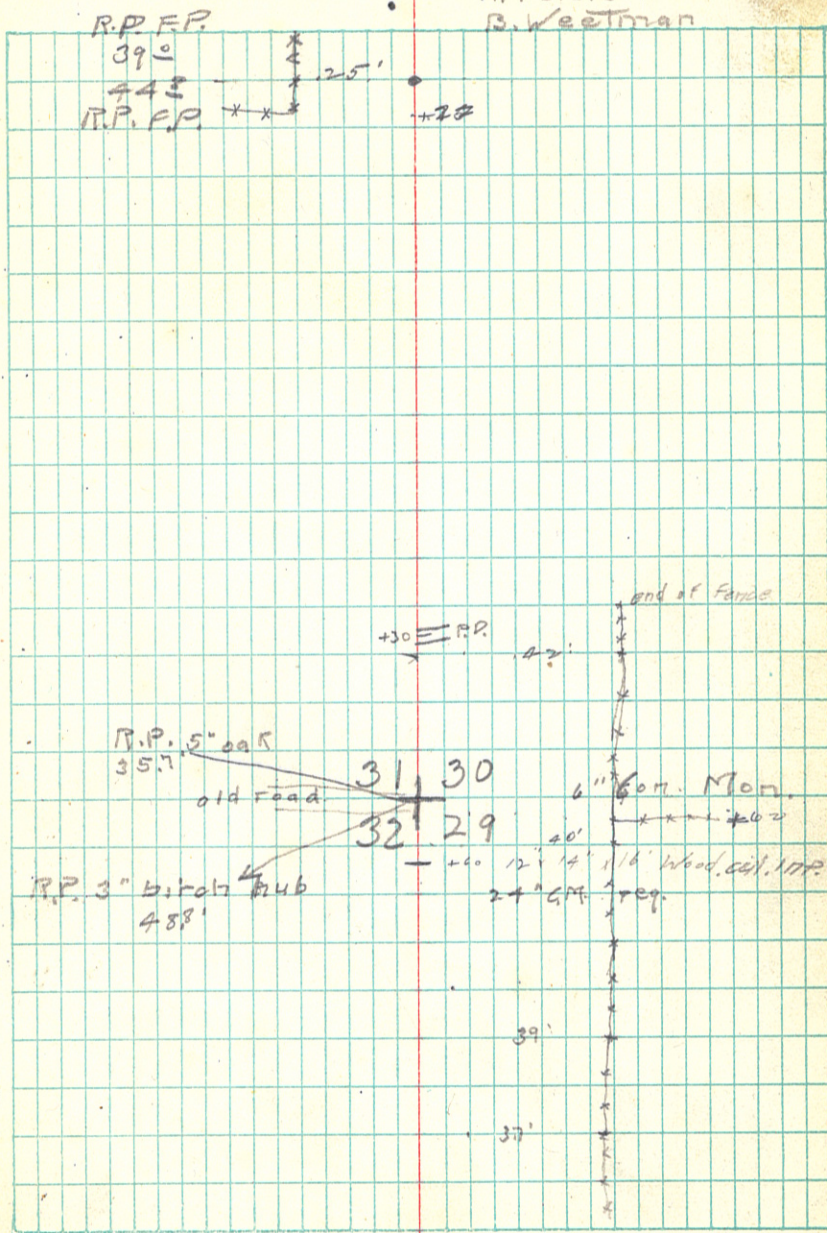

Concluded on page #1

6

- 91
- 90
- 9
- 8
- 7
- 6
- 5
- 4
- 3
- 2
- 1
- 80
- +44.8 P.O.T. 1/4 Cor
- +7.9
- 78
- 77
- 76
- 75
- 74
- 73
- 72
- 71
- 70
- 69
- 68
- 67

