

CERTIFICATE OF SURVEY

For Ditech Financial LLC

LOTS 13 THRU 17, BLOCK 25,
PLAT OF THE VILLAGE OF BENA,
CASS COUNTY, MINNESOTA.

Legal Description:

Lots Thirteen (13) Thru Seventeen (17), Block Twenty-five (25), PLAT OF THE VILLAGE OF BENA, Cass County, Minnesota.

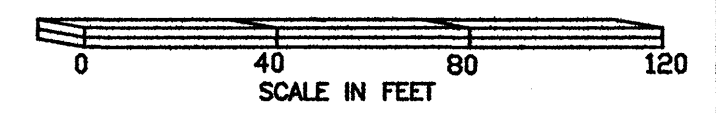
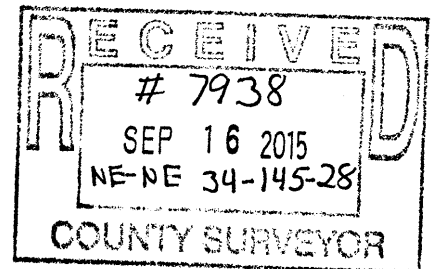

THE BEARING ORIENTATION OF THIS SURVEY IS BASED ON THE EAST LINE OF BLOCK 25, PLAT OF THE VILLAGE OF BENA, IS ASSUMED TO BEAR N00°06'05"E.

LEGEND	
●	DENOTES IRON MONUMENT FOUND
○	DENOTES SET 3/4"X18" IRON PIPE W/PLASTIC CAP STAMPED "45353"
x	DENOTES CALCULATED POSITION
(325.00)	DENOTES DEED OR PLAT MEASURE
▨	DENOTES SAND/GRAVEL SURFACE
⊙	DENOTES SEPTIC CLEANOUT
⊗	DENOTES WELL
⊕	DENOTES PROPANE TANK

EagleEye Data Services
32214 Southwood Road
Grand Rapids, MN 55744
(218)244-7030

I HEREBY CERTIFY THAT THIS SURVEY, PLAN OR REPORT WAS PREPARED BY ME OR UNDER MY DIRECT SUPERVISION AND THAT I AM A DULY LICENSED LAND SURVEYOR UNDER THE LAWS OF THE STATE OF MINNESOTA.

SIGNATURE: *Corey J. Hendershott*
COREY J. HENDERSHOTT

DATE 09-08-15 LIC. NO. 45353

- Surveyor's Note:**
- The purpose of this survey was to stake the Boundary of Lots 13-17, PLAT OF THE VILLAGE OF BENA.
 - No building exist with in the Lots 13-17, Block 25, PLAT OF THE VILLAGE OF BENA.
 - The existing house lies within the undeveloped FIFTH STREET and Lot 24, Block 28.