

NW COR SEC 19-139-26

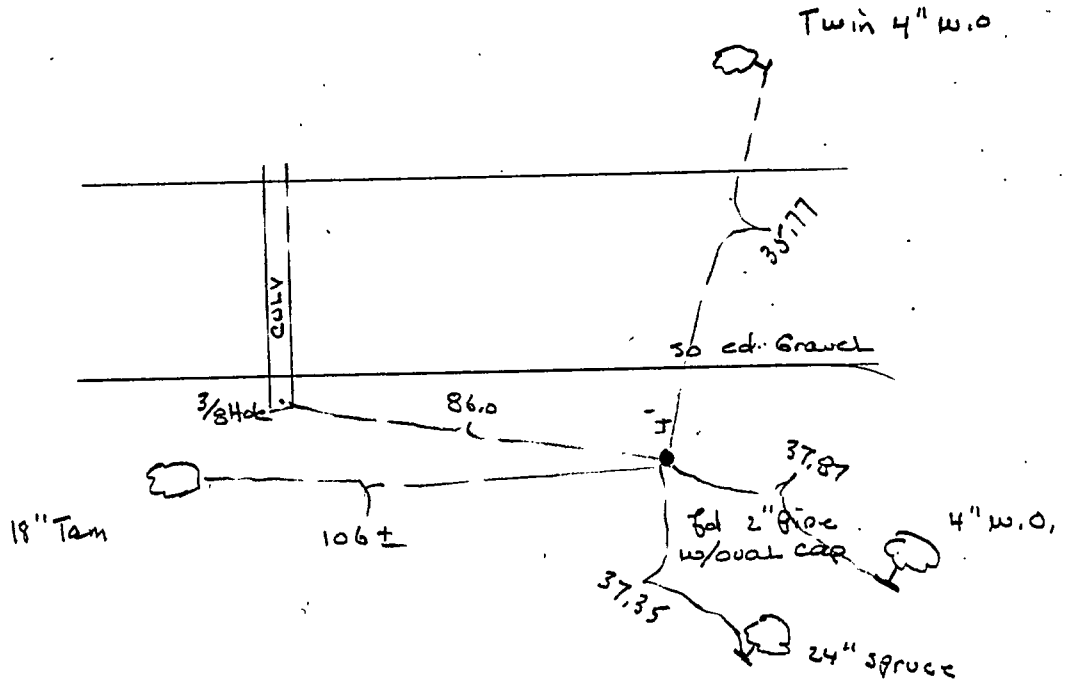

Ties from 11 June 1984

**WALLACE F. BUCKLER**  
REGISTERED LAND SURVEYOR  
NORTH LAKESHORE DRIVE P.O. BOX 144 CROSBY, MN 56441-0144

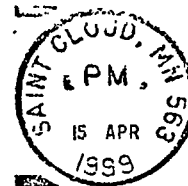

Bob Kovanen  
Cass County Surveyor  
P.O. Box 579  
Walker, MN 56484