

Road Survey

TOWN OF ANSEL T. 137. R. 32.

JUNE 20-21-22-23-24-1905

Found corner with iron pipe
Set by corner. Pl. 100 5.17 10.8
Set by corner. Pl. 100 3 5.21 10.8
400 0.14

S.P. 2-Town-103
T.P. N. 40.0

Station No. 2

Station No. 3

Station No. 4

Station No. 5

Station No. 6

RANGE 32W.

TOWNSHIP 137. N

THE 3 CORNERS
STATION NO.
BEARING
DISTANCE

N 88° 49' E 16
10452.6

N 1° 12' W 15
2609.75

N 1° 25' W 22
2588.75

N 0° 45' W 26
2623

N 0° 54' W 27
7888

N 1° 12' W 28
2609.75

N 1° 25' W 29
2588.75

N 0° 45' W 30
2623

N 0° 54' W 31
7888

N 1° 12' W 32
2609.75

N 1° 25' W 33
2588.75

Station	Bearing	Distance	Remarks
1			Being cor. betw Sec 16 & 17.
2	N 88° 49' E	10452.6	To station # 2
3			1/2 corner Foot Line Sec. 15.
3			Being S.E. corner Sec 15.
4	N 0° 45' W	2623	To station No. 2
5	N 0° 54' W	7888	To " " " " " " " " " " " "
6	N 1° 12' W	2609.75	" " " " " " " " " " " "
7	N 1° 25' W	2588.75	" " " " " " " " " " " "
8			Being N.E. corner Sec 3.
Copy of description in "Superior Road order."			
Beginning at quarter post on west line of Sect. 16.			
Thence East ③ 100 miles to quarter post on East			
line of Sect. 15 - 137-32. Thence beginning at the			
S.E. corner of Sect. 15 Thence north 1/2 mile			
to town line.			

#4705

M.H.S.M.S. C.E.

Root Survey

TOWN OF AMSEL T. 137. R. 32.

JUNE 20. 1882. 23 N. 24. 1305

Found corner with No. 23. 7. 1305
Set for station No. 23. 7. 1305
2408' 0.00' - 121 ft. 5. 24. 1305

J.P. 5. 2. 1. 1305
J.P. N. 23

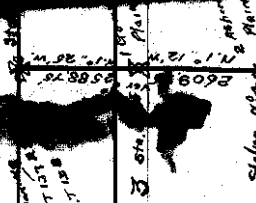

TOWNSHIP 137. N RANGE 32. W.

Station No. 23
Bearing N. 88.49 E 16 Var 8°
100.52 ft.

15

22

T. 137. R. 32. S. E.

Station	Bearing	Distance	Remarks
1			Bearing $\frac{1}{2}$ cor. betw Sec. 16 & 17.
2	N. 88.49 E.	100.52 ft.	To station # 2
3			$\frac{1}{2}$ corner East Line Sec. 15.
4	Bearing S. E. corner Sec. 15.		
5	N. 0.43 N.	2623 ft.	To station No. 2
6	N. 0.54 W.	7888 ft.	To " " " 4 = 3000 ft. 10. 11
7	N. 1.12 W.	2609.75 ft.	" " " 5 = 2000 ft. 20. 23.
8	N. 1.25 W.	2588.75 ft.	" " " 6.
9			Bearing N. E. corner Sec. 3.
Copy of description in Supervisors' Record order.			
Beginning at quarter post on west line of Sect. 16, Thence East \odot two miles to quarter post on East line of Sect. 15 - 137-32. Thence beginning at the S.E. corner of Sect. 15 Thence north 1.3 miles to town line.			

24705

