

J

MAP OF

JUDICIAL ROAD # 3

Cass & Crow Wing Counties, Minnesota

Township 136, Rg. 29

Surveyed June 28<sup>th</sup> 1915

Road #37

James Ingram, surveyor in charge

Ernest Roney, Chairman

Hjalma Olson

Frank Bryant

Sec. 34  
Sec. 35

Township 137, Rg. 29

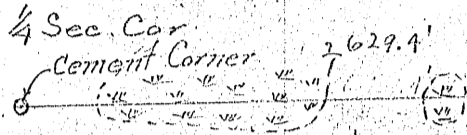

Correction Line

Township 136, Rg. 29

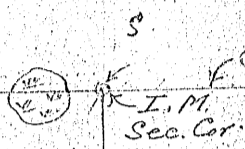

2337.2'

North  
Yor. 7°30'

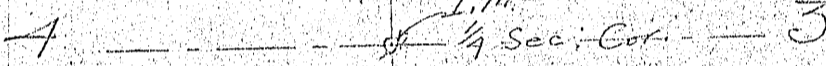

2684.88'

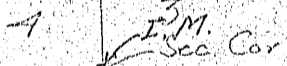

9 10

2699.40'

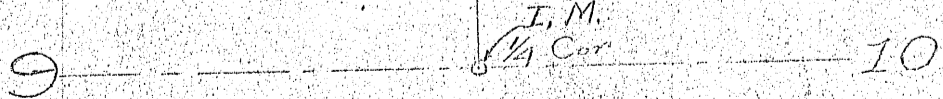

Note:  
Really  
surveyed  
by James Olson