

N. PARK IN DAWES SECOND ADDITION, PINE RIVER, MINN.  
 BILL SPAHN, LAND SURVEYOR, REG # 2003

Scale: 1" = 20 FT.  
 6-14-74 R.A.M.

I hereby certify that this survey, plan, or report was prepared by me or under my direct supervision and that I am a duly Registered Land Surveyor under the laws of the State of Minnesota.

W. J. Spaine, Jr.  
 Date: 9 June, 1974. Reg. No. 2003

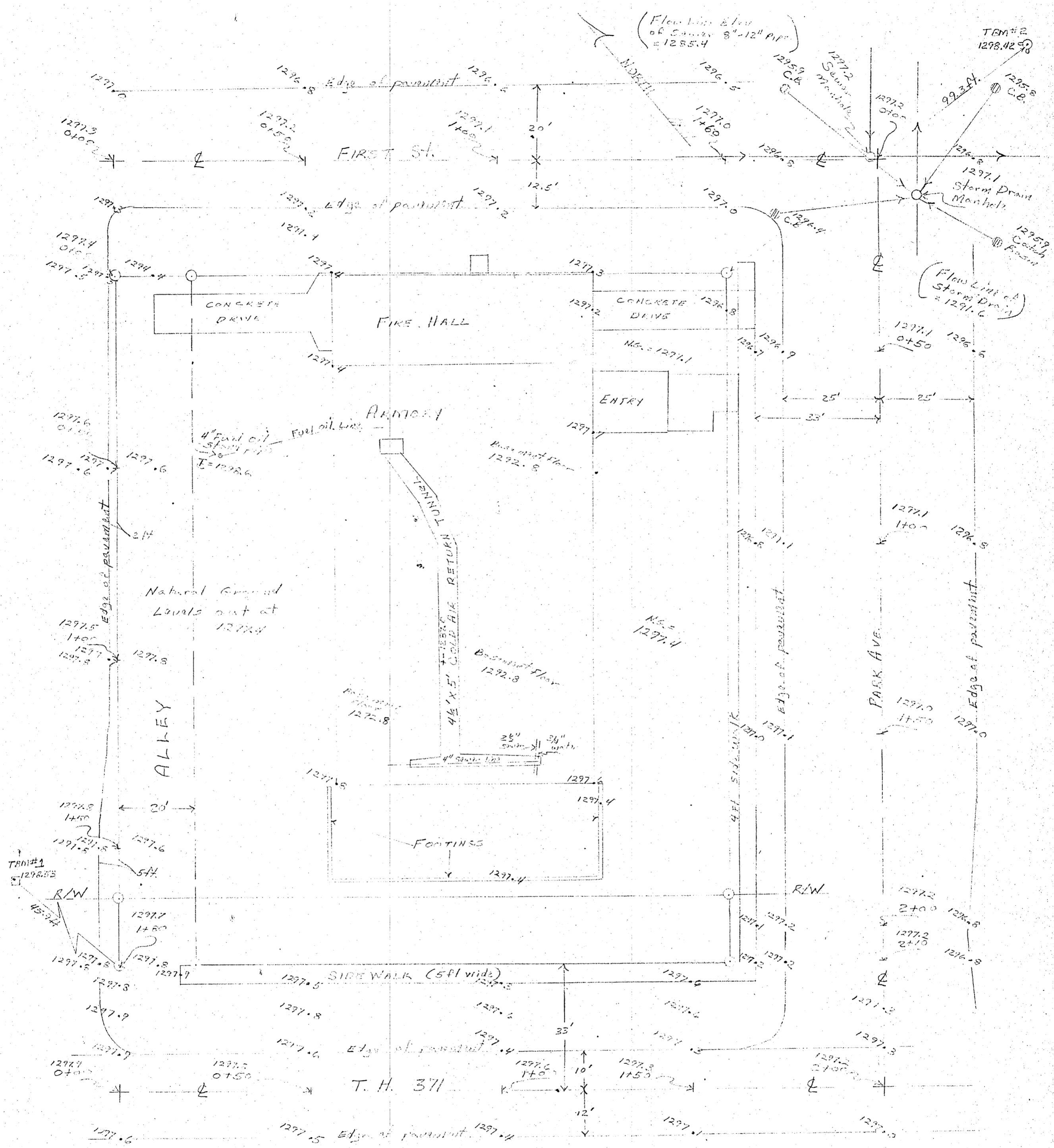

**SEA LEVEL DATUM**  
 TBM#1 (1298.3) = Top of Iron Nail at N.E. corner of 2'x2' concrete slab foundation  
 TBM#2 (1298.42) = Top of Iron Hydrant at S.W. corner of Park Ave & First Street

PROFILES, CROSS SECTIONS AND ELEVATIONS  
 N. PARK IN DANCE SECOND ADDITION, PINE RIVER, MINN.  
 BILL SMITH, LAND SURVEYOR  
 I hereby certify that this survey, plan, or report was prepared by me or under my supervision and that I am duly qualified as a Land Surveyor under the laws of the State of Minnesota.  
 M. J. Spaine, Jr.  
 Date 19 June 1974 Reg. No. 2003

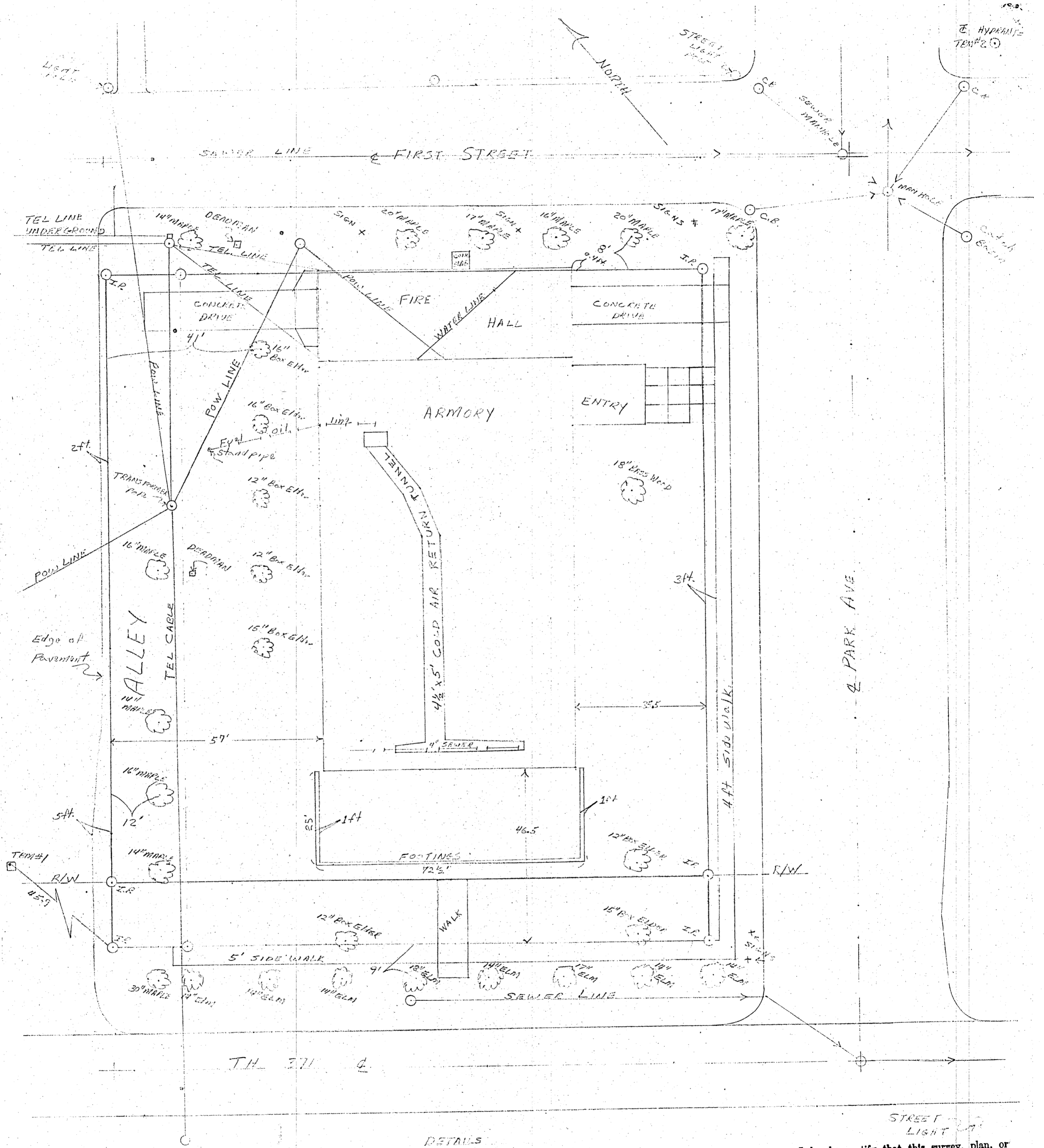

DETAILS  
 N. PARK BL. 2ND SECOND ADDITION, PINE RIVER, MINN.  
 ERIC SWAN, LAND SURVEYOR, REG. # 2063  
 2001-2001  
 6-19-74 RAIA

STREET LIGHT  
 I hereby certify that this survey, plan, or report was prepared by me or under my direct supervision and that I am a duly Registered Land Surveyor under the laws of the State of Minnesota.  
 W. J. Swain, Jr.  
 Date 19 June 1974 Reg. No. 2063

# 4444