

# CERTIFICATE OF SURVEY

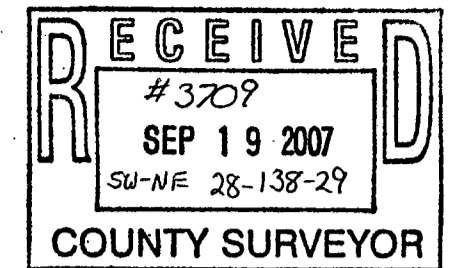

Scale: 1 inch = 100 feet

Bearings based on assumed datum.

- Denotes iron monument found
- Denotes iron monument set
- ⊙ Sanitary sewer manhole
- ⊙ Sanitary sewer cleanout
- ⊞ Electric Transformer
- ⊕ Well

**LEGAL DESCRIPTION FOR TRACT A:**

The West Half of the Southwest Quarter of the Northeast Quarter of Section 28, Township 138 North, Range 29 West, Cass County, Minnesota. Subject to a permanent easement for ingress, egress and utility purposes over under and across the south 33.00 feet of the East 375.00 feet of said West Half of the Southwest Quarter of the Northeast Quarter. Subject to easements, reservations and restrictions of record, if any.

**LEGAL DESCRIPTION FOR TRACT B:**

The East Half of the Southwest Quarter of the Northeast Quarter of Section 28, Township 138 North, Range 29 West, Cass County, Minnesota.  
 EXCEPT  
 The Southeast Quarter of the Southeast Quarter of the Southwest Quarter of the Northeast Quarter of said Section 28.  
 TOGETHER WITH  
 A permanent easement for ingress, egress and utility purposes over under and across the south 33.00 feet of the East 375.00 feet of the West Half of the Southwest Quarter of the Northeast Quarter of said Section 28. Subject to easements, reservations and restrictions of record, if any.

I hereby certify that this survey was prepared by me or under my direct supervision and that I am a duly Licensed Land Surveyor under the laws of the State of Minnesota.

*Paul Herkenhoff* 9-5-07  
 Paul Herkenhoff, R.L.S. Date  
 Registration No. 45875

REQUESTED BY:

**CURT BAUMAN**

**Westwood**  
 Westwood Professional Services, Inc.  
 423 Laurel Street  
 Brainerd, MN 56401  
 PHONE 218-829-1751  
 FAX 218-829-4733  
 TOLL FREE 1-800-270-9495  
 www.westwoodps.com

Drawn by: KPM Date: 9/4/07 Job No: 20077788

