

WATER ELEV. 1294.13
JAN. 7, 1969

SCALE: 1 INCH = 30 FEET
 ○ = IRON PIN
 ⊕ = POWER POLE
 ✖ = LIGHT POLE

NOTE: SURFACING CONDITIONS SUCH AS CONCRETE OR BITUMINOUS NOT LOCATED BECAUSE OF ICE & SNOW CONDITIONS.
 NOTE: DISTANCES GIVEN ON CORNERS OF HOUSE OVER LINE ARE TO CORNERS OF MAIN STRUCTURE & DO NOT INCLUDE PLANTERS OR ROOF OVERHANG.

BENCH MARK ELEV. 1323.38
 TOP OF TOP NUT - FIRE HYDRANT
 NE COR. INT. FIFTH ST. & CLEVELAND BLVD.

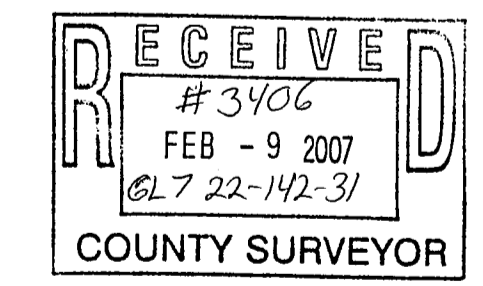

**CITY DOCK SURVEY - WALKER, MINN.
 PART OF BLOCK 3, ORIG. TOWN - WALKER**

I hereby certify that this survey, map or report was made by me or under my direct supervision and that I am a duly Licensed Professional Engineer and a duly Licensed Land Surveyor of the State of Minnesota.
R. F. Schneider
 Date JAN. 1969 Rec. No. 5740
R. F. SCHNEIDER
 REGISTERED LAND SURVEYOR
 MINN. REG. NO. 5740