

# CERTIFICATE OF SURVEY

THE SOUTH 600.00 FEET OF  
THE NORTHWEST QUARTER OF THE SOUTHWEST QUARTER OF  
SECTION 33, TOWNSHIP 134 NORTH, RANGE 29 WEST,  
CASS COUNTY, MINNESOTA.

WEST QUARTER CORNER  
SECTION 33-134-29

N 00°30'39"W  
729.44'

N 89°46'28"E  
31.41'

N 89°46'28"E  
357.52'

N 89°46'28"E  
384.99'

NORTH LINE OF THE  
SOUTH 600.00 FEET OF THE  
NW<sup>1</sup>/<sub>4</sub> - SW<sup>1</sup>/<sub>4</sub>  
SECTION 33-134-29

N 89°46'28"E  
554.55'

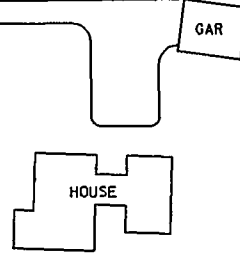

SEPTIC

EAST LINE OF THE  
NW<sup>1</sup>/<sub>4</sub> - SW<sup>1</sup>/<sub>4</sub>  
SECTION 33-134-29

WEST LINE OF  
SECTION 33-134-29

N 00°30'39"W  
560.01'

N 89°46'28"E

N 00°30'39"W  
560.01'

N 89°46'28"E

N 00°30'39"W  
560.00'

N 89°46'28"E

LYNCH  
LAKE

NORTH LINE OF THE  
SOUTH 40.0 FEET OF THE  
NW<sup>1</sup>/<sub>4</sub> - SW<sup>1</sup>/<sub>4</sub>  
SECTION 33-134-29

EAST LINE OF THE  
WEST 388.92 FEET OF THE  
NW<sup>1</sup>/<sub>4</sub> - SW<sup>1</sup>/<sub>4</sub>  
SECTION 33-134-29

N 89°46'28"E

388.93'

POWER LINES

N 00°30'39"W  
40.00'

N 89°46'28"E

175.00'

N 89°46'28"E

1152.68'

SOUTH LINE OF THE  
NW<sup>1</sup>/<sub>4</sub> - SW<sup>1</sup>/<sub>4</sub>  
SECTION 33-134-29

- = IRON MONUMENT FOUND IN PLACE
- = IRON MONUMENT SET, MARKED RLS 23668

ORIENTATION OF THIS BEARING SYSTEM  
IS THE NORTH AMERICAN DATUM OF 1983,  
CASS COUNTY COORDINATE SYSTEM.

SCALE : 1 INCH = 100 FEET

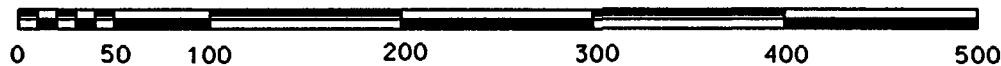

I HEREBY CERTIFY THAT THIS SURVEY WAS PREPARED  
BY ME OR UNDER MY DIRECT SUPERVISION, AND THAT  
I AM A DULY LICENSED LAND SURVEYOR UNDER THE  
LAWS OF THE STATE OF MINNESOTA.

*James Kramer* 3-3-2000  
JAMES KRAMER, LAND SURVEYOR  
MINNESOTA REGISTRATION NO. 23668

SOUTHWEST CORNER  
SECTION 33-134-29

N 00°30'39"W  
1329.45'