

Assessment & Tax List 1958

Hiram



SECTION	PAGE
---------	------

Sec. 1	
" 2	
" 3	
" 4	
" 5	
" 6	
" 7	
" 8	
" 9	
" 10	
" 11	
" 12	
" 13	
" 14	
" 15	
" 16	
" 17	
" 18	
" 19	
" 20	
" 21	
" 22	
" 23	
" 24	
" 25	
" 26	
" 27	
" 28	
" 29	
" 30	
" 31	
" 32	
" 33	
" 34	
" 35	
" 36	

### For Convenience of Auditor in Showing Boundaries of School Districts

Township No. 140 Range No. 31 Mer. P. M.

0	5	4	3	2	1
7	8	9	10	11	12
13	17	16	15	14	13
10	20	21	22	23	24
30	20	23	27	26	25
31	32	33	34	35	36

Returns Showing Grain Received in or Handled by Elevators, Warehouses and Mills in the \_\_\_\_\_ of \_\_\_\_\_ in the  
County of \_\_\_\_\_ for the Year Ending May 1, 1958.

[illegible]

**Note ★ Assessors will not fill these Columns**



# SUMMARY OF TAX COLLECTION

Original Levy	-	-	-	-	-	\$	19522.98	
Additions	-	-	-	-	-	\$	117.34	=
							\$19640.32	
Abatements	-	-	-	-	-	\$	156.14	
							\$19484.18	

## COLLECTIONS

March Settlement	-	-	-	-	-	\$	3087.05	
June Settlement	-	-	-	-	-	\$	11,706.85	
November Settlement	-	-	-	-	-	\$	3096.22	
January Settlement	-	-	-	-	-	\$	371.75	\$18,261.87
								\$
Over Collected	-	-	-	-	-	\$	7.44	
Under Collected	-	-	-	-	-	\$		
Delinquent	-	-	-	-	-	\$	122,913.5	\$122,221.31
Total	-	-	-	-	-	\$	19484.18	



LEVIED IN THE Town OF Hiram

Assessed Value	Rural	All Other	Personal Property	Total
Homestead	12,235			12,235
Non-Homestead	53,832		11,011	63,843
Total	65,067		11,011	76,078

Total Taxes Real Estate 16,647.54  
Pers. Prop. 2875.44  
Total 19,522.98

COUNTY OF CASS, STATE OF MINNESOTA

County: R. & B. Bldg. 15216  
Agric Bldg. 3804  
830544

SEAL

**Real Estate**



## COLLECTIONS OF TAXES OF 1958

Town OF *Nissau*

CASS COUNTY, MINNESOTA

FUNDS	MARCH SETTLEMENT 1957	JUNE SETTLEMENT 1957	NOV. SETTLEMENT 1957	Amount Collected from Nov. 1957 to First Monday in Jan. 1958	REDUCTIONS	Total Reductions and Collected	BALANCE UNCOLLECTED	ADDITIONS	Total Uncollected to First Monday in January, 1958
State-Non-Homestead,	7643	25329	5320	560					
State-Homestead,	6993	26884	7187	871					
County Revenue,	35013	134602	35984	4362					
County Road and Bridge,	17778	68349	18272	2215					
County Welfare,	61254	235486	62954	7630					
County Bond and Interest,									
R. & B. Fed. Proj.	5926	22783	6091	738					
Co. Nurse	2370	9113	2436	295					
R. & B. Bldg.	2370	9113	2436	295					
Town Revenue,	5452	20960	5603	679					
Town Road and Bridge,	19438	74728	19978	2421					
Town Drag,	1185	4557	1218	148					
Town State Loan,									
School Local 1 Mill,	1185	4556	1218	148					
School Special,	46687	167416	43863	4926					
School State Loan,									
Deficiency	74669	287067	76743	9302					
Tuition									
Transportation	1718	6628	1767	214					
C. O.	11854	45566	12181	1476					
PERA	2489	9569	3559	311					
PERA	4089	15720	4203	509					
Agri. Ass'n	592	2279	609	75					
	308765	1170685	309622	37175					

	School District No.	LOCAL 1 MILL	SPECIAL	STATE LOAN	Deficiency	Drainage	C. O.	PERA	TOTALS
MARCH SETTLEMENT	<i>Un a</i>	36	722		2274	52	362	76	3522
	<i>Un na</i>	1149	45965		72395	1666	11492	2413	135080
	Totals	1185	46687		74669	1718	11854	2489	138602
JUNE SETTLEMENT	<i>Un a</i>	742	14848		46773	1077	7424	1559	72443
	<i>Un na</i>	3814	152568		240294	5531	38142	8010	448359
	Totals	4556	167416		287067	6608	45566	9569	520802
NOVEMBER SETTLEMENT	<i>Un a</i>	293	5862		18466	425	2931	616	28593
	<i>Un na</i>	925	37001		58277	1342	9250	1943	108738
	Totals	1218	42863		76743	1767	12181	2559	137331
NOVEMBER to JANUARY	<i>Un a</i>	49	980		3086	71	490	103	4779
	<i>Un na</i>	99	3946		6216	143	986	208	11598
	Totals	148	4926		9302	214	1476	311	16377
ADDITIONS	School District No.								
	Totals								
REDUCTIONS	School District No.								
	Totals								



		DESCRIPTION OF PROPERTY					No. School District	Indicate Homestead Tax or No	Indicate Agricultural Tax or No	Indicate Type of Property	TRUE AND FULL VALUATIONS				ASSESSED VALUATIONS								Total Assessed Value as Equalized by the Board of Review	FINAL EQUALIZED VALUE
IN WHOSE NAME ASSESSED	TO WHOM TRANSFERRED	SUBDIVISION	Sec. or Lot	Town or Block	Rdg.	Number of Acres of Land					LAND Exclusive of Structures and Improvements	BUILDINGS and Other Structures	MACHINERY Permanently Attached to Real Estate	TOTAL True and Full Value	RURAL		ALL OTHER		MACHINERY Permanently Attached to Real Estate 33 1/8 %	TOTAL ASSESSED VALUE	Dollars			
															Homestead Up to \$4,000 20%	Over \$4,000 and Non-Homestead 33 1/8 %	Timber Land Class Je 20%	Homestead Up to \$4,000 25%				Over \$4,000 and Non-Homestead 40%		
Hannah Thomas		NE 1/4 of NE 1/4 Lot 1	1	140 31	28	28	98	387		485	97						97							
" "		NW 1/4 of NE 1/4 Lot 2	2			35	210			210	42						42							
Albert & Lydia Thomas		SW 1/4 of NE 1/4	3			40	160			160	32						32							
Charles M. & Jessie F. Cook		SE 1/4 of NE 1/4 Lot 7	4			31	180	216		396		132					132							
			5																					
Catherine Cram & Helen Dalton		NE 1/4 of NW 1/4 Lot 3	6			24 50	246			246		82					82							
		NW 1/4 of NW 1/4	7																					
		SW 1/4 of NW 1/4	8																					
Chas. W. & Henrietta U. Laufek		SE 1/4 of NW 1/4 Lot 4	9			24 50	215	430		645		215					215							
			10																					
Charles W. & Henrietta U. Laufek		NE 1/4 of SW 1/4	11			40	279			279		93					93							
" "		NW 1/4 of SW 1/4 Lot 5	12			33	396			396		132					132							
Harry W. Lundberg		SW 1/4 of SW 1/4 Private Rd. 7,900' of S. 933' lying w. of	13			9 50	115	450		565	113						113							
Ernest J. & Novella S. Mulligan		SE 1/4 of SW 1/4 7,150' of S. 873' of Lot 6	14			3	75	650		725	145						145							
Ernest J. & Novella S. Mulligan		NE 1/4 of SE 1/4 7,100' of S. 633' of Lot 6	15			2	51			51		17					17							
Mabel B. Farnberger		SW 1/4 of SE 1/4 7,100' of S. 533' of Lot 6	16			2	51			51		17					17							
Novella B. & Karen J. Jensen		NW 1/4 of SE 1/4 7,100' of S. 433' of Lot 6	17			2	51			51		17					17							
Joseph Daniel Moran		SE 1/4 of SE 1/4 7,100' of S. 333' of Lot 6	18			2	50	650		700	140						140							
Hilda Ylinen		SW 1/4 of SE 1/4 7,100' of S. 233' of Lot 6	19			2	51			51		17					17							
Roy & Elizabeth R. Quick		NE 1/4 of SE 1/4 7,100' of S. 133' of Lot 6	20			2	51			51		17					17							
Clara Johnson & August Sestrom																								
Clara Johnson & Charles Sestrom																								
(Continued Next Page)						22 50	2279	2783		5062	569	139					1308							

SOLD FOR TAXES	VALUATIONS BY SCHOOL DISTRICTS AS EQUALIZED BY DEPARTMENT OF TAXATION						Tax including State Homestead .....Mills	State Tax on Non-Homestead .....Mills	SPECIAL TAXES \$ cts.	TOTAL TAXES \$ cts.	PAID	WHEN PAID	Number of Receipt	March Settlement 1959 \$ cts.	June Settlement 1959 \$ cts.	Penalty \$ cts.	November Settlement 1959 \$ cts.	Penalty \$ cts.	Collections to First Monday in January 1960 \$ cts.	Penalty \$ cts.	Delinquent on First Monday in January 1960 \$ cts.	Total Delinquent Tax and Penalty \$ cts.	REMARKS	
	District No.	District No.	District No.	District No.	District No.	District No.																		
	Rate.....Mills	Rate.....Mills	Rate.....Mills	Rate.....Mills	Rate.....Mills	Rate.....Mills																		
	Dollars	Dollars	Dollars	Dollars	Dollars	Dollars																		
1		97					2276			2276	1	2nd HALF PAID NOV 2 1959												
2		42					986			986	2	1st Half Paid MAY 29 1959	14342		1138			1138	x				9506	
3		32					750			750	3	2nd HALF PAID NOV 2 1959	10716		493			493	x				"	
4	SOLD FOR TAXES				132		3360	86		3446	4	1st Half Paid MAY 29 1959	14342		375			375	x			3446	8413	
5											5													
6		82					1924	54		1978	6	PAID IN FULL APR 18 1959	5414		1978								9578	
7											7													
8											8													
9					215		5474	140		5614	9	PAID IN FULL FEB 25 1959											6122	
10											10		1865	11038										
11		93					2182	60		2242	11	PAID IN FULL FEB 25 1959											"	
12		132					3096	86		3182	12	PAID IN FULL FEB 25 1959											"	
13			# 113				2878			2878	13	PAID IN FULL SEP 14 1959	3294		2878								9504	
14			# 145				3692			3692	14	PAID IN FULL MAY 29 1959	3277		3692								8301	
15			17				432	12		444	15	PAID IN FULL SEP 24 1959	11673				444	x	13				9503	
16			17				432	12		444	16	PAID IN FULL MAY 29 1959	10655		444								9502	
17			17				432	12		444	17	PAID IN FULL MAY 29 1959	9678		444								8167	
18			# 140				3564			3564	18	PAID IN FULL MAY 27 1959	10855		3564								9501	
19			17				432	12		444	19													
20			17				432	12		444	20	PAID IN FULL MAY 2 1959	3512		444									
		# 171 307 478			# 398 = 569 432 = 739 830 = 1308		11214 21128 32342	486		32828				11038	15450		2450				3870			



# Cass County, Minnesota, for Taxes for the Year 1958.

\* Indicate Type of Property: R-Residential, C-Commercial, I-Industrial, U-Utility, F-Farm, L-Lakeshore, T-Timber, M-Mineral

	SOLD FOR TAXES	VALUATIONS BY SCHOOL DISTRICTS AS EQUALIZED BY DEPARTMENT OF TAXATION						Tax including State Homestead .....Mills	State Tax on Non-Homestead .....Mills	SPECIAL TAXES	TOTAL TAXES		PAID	WHEN PAID	Number of Receipt	March Settlement 1959	June Settlement 1959	Penalty	November Settlement 1959	Penalty	Collections to First Monday in January 1960	Penalty	Delinquent on First Monday in January 1960	Total Delinquent Tax and Penalty	REMARKS
		District No.	District No.	District No.	District No.	District No.	District No.																		
		Rate.....	Rate.....	Rate.....	Rate.....	Rate.....	Rate.....																		
		.....Mills	.....Mills	.....Mills	.....Mills	.....Mills	.....Mills																		
Dollars	Dollars	Dollars	Dollars	Dollars	Dollars	\$ cts.	\$ cts.	\$ cts.	\$ cts.		Month	Day	Year	\$ cts.	\$ cts.	\$ cts.	\$ cts.	\$ cts.	\$ cts.	\$ cts.	\$ cts.	\$ cts.	\$ cts.		
1												1													
2												2													
3												3													
4												4													
5												5													
6												6													
7												7													
8												8													
9												9													
10												10													
11												11													
12												12													
13												13	PAID IN FULL	APR 14 1959											
14												14	PAID IN FULL	APR 14 1959											
15	SOLD FOR TAXES											15													
16												16	PAID IN FULL	FEB 19 1959											
17												17	PAID IN FULL	MAY 29 1959											
18	SOLD FOR TAXES											18													
19	SOLD FOR TAXES											19	PAID IN FULL	APR 20 1959											
20												20													
						</																			











Assessment Roll and Tax List of Real Property in the Town of Hiram

\* Indicate Type of Property: R-Residential, C-Commercial, I-Industrial, U-Utility, F-Farm, L-Lakeshore, T-Timber, M-Mineral

Form 300 (1955) MINN. STATE GOVERNMENT, MINNEAPOLIS

Real Est.

IN WHOSE NAME ASSESSED	TO WHOM TRANSFERRED	DESCRIPTION OF PROPERTY					No. School District	Indicate Homes- tead Tax or No	Indicate Agricultural Tax or No	Indicate Type of Prop- erty	TRUE AND FULL VALUATIONS				ASSESSED VALUATIONS										FINAL EQUALIZED VALUE
		SUBDIVISION	Sec. or Lot	Town or Block	Rng.	Number of Acres of Land					LAND Exclusive of Structures and Improvements	BUILDINGS and Other Structures	MACHINERY Permanently Attached to Real Estate	TOTAL True and Full Value	RURAL		ALL OTHER			MACHINERY Permanently Attached to Real Estate 33 1/8 %	TOTAL ASSESSED VALUE	Total Assessed Value as Equalized by the Board of Review			
															Homestead Up to \$1,000 20%	Over \$1,000 and Non- Homestead 33 1/8 %	Timber Land Class de 20%	Homestead Up to \$1,000 25%	Over \$1,000 and Non- Homestead 40%						
																							Dollars	Dollars	
State of Minnesota		1				NE 1/4 of NE 1/4 Lot 1	4 140 31		211																
Mary C. & Joseph D. Peterson		2				NW 1/4 of NE 1/4 Lot 2	33 50	no	yr	T	174			174		58							58		
Fred T. Hagen & R. E. Wood		3				SW 1/4 of NE 1/4 at 5 less Plat	15 00	no	yr	T	36			36		12							12		
		4				SE 1/4 of NE 1/4																			
		5																							
Arlo & Luis Abraham		6				NE 1/4 of NW 1/4 Lot 3	33 50	no	no	C	336	564		900		300							300		
		7				NW 1/4 of NW 1/4																			
		8				SW 1/4 of NW 1/4																			
		9				SE 1/4 of NW 1/4																			
Fred T. Hagen & R. E. Wood		10				Lot 4 less Plat	96	no	yr	T	3			3		1							1		
		11				NE 1/4 of SW 1/4																			
		12				NW 1/4 of SW 1/4																			
		13				SW 1/4 of SW 1/4																			
		14				SE 1/4 of SW 1/4																			
		15																							
		16				NE 1/4 of SE 1/4																			
		17				NW 1/4 of SE 1/4																			
		18				SW 1/4 of SE 1/4																			
		19				SE 1/4 of SE 1/4																			
		20																							
							82 96				349	564		1113		371							371		

## Cass County, Minnesota, for Taxes for the Year 1958.

SOLD FOR TAXES	VALUATIONS BY SCHOOL DISTRICTS AS EQUALIZED BY DEPARTMENT OF TAXATION						Tax Including State Homestead	State Tax on Non- Homestead	SPECIAL TAXES	TOTAL TAXES	PAID	WHEN PAID	Number of Receipt	March Settlement 1959	June Settlement 1959	Penalty	November Settlement 1959	Penalty	Collections to First Monday in January 1960	Penalty	Delinquent on First Monday in January 1960	Total Delinquent Tax and Penalty	REMARKS
	District No.	District No.	District No.	District No.	District No.	District No.																	
	Rate	Rate	Rate	Rate	Rate	Rate																	
	Mills	Mills	Mills	Mills	Mills	Mills																	
	Dollars	Dollars	Dollars	Dollars	Dollars	Dollars	\$ cts.	\$ cts.	\$ cts.	\$ cts.		Month Day Year		\$ cts.	\$ cts.	\$ cts.	\$ cts.	\$ cts.	\$ cts.	\$ cts.	\$ cts.	\$ cts.	
1																							
2		58					13 60	38		13 98	2	PAID IN FULL	MAY 29 1959	9475		13 98							9509
3		12					2 82	08		2 90	3	PAID IN FULL	MAY 29 1959	14815		2 90							11003
4																							
5																							
6				300			76 38	196		78 34	6	PAID IN FULL	APR 22 1959	5553		78 34							9548
7																							
8																							
9																							
10		1					24			24	10	PAID IN FULL	MAY 29 1959	14815		24							11003
11																							
12																							
13																							
14																							
15																							
16																							
17																							
18																							
19																							
20																							
		71		300 = 371			16 66 76 38 93 04	242		9546													

Shady Shore Pine Beach Plainview Beach White Pine Beach



[illegible]



[illegible]



[illegible]















Assessment Roll and Tax List of Real Property in the Town of Hiram.

\* Indicate Type of Property: R-Residential, C-Commercial, I-Industrial, U-Utility, F-Farm, L-Lakeshore, T-Timber, M-Mineral

		DESCRIPTION OF PROPERTY						No. School District	Indicate Homestead Yes or No	Indicate Agricultural Yes or No	Indicate Type of Property	TRUE AND FULL VALUATIONS				ASSESSED VALUATIONS							FINAL EQUALIZED VALUE  Dollars
IN WHOSE NAME ASSESSED	TO WHOM TRANSFERRED	SUBDIVISION	Sec. or Lot	Town or Block	Rng.	Number of Acres of Land	LAND Exclusive of Structures and Improvements					BUILDINGS and Other Structures	MACHINERY Permanently Attached to Real Estate	TOTAL True and Full Value	RURAL		ALL OTHER			MACHINERY Permanently Attached to Real Estate 33 1/8 %	TOTAL ASSESSED VALUE	Total Assessed Value as Equalized by the Board of Review	
															Homestead Up to \$4,000 20%	Over \$4,000 and Non-Homestead 33 1/8 %	Timber Land Class A 20%	Homestead Up to \$4,000 25%	Over \$4,000 and Non-Homestead 40%				
						Acres	100ths																
		1		NE 1/4 of NE 1/4		10 140 31		UN															
		2		NW 1/4 of NE 1/4																			
		3		SW 1/4 of NE 1/4																			
		4		SE 1/4 of NE 1/4																			
		5																					
		6		NE 1/4 of NW 1/4																			
		7		NW 1/4 of NW 1/4																			
		8		SW 1/4 of NW 1/4																			
		9		SE 1/4 of NW 1/4																			
Helen A. Dalton & Catherine A. Cram		10		4 acs. of Lot 2		4		No	No	R	120	1665		1785		595							595
Ernest F. & Alma M. Matthias		11		W 110' x S 380' x E 99' x S 85' of NE 1/4 of SW 1/4 of Lot 3				No	No	L	99	633		732		244							244
Marjorie Foreseman		12		W 88' x S 385' x E 84' x 390' of Lot 3				No	No	S	87			87		29							29
Ernest F. & Alma M. Matthias		13		100 W x 350 S x 110 E x 380 N of SE 1/4 of SW 1/4 of Lot 3				No	No	S	99			99		33							33
Calmer S. & Amelia Forseth		14		E 100' x 400' of Lot 3		92		No	No	C	100	200		300		100							100
" " "		15		E 100' x 400' of Lot 3		1		No	No	C	100	215		315		105							105
" " "		16		200' x 400' on lake w. joining E 200' NE 1/4 of SE 1/4 out of Lot 3		2		No	No	S	200	481		681		227							227
W. Harold & Virginia S. Cox		17		W 100' of E 682' between Hwy & lake		4		No	No	R	98	478		576		192							192
" " "		18		W 69' of E 582' of Lot 2		350		No	No	R	120	462		582		194							194
Lillian Margaret & Jennie R. Wilson		19		6 1/2 acs. of Lot 2		650		No	No	S	185	493		678		226							226
Harry Alvin & Esther Augusta Johnson		20		E 100' of W 500' of Lot 2				No	No	R	99	963		1062		354							354
(Continued Next Page)						21 92					1208	4621		5835		1945							1945

Cass County, Minnesota, for Taxes for the Year 1958.

[illegible]



Cass County, Minnesota, for Taxes for the Year 1958.

\* Indicate Type of Property: R-Residential, C-Commercial, I-Industrial, U-Utility, F-Farm, L-Lakeshore, T-Timber, M-Miner

SOLD FOR TAXES	VALUATIONS BY SCHOOL DISTRICTS AS EQUALIZED BY DEPARTMENT OF TAXATION						Tax including State Homestead	State Tax on Non- Homestead	SPECIAL TAXES	TOTAL TAXES	PAID	WHEN PAID	Number of Receipt	March Settlement 1959	June Settlement 1959	Penalty	November Settlement 1959	Penalty	Collections to First Monday in January 1960	Penalty	Delinquent on First Monday in January 1960	Total Delinquent Tax and Penalty	REMARKS
	District No. ....	District No. ....	District No. ....	District No. ....	District No. ....	District No. ....																	
	Rate. ....	Rate. ....	Rate. ....	Rate. ....	Rate. ....	Rate. ....																	
	.....Mills	.....Mills	.....Mills	.....Mills	.....Mills	.....Mills																	
Dollars	Dollars	Dollars	Dollars	Dollars	Dollars	\$ cts.	\$ cts.	\$ cts.	\$ cts.		Month Day Year	\$ cts.	\$ cts.	\$ cts.	\$ cts.	\$ cts.	\$ cts.	\$ cts.	\$ cts.	\$ cts.	\$ cts.		
1												1											
2												2											
3												3											
4												4											
5	SOLD FOR TAXES					254	6468	166		6634		5	PAID IN FULL MAY 29 1958	13885	3317					3317	3649		
6												6											
7						33	840	22		862		7								862	948		
8												8											
9												9											
10						33	840	22		862		10	PAID IN FULL MAY 23 1959	10144	862								
11	SOLD FOR TAXES					70	2292	58		2350		11								2350			
12												12											
13												13											
14												14											
15												15											
16						616	15684	402		16086		16	PAID IN FULL APR 13 1959	5414	16086								
17						50	1274	32		1306		17	PAID IN FULL MAR 18 1959		1306								
18						440	11204	286		11490		18	PAID IN FULL MAR 18 1959	6696	11490								
19						451	11484	294		11778		19	2nd HALF PAID NOV 2 1959	15448	5889		5889						
20						421	10720	274		10994		20	1st HALF PAID MAY 29 1959	9479	5889								
						2382	60806	1556		62362			PAID IN FULL APR 13 1959	5165	49944		5889			1529			



IN WHOSE NAME ASSESSED	TO WHOM TRANSFERRED	DESCRIPTION OF PROPERTY				No. School District	Indicate Homestead Yes or No	Indicate Agricultural Yes or No	Indicate Type of Property	TRUE AND FULL VALUATIONS				ASSESSED VALUATIONS						SOLD FOR TAXES	VALUATIONS BY SCHOOL DISTRICTS AS EQUALIZED BY DEPARTMENT OF TAXATION						Tax including State Homestead	State Tax on Non-Homestead	SPECIAL TAXES	TOTAL TAXES	PAID	WHEN PAID	Number of Receipt	March Settlement 1959	June Settlement 1959	Penalty	November Settlement 1959	Penalty	Collections to First Monday in January 1960	Penalty	Delinquent on First Monday in January 1960	Total Delinquent Tax and Penalty	REMARKS																																																																																																																																																																																																																																																																																																		
		SUBDIVISION	Sec. or Lot	Town or Block	Rag.					Number of Acres of Land	LAND Exclusive of Structures and Improvements	BUILDINGS and Other Structures	MACHINERY Permanently Attached to Real Estate	TOTAL True and Full Value	RURAL		ALL OTHER				TOTAL ASSESSED VALUE	Total Assessed Value as Equalized by the Board of Review	FINAL EQUALIZED VALUE	District No.	District No.	District No.																		District No.	District No.	District No.	Rate..... Mills	Rate..... Mills	Rate..... Mills	Rate..... Mills	Rate..... Mills	Rate..... Mills	Rate..... Mills	Rate..... Mills	Rate..... Mills	Rate..... Mills	Rate..... Mills	Rate..... Mills	Rate..... Mills	Rate..... Mills	Rate..... Mills	Rate..... Mills	Rate..... Mills	Rate..... Mills	Rate..... Mills	Rate..... Mills	Rate..... Mills	Rate..... Mills	Rate..... Mills	Rate..... Mills	Rate..... Mills	Rate..... Mills	Rate..... Mills	Rate..... Mills	Rate..... Mills	Rate..... Mills	Rate..... Mills	Rate..... Mills	Rate..... Mills	Rate..... Mills	Rate..... Mills	Rate..... Mills	Rate..... Mills	Rate..... Mills	Rate..... Mills	Rate..... Mills	Rate..... Mills	Rate..... Mills	Rate..... Mills	Rate..... Mills	Rate..... Mills	Rate..... Mills	Rate..... Mills	Rate..... Mills	Rate..... Mills	Rate..... Mills	Rate..... Mills	Rate..... Mills	Rate..... Mills	Rate..... Mills	Rate..... Mills	Rate..... Mills	Rate..... Mills	Rate..... Mills	Rate..... Mills	Rate..... Mills	Rate..... Mills	Rate..... Mills	Rate..... Mills	Rate..... Mills	Rate..... Mills	Rate..... Mills	Rate..... Mills	Rate..... Mills	Rate..... Mills	Rate..... Mills	Rate..... Mills	Rate..... Mills	Rate..... Mills	Rate..... Mills	Rate..... Mills	Rate..... Mills	Rate..... Mills	Rate..... Mills	Rate..... Mills	Rate..... Mills	Rate..... Mills	Rate..... Mills	Rate..... Mills	Rate..... Mills	Rate..... Mills	Rate..... Mills	Rate..... Mills	Rate..... Mills	Rate..... Mills	Rate..... Mills	Rate..... Mills	Rate..... Mills	Rate..... Mills	Rate..... Mills	Rate..... Mills	Rate..... Mills	Rate..... Mills	Rate..... Mills	Rate..... Mills	Rate..... Mills	Rate..... Mills	Rate..... Mills	Rate..... Mills	Rate..... Mills	Rate..... Mills	Rate..... Mills	Rate..... Mills	Rate..... Mills	Rate..... Mills	Rate..... Mills	Rate..... Mills	Rate..... Mills	Rate..... Mills	Rate..... Mills	Rate..... Mills	Rate..... Mills	Rate..... Mills	Rate..... Mills	Rate..... Mills	Rate..... Mills	Rate..... Mills	Rate..... Mills	Rate..... Mills	Rate..... Mills	Rate..... Mills	Rate..... Mills	Rate..... Mills	Rate..... Mills	Rate..... Mills	Rate..... Mills	Rate..... Mills	Rate..... Mills	Rate..... Mills	Rate..... Mills	Rate..... Mills	Rate..... Mills	Rate..... Mills	Rate..... Mills	Rate..... Mills	Rate..... Mills	Rate..... Mills	Rate..... Mills	Rate..... Mills	Rate..... Mills	Rate..... Mills	Rate..... Mills	Rate..... Mills	Rate..... Mills	Rate..... Mills	Rate..... Mills	Rate..... Mills	Rate..... Mills	Rate..... Mills	Rate..... Mills	Rate..... Mills	Rate..... Mills	Rate..... Mills	Rate..... Mills	Rate..... Mills	Rate..... Mills	Rate..... Mills	Rate..... Mills	Rate..... Mills	Rate..... Mills	Rate..... Mills	Rate..... Mills	Rate..... Mills	Rate..... Mills	Rate..... Mills	Rate..... Mills	Rate..... Mills	Rate..... Mills	Rate..... Mills	Rate..... Mills	Rate..... Mills	Rate..... Mills	Rate..... Mills	Rate..... Mills	Rate..... Mills	Rate..... Mills	Rate..... Mills	Rate..... Mills	Rate..... Mills	Rate..... Mills	Rate..... Mills	Rate..... Mills	Rate..... Mills	Rate..... Mills	Rate..... Mills	Rate..... Mills	Rate..... Mills	Rate..... Mills	Rate..... Mills	Rate..... Mills	Rate..... Mills	Rate..... Mills	Rate..... Mills	Rate..... Mills	Rate..... Mills	Rate..... Mills	Rate..... Mills	Rate..... Mills	Rate..... Mills	Rate..... Mills	Rate..... Mills	Rate..... Mills	Rate..... Mills	Rate..... Mills	Rate..... Mills	Rate..... Mills	Rate..... Mills	Rate..... Mills	Rate..... Mills	Rate..... Mills	Rate..... Mills	Rate..... Mills	Rate..... Mills	Rate..... Mills	Rate..... Mills	Rate..... Mills	Rate..... Mills	Rate..... Mills	Rate..... Mills	Rate..... Mills	Rate..... Mills	Rate..... Mills	Rate..... Mills	Rate..... Mills	Rate..... Mills	Rate..... Mills	Rate..... Mills	Rate..... Mills	Rate..... Mills	Rate..... Mills	Rate..... Mills	Rate..... Mills	Rate..... Mills	Rate..... Mills	Rate..... Mills	Rate..... Mills	Rate..... Mills	Rate..... Mills	Rate..... Mills	Rate..... Mills	Rate..... Mills	Rate..... Mills	Rate..... Mills	Rate..... Mills	Rate..... Mills	Rate..... Mills	Rate..... Mills	Rate..... Mills	Rate..... Mills	Rate..... Mills	Rate..... Mills	Rate..... Mills	Rate..... Mills	Rate..... Mills	Rate..... Mills	Rate..... Mills	Rate..... Mills	Rate..... Mills	Rate..... Mills	Rate..... Mills	Rate..... Mills	Rate..... Mills	Rate..... Mills	Rate..... Mills	Rate..... Mills	Rate..... Mills	Rate..... Mills	Rate..... Mills	Rate..... Mills	Rate..... Mills	Rate..... Mills	Rate..... Mills	Rate..... Mills	Rate..... Mills	Rate..... Mills	Rate..... Mills	Rate..... Mills	Rate..... Mills	Rate..... Mills	Rate..... Mills	Rate..... Mills	Rate..... Mills</	



## Cass County, Minnesota, for Taxes for the Year 1958.

VALUATIONS BY SCHOOL DISTRICTS AS EQUALIZED BY DEPARTMENT OF TAXATION										SPECIAL TAXES	TOTAL TAXES	PAID	WHEN PAID	Number of Receipt	March Settlement 1959	June Settlement 1959	Penalty	November Settlement 1959	Penalty	Collections to First Monday in January 1960	Penalty	Delinquent on First Monday in January 1960	Total Delinquent Tax and Penalty	REMARKS
District No. ....	District No. ....	District No. ....	District No. ....	District No. ....	District No. ....	Tax including State Homestead	State Tax on Non- Homestead																	
Rate.....	Rate.....	Rate.....	Rate.....	Rate.....	Rate.....	.....Mills	.....Mills																	
.....Mills	.....Mills	.....Mills	.....Mills	.....Mills	.....Mills	.....Mills	.....Mills																	
Dollars	Dollars	Dollars	Dollars	Dollars	Dollars	\$ cts.	\$ cts.	\$ cts.	\$ cts.		Month Day Year	\$ cts.	\$ cts.	\$ cts.	\$ cts.	\$ cts.	\$ cts.	\$ cts.	\$ cts.	\$ cts.	\$ cts.	\$ cts.		
	4	79				1854				1854	1	PAID IN FULL	MAY 20 1959	9994		1854								
		20				470	14			484	2	PAID IN FULL	MAY 8 1959	8598		484								
SOLD FOR TAXES	4	14				328				328	3										328	361		
		67				1572	44			1616	4										1616	1770		
	4	146				3426				3426	5	PAID IN FULL	MAY 29 1959	6684		3426								
SOLD FOR TAXES		100				2340	66			2412	6	PAID IN FULL	JUN 3 1959	14046				2412	36					
	4	91				2136				2136	7	2nd Half Paid OCT 7 1959	1296				1068							
	4	47				1102				1102	8	1st Half Paid MAY 6 1959	8480				1068							
SOLD FOR TAXES	4	32				750				750	9	PAID IN FULL	MAY 5 1959	3584								750	825	
					327	8326	214			8540	10	PAID IN FULL	APR 13 1959	5171		8540								
	4	14				328				328	11	PAID IN FULL	MAY 5 1959	3584		328								
	4	23				540				540	12	PAID IN FULL	MAY 5 1959			540								
	4	96				2252				2252	13	PAID IN FULL	APR 16 1959	5315		2252						5658		
SOLD FOR TAXES		102				2394	68			2462	14	PAID IN FULL	JAN 28 1959	624	2462									
	4	100				2346				2346	15	PAID IN FULL	JUN 26 1959	18662				2346	35					
SOLD FOR TAXES	4	32				750				750	16	PAID IN FULL	MAY 8 1959	9667		1220								
SOLD FOR TAXES	4	20				470				470	17	PAID IN FULL	MAY 8 1959											
		56				1314	36			1350	18	PAID IN FULL	APR 9 1959			1350						839		
		30				704	20			724	19	PAID IN FULL	APR 9 1959	7154		724								
	4	694				1656	42			1698	20	PAID IN FULL	MAY 29 1959	9491		1698								
		375				25082				25568						2462	24586		5826			2694		
		1069				392				392														
						392				392														
						392				392														
						392				392														
						392				392														
						392				392														
						392				392														
						392				392														
						392				392														
						392				392														
						392				392														
						392				392														
						392				392														
						392				392														
						392				392														
						392				392														
						392				392														
						392				392														
						392				392														
						392				392														
						392				392														
						392				392														
						392				392														
						392				392														
						392				392														
						392				392														
						392				392														
						392				392														
						392				392														
						392				392														
						392				392														
						392				392														







[illegible]



## Cass County, Minnesota, for Taxes for the Year 1958.

\* Indicate Type of Property: R-Residential, C-Commercial, I-Industrial, U-Utility, F-Farm, L-Lakeshore, T-Timber, M-Mineral

[illegible]



Cass County, Minnesota, for Taxes for the Year 1958.



Cass County, Minnesota, for Taxes for the Year 1958.

\* Indicate Type of Property: R-Residential, C-Commercial, I-Industrial, U-Utility, F-Farm, L-Lakeshore, T-Timber, M-Mineral

[illegible]



Assessment Roll and Tax List of Real Property in the Town of Huron, Minnesota

Indicate Type of Property: R-Residential, C-Commercial, I-Industrial, U-Utility, F-Farm, L-Lakeshore, T-Timber, M-Mineral

IN WHOSE NAME ASSESSED		TO WHOM TRANSFERRED		DESCRIPTION OF PROPERTY					No. School District	Indicate Homestead Yes or No	Indicate Agricultural Yes or No	Indicate Type of Property	TRUE AND FULL VALUATIONS				ASSESSED VALUATIONS								FINAL EQUALIZED VALUE	
				SUBDIVISION	Sec. or Lot	Town or Block	Rng.	Number of Acres of Land					LAND Exclusive of Structures and Improvements	BUILDINGS and Other Structures	MACHINERY Permanently Attached to Real Estate	TOTAL True and Full Value	RURAL		ALL OTHER					TOTAL ASSESSED VALUE		Total Assessed Value as Equalized by the Board of Review
																	Homestead Up to \$4,000 20%	Over \$4,000 and Non-Homestead 33 1/3%	Timber Land Class 3e 20%	Homestead Up to \$4,000 25%	Over \$4,000 and Non-Homestead 40%	MACHINERY Permanently Attached to Real Estate 33 1/3%				
																							Dollars			
Acres	100ths	Dollars	Dollars	Dollars	Dollars	Dollars	Dollars	Dollars	Dollars	Dollars	Dollars	Dollars	Dollars	Dollars	Dollars	Dollars	Dollars	Dollars	Dollars	Dollars						
Ernest E. & Lucy L. Patrick	Charles F. & Alice K. Altstadt	1	W. 50' of E. 150' of Lat 2 NE 1/4 of NE 1/4	16	140	31	1	20	no	no	R	50	475		525		175			175						
		2	W. 575.14' of Lat 2 NW 1/4 of NE 1/4				12		no	no	C	500	1591		2091		697			697						
		3	SW 1/4 of NE 1/4																							
Levi C. & Lucille Frederick	Wilbur Olson	4	Lat 1 less W. 200' less 1 3/4 ac. SE 1/4 of NE 1/4 & less sold				31	75	no	no	R	155	885		1040	208				208						
		5	E. 100' of Lat 2				2	10	no	no	R	99	1008		1107		369			369						
John W. & Mildred D. Kessell	Wilbur E. Olson	6	E. 75' of W. 750.14' of Lat 2 NE 1/4 of NW 1/4				1		no	no	LS	75	99		174		58			58						
		7	W. 200' of Lat 1 NW 1/4 of NW 1/4						no	no	LS	150			150		50			50						
Jake R. & Alice E. Eliash	H. W. & Edith M. Jensen	8	1 3/4 ac. of Lat 1 & 1.35 ac. SW 1/4 of NW 1/4				1	75	no	no	LS	99			99		33			33						
		9	300' x 150' of Lat 3 less sold SE 1/4 of NW 1/4				2	-	no	no	LS	300	192		492		164			164						
Nelson & C. L. Simonson		10	200' x 150' of Lat 3				1	-																		
State of Minnesota	William J. Rewick, Augusta L. Rewick, Lillian L. Rewick & Edith Joy Rewick	11	NE 1/4 of SW 1/4						no	no	C	320	844		1164				388	1.8 change						
		12	NW 1/4 of SW 1/4 Lat 4 less No. 100'				27	50	no	no	C	320	844		1164		233		388	1.8 change						
State of Minnesota		13	SW 1/4 of SW 1/4																							
State of Minnesota		14	SE 1/4 of SW 1/4																							
Walter H. Witte		15	E. 100' of W. 675.14' of Lat 2						no	no	LS	100	180		280		56			56						
State of Minnesota		16	NE 1/4 of SE 1/4																							
State of Minnesota		17	NW 1/4 of SE 1/4																							
State of Minnesota		18	SW 1/4 of SE 1/4																							
State of Minnesota		19	SE 1/4 of SE 1/4																							
Stanley M. & Edith M. Jensen	William D. & Edith L. Jensen	20	E. 100' of 300' x 400' of Lat 3 No. 100' of Lat 4					78	10			1948	5196		7124	497	1512		2010							
												5294			7122	264	1934		2198							

Cass County, Minnesota, for Taxes for the Year 1958.

SOLD FOR TAXES	VALUATIONS BY SCHOOL DISTRICTS AS EQUALIZED BY DEPARTMENT OF TAXATION						Tax including State Homestead	State Tax on Non-Homestead	SPECIAL TAXES	TOTAL TAXES	PAID	WHEN PAID	Number of Receipt	March Settlement 1959	June Settlement 1959	Penalty	November Settlement 1959	Penalty	Collections to First Monday in January 1960	Penalty	Delinquent on First Monday in January 1960	Total Delinquent Tax and Penalty	REMARKS
	District No.	District No.	District No.	District No.	District No.	District No.																	
	Rate	Rate	Rate	Rate	Rate	Rate																	
	Mills	Mills	Mills	Mills	Mills	Mills																	
1							4456	114		4570	1st HALF PAID MAY 29 1959	9484			22 85						22 85	2519	9535
2							17748	454		18202	2nd HALF PAID SEP 10 1959	1555			91 01		91 01						9527
3																							
4							5296			5296	2nd HALF PAID NOV 2 1959	15938			26 48		26 48						9514
5							9396	240		9636	1st HALF PAID APR 20 1959	1356			48 18		48 18						9526
6							1476	38		1514	2nd HALF PAID OCT 27 1959	13136			6 53		6 53						9526
7							1274	32		1206	1st HALF PAID APR 17 1959	5387			43 1		43 1						9522
8							840	22		862	2nd HALF PAID SEP 9 1959	11536			42 8		42 8						9591
9							4176	106		4282	1st HALF PAID MAY 27 1959	8336											
10																							
11																							
12							9880	252		10132	2nd HALF PAID SEP 29 1959	11708			50 76		50 56						9523
13																							
14																							
15							1426			1426	1st HALF PAID APR 15 1959	5283			14 26								9522
16																							
17																							
18																							
19																							
20							55968	1258		57226					30720		2422				22 85		



Assessment Roll and Tax List of Real Property in the Town of Hiram,

\* Indicate Type of Property: R-Residential, C-Commercial, I-Industrial, U-Utility, F-Farm, L-Lakeshore, T-Timber, M-Mineral

\* Indicate Type of Property: R-Residential, C-Commercial, I-Industrial, U-Utility, F-Farm, L-Lakeshore, T-Timber, M-Mineral

IN WHOSE NAME ASSESSED	TO WHOM TRANSFERRED	DESCRIPTION OF PROPERTY				No. School District	Indicate Homestead Yes or No	Indicate Agricultural Yes or No	Indicate Type of Property	TRUE AND FULL VALUATIONS				ASSESSED VALUATIONS								FINAL EQUALIZED VALUE					
		SUBDIVISION	Sec. or Lot	Town or Block	Rng.					Number of Acres of Land	LAND Exclusive of Structures and Improvements	BUILDINGS and Other Structures	MACHINERY Permanently Attached to Real Estate	TOTAL True and Full Value	RURAL		ALL OTHER				MACHINERY Permanently Attached to Real Estate		TOTAL ASSESSED VALUE	Total Assessed Value as Equalized by the Board of Review			
															Dollars	Dollars	Dollars	Dollars	Homestead Up to \$4,000 20%	Over \$4,000 and Non-Homestead 33 1/3%					Timber Land Class 3e 20%	Homestead Up to \$1,000 25%	Over \$1,000 and Non-Homestead 40%
Joseph L. & Mary J. Major F.C. & Elizabeth J. Bair		W. 100' of E. 300' of Lot 3 NE 1/4 of NE 1/4 77. of Rd.	16	140	31	21	no	no	LS	99			99		33						33						
		W. 100' of E. 400' of Lot 3 NW 1/4 of NE 1/4 77. of Rd.					no	no	LS	99			99		33						33						
		SW 1/4 of NE 1/4																									
		SE 1/4 of NE 1/4																									
M.M. & Helen M. Williams Verdie & Helen Paulson		W. 385.2' of E. 570.2' of Lot 2 W. 100' of E. 500' of Part of Lot 3 lying 77. of NE 1/4 of NW 1/4 Private Rd way					no	no	LS	400	1316		1716		572						572						
		NW 1/4 of NW 1/4					no	no	LS	99			99		33						33						
		SW 1/4 of NW 1/4																									
		SE 1/4 of NW 1/4																									
Henry & Janet Heinsch		N. 300' of E. 200' of Lot 3					no	no	LS	195			195		65						65						
		NE 1/4 of SW 1/4																									
		NW 1/4 of SW 1/4																									
		SW 1/4 of SW 1/4																									
		SE 1/4 of SW 1/4																									
Sherman W. & Alice Fulton Donald & May Fleisher Ruby Ellen Melby		Part of Lot 1 Part of Lot 1 NE 1/4 of SE 1/4 Part of Lot 1 NW 1/4 of SE 1/4					no	no	LS	51	201		252		84						84						
							yes	no	LS	108	307		415								83	1.8 change					
							no	no	LS	200	289		489	83	138						138						
		SW 1/4 of SE 1/4													163						163						
		SE 1/4 of SE 1/4																									
Archie E. & Marjorie K Johnson		Part of Cont Lot 1 has sold					no	no	LS	240			240		80						80						
										1491	2112		3603		1201						1201						
											2113		3604	83	1063						1146						

## Cass County, Minnesota, for Taxes for the Year 1958.

[illegible]



Cass County, Minnesota, for Taxes for the Year 1958.

\* Indicate Type of Property: R-Residential, C-Commercial, I-Industrial, U-Utility, F-Farm, L-Lakeshore, T-Timber, M-Mineral

SOLD FOR TAXES	VALUATIONS BY SCHOOL DISTRICTS AS EQUALIZED BY DEPARTMENT OF TAXATION						Tax including State Homestead .....Mills	State Tax on Non- Homestead 6.2.....Mills	SPECIAL TAXES	TOTAL TAXES	PAID	WHEN PAID	Number of Receipt	March Settlement 1959	June Settlement 1959	Penalty	November Settlement 1959	Penalty	Collections to First Monday in January 1960	Penalty	Delinquent on First Monday in January 1960	Total Delinquent Tax and Penalty	REMARKS
	District No. ....	District No. ....	District No. ....	District No. ....	District No. ....	District No. ....																	
	Rate.....	Rate.....	Rate.....	Rate.....	Rate.....	Rate.....																	
	.....Mills	.....Mills	.....Mills	.....Mills	.....Mills	.....Mills																	
Dollars	Dollars	Dollars	Dollars	Dollars	Dollars	\$ cts.	\$ cts.	\$ cts.	\$ cts.	Month Day Year	\$ cts.	\$ cts.	\$ cts.	\$ cts.	\$ cts.	\$ cts.	\$ cts.	\$ cts.	\$ cts.	\$ cts.	\$ cts.		
1		123				2886	80		2966	1	PAID IN FULL	MAY 13 1959	8997		2966								
2										2													
3										3													
4										4													
5		10				234	06		240	5	PAID IN FULL	APR 13 1959	5769		240								
6										6													
7										7													
8										8													
9										9													
10				120		3056	78		3134	10	PAID IN FULL	MAY 2 1959	5940		3134								
11										11													
12										12													
13		41				962			962	13	2ND HALF PAID NOV 2 1959	15986		481		481 X							
14										14	1ST HALF PAID MAY 29 1959	9470											
15										15													
16										16													
17										17													
18										18													
19										19													
20										20													
		41				4082																	
		133				3056	164		7302						6821		481						
		174				7138																	



Cass County, Minnesota, for Taxes for the Year 1958.

\* Indicate Type of Property: R-Residential, C-Commercial, I-Industrial, U-Utility, F-Farm, L-Lakeshore, T-Timber, M-Mineral

[illegible]



1758'

Plot 1 Dec. 18. 140-31

Carlson	W. 104'	104'
um. Katz	E. 100' of W. 204'	100'
Zahn	E. 100' of W. 304'	100'
Cocks	E. 100' of W. 404'	100'
Schaffer	E. 100' of W. 504'	100'
Reiback	E. 100' of W. 604'	100'
Svenson	E. 200' of W. 804'	200'
Kastka	E. 100' of W. 804'	100'
Young	E. 100' of W. 1004'	100'
Jr. F. Katz	E. 100' of W. 1104'	100'
Stokes	E. 100' of W. 1204'	100'
Judith & Benson	E. 50'	50'
	1584'	1254'



Assessment Roll and Tax List of Real Property in the Town of Niam  
\* Indicate Type of Property: R-Residential, C-Commercial, I-Industrial, U-Utility, F-Farm, L-Lakeshore, T-Timber, M-Mineral

Cass County, Minnesota, for Taxes for the Year 1958.

IN WHOSE NAME ASSESSED		TO WHOM TRANSFERRED		DESCRIPTION OF PROPERTY					No. School District	Indicate Homestead Yes or No	Indicate Agricultural Yes or No	Indicate Type of Property	TRUE AND FULL VALUATIONS				ASSESSED VALUATIONS								FINAL EQUALIZED VALUE	
				SUBDIVISION	Sec. or Lot	Town or Block	Rng.	Number of Acres of Land					LAND Exclusive of Structures and Improvements	BUILDINGS and Other Structures	MACHINERY Permanently Attached to Real Estate	TOTAL True and Full Value	RURAL			ALL OTHER			MACHINERY Permanently Attached to Real Estate 33 1/3 %	TOTAL ASSESSED VALUE		Total Assessed Value as Equalized by the Board of Review
																	Homestead Up to \$4,000 20%	Over \$4,000 and Non-Homestead 33 1/3 %	Timber Land Class 3e 20%	Homestead Up to \$4,000 25%	Over \$4,000 and Non-Homestead 40%					
																						Dollars				
Angelo S. Tarizzo & Robert Bisson		1				E. 50' of Lat 14 W. 100' of Lat 2 N.E. 1/4 of N.E. 1/4	18	140	31	5.41	UN	No	No	LS	25	86		111		37				37		
Gertude D. & Douglas L. Woodbeck		2				E. 75' of W. 250' of Lat 2 N.W. 1/4 of N.E. 1/4				2.50		No	No	R	75	159		234		78				78		
Gertude Woodbeck		3				E. 75' of W. 175' of Lat 2 S.W. 1/4 of N.E. 1/4				2.50		No	No	LS	36			36		12				12		
Emil H. & Margaret Grausnick		4				E. 150' of W. 400' of Lat 2 S.E. 1/4 of N.E. 1/4				4.88		No	No	R	75	153		228		76				76		
Ralph E. & Florence M. Bannister		5				E. 150' of W. 550' of Lat 2 N.E. 1/4 of N.W. 1/4				5.10		No	No	R	75	126		201		67				67		
Theodore R. & Mary V. Louland		6				E. 150' of W. 700' of Lat 2 N.E. 1/4 of N.W. 1/4				5.27		No	No	R	75	291		366		122				122		
" " "		7				E. 300' of W. 1000' of Lat 2 N.W. 1/4 of N.W. 1/4				12.75		No	No	LS	150	33		183		61				61		
Anthony L. & Lucille L. Boyer		8				E. 150' of W. 1150' of Lat 2 S.W. 1/4 of N.W. 1/4				6.39		No	No	LS	75			75		25				25		
" " "		9				E. 150' of W. 1300' of Lat 2 S.E. 1/4 of N.W. 1/4				6.36		No	No	LS	75			75		25				25		
Gordon A. Mikkelsen		10				E. 20' of Lat 2 + W. 130' of Lat 3 N.E. 1/4 of S.W. 1/4				6.01		No	No	LS	75			75		25				25		
Gordon A. & Harris R. Mikkelsen		11				E. 150' of W. 280' of Lat 3 N.E. 1/4 of S.W. 1/4				5.66		No	No	R	75	237		312		104				104		
Marlys V. Peterson		12				E. 150' of W. 430' of Lat 3 N.W. 1/4 of S.W. 1/4				5.50		No	No	R	75	192		267		89				89		
Edward E. Nielson		13				E. 150' of W. 580' of Lat 3 S.W. 1/4 of S.W. 1/4				5.40		No	No	R	75	237		312		104				104		
Ralph E. & Florence M. Bannister		14				E. 150' of W. 730' of Lat 3 S.E. 1/4 of S.W. 1/4				5.66		No	No	LS	75			75		25				25		
Arnold L. & Dorothy L. Melin		15				E. 150' of W. 880' of Lat 3 N.E. 1/4 of S.E. 1/4				5.46		No	No	R	75	192		267		89				89		
William B. Lenk		16				E. 150' of W. 1030' of Lat 3 N.E. 1/4 of S.E. 1/4				6.19		No	No	LS	75			75		25				25		
Ralph E. Bannister		17				E. 150' of W. 1180' of Lat 3 N.W. 1/4 of S.E. 1/4				6.19		No	No	R	75	87		162		54				54		
Leo E. Brown		18				E. 140' of Lat 3 (Lat 3 except S.W. 1/4 of S.E. 1/4 W. 1180')				5.73		No	No	R	70	116		186		62				62		
		19				S.E. 1/4 of S.E. 1/4																				
		20																								
										103.46					1331	1909		3240		1080				1080		

SOLD FOR TAXES	VALUATIONS BY SCHOOL DISTRICTS AS EQUALIZED BY DEPARTMENT OF TAXATION						Tax Including State Homestead	State Tax on Non-Homestead	SPECIAL TAXES	TOTAL TAXES	PAID	WHEN PAID	Number of Receipt	March Settlement 1959	June Settlement 1959	Penalty	November Settlement 1959	Penalty	Collections to First Monday in January 1960	Penalty	Delinquent on First Monday in January 1960	Total Delinquent Tax and Penalty	REMARKS
	District No.	District No.	District No.	District No.	District No.	District No.																	
	Rate	Rate	Rate	Rate	Rate	Rate																	
	Mills	Mills	Mills	Mills	Mills	Mills																	
1						37	9.42	2.4		966	1	PAID IN FULL APR 24 1959	5614		9.66								
2						78	19.86	5.0		2036	2	PAID IN FULL MAY 4 1959	8477		20.36								
3						12	3.06	0.8		314	3	PAID IN FULL MAY 6 1959			3.14								
4						76	19.36	5.0		1986	4	PAID IN FULL MAY 22 1959	9163		19.86								
5						67	17.06	4.4		1750	5	PAID IN FULL MAY 12 1959	8715		17.50								
6						122	31.06	8.0		3186	6	2nd HALF PAID OCT 27 1959											
7						61	15.54	4.0		1594	7	1st HALF PAID MAY 29 1959	13172		15.93		15.93						
8						25	6.36	1.6		652	8	2nd HALF PAID OCT 27 1959	9514		7.97		7.97						
9						25	6.36	1.6		652	9	1st HALF PAID MAY 29 1959			6.52								
10						25	6.36	1.6		652	10				6.52								
11						104	26.48	7.0		2718	11												
12						89	22.66	5.8		2324	12	1st HALF PAID MAY 29 1959	9467		11.62								
13						104	26.48	7.0		2718	13												
14						25	6.36	1.6		652	14	PAID IN FULL MAY 12 1959	8716		6.52								
15						89	22.66	5.8		2324	15	2nd HALF PAID NOV 2 1959	15444										
16						25	6.36	1.6		652	16	1st HALF PAID MAY 1 1959	5888		11.62		11.62						
17						54	13.74	3.6		1416	17	PAID IN FULL MAR 18 1959	6695		14.16								
18						62	15.78	4.0		1618	18	PAID IN FULL MAY 20 1959	9059		16.18								
19											19												
20											20												
						27496	7.08			28204					167.50		35.52				79.02		



Heinrich  
1958

1584'

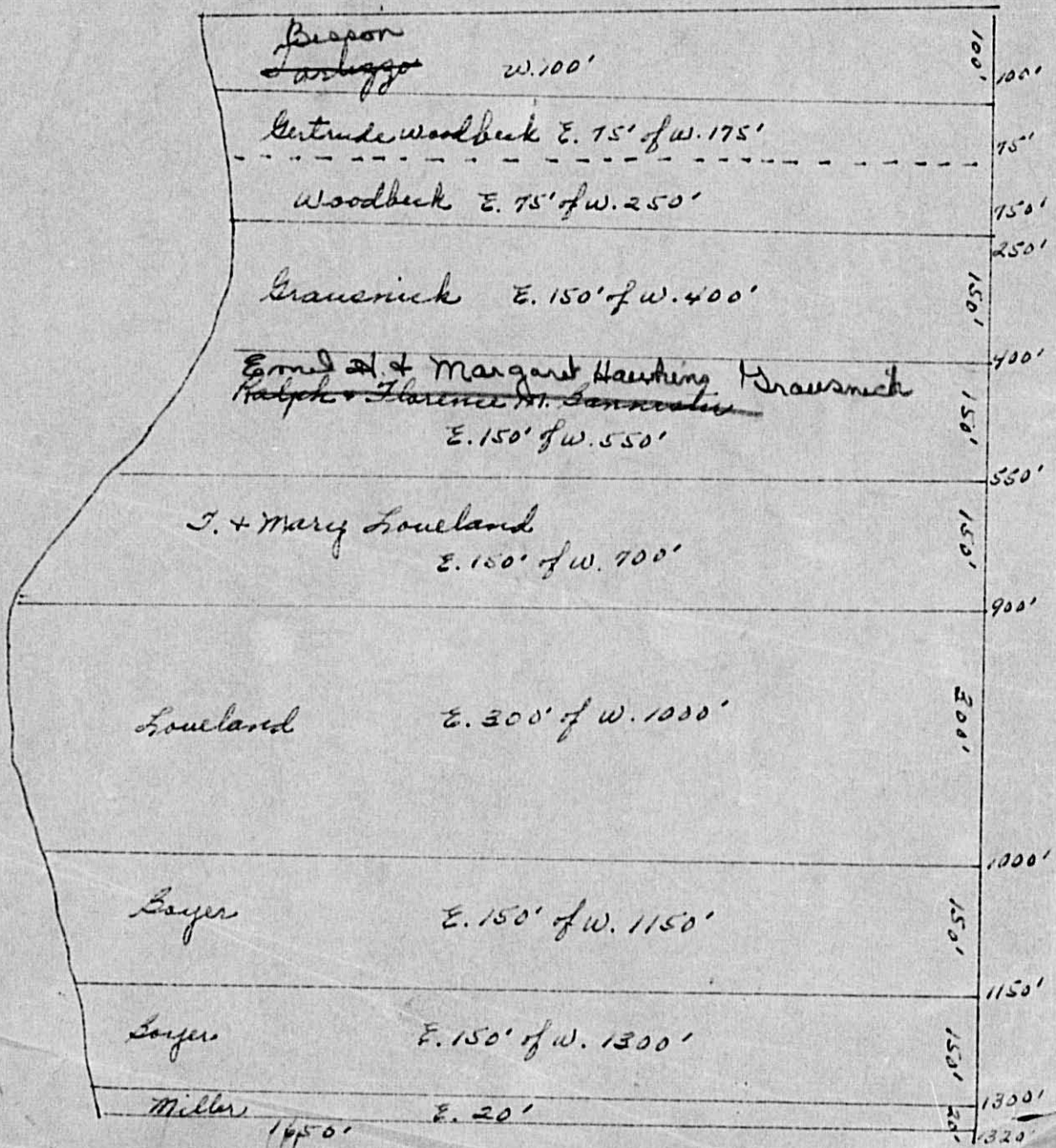

LOT 2 - 18-140-31



Henderson  
1958



Lot 3 18-140-31

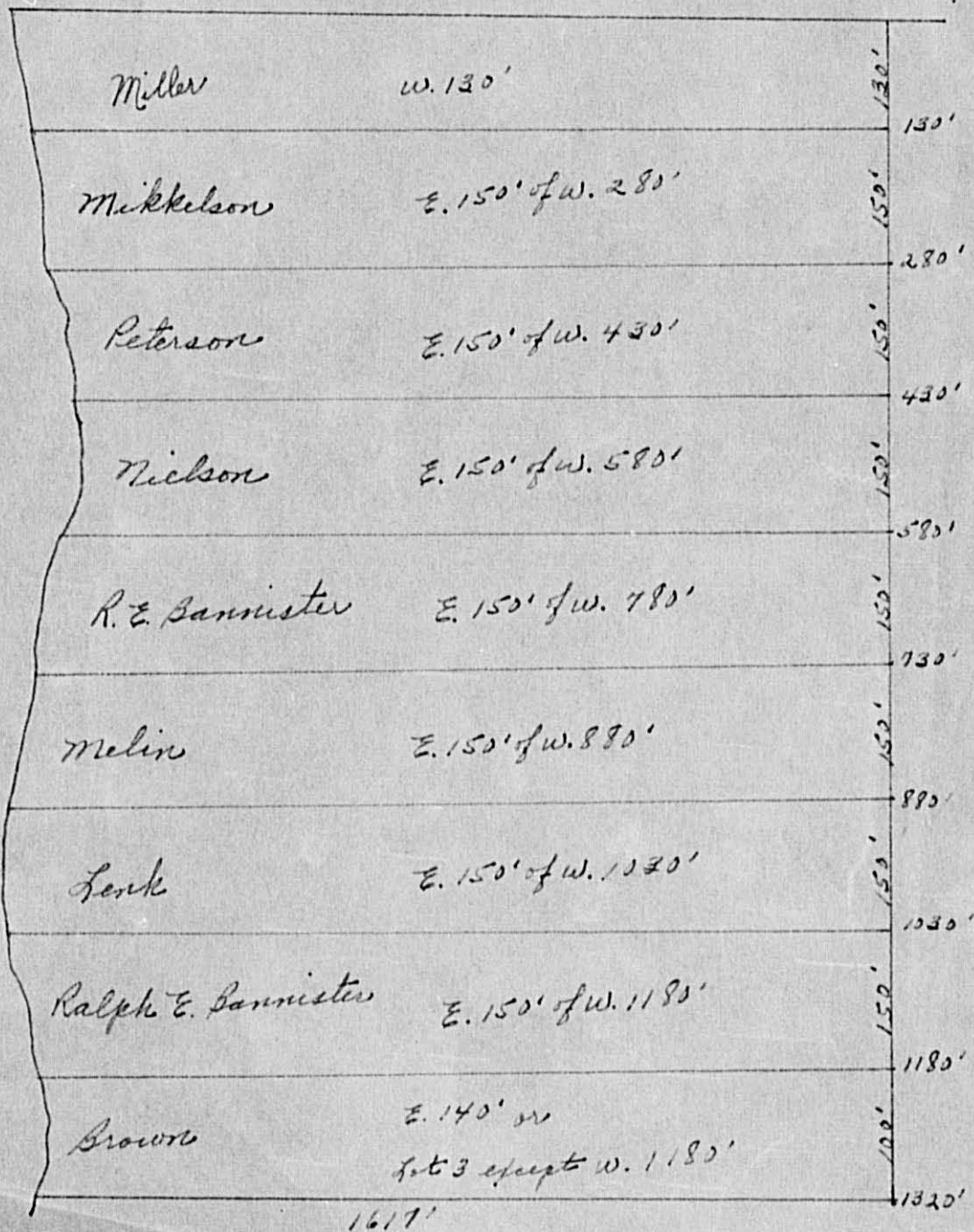



## Cass County, Minnesota, for Taxes for the Year 1958.

\* Indicate Type of Property: R-Residential, C-Commercial, I-Industrial, U-Utility, F-Farm, L-Lakeshore, T-Timber, M-Mineral

[illegible]



## Cass County, Minnesota, for Taxes for the Year 1958.

\* Indicate Type of Property: R-Residential, C-Commercial, I-Industrial, U-Utility, F-Farm, L-Lakeshore, T-Timber, M-Mineral

[illegible]



Cass County, Minnesota, for Taxes for the Year 1958.

\* Indicate Type of Property: R-Residential, C-Commercial, I-Industrial, U-Utility, F-Farm, L-Lakeshore, T-Timber, M-Minera

[illegible]



Assessment Roll and Tax List of Real Property in the Town of Hiram

\* Indicate Type of Property: R-Residential, C-Commercial, I-Industrial, U-Utility, F-Farm, L-Lakeshore, T-Timber, M-Mineral

## Cass County, Minnesota, for Taxes for the Year 1958.

[illegible]



Cass County, Minnesota, for Taxes for the Year 1958.

\* Indicate Type of Property: R-Residential, C-Commercial, I-Industrial, U-Utility, F-Farm, L-Lakeshore, T-Timber, M-Mineral

[illegible]



## Cass County, Minnesota, for Taxes for the Year 1958.

\* Indicate Type of Property: R-Residential, C-Commercial, I-Industrial, U-Utility, F-Farm, L-Lakeshore, T-Timber, M-Mineral

[illegible]



\* Indicate Type of Property: R-Residential, C-Commercial, I-Industrial, U-Utility, F-Farm, L-Lakeshore, T-Timber, M-Mineral

Form SCD WILLIAM-BAYNE COMPANY, MINNEAPOLIS

[illegible]

## 32

[illegible]



[illegible]



# Assessment Roll and Tax List of Real Property in the

Town of Hiram

\* Indicate Type of Property: R-Residential, C-Commercial, I-Industrial, U-Utility, F-Farm, L-Lakeshore, T-Timber, M-Mineral

[illegible]

## Cass County, Minnesota, for Taxes for the Year 1958.

[illegible]







Assessment Roll and Tax List of Real Property in the Town of Hiram

\* Indicate Type of Property: R-Residential, C-Commercial, I-Industrial, U-Utility, F-Farm, L-Lakeshore, T-Timber, M-Mineral

Cass County, Minnesota, for Taxes for the Year 1958.

[illegible]



Assessment Roll and Tax List of Real Property in the Town of Hiram

\* Indicate Type of Property: R-Residential, C-Commercial, I-Industrial, U-Utility, F-Farm, L-Lakeshore, T-Timber, M-Mineral

[illegible]

Cass County, Minnesota, for Taxes for the Year 1958.

[illegible]







## Cass County, Minnesota, for Taxes for the Year 1958.

\* Indicate Type of Property: R-Residential, C-Commercial, I-Industrial, U-Utility, F-Farm, L-Lakeshore, T-Timber, M-Mineral

SOLD FOR TAXES	VALUATIONS BY SCHOOL DISTRICTS AS EQUALIZED BY DEPARTMENT OF TAXATION						Tax including State Homestead .....Mills	State Tax on Non- Homestead 6.52.....Mills	SPECIAL TAXES	TOTAL TAXES	PAID	WHEN PAID	Number of Receipt	March Settlement 1959	June Settlement 1959	Penalty	November Settlement 1959	Penalty	Collections to First Monday in January 1960	Penalty	Delinquent on First Monday in January 1960	Total Delinquent Tax and Penalty	REMARKS
	District No. ....	District No. ....	District No. ....	District No. ....	District No. ....	District No. ....																	
	Rate.....	Rate.....	Rate.....	Rate.....	Rate.....	Rate.....																	
	.....Mills	.....Mills	.....Mills	.....Mills	.....Mills	.....Mills																	
Dollars	Dollars	Dollars	Dollars	Dollars	Dollars	\$ cts.	\$ cts.	\$ cts.	\$ cts.	Month Day Year	\$ cts.	\$ cts.	\$ cts.	\$ cts.	\$ cts.	\$ cts.	\$ cts.	\$ cts.	\$ cts.	\$ cts.	\$ cts.		
1											1												
2											2												
3				230			5856	150		6006	3	PAID IN FULL MAY 19 1959	7898		6006								
4				87			2216	56		2272	4	PAID IN FULL MAY 19 1959			2272								
5											5												
6											6												
7											7												
8											8												
9											9												
10											10												
11											11												
12											12												
13											13												
14											14												
15											15												
16											16												
17		50					1174	32		1206	17	PAID IN FULL MAY 19 1959	7898		1206								
18											18												
19											19												
20		50					1174 8072 9246	238		9484	20					9484							



Cass County, Minnesota, for Taxes for the Year 1958.

\* Indicate Type of Property: R-Residential, C-Commercial, I-Industrial, U-Utility, F-Farm, L-Lakeshore, T-Timber, M-Mineral

SOLD FOR TAXES	VALUATIONS BY SCHOOL DISTRICTS AS EQUALIZED BY DEPARTMENT OF TAXATION						Tax including State Homestead .....Mills	State Tax on Non- Homestead .....Mills	SPECIAL TAXES	TOTAL TAXES	PAID	WHEN PAID	Number of Receipt	March Settlement 1959	June Settlement 1959	Penalty	November Settlement 1959	Penalty	Collections to First Monday in January 1960	Penalty	Delinquent on First Monday in January 1960	Total Delinquent Tax and Penalty	REMARKS	
	District	District	District	District	District	District																		
	No.....	No.....	No.....	No.....	No.....	No.....																		
	Rate.....	Rate.....	Rate.....	Rate.....	Rate.....	Rate.....																		
	.....Mills	.....Mills	.....Mills	.....Mills	.....Mills	.....Mills																		
	Dollars	Dollars	Dollars	Dollars	Dollars	Dollars	\$ cts.	\$ cts.	\$ cts.	\$ cts.		Month Day Year	\$ cts.	\$ cts.	\$ cts.	\$ cts.	\$ cts.	\$ cts.	\$ cts.	\$ cts.	\$ cts.	\$ cts.		
1											1													
2											2													
3											3													
4											4													
5											5													
6		4 18					4 22			4 22	6	PAID IN FULL	OCT 27 1959					4 22 <sup>x</sup>						
7		4 26					6 10			6 10	7	PAID IN FULL	OCT 27 1959	13179				6 10 <sup>x</sup>	36					
8				10 0			25 46	6 6		26 12	8	PAID IN FULL	MAY 15 1959	9840		36 12								
9				4 155			39 46			39 46	9	PAID IN FULL	OCT 27 1959	13179				39 46 <sup>x</sup>	1 38					
10											10													
11	SOLD FOR TAXES			87			22 16	5 6		22 72	11									22 72 <sup>x</sup>	2499			
12											12													
13											13													
14											14													
15				93			23 68	6 0		24 28	15	PAID IN FULL	MAY 15 1959	9840		34 28								
16											16													
17											17													
18											18													
19											19													
20		4 44		4 155 = 199			10 32			11076														
				280 = 280			11076	182		122 90														
		4 4		43 5 = 419			12108								5070		4978			22 72				



Assessment Roll and Tax List of Real Property in the Town of Minnetonka

\* Indicate Type of Property: R-Residential, C-Commercial, I-Industrial, U-Utility, F-Farm, L-Lakeshore, T-Timber, M-Mineral

Form 507) MILLER-BLUM COMPANY, MINNEAPOLIS																	Indicate Type of Property: R-Residential, C-Commercial, I-Industrial, U-Utility, F-Farm, L-Lakeshore, T-Timber, M-Mineral																
IN WHOSE NAME ASSESSED	TO WHOM TRANSFERRED	DESCRIPTION OF PROPERTY					No. School District	Indicate Homestead Yes or No	Indicate Agricultural Yes or No	Indicate Type of Property	TRUE AND FULL VALUATIONS				ASSESSED VALUATIONS										FINAL EQUALIZED VALUE								
		SUBDIVISION	Sec. or Lot	Town or Block	Rng.	Number of Acres of Land					LAND Exclusive of Structures and Improvements	BUILDINGS and Other Structures	MACHINERY Permanently Attached to Real Estate	TOTAL True and Full Value	RURAL		ALL OTHER				MACHINERY Permanently Attached to Real Estate 33 1/8 %	TOTAL ASSESSED VALUE	Total Assessed Value as Equalized by the Board or Review										
															Homestead Up to \$4,000 20%	Over \$4,000 and Non-Homestead 33 1/8 %	Timber Land Class 3e 20%	Homestead Up to \$4,000 25%	Over \$4,000 and Non-Homestead 40%														
Dollars	Dollars	Dollars	Dollars	Dollars	Dollars	Dollars	Dollars	Dollars	Dollars	Dollars	Dollars	Dollars	Dollars	Dollars	Dollars	Dollars																	
State of Minnesota		1	NE 1/4 of NE 1/4			34 140 31																											
State of Minnesota		2	NW 1/4 of NE 1/4																														
State of Minnesota		3	SW 1/4 of NE 1/4																														
State of Minnesota		4	SE 1/4 of NE 1/4																														
		5																															
State of Minnesota		6	NE 1/4 of NW 1/4																														
State of Minnesota		7	NW 1/4 of NW 1/4																														
The Northwest Paper Co.		8	SW 1/4 of NW 1/4			40			no	gr	T	201		201		67						67											
State of Minnesota		9	SE 1/4 of NW 1/4																														
		10																															
Carrie Blumberg & Elizabeth Putnam		11	NE 1/4 of SW 1/4			40			no	gr	T	180		180		60						60											
" " " " "		12	NW 1/4 of SW 1/4			40			no	gr	T	180		180		60						60											
State of Minnesota		13	SW 1/4 of SW 1/4																														
State of Minnesota		14	SE 1/4 of SW 1/4																														
		15																															
State of Minnesota		16	NE 1/4 of SE 1/4																														
State of Minnesota		17	NW 1/4 of SE 1/4																														
State of Minnesota		18	SW 1/4 of SE 1/4																														
State of Minnesota		19	SE 1/4 of SE 1/4																														
		20																															
						120						561		561		187						187											

## Cass County, Minnesota, for Taxes for the Year 1958.

SOLID FOR TAXES	VALUATIONS BY SCHOOL DISTRICTS AS EQUALIZED BY DEPARTMENT OF TAXATION						Tax including State Homestead	State Tax on Non-Homestead	SPECIAL TAXES	TOTAL TAXES	PAID	WHEN PAID	Number of Receipt	March Settlement 1959	June Settlement 1959	Penalty	November Settlement 1959	Penalty	Collections to First Monday in January 1960	Penalty	Delinquent on First Monday in January 1960	Total Delinquent Tax and Penalty	REMARKS
	District No.	District No.	District No.	District No.	District No.	District No.																	
	Rate	Rate	Rate	Rate	Rate	Rate																	
	Mills	Mills	Mills	Mills	Mills	Mills																	
1																							
2																							
3																							
4																							
5																							
6																							
7																							
8		67					15 72	44		16 16		PAID IN FULL MAY 20 1959	7943		16 16								7329
9																							
10																							
11		60					14 08	40		14 48		PAID IN FULL APR 16 1959			14 48								8324
12		60					14 08	40		14 48		PAID IN FULL APR 16 1959	5324		14 48								
13																							
14																							
15																							
16																							
17																							
18																							
19																							
20		187					43 88	124		45 12					45 12								



Assessment Roll and Tax List of Real Property in the Town of Hiram,  
\* Indicate Type of Property: R-Residential, C-Commercial, I-Industrial, U-Utility, F-Farm, L-Lakeshore, T-Timber, M-Mineral

IN WHOSE NAME ASSESSED		TO WHOM TRANSFERRED	DESCRIPTION OF PROPERTY					No. School District	Indicate Homestead Yes or No	Indicate Agricultural Yes or No	Indicate Type of Property	TRUE AND FULL VALUATIONS				ASSESSED VALUATIONS								FINAL EQUALIZED VALUE
			SUBDIVISION	Sec. or Lot	Town or Block	Rng.	Number of Acres of Land					LAND Exclusive of Structures and Improvements	BUILDINGS and Other Structures	MACHINERY Permanently Attached to Real Estate	TOTAL True and Full Value	RURAL		ALL OTHER			MACHINERY Permanently Attached to Real Estate	TOTAL ASSESSED VALUE	Total Assessed Value as Equalized by the Board or Review	
																Homestead Up to \$4,000 20%	Over \$4,000 and Non-Homestead 33 1/3%	Timber Land Class 3e 20%	Homestead Up to \$1,000 25%	Over \$4,000 and Non-Homestead 40%				
State of Minnesota		1	NE 1/4 of NE 1/4				35 140 31		200															
Albert & Lydia E. Thomas		2	NW 1/4 of NE 1/4				40		no	yes	T	111			111			37				37		
State of Minnesota		3	SW 1/4 of NE 1/4																					
State of Minnesota		4	SE 1/4 of NE 1/4																					
		5																						
State of Minnesota		6	NE 1/4 of NW 1/4																					
State of Minnesota		7	NW 1/4 of NW 1/4																					
State of Minnesota		8	SW 1/4 of NW 1/4																					
State of Minnesota		9	SE 1/4 of NW 1/4																					
		10																						
State of Minnesota		11	NE 1/4 of SW 1/4																					
Glacier Park Hotel		12	NW 1/4 of SW 1/4				40		no	yes	T	201			201			67				67		
State of Minnesota		13	SW 1/4 of SW 1/4																					
State of Minnesota		14	SE 1/4 of SW 1/4																					
		15																						
State of Minnesota		16	NE 1/4 of SE 1/4																					
State of Minnesota		17	NW 1/4 of SE 1/4																					
Richard Salminen		18	SW 1/4 of SE 1/4				40		no	yes	T	201			201			67				67		
" "		19	SE 1/4 of SE 1/4				40		no	yes	T	201			201			67				67		
		20																						
							160					214			214			238				238		

Cass County, Minnesota, for Taxes for the Year 1958.

SOLD FOR TAXES	VALUATIONS BY SCHOOL DISTRICTS AS EQUALIZED BY DEPARTMENT OF TAXATION						Tax Including State Homestead	State Tax on Non-Homestead	SPECIAL TAXES	TOTAL TAXES	PAID	WHEN PAID	Number of Receipt	March Settlement 1959	June Settlement 1959	Penalty	November Settlement 1959	Penalty	Collections to First Monday in January 1960	Penalty	Delinquent on First Monday in January 1960	Total Delinquent Tax and Penalty	REMARKS
	District No.	District No.	District No.	District No.	District No.	District No.																	
	Rate	Rate	Rate	Rate	Rate	Rate																	
	Mills	Mills	Mills	Mills	Mills	Mills																	
	Dollars	Dollars	Dollars	Dollars	Dollars	Dollars	\$ cts.	\$ cts.	\$ cts.	\$ cts.		Month Day Year		\$ cts.	\$ cts.	\$ cts.	\$ cts.	\$ cts.	\$ cts.	\$ cts.	\$ cts.	\$ cts.	
1																							
2		37					868	24		892		2nd HALF PAID NOV 2 1959 14362 1st Half Paid MAY 29 1959 10716			4 46		4 46					9586	
3																							
4																							
5																							
6																							
7																							
8																							
9																							
10																							
11																							
12		67					1572	44		1616		PAID IN FULL MAY 23 1959 8173			1616							8236	
13																							
14																							
15																							
16																							
17																							
18	SOLD FOR TAXES	67					1572	44		1616												1616 1778	
19	SOLD FOR TAXES	67					1572	44		1616												1616 1778	
20																							
		238					5584	156		5740					2062	4 46					3232		



Cass County, Minnesota, for Taxes for the Year 1958.

[illegible]

Long Beach  
Shady Shores  
Pine Beach  
Plainview Beach  
Whitely Pine Beach



# BLANK

[illegible]



Cass County, Minnesota, for Taxes for the Year 1958.

[illegible][illegible]



\* Indicate Type of Property: R-Residential, C-Commercial, I-Industrial, U-Utility, F-Farm, L-Lakeshore, T-Timber, M-Mineral

58

SOLD FOR TAXES	VALUATIONS BY SCHOOL DISTRICTS AS EQUALIZED BY DEPARTMENT OF TAXATION						Tax Including State Homestead	State Tax on Non-Homestead	SPECIAL TAXES	TOTAL TAXES	PAID	WHEN PAID	Number of Receipt	March Settlement 1959	June Settlement 1959	Penalty	November Settlement 1959	Penalty	Collections to First Monday in January 1960	Penalty	Delinquent on First Monday in January 1960	Total Delinquent Tax and Penalty	REMARKS
	District No.	District No.	District No.	District No.	District No.	District No.																	
	Rate	Rate	Rate	Rate	Rate	Rate																	
	Mills	Mills	Mills	Mills	Mills	Mills																	
	Dollars	Dollars	Dollars	Dollars	Dollars	Dollars	\$ cts.	\$ cts.	\$ cts.	\$ cts.	Month Day Year	\$ cts.	\$ cts.	\$ cts.	\$ cts.	\$ cts.	\$ cts.	\$ cts.	\$ cts.	\$ cts.	\$ cts.		
1				17			4320	04 12		444	1	Balance Paid OCT 23 1959 Part Paid MAY 29 1959	9515										5
2				274			6976	49 128		7154	2	Balance Paid OCT 23 1959 Part Paid MAY 29 1959	15645	38 00		3798							4
3											3												
4											4												
5											5												
6											6												
7											7												
8											8												
9											9												
10											10												
11											11												
12											12												
13											13												
14											14												
15											15												
16											16												
17											17												
18											18												
19											19												
20											20												
				291			7408	190		7598					38 00		3798						

Sunset Beach

Shady Shores

Pine Beach

Plainview

Beach  
arrange  
White

ment of Lot  
Pine Beach



[illegible]



\* Indicate Type of Property: R-Residential, C-Commercial, I-Industrial, U-Utility, F-Farm, L-Lakeshore, T-Timber, M-Mineral

[illegible]



[illegible]



\* Indicate Type of Property: R-Residential, C-Commercial, I-Industrial, U-Utility, F-Farm, L-Lakeshore, T-Timber, M-Mineral

[illegible]



\* Indicate Type of Property: R-Residential, C-Commercial, I-Industrial, U-Utility, F-Farm, L-Lakeshore, T-Timber, M-Mineral

[illegible]

SOLD FOR TAXES	VALUATIONS BY SCHOOL DISTRICTS AS EQUALIZED BY DEPARTMENT OF TAXATION						Tax including State Homestead	State Tax on Non-Homestead	SPECIAL TAXES	TOTAL TAXES	PAID	WHEN PAID	Number of Receipt	March Settlement 1959	June Settlement 1959	Penalty	November Settlement 1959	Penalty	Collections to First Monday in January 1960	Penalty	Delinquent on First Monday in January 1960	Total Delinquent Tax and Penalty	REMARKS
	District No.	District No.	District No.	District No.	District No.	District No.																	
	Rate	Rate	Rate	Rate	Rate	Rate																	
	Mills	Mills	Mills	Mills	Mills	Mills																	
	Dollars	Dollars	Dollars	Dollars	Dollars	Dollars	\$ cts.	\$ cts.	\$ cts.	\$ cts.	Month Day Year	\$ cts.	\$ cts.	\$ cts.	\$ cts.	\$ cts.	\$ cts.	\$ cts.	\$ cts.	\$ cts.	\$ cts.	\$ cts.	
1				17			432	12		444	1	2nd HALF PAID OCT 30 1959											
2				135			3438	88		3526	2	1st HALF PAID JUN 30 1959											
3				10			254			254	3	2nd HALF PAID OCT 30 1959											
4				130			3310			3310	4	1st HALF PAID JUN 30 1959											
5				74			1884	48		1932	5	2nd HALF PAID OCT 30 1959											
6				17			432	12		444	6	1st HALF PAID JUN 30 1959											
7				115			2928	74		3002	7	2nd HALF PAID OCT 30 1959	16951				114 46						
8				87			2216	56		2272	8	1st HALF PAID JUN 30 1959	18877				114 46 3 43					02 overcollect	
9				101			2572	66		2638	9	2nd HALF PAID OCT 30 1959											
10				94			2394	62		2456	10	1st HALF PAID JUN 30 1959											
11				100			2546	66		2612	11	2nd HALF PAID OCT 30 1959											
12				90			2292			2272	12	2nd HALF PAID SEP 11 1959	1377	2530			2530						
13				106			2698	70		2768	13	1st HALF PAID FEB 19 1959	2687										
14		5					118	04		122	14	PAID IN FULL MAY 19 1959			122								
15		5					118	04		122	15	PAID IN FULL MAY 19 1959			122								
16		5					118	04		122	16	PAID IN FULL MAY 19 1959	7899		122								
17		5					118	04		122	17	PAID IN FULL MAY 19 1959			122								
18		5					118	04		122	18	PAID IN FULL MAY 19 1959			122								
19											19												
20											20												
		25		230 = 230			590			27396	574												
		25		846 = 871			27986			28560													
		25		1576 = 1101			27986							2530	610		25422					02 overcollect	



Sunset Beach  
Charlton Beach  
Peace Beach  
Plainview Beach  
Irrengement of Lot  
Sunset Beach  
Almond



Cass County, Minnesota, for Taxes for the Year 1958.

\* Indicate Type of Property: R-Residential, C-Commercial, I-Industrial, U-Utility, F-Farm, L-Lakeshore, T-Timber, M-Mineral

SOLD FOR TAXES	VALUATIONS BY SCHOOL DISTRICTS AS EQUALIZED BY DEPARTMENT OF TAXATION						Tax including State Homestead .....Mills	State Tax on Non- Homestead 6.52.....Mills	SPECIAL TAXES	TOTAL TAXES		PAID	WHEN PAID	Number of Receipt	March Settlement 1959	June Settlement 1959	Penalty	November Settlement 1959	Penalty	Collections to First Monday in January 1960	Penalty	Delinquent on First Monday in January 1960	Total Delinquent Tax and Penalty	REMARKS
	District No. ....	District No. ....	District No. ....	District No. ....	District No. ....	District No. ....																		
	Rate.....	Rate.....	Rate.....	Rate.....	Rate.....	Rate.....																		
	.....Mills	.....Mills	.....Mills	.....Mills	.....Mills	.....Mills																		
Dollars	Dollars	Dollars	Dollars	Dollars	Dollars	\$ cts.	\$ cts.	\$ cts.	\$ cts.		Month Day Year	\$ cts.	\$ cts.	\$ cts.	\$ cts.	\$ cts.	\$ cts.	\$ cts.	\$ cts.	\$ cts.	\$ cts.	\$ cts.		
			192			4888				4888	1	PAID IN FULL	MAY 13 1959	9763		4888								84.4
			139			3540	90			3630	2	PAID IN FULL	MAY 4 1959	5975		3630								95.39
			17			432	12			444	3	PAID IN FULL	APR 11 1959			444								83.9
			76			1936	50			1986	4	PAID IN FULL	APR 11 1959	5146		1986								
			10			254				254	5	PAID IN FULL	MAY 25 1959	10187		254								95.28
			89			2266				2266	6	PAID IN FULL	MAY 25 1959			2266								
			145			3692				3692	7	PAID IN FULL	MAY 13 1959	9764		3692								95.29
			153			3846	100			3996	8	PAID IN FULL	MAY 2 1959	5942		3996								83.00
			17			432	12			444	9	PAID IN FULL	APR 11 1959			444								84.85
			143			3642	94			3736	10	PAID IN FULL	APR 11 1959	5145		3736								
											11													
											12													
											13													
											14													
											15													
											16													
											17													
											18													
											19													
											20													
			436			24978	358			25336						25336								
			545																					
			981																					







Assessment Roll and Tax List of Real Property in the Town of Hiram

\* Indicate Type of Property: R-Residential, C-Commercial, I-Industrial, U-Utility, F-Farm, L-Lakeshore, T-Timber, M-Mineral

Form 3C - 1957-58

IN WHOSE NAME ASSESSED	TO WHOM TRANSFERRED	DESCRIPTION OF PROPERTY					No. School District	Indicate Homestead Yes or No	Indicate Agricultural Yes or No	Indicate Type of Property	TRUE AND FULL VALUATIONS				ASSESSED VALUATIONS								FINAL EQUALIZED VALUE	
		SUBDIVISION	Sec. or Lot	Town or Block	Rng.	Number of Acres of Land					LAND Exclusive of Structures and Improvements	BUILDINGS and Other Structures	MACHINERY Permanently Attached to Real Estate	TOTAL True and Full Value	RURAL		ALL OTHER				MACHINERY Permanently Attached to Real Estate 33 1/3 %	TOTAL ASSESSED VALUE		Total Assessed Value as Equalized by the Board of Review
															Homestead Up to \$4,000 20%	Over \$4,000 and Non-Homestead 33 1/3 %	Timber Land Class 3c 20%	Homestead Up to \$4,000 25%	Over \$4,000 and Non-Homestead 40%					
																				Dollars				
Carl W. & Clara Johnson		Elmhurst	1				44	no	no	R	50	322		372		124					124			
Emma Dixon		Part of Lot 1 Sec 12-140-31 (S. 44th)	2					no	no	LS	51			51		17					17			
" "			3					no	no	R	52	800		852		284					284			
Frank F. & Latta H. Murray			4					yes	no	LS	50			50	10						10			
" "			5					yes	no	R	50	1595		1645	329						329			
" "			6					yes	no	LS	50			50	10						10			
" "			7					yes	no	R	50			50	10						10			
John S. & Antonisen			8					no	no	LS	57			57		17					17			
Loen K. & Esther A. Madsen			9					no	no	R	50	1087		1137		379					379			
" "			10					no	no	LS	57			57		17					17			
" "			11					no	no	LS	57			57		17					17			
Arthur C. & Mildred F. Loopp			12					no	no	R	57	1101		1152		384					384			
" "			13					no	no	LS	57			57		17					17			
Ruth W. Abrahamson			14					no	no	R	50	847		897		299					299			
" "			15					no	no	LS	57			57		17					17			
Ida & Leida Rausch			16					no	no	LS	57			57		17					17			
" "			17					no	no	LS	57			57		17					17			
Mabel Bastrom			18					no	no	LS	57			57		17					17			
" "			19					no	no	LS	57			57		17					17			
Edwin & Willard Bastrom			20					no	no	LS	9			9		3					3			
											972	5752		6724	359	1643					2002			

## Cass County, Minnesota, for Taxes for the Year 1958.

SOLD FOR TAXES	VALUATIONS BY SCHOOL DISTRICTS AS EQUALIZED BY DEPARTMENT OF TAXATION						Tax including State Homestead	State Tax on Non-Homestead	SPECIAL TAXES	TOTAL TAXES	PAID	WHEN PAID	Number of Receipt	March Settlement 1959	June Settlement 1959	Penalty	November Settlement 1959	Penalty	Collections to First Monday in January 1960	Penalty	Delinquent on First Monday in January 1960	Total Delinquent Tax and Penalty	REMARKS
	District No.	District No.	District No.	District No.	District No.	District No.																	
	Rate	Rate	Rate	Rate	Rate	Rate																	
	Dollars	Dollars	Dollars	Dollars	Dollars	Dollars	\$ cts.	\$ cts.	\$ cts.	\$ cts.		Month Day Year		\$ cts.	\$ cts.	\$ cts.	\$ cts.	\$ cts.	\$ cts.	\$ cts.	\$ cts.	\$ cts.	
1							3158	80		3238	1	PAID IN FULL MAY 2 1959	3512		3238								9516
2							432	12		444	2	1st HALF PAID OCT 23 1959	15646		222		222						10468
3							7232	186		7418	3	2nd HALF PAID OCT 23 1959	8021		3709		3709						9524
4							254			254	4	1st HALF PAID MAY 6 1959			127		127						
5							8376			8376	5	2nd HALF PAID OCT 7 1959	12906		4188		4188						
6							254			254	6	1st HALF PAID MAY 6 1959	8480		127		127						
7							254			254	7	2nd HALF PAID OCT 7 1959			127		127						
8							432	12		444	8	1st HALF PAID MAY 6 1959											8339
9							9650	248		9898	9	PAID IN FULL AUG 15 1959	15547					11230	281				
10							432	12		444	10	PAID IN FULL AUG 15 1959											
11							432	12		444	11	PAID IN FULL AUG 15 1959											
12							384	250		10028	12	PAID IN FULL FEB 2 1959	4653	10472									5538
13							432	12		444	13	PAID IN FULL FEB 2 1959											
14							7614	194		7808	14	2nd HALF PAID SEP 10 1959	11526		4126		4126						8358
15							432	12		444	15	1st HALF PAID MAY 29 1959	18671										
16							432	12		444	16	2nd HALF PAID SEP 10 1959											
17							432	12		444	17	PAID IN FULL MAY 29 1959	9368		888								9517
18							432	12		444	18	PAID IN FULL MAY 8 1959	9667		888								
19							432	12		444	19	PAID IN FULL MAY 8 1959											
20							76	02		78	20												482.86
							50966	1080		52046				10472	13514		27982						78



Assessment Roll and Tax List of Real Property in the Town of Niara

\* Indicate Type of Property: R-Residential, C-Commercial, I-Industrial, U-Utility, F-Farm, L-Lakeshore, T-Timber, M-Mineral

Form 30 - JULY 1957 - MINNAPOLIS

IN WHOSE NAME ASSESSED		TO WHOM TRANSFERRED		DESCRIPTION OF PROPERTY					TRUE AND FULL VALUATIONS				ASSESSED VALUATIONS								FINAL EQUALIZED VALUE		
				SUBDIVISION	Sec. or Lot	Town or Block	Rng.	Number of Acres of Land	LAND Exclusive of Structures and Improvements	BUILDINGS and Other Structures	MACHINERY Permanently Attached to Real Estate	TOTAL True and Full Value	RURAL		ALL OTHER			MACHINERY Permanently Attached to Real Estate 33 1/3%	TOTAL ASSESSED VALUE	Total Assessed Value as Equalized by the Board of Review			
													Homestead Up to \$4,000 20%	Over \$4,000 and Non-Homestead 33 1/3%	Timber Land Class 3e 20%	Homestead Up to \$4,000 25%	Over \$4,000 and Non-Homestead 40%						
				Acres	100ths				Dollars	Dollars	Dollars	Dollars	Dollars	Dollars	Dollars	Dollars	Dollars	Dollars	Dollars				
				52 acs. Plant Lot 4 Sec. 14-140-31																			
William J. & Viola K. Marschen		1						20	No	No	R	30	90		120		40				40		
" " "		2							No	No	LS	30			30		10				10		
" " "		3							No	No	LS	30			30		10				10		
Edw. L. & Margery Wosok		4							No	No	LS	30			30		10				10		
Robert W. & Mae H. Stigmer		5							No	No	R	30	351		381		127				127		
" " "		6							No	No	LS	30			30		10				10		
" " "		7							No	No	LS	30			30		10				10		
Harald K. Mattison		8							No	No	R	30	237		267		89				89		
" " "		9							No	No	LS	30			30		10				10		
" " "		10							No	No	LS	30	114		144		48				48		
George J. & Viola M. Terrell		11							No	No	R	40	281		321		107				107		
Malcolm & Chloa Combs		12							No	No	R	28	167		195		65				65		
" " "		13							No	No	R	28	92		120		40				40		
" " "		14							No	No	LS	30			30		10				10		
" " "		15							No	No	R	28	134		162		54				54		
G. M. & Helen J. Hougham		16							No	No	R	31	140		171		57				57		
George E. & Opal Kitz		17							No	No	LS	30			30		10				10		
" " "		18							No	No	LS	30			30		10				10		
" " "		19							No	No	LS	30			30		10				10		
" " "		20							No	No	LS	30			30		10				10		
												605	1606		2211		737				737		

Cass County, Minnesota, for Taxes for the Year 1958.

SOLD FOR TAXES	VALUATIONS BY SCHOOL DISTRICTS AS EQUALIZED BY DEPARTMENT OF TILATION						Tax including State Homestead	State Tax on Non-Homestead	SPECIAL TAXES	TOTAL TAXES	PAID	WHEN PAID	Number of Receipt	March Settlement 1959	June Settlement 1959	Penalty	November Settlement 1959	Penalty	Collections to First Monday in January 1960	Penalty	Delinquent on First Monday in January 1960	Total Delinquent Tax and Penalty	REMARKS
	District No.	District No.	District No.	District No.	District No.	District No.																	
	Rate	Rate	Rate	Rate	Rate	Rate																	
	Mills	Mills	Mills	Mills	Mills	Mills																	
1						40	10 18	26		10 44	1	PAID IN FULL MAY 29 1959			10 44								8350
2						10	254	06		260	2	PAID IN FULL MAY 29 1959	9494		260								
3						10	254	06		260	3	PAID IN FULL MAY 29 1959			260								
4						10	254	06		260	4									260			
5						127	3234	82		3316	5	PAID IN FULL APR 14 1959			3316								8365
6						10	254	06		260	6	PAID IN FULL APR 14 1959	5226		260								
7						10	254	06		260	7	PAID IN FULL APR 14 1959			260								
8						89	2266	58		2324	8	PAID IN FULL MAY 4 1959											9534
9						10	254	06		260	9	PAID IN FULL MAY 4 1959	5974		3838								
10						48	1222	32		1254	10	PAID IN FULL MAY 4 1959											
11						107	2724	70		2794	11	PAID IN FULL APR 16 1959	5325		2794								8364
12						65	1656	42		1698	12	PAID IN FULL MAY 22 1959											9532
13						40	1018	26		1044	13	PAID IN FULL MAY 22 1959			4416								
14						10	254	06		260	14	PAID IN FULL MAY 22 1959	9164										
15						54	1374	36		1410	15	PAID IN FULL MAY 22 1959											
16						57	1452	38		1490	16	PAID IN FULL MAY 29 1959	9471		1490								8363
17						10	254	06		260	17	PAID IN FULL MAY 29 1959											9525
18						10	254	06		260	18	PAID IN FULL MAY 29 1959	9482		1040								
19						10	254	06		260	19	PAID IN FULL MAY 29 1959											
20						10	254	06		260	20	PAID IN FULL MAY 29 1959											
							18758	476		19234					18994						260		



\* Indicate Type of Property: R-Residential, C-Commercial, I-Industrial, U-Utility, F-Farm, L-Lakeshore, T-Timber, M-Mineral

[illegible]



DO NOT



[illegible]



[illegible]



[illegible]



Assessment Roll and Tax List of Real Property in the Town of Hiawatha

\* Indicate Type of Property: R-Residential, C-Commercial, I-Industrial, U-Utility, F-Farm, L-Lakeshore, T-Timber, M-Mineral

Form 30

IN WHOSE NAME ASSESSED	TO WHOM TRANSFERRED	DESCRIPTION OF PROPERTY					No. School District	Indicate Homestead Yes or No	Indicate Agricultural Yes or No	Indicate Type of Property	TRUE AND FULL VALUATIONS				ASSESSED VALUATIONS							FINAL EQUALIZED VALUE	
		SUBDIVISION	Sec. or Lot	Town or Block	Rng.	Number of Acres of Land					LAND Exclusive of Structures and Improvements	BUILDINGS and Other Structures	MACHINERY Permanently Attached to Real Estate	TOTAL True and Full Value	RURAL		ALL OTHER		MACHINERY Permanently Attached to Real Estate	TOTAL ASSESSED VALUE	Total Assessed Value as Equalized by the Board of Review		
															Homestead Up to \$4,000 20%	Over \$4,000 and Non-Homestead 33 1/3%	Timber Land Class 3c 20%	Homestead Up to \$4,000 25%					Over \$4,000 and Non-Homestead 40%
Acres	100ths	Dollars	Dollars	Dollars	Dollars	Dollars	Dollars	Dollars	Dollars	Dollars	Dollars	Dollars	Dollars	Dollars	Dollars	Dollars	Dollars						
Peaceful Shores																							
Quit Lots 2 + 3 + Part of Quit Lot 4 Sec. 13-140-31																							
Mrs. Blanche Grath	1						24	no	no	R	74	304		378		126				126			
Henry + Alma Groszkrentz	2							no	no	R	74	328		402		134				134			
Jay E. + Ruth M. Laker	3						no	yes	no	LS	76			75		25				25			
Frank + Jessie Green	4							yes	no	C	111	449		560	112					112			
Jay E. + Ruth M. Laker	5							yes	no	LS	40			40	8					8			
George + Lillian F. Wessale	6							no	no	LS	76	429		504		168				168			
Emma A. Funk	7							yes	no	LS	75	450		525	105					105			
Paul William Mosher	8							no	no	LS	75			75		25				25			
John F. + Alma S. Greer	9							yes	no	R	100	500		600	120					120			
"	10							no	no	C	99	384		483		161				161			
"	11							no	no	C	99	192		291		97				97			
C. C. Ekland	12							no	no	R	51	192		243		81				81			
Clayd E. + Philip A. Eichorn	13							no	no	R	51	327		378		126				126			
Newman F. Nies	14							no	no	LS	99			99		33				33			
Newman F. Nies + Laverne Link Nies	15							no	no	R	100	293		393		131				131			
Newman F. Nies	16							no	no	R	100	293		393		131				131			
Newman Francis Nies	17							no	no	R	51	192		243		81				81			
Laverne Louis Nies	18							no	no	"	52	382		435		145				145			
Laverne L. Nies	19							no	no	C	100	131		231		77				77			
	20																						
											1501	4655		6156	345	1477					1822		



[illegible]



## Assessment Roll and Tax List of Real Property in the Town of Hiram

\* Indicate Type of Property: R-Residential, C-Commercial, I-Industrial, U-Utility, F-Farm, L-Lakeshore, T-Timber, M-Mineral

IN WHOSE NAME ASSESSED	TO WHOM TRANSFERRED	DESCRIPTION OF PROPERTY					TRUE AND FULL VALUATIONS										ASSESSED VALUATIONS							FINAL EQUALIZED VALUE
		SUBDIVISION	Sec. or Lot	Town or Block	Rng.	Number of Acres of Land	No. School District	Indicate Homestead Tax or No	Indicate Agricultural Tax or No	Indicate Type of Property	LAND Exclusive of Structures and Improvements	BUILDINGS and Other Structures	MACHINERY Permanently Attached to Real Estate	TOTAL True and Full Value	RURAL		ALL OTHER			MACHINERY Permanently Attached to Real Estate 33 1/3%	TOTAL ASSESSED VALUE	Total Assessed Value as Equalized by the Board of Review		
															Homestead Up to \$4,000 20%	Over \$4,000 and Non-Homestead 33 1/3%	Timber Land Class 3e 20%	Homestead Up to \$4,000 25%	Over \$4,000 and Non-Homestead 40%					
																							Dollars	
Ralph C. & Cora Lee Krbaukh		Peaceful Shores	37				44	No	No	C	99	450		549		183					183			
"	"		38					Yes	No	R	100	325		425	85						85			
Paul E. Huckleberg			39					No	No	L S	99			99		33					33			
"	"		40					No	No	L S	99			99		33					33			
Gerald W. & Helen M. Darrow			41					Yes	No	C	100	430		1151	106	207					313			
"	"		42					No	No	C	100	263		363		121					121			
"	"		43					No	No	C	100	536		606		202					202			
Oscar M. & Gazella Magnuson			44					No	No	R	99	336		438		145					145			
Irving A. & Hazel M. Kellum			45					No	No	R	99	303		402		134					134			
Henry J. J. Ryan			46					No	No	L S	99			99		33					33			
"	"		47					No	No	L S	99			99		33					33			
Carl A. Ryan & Vincent & Kathleen Haleapple			48					No	No	L S	99			99		33					33			
James M. Hicks			49					No	No	L S	49	254		303		101					101			
"	"		50					No	No	L S	81			81		27					27			
John F. & Almond A. Greer		Outlot A						No	No	C	301	1100		1401		467					467			
Carl A. Ryan		" B						No	No	L S	150			150		50					50			
Carl A. Ryan		" C line W. 800'						No	No	L S	99			99		33					33			
Roy A. & Edna A. Swanson		W. 800' Outlot C						No	No	"	57			57		17					17			
											1923	4588		6511	191	1852					2043			

## Cass County, Minnesota, for Taxes for the Year 1958.

SOLD FOR TAXES	VALUATIONS BY SCHOOL DISTRICTS AS EQUALIZED BY DEPARTMENT OF TAXATION						Tax Including State Homestead	State Tax on Non-Homestead	SPECIAL TAXES	TOTAL TAXES	PAID	WHEN PAID	Number of Receipt	March Settlement 1959	June Settlement 1959	Penalty	November Settlement 1959	Penalty	Collections to First Monday in January 1960	Penalty	Delinquent on First Monday in January 1960	Total Delinquent Tax and Penalty	REMARKS
	District No.	District No.	District No.	District No.	District No.	District No.																	
	Rate	Rate	Rate	Rate	Rate	Rate																	
	Mills	Mills	Mills	Mills	Mills	Mills																	
1						183	4660	120		4780	1	2nd HALF PAID OCT 13 1959											
2						85	2164			2164	2	1st HALF PAID APR 18 1959			2390		3472						
3						33	840	22		862	3	2nd HALF PAID OCT 13 1959			1682								
4						33	840	22		862	4	1st HALF PAID APR 18 1959											
5						207	7970	134		8104	5	2nd HALF PAID OCT 22 1959											
6						121	3080	78		3158	6	1st HALF PAID JUL 2 1959											
7						202	5144	132		5276	7	2nd HALF PAID OCT 22 1959											
8						145	3672	94		3786	8	1st HALF PAID JUL 2 1959											
9						134	3412	88		3500	9	PAID IN FULL MAY 29 1959			3786								
10						33	840	22		862	10	PAID IN FULL MAY 4 1959			3500								
11						33	840	22		862	11	PAID IN FULL MAY 4 1959			1724								
12						33	840	22		862	12	PAID IN FULL JAN 5 1959			862								
13						101	2572	66		2638	13	PAID IN FULL SEP 21 1959											
14						27	688	18		706	14	PAID IN FULL SEP 21 1959											
15						467	11890	304		12194	15	2nd HALF PAID OCT 28 1959											
16						50	1274	32		1306	16	1st HALF PAID MAY 1 1959			6097		6097						
17						23	840	22		862	17	PAID IN FULL JAN 5 1959											
18						17	432	12		444	18	Part Paid OCT 26 1958											
19											19	Part Paid MAY 25 1959											
20											20												
						191	52018	1210		53228					2168	19140	28568			2352			



[illegible]



	SOLD FOR TAXES	VALUATIONS BY SCHOOL DISTRICTS AS EQUALIZED BY DEPARTMENT OF TAXATION						Tax including State Homestead	State Tax on Non-Homestead	SPECIAL TAXES	TOTAL TAXES		PAID	WHEN PAID	Number of Receipt	March Settlement 1959	June Settlement 1959	Penalty	November Settlement 1959	Penalty	Collections to First Monday in January 1960	Penalty	Delinquent on First Monday in January 1960	Total Delinquent Tax and Penalty	REMARKS
		District No.	District No.	District No.	District No.	District No.	District No.																		
		Rate.....Mills	Rate.....Mills	Rate.....Mills	Rate.....Mills	Rate.....Mills	Rate.....Mills																		
		Dollars	Dollars	Dollars	Dollars	Dollars	Dollars																		
						\$ cts.	\$ cts.	\$ cts.	\$ cts.			Month	Day	Year		\$ cts.	\$ cts.	\$ cts.	\$ cts.	\$ cts.	\$ cts.	\$ cts.	\$ cts.	\$ cts.	
1				63		16 04	42		16 46	1	PAID IN FULL	MAY 2 2	1959			16 46									
2				200		50 42	130		52 22	2	PAID IN FULL	MAY 2 2	1959	8101		52 22									
3				117		29 80	76		30 56	3	PAID IN FULL	MAY 2	1959	5941		30 56									
4			X	122		31 06			31 06	4	2nd HALF PAID	SEP 3	1959	11523											
5				103		26 22	68		26 90	5	1st HALF PAID	MAY 2 9	1959	11867		13 45		15 53							
6				175		44 56	114		45 70	6	PAID IN FULL	MAY 2 9	1959	9469		45 70									
7				116		29 54	76		30 30	7	PAID IN FULL	MAY 2 9	1959	9513		30 30									
8				33		8 40	22		8 62	8	PAID IN FULL	MAY 2 9	1959	9481		8 62									
9				50		12 74	32		13 06	9															
10				33		8 40	22		8 62	10															
11				33		8 40	22		8 62	11															
12	GOLD FOR TAXES			33		8 40	22		8 62	12	PAID IN FULL	APR 20	1959			8 62									
13	GOLD FOR TAXES			33		8 40	22		8 62	13	PAID IN FULL	APR 30	1959	5803		8 62									
14	GOLD FOR TAXES			33		8 40	22		8 62	14															
15				33		8 40	22		8 62	15															
16				33		8 40	22		8 62	16	PAID IN FULL	MAY 15	1959	9861		8 62									
17				33		8 40	22		8 62	17	PAID IN FULL	MAY 2 9	1959	9516		8 62									
18				33		8 40	22		8 62	18	PAID IN FULL	MAY 2 9	1959	10479		8 62									
19				17		43 2	12		44 4	19	Balance Paid	MAY 2 2	1959	15270											
20				30		76 4	20		78 4	20	Part Paid	MAY 2 7	1959	8339		10 00		2 28							
			X	122																					
				120 1		336 84	790		344 74							260 94		31 26					47 54		
				120 3																					



[illegible]



Form 5C MULLER-BAYNE COMPANY, MINNEAPOLIS

[illegible]



\* Indicate Type of Property: R-Residential, C-Commercial, I-Industrial, U-Utility, F-Farm, L-Lakeshore, T-Timber, M-Mineral

Form 5C HULLER-BAYNE COMPANY, MINNEAPOLIS

SOLD FOR TAXES	VALUATIONS BY SCHOOL DISTRICTS AS EQUALIZED BY DEPARTMENT OF TAXATION						Tax including State Homestead .....Mills	State Tax on Non- Homestead 6.52.....Mills	SPECIAL TAXES	TOTAL TAXES	PAID	WHEN PAID	Number of Receipt	March Settlement 1959	June Settlement 1959	Penalty	November Settlement 1959	Penalty	Collections to First Monday in January 1960	Penalty	Delinquent on First Monday in January 1960	Total Delinquent Tax and Penalty	REMARKS
	District No. .... Rate..... .....Mills	District No. .... Rate..... .....Mills	District No. .... Rate..... .....Mills	District No. .... Rate..... .....Mills	District No. .... Rate..... .....Mills	District No. .... Rate..... .....Mills																	
	Dollars	Dollars	Dollars	Dollars	Dollars	Dollars																	
	\$	cts.	\$	cts.	\$	cts.																	
1				7			178	04		182	1	PAID IN FULL OCT 20 1959											
2				7			178	04		182	2	PAID IN FULL OCT 20 1959											
3				7			178	04		182	3	PAID IN FULL APR 25 1959	3439		182								
4				7			178	04		182	4	PAID IN FULL JAN 5 1959	2	182									
5				7			178	04		182	5	1st HALF PAID OCT 20 1959											
6				7			178	04		182	6	2nd HALF PAID MAY 25 1959			91		91						
7				7			178	04		182	7	1st HALF PAID OCT 20 1959			91		91						
8				7			178	04		182	8	2nd HALF PAID MAY 25 1959			91		91						
9				7			178	04		182	9	1st HALF PAID OCT 20 1959			91		91						
10				7			178	04		182	10	2nd HALF PAID MAY 25 1959			91		91						
11				7			178	04		182	11	1st HALF PAID OCT 20 1959			91		91						
12				7			178	04		182	12	2nd HALF PAID MAY 25 1959			91		91						
13				7			178	04		182	13	1st HALF PAID OCT 20 1959	12/31		91		91						
14				7			178	04		182	14	2nd HALF PAID MAY 25 1959	8235		91		91						
15				7			178	04		182	15	1st HALF PAID OCT 20 1959			91		91						
16				7			178	04		182	16	2nd HALF PAID MAY 25 1959			91		91						
17				7			178	04		182	17	1st HALF PAID OCT 20 1959			91		91						
18				7			178	04		182	18	2nd HALF PAID MAY 25 1959			91		91						
19				7			178	04		182	19	1st HALF PAID OCT 20 1959			91		91						
20				7			178	04		182	20	2nd HALF PAID MAY 25 1959			91		91						
				140			3560	80		3640					182	1638		1820					



[illegible]



Assessment Roll and Tax List of Real Property in the Town of Nieman,  
\* Indicate Type of Property: R-Residential, C-Commercial, I-Industrial, U-Utility, F-Farm, L-Lakeshore, T-Timber, M-Mineral

Form 5C

IN WHOSE NAME ASSESSED	TO WHOM TRANSFERRED	DESCRIPTION OF PROPERTY					No. School District	Indicate Homestead Tax or No	Indicate Agricultural Tax or No	Indicate Type of Property	TRUE AND FULL VALUATIONS				ASSESSED VALUATIONS								Total Assessed Value as Equalized by the Board of Review	FINAL EQUALIZED VALUE
		SUBDIVISION	Sec. or Lot	Town or Block	Rng.	Number of Acres of Land					LAND Exclusive of Structures and Improvements	BUILDINGS and Other Structures	MACHINERY Permanently Attached to Real Estate	TOTAL True and Full Value	RURAL		ALL OTHER		MACHINERY Permanently Attached to Real Estate	TOTAL ASSESSED VALUE				
															Homestead Up to \$4,000 20%	Over \$4,000 and Non-Homestead 33 1/3%	Timber Land Class 3e 20%	Homestead Up to \$4,000 25%			Over \$4,000 and Non-Homestead 40%			
																						Acres		
Coughlin Beach Part of Lot 1 Sec. 15-140-31. Part of Lot 4 Sec. 16-140-31																								
Joseph + Ella Welsch		1					40	70	LS		80	50	130	26								26		
John W. + Blanche S. Coughlin		2					70	70	LS		112	443	535		185							185		
Alfred E. Woock		3					70	70	LS		111		111		37							37		
		4																						
		5																						
		6																						
		7																						
		8																						
		9																						
		10																						
		11																						
		12																						
		13																						
		14																						
		15																						
		16																						
		17																						
		18																						
		19																						
		20																						
													303	493	196	26	222					248		



Assessment Roll and Tax List of Real Property in the Town of Hiram

Indicate Type of Property: R-Residential, C-Commercial, I-Industrial, U-Utility, F-Farm, L-Lakeshore, T-Timber, M-Mineral

Form 5C - JULY 1954 EDITION, MINNESOTA

DESCRIPTION OF PROPERTY					No. School District	Indicate Homestead Yes or No	Indicate Agricultural Yes or No	Indicate Type of Property	TRUE AND FULL VALUATIONS				ASSESSED VALUATIONS							FINAL EQUALIZED VALUE	
SUBDIVISION	Sec. or Lot	Town or Block	Rng.	Number of Acres of Land					LAND Exclusive of Structures and Improvements	BUILDINGS and Other Structures	MACHINERY Permanently Attached to Real Estate	TOTAL True and Full Value	RURAL		ALL OTHER		MACHINERY Permanently Attached to Real Estate	TOTAL ASSESSED VALUE	Total Assessed Value as Equalized by the Board of Review		
													Homestead Up to \$4,000 20%	Over \$4,000 and Non-Homestead 33 1/3%	Timber Land Class 3e 20%	Homestead Up to \$4,000 25%					Over \$4,000 and Non-Homestead 40%
Long Pine																					
Part of Lot 3 Sec. 16-140-31																					

Cass County, Minnesota, for Taxes for the Year 1958.

SOLD FOR TAXES	VALUATIONS BY SCHOOL DISTRICTS AS EQUALIZED BY DEPARTMENT OF TAXATION						Tax including State Homestead	State Tax on Non-Homestead	SPECIAL TAXES	TOTAL TAXES	PAID	WHEN PAID	Number of Receipt	March Settlement 1959	June Settlement 1959	Penalty	November Settlement 1959	Penalty	Collections to First Monday in January 1960	Penalty	Delinquent on First Monday in January 1960	Total Delinquent Tax and Penalty	REMARKS
	District No.	District No.	District No.	District No.	District No.	District No.																	
	Rate	Rate	Rate	Rate	Rate	Rate																	
	Dollars	Dollars	Dollars	Dollars	Dollars	Dollars																	
1							6952	100		7130	1	Balance Paid	15516										
2	50						1174	32		1206	2	Part Paid	9157		50 00		21 30						10467
3							636	16		652	3	PAID IN FULL	15517				6 03						8310
4							6110	156		6266	4	PAID IN FULL	15248		62 66		6 52	16					8308
5							636	16		652	5	PAID IN FULL	15275				6 52						
6	Write #7603						2928	126		3054	6	PAID IN FULL	10322		29 28								20.86 Abated
7							2750	35		2820	7	Balance Paid	12733		14 20		14 00						8314
8							4022	104		4126	8	Part Paid	16916		20 63		30 63						15671 + 597 = 16268
9							636	16		652	9	PAID IN FULL	15518				6 52	16					
10							254	06		260	10	PAID IN FULL	15519				2 60	07					
11							3412	88		3500	11	PAID IN FULL	8717		35 00								10491
12							2342	60		2402	12	PAID IN FULL	8798		24 02								10492
13							636	16		652	13	PAID IN FULL	8986		6 52								
14																							
15																							
16																							
17																							
18																							
19																							
20							1174			33274													
	50						33274	884		34448					24834		8412						20.86 Abated







Cass County, Minnesota, for Taxes for the Year 1958.



SOLD FOR TAXES	VALUATIONS BY SCHOOL DISTRICTS AS EQUALIZED BY DEPARTMENT OF TAXATION						Tax including State Homestead	State Tax on Non- Homestead	SPECIAL TAXES	TOTAL TAXES		PAID	WHEN PAID	Number of Receipt	March Settlement 1959	June Settlement 1959	Penalty	November Settlement 1959	Penalty	Collections to First Monday in January 1960	Penalty	Delinquent on First Monday in January 1960	Total Delinquent Tax and Penalty	REMARKS
	District No. ....	District No. ....	District No. ....	District No. ....	District No. ....	District No. ....																		
	Rate. ....	Rate. ....	Rate. ....	Rate. ....	Rate. ....	Rate. ....																		
	.....Mills	.....Mills	.....Mills	.....Mills	.....Mills	.....Mills																		
	Dollars	Dollars	Dollars	Dollars	Dollars	Dollars	\$ cts.	\$ cts.	\$ cts.	\$ cts.		Month Day Year		\$ cts.	\$ cts.	\$ cts.	\$ cts.	\$ cts.	\$ cts.	\$ cts.	\$ cts.	\$ cts.	\$ cts.	
1				8			204	06		210	1	PAID IN FULL	MAY 24 1959											
2				8			204	06		210	2	PAID IN FULL	MAY 24 1959	14815		630								
3				8			204	06		210	3	PAID IN FULL	MAY 24 1959											
4				8			204	06		210	4	PAID IN FULL	MAY 25 1959	9269		210								
5											5													
6											6													
7											7													
8											8													
9											9													
10											10													
11											11													
12											12													
13											13													
14											14													
15											15													
16											16													
17											17													
18											18													
19											19													
20											20													
				32			816	24		840						840								



[illegible]