

ASSESSMENT & TAX LIST

Wabedo

1952

SUMMARY OF TAX COLLECTION

Original Levy	- - - - -	\$14020.96	
Additions	- - - - -	\$	
			\$14020.96
Abatements	- - - - -	\$87.84	
			\$13933.12
COLLECTIONS			
March Settlement	- - - - -	\$2113.4	
June Settlement	- - - - -	\$6940.31	
November Settlement	- - - - -	\$3542.69	
January Settlement	- - - - -	\$85.16	\$12679.50
			\$1253.62
Over Collected	- - - - -	\$18.56	
Under Collected	- - - - -	\$	
Delinquent	- - - - -	\$1272.18	\$1253.62
Total	- - - - -		\$13933.12

WABEHO PASS
 WABEHO SPRINGS
 IO#A POOL
 WABEHO'S ADDITION

Assessment Roll and Tax List of Real

Form 5CD (52)	DESCRIPTION OF PROPERTY	Sec. of Lot	Town of Block
IN WHOSE NAME ASSESSED	TO WHOM TRANSFERRED		
	SUBDIVISION		
		27	140
Lalvar Robberstad	Strip 200' wide of Lot 8 between lake and road and lying adjacent to and SW of a line parallel to and 1140' distant from SW line of Lot 1, Plat of Wabedo Pass.		
Verlaury & Robberstad	All that part of Lot 8 lying SW of a line which is parallel to and 1340' distant from SW line of Lot 1, Plat of Wabedo Pass less to Oltmann.		
Adolph E. & Effie Litzsch	A strip 874' wide of Lot 8, lying adjacent to and SW of extended line parallel to and 266' distant from SW line of Lot 1, Plat of Wabedo Pass less E. 300'		
Lloyd M. & Rose Thorburn	E. 300' of part of Lot 8		
Lloyd M. & Rose Thorburn	Strip 200' wide of Lot 8 lying between lake and road, and being parallel to and 66' from SW line of Lot 1, Plat of Wabedo Pass. 1.39 acs. Strip 100' of Lot 8 lying between road and north line of Lot 1, Plat of Wabedo Pass. 61 acs.		
Linn Castle	Strip 200' wide of Lot 8, between road and W line of Lot 8 and lying adjacent to and SW of an extended line parallel to and 1140' distant from SW line of Lot 1, Plat of Wabedo Pass.		
Harm Oltmann	Part of Lot 8		

Handwritten notes:
 Lloyd M. & Rose Thorburn & 300' of lake
 A strip 300' wide between lake & road
 N. line of Lot 8 & being parallel to & 266' from SW line of Lot 1, Plat of Wabedo Pass.
 Harm Oltmann
 Strip 200' wide of Lot 8 lying between lake and road and being parallel to and 66' from SW line of Lot 1, Plat of Wabedo Pass. 1.39 acs. Strip 100' of Lot 8 lying between road and north line of Lot 1, Plat of Wabedo Pass. 61 acs.
 Strip 200' wide of Lot 8, between road and W line of Lot 8 and lying adjacent to and SW of an extended line parallel to and 1140' distant from SW line of Lot 1, Plat of Wabedo Pass.
 Part of Lot 8

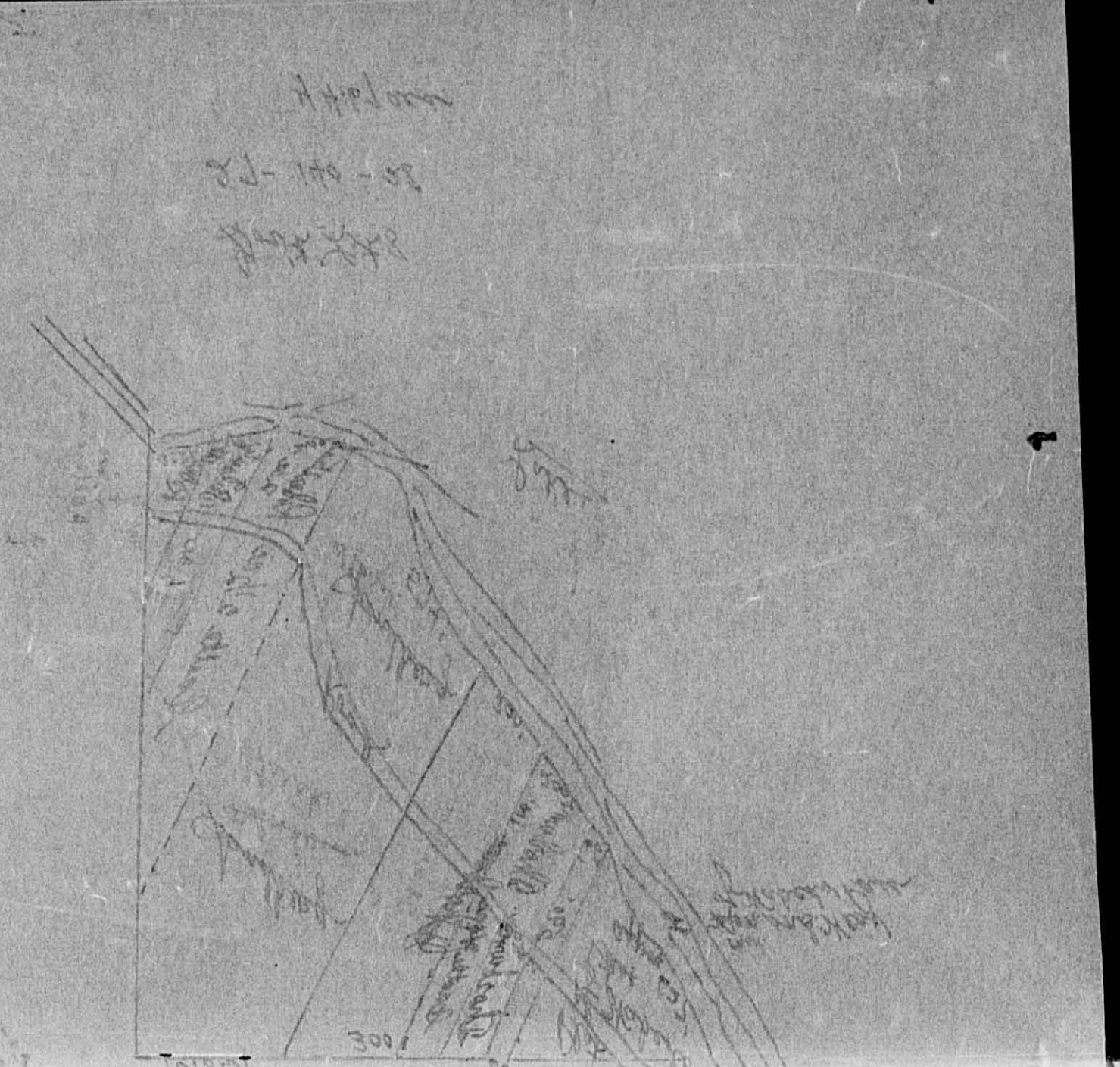

Cass County, Minnesota, for Taxes for the Year 1952.

FINAL EQUALIZED VALUE	SOLD FOR TAXES	VALUATIONS BY SCHOOL DISTRICTS AS EQUALIZED BY DEPARTMENT OF TAXATION					Tax including State Homestead	State Tax on Non-Homestead	SPECIAL TAXES	TOTAL TAXES	PAID	WHEN PAID	Number of Receipt	March Settlement 1953	June Settlement 1953	Penalty	November Settlement 1953	Penalty	Collections to First Monday in January 1954	Penalty	Delinquent on First Monday in January 1954	Total Delinquent Tax and Penalty	REMARKS
		District No.	Rate	District No.	Rate	District No.																	
Dollars		Dollars	Dollars	Dollars	Dollars	Dollars	\$ cts.	\$ cts.	\$ cts.	\$ cts.	Month Day Year		\$ cts.	\$ cts.	\$ cts.	\$ cts.	\$ cts.	\$ cts.	\$ cts.	\$ cts.	\$ cts.		
	1	10					214	02	216		1 PAID IN FULL MAY 29 1953												
	2										2												
	3										3												
	4						6454	24	6478		4 PAID IN FULL MAY 29 1953												
	5										5												
	6										6												
	7	97					2082	22	2104		7 PAID IN FULL MAY 29 1953	12193											
	8										8												
	9										9												
	10	16					344	04	348		10 PAID IN FULL JAN 14 1953	42	348										
	11										11												
	12	195					4186	44	4230		12 PAID IN FULL JAN 14 1953	42	4230										
	13										13												
	14										14												
	15										15												
	16										16												
	17 SOLD FOR TAXES	20					430	04	434		17												
	18										18												
	19										19												
	20	371					7964	84	8048		20 PAID IN FULL MAY 20 1953	5324	8048										
		709					6454	184	21858				4578	16846									
		709					21674																

THEOREM

THEOREM

THEOREM

THEOREM

THEOREM

THEOREM

THEOREM

THEOREM

THEOREM

THEOREM

THEOREM

THEOREM

371

354

371

354

371

354

371

354

371

354

371

354

709

709

709

709

709

709

709

709

709

709

709

709

709

709

709

709

709

709

709

709

709

709

709

709

709

709

709

709

709

709

709

709

709

709

709

709

709

709

709

709

709

709

709

709

709

709

709

709

709

709

709

709

709

709

709

709

709

709

709

709

709

709

709

709

709

709

709

709

709

709

709

709

709

709

709

709

709

709

709

709

709

709

709

709

709

709

709

709

709

709

709

709

709

709

709

709

709

709

709

709

709

709

709

709

709

709

709

709

709

709

709

709

709

709

709

709

709

709

709

709

709

709

709

709

709

709

709

709

709

709

709

709

709

709

709

709

709

709

709

709

709

709

709

709

709

709

709

709

709

709

709

709

709

709

709

709

709

