

ASSESSMENT & TAX LIST
Unorganized No. 5

1951

Assessment of

NAME OF OWNER

1

2

3

4

5

6

7

8

Treasurer's Office, Cass County, Minnesota

RECEIVED this, the first Monday (being the 7th day) of January, A. D. 1952, of L. C. Peterson, Auditor of said County, Minnesota, the Tax List of all Taxable Real and Personal Property in the Town of Unsig, #5 in said County for the year A. D. 1951, as specified above and amounting to _____ Dollars

Paul D. Jewell, County Treasurer, F.M.P.

Auditor's Office, Cass County, Minnesota

I, _____ Auditor of said County, and State of Minnesota, do hereby certify that the following is a correct list of the Taxes levied on the Real and Personal Property in the _____ of _____ for the year 1951. WITNESS my hand and official seal, the _____ day of _____ 1952.

(SEAL) _____ County Auditor.

Office of County Treasurer, Cass County, Minnesota

To L. C. Peterson, County Auditor

Sir:—I herewith return to you the Tax List for the Town of Unsig, #4 in said County for the year 1951, heretofore received from you. I certify that I have compared the same with the duplicate receipts in your office, and have written opposite the amount of each tax so received the words "First Quarter Paid", "Second Quarter Paid", "Third Quarter Paid" or "Paid in full" as the case may be, and the number of my receipt given in discharge of said tax, and each tract or lot of real property against which the taxes remain unpaid is delinquent for said year.

Yours respectfully, Paul D. Jewell, County Treasurer, F.M.P.

Auditor's Office, Cass County, Minnesota

I hereby certify that on the first Monday in January 1952, I received of _____ 1952, _____ County Treasurer, the Tax List of the _____ of _____ in said County for the year 1951; that I have compared the said list with the Statements received for by said Treasurer, which are on file in my office, and that each tract or lot of real property therein against which the taxes, or any part thereof, remains unpaid are delinquent for said year.

(SEAL) _____ County Auditor.

Assessment of

NAME OF OWNER

1

2

3

4

5

6

7

8

FUNDS	MARCH SETTLEMENT 1952	JUNE SETTLEMENT 1952	NOV. SETTLEMENT 1952	Amount Collected from Nov. 1st to First Monday in Jan. 1953	REDUCTIONS	Total Reductions and Collected	BALANCE UNCOLLECTED	ADDITIONS	Total Uncollected to First Monday in January, 1953
State - Non-Homestead, State - Homestead,	34708 61312	5872 12556	3194 7271	3111 506					
County Revenue, County Road and Bridge, County Welfare, County Bond and Interest,	340161 174086 555912 215152	69783 36675 113844 44060	40411 21238 65926 25515	2812 1478 4588 1776					
Town Revenue, Town Road and Bridge, Town Drag, Town State Loan,	124365	25468	14749	1026					
School Local 1 Mill, School Special, School State Loan, Deficiency Tuition Transportation Co. B+I	12437 496683 37309 559644 124366 62193	2547 91653 1640 114607 25468 12731	7475 57573 4424 66368 14749 7374	102 4020 308 4619 1027 513					
	2803918	562877	330267	25886					

	LOCAL 1 MILL	SPECIAL	STATE LOAN- Trans	Deficiency	CO.	B+I	TOTALS
MARCH SETTLEMENT							
School District No. Un A Un Na	39 12398	776 475907	116 31193	1746 557898	388 123918	194 61989	3259 1289363
Totals	12437	496683	37309	559644	124366	62193	1292622
JUNE SETTLEMENT							
School District No. Un A Un Na	511 2036	10223 31930	1533 812	25001 91606	5111 20357	2556 1178	52935 21714
Totals	2547	91653	7640	114607	25468	12731	254649
NOVEMBER SETTLEMENT							
School District No. Un A Un Na	71 1404	1421 56152	213 4211	3197 63171	711 14038	355 7069	5968 145795
Totals	1475	57573	4424	66368	14749	7374	151963
NOVEMBER to JANUARY							
School District No. Un A Un Na	04 98	87 3933	13 295	196 4423	44 983	22 491	366 10223
Totals	102	4020	308	4619	1027	513	10589
ADDITIONS							
School District No.							
Totals							
REDUCTIONS							
School District No.							
Totals							

116-27
116-28
116-29
116-30
116-31
117-28
117-29
117-30
117-31
118-28
118-29
118-30
118-31
119-28
119-29
119-30
119-31
120-28
120-29
120-30
120-31

North

Govt Lot 2 Sec-17-144-28

West

Govt Lot 2 less
200' x 200'
Section 17-144-28
The Country

East

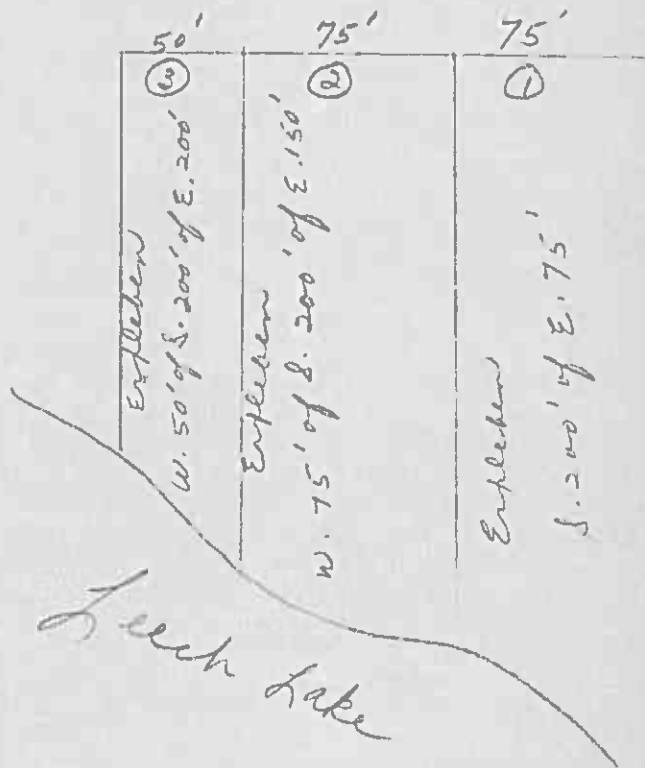

Form 500

IN WHOSE NAME ASSESSED	TO WHOM TRANSFERRED	DESCRIPTION OF PROPERTY				TRUE AND FULL VALUATIONS										FINAL EQUALIZED VALUE
		SUBDIVISION	Sec. or Lot	Town or Block	Rng.	Number of Acres of Land	Machinery Permanently Attached to Real Estate	RURAL		ALL OTHER		Machinery Permanently Attached to Real Estate	TOTAL ASSESSED VALUE	Total Assessed Value as Equalized by the Board of Review		
								LAND Exclusive of Structures and Improvements	BUILDINGS and Other Structures	Homestead Up to \$4,000	Over \$4,000 and Non-Homestead				Homestead Up to \$4,000	
							Dollars	Dollars	Dollars	Dollars	Dollars	Dollars	Dollars	Dollars	Dollars	Dollars
		NE 1/4 of NE 1/4	31	144	30											
State of Minnesota		NW 1/4 of NE 1/4														
State of Minnesota		SW 1/4 of NE 1/4														
		SE 1/4 of NE 1/4														
S. H. Guber		NE 1/4 of NW 1/4 Lot 7			40											
" "		NW 1/4 of NW 1/4 Lot 8			40											
Frank Broken		SW 1/4 of NW 1/4 Lot 11			40											
" "		SE 1/4 of NW 1/4 Lot 12			40											
		NE 1/4 of SW 1/4														
		NW 1/4 of SW 1/4														
		SW 1/4 of SW 1/4														
		SE 1/4 of SW 1/4														
State of Minnesota		NE 1/4 of SE 1/4														
State of Minnesota		NW 1/4 of SE 1/4														
		SW 1/4 of SE 1/4														
		SE 1/4 of SE 1/4														

160

SOLD FOR TAXES	VALUATIONS BY SCHOOL DISTRICTS AS EQUALIZED BY DEPARTMENT OF TALENTION						Tax including State Homestead	State Tax on Non-Homestead	SPECIAL TAXES	TOTAL TAXES	PAID	WHEN PAID	Number of Receipt	March Settlement 1952	June Settlement 1952	Penalty 1952	November Settlement 1952	Penalty 1952	Collections to First Monday in January 1953	Penalty	Delinquent on First Monday in January 1953	Total Delinquent Tax and Penalty	REMARKS	
	District No.	District No.	District No.	District No.	District No.	District No.																		
	Rate	Rate	Rate	Rate	Rate	Rate																		
SOLD FOR TAXES							1358	18	1376															
SOLD FOR TAXES							1358	18	1376															1376
SOLD FOR TAXES							810	12	822															822
SOLD FOR TAXES							810	12	822															822

Assessment Roll and Tax List of Real Property in the Town of Unarg #5

Cass County, Minnesota, for Taxes for the Year 1951.

IN WHOSE NAME ASSESSED	TO WHOM TRANSFERRED	DESCRIPTION OF PROPERTY				TRUE AND FULL VALUATIONS										FINAL EQUALIZED VALUE	
		SUBDIVISION	Sec. or Lot	Town or Block	No. of Acres of Land	LAND Exclusive of Structures and Improvements	BUILDINGS and Other Structures	MACHINERY Permanently Attached to Real Estate	TOTAL True and Full Value	RURAL		ALL OTHER		MACHINERY Permanently Attached to Real Estate	TOTAL ASSESSED VALUE		Total Assessed Value as Equalized by the Board of Review
										Homestead Up to \$4,000 20%	Over \$4,000 and Non-Homestead 33 1/3%	Homestead Up to \$4,000 25%	Over \$4,000 and Non-Homestead 40%				
State of Minnesota		NW 1/4 of NW 1/4	Lot 1	6 145-26													
		NW 1/4 of NW 1/4															
		SW 1/4 of NW 1/4															
		SE 1/4 of NW 1/4															
State of Minnesota		NW 1/4 of NW 1/4	31	145-26													
State of Minnesota		NW 1/4 of NW 1/4	Lot 1														
State of Minnesota		SW 1/4 of NW 1/4	Lot 2														
		SE 1/4 of NW 1/4															
State of Minnesota		NE 1/4 of SW 1/4															
State of Minnesota		NW 1/4 of SW 1/4	Lot 3														
State of Minnesota		SW 1/4 of SW 1/4	Lot 4														
		SE 1/4 of SW 1/4															
		NE 1/4 of SE 1/4															
		NW 1/4 of SE 1/4															
		SW 1/4 of SE 1/4															
		SE 1/4 of SE 1/4															

SOLD FOR TAXES	VALUATIONS BY SCHOOL DISTRICTS AS EQUALIZED BY DEPARTMENT OF TAXATION						Tax including State Homestead	State Tax on Non-Homestead	SPECIAL TAXES	TOTAL TAXES	PAID	WHEN PAID	Number of Receipts	March Settlement 1952	June Settlement 1952	November Settlement 1952	Penalty	Collections to First Monday in January 1953	Penalty	Delinquent on First Monday in January 1953	Total Delinquent Tax and Penalty	REMARKS
	District No.	District No.	District No.	District No.	District No.	District No.																
	Rate	Rate	Rate	Rate	Rate	Rate																
1																						
2																						
3																						
4																						
5																						
6																						
7																						
8																						
9																						
10																						
11																						
12																						
13																						
14																						
15																						
16																						
17																						
18																						
19																						
20																						

146-27
146-29
LAKEVIEW RESORT
145-28
145-30
145-27
TOWN'S SUBDIVISION

