

Assessment & Tax List - 1959

Trelipe

Assessment o

Form 335, MILLER-DAY COMPANY, MINNEAPOLIS

COLLECTIONS OF TAXES OF 1959, *Town of Maple* OF *Maple*, CASS COUNTY, MINNESOTA

| NAME OF OWNER | FUNDS | MARCH SETTLEMENT | JUNE SETTLEMENT | NOV. SETTLEMENT | Amount Collected from Nov. 1954 to First Monday in Jan. 1955 | REDUCTIONS | Total Reductions and Collected | BALANCE UNCOLLECTED | ADDITIONS | Total Uncollected to First Monday in January, 1955 |
|---------------|---------------------------|------------------|-----------------|-----------------|--|------------|--------------------------------|---------------------|-----------|--|
| | | 1959 | 1959 | 1959 | | | | | | |
| | State-Non-Homestead, | 17 05 | 76 53 | 19 54 | 176 | | | | | |
| | State-Homestead, | 23 11 | 107 34 | 38 18 | 390 | | | | | |
| | County Revenue, | 158 44 | 478 43 | 170 39 | 1722 | | | | | |
| | County Road and Bridge, | 66 61 | 201 13 | 71 64 | 724 | | | | | |
| | County Welfare, | 275 10 | 830 68 | 295 85 | 2989 | | | | | |
| | County Bond and Interest, | | | | | | | | | |
| | Rd. & B. Fed. Prog. | 22 20 | 67 04 | 23 88 | 241 | | | | | |
| | PERA | 35 71 | 77 64 | 27 65 | 279 | | | | | |
| | Co. Nurse | 8 88 | 26 82 | 9 55 | 96 | | | | | |
| | Town Revenue, | 44 41 | 134 09 | 47 76 | 483 | | | | | |
| | Town Road and Bridge, | 66 61 | 201 13 | 71 63 | 725 | | | | | |
| | Town Drag, | | | | | | | | | |
| | Town State Loan, | | | | | | | | | |
| | Phone | 44 41 | 134 09 | 47 76 | 482 | | | | | |
| | School Local 1 Mill, | | | | | | | | | |
| | School Special, | 170 23 | 360 17 | 136 23 | 1116 | | | | | |
| | School State Loan, | | | | | | | | | |
| | Deficiency | 486 53 | 1469 08 | 533 22 | 5287 | | | | | |
| | Tuition | | | | | | | | | |
| | Transportation | | | | | | | | | |
| | C.O. | 56 31 | 170 03 | 60 55 | 611 | | | | | |
| | PERA | 17 59 | 53 10 | 18 91 | 191 | | | | | |
| | R. & B. Bldg. | 8 88 | 26 82 | 9 55 | 96 | | | | | |
| | Agri. Assn | 2 22 | 6 70 | 2 39 | 24 | | | | | |
| | Plans. | 4 97 | 15 01 | 5 35 | 54 | | | | | |
| | | 1499 26 | 4435 83 | 1580 03 | 15686 | | | | | |

| | School District No. | LOCAL 1 MILL | SPECIAL | STATE LOAN | Deficiency | C.O. | PERA | TOTALS |
|---------------------|---------------------|--------------|---------|------------|------------|--------|-------|---------|
| | | | | | | | | |
| MARCH SETTLEMENT | | | 7 40 | | 40 54 | 4 69 | 1 47 | 54 10 |
| | <i>una</i> | | 162 83 | | 445 99 | 51 62 | 16 12 | 676 56 |
| | <i>una</i> | | | | | | | |
| | Totals | | 170 23 | | 486 53 | 56 31 | 17 59 | 730 66 |
| JUNE SETTLEMENT | | | 176 18 | | 965 12 | 111 70 | 34 88 | 1287 88 |
| | <i>una</i> | | 183 99 | | 503 96 | 58 33 | 18 22 | 764 50 |
| | <i>una</i> | | | | | | | |
| | Totals | | 360 17 | | 1469 08 | 170 03 | 53 10 | 2052 38 |
| NOVEMBER SETTLEMENT | | | 54 81 | | 300 21 | 34 74 | 10 85 | 400 61 |
| | <i>una</i> | | 81 42 | | 223 01 | 25 81 | 8 06 | 338 30 |
| | <i>una</i> | | | | | | | |
| | Totals | | 136 23 | | 523 22 | 60 55 | 18 91 | 738 91 |
| NOVEMBER to JANUARY | | | 8 12 | | 44 54 | 5 15 | 1 61 | 59 42 |
| | <i>una</i> | | 30 4 | | 8 33 | 9 6 | 3 0 | 12 63 |
| | <i>una</i> | | | | | | | |
| | Totals | | 11 16 | | 52 87 | 6 11 | 1 91 | 72 05 |
| ADDITIONS | School District No. | | | | | | | |
| | Totals | | | | | | | |
| REDUCTIONS | School District No. | | | | | | | |
| | Totals | | | | | | | |

139-2
110-27
Shores
Wood Shores
Brookman's Linden Beach
L.A. 690

Assessment Roll and Tax List of Real Property in the Town of Inalpa

Form 500 MILLER-DAVIS CO., MINNEAPOLIS

Indicate Type of Property: R-Residential, C-Commercial, I-Industrial, U-Utility, F-Farm, L-Lakeshore, T-Timber, M-Mineral

Table with columns: IN WHOSE NAME ASSESSED, TO WHOM TRANSFERRED, DESCRIPTION OF PROPERTY, TRUE AND FULL VALUATIONS, ASSESSED VALUATIONS, and FINAL EQUALIZED VALUE.

Cass County, Minnesota, for Taxes for the Year 1959.

Table with columns: VALUATIONS BY SCHOOL DISTRICTS AS EQUALIZED BY DEPARTMENT OF TAXATION, TAX INCLUDING STATE HOMESTEAD, SPECIAL TAXES, TOTAL TAXES, PAID, WHEN PAID, Number of Receipt, March Settlement, June Settlement, Penalty, November Settlement, Penalty, Collections to First Monday in January, Delinquent on First Monday in January, Total Delinquent Tax and Penalty, and REMARKS.

110-27

Shores

Wood Shores

Brookman's Linden Beach

LaSalle

Assessment Roll and Tax List of Real Property in the Iowa of Jelipe

Form SCD MILLER-DAVIS CO., MINNEAPOLIS

Indicate Type of Property: R-Residential, C-Commercial, I-Industrial, U-Utility, F-Farm, L-Lakeshore, T-Timber, M-Mineral

| IN WHOSE NAME ASSESSED | TO WHOM TRANSFERRED | DESCRIPTION OF PROPERTY | | | | TRUE AND FULL VALUATIONS | | | | | | | | | | | FINAL EQUALIZED VALUE | | |
|------------------------------|---------------------|-------------------------|-----------------------------|---------------|----------------------|--------------------------|------------------------------|---------------------------------|---------------------------|---|--------------------------------|---|---------------------------|-----------------------------|--|---|-----------------------|----------------------|--|
| | | SUBDIVISION | Sec. of Lot | Town or Block | No. of Acres of Land | No. School District | Indicate Homestead Yes or No | Indicate Agricultural Yes or No | Indicate Type of Property | RURAL | | | ALL OTHER | | | MACHINERY Permanently Attached to Real Estate | | TOTAL ASSESSED VALUE | Total Assessed Value as Equalized by the Board of Review |
| | | | | | | | | | | LAND Exclusive of Structures and Improvements | BUILDINGS and Other Structures | MACHINERY Permanently Attached to Real Estate | TOTAL True and Full Value | Homestead Up to \$4,000 20% | Over \$4,000 and Non-Homestead 33 1/3% | | | | |
| State of Minnesota | | 1 | NEW of NEW | 12 139 27 | | | | | | | | | | | | | | | |
| State of Minnesota | | 2 | 8 1/2 of NW 1/4 of NE 1/4 | | | | | | | | | | | | | | | | |
| State of Minnesota | | 3 | SW 1/4 of NE 1/4 | | | | | | | | | | | | | | | | |
| State of Minnesota | | 4 | SE 1/4 of NE 1/4 | | | | | | | | | | | | | | | | |
| Edward H. & Angeline Tekautz | | 5 | 7 1/2 of NW 1/4 of 77 6 1/4 | 20 | | | | | | | | | | | | | | | |
| State of Minnesota | | 6 | NE 1/4 of NW 1/4 | | | | | | | | | | | | | | | | |
| Ewald B. Nelson | | 7 | NW 1/4 of NW 1/4 | 40 | | | | | | | | | | | | | | | |
| " " | | 8 | SW 1/4 of NW 1/4 | 40 | | | | | | | | | | | | | | | |
| State of Minnesota | | 9 | SE 1/4 of NW 1/4 | | | | | | | | | | | | | | | | |
| State of Minnesota | | 10 | | | | | | | | | | | | | | | | | |
| State of Minnesota | | 11 | NE 1/4 of SW 1/4 | | | | | | | | | | | | | | | | |
| State of Minnesota | | 12 | NW 1/4 of SW 1/4 | | | | | | | | | | | | | | | | |
| State of Minnesota | | 13 | SW 1/4 of SW 1/4 | | | | | | | | | | | | | | | | |
| Glacier Park Hotel Co. | | 14 | SE 1/4 of SW 1/4 | 40 | | | | | | | | | | | | | | | |
| State of Minnesota | | 15 | | | | | | | | | | | | | | | | | |
| State of Minnesota | | 16 | NE 1/4 of SE 1/4 | | | | | | | | | | | | | | | | |
| State of Minnesota | | 17 | NW 1/4 of SE 1/4 | | | | | | | | | | | | | | | | |
| Moneta Improvement Co. | | 18 | SW 1/4 of SE 1/4 | 40 | | | | | | | | | | | | | | | |
| State of Minnesota | | 19 | SE 1/4 of SE 1/4 | | | | | | | | | | | | | | | | |
| | | 20 | | 180 | | | | | | | | | | | | | | | |

Cass County, Minnesota, for Taxes for the Year 1959.

| SOLD FOR TAXES | VALUATIONS BY SCHOOL DISTRICTS AS EQUALIZED BY DEPARTMENT OF TAXATION | | | | | | Tax including State Homestead | State Tax on Non-Homestead | SPECIAL TAXES | TOTAL TAXES | PAID | WHEN PAID | Number of Receipt | March Settlement 1960 | June Settlement 1960 | Penalty 1960 | November Settlement 1960 | Penalty 1960 | Collections to First Monday in January 1961 | Penalty 1961 | Delinquent on First Monday in January 1961 | Total Delinquent Tax and Penalty | REMARKS |
|----------------|---|--------------|--------------|--------------|--------------|--------------|-------------------------------|----------------------------|---------------|-------------|------|-----------|-------------------|-----------------------|----------------------|--------------|--------------------------|--------------|---|--------------|--|----------------------------------|---------|
| | District No. | District No. | District No. | District No. | District No. | District No. | | | | | | | | | | | | | | | | | |
| | Rate | Rate | Rate | Rate | Rate | Rate | | | | | | | | | | | | | | | | | |
| | 1 | | | | | | | | | | | | | | | | | | | | | | |
| | 2 | | | | | | | | | | | | | | | | | | | | | | |
| | 3 | | | | | | | | | | | | | | | | | | | | | | |
| | 4 | | | | | | | | | | | | | | | | | | | | | | |
| 5 | | | | | | | | 28 | 892 | 18 | 910 | | | | | | | | | | 910 | | |
| 6 | | | | | | | | | | | | | | | | | | | | | | | |
| 7 | | | | | | | | 32 | 1018 | | 1018 | | | | | | | | | | | 10525 | |
| 8 | | | | | | | | 32 | 1018 | | 1018 | | | | | | | | | | | | |
| 9 | | | | | | | | | | | | | | | | | | | | | | | |
| 10 | | | | | | | | | | | | | | | | | | | | | | | |
| 11 | | | | | | | | | | | | | | | | | | | | | | | |
| 12 | | | | | | | | | | | | | | | | | | | | | | | |
| 13 | | | | | | | | | | | | | | | | | | | | | | | |
| 14 | | | | | | | | 66 | 2100 | 42 | 2142 | | | | | | | | | | | 10515 | |
| 15 | | | | | | | | | | | | | | | | | | | | | | | |
| 16 | | | | | | | | | | | | | | | | | | | | | | | |
| 17 | | | | | | | | | | | | | | | | | | | | | | | |
| 18 | | | | | | | | 66 | 2102 | 40 | 2142 | | | | | | | | | | | 10525 | |
| 19 | | | | | | | | | | | | | | | | | | | | | | | |
| 20 | | | | | | | | 64 | 7130 | 100 | 7230 | | | | | | | | | | | 910 | |

110-27

Shores

Wood Shores

Brookman's Linden Beach

Lakewood

Assessment Roll and Tax List of Real Property in the Town of Isabella, Cass County, Minnesota, for Taxes for the Year 1959.

Form 300 WILLIAM DAVID COMPANY, MINNEAPOLIS * Indicate Type of Property: R-Residential, C-Commercial, I-Industrial, U-Utility, F-Farm, L-Lakeshore, T-Timber, M-Mineral

Table with columns: IN WHOSE NAME ASSESSED, TO WHOM TRANSFERRED, DESCRIPTION OF PROPERTY, TRUE AND FULL VALUATIONS, ASSESSED VALUATIONS, and FINAL EQUALIZED VALUE.

Cass County, Minnesota, for Taxes for the Year 1959.

Table with columns: VALUATIONS BY SCHOOL DISTRICTS AS EQUALIZED BY DEPARTMENT OF TAXATION, TAXES, PAID, WHEN PAID, Number of Receipt, March Settlement, June Settlement, November Settlement, Collections to First Monday in January 1961, Delinquent on First Monday in January 1961, Total Delinquent Tax and Penalty, and REMARKS.

139-27

140-27

Shores

Mr. Wood Shores

Brookman's Linden Beach

Linden Beach

Assessment Roll and Tax List of Real Property in the Town of Lehigh,
* Indicate Type of Property: R-Residential, C-Commercial, I-Industrial, U-Utility, F-Farm, L-Lakeshore, T-Timber, M-Mineral

Form SCD 11-15-59

| IN WHOSE NAME ASSESSED | TO WHOM TRANSFERRED | DESCRIPTION OF PROPERTY | | | | No. School District | Indicate Homestead Yes or No | Indicate Agricultural Yes or No | Indicate Type of Property | TRUE AND FULL VALUATIONS | | | ASSESSED VALUATIONS | | | | | | FINAL EQUALIZED VALUE | |
|------------------------|---------------------|-------------------------|------------------|---------------|------|---------------------|------------------------------|---------------------------------|---------------------------|--------------------------|---------------------------|-------------------------|--------------------------------|--------------------------|-------------------------|--------------------------------|---|----------------------|-----------------------|--|
| | | SUBDIVISION | Sec. or Lot | Town or Block | Rag. | | | | | Number of Acres of Land | TOTAL True and Full Value | RURAL | | ALL OTHER | | | MACHINERY Permanently Attached to Real Estate | TOTAL ASSESSED VALUE | | Total Assessed Value as Equalized by the Board of Review |
| | | | | | | | | | | | | Homestead Up to \$4,000 | Over \$4,000 and Non-Homestead | Timber Land Class 3e 20% | Homestead Up to \$1,000 | Over \$1,000 and Non-Homestead | | | | |
| | | | | | | | | | | | | 20% | 33 1/3% | 20% | 25% | 40% | | | | |
| Dollars | | | | | | | | | Dollars | Dollars | Dollars | Dollars | Dollars | Dollars | Dollars | Dollars | | | | |
| State of Minnesota | | 1 | NEW of NEW | 18 | 139 | 27 | | | | | | | | | | | | | | |
| State of Minnesota | | 2 | NW 1/4 of NEW | | | | | | | | | | | | | | | | | |
| State of Minnesota | | 3 | SW 1/4 of NEW | | | | | | | | | | | | | | | | | |
| State of Minnesota | | 4 | SE 1/4 of NEW | | | | | | | | | | | | | | | | | |
| | | 5 | | | | | | | | | | | | | | | | | | |
| State of Minnesota | | 6 | NE 1/4 of NW 1/4 | | | | | | | | | | | | | | | | | |
| State of Minnesota | | 7 | NW 1/4 of NW 1/4 | | | | | | | | | | | | | | | | | |
| State of Minnesota | | 8 | SW 1/4 of NW 1/4 | | | | | | | | | | | | | | | | | |
| State of Minnesota | | 9 | SE 1/4 of NW 1/4 | | | | | | | | | | | | | | | | | |
| | | 10 | | | | | | | | | | | | | | | | | | |
| State of Minnesota | | 11 | NE 1/4 of SW 1/4 | | | | | | | | | | | | | | | | | |
| State of Minnesota | | 12 | NW 1/4 of SW 1/4 | | | | | | | | | | | | | | | | | |
| State of Minnesota | | 13 | SW 1/4 of SW 1/4 | | | | | | | | | | | | | | | | | |
| State of Minnesota | | 14 | SE 1/4 of SW 1/4 | | | | | | | | | | | | | | | | | |
| | | 15 | | | | | | | | | | | | | | | | | | |
| State of Minnesota | | 16 | NE 1/4 of SE 1/4 | | | | | | | | | | | | | | | | | |
| State of Minnesota | | 17 | NW 1/4 of SE 1/4 | | | | | | | | | | | | | | | | | |
| State of Minnesota | | 18 | SW 1/4 of SE 1/4 | | | | | | | | | | | | | | | | | |
| State of Minnesota | | 19 | SE 1/4 of SE 1/4 | | | | | | | | | | | | | | | | | |
| | | 20 | | | | | | | | | | | | | | | | | | |

Cass County, Minnesota, for Taxes for the Year 1959.

| SOLD FOR TAXES | VALUATIONS BY SCHOOL DISTRICTS AS EQUALIZED BY DEPARTMENT OF TAXATION | | | | | | Tax Including State Homestead | State Tax on Non-Homestead | SPECIAL TAXES | TOTAL TAXES | PAID | WHEN PAID | Number of Receipt | March Settlement 1960 | June Settlement 1960 | Penalty | November Settlement 1960 | Penalty | Collections to First Monday in January 1961 | Penalty | Delinquent on First Monday in January 1961 | Total Delinquent Tax and Penalty | REMARKS |
|----------------|---|--------------|--------------|--------------|--------------|--------------|-------------------------------|----------------------------|---------------|-------------|----------------|-----------|-------------------|-----------------------|----------------------|---------|--------------------------|---------|---|---------|--|----------------------------------|---------|
| | District No. | District No. | District No. | District No. | District No. | District No. | | | | | | | | | | | | | | | | | |
| | Rate | Rate | Rate | Rate | Rate | Rate | | | | | | | | | | | | | | | | | |
| | Mills | Mills | Mills | Mills | Mills | Mills | | | | | | | | | | | | | | | | | |
| | Dollars | Dollars | Dollars | Dollars | Dollars | Dollars | \$ cts | \$ cts | \$ cts | \$ cts | Month Day Year | | \$ cts | \$ cts | \$ cts | \$ cts | \$ cts | \$ cts | \$ cts | \$ cts | \$ cts | | |
| 1 | | | | | | | | | | | | | | | | | | | | | | | |
| 2 | | | | | | | | | | | | | | | | | | | | | | | |
| 3 | | | | | | | | | | | | | | | | | | | | | | | |
| 4 | | | | | | | | | | | | | | | | | | | | | | | |
| 5 | | | | | | | | | | | | | | | | | | | | | | | |
| 6 | | | | | | | | | | | | | | | | | | | | | | | |
| 7 | | | | | | | | | | | | | | | | | | | | | | | |
| 8 | | | | | | | | | | | | | | | | | | | | | | | |
| 9 | | | | | | | | | | | | | | | | | | | | | | | |
| 10 | | | | | | | | | | | | | | | | | | | | | | | |
| 11 | | | | | | | | | | | | | | | | | | | | | | | |
| 12 | | | | | | | | | | | | | | | | | | | | | | | |
| 13 | | | | | | | | | | | | | | | | | | | | | | | |
| 14 | | | | | | | | | | | | | | | | | | | | | | | |
| 15 | | | | | | | | | | | | | | | | | | | | | | | |
| 16 | | | | | | | | | | | | | | | | | | | | | | | |
| 17 | | | | | | | | | | | | | | | | | | | | | | | |
| 18 | | | | | | | | | | | | | | | | | | | | | | | |
| 19 | | | | | | | | | | | | | | | | | | | | | | | |
| 20 | | | | | | | | | | | | | | | | | | | | | | | |

110-27

Shores

Shores

Shores

Shores

Assessment Roll and Tax List of Real Property in the Town of Inelipe

Form SCD WALL-BATE COMPANY, CHICAGO * Indicate Type of Property: R-Residential, C-Commercial, I-Industrial, U-Utility, F-Farm, L-Lakeshore, T-Timber, M-Mineral

| IN WHOSE NAME ASSESSED | TO WHOM TRANSFERRED | DESCRIPTION OF PROPERTY | ACRES | | TRUE AND FULL VALUATIONS | | | ASSESSED VALUATIONS | | | | | | | | | FINAL EQUALIZED VALUE | | | | | |
|------------------------|---------------------|-------------------------|-------|--------|---|--------------------------------|---|---------------------------|-----------------------------|--|--------------------------|-----------------------------|------------------------------------|---------|---|----------------------|-----------------------|--|--|--|--|--|
| | | | Acres | 100ths | LAND Exclusive of Structures and Improvements | BUILDINGS and Other Structures | MACHINERY Permanently Attached to Real Estate | TOTAL True and Full Value | RURAL | | ALL OTHER | | | | MACHINERY Permanently Attached to Real Estate | TOTAL ASSESSED VALUE | | Total Assessed Value as Equalized by the Board of Review | | | | |
| | | | | | | | | | Homestead Up to \$1,000 20% | Over \$4,000 and Non-Homestead 33 1/8% | Timber Land Class 3e 20% | Homestead Up to \$4,000 25% | Over \$4,000 and Non-Homestead 40% | 33 1/8% | | | | | | | | |
| State of Minnesota | | 1 NE 1/4 of NE 1/4 | 28 | 139 | | | | | | | | | | | | | | | | | | |
| State of Minnesota | | 2 NW 1/4 of NE 1/4 | | | | | | | | | | | | | | | | | | | | |
| State of Minnesota | | 3 SW 1/4 of NE 1/4 | | | | | | | | | | | | | | | | | | | | |
| State of Minnesota | | 4 SE 1/4 of NE 1/4 | | | | | | | | | | | | | | | | | | | | |
| | | 5 | | | | | | | | | | | | | | | | | | | | |
| State of Minnesota | | 6 NE 1/4 of NW 1/4 | | | | | | | | | | | | | | | | | | | | |
| State of Minnesota | | 7 NW 1/4 of NW 1/4 | | | | | | | | | | | | | | | | | | | | |
| State of Minnesota | | 8 SW 1/4 of NW 1/4 | | | | | | | | | | | | | | | | | | | | |
| State of Minnesota | | 9 SE 1/4 of NW 1/4 | | | | | | | | | | | | | | | | | | | | |
| | | 10 | | | | | | | | | | | | | | | | | | | | |
| State of Minnesota | | 11 NE 1/4 of SW 1/4 | | | | | | | | | | | | | | | | | | | | |
| State of Minnesota | | 12 NW 1/4 of SW 1/4 | | | | | | | | | | | | | | | | | | | | |
| State of Minnesota | | 13 SW 1/4 of SW 1/4 | | | | | | | | | | | | | | | | | | | | |
| State of Minnesota | | 14 SE 1/4 of SW 1/4 | | | | | | | | | | | | | | | | | | | | |
| | | 15 | | | | | | | | | | | | | | | | | | | | |
| State of Minnesota | | 16 NE 1/4 of SE 1/4 | | | | | | | | | | | | | | | | | | | | |
| State of Minnesota | | 17 NW 1/4 of SE 1/4 | | | | | | | | | | | | | | | | | | | | |
| State of Minnesota | | 18 SW 1/4 of SE 1/4 | | | | | | | | | | | | | | | | | | | | |
| State of Minnesota | | 19 SE 1/4 of SE 1/4 | | | | | | | | | | | | | | | | | | | | |
| | | 20 | | | | | | | | | | | | | | | | | | | | |

Cass County, Minnesota, for Taxes for the Year 1959.

| SOLD FOR TAXES | VALUATIONS BY SCHOOL DISTRICTS AS EQUALIZED BY DEPARTMENT OF TAXATION | | | | | | Tax including State Homestead | State Tax on Non-Homestead | SPECIAL TAXES | TOTAL TAXES | PAID | WHEN PAID | Number of Receipt | March Settlement 1960 | June Settlement 1960 | November Settlement 1960 | Penalty | Collections to First Monday in January 1961 | Penalty | Delinquent on First Monday in January 1961 | Total Delinquent Tax and Penalty | REMARKS | |
|----------------|---|--------------|--------------|--------------|--------------|--------------|-------------------------------|----------------------------|---------------|-------------|------|-----------|-------------------|-----------------------|----------------------|--------------------------|---------|---|---------|--|----------------------------------|---------|--|
| | District No. | District No. | District No. | District No. | District No. | District No. | | | | | | | | | | | | | | | | | |
| | Rate | Rate | Rate | Rate | Rate | Rate | | | | | | | | | | | | | | | | | |
| 1 | | | | | | | | | | | | | | | | | | | | | | | |
| 2 | | | | | | | | | | | | | | | | | | | | | | | |
| 3 | | | | | | | | | | | | | | | | | | | | | | | |
| 4 | | | | | | | | | | | | | | | | | | | | | | | |
| 5 | | | | | | | | | | | | | | | | | | | | | | | |
| 6 | | | | | | | | | | | | | | | | | | | | | | | |
| 7 | | | | | | | | | | | | | | | | | | | | | | | |
| 8 | | | | | | | | | | | | | | | | | | | | | | | |
| 9 | | | | | | | | | | | | | | | | | | | | | | | |
| 10 | | | | | | | | | | | | | | | | | | | | | | | |
| 11 | | | | | | | | | | | | | | | | | | | | | | | |
| 12 | | | | | | | | | | | | | | | | | | | | | | | |
| 13 | | | | | | | | | | | | | | | | | | | | | | | |
| 14 | | | | | | | | | | | | | | | | | | | | | | | |
| 15 | | | | | | | | | | | | | | | | | | | | | | | |
| 16 | | | | | | | | | | | | | | | | | | | | | | | |
| 17 | | | | | | | | | | | | | | | | | | | | | | | |
| 18 | | | | | | | | | | | | | | | | | | | | | | | |
| 19 | | | | | | | | | | | | | | | | | | | | | | | |
| 20 | | | | | | | | | | | | | | | | | | | | | | | |

110-27
River Shores
Birdwood Shores
Brookman's Linden Beach
Lagwood St.

Assessment Roll and Tax List of Real Property in the Town of Isabella

Form 507 (11-15-54) RENTALS, MINNAPOLIS

Indicate Type of Property: R-Residential, C-Commercial, I-Industrial, U-Utility, F-Farm, L-Lakeshore, T-Timber, M-Mineral

| IN WHOSE NAME ASSESSED | TO WHOM TRANSFERRED | DESCRIPTION OF PROPERTY | | | | No. School District | Indicate Homestead Yes or No | Indicate Agricultural Property Yes or No | TRUE AND FULL VALUATIONS | | | | | | | | | | | | FINAL EQUALIZED VALUE | | | | | | | | | | | | | | | | |
|------------------------|---------------------|-------------------------|------------------|---------------|----------------------|---------------------|------------------------------|--|---|--------------------------------|---|---------------------------|-------|--|-----------|--|---------------|----------------------|--|--------------------------------|-----------------------|-------------------------------------|--|--|--|--|--|--|--|--|--|--|--|--|--|--|--|
| | | SUBDIVISION | Sec. or Lot | Town or Block | No. of Acres of Land | | | | ASSESSED VALUATIONS | | | | | | MACHINERY | | | TOTAL ASSESSED VALUE | Total Assessed Value as Equalized by the Board of Review | | | | | | | | | | | | | | | | | | |
| | | | | | | | | | LAND Exclusive of Structures and Improvements | BUILDINGS and Other Structures | MACHINERY Permanently Attached to Real Estate | TOTAL True and Full Value | RURAL | | ALL OTHER | | Up to \$1,000 | | | Over \$1,000 and Non-Homestead | | Permanently Attached to Real Estate | | | | | | | | | | | | | | | |
| State of Minnesota | | 1 | NE 1/4 of NE 1/4 | 29 | 139 | 27 | | | | | | | | | | | | | | | | | | | | | | | | | | | | | | | |

Cass County, Minnesota, for Taxes for the Year 1959.

| SOLD FOR TAXES | VALUATIONS BY SCHOOL DISTRICTS AS EQUALIZED BY DEPARTMENT OF TAXATION | | | | | | Tax including State Homestead | State Tax on Non-Homestead | SPECIAL TAXES | TOTAL TAXES | PAID | WHEN PAID | Number of Receipt | March Settlement 1960 | June Settlement 1960 | Penalty 1960 | November Settlement 1960 | Penalty | Collections to First Monday in January 1961 | Penalty | Delinquent on First Monday in January 1961 | Total Delinquent Tax and Penalty | REMARKS | |
|----------------|---|--------------|--------------|--------------|--------------|--------------|-------------------------------|----------------------------|---------------|-------------|------|-----------|-------------------|-----------------------|----------------------|--------------|--------------------------|---------|---|---------|--|----------------------------------|---------|--|
| | District No. | District No. | District No. | District No. | District No. | District No. | | | | | | | | | | | | | | | | | | |
| | Rate | Rate | Rate | Rate | Rate | Rate | | | | | | | | | | | | | | | | | | |
| | Mills | Mills | Mills | Mills | Mills | Mills | | | | | | | | | | | | | | | | | | |
| 1 | | | | | | | | | | | | | | | | | | | | | | | | |
| 2 | | | | | | | | | | | | | | | | | | | | | | | | |
| 3 | | | | | | | | | | | | | | | | | | | | | | | | |
| 4 | | | | | | | | | | | | | | | | | | | | | | | | |
| 5 | | | | | | | | | | | | | | | | | | | | | | | | |
| 6 | | | | | | | | | | | | | | | | | | | | | | | | |
| 7 | | | | | | | | | | | | | | | | | | | | | | | | |
| 8 | | | | | | | | | | | | | | | | | | | | | | | | |
| 9 | | | | | | | | | | | | | | | | | | | | | | | | |
| 10 | | | | | | | | | | | | | | | | | | | | | | | | |
| 11 | | | | | | | | | | | | | | | | | | | | | | | | |
| 12 | | | | | | | | | | | | | | | | | | | | | | | | |
| 13 | | | | | | | | | | | | | | | | | | | | | | | | |
| 14 | | | | | | | | | | | | | | | | | | | | | | | | |
| 15 | | | | | | | | | | | | | | | | | | | | | | | | |
| 16 | | | | | | | | | | | | | | | | | | | | | | | | |
| 17 | | | | | | | | | | | | | | | | | | | | | | | | |
| 18 | | | | | | | | | | | | | | | | | | | | | | | | |
| 19 | | | | | | | | | | | | | | | | | | | | | | | | |
| 20 | | | | | | | | | | | | | | | | | | | | | | | | |

110-27

Mer Shores

Birdwood Shores

Brookman's Linden Beach

Lagwood St.

Assessment Roll and Tax List of Real Property in the Town of Inelaps

Form SCD

* Indicate Type of Property: R-Residential, C-Commercial, I-Industrial, U-Utility, F-Farm, L-Lakeshore, T-Timber, M-Mineral

| IN WHOSE NAME ASSESSED | TO WHOM TRANSFERRED | DESCRIPTION OF PROPERTY | | | | No. School District | Indicate Homestead Tax or No | Indicate Agricultural Property or No | TRUE AND FULL VALUATIONS | | | | | | | | | | | FINAL EQUALIZED VALUE | | | |
|------------------------|---------------------|-------------------------|------------------|---------------|---------|---------------------|------------------------------|--------------------------------------|--------------------------|---|--------------------------------|---|---------------------------|-----------------------------|--|---------------------------|-----------------------------|------------------------------------|---------|-----------------------|---|----------------------|--|
| | | SUBDIVISION | Sec. or Lot | Town or Block | Reg. | | | | Number of Acres of Land | ASSESSED VALUATIONS | | | | | | | | | | | | | |
| | | | | | | | | | | LAND Exclusive of Structures and Improvements | BUILDINGS and Other Structures | MACHINERY Permanently Attached to Real Estate | TOTAL True and Full Value | RURAL | | | ALL OTHER | | | | MACHINERY Permanently Attached to Real Estate | TOTAL ASSESSED VALUE | Total Assessed Value as Equalized by the Board of Review |
| | | | | | | | | | | | | | | Homestead Up to \$4,000 20% | Over \$4,000 and Non-Homestead 33 1/3% | Timber Land Class. 3e 20% | Homestead Up to \$4,000 25% | Over \$4,000 and Non-Homestead 40% | 33 1/3% | | | | |
| Dollars | Dollars | Dollars | Dollars | Dollars | Dollars | Dollars | Dollars | Dollars | Dollars | Dollars | Dollars | Dollars | Dollars | Dollars | | | | | | | | | |
| State of Minnesota | | 1 | NEW of NEW | 30 | 139 | 27 | Un | | | | | | | | | | | | | | | | |
| State of Minnesota | | 2 | NW 1/4 of NEW | | | | | | | | | | | | | | | | | | | | |
| State of Minnesota | | 3 | SW 1/4 of NEW | | | | | | | | | | | | | | | | | | | | |
| State of Minnesota | | 4 | SE 1/4 of NEW | | | | | | | | | | | | | | | | | | | | |
| | | 5 | | | | | | | | | | | | | | | | | | | | | |
| State of Minnesota | | 6 | NEW of NW 1/4 | | | | | | | | | | | | | | | | | | | | |
| State of Minnesota | | 7 | NW 1/4 of NW 1/4 | | | | | | | | | | | | | | | | | | | | |
| State of Minnesota | | 8 | SW 1/4 of NW 1/4 | | | | | | | | | | | | | | | | | | | | |
| State of Minnesota | | 9 | SE 1/4 of NW 1/4 | | | | | | | | | | | | | | | | | | | | |
| | | 10 | | | | | | | | | | | | | | | | | | | | | |
| State of Minnesota | | 11 | NEW of SW 1/4 | | | | | | | | | | | | | | | | | | | | |
| State of Minnesota | | 12 | NW 1/4 of SW 1/4 | | | | | | | | | | | | | | | | | | | | |
| State of Minnesota | | 13 | SW 1/4 of SW 1/4 | | | | | | | | | | | | | | | | | | | | |
| State of Minnesota | | 14 | SE 1/4 of SW 1/4 | | | | | | | | | | | | | | | | | | | | |
| | | 15 | | | | | | | | | | | | | | | | | | | | | |
| State of Minnesota | | 16 | NEW of SE 1/4 | | | | | | | | | | | | | | | | | | | | |
| State of Minnesota | | 17 | NW 1/4 of SE 1/4 | | | | | | | | | | | | | | | | | | | | |
| State of Minnesota | | 18 | SW 1/4 of SE 1/4 | | | | | | | | | | | | | | | | | | | | |
| State of Minnesota | | 19 | SE 1/4 of SE 1/4 | | | | | | | | | | | | | | | | | | | | |
| | | 20 | | | | | | | | | | | | | | | | | | | | | |

Cass County, Minnesota, for Taxes for the Year 1959.

| SOLD FOR TAXES | VALUATIONS BY SCHOOL DISTRICTS AS EQUALIZED BY DEPARTMENT OF TAXATION | | | | | | Tax including State Homestead | State Tax on Non-Homestead | SPECIAL TAXES | TOTAL TAXES | PAID | WHEN PAID | Number of Receipt | March Settlement 1960 | June Settlement 1960 | Penalty Settlement 1960 | November Settlement 1960 | Penalty | Collections to First Monday in January 1961 | Penalty | Delinquent on First Monday in January 1961 | Total Delinquent Tax and Penalty | REMARKS |
|----------------|---|--------------|--------------|--------------|--------------|--------------|-------------------------------|----------------------------|---------------|-------------|------|-----------|-------------------|-----------------------|----------------------|-------------------------|--------------------------|---------|---|---------|--|----------------------------------|---------|
| | District No. | District No. | District No. | District No. | District No. | District No. | | | | | | | | | | | | | | | | | |
| | Rate | Rate | Rate | Rate | Rate | Rate | | | | | | | | | | | | | | | | | |
| | | | | | | | | | | | | | | | | | | | | | | | |
| | | | | | | | | | | | | | | | | | | | | | | | |

140-27

Mr. Shores

Birdwood Shores

Brookman's Linden Beach

Lagwood St.

Assessment Roll and Tax List of Real Property in the

Town of Dellys

Form 502 MILLER-DAVIS CO., MINNEAPOLIS

Indicate Type of Property: R-Residential, C-Commercial, I-Industrial, U-Utility, F-Farm, L-Lakeshore, T-Timber, M-Mineral

Cass County, Minnesota, for Taxes for the Year 1959.

| IN WHOSE NAME ASSESSED | TO WHOM TRANSFERRED | DESCRIPTION OF PROPERTY | | | | | TRUE AND FULL VALUATIONS | | | | | | | | | | | | No. School District | Indicate Homestead Tax or No | Indicate Agricultural Tax or No | Indicate Type of Property | ASSESSED VALUATIONS | | | | | | | | | | | | FINAL EQUALIZED VALUE |
|------------------------|---------------------|-------------------------|------------------|---------------|-----------|-------------------------|---|--------------------------------|---|---------------------------|-------|--------|-----------------------------|--|--------------------------|-----------------------------|---|----------------------|---------------------|------------------------------|---------------------------------|---------------------------|--|------------------------------------|---------|---------|---------|---------|---------|---------|--|--|--|--|-----------------------|
| | | SUBDIVISION | Sec. or Lot | Town or Block | Rog. | Number of Acres of Land | LAND Exclusive of Structures and Improvements | BUILDINGS and Other Structures | MACHINERY Permanently Attached to Real Estate | TOTAL True and Full Value | RURAL | | | ALL OTHER | | | MACHINERY Permanently Attached to Real Estate | TOTAL ASSESSED VALUE | | | | | Total Assessed Value as Equalized by the Board of Review | | | | | | | | | | | | |
| | | | | | | | | | | | Acres | 100ths | Homestead Up to \$4,000 20% | Over \$4,000 and Non-Homestead 33 1/3% | Timber Land Class 3c 20% | Homestead Up to \$4,000 25% | | | | | | | | Over \$4,000 and Non-Homestead 40% | Dollars | Dollars | Dollars | Dollars | Dollars | Dollars | | | | | |
| State of Minnesota | | 1 | NE 1/4 of NE 1/4 | | 31 139 27 | | | | | | | | | | | | | | | | | | | | | | | | | | | | | | |
| State of Minnesota | | 2 | NW 1/4 of NE 1/4 | | | | | | | | | | | | | | | | | | | | | | | | | | | | | | | | |
| State of Minnesota | | 3 | SW 1/4 of NE 1/4 | | | | | | | | | | | | | | | | | | | | | | | | | | | | | | | | |
| State of Minnesota | | 4 | SE 1/4 of NE 1/4 | | | | | | | | | | | | | | | | | | | | | | | | | | | | | | | | |
| State of Minnesota | | 5 | | | | | | | | | | | | | | | | | | | | | | | | | | | | | | | | | |
| State of Minnesota | | 6 | NE 1/4 of NW 1/4 | | | | | | | | | | | | | | | | | | | | | | | | | | | | | | | | |
| State of Minnesota | | 7 | NW 1/4 of NW 1/4 | | | | | | | | | | | | | | | | | | | | | | | | | | | | | | | | |
| State of Minnesota | | 8 | SW 1/4 of NW 1/4 | | | | | | | | | | | | | | | | | | | | | | | | | | | | | | | | |
| State of Minnesota | | 9 | SE 1/4 of NW 1/4 | | | | | | | | | | | | | | | | | | | | | | | | | | | | | | | | |
| State of Minnesota | | 10 | | | | | | | | | | | | | | | | | | | | | | | | | | | | | | | | | |
| State of Minnesota | | 11 | NE 1/4 of SW 1/4 | | | | | | | | | | | | | | | | | | | | | | | | | | | | | | | | |
| State of Minnesota | | 12 | NW 1/4 of SW 1/4 | | | | | | | | | | | | | | | | | | | | | | | | | | | | | | | | |
| State of Minnesota | | 13 | SW 1/4 of SW 1/4 | | | | | | | | | | | | | | | | | | | | | | | | | | | | | | | | |
| State of Minnesota | | 14 | SE 1/4 of SW 1/4 | | | | | | | | | | | | | | | | | | | | | | | | | | | | | | | | |
| State of Minnesota | | 15 | | | | | | | | | | | | | | | | | | | | | | | | | | | | | | | | | |
| State of Minnesota | | 16 | NE 1/4 of SE 1/4 | | | | | | | | | | | | | | | | | | | | | | | | | | | | | | | | |
| State of Minnesota | | 17 | NW 1/4 of SE 1/4 | | | | | | | | | | | | | | | | | | | | | | | | | | | | | | | | |
| State of Minnesota | | 18 | SW 1/4 of SE 1/4 | | | | | | | | | | | | | | | | | | | | | | | | | | | | | | | | |
| State of Minnesota | | 19 | SE 1/4 of SE 1/4 | | | | | | | | | | | | | | | | | | | | | | | | | | | | | | | | |
| | | 20 | | | | | | | | | | | | | | | | | | | | | | | | | | | | | | | | | |

| SOLD FOR TAXES | VALUATIONS BY SCHOOL DISTRICTS AS EQUALIZED BY DEPARTMENT OF TAXATION | | | | | | Tax including State Homestead | State Tax on Non-Homestead | SPECIAL TAXES | TOTAL TAXES | PAID | WHEN PAID | Number of Receipt | March Settlement 1960 | June Settlement 1960 | Penalty | November Settlement 1960 | Penalty | Collections to First Monday in January 1961 | Penalty | Delinquent on First Monday in January 1961 | Total Delinquent Tax and Penalty | REMARKS |
|----------------|---|--------------|--------------|--------------|--------------|--------------|-------------------------------|----------------------------|---------------|-------------|------|-----------|-------------------|-----------------------|----------------------|---------|--------------------------|---------|---|---------|--|----------------------------------|---------|
| | District No. | District No. | District No. | District No. | District No. | District No. | | | | | | | | | | | | | | | | | |
| | Rate | Rate | Rate | Rate | Rate | Rate | | | | | | | | | | | | | | | | | |
| | | | | | | | | | | | | | | | | | | | | | | | |
| | | | | | | | | | | | | | | | | | | | | | | | |
| | | | | | | | | | | | | | | | | | | | | | | | |
| | | | | | | | | | | | | | | | | | | | | | | | |
| | | | | | | | | | | | | | | | | | | | | | | | |
| | | | | | | | | | | | | | | | | | | | | | | | |
| | | | | | | | | | | | | | | | | | | | | | | | |
| | | | | | | | | | | | | | | | | | | | | | | | |
| | | | | | | | | | | | | | | | | | | | | | | | |
| | | | | | | | | | | | | | | | | | | | | | | | |
| | | | | | | | | | | | | | | | | | | | | | | | |
| | | | | | | | | | | | | | | | | | | | | | | | |
| | | | | | | | | | | | | | | | | | | | | | | | |
| | | | | | | | | | | | | | | | | | | | | | | | |
| | | | | | | | | | | | | | | | | | | | | | | | |
| | | | | | | | | | | | | | | | | | | | | | | | |
| | | | | | | | | | | | | | | | | | | | | | | | |
| | | | | | | | | | | | | | | | | | | | | | | | |
| | | | | | | | | | | | | | | | | | | | | | | | |
| | | | | | | | | | | | | | | | | | | | | | | | |
| | | | | | | | | | | | | | | | | | | | | | | | |
| | | | | | | | | | | | | | | | | | | | | | | | |

10-27

Over Shares

Over Shares

Over Shares

Over Shares

Assessment Roll and Tax List of Real Property in the Town of *Tralips*

Form 50D MILLER-DAVIS CO., MINNEAPOLIS

Indicate Type of Property: R-Residential, C-Commercial, I-Industrial, U-Utility, F-Farm, L-Lakeshore, T-Timber, M-Mineral

| IN WHOSE NAME ASSESSED | TO WHOM TRANSFERRED | DESCRIPTION OF PROPERTY | | | | TRUE AND FULL VALUATIONS | | | | | | | | | | FINAL EQUALIZED VALUE | REMARKS | | | |
|------------------------|---------------------|-------------------------|------------------|---------------|----------------------|---|--------------------------------|---|---------------------------|-----------------------------|--|--------------------------|-----------------------------|------------------------------------|---------|-----------------------|---------|---|----------------------|--|
| | | SUBDIVISION | Sec. of Lot | Town or Block | No. of Acres of Land | LAND Excl. of Structures and Improvements | BUILDINGS and Other Structures | MACHINERY Permanently Attached to Real Estate | TOTAL True and Full Value | RURAL | | | ALL OTHER | | | | | MACHINERY Permanently Attached to Real Estate | TOTAL ASSESSED VALUE | Total Assessed Value as Equalized by the Board of Review |
| | | | | | | | | | | Homestead Up to \$4,000 20% | Over \$4,000 and Non-Homestead 33 1/3% | Timber Land Class 3e 20% | Homestead Up to \$4,000 25% | Over \$4,000 and Non-Homestead 40% | Dollars | | | | | |
| State of Minnesota | | 1 | NEW of NE 1/4 | 32 139 27 | | | | | | | | | | | | | | | | |
| State of Minnesota | | 2 | NW 1/4 of NE 1/4 | | | | | | | | | | | | | | | | | |
| State of Minnesota | | 3 | SW 1/4 of NE 1/4 | | | | | | | | | | | | | | | | | |
| State of Minnesota | | 4 | SE 1/4 of NE 1/4 | | | | | | | | | | | | | | | | | |
| State of Minnesota | | 5 | | | | | | | | | | | | | | | | | | |
| State of Minnesota | | 6 | NE 1/4 of NW 1/4 | | | | | | | | | | | | | | | | | |
| State of Minnesota | | 7 | NW 1/4 of NW 1/4 | | | | | | | | | | | | | | | | | |
| State of Minnesota | | 8 | SW 1/4 of NW 1/4 | | | | | | | | | | | | | | | | | |
| State of Minnesota | | 9 | SE 1/4 of NW 1/4 | | | | | | | | | | | | | | | | | |
| State of Minnesota | | 10 | | | | | | | | | | | | | | | | | | |
| State of Minnesota | | 11 | NE 1/4 of SW 1/4 | | | | | | | | | | | | | | | | | |
| State of Minnesota | | 12 | NW 1/4 of SW 1/4 | | | | | | | | | | | | | | | | | |
| State of Minnesota | | 13 | SW 1/4 of SW 1/4 | | | | | | | | | | | | | | | | | |
| State of Minnesota | | 14 | SE 1/4 of SW 1/4 | | | | | | | | | | | | | | | | | |
| State of Minnesota | | 15 | | | | | | | | | | | | | | | | | | |
| State of Minnesota | | 16 | NE 1/4 of SE 1/4 | | | | | | | | | | | | | | | | | |
| State of Minnesota | | 17 | NW 1/4 of SE 1/4 | | | | | | | | | | | | | | | | | |
| State of Minnesota | | 18 | SW 1/4 of SE 1/4 | | | | | | | | | | | | | | | | | |
| State of Minnesota | | 19 | SE 1/4 of SE 1/4 | | | | | | | | | | | | | | | | | |
| State of Minnesota | | 20 | | | | | | | | | | | | | | | | | | |

Cass County, Minnesota, for Taxes for the Year 1959.

| SOLD FOR TAXES | VALUATIONS BY SCHOOL DISTRICTS AS EQUALIZED BY DEPARTMENT OF TAXATION | | | | | | Tax including State Homestead | State Tax on Non-Homestead | SPECIAL TAXES | TOTAL TAXES | PAID | WHEN PAID | Number of Receipt | March Settlement 1960 | June Settlement 1960 | Penalty Settlement 1960 | November Settlement 1960 | Penalty | Collections to First Monday in January 1961 | Penalty | Delinquent on First Monday in January 1961 | Total Delinquent Tax and Penalty | REMARKS | | |
|----------------|---|--------------|--------------|--------------|--------------|--------------|-------------------------------|----------------------------|---------------|-------------|------|-----------|-------------------|-----------------------|----------------------|-------------------------|--------------------------|---------|---|---------|--|----------------------------------|---------|--|--|
| | District No. | District No. | District No. | District No. | District No. | District No. | | | | | | | | | | | | | | | | | | | |
| | Rate | Rate | Rate | Rate | Rate | Rate | | | | | | | | | | | | | | | | | | | |
| | Mills | Mills | Mills | Mills | Mills | Mills | | | | | | | | | | | | | | | | | | | |
| 1 | | | | | | | | | | | | | | | | | | | | | | | | | |
| 2 | | | | | | | | | | | | | | | | | | | | | | | | | |
| 3 | | | | | | | | | | | | | | | | | | | | | | | | | |
| 4 | | | | | | | | | | | | | | | | | | | | | | | | | |
| 5 | | | | | | | | | | | | | | | | | | | | | | | | | |
| 6 | | | | | | | | | | | | | | | | | | | | | | | | | |
| 7 | | | | | | | | | | | | | | | | | | | | | | | | | |
| 8 | | | | | | | | | | | | | | | | | | | | | | | | | |
| 9 | | | | | | | | | | | | | | | | | | | | | | | | | |
| 10 | | | | | | | | | | | | | | | | | | | | | | | | | |
| 11 | | | | | | | | | | | | | | | | | | | | | | | | | |
| 12 | | | | | | | | | | | | | | | | | | | | | | | | | |
| 13 | | | | | | | | | | | | | | | | | | | | | | | | | |
| 14 | | | | | | | | | | | | | | | | | | | | | | | | | |
| 15 | | | | | | | | | | | | | | | | | | | | | | | | | |
| 16 | | | | | | | | | | | | | | | | | | | | | | | | | |
| 17 | | | | | | | | | | | | | | | | | | | | | | | | | |
| 18 | | | | | | | | | | | | | | | | | | | | | | | | | |
| 19 | | | | | | | | | | | | | | | | | | | | | | | | | |
| 20 | | | | | | | | | | | | | | | | | | | | | | | | | |

Assessment Roll and Tax List of Real Property in the

Town of *Delphi*

Form 5CD MILLER-DAVIS CO., MINNEAPOLIS

* Indicate Type of Property: R-Residential, C-Commercial, I-Industrial, U-Utility, F-Farm, L-Lakeshore, T-Timber, M-Mineral

| IN WHOSE NAME ASSESSED | TO WHOM TRANSFERRED | DESCRIPTION OF PROPERTY | | | | | No. School District | Indicate Homestead or No. | Indicate Agricultural Use or No. | Indicate Type of Property | TRUE AND FULL VALUATIONS | | | | ASSESSED VALUATIONS | | | | | | FINAL EQUALIZED VALUE | | | | | | |
|------------------------|---------------------|-------------------------|-------------------------------------|---------------|------|-------------------------|---------------------|---------------------------|----------------------------------|---------------------------|---|--------------------------------|---|---------------------------|---------------------|---------|---------|-----------|---------------|---------|-----------------------|---|----------------------|--|----------------------|-----------|--------------------------------|
| | | SUBDIVISION | Sec. of Lot | Town or Block | Rng. | Number of Acres of Land | | | | | LAND Exclusive of Structures and Improvements | BUILDINGS and Other Structures | MACHINERY Permanently Attached to Real Estate | TOTAL True and Full Value | RURAL | | | ALL OTHER | | | | MACHINERY Permanently Attached to Real Estate | TOTAL ASSESSED VALUE | Total Assessed Value as Equalized by the Board of Review | | | |
| | | | | | | | | | | | | | | | Dollars | Dollars | Dollars | Dollars | Homestead | | | | | | Timber Land Class 3c | Homestead | Over \$4,000 and Non-Homestead |
| | | | | | | | | | | | | | | | | | | | Up to \$4,000 | 33 1/3% | | | | | | | |
| State of Minnesota | | 1 | NE 1/4 of NE 1/4 | | | | | | | | | | | | | | | | | | | | | | | | |
| | | 2 | NW 1/4 of NE 1/4 | | | | | | | | | | | | | | | | | | | | | | | | |
| | | 3 | SW 1/4 of NE 1/4 | | | | | | | | | | | | | | | | | | | | | | | | |
| | | 4 | SE 1/4 of NE 1/4 | | | | | | | | | | | | | | | | | | | | | | | | |
| | | 5 | | | | | | | | | | | | | | | | | | | | | | | | | |
| State of Minnesota | | 6 | NE 1/4 of NW 1/4 <i>Cont. lot 1</i> | | | | | | | | | | | | | | | | | | | | | | | | |
| State of Minnesota | | 7 | NW 1/4 of NW 1/4 <i>Cont. lot 3</i> | | | | | | | | | | | | | | | | | | | | | | | | |
| | | 8 | SW 1/4 of NW 1/4 | | | | | | | | | | | | | | | | | | | | | | | | |
| State of Minnesota | | 9 | SE 1/4 of NW 1/4 <i>Cont. lot 2</i> | | | | | | | | | | | | | | | | | | | | | | | | |
| | | 10 | | | | | | | | | | | | | | | | | | | | | | | | | |
| State of Minnesota | | 11 | NE 1/4 of SW 1/4 | | | | | | | | | | | | | | | | | | | | | | | | |
| State of Minnesota | | 12 | NW 1/4 of SW 1/4 | | | | | | | | | | | | | | | | | | | | | | | | |
| State of Minnesota | | 13 | SW 1/4 of SW 1/4 | | | | | | | | | | | | | | | | | | | | | | | | |
| State of Minnesota | | 14 | SE 1/4 of SW 1/4 | | | | | | | | | | | | | | | | | | | | | | | | |
| | | 15 | | | | | | | | | | | | | | | | | | | | | | | | | |
| State of Minnesota | | 16 | NE 1/4 of SE 1/4 | | | | | | | | | | | | | | | | | | | | | | | | |
| State of Minnesota | | 17 | NW 1/4 of SE 1/4 | | | | | | | | | | | | | | | | | | | | | | | | |
| State of Minnesota | | 18 | SW 1/4 of SE 1/4 | | | | | | | | | | | | | | | | | | | | | | | | |
| State of Minnesota | | 19 | SE 1/4 of SE 1/4 | | | | | | | | | | | | | | | | | | | | | | | | |
| | | 20 | | | | | | | | | | | | | | | | | | | | | | | | | |

Cass County, Minnesota, for Taxes for the Year 1959.

| SOLD FOR TAXES | VALUATIONS BY SCHOOL DISTRICTS AS EQUALIZED BY DEPARTMENT OF TAXATION | | | | | | Tax including State Homestead | State Tax on Non-Homestead | SPECIAL TAXES | TOTAL TAXES | PAID | WHEN PAID | Number of Receipt | March Settlement 1960 | June Settlement 1960 | Penalty 1960 | November Settlement 1960 | Penalty | Collections to First Monday in January 1961 | Penalty | Delinquent on First Monday in January 1961 | Total Delinquent Tax and Penalty | REMARKS |
|----------------|---|--------------|--------------|--------------|--------------|--------------|-------------------------------|----------------------------|---------------|-------------|------|-----------|-------------------|-----------------------|----------------------|--------------|--------------------------|---------|---|---------|--|----------------------------------|---------|
| | District No. | District No. | District No. | District No. | District No. | District No. | | | | | | | | | | | | | | | | | |
| | Rate | Rate | Rate | Rate | Rate | Rate | | | | | | | | | | | | | | | | | |
| | Mills | Mills | Mills | Mills | Mills | Mills | | | | | | | | | | | | | | | | | |
| 1 | | | | | | | | | | | | | | | | | | | | | | | |
| 2 | | | | | | | | | | | | | | | | | | | | | | | |
| 3 | | | | | | | | | | | | | | | | | | | | | | | |
| 4 | | | | | | | | | | | | | | | | | | | | | | | |
| 5 | | | | | | | | | | | | | | | | | | | | | | | |
| 6 | | | | | | | | | | | | | | | | | | | | | | | |
| 7 | | | | | | | | | | | | | | | | | | | | | | | |
| 8 | | | | | | | | | | | | | | | | | | | | | | | |
| 9 | | | | | | | | | | | | | | | | | | | | | | | |
| 10 | | | | | | | | | | | | | | | | | | | | | | | |
| 11 | | | | | | | | | | | | | | | | | | | | | | | |
| 12 | | | | | | | | | | | | | | | | | | | | | | | |
| 13 | | | | | | | | | | | | | | | | | | | | | | | |
| 14 | | | | | | | | | | | | | | | | | | | | | | | |
| 15 | | | | | | | | | | | | | | | | | | | | | | | |
| 16 | | | | | | | | | | | | | | | | | | | | | | | |
| 17 | | | | | | | | | | | | | | | | | | | | | | | |
| 18 | | | | | | | | | | | | | | | | | | | | | | | |
| 19 | | | | | | | | | | | | | | | | | | | | | | | |
| 20 | | | | | | | | | | | | | | | | | | | | | | | |

110-27
Shores
Mr. Wood Shores
Brookman's Linden
Beach
Lagwood St.

Assessment Roll and Tax List of Real Property in the Town of Irles

Form 5CD MILLER-DAVIS CO., MINNEAPOLIS

* Indicate Type of Property: R-Residential, C-Commercial, I-Industrial, U-Utility, F-Farm, L-Lakeshore, T-Timber, M-Mineral

| IN WHOSE NAME ASSESSED | TO WHOM TRANSFERRED | DESCRIPTION OF PROPERTY | | | | No. School District | Indicate Homestead Yes or No | Indicate Agricultural Yes or No | Indicate Type of Property | TRUE AND FULL VALUATIONS | | | ASSESSED VALUATIONS | | | | | | FINAL EQUALIZED VALUE | | | | |
|------------------------|---------------------|-------------------------|------------------|---------------|------|---------------------|------------------------------|---------------------------------|---------------------------|---|---|--------------------------------|---|---------------------------|---|----------------------|--|--------------------------------|-----------------------|--|-----------------------------|--------------------------------|---------------------------------------|
| | | SUBDIVISION | Sec. or Lot | Town or Block | Reg. | | | | | Number of Acres of Land Acres 100ths | RURAL | | ALL OTHER | | MACHINERY Permanently Attached to Real Estate 33 1/8 % | TOTAL ASSESSED VALUE | Total Assessed Value as Equalized by the Board of Review | | | | | | |
| | | | | | | | | | | | LAND Exclusive of Structures and Improvements | BUILDINGS and Other Structures | MACHINERY Permanently Attached to Real Estate | TOTAL True and Full Value | | | | Homestead Up to \$4,000 20% | | Over \$4,000 and Non-Homestead 33 1/8 % | Timber Land Class 3e 20% | Homestead Up to \$4,000 25% | Over \$4,000 and Non-Homestead 40% |
| State of Minnesota | | | | | | | | | | | | | | | | | | | | | | | |
| | | 1 | NEW of NEW | | | 36 139 27 | | | | | | | | | | | | | | | | | |
| State of Minnesota | | 2 | NW 1/4 of NEW | | | | | | | | | | | | | | | | | | | | |
| State of Minnesota | | 3 | SW 1/4 of NEW | | | | | | | | | | | | | | | | | | | | |
| State of Minnesota | | 4 | SE 1/4 of NEW | | | | | | | | | | | | | | | | | | | | |
| | | 5 | | | | | | | | | | | | | | | | | | | | | |
| State of Minnesota | | 6 | NE 1/4 of NW 1/4 | | | | | | | | | | | | | | | | | | | | |
| State of Minnesota | | 7 | NW 1/4 of NW 1/4 | | | | | | | | | | | | | | | | | | | | |
| State of Minnesota | | 8 | SW 1/4 of NW 1/4 | | | | | | | | | | | | | | | | | | | | |
| State of Minnesota | | 9 | SE 1/4 of NW 1/4 | | | | | | | | | | | | | | | | | | | | |
| | | 10 | | | | | | | | | | | | | | | | | | | | | |
| State of Minnesota | | 11 | NE 1/4 of SW 1/4 | | | | | | | | | | | | | | | | | | | | |
| State of Minnesota | | 12 | NW 1/4 of SW 1/4 | | | | | | | | | | | | | | | | | | | | |
| State of Minnesota | | 13 | SW 1/4 of SW 1/4 | | | | | | | | | | | | | | | | | | | | |
| State of Minnesota | | 14 | SE 1/4 of SW 1/4 | | | | | | | | | | | | | | | | | | | | |
| | | 15 | | | | | | | | | | | | | | | | | | | | | |
| State of Minnesota | | 16 | NE 1/4 of SE 1/4 | | | | | | | | | | | | | | | | | | | | |
| State of Minnesota | | 17 | NW 1/4 of SE 1/4 | | | | | | | | | | | | | | | | | | | | |
| State of Minnesota | | 18 | SW 1/4 of SE 1/4 | | | | | | | | | | | | | | | | | | | | |
| State of Minnesota | | 19 | SE 1/4 of SE 1/4 | | | | | | | | | | | | | | | | | | | | |
| | | 20 | | | | | | | | | | | | | | | | | | | | | |

Cass County, Minnesota, for Taxes for the Year 1959.

| SOLD FOR TAXES | VALUATIONS BY SCHOOL DISTRICTS AS EQUALIZED BY DEPARTMENT OF TAXATION | | | | | | Tax including State Homestead Mills | State Tax on Non-Homestead Mills | SPECIAL TAXES | TOTAL TAXES | PAID | WHEN PAID | Number of Receipt | March Settlement 1960 | June Settlement 1960 | Penalty | November Settlement 1960 | Penalty | Collections to First Monday in January 1961 | Penalty | Delinquent on First Monday in January 1961 | Total Delinquent Tax and Penalty | REMARKS | | | |
|----------------|---|--------------|--------------|--------------|--------------|--------------|---|--|---------------|-------------|------|-----------|-------------------|-----------------------|----------------------|---------|--------------------------|---------|---|---------|--|----------------------------------|---------|--|--|--|
| | District No. | District No. | District No. | District No. | District No. | District No. | | | | | | | | | | | | | | | | | | | | |
| | Rate | Rate | Rate | Rate | Rate | Rate | | | | | | | | | | | | | | | | | | | | |
| | | | | | | | | | | | | | | | | | | | | | | | | | | |
| | | | | | | | | | | | | | | | | | | | | | | | | | | |

110-27

Shores

Shores

Shores

Shores

Assessment Roll and Tax List of Real Property in the Town of Trilpe

Indicate Type of Property: R-Residential, C-Commercial, I-Industrial, U-Utillity, F-Farm, L-Lakeshore, T-Timber, M-Mineral

Cass County, Minnesota, for Taxes for the Year 1959.

Table with columns: IN WHOSE NAME ASSESSED, TO WHOM TRANSFERRED, DESCRIPTION OF PROPERTY, TRUE AND FULL VALUATIONS, ASSESSED VALUATIONS, FINAL EQUALIZED VALUE. Includes handwritten entries for Bernadine S. Nelson, Alexander Gilmore, Irwin C. + Eleanor Becker, Reginald W. + Anna Marie McKay, Delbert J. + Marie E. Fitzloff, Francis B. + Mary L. McKenna, Frank + Marie Hoffmann, Harvey Brisse, Paul B. + Violet S. Green, Minneapolis Council of Camp Fire Girls, Inc., Fred C. + Leona J. Smith.

Table with columns: VALUATIONS BY SCHOOL DISTRICTS AS EQUALIZED BY DEPARTMENT OF TAXATION, TAX including State Homestead, SPECIAL TAXES, TOTAL TAXES, PAID, WHEN PAID, Number of Receipt, March Settlement 1960, June Settlement 1960, Penalty, November Settlement 1960, Penalty, Collections to First Monday in January 1961, Penalty, Delinquent on First Monday in January 1961, Total Delinquent Tax and Penalty, REMARKS. Includes handwritten entries for tax amounts and dates.

110-27

Over Shore, Birchwood Shores, Brookman's Linden Beach, Logwood Shores

Assessment Roll and Tax List of Real Property in the Town of Malissa, * Indicate Type of Property: R-Residential, C-Commercial, I-Industrial, U-Utility, F-Farm, L-Lakeshore, T-Timber, M-Mineral

Form SCD 1-1-59

| IN WHOSE NAME ASSESSED | TO WHOM TRANSFERRED | DESCRIPTION OF PROPERTY | | | | | TRUE AND FULL VALUATIONS | | | | | | | | | | | FINAL EQUALIZED VALUE | |
|--|---------------------|-------------------------|-------------|---------------|---------|-------------------------|--------------------------|-----------------------|---------------------------|---|--------------------------------|---|---------------------------|-----------------------------|--|---|----------------------|-----------------------|--|
| | | SUBDIVISION | Sec. or Lot | Town or Block | Rng. | Number of Acres of Land | INDICATE HOMESTEAD | INDICATE AGRICULTURAL | INDICATE TYPE OF PROPERTY | RURAL | | | ALL OTHER | | | MACHINERY Permanently Attached to Real Estate | TOTAL ASSESSED VALUE | | Total Assessed Value as Equalized by the Board of Review |
| | | | | | | | | | | LAND Exclude of Structures and Improvements | BUILDINGS and Other Structures | MACHINERY Permanently Attached to Real Estate | TOTAL True and Full Value | Homestead Up to \$4,000 20% | Over \$4,000 and Non-Homestead 33 1/3% | | | | |
| | | Dollars | Dollars | Dollars | Dollars | Dollars | Dollars | Dollars | Dollars | Dollars | Dollars | Dollars | Dollars | Dollars | | | | | |
| State of Minnesota | | | | | | | | | | | | | | | | | | | |
| State of Minnesota | | | | | | | | | | | | | | | | | | | |
| State of Minnesota | | | | | | | | | | | | | | | | | | | |
| State of Minnesota | | | | | | | | | | | | | | | | | | | |
| | | | | | | | | | | | | | | | | | | | |
| <i>John + Muriel Wheeler</i> | | | | | | | | | | | | | | | | | | | |
| <i>John + Muriel + Louis + Mayme Wheeler</i> | | | | | | | | | | | | | | | | | | | |
| <i>John + Muriel Wheeler</i> | | | | | | | | | | | | | | | | | | | |
| State of Minnesota | | | | | | | | | | | | | | | | | | | |
| State of Minnesota | | | | | | | | | | | | | | | | | | | |
| <i>Chas Wheeler</i> | | | | | | | | | | | | | | | | | | | |
| " " | | | | | | | | | | | | | | | | | | | |
| State of Minnesota | | | | | | | | | | | | | | | | | | | |
| State of Minnesota | | | | | | | | | | | | | | | | | | | |
| State of Minnesota | | | | | | | | | | | | | | | | | | | |
| State of Minnesota | | | | | | | | | | | | | | | | | | | |
| State of Minnesota | | | | | | | | | | | | | | | | | | | |
| State of Minnesota | | | | | | | | | | | | | | | | | | | |
| | | | | | 19756 | | | | | | | | | | | | | | |

Cass County, Minnesota, for Taxes for the Year 1959.

| SOLD FOR TAXES | VALUATIONS BY SCHOOL DISTRICTS AS EQUALIZED BY DEPARTMENT OF TAXATION | | | | | | Tax including State Homestead | State Tax on Non-Homestead | SPECIAL TAXES | TOTAL TAXES | PAID | WHEN PAID | Number of Receipt | March Settlement 1960 | June Settlement 1960 | November Settlement 1960 | Penalty | Collections to First Monday in January 1961 | Penalty | Delinquent on First Monday in January 1961 | Total Delinquent Tax and Penalty | REMARKS |
|----------------|---|--------------|--------------|--------------|--------------|--------------|-------------------------------|----------------------------|---------------|-------------|------|-----------|-------------------|-----------------------|----------------------|--------------------------|---------|---|---------|--|----------------------------------|---------|
| | District No. | District No. | District No. | District No. | District No. | District No. | | | | | | | | | | | | | | | | |
| | Rate | Rate | Rate | Rate | Rate | Rate | | | | | | | | | | | | | | | | |
| | Mills | Mills | Mills | Mills | Mills | Mills | | | | | | | | | | | | | | | | |
| | 43 | | | | | 1368 | 26 | | 1394 | | | | | | | | | | | | | |
| | 43 | | | | | 1368 | 26 | | 1394 | | | | | | | | | | | | | |
| | 44 | | | | | 1400 | 28 | | 1428 | | | | | | | | | | | | | |
| | 44 | | | | | 1400 | 28 | | 1428 | | | | | | | | | | | | | |
| | 47 | | | | | 4480 | 92 | | 4772 | | | | | | | | | | | | | |
| | | | | | | | 10216 | 200 | | 10416 | | | | | | | | | | | | |

139-27
140-27

Shores Brookman's Linden Logwood Shores Birchwood Shores

Assessment Roll and Tax List of Real Property in the Town of *Trilips*

Form 500 (1958) MINN. STATE DEPT. OF REVENUE

Indicate Type of Property: R-Residential, C-Commercial, I-Industrial, U-Utility, F-Farm, L-Lakeshore, T-Timber, M-Mineral

140-27

| IN WHOSE NAME ASSESSED | TO WHOM TRANSFERRED | DESCRIPTION OF PROPERTY | | | | No. School District | Indicate Homestead Tax or No | Indicate Agricultural Tax or No | Indicate Type of Property | TRUE AND FULL VALUATIONS | | | | | | | | | | | FINAL EQUALIZED VALUE | | |
|----------------------------------|---------------------|---|-------------|---------------|------|---------------------|------------------------------|---------------------------------|---------------------------|--------------------------|---|--------------------------------|---|---------------------------|-------|--------|-----------------------------|--|--------------------------|---|-----------------------|----------------------|--|
| | | SUBDIVISION | Sec. or Lot | Town or Block | Rng. | | | | | Number of Acres of Land | LAND Exclusive of Structures and Improvements | BUILDINGS and Other Structures | MACHINERY Permanently Attached to Real Estate | TOTAL True and Full Value | RURAL | | ALL OTHER | | | MACHINERY Permanently Attached to Real Estate | | TOTAL ASSESSED VALUE | Total Assessed Value as Equalized by the Board of Review |
| | | | | | | | | | | | | | | | Acres | 100ths | Homestead Up to \$4,000 20% | Over \$4,000 and Non-Homestead 33 1/3% | Timber Land Class 3c 20% | | | | |
| Jacob & Agnes Woodley | | N E 1/4 of N 1/4 | 5 | 140 27 | | 36 99 | Un | 70 | 40 | F | | | | | | | | | | | | | |
| Douglas J. & Ann B. Hafften | | Cont. Lot 2 less 1 ac. & less 8.470' | | | | 39 | | 70 | 70 | L | | | | | | | | | | | | | |
| " | " | S W 1/4 of N 1/4 | | | | 43 15 | | 70 | " | " | | | | | | | | | | | | | |
| Jacob & Agnes Woodley | | S E 1/4 of N E 1/4 | | | | 40 | | 70 | 40 | T | | | | | | | | | | | | | |
| Irving Johnson, et al | | Com. at a point on N. line of lot 2, 2310' W. of N.E. Cor. S. 196' thence W. 225' to E. Bank of Inguadona lake then N'Ely & N'ly along lake to N. line, thence E. 200.4' to place of beg. | | | | 1 | | 70 | 70 | L | | | | | | | | | | | | | |
| Poland Edwards | | N W 1/4 of N W 1/4 | | | | 4 | | 70 | 40 | F | | | | | | | | | | | | | |
| " | " | S W 1/4 of N W 1/4 | | | | | | | | | | | | | | | | | | | | | |
| " | " | S E 1/4 of N W 1/4 | | | | | | | | | | | | | | | | | | | | | |
| Douglas J. & Ann B. Hafften | | S 470' of Cont. Lot 2 | | | | | | 70 | 40 | C | | | | | | | | | | | | | |
| " | " | N E 1/4 of S W 1/4 | | | | | | | | | | | | | | | | | | | | | |
| " | " | N W 1/4 of S W 1/4 | | | | | | | | | | | | | | | | | | | | | |
| " | " | S W 1/4 of S W 1/4 | | | | | | | | | | | | | | | | | | | | | |
| " | " | S E 1/4 of S W 1/4 | | | | | | | | | | | | | | | | | | | | | |
| Lewis E. & Arrie E. Richards | | Part of Cont. Lot 7 | | | | | | | | | | | | | | | | | | | | | |
| Louis & Agnes Sanderson | | N E 1/4 of S E 1/4 | | | | 40 | | 70 | 40 | F | | | | | | | | | | | | | |
| Arthur Larson & B. E. Holmes | | N W 1/4 of S E 1/4 | | | | 41 25 | | 70 | " | T | | | | | | | | | | | | | |
| Milton E. & Estelle E. Christian | | Cont. Lot 7 less 100' of W. 330' | | | | 47 25 | | 70 | 70 | C | | | | | | | | | | | | | |
| " | " | S E 1/4 of S E 1/4 | | | | 40 | | 70 | 40 | T | | | | | | | | | | | | | |
| Arthur C. & Mabel S. Nelson | | S 100' of W. 330' of Cont. Lot 7 | | | | | | 70 | 70 | L | | | | | | | | | | | | | |
| Continued on next page | | | | | | 332.64 | | | | | | | | | | | | | | | | | |

Cass County, Minnesota, for Taxes for the Year 1959.

| SOLD FOR TAXES | VALUATIONS BY SCHOOL DISTRICTS AS EQUALIZED BY DEPARTMENT OF TAXATION | | | | | | Tax Including State Homestead | State Tax on Non-Homestead | SPECIAL TAXES | TOTAL TAXES | PAID | WHEN PAID | Number of Receipt | March Settlement 1960 | June Settlement 1960 | Penalty | November Settlement 1960 | Penalty | Collections to First Monday in January 1961 | Penalty | Delinquent on First Monday in January 1961 | Total Delinquent Tax and Penalty | REMARKS | | |
|----------------|---|--------------|--------------|--------------|--------------|--------------|-------------------------------|----------------------------|---------------|-------------|------|---------------------------------|-------------------|-----------------------|----------------------|---------|--------------------------|---------|---|---------|--|----------------------------------|---------|-------|------|
| | District No. | District No. | District No. | District No. | District No. | District No. | | | | | | | | | | | | | | | | | | | |
| | Rate | Rate | Rate | Rate | Rate | Rate | | | | | | | | | | | | | | | | | | | |
| | 1 | 75 | | | | | 23 88 | 46 | | 24 34 | 1 | 2nd HALF PAID OCT 13 1960 14952 | | | | | | | | | | | | | |
| | 2 | | | | | | 50 42 | 92 | | 51 34 | 2 | 1st HALF PAID MAY 10 1960 6966 | | | 12 17 | | | | | | | | | 10522 | |
| | 3 | | | | | | 17 94 | 32 | | 18 26 | 3 | PAID IN FULL MAY 4 1960 6658 | | | 51 34 | | | | | | | | | 9956 | |
| | 4 | 67 | | | | | 21 32 | 42 | | 21 74 | 4 | PAID IN FULL MAY 4 1960 6658 | | | 18 26 | | | | | | | | | " | |
| | 5 | | | | | | 30 78 | 56 | | 31 34 | 5 | 1st HALF PAID MAY 18 1960 6966 | | | 10 87 | | | | | | | | | 10522 | |
| | 6 | | | | | | | | | | 6 | | | | | | | | | | | | | | |
| | 7 | 90 | | | | | 28 66 | | | 28 66 | 7 | 2nd HALF PAID OCT 31 1960 17097 | | | | | | | | | | | | 15436 | |
| | 8 | | | | | | | | | | 8 | | | | | | | | | | | | | | |
| | 9 | | | | | | | | | | 9 | | | | | | | | | | | | | | |
| | 10 | | | | | | | | | 61 92 | 10 | PAID IN FULL MAY 4 1960 6658 | | | 61 92 | | | | | | | | | | 9956 |
| | 11 | | | | | | | | | | 11 | | | | | | | | | | | | | | |
| | 12 | | | | | | | | | | 12 | | | | | | | | | | | | | | |
| | 13 | | | | | | | | | | 13 | | | | | | | | | | | | | | |
| | 14 | | | | | | | | | | 14 | | | | | | | | | | | | | | |
| | 15 | | | | | | | | | | 15 | | | | | | | | | | | | | | |
| | 16 | 55 | | | | | 17 50 | | | 17 50 | 16 | SOLD FOR TAXES | | | | | | | | | | | | | |
| | 17 | 66 | | | | | 21 02 | 42 | | 21 44 | 17 | PAID IN FULL MAY 23 1960 8818 | | | 21 44 | | | | | | | | | | |
| | 18 | | | | | | 55 82 | 62 | | 56 44 | 18 | 2nd HALF PAID SEP 1 1960 | | | | | | | | | | | | | |
| | 19 | 60 | | | | | 19 10 | 38 | | 19 48 | 19 | 1st HALF PAID MAY 31 1960 11122 | | | 28 22 | | | | | | | | | | |
| | 20 | | | | | | 19 62 | 36 | | 19 98 | 20 | 2nd HALF PAID SEP 1 1960 13577 | | | 9 74 | | | | | | | | | | |
| | | 145 | | | | | 131 48 | 46 | | 136 94 | | PAID IN FULL MAY 23 1960 8813 | | | 19 98 | | | | | | | | | | |
| | | 268 | | | | | 236 50 | | | 236 50 | | | | | | | | | | | | | | | |
| | | 413 | | | | | 367 98 | | | 367 98 | | | | | | | | | | | | | | | |

Shores

Wood Shores

Brookman's Linden Beach

Logwood Sho

Assessment Roll and T

Form SCD

DESC

IN WHOSE NAME ASSESSED TO WHOM TRANSFERRED

SUBDI

John T. + Gloria Graham, et al

Roland Edwards

Clarence E + Elizabeth M. Stresnak

Guy Wm + Bella Thompson

Karathy E. Workman

D.W. + Leona Tate

Marvin Elson + Iris Larson

Byron + Irma Sherwood

| | |
|----|--------------------|
| 1 | NEW of NEW |
| 2 | NW of NEW |
| 3 | SW of NEW |
| 4 | SE of NEW |
| 5 | Upper S. 25' of T1 |
| 6 | NEW of NW |
| 7 | NW of NW |
| 8 | SW of NW |
| 9 | SE of NW |
| 10 | SW of SW |
| 11 | NW of SW |
| 12 | SW of SW |
| 13 | SE of SW |
| 14 | SE of SW |
| 15 | SW of SE |
| 16 | SW of SE |
| 17 | SW of SE |
| 18 | SW of SE |
| 19 | SW of SE |
| 20 | |

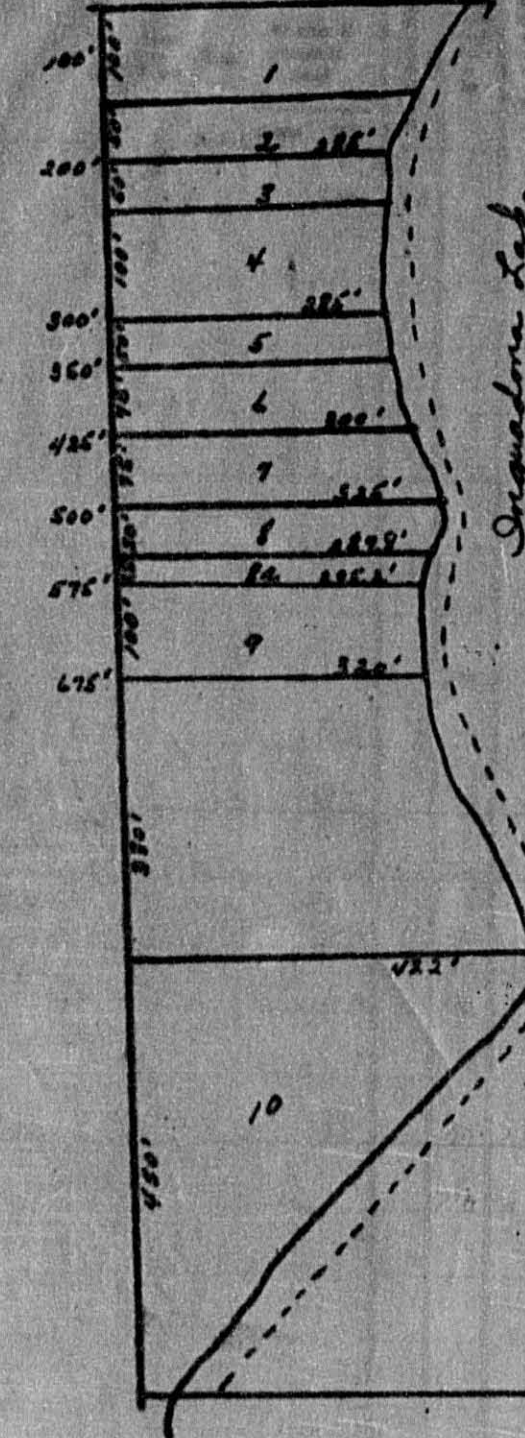

- 1. Roland Edwards 6.00
- 2. Clarence + Elizabeth Stresnak 9.60
- 3. " " .2500
- 4. Guy Wm + Bella Thompson .5000
- 5. " " .2500
- 6. Karathy E. Workman .5000
- 7. D.W. Tate 1.0000
- 8. " " .5000
- 9. John T. Graham, et al .7500
- 10. Marion Elson + Iris Larson 2.00

1250

Utility, F-Farm, L-Lakeshore, T-Timber, M-Mineral

| ASSESSED VALUATIONS | | | | | FINAL EQUALIZED VALUE |
|---------------------|----------------------------|------------------------------------|---|----------------------|-----------------------|
| ALL OTHER | Over \$4,000 Homestead 25% | Over \$4,000 and Non-Homestead 40% | MACHINERY Permanently Attached to Real Estate 33 1/3% | TOTAL ASSESSED VALUE | |
| Dollars | Dollars | Dollars | Dollars | Dollars | Dollars |

| SOLD FOR TAXES | VALUATIONS BY SCHOOL DISTRICTS AS EQUALIZED BY DEPARTMENT OF TAXATION | | | | | | Tax including State Homestead | State Tax on Non-Homestead | SPECIAL TAXES | TOTAL TAXES | PAID | WHEN PAID | Number of Receipt | March Settlement 1960 | June Settlement 1960 | Penalty | November Settlement 1960 | Penalty | Collections to First Monday in January 1961 | Penalty | Delinquent on First Monday in January 1961 | Total Delinquent Tax and Penalty | REMARKS |
|----------------|---|--------------|--------------|--------------|--------------|--------------|-------------------------------|----------------------------|---------------|-------------|------|-----------|-------------------|-----------------------|----------------------|---------|--------------------------|---------|---|---------|--|----------------------------------|---------|
| | District No. | District No. | District No. | District No. | District No. | District No. | | | | | | | | | | | | | | | | | |
| | | | | | | | | | | | | | | | | | | | | | | | |

| | | | | | | | | | | | | | | | | | | | | | | | |
|----|----------------|--|--|--|---|------|------|-----|--|------|--|--------------------------|-------|--|--|------|-----|----|--|--|--|-------|--|
| 1 | | | | | | | | | | | | | | | | | | | | | | | |
| 2 | | | | | | | | | | | | | | | | | | | | | | | |
| 3 | | | | | | | | | | | | | | | | | | | | | | | |
| 4 | | | | | | | | | | | | | | | | | | | | | | | |
| 5 | SOLD FOR TAXES | | | | 7 | | 236 | 04 | | 240 | | PAID IN FULL JUL 12 1960 | 11428 | | | | 240 | 06 | | | | | |
| 6 | | | | | | | | | | | | | | | | | | | | | | | |
| 7 | | | | | | | | | | | | | | | | | | | | | | | |
| 8 | | | | | | H 10 | 338 | | | 338 | | PAID IN FULL OCT 31 1960 | 17097 | | | | 338 | 12 | | | | 15486 | |
| 9 | | | | | | 59 | 1996 | 36 | | 2032 | | PAID IN FULL MAY 31 1960 | 13566 | | | 2032 | | | | | | 9950 | |
| 10 | | | | | | 18 | 610 | 12 | | 622 | | PAID IN FULL MAY 31 1960 | 13566 | | | 622 | | | | | | " | |
| 11 | | | | | | 94 | 3180 | 58 | | 3238 | | PAID IN FULL MAY 31 1960 | 13553 | | | 3238 | | | | | | 9955 | |
| 12 | | | | | | 59 | 1996 | 36 | | 2032 | | PAID IN FULL JUN 27 1960 | 10780 | | | | | | | | | 9954 | |
| 13 | | | | | | 83 | 2908 | 52 | | 2960 | | PAID IN FULL MAY 16 1960 | 6980 | | | 2960 | | | | | | 9952 | |
| 14 | | | | | | | | | | | | | | | | | | | | | | | |
| 15 | | | | | | 17 | 576 | 10 | | 586 | | PAID IN FULL MAY 31 1960 | 13545 | | | 586 | | | | | | 15489 | |
| 16 | | | | | | 199 | 6732 | 124 | | 6856 | | PAID IN FULL MAY 16 1960 | 6970 | | | 6856 | | | | | | 9953 | |
| 17 | | | | | | | | | | | | | | | | | | | | | | | |
| 18 | | | | | | | | | | | | | | | | | | | | | | | |
| 19 | | | | | | | | | | | | | | | | | | | | | | | |
| 20 | | | | | | | | | | | | | | | | | | | | | | | |

Sherr Shores

Richwood Shores

Brookman's Linden Beach

Logwood Sho

Assessment Roll and Tax List of Real Property in the Town of Inelipe

Form SCD MILLER-DAVIS CO., MINNEAPOLIS

Indicate Type of Property: R-Residential, C-Commercial, I-Industrial, U-Utility, F-Farm, L-Lakeshore, T-Timber, M-Mineral

110-27

Table with columns: IN WHOSE NAME ASSESSED, TO WHOM TRANSFERRED, DESCRIPTION OF PROPERTY, TRUE AND FULL VALUATIONS, ASSESSED VALUATIONS, and FINAL EQUALIZED VALUE.

Continued on next page

Cass County, Minnesota, for Taxes for the Year 1959.

Table with columns: SOLD FOR TAXES, VALUATIONS BY SCHOOL DISTRICTS AS EQUALIZED BY DEPARTMENT OF TAXATION, Tax including State Homestead, SPECIAL TAXES, TOTAL TAXES, PAID, WHEN PAID, Number of Receipt, March Settlement, June Settlement, November Settlement, Collections to First Monday in January 1961, Delinquent on First Monday in January 1961, Total Delinquent Tax and Penalty, REMARKS.

Over Shores

Brookman's Linden Beach

Jerwood Shores

Jerwood Shores

Assessment Roll and Tax List of Real Property in the Town of Icelips

Form SCD MILLER-DAVIE CO., MINNEAPOLIS

Indicate Type of Property: R-Residential, C-Commercial, I-Industrial, U-Utility, F-Farm, L-Lakeshore, T-Timber, M-Mineral

Cass County, Minnesota, for Taxes for the Year 1959.

Table with columns: IN WHOSE NAME ASSESSED, TO WHOM TRANSFERRED, DESCRIPTION OF PROPERTY, TRUE AND FULL VALUATIONS, ASSESSED VALUATIONS, and FINAL EQUALIZED VALUE. Includes handwritten entries for Chester + Reva Allen, John J. + Gloria Graham, Janet + Donald Brown, Eugene + La Donna Lilyquist, Clinton R. Lilyquist, and Lorraine + Kenneth R. Secora.

Table with columns: VALUATIONS BY SCHOOL DISTRICTS AS EQUALIZED BY DEPARTMENT OF TAXATION, Tax including State Homestead, State Tax on Non-Homestead, SPECIAL TAXES, TOTAL TAXES, PAID, WHEN PAID, Number of Receipt, March Settlement, June Settlement, November Settlement, Collections to First Monday in January 1961, Delinquent on First Monday in January 1961, Total Delinquent Tax and Penalty, and REMARKS. Includes handwritten entries for tax amounts and payment dates.

139-27
140-27

Over Shore
Birdwood Shores
Brookman's Linden Beach
Lagwood Shores

Assessment Roll and Tax List of Real Property in the Town of Inglewood

Form SCD MILLER-DAVIS CO., MINNEAPOLIS

Indicate Type of Property: R-Residential, C-Commercial, I-Industrial, U-Utility, F-Farm, L-Lakeshore, T-Timber, M-Mineral

Cass County, Minnesota, for Taxes for the Year 1959.

Table with columns: IN WHOSE NAME ASSESSED, TO WHOM TRANSFERRED, DESCRIPTION OF PROPERTY, TRUE AND FULL VALUATIONS, ASSESSED VALUATIONS, FINAL EQUALIZED VALUE. Includes rows 1-20 with property details and valuations.

Table with columns: SOLD FOR TAXES, VALUATIONS BY SCHOOL DISTRICTS AS EQUALIZED BY DEPARTMENT OF TAXATION, Tax Including State Homestead, State Tax on Non-Homestead, SPECIAL TAXES, TOTAL TAXES, PAID, WHEN PAID, Number of Receipt, March Settlement, June Settlement, November Settlement, Collections to First Monday in January, Delinquent on First Monday in January, Total Delinquent Tax and Penalty, REMARKS. Includes rows 1-20 with tax details and payment dates.

139-27

140-27

Lower Shores, Birchwood Shores, Brookman's Linden Beach, Logwood Shores

9942

9943

Assessment Roll and Tax List of Real Property in the Town of Inelipe

Form SCD MILLER-DAVIS CO., MINNEAPOLIS

Indicate Type of Property: R-Residential, C-Commercial, I-Industrial, U-Utility, F-Farm, L-Lakeshore, T-Timber, M-Mineral

Cass County, Minnesota, for Taxes for the Year 1959.

Table with columns: IN WHOSE NAME ASSESSED, TO WHOM TRANSFERRED, DESCRIPTION OF PROPERTY, TRUE AND FULL VALUATIONS, ASSESSED VALUATIONS, VALUATIONS BY SCHOOL DISTRICTS AS EQUALIZED BY DEPARTMENT OF TAXATION, TAXES, PAID, WHEN PAID, Number of Receipt, March Settlement, June Settlement, November Settlement, Collections to First Monday in January, Delinquent on First Monday in January, Total Delinquent Tax and Penalty, REMARKS.

Assessment Roll and Tax List of Real Property in the Town of Irles

Indicate Type of Property: R-Residential, C-Commercial, I-Industrial, U-Utility, F-Farm, L-Lakeshore, T-Timber, M-Mineral

Form 502 MILLER-DAVIS CO., MINNEAPOLIS

139-27

Table with columns: IN WHOSE NAME ASSESSED, TO WHOM TRANSFERRED, DESCRIPTION OF PROPERTY, TRUE AND FULL VALUATIONS, ASSESSED VALUATIONS, and FINAL EQUALIZED VALUE.

160

Cass County, Minnesota, for Taxes for the Year 1959.

Table with columns: VALUATIONS BY SCHOOL DISTRICTS AS EQUALIZED BY DEPARTMENT OF TAXATION, TAXES, PAID, WHEN PAID, and REMARKS.

Handwritten numbers: 24, 246, 270

8596 154

8750

4375 4375

Ever Shores

Birdwood Shores

Brookman's Linden Beach

Lagwood Shores

Assessment Roll and Tax List of Real Property in the Town of Irelips

Form 502 MILLER-DAVIS CO., MINNEAPOLIS

* Indicate Type of Property: R-Residential, C-Commercial, I-Industrial, U-Utility, F-Farm, L-Lakeshore, T-Timber, M-Mineral

Table with columns: IN WHOSE NAME ASSESSED, TO WHOM TRANSFERRED, DESCRIPTION OF PROPERTY, TRUE AND FULL VALUATIONS, ASSESSED VALUATIONS, FINAL EQUALIZED VALUE.

520

Cass County, Minnesota, for Taxes for the Year 1959.

Table with columns: SOLD FOR TAXES, VALUATIONS BY SCHOOL DISTRICTS AS EQUALIZED BY DEPARTMENT OF TAXATION, Tax including State Homestead, SPECIAL TAXES, TOTAL TAXES, PAID, WHEN PAID, Number of Receipt, March Settlement 1960, June Settlement 1960, Penalty, November Settlement 1960, Penalty, Collections to First Monday in January 1961, Penalty, Delinquent on First Monday in January 1961, Total Delinquent Tax and Penalty, REMARKS.

H. 625

19894

19894

10090

6303

2501

Shores, Brookman's Linden, Logwood Shor

Assessment Roll and Tax List of Real Property in the Town of Irelips

Indicate Type of Property: R-Residential, C-Commercial, I-Industrial, U-Utility, F-Farm, L-Lakeshore, T-Timber, M-Mineral

Form SCID 11-10-57

DESCRIPTION OF PROPERTY

TRUE AND FULL VALUATIONS

ASSESSED VALUATIONS

VALUATIONS BY SCHOOL DISTRICTS AS EQUALIZED BY DEPARTMENT OF TAXATION

Table with columns: IN WHOSE NAME ASSESSED, TO WHOM TRANSFERRED, SUBDIVISION, TRUE AND FULL VALUATIONS (LAND, BUILDINGS, MACHINERY, TOTAL), ASSESSED VALUATIONS (RURAL, ALL OTHER, MACHINERY, TOTAL), FINAL EQUALIZED VALUE.

Cass County, Minnesota, for Taxes for the Year 1959.

Table with columns: SOLD FOR TAXES, VALUATIONS BY SCHOOL DISTRICTS AS EQUALIZED BY DEPARTMENT OF TAXATION, Tax including State Homestead, SPECIAL TAXES, TOTAL TAXES, PAID, WHEN PAID, Number of Receipt, March Settlement, June Settlement, Penalty, November Settlement, Collections to First Monday in January, Delinquent on First Monday in January, Total Delinquent Tax and Penalty, REMARKS.

Assessment Roll and Tax List of Real Property in the Town of Isleipe

Form SCD 11-10-57 REV. 5-10-57, MINNAPOLIS

* Indicate Type of Property: R-Residential, C-Commercial, I-Industrial, U-Utility, F-Farm, L-Lakeshore, T-Timber, M-Mineral

Cass County, Minnesota, for Taxes for the Year 1959.

| IN WHOSE NAME ASSESSED | TO WHOM TRANSFERRED | DESCRIPTION OF PROPERTY | | | | | No. School District | Indicate Homestead Yes or No | Indicate Agricultural Yes or No | Indicate Type of Property | TRUE AND FULL VALUATIONS | | | | | | Total Assessed Value as Equalized by the Board of Review | FINAL EQUALIZED VALUE | |
|------------------------|---------------------|-------------------------|------------------|---------------|---------|-------------------------|---------------------|------------------------------|---------------------------------|---------------------------|---------------------------|-------------------------|--------------------------------|-------------------------|--------------------------------|---|--|-----------------------|----------------------|
| | | SUBDIVISION | Sec. or Lot | Town or Block | Rng. | Number of Acres of Land | | | | | TOTAL True and Full Value | RURAL | | ALL OTHER | | MACHINERY Permanently Attached to Real Estate | | | TOTAL ASSESSED VALUE |
| | | | | | | | | | | | | Homestead Up to \$4,000 | Over \$4,000 and Non-Homestead | Homestead Up to \$1,000 | Over \$1,000 and Non-Homestead | | | | |
| | | | | | | | | | | | | 20% | 33 1/3% | 25% | 40% | | | | |
| Dollars | Dollars | Dollars | Dollars | Dollars | Dollars | Dollars | Dollars | Dollars | Dollars | Dollars | Dollars | Dollars | Dollars | | | | | | |
| State of Minnesota | | 1 | NE 1/4 of NE 1/4 | 12 | 140 | 27 | | | | | | | | | | | | | |
| State of Minnesota | | 2 | NW 1/4 of NE 1/4 | | | | | | | | | | | | | | | | |
| State of Minnesota | | 3 | SW 1/4 of NE 1/4 | | | | | | | | | | | | | | | | |
| State of Minnesota | | 4 | SE 1/4 of NE 1/4 | | | | | | | | | | | | | | | | |
| State of Minnesota | | 5 | | | | | | | | | | | | | | | | | |
| State of Minnesota | | 6 | NE 1/4 of NW 1/4 | | | | | | | | | | | | | | | | |
| State of Minnesota | | 7 | NW 1/4 of NW 1/4 | | | | | | | | | | | | | | | | |
| State of Minnesota | | 8 | SW 1/4 of NW 1/4 | | | | | | | | | | | | | | | | |
| State of Minnesota | | 9 | SE 1/4 of NW 1/4 | | | | | | | | | | | | | | | | |
| State of Minnesota | | 10 | | | | | | | | | | | | | | | | | |
| State of Minnesota | | 11 | NE 1/4 of SW 1/4 | | | | | | | | | | | | | | | | |
| State of Minnesota | | 12 | NW 1/4 of SW 1/4 | | | | | | | | | | | | | | | | |
| State of Minnesota | | 13 | SW 1/4 of SW 1/4 | | | | | | | | | | | | | | | | |
| State of Minnesota | | 14 | SE 1/4 of SW 1/4 | | | | | | | | | | | | | | | | |
| State of Minnesota | | 15 | | | | | | | | | | | | | | | | | |
| State of Minnesota | | 16 | NE 1/4 of SE 1/4 | | | | | | | | | | | | | | | | |
| State of Minnesota | | 17 | NW 1/4 of SE 1/4 | | | | | | | | | | | | | | | | |
| State of Minnesota | | 18 | SW 1/4 of SE 1/4 | | | | | | | | | | | | | | | | |
| State of Minnesota | | 19 | SE 1/4 of SE 1/4 | | | | | | | | | | | | | | | | |
| State of Minnesota | | 20 | | | | | | | | | | | | | | | | | |

| SOLD FOR TAXES | VALUATIONS BY SCHOOL DISTRICTS AS EQUALIZED BY DEPARTMENT OF TAXATION | | | | | | Tax including State Homestead | State Tax on Non-Homestead | SPECIAL TAXES | TOTAL TAXES | PAID | WHEN PAID | Number of Receipt | March Settlement 1960 | June Settlement 1960 | Penalty | November Settlement 1960 | Penalty | Collections to First Monday in January 1961 | Penalty | Delinquent on First Monday in January 1961 | Total Delinquent Tax and Penalty | REMARKS |
|----------------|---|--------------|--------------|--------------|--------------|--------------|-------------------------------|----------------------------|---------------|-------------|------|-----------|-------------------|-----------------------|----------------------|---------|--------------------------|---------|---|---------|--|----------------------------------|---------|
| | District No. | District No. | District No. | District No. | District No. | District No. | | | | | | | | | | | | | | | | | |
| | Rate | Rate | Rate | Rate | Rate | Rate | | | | | | | | | | | | | | | | | |
| | Mills | Mills | Mills | Mills | Mills | Mills | | | | | | | | | | | | | | | | | |
| | | | | | | \$ | cts. | \$ | cts. | \$ | cts. | \$ | cts. | | | | | | | | | | |
| 1 | | | | | | | | | | | | | | | | | | | | | | | |
| 2 | | | | | | | | | | | | | | | | | | | | | | | |
| 3 | | | | | | | | | | | | | | | | | | | | | | | |
| 4 | | | | | | | | | | | | | | | | | | | | | | | |
| 5 | | | | | | | | | | | | | | | | | | | | | | | |
| 6 | | | | | | | | | | | | | | | | | | | | | | | |
| 7 | | | | | | | | | | | | | | | | | | | | | | | |
| 8 | | | | | | | | | | | | | | | | | | | | | | | |
| 9 | | | | | | | | | | | | | | | | | | | | | | | |
| 10 | | | | | | | | | | | | | | | | | | | | | | | |
| 11 | | | | | | | | | | | | | | | | | | | | | | | |
| 12 | | | | | | | | | | | | | | | | | | | | | | | |
| 13 | | | | | | | | | | | | | | | | | | | | | | | |
| 14 | | | | | | | | | | | | | | | | | | | | | | | |
| 15 | | | | | | | | | | | | | | | | | | | | | | | |
| 16 | | | | | | | | | | | | | | | | | | | | | | | |
| 17 | | | | | | | | | | | | | | | | | | | | | | | |
| 18 | | | | | | | | | | | | | | | | | | | | | | | |
| 19 | | | | | | | | | | | | | | | | | | | | | | | |
| 20 | | | | | | | | | | | | | | | | | | | | | | | |

110-27

Lower Shores, Parkwood Shores, Brookman's Linden Beach, Lakewood Shores

Assessment Roll and Tax List of Real Property in the Town of Inelipe, Cass County, Minnesota, for Taxes for the Year 1959.

Form SCD WILLIAMSON COMPANY, MINNEAPOLIS

Indicate Type of Property: R-Residential, C-Commercial, I-Industrial, U-Utility, F-Farm, L-Lakeshore, T-Timber, M-Mineral

Table with columns: IN WHOSE NAME ASSESSED, TO WHOM TRANSFERRED, SUBDIVISION, TRUE AND FULL VALUATIONS, ASSESSED VALUATIONS (RURAL, ALL OTHER), TOTAL ASSESSED VALUE, and FINAL EQUALIZED VALUE.

Cass County, Minnesota, for Taxes for the Year 1959.

Table with columns: VALUATIONS BY SCHOOL DISTRICTS AS EQUALIZED BY DEPARTMENT OF TAXATION, TAX including State Homestead, SPECIAL TAXES, TOTAL TAXES, PAID, WHEN PAID, Number of Receipt, March Settlement 1960, June Settlement 1960, November Settlement 1960, Penalty, Collections to First Monday in January 1961, Delinquent on First Monday in January 1961, Total Delinquent Tax and Penalty, REMARKS.

139-27
110-27

Lower Shores
Birdwood Shores
Brookman's Linden
Logwood Shores

Assessment Roll and Tax List of Real Property in the Town of Irish

Cass County, Minnesota, for Taxes for the Year 1959.

Form SCD 5-11-55 REVISED, MINNAPOLIS

* Indicate Type of Property: R-Residential, C-Commercial, I-Industrial, U-Utility, F-Farm, L-Lakeshore, T-Timber, M-Mineral

| IN WHOSE NAME ASSESSED | TO WHOM TRANSFERRED | SUBDIVISION | Sec. or Lot | Town or Block | Rng. | Number of Acres of Land Acres 100ths | No. School District | Indicate Homestead Yes or No | Indicate Agricultural Yes or No | Indicate Type of Property | TRUE AND FULL VALUATIONS | | | ASSESSED VALUATIONS | | | | | | FINAL EQUALIZED VALUE | | | | |
|------------------------------|---------------------|------------------|-------------|---------------|------|---|---------------------|------------------------------|---------------------------------|---------------------------|---|--------------------------------|---|---------------------------|-------|--|-----------|--|--|-----------------------|---|----------------------|--|--|
| | | | | | | | | | | | LAND Exclusive of Structures and Improvements | BUILDINGS and Other Structures | MACHINERY Permanently Attached to Real Estate | TOTAL True and Full Value | RURAL | | ALL OTHER | | | | MACHINERY Permanently Attached to Real Estate | TOTAL ASSESSED VALUE | Total Assessed Value as Equalized by the Board of Review | |
| State of Minnesota | | NE 1/4 of NE 1/4 | | | | 15 140 27 | | | | | | | | | | | | | | | | | | |
| State of Minnesota | | NW 1/4 of NE 1/4 | | | | | | | | | | | | | | | | | | | | | | |
| State of Minnesota | | SW 1/4 of NE 1/4 | | | | | | | | | | | | | | | | | | | | | | |
| State of Minnesota | | SE 1/4 of NE 1/4 | | | | | | | | | | | | | | | | | | | | | | |
| State of Minnesota | | NE 1/4 of NW 1/4 | | | | | | | | | | | | | | | | | | | | | | |
| State of Minnesota | | NW 1/4 of NW 1/4 | | | | | | | | | | | | | | | | | | | | | | |
| State of Minnesota | | SW 1/4 of NW 1/4 | | | | | | | | | | | | | | | | | | | | | | |
| State of Minnesota | | SE 1/4 of NW 1/4 | | | | | | | | | | | | | | | | | | | | | | |
| The Trustees of Iowa College | | NE 1/4 of SW 1/4 | | | | 40 | 770 | | | F | | | | | | | | | | | | | | |
| " " " " | | NW 1/4 of SW 1/4 | | | | 40 | 770 | | | " " | | | | | | | | | | | | | | |
| " " " " | | SW 1/4 of SW 1/4 | | | | 40 | 770 | | | " " | | | | | | | | | | | | | | |
| " " " " | | SE 1/4 of SW 1/4 | | | | 40 | 770 | | | " " | | | | | | | | | | | | | | |
| State of Minnesota | | NE 1/4 of SE 1/4 | | | | | | | | | | | | | | | | | | | | | | |
| State of Minnesota | | NW 1/4 of SE 1/4 | | | | | | | | | | | | | | | | | | | | | | |
| State of Minnesota | | SW 1/4 of SE 1/4 | | | | | | | | | | | | | | | | | | | | | | |
| State of Minnesota | | SE 1/4 of SE 1/4 | | | | | | | | | | | | | | | | | | | | | | |
| | | | | | | 160 | | | | | | | | | | | | | | | | | | |

| SOLD FOR TAXES | VALUATIONS BY SCHOOL DISTRICTS AS EQUALIZED BY DEPARTMENT OF TAXATION | | | | | | Tax including State Homestead | State Tax on Non-Homestead | SPECIAL TAXES | TOTAL TAXES | PAID | WHEN PAID | Number of Receipt | March Settlement 1960 | June Settlement 1960 | November Settlement 1960 | November Penalty | Collections to First Monday in January 1961 | Penalty | Delinquent on First Monday in January 1961 | Total Delinquent Tax and Penalty | REMARKS | |
|----------------|---|--------------|--------------|--------------|--------------|--------------|-------------------------------|----------------------------|---------------|-------------|------|-----------|-------------------|-----------------------|----------------------|--------------------------|------------------|---|---------|--|----------------------------------|---------|------|
| | District No. | District No. | District No. | District No. | District No. | District No. | | | | | | | | | | | | | | | | | Rate |
| | | | | | | | | | | | | | | | | | | | | | | | |
| | | | | | | | | | | | | | | | | | | | | | | | |
| | | | | | | | | | | | | | | | | | | | | | | | |
| | | | | | | | | | | | | | | | | | | | | | | | |
| | | | | | | | | | | | | | | | | | | | | | | | |
| | | | | | | | | | | | | | | | | | | | | | | | |
| | | | | | | | | | | | | | | | | | | | | | | | |
| | | | | | | | | | | | | | | | | | | | | | | | |
| | | | | | | | | | | | | | | | | | | | | | | | |
| | | | | | | | | | | | | | | | | | | | | | | | |
| | | | | | | | | | | | | | | | | | | | | | | | |
| | | | | | | | | | | | | | | | | | | | | | | | |
| | | | | | | | | | | | | | | | | | | | | | | | |
| | | | | | | | | | | | | | | | | | | | | | | | |
| | | | | | | | | | | | | | | | | | | | | | | | |
| | | | | | | | | | | | | | | | | | | | | | | | |
| | | | | | | | | | | | | | | | | | | | | | | | |
| | | | | | | | | | | | | | | | | | | | | | | | |

Over Shores
Parkwood Shores
Brookman's Linden Beach
Logwood Shore

Assessment Roll and Tax List of Real Property in the Town of Icelia,

Cass County, Minnesota, for Taxes for the Year 1959.

Form SCD 11-15-58 REV. 1-1-59. Indicate Type of Property: R-Residential, C-Commercial, I-Industrial, U-Utility, F-Farm, L-Lakeshore, T-Timber, M-Mineral

Table with columns: IN WHOSE NAME ASSESSED, TO WHOM TRANSFERRED, SUBDIVISION, Sec. of Lot, Town or Block, Rng., Number of Acres of Land, TRUE AND FULL VALUATIONS (RURAL, ALL OTHER), ASSESSED VALUATIONS (LAND, BUILDINGS, MACHINERY, TOTAL, RURAL, ALL OTHER, MACHINERY), VALUATIONS BY SCHOOL DISTRICTS, SPECIAL TAXES, TOTAL TAXES, PAID, WHEN PAID, Number of Receipt, March, June, November Settlements, Collections to First Monday, Delinquent on First Monday, Total Delinquent Tax and Penalty, REMARKS.

139-27

140-27

Ger Shores

Birdwood Shores

Brookman's Linden Beach

Logwood Shore

Assessment Roll and Tax List of Real Property in the Town of Tralips,

Form SCD MILLER-DAVIS CO., MINNEAPOLIS

* Indicate Type of Property: R-Residential, C-Commercial, I-Industrial, U-Utility, F-Farm, L-Lakeshore, T-Timber, M-Mineral

| IN WHOSE NAME ASSESSED | TO WHOM TRANSFERRED | DESCRIPTION OF PROPERTY | | | | No. School District | Indicate Homestead Tax or No. | Indicate Agricultural Tax or No. | Indicate Type of Property | TRUE AND FULL VALUATIONS | | | | | ASSESSED VALUATIONS | | | | | FINAL EQUALIZED VALUE | | |
|------------------------|---------------------|-------------------------|-------------|---------------|----------------------|---------------------|-------------------------------|----------------------------------|---------------------------|---|--------------------------------|---|---------------------------|-------|---------------------|--------------------------------|---|-----------------------------|----------------------|-----------------------|--|--------------------------------|
| | | SUBDIVISION | Sec. or Lot | Town or Block | No. of Acres of Land | | | | | LAND Exclusive of Structures and Improvements | BUILDINGS and Other Structures | MACHINERY Permanently Attached to Real Estate | TOTAL True and Full Value | RURAL | | ALL OTHER | | | TOTAL ASSESSED VALUE | | Total Assessed Value as Equalized by the Board of Review | |
| | | | | | | | | | | | | | | Acres | 100ths | Homestead Up to \$4,000 20% | Over \$4,000 and Non-Homestead 33 1/3% | Timber Land Class 3e 20% | | | | Homestead Up to \$4,000 25% |
| State of Minnesota | | 1 | | | NE 1/4 of NE 1/4 | 18 140 27 | Un | | | | | | | | | | | | | | | |
| State of Minnesota | | 2 | | | NW 1/4 of NE 1/4 | | | | | | | | | | | | | | | | | |
| State of Minnesota | | 3 | | | SW 1/4 of NE 1/4 | | | | | | | | | | | | | | | | | |
| State of Minnesota | | 4 | | | SE 1/4 of NE 1/4 | | | | | | | | | | | | | | | | | |
| State of Minnesota | | 5 | | | | | | | | | | | | | | | | | | | | |
| State of Minnesota | | 6 | | | NE 1/4 of NW 1/4 | | | | | | | | | | | | | | | | | |
| State of Minnesota | | 7 | | | NW 1/4 of NW 1/4 | | | | | | | | | | | | | | | | | |
| State of Minnesota | | 8 | | | SW 1/4 of NW 1/4 | | | | | | | | | | | | | | | | | |
| State of Minnesota | | 9 | | | SE 1/4 of NW 1/4 | | | | | | | | | | | | | | | | | |
| State of Minnesota | | 10 | | | | | | | | | | | | | | | | | | | | |
| State of Minnesota | | 11 | | | NE 1/4 of SW 1/4 | | | | | | | | | | | | | | | | | |
| State of Minnesota | | 12 | | | NW 1/4 of SW 1/4 | | | | | | | | | | | | | | | | | |
| State of Minnesota | | 13 | | | SW 1/4 of SW 1/4 | | | | | | | | | | | | | | | | | |
| State of Minnesota | | 14 | | | SE 1/4 of SW 1/4 | | | | | | | | | | | | | | | | | |
| State of Minnesota | | 15 | | | | | | | | | | | | | | | | | | | | |
| State of Minnesota | | 16 | | | NE 1/4 of SE 1/4 | | | | | | | | | | | | | | | | | |
| State of Minnesota | | 17 | | | NW 1/4 of SE 1/4 | | | | | | | | | | | | | | | | | |
| State of Minnesota | | 18 | | | SW 1/4 of SE 1/4 | | | | | | | | | | | | | | | | | |
| State of Minnesota | | 19 | | | SE 1/4 of SE 1/4 | | | | | | | | | | | | | | | | | |
| | | 20 | | | | | | | | | | | | | | | | | | | | |

Cass County, Minnesota, for Taxes for the Year 1959.

| SOLD FOR TAXES | VALUATIONS BY SCHOOL DISTRICTS AS EQUALIZED BY DEPARTMENT OF TAXATION | | | | | | Tax including State Homestead | State Tax on Non-Homestead | SPECIAL TAXES | TOTAL TAXES | PAID | WHEN PAID | Number of Receipt | March Settlement 1960 | June Settlement 1960 | Penalty | November Settlement 1960 | Penalty | Collections to First Monday in January 1961 | Penalty | Delinquent on First Monday in January 1961 | Total Delinquent Tax and Penalty | REMARKS | | | | | | | | | | | | | | | |
|----------------|---|--------------|--------------|--------------|--------------|--------------|-------------------------------|----------------------------|---------------|-------------|------|-----------|-------------------|-----------------------|----------------------|---------|--------------------------|---------|---|---------|--|----------------------------------|---------|-------|-------|-------|-------|-------|-------|-------|-------|-------|-------|-------|-------|-------|-------|-------|
| | District No. | District No. | District No. | District No. | District No. | District No. | | | | | | | | | | | | | | | | | | Rate | Rate | Rate | Rate | Rate | Rate | Rate | Rate | Rate | Rate | Rate | Rate | Rate | Rate | Rate |
| | No. | No. | No. | No. | No. | No. | | | | | | | | | | | | | | | | | | Mills | Mills | Mills | Mills | Mills | Mills | Mills | Mills | Mills | Mills | Mills | Mills | Mills | Mills | Mills |
| | | | | | | | | | | | | | | | | | | | | | | | | | | | | | | | | | | | | | | |
| | | | | | | | | | | | | | | | | | | | | | | | | | | | | | | | | | | | | | | |
| | | | | | | | | | | | | | | | | | | | | | | | | | | | | | | | | | | | | | | |
| | | | | | | | | | | | | | | | | | | | | | | | | | | | | | | | | | | | | | | |
| | | | | | | | | | | | | | | | | | | | | | | | | | | | | | | | | | | | | | | |
| | | | | | | | | | | | | | | | | | | | | | | | | | | | | | | | | | | | | | | |
| | | | | | | | | | | | | | | | | | | | | | | | | | | | | | | | | | | | | | | |
| | | | | | | | | | | | | | | | | | | | | | | | | | | | | | | | | | | | | | | |
| | | | | | | | | | | | | | | | | | | | | | | | | | | | | | | | | | | | | | | |
| | | | | | | | | | | | | | | | | | | | | | | | | | | | | | | | | | | | | | | |
| | | | | | | | | | | | | | | | | | | | | | | | | | | | | | | | | | | | | | | |
| | | | | | | | | | | | | | | | | | | | | | | | | | | | | | | | | | | | | | | |
| | | | | | | | | | | | | | | | | | | | | | | | | | | | | | | | | | | | | | | |
| | | | | | | | | | | | | | | | | | | | | | | | | | | | | | | | | | | | | | | |
| | | | | | | | | | | | | | | | | | | | | | | | | | | | | | | | | | | | | | | |
| | | | | | | | | | | | | | | | | | | | | | | | | | | | | | | | | | | | | | | |
| | | | | | | | | | | | | | | | | | | | | | | | | | | | | | | | | | | | | | | |
| | | | | | | | | | | | | | | | | | | | | | | | | | | | | | | | | | | | | | | |
| | | | | | | | | | | | | | | | | | | | | | | | | | | | | | | | | | | | | | | |
| | | | | | | | | | | | | | | | | | | | | | | | | | | | | | | | | | | | | | | |
| | | | | | | | | | | | | | | | | | | | | | | | | | | | | | | | | | | | | | | |
| | | | | | | | | | | | | | | | | | | | | | | | | | | | | | | | | | | | | | | |
| | | | | | | | | | | | | | | | | | | | | | | | | | | | | | | | | | | | | | | |

River Shores, Birchwood Shores, Brookman's Linden Beach, Logwood Shores

Assessment Roll and Tax List of Real Property in the Town of Iselips,

Cass County, Minnesota, for Taxes for the Year 1959.

Form 3CD MILLER-DAVIS CO., MINNEAPOLIS

* Indicate Type of Property: R-Residential, C-Commercial, I-Industrial, U-Utility, F-Farm, L-Lakeshore, T-Timber, M-Mineral

| IN WHOSE NAME ASSESSED | TO WHOM TRANSFERRED | DESCRIPTION OF PROPERTY | | | | | No. School District | Indicate Homestead Yes or No | Indicate Agricultural Use Yes or No | Indicate Type of Property | TRUE AND FULL VALUATIONS | | | | | | | | | | | | FINAL EQUALIZED VALUE | | | |
|-------------------------|---------------------|-----------------------------|-------------|---------------|------|---|---------------------|------------------------------|-------------------------------------|---------------------------|---|--------------------------------|---|---------------------------|-------|----------------------|--|---------|-----------|--|--|--|-----------------------|--|--|--|
| | | SUBDIVISION | Sec. or Lot | Town or Block | Rng. | Number of Acres of Land Acres 100ths | | | | | ASSESSED VALUATIONS | | | | | TOTAL ASSESSED VALUE | Total Assessed Value as Equalized by the Board of Review | Dollars | | | | | | | | |
| | | | | | | | | | | | LAND EXCLUSIVE OF STRUCTURES AND IMPROVEMENTS | BUILDINGS AND OTHER STRUCTURES | MACHINERY Permanently Attached to Real Estate | TOTAL True and Full Value | RURAL | | | | ALL OTHER | | | | | | | |
| State of Minnesota | | NEW of NEW | 19 | 140 | 27 | | | | | | | | | | | | | | | | | | | | | |
| State of Minnesota | | NW 1/4 of NEW | | | | | | | | | | | | | | | | | | | | | | | | |
| The Northwest Paper Co. | | SW 1/4 of NEW | | | | 40 | | 770 | | T | | | | | | | | | | | | | | | | |
| " | " | SE 1/4 of NEW | | | | 40 | | 770 | | " | | | | | | | | | | | | | | | | |
| State of Minnesota | | NEW of NEW | | | | | | | | | | | | | | | | | | | | | | | | |
| State of Minnesota | | NW 1/4 of NW 1/4 East Lot 1 | | | | | | | | | | | | | | | | | | | | | | | | |
| State of Minnesota | | SW 1/4 of NW 1/4 East Lot 2 | | | | | | | | | | | | | | | | | | | | | | | | |
| State of Minnesota | | SE 1/4 of NW 1/4 | | | | | | | | | | | | | | | | | | | | | | | | |
| State of Minnesota | | NE 1/4 of SW 1/4 | | | | | | | | | | | | | | | | | | | | | | | | |
| State of Minnesota | | NW 1/4 of SW 1/4 East Lot 3 | | | | | | | | | | | | | | | | | | | | | | | | |
| State of Minnesota | | SW 1/4 of SW 1/4 East Lot 4 | | | | | | | | | | | | | | | | | | | | | | | | |
| State of Minnesota | | SE 1/4 of SW 1/4 | | | | | | | | | | | | | | | | | | | | | | | | |
| The Northwest Paper Co. | | NE 1/4 of SE 1/4 | | | | 40 | | 770 | | T | | | | | | | | | | | | | | | | |
| " | " | NW 1/4 of SE 1/4 | | | | 40 | | 770 | | " | | | | | | | | | | | | | | | | |
| " | " | SW 1/4 of SE 1/4 | | | | 40 | | 770 | | " | | | | | | | | | | | | | | | | |
| " | " | SE 1/4 of SE 1/4 | | | | 40 | | 770 | | " | | | | | | | | | | | | | | | | |
| | | | | | | 240 | | | | | | | | | | | | | | | | | | | | |

| SOLD FOR TAXES | VALUATIONS BY SCHOOL DISTRICTS AS EQUALIZED BY DEPARTMENT OF TAXATION | | | | | | Tax including State Homestead | State Tax on Non-Homestead | SPECIAL TAXES | TOTAL TAXES | PAID | WHEN PAID | Number of Receipt | March Settlement 1960 | June Settlement 1960 | Penalty | November Settlement 1960 | Penalty | Collections to First Monday in January 1961 | Penalty | Delinquent on First Monday in January 1961 | Total Delinquent Tax and Penalty | REMARKS | | |
|----------------|---|----------------|----------------|----------------|----------------|----------------|-------------------------------|----------------------------|---------------|-------------|------|-----------|-------------------|-----------------------|----------------------|---------|--------------------------|---------|---|---------|--|----------------------------------|---------|--|--|
| | District No. | District No. | District No. | District No. | District No. | District No. | | | | | | | | | | | | | | | | | | | |
| | Rate.....Mills | Rate.....Mills | Rate.....Mills | Rate.....Mills | Rate.....Mills | Rate.....Mills | | | | | | | | | | | | | | | | | | | |
| 1 | | | | | | | | | | | | | | | | | | | | | | | | | |
| 2 | | | | | | | | | | | | | | | | | | | | | | | | | |
| 3 | | | | | | | 66 | 21 00 | 40 | 21 40 | | | | | | | | | | | | | | | |
| 4 | | | | | | | 66 | 21 00 | 40 | 21 40 | | | | | | | | | | | | | | | |
| 5 | | | | | | | | | | | | | | | | | | | | | | | | | |
| 6 | | | | | | | | | | | | | | | | | | | | | | | | | |
| 7 | | | | | | | | | | | | | | | | | | | | | | | | | |
| 8 | | | | | | | | | | | | | | | | | | | | | | | | | |
| 9 | | | | | | | | | | | | | | | | | | | | | | | | | |
| 10 | | | | | | | | | | | | | | | | | | | | | | | | | |
| 11 | | | | | | | | | | | | | | | | | | | | | | | | | |
| 12 | | | | | | | | | | | | | | | | | | | | | | | | | |
| 13 | | | | | | | | | | | | | | | | | | | | | | | | | |
| 14 | | | | | | | | | | | | | | | | | | | | | | | | | |
| 15 | | | | | | | | | | | | | | | | | | | | | | | | | |
| 16 | | | | | | | | | | | | | | | | | | | | | | | | | |
| 17 | | | | | | | | | | | | | | | | | | | | | | | | | |
| 18 | | | | | | | | | | | | | | | | | | | | | | | | | |
| 19 | | | | | | | | | | | | | | | | | | | | | | | | | |
| 20 | | | | | | | | | | | | | | | | | | | | | | | | | |
| | | | | | | 396 | | | | | | 12608 | 248 | 12856 | | | | | | | | | | | |

14955

14955

Over Shores

Marquette Shores

Brookman's Linden Beach

Logwood Shore

Assessment Roll and Tax List of Real Property in the Town of Irelise

Indicate Type of Property: R-Residential, C-Commercial, I-Industrial, U-Utility, F-Farm, L-Lakeshore, T-Timber, M-Mineral

Cass County, Minnesota, for Taxes for the Year 1959.

Form SCD MILLER-DAVIS CO., MINNEAPOLIS

Table with columns: IN WHOSE NAME ASSESSED, TO WHOM TRANSFERRED, DESCRIPTION OF PROPERTY, TRUE AND FULL VALUATIONS (RURAL, ALL OTHER, MACHINERY), ASSESSED VALUATIONS, TOTAL ASSESSED VALUE, FINAL EQUALIZED VALUE. Includes rows for State of Minnesota and The Northwest Paper Co.

Table with columns: SOLD FOR TAXES, VALUATIONS BY SCHOOL DISTRICTS AS EQUALIZED BY DEPARTMENT OF TAXATION, Tax including State Homestead, State Tax on Non-Homestead, SPECIAL TAXES, TOTAL TAXES, PAID, WHEN PAID, Number of Receipt, March Settlement 1960, June Settlement 1960, November Settlement 1960, Collections to First Monday in January 1961, Delinquent on First Monday in January 1961, Total Delinquent Tax and Penalty, REMARKS. Includes handwritten entries for 1960 payments and 1959 tax amounts.

Assessment Roll and Tax List of Real Property in the Town of Inelike

Form SCD MILLER-DAVIS CO., MINNEAPOLIS

* Indicate Type of Property: R-Residential, C-Commercial, I-Industrial, U-Utility, F-Farm, L-Lakeshore, T-Timber, M-Mineral

Table with columns: IN WHOSE NAME ASSESSED, TO WHOM TRANSFERRED, DESCRIPTION OF PROPERTY, TRUE AND FULL VALUATIONS, ASSESSED VALUATIONS, and FINAL EQUALIZED VALUE. Includes handwritten entries for B. F. Nelson Mining + Land Co. and State of Minnesota.

Cass County, Minnesota, for Taxes for the Year 1959.

Table with columns: SOLD FOR TAXES, VALUATIONS BY SCHOOL DISTRICTS AS EQUALIZED BY DEPARTMENT OF TAXATION, SPECIAL TAXES, TOTAL TAXES, PAID, WHEN PAID, Number of Receipt, March Settlement 1960, June Settlement 1960, November Settlement 1960, Penalty, Collections to First Monday in January 1961, Delinquent on First Monday in January 1961, Total Delinquent Tax and Penalty, and REMARKS. Includes handwritten tax amounts and payment dates.

139-27

140-27

Shores

Shores

Shores

Shores

Assessment Roll and Tax List of Real Property in the Town of Irelize

Indicate Type of Property: R-Residential, C-Commercial, I-Industrial, U-Utility, F-Farm, L-Lakeshore, T-Timber, M-Mineral

Table with columns: IN WHOSE NAME ASSESSED, TO WHOM TRANSFERRED, SUBDIVISION, TRUE AND FULL VALUATIONS (RURAL, ALL OTHER, MACHINERY), ASSESSED VALUATIONS, FINAL EQUALIZED VALUE.

Cass County, Minnesota, for Taxes for the Year 1959.

Table with columns: SOLD FOR TAXES, VALUATIONS BY SCHOOL DISTRICTS AS EQUALIZED BY DEPARTMENT OF TAXATION, Tax including State Homestead, State Tax on Non-Homestead, SPECIAL TAXES, TOTAL TAXES, PAID, WHEN PAID, Number of Receipt, March Settlement, June Settlement, November Settlement, Collections to First Monday in January, Delinquent on First Monday in January, Total Delinquent Tax and Penalty, REMARKS.

139-27

140-27

Super Shores

Stratwood Shores

Brookman's Linden Beach

Lagwood Shores

Assessment Roll and Tax List of Real Property in the Town of Trilipes, Cass County, Minnesota, for Taxes for the Year 1959.

Form SCID 1959-1-10-59, MINNAPOLA. Indicate Type of Property: R-Residential, C-Commercial, I-Industrial, U-Utility, F-Farm, L-Lakeshore, T-Timber, M-Mineral

Table with columns: IN WHOSE NAME ASSESSED, TO WHOM TRANSFERRED, DESCRIPTION OF PROPERTY, TRUE AND FULL VALUATIONS, ASSESSED VALUATIONS, and FINAL EQUALIZED VALUE.

Table with columns: VALUATIONS BY SCHOOL DISTRICTS AS EQUALIZED BY DEPARTMENT OF TAXATION, Tax including State Homestead, State Tax on Non-Homestead, SPECIAL TAXES, TOTAL TAXES, PAID, WHEN PAID, Number of Receipt, March Settlement 1960, June Settlement 1960, November Settlement 1960, Collections to First Monday in January 1961, Delinquent on First Monday in January 1961, Total Delinquent Tax and Penalty, REMARKS.

Vertical text on the right edge of the page, including names and addresses such as 'Shore Shores', 'Birdwood Shores', 'Brookman's Linden Beach', and 'Logwood Shore'.

Assessment Roll and Tax List of Real Property in the Town of Iselipe

* Indicate Type of Property: R-Residential, C-Commercial, I-Industrial, U-Utility, F-Farm, L-Lakeshore, T-Timber, M-Mineral

Form 3CD - MINN. STATE TAX DEPARTMENT, BUREAU OF TAXATION

Table with columns: IN WHOSE NAME ASSESSED, TO WHOM TRANSFERRED, DESCRIPTION OF PROPERTY, TRUE AND FULL VALUATIONS (LAND, BUILDINGS, MACHINERY, TOTAL), ASSESSED VALUATIONS (RURAL, ALL OTHER, MACHINERY, TOTAL ASSESSED VALUE), FINAL EQUALIZED VALUE.

Cass County, Minnesota, for Taxes for the Year 1959.

Table with columns: SOLD FOR TAXES, VALUATIONS BY SCHOOL DISTRICTS AS EQUALIZED BY DEPARTMENT OF TAXATION, Tax including State Homestead, State Tax on Non-Homestead, SPECIAL TAXES, TOTAL TAXES, PAID, WHEN PAID, Number of Receipt, March Settlement 1960, June Settlement 1960, November Settlement 1960, Penalty, Collections to First Monday in January 1961, Delinquent on First Monday in January 1961, Total Delinquent Tax and Penalty, REMARKS.

140-27

Town Shores

Birdwood Shores

Brookman's Linden Beach

Logwood Shores

Assessment Roll and Tax List of Real Property in the Town of Trilisa

* Indicate Type of Property: R-Residential, C-Commercial, I-Industrial, U-Utility, F-Farm, L-Lakeshore, T-Timber, M-Mineral

Form SCD 11-10-57 REVISED EDITION, MINNEAPOLIS

Table with columns: IN WHOSE NAME ASSESSED, TO WHOM TRANSFERRED, DESCRIPTION OF PROPERTY, TRUE AND FULL VALUATIONS, ASSESSED VALUATIONS, and FINAL EQUALIZED VALUE. Includes handwritten entries for 'The Northwest Paper Co.' and 'State of Minnesota'.

Cass County, Minnesota, for Taxes for the Year 1959.

Table with columns: SOLD FOR TAXES, VALUATIONS BY SCHOOL DISTRICTS AS EQUALIZED BY DEPARTMENT OF TAXATION, SPECIAL TAXES, TOTAL TAXES, PAID, WHEN PAID, and REMARKS. Includes handwritten entries for 'PAID IN FULL MAY 31 1960' and numerical values.

139-27
110-27

Over Shores
Birdwood Shores
Brookman's Linden
Logwood Shore

Assessment Roll and Tax List of Real Property in the Town of Delice

* Indicate Type of Property: R-Residential, C-Commercial, I-Industrial, U-Utility, F-Farm, L-Lakeshore, T-Timber, M-Mineral

Form 5CD MILLER-DAVIS CO., MINNEAPOLIS

| IN WHOSE NAME ASSESSED | TO WHOM TRANSFERRED | DESCRIPTION OF PROPERTY | | | | No. School District | Indicate Homestead Yes or No | Indicate Agricultural Yes or No | Indicate Type of Property | TRUE AND FULL VALUATIONS | | | | | ASSESSED VALUATIONS | | | | | FINAL EQUALIZED VALUE | | | | | | | | |
|-------------------------|---------------------|-------------------------|------------------|---------------|------|---------------------|------------------------------|---------------------------------|---------------------------|--------------------------|---|--------------------------------|---|---------------------------|---------------------|--------|-----------|---------|---------|-----------------------|---|----------------------|--|---------|---------|---------|---------|---------|
| | | SUBDIVISION | Sec. or Lot | Town or Block | Rng. | | | | | Number of Acres of Land | LAND Exclusive of Structures and Improvements | BUILDINGS and Other Structures | MACHINERY Permanently Attached to Real Estate | TOTAL True and Full Value | RURAL | | ALL OTHER | | | | MACHINERY Permanently Attached to Real Estate | TOTAL ASSESSED VALUE | Total Assessed Value as Equalized by the Board of Review | | | | | |
| | | | | | | | | | | | | | | | Acres | 100ths | Dollars | Dollars | Dollars | | | | | Dollars | Dollars | Dollars | Dollars | Dollars |
| | | | | | | | | | | | | | | | | | | | | | | | | | | | | |
| The Northwest Paper Co. | | 1 | NE 1/4 of NE 1/4 | 29 140 27 | 40 | | U | No | T | | | | | | | | | | | | | | | | | | | |
| " | " | 2 | NW 1/4 of NE 1/4 | | 40 | | " | " | " | | | | | | | | | | | | | | | | | | | |
| " | " | 3 | SW 1/4 of NE 1/4 | | 40 | | " | " | " | | | | | | | | | | | | | | | | | | | |
| " | " | 4 | SE 1/4 of NE 1/4 | | 40 | | " | " | " | | | | | | | | | | | | | | | | | | | |
| " | " | 5 | | | | | | | | | | | | | | | | | | | | | | | | | | |
| " | " | 6 | NE 1/4 of NW 1/4 | | 40 | | " | " | " | | | | | | | | | | | | | | | | | | | |
| " | " | 7 | NW 1/4 of NW 1/4 | | 40 | | " | " | " | | | | | | | | | | | | | | | | | | | |
| " | " | 8 | SW 1/4 of NW 1/4 | | 40 | | " | " | " | | | | | | | | | | | | | | | | | | | |
| " | " | 9 | SE 1/4 of NW 1/4 | | 40 | | " | " | " | | | | | | | | | | | | | | | | | | | |
| " | " | 10 | | | | | | | | | | | | | | | | | | | | | | | | | | |
| " | " | 11 | NE 1/4 of SW 1/4 | | 40 | | " | " | " | | | | | | | | | | | | | | | | | | | |
| State of Minnesota | | 12 | NW 1/4 of SW 1/4 | | | | | | | | | | | | | | | | | | | | | | | | | |
| The Northwest Paper Co. | | 13 | SW 1/4 of SW 1/4 | | 40 | | " | " | " | | | | | | | | | | | | | | | | | | | |
| " | " | 14 | SE 1/4 of SW 1/4 | | 40 | | " | " | " | | | | | | | | | | | | | | | | | | | |
| " | " | 15 | | | | | | | | | | | | | | | | | | | | | | | | | | |
| " | " | 16 | NE 1/4 of SE 1/4 | | 40 | | " | " | " | | | | | | | | | | | | | | | | | | | |
| " | " | 17 | NW 1/4 of SE 1/4 | | 40 | | " | " | " | | | | | | | | | | | | | | | | | | | |
| " | " | 18 | SW 1/4 of SE 1/4 | | 40 | | " | " | " | | | | | | | | | | | | | | | | | | | |
| " | " | 19 | SE 1/4 of SE 1/4 | | 40 | | " | " | " | | | | | | | | | | | | | | | | | | | |
| | | 20 | | | | | | | | | | | | | | | | | | | | | | | | | | |
| | | | | | 600 | | | | | | | | | | | | | | | | | | | | | | | |

Cass County, Minnesota, for Taxes for the Year 1959.

| SOLD FOR TAXES | VALUATIONS BY SCHOOL DISTRICTS AS EQUALIZED BY DEPARTMENT OF TAXATION | | | | | | Tax including State Homestead | State Tax on Non-Homestead | SPECIAL TAXES | TOTAL TAXES | PAID | WHEN PAID | Number of Receipt | March Settlement 1960 | June Settlement 1960 | Penalty | November Settlement 1960 | Penalty | Collections to First Monday in January 1961 | Penalty | Delinquent on First Monday in January 1961 | Total Delinquent Tax and Penalty | REMARKS |
|----------------|---|--------------|--------------|--------------|--------------|--------------|-------------------------------|----------------------------|---------------|-------------|---------------------------|-----------|-------------------|-----------------------|----------------------|---------|--------------------------|---------|---|---------|--|----------------------------------|---------|
| | District No. | District No. | District No. | District No. | District No. | District No. | | | | | | | | | | | | | | | | | |
| | Rate | Rate | Rate | Rate | Rate | Rate | | | | | | | | | | | | | | | | | |
| | Dollars | Dollars | Dollars | Dollars | Dollars | Dollars | | | | | | | | | | | | | | | | | |
| 1 | | | | | | 66 | 21 00 | 42 | 21 42 | 1 | PAID IN FULL MAY 3 1 1960 | | | | | | | | | | | | 14 957 |
| 2 | | | | | | 66 | 21 00 | 42 | 21 42 | 2 | PAID IN FULL MAY 3 1 1960 | | | | | | | | | | | | " |
| 3 | | | | | | 66 | 21 00 | 42 | 21 42 | 3 | PAID IN FULL MAY 3 1 1960 | 15807 | | 85 681 | | | | | | | | | " |
| 4 | | | | | | 66 | 21 00 | 42 | 21 42 | 4 | PAID IN FULL MAY 3 1 1960 | | | | | | | | | | | | " |
| 5 | | | | | | | | | | 5 | | | | | | | | | | | | | |
| 6 | | | | | | 66 | 21 00 | 42 | 21 42 | 6 | PAID IN FULL MAY 3 1 1960 | | | | | | | | | | | | 14 957 |
| 7 | | | | | | 66 | 21 00 | 42 | 21 42 | 7 | PAID IN FULL MAY 3 1 1960 | | | | | | | | | | | | " |
| 8 | | | | | | 66 | 21 00 | 42 | 21 42 | 8 | PAID IN FULL MAY 3 1 1960 | 15807 | | 85 681 | | | | | | | | | " |
| 9 | | | | | | 66 | 21 00 | 42 | 21 42 | 9 | PAID IN FULL MAY 3 1 1960 | | | | | | | | | | | | " |
| 10 | | | | | | | | | | 10 | | | | | | | | | | | | | |
| 11 | | | | | | 66 | 21 02 | 40 | 21 42 | 11 | PAID IN FULL MAY 3 1 1960 | 15807 | | 21 42 | | | | | | | | | 14 957 |
| 12 | | | | | | | | | | 12 | | | | | | | | | | | | | |
| 13 | | | | | | 66 | 21 02 | 40 | 21 42 | 13 | PAID IN FULL MAY 3 1 1960 | 15807 | | 21 42 | | | | | | | | | " |
| 14 | | | | | | 66 | 21 02 | 40 | 21 42 | 14 | PAID IN FULL MAY 3 1 1960 | | | 21 42 | | | | | | | | | 14 957 |
| 15 | | | | | | | | | | 15 | | | | | | | | | | | | | |
| 16 | | | | | | 66 | 21 02 | 40 | 21 42 | 16 | PAID IN FULL MAY 3 1 1960 | | | | | | | | | | | | " |
| 17 | | | | | | 66 | 21 02 | 40 | 21 42 | 17 | PAID IN FULL MAY 3 1 1960 | | | | | | | | | | | | " |
| 18 | | | | | | 66 | 21 02 | 40 | 21 42 | 18 | PAID IN FULL MAY 3 1 1960 | 15807 | | 85 681 | | | | | | | | | " |
| 19 | | | | | | 66 | 21 02 | 40 | 21 42 | 19 | PAID IN FULL MAY 3 1 1960 | | | | | | | | | | | | " |
| 20 | | | | | | | | | | 20 | | | | | | | | | | | | | |
| | | | | | | 990 | 315 14 | 616 | 321 30 | | | | | 321 30 | | | | | | | | | |

Over Shores

Highwood Shores

Brookman's Linden Beach

Logwood Shores

Assessment Roll and Tax List of Real Property in the Town of Duluth

Form 5CD MILLER-DAVIS CO., MINNEAPOLIS

Indicate Type of Property: R-Residential, C-Commercial, I-Industrial, U-Utility, F-Farm, L-Lakeshore, T-Timber, M-Mineral

Table with columns: IN WHOSE NAME ASSESSED, TO WHOM TRANSFERRED, DESCRIPTION OF PROPERTY, TRUE AND FULL VALUATIONS, ASSESSED VALUATIONS, and FINAL EQUALIZED VALUE.

Cass County, Minnesota, for Taxes for the Year 1959.

Table with columns: VALUATIONS BY SCHOOL DISTRICTS AS EQUALIZED BY DEPARTMENT OF TAKATION, TAXES, PAID, WHEN PAID, Number of Receipt, March Settlement, June Settlement, November Settlement, Penalty, Collections to First Monday in January, Delinquent on First Monday in January, Total Delinquent Tax and Penalty, and REMARKS.

Assessment Roll and Tax List of Real Property in the Town of *Delphi*

Indicate Type of Property: R-Residential, C-Commercial, I-Industrial, U-Utility, F-Farm, L-Lakeshore, T-Timber, M-Mineral

Form 5CD MILLER-DAVIS CO., MINNEAPOLIS

Table with columns: IN WHOSE NAME ASSESSED, TO WHOM TRANSFERRED, DESCRIPTION OF PROPERTY, TRUE AND FULL VALUATIONS, ASSESSED VALUATIONS, and FINAL EQUALIZED VALUE.

Cass County, Minnesota, for Taxes for the Year 1959.

Table with columns: SOLD FOR TAXES, VALUATIONS BY SCHOOL DISTRICTS AS EQUALIZED BY DEPARTMENT OF TAXATION, SPECIAL TAXES, TOTAL TAXES, PAID, WHEN PAID, Number of Receipt, March Settlement, June Settlement, November Settlement, Penalty, Collections to First Monday in January 1961, Delinquent on First Monday in January 1961, Total Delinquent Tax and Penalty, and REMARKS.

139-27 110-27

Ever Shores Birchwood Shores Brookman's Linden Logwood Shore

Assessment Roll and Tax List of Real Property in the Town of Irelise

Form 5CD MILLER-DAVIS CO., MINNEAPOLIS

Indicate Type of Property: R-Residential, C-Commercial, I-Industrial, U-Utility, F-Farm, L-Lakeshore, T-Timber, M-Mineral

110-27

Table with columns: IN WHOSE NAME ASSESSED, TO WHOM TRANSFERRED, DESCRIPTION OF PROPERTY (Subdivision, Sec. of Lot, Town or Block, Rng., Number of Acres of Land), TRUE AND FULL VALUATIONS (LAND, BUILDINGS, MACHINERY, TOTAL), ASSESSED VALUATIONS (RURAL, ALL OTHER, MACHINERY, TOTAL ASSESSED VALUE), FINAL EQUALIZED VALUE.

Cass County, Minnesota, for Taxes for the Year 1959.

Table with columns: SOLD FOR TAXES, VALUATIONS BY SCHOOL DISTRICTS AS EQUALIZED BY DEPARTMENT OF TAXATION (District No., Rate), Tax including State Homestead, State Tax on Non-Homestead, SPECIAL TAXES, TOTAL TAXES, PAID, WHEN PAID, Number of Receipt, March Settlement 1960, June Settlement 1960, Penalty, November Settlement 1960, Penalty, Collections to First Monday in January 1961, Penalty, Delinquent on First Monday in January 1961, Total Delinquent Tax and Penalty, REMARKS.

Ever Shores, Birchwood Shores, Brookman's Linden Beach, Logwood Shores

280

462

14706

14994

14994

14958

14958

Assessment Roll and Tax List of Real Property in the Town of Delia

Form SCD MILLER-DAVIS CO., MINNEAPOLIS

Indicate Type of Property: R-Residential, C-Commercial, I-Industrial, U-Utility, F-Farm, L-Lakeshore, T-Timber, M-Mineral

Table with columns: IN WHOSE NAME ASSESSED, TO WHOM TRANSFERRED, DESCRIPTION OF PROPERTY, TRUE AND FULL VALUATIONS, ASSESSED VALUATIONS, FINAL EQUALIZED VALUE.

California Institute of Technology (in land)
Thomas H. Yawkey to Ent. Emmet H. Gardner 34 1/2

160

Cass County, Minnesota, for Taxes for the Year 1959.

Table with columns: SOLD FOR TAXES, VALUATIONS BY SCHOOL DISTRICTS AS EQUALIZED BY DEPARTMENT OF TAXATION, SPECIAL TAXES, TOTAL TAXES, PAID, WHEN PAID, Number of Receipt, March Settlement 1960, June Settlement 1960, November Settlement 1960, Collections to First Monday in January 1961, Delinquent on First Monday in January 1961, Total Delinquent Tax and Penalty, REMARKS.

264

8408 160

8568

8568

Ever Shores

Birchwood Shores

Brookman's Linden Beach

Logwood Shore

Assessment Roll and Tax List of Real Property in the Town of Delice, Cass County, Minnesota, for Taxes for the Year 1959.

Form SCID MILLER-DAY COMPANY, MINNEAPOLIS

Indicate Type of Property: R-Residential, C-Commercial, I-Industrial, U-Utility, F-Farm, L-Lakeshore, T-Timber, M-Mineral

Table with columns: IN WHOSE NAME ASSESSED, TO WHOM TRANSFERRED, DESCRIPTION OF PROPERTY (SUBDIVISION, Sec. or Lot, Town or Block, Rng., Acres, 100ths), TRUE AND FULL VALUATIONS (LAND, BUILDINGS, MACHINERY, TOTAL), ASSESSED VALUATIONS (RURAL, ALL OTHER, MACHINERY, TOTAL ASSESSED VALUE), and FINAL EQUALIZED VALUE.

80

Cass County, Minnesota, for Taxes for the Year 1959.

Table with columns: SOLD FOR TAXES, VALUATIONS BY SCHOOL DISTRICTS AS EQUALIZED BY DEPARTMENT OF TAXATION (District No., Rate, etc.), SPECIAL TAXES, TOTAL TAXES, PAID, WHEN PAID, Number of Receipt, March Settlement 1960, June Settlement 1960, November Settlement 1960, Penalty, Collections to First Monday in January 1961, Delinquent on First Monday in January 1961, Total Delinquent Tax and Penalty, REMARKS.

H 80

25 48

25 48

35 48

Ever Shores, Birchwood Shores, Brookman's Linden Beach, Logwood Shores

Assessment Roll and Tax List of Real Property in the Town of Irehje,

Indicate Type of Property: R-Residential, C-Commercial, I-Industrial, U-Utility, F-Farm, L-Lakeshore, T-Timber, M-Mineral

Form 50 - MILLER-DAVIS CO., MINNEAPOLIS

Table with columns: IN WHOSE NAME ASSESSED, TO WHOM TRANSFERRED, SUBDIVISION, Sec. of Lot, Town or Block, Rng., Number of Acres of Land, TRUE AND FULL VALUATIONS, ASSESSED VALUATIONS, FINAL EQUALIZED VALUE.

Cass County, Minnesota, for Taxes for the Year 1959.

Table with columns: SOLD FOR TAXES, VALUATIONS BY SCHOOL DISTRICTS AS EQUALIZED BY DEPARTMENT OF TAXATION, Tax including State Homestead, State Tax on Non-Homestead, SPECIAL TAXES, TOTAL TAXES, PAID, WHEN PAID, Number of Receipt, March Settlement, June Settlement, November Settlement, Penalty, Collections to First Monday in January 1961, Delinquent on First Monday in January 1961, Total Delinquent Tax and Penalty, REMARKS.

139-27

Ewers Shores

Birdwood Shores

Brookman's Linden Beach

Logwood Shores

Assessment Roll and Tax List of Real Property in the Town of Inelipe,

Form 3C - MILLER-DAVIS CO., MINNEAPOLIS

* Indicate Type of Property: R-Residential, C-Commercial, I-Industrial, U-Utility, F-Farm, L-Lakeshore, T-Timber, M-Mineral

Table with columns: IN WHOSE NAME ASSESSED, TO WHOM TRANSFERRED, DESCRIPTION OF PROPERTY (SUBDIVISION, Sec. of Lot, Town or Block, Rng., Number of Acres of Land), TRUE AND FULL VALUATIONS (LAND, BUILDINGS, MACHINERY, TOTAL True and Full Value), ASSESSED VALUATIONS (RURAL, ALL OTHER, MACHINERY, TOTAL ASSESSED VALUE), Total Assessed Value as Equalized by the Board of Review, FINAL EQUALIZED VALUE.

Iwers Shores

Birchwood Shores

Cass County, Minnesota, for Taxes for the Year 1959.

Table with columns: SOLD FOR TAXES, VALUATIONS BY SCHOOL DISTRICTS AS EQUALIZED BY DEPARTMENT OF TAXATION, Tax including State Homestead, State Tax on Non-Homestead, SPECIAL TAXES, TOTAL TAXES, PAID, WHEN PAID, Number of Receipt, March Settlement 1960, June Settlement 1960, November Settlement 1960, Penalty, Collections to First Monday in January 1961, Delinquent on First Monday in January 1961, Total Delinquent Tax and Penalty, REMARKS.

Brookman's Linden Beach Logwood Shores

Assessment Roll and Tax List of Real Property in the Town of Iredale

Form 5C MILLER-DAVIS CO., MINNEAPOLIS

Indicate Type of Property: R-Residential, C-Commercial, I-Industrial, U-Utility, F-Farm, L-Lakeshore, T-Timber, M-Mineral

Table with columns: IN WHOSE NAME ASSESSED, TO WHOM TRANSFERRED, DESCRIPTION OF PROPERTY, TRUE AND FULL VALUATIONS, ASSESSED VALUATIONS, FINAL EQUALIZED VALUE.

Cass County, Minnesota, for Taxes for the Year 1959.

Table with columns: VALUATIONS BY SCHOOL DISTRICTS AS EQUALIZED BY DEPARTMENT OF TAXATION, Tax including State Homestead, State Tax on Non-Homestead, SPECIAL TAXES, TOTAL TAXES, PAID, WHEN PAID, Number of Receipt, March Settlement 1960, June Settlement 1960, November Settlement 1960, Penalty, Collections to First Monday in January 1961, Delinquent on First Monday in January 1961, Total Delinquent Tax and Penalty, REMARKS.

