

ASSESSMENT & TAX LIST · 1962

Trelife

SUMMARY OF TAX COLLECTION

Original Levy	-	-	-	-	\$	<u>8247.94</u>
Additions	-	-	-	-	\$	<u>75.28</u>
Abatements	-	-	-	-	\$	<u>16.34</u>
					\$	<u>8406.88</u>

COLLECTIONS

March Settlement	-	-	-	-	\$	<u>1838.62</u>
June Settlement	-	-	-	-	\$	<u>4205.47</u>
November Settlement	-	-	-	-	\$	<u>169.33</u>
January Settlement	-	-	-	-	\$	<u>168.40</u>
					\$	<u>7899.82</u>
Over Collected	-	-	-	-	\$	<u>8.72</u>
Under Collected	-	-	-	-	\$	
Delinquent	-	-	-	-	\$	<u>515.78</u>
Total	-	-	-	-	\$	<u>8406.88</u>

Assessor's Return of Exempt Real Property in the _____ of _____ County of _____, Minnesota, for the Year 1962

FORM 2 MILLER-DAVIS CO., MINNEAPOLIS

NAMES OF OWNERS	DESCRIPTION	Sec. or Lot	Town or Block	Range	No of Acres	FOR WHAT PURPOSE USED	TRUE AND FULL VALUATIONS			ASSESSED VALUATIONS		REMARKS
							LAND Exclusive of Structures and Improvements Dollars	BUILDINGS and Other Structures Dollars	MACHINERY Permanently Attached to Real Estate Dollars	TOTAL True and Full Value Dollars	Rural Including Machinery 33 1/3%	
Tacon Tulipe	part of Sect 14	14	140	27		Tacon Hall	60	600	660	220		
"	Lot 6	24	140	27		Township front	210		210	70		
"	sw 1/4 SW	24	140	27		" "	210		210	70		
"	SE 1/4 SW	24	140	27		" "	210		210	70		
"	NE 1/4 NW	25	140	27		" "	210		210	70		
"	NW 1/4 NW	25	140	27		" "	210		210	70		
"	SW 1/4 NW	25	140	27		" "	210		210	70		
"	SE 1/4 NW	25	140	27		" "	210		210	70		
"	NW 1/4 SW	25	140	27		" "	210		210	70		

139-27

Shores
Birkwood
Shores
Brogger's
Linden Beach
Shores
Logwood
Shores

Assessment Roll and Tax List of Real Property in the Town of Trelise

Form 500 MILLER-DAVIS CO., MINNEAPOLIS

Table with columns: IN WHOSE NAME ASSESSED, DESCRIPTION OF PROPERTY, TRUE AND FULL VALUATIONS, ASSESSED VALUATIONS, and FINAL EQUALIZED VALUE. Includes entries for State of Minnesota, Donald D. + Ruth E. Worsham, and Glacier Park Hotel Co.

Cass County, Minnesota, for Taxes for the Year 1962.

Table with columns: SOLD FOR TAXES, VALUATIONS BY SCHOOL DISTRICTS AS EQUALIZED BY DEPARTMENT OF TAXATION, Tax including State Homestead, State Tax on Non-Homestead, SPECIAL TAXES, TOTAL TAXES, PAID, WHEN PAID, Number of Receipt, March Settlement 1963, June Settlement 1963, November Settlement 1963, Collections to First Monday in January 1964, Delinquent on First Monday in January 1964, Total Delinquent Tax and Penalty, and REMARKS. Includes handwritten notes and dates like '2nd HALF PAID SEP 9 1963'.

Assessment Roll and Tax List of Real Property in the Town of Trilipe

* Indicate Type of Property: R-Residential, C-Commercial, I-Industrial, U-Utility, F-Farm, L-Lakeshore, T-Timber, M-Mineral

Cass County, Minnesota, for Taxes for the Year 1962.

Form 500 MILLER-DAVIS CO., MINNEAPOLIS

IN WHOSE NAME ASSESSED	DESCRIPTION OF PROPERTY				No. School District	Indicate Homestead Yes or No	Agricultural Rec. Yes or No	* Indicate Type of Property	TRUE AND FULL VALUATIONS							Total Assessed Value as Equalized by the Board of Review	FINAL EQUALIZED VALUE	
	SUBDIVISION	Sec. or Lot	Town or Block	Number of Acres of Land					ASSESSED VALUATIONS				ALL OTHER					
									LAND Exclusive of Structures and Improvements	BUILDINGS and Other Structures	MACHINERY Permanently Attached to Real Estate	TOTAL True and Full Value	Homestead Up to \$4,000 20%	RURAL Over \$4,000 and Non-Homestead 33 1/2%	Timber Land Class 2e 20%			Homestead Up to \$4,000 25%
State of Minnesota	1			34 139 27	UN													
State of Minnesota	2																	
State of Minnesota	3																	
State of Minnesota	4																	
State of Minnesota	6																	
State of Minnesota	7																	
State of Minnesota	8																	
State of Minnesota	9																	
State of Minnesota	11																	
State of Minnesota	12																	
State of Minnesota	13																	
State of Minnesota	14																	
State of Minnesota	15																	
State of Minnesota	16																	
State of Minnesota	17																	
State of Minnesota	18																	
State of Minnesota	19																	
State of Minnesota	20																	

SOLD FOR TAXES	VALUATIONS BY SCHOOL DISTRICTS AS EQUALIZED BY DEPARTMENT OF TAXATION						Tax Including State Homestead	State Tax on Non-Homestead	SPECIAL TAXES	SPECIAL TAXES	TOTAL TAXES	PAID	WHEN PAID	Number of Receipt	March Settlement 1963	June Settlement 1963	November Settlement 1963	Penalty	Collections to First Monday in January 1964	Penalty	Delinquent on First Monday in January 1964	Total Delinquent Tax and Penalty	REMARKS	
	District No.	District No.	District No.	District No.	District No.	District No.																		
	Rate	Rate	Rate	Rate	Rate	Rate																		

140-27

Shores, Brookwood, Brook Park, Logwood, Trilipe

Assessment Roll and Tax List of Real Property in the Town of Treelipe

Indicate Type of Property: R-Residential, C-Commercial, I-Industrial, U-Utility, F-Farm, L-Lakeshore, T-Timber, M-Mineral

Cass County, Minnesota, for Taxes for the Year 1962.

140-27

Table with columns: IN WHOSE NAME ASSESSED, SUBDIVISION, No. School District, Indicate Home-stead, No. or Nearest, Indicate Type of Property, TRUE AND FULL VALUATIONS, ASSESSED VALUATIONS, and FINAL EQUALIZED VALUE.

Table with columns: SOLD FOR TAXES, VALUATIONS BY SCHOOL DISTRICTS AS EQUALIZED BY DEPARTMENT OF TAXATION, Tax Including State Homestead, State Tax on Non-Homestead, SPECIAL TAXES, TOTAL TAXES, PAID, WHEN PAID, Number of Receipt, March Settlement 1963, June Settlement 1963, Penalty, November Settlement 1963, Penalty, Collections to First Monday in January 1964, Penalty, Delinquent on First Monday in January 1964, Total Delinquent Tax and Penalty, and REMARKS.

(CONT. NEXT PAGE)

Vertical text on the right edge of the page, possibly a page number or index reference.

LOT 4 - SEC. 5-140-27

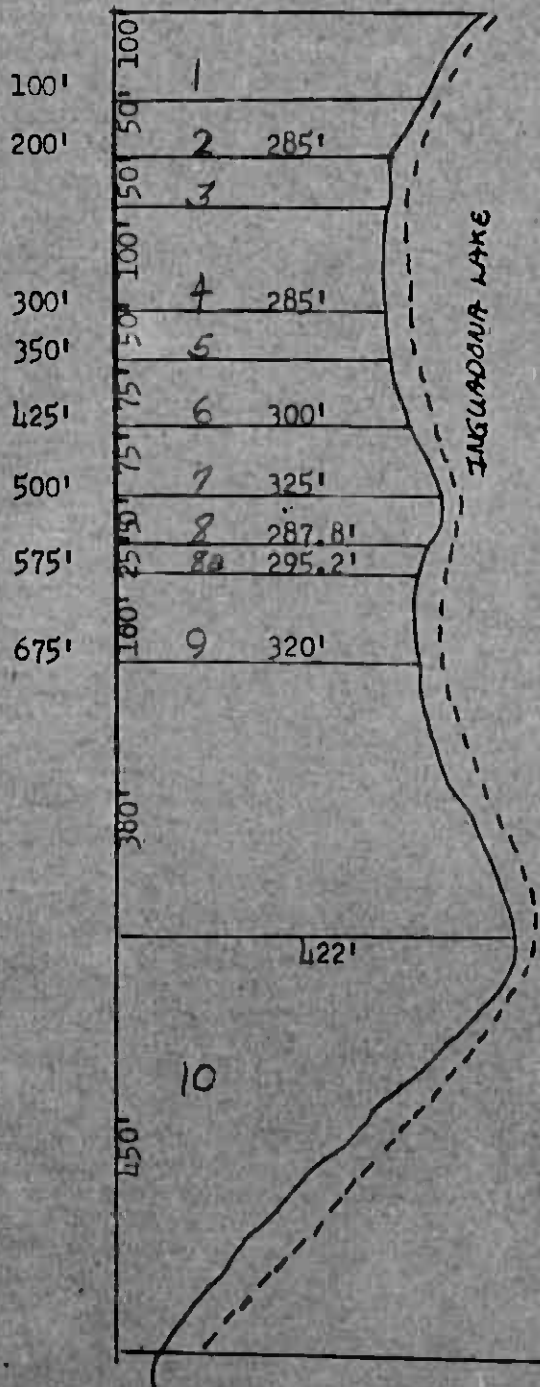

1. Roland Edwards --- 6.0 acres
2. Clarence & Elizabeth Strensak - 7.5 ac.
3. " " " - .25 ac.
4. Guy Wm. & Belle Thompson -- .50 ac.
5. " " " " -- .25 acs.
6. Dorothy E. Workman---- .50 acs.
7. D. W. Tate-----1.0 acres
8. Gordon I. Lilyquist, etal -- .50 acs.
8. D. W. Tate--- .50 acs.
9. Marion Olson & Irene Larson-- .75 acs.
- 10 Byron & Irma Sherwood--- 2.0 acres.

Assessment Roll and Tax List of Real Property in the Town of Trelice

* Indicate Type of Property: R-Residential, C-Commercial, I-Industrial, U-Utility, F-Farm, L-Lakeshore, T-Timber, M-Mineral

Cass County, Minnesota, for Taxes for the Year 1962.

Table with columns: IN WHOSE NAME ASSESSED, DESCRIPTION OF PROPERTY, TRUE AND FULL VALUATIONS, ASSESSED VALUATIONS, and FINAL EQUALIZED VALUE. Includes handwritten entries for Gordon L. Lilyquist, Roland Edwards, Clarence E. + Elizabeth M. Streson, Gaylord Christenson, Dorothy E. Workman, D. W. + Leona Tate, Marvin Olson + Iris Larson, and Forest C. + Ruth G. Whitaker.

Table with columns: VALUATIONS BY SCHOOL DISTRICTS AS EQUALIZED BY DEPARTMENT OF TAXATION, TAX INCLUDING STATE HOMESTEAD, SPECIAL TAXES, TOTAL TAXES, PAID, WHEN PAID, Number of Receipt, March Settlement 1963, June Settlement 1963, November Settlement 1963, Collections to First Monday in January 1964, Delinquent on First Monday in January 1964, Total Delinquent Tax and Penalty, and REMARKS. Includes handwritten notes like 'PAID IN FULL' and '2nd HALF PAID'.

140

Shores, Brookwood, Linden, Logwood, Trelice

Assessment Roll and Tax List of Real Property in the Town of Trelife

* Indicate Type of Property: R-Residential, C-Commercial, I-Industrial, U-Utility, F-Farm, L-Lakeshore, T-Timber, M-Mineral

Cass County, Minnesota, for Taxes for the Year 1962.

Table with columns: IN WHOSE NAME ASSESSED, DESCRIPTION OF PROPERTY, TRUE AND FULL VALUATIONS, ASSESSED VALUATIONS, VALUATIONS BY SCHOOL DISTRICTS AS EQUALIZED BY DEPARTMENT OF TAXATION, TAXES, PAID, WHEN PAID, Number of Receipt, March Settlement 1963, June Settlement 1963, November Settlement 1963, Collections to First Monday in January 1964, Delinquent on First Monday in January 1964, Total Delinquent Tax and Penalty, REMARKS.

Eldon R. + Martha Oberfoell
Lewis G. + Mayme A. Wheeler
State of Minnesota

William N. + Rose Lang
Wm. N. + Rose Lang
State of Minnesota

State of Minnesota
State of Minnesota
State of Minnesota
State of Minnesota
State of Minnesota
State of Minnesota
State of Minnesota
State of Minnesota

160 702 121 823 26 221 357

H 26 231 259 6978 198 7176

PAID WHEN PAID
HALF PAID OCT 31 1962
PAID IN FULL MAY 31 1963
PAID IN FULL OCT 31 1963
PAID IN FULL OCT 31 1963

Shores
Shores
Shores
Shores
Shores
Shores
Shores
Shores

Assessment Roll and Tax List of Real Property in the Town of Trelise

Form 300 MILLER-DAVIS CO., MINNEAPOLIS

* Indicate Type of Property: R-Residential, C-Commercial, I-Industrial, U-Utility, F-Farm, L-Lakeshore, T-Timber, M-Mineral

Cass County, Minnesota, for Taxes for the Year 1962.

Table with columns: IN WHOSE NAME ASSESSED, DESCRIPTION OF PROPERTY, TRUE AND FULL VALUATIONS, ASSESSED VALUATIONS, VALUATIONS BY SCHOOL DISTRICTS AS EQUALIZED BY DEPARTMENT OF TAXATION, TAX INCLUDING STATE HOMESTEAD, SPECIAL TAXES, TOTAL TAXES, PAID, WHEN PAID, Number of Receipt, March Settlement 1963, June Settlement 1963, Penalty, November Settlement 1963, Penalty, Collections to First Monday in January 1964, Penalty, Delinquent on First Monday in January 1964, Total Delinquent Tax and Penalty, REMARKS.

140

Shores, Birchwood, Brookman's, Logwood, Trelise

Assessment Roll and Tax List of Real Property in the Town of Trelise

Form 300 MILLER-DAVIS CO., MINNEAPOLIS

* Indicate Type of Property: R-Residential, C-Commercial, I-Industrial, U-Utility, F-Farm, L-Lakeshore, T-Timber, M-Mineral

Table with columns: IN WHOSE NAME ASSESSED, SUBDIVISION, No. School District, Indicate Home-stead, Agri. Rec., Indicate Type of Property, TRUE AND FULL VALUATIONS (LAND, BUILDINGS, MACHINERY, TOTAL), ASSESSED VALUATIONS (RURAL, ALL OTHER), Total Assessed Value, FINAL EQUALIZED VALUE.

Cass County, Minnesota, for Taxes for the Year 1962.

Table with columns: SOLD FOR TAXES, VALUATIONS BY SCHOOL DISTRICTS AS EQUALIZED BY DEPARTMENT OF TAXATION, Tax Including State Homestead, State Tax on Non-Homestead, SPECIAL TAXES, PAID, WHEN PAID, Number of Receipt, March Settlement 1963, June Settlement 1963, November Settlement 1963, Collections to First Monday in January 1964, Delinquent on First Monday in January 1964, Total Delinquent Tax and Penalty, REMARKS.

Assessment Roll and Tax List of Real Property in the Town of Trelips

* Indicate Type of Property: R-Residential, C-Commercial, I-Industrial, U-Utility, F-Farm, L-Lakeshore, T-Timber, M-Mineral

Table with columns: IN WHOSE NAME ASSESSED, SUBDIVISION, No. School District, Indicate Homestead, Agri. or Sea. Reer. Yes or No, Indicate Type of Property, TRUE AND FULL VALUATIONS (LAND, BUILDINGS, MACHINERY, TOTAL), ASSESSED VALUATIONS (RURAL, ALL OTHER, MACHINERY, Seasonal and Recreational Cabins, TOTAL ASSESSED VALUE), Total Assessed Value as Equalized by the Board of Review, FINAL EQUALIZED VALUE.

Cass County, Minnesota, for Taxes for the Year 1962.

Table with columns: SOLD FOR TAXES, VALUATIONS BY SCHOOL DISTRICTS AS EQUALIZED BY DEPARTMENT OF TAXATION (District No., Rate, Mills), Tax Including State Homestead, State Tax on Non-Homestead, SPECIAL TAXES, TOTAL TAXES, PAID, WHEN PAID, Number of Receipt, March Settlement 1963, June Settlement 1963, Penalty, November Settlement 1963, Penalty, Collections to First Monday in January 1964, Penalty, Delinquent on First Monday in January 1964, Total Delinquent Tax and Penalty, REMARKS.

Assessment Roll and Tax List of Real Property in the Town of Trelipe

* Indicate Type of Property: R-Residential, C-Commercial, I-Industrial, U-Utility, F-Farm, L-Lakeshore, T-Timber, M-Mineral

Table with columns: IN WHOSE NAME ASSESSED, SUBDIVISION, DESCRIPTION OF PROPERTY, TRUE AND FULL VALUATIONS, ASSESSED VALUATIONS, FINAL EQUALIZED VALUE.

Cass County, Minnesota, for Taxes for the Year 1962.

Table with columns: VALUATIONS BY SCHOOL DISTRICTS AS EQUALIZED BY DEPARTMENT OF TAXATION, TAXES, PAID, WHEN PAID, Number of Receipt, March Settlement, June Settlement, November Settlement, Collections to First Monday in January, Delinquent on First Monday in January, Total Delinquent Tax and Penalty, REMARKS.

Assessment Roll and Tax List of Real Property in the Town of Trelise

Cass County, Minnesota, for Taxes for the Year 1962.

Table with columns: IN WHOSE NAME ASSESSED, DESCRIPTION OF PROPERTY, TRUE AND FULL VALUATIONS (LAND, BUILDINGS, MACHINERY, TOTAL), ASSESSED VALUATIONS (RURAL, ALL OTHER, MACHINERY, Seasonal and Recreational Cabins, TOTAL ASSESSED VALUE), FINAL EQUALIZED VALUE.

Table with columns: SOLD FOR TAXES, VALUATIONS BY SCHOOL DISTRICTS AS EQUALIZED BY DEPARTMENT OF TAXATION, Tax including State Homestead, SPECIAL TAXES, TOTAL TAXES, PAID, WHEN PAID, Number of Receipt, March Settlement 1963, June Settlement 1963, Penalty, November Settlement 1963, Collections to First Monday in January 1964, Delinquent on First Monday in January 1964, Total Delinquent Tax and Penalty, REMARKS.

140-2
Brewer's Shores
Birchwood Shores

Brookman's Linden Shores
Leewood Shores
Trelise Shores

Assessment Roll and Tax List of Real Property in the Town of Trelipe

* Indicate Type of Property: R-Residential, C-Commercial, I-Industrial, U-Utility, F-Farm, L-Lakeshore, T-Timber, M-Mineral

Cass County, Minnesota, for Taxes for the Year 1962.

Table with columns: IN WHOSE NAME ASSESSED, LOGWOOD SHORES SUBDIVISION, TRUE AND FULL VALUATIONS (LAND, BUILDINGS, MACHINERY, TOTAL), ASSESSED VALUATIONS (RURAL, ALL OTHER), and FINAL EQUALIZED VALUE.

Table with columns: SOLD FOR TAXES, VALUATION BY SCHOOL DISTRICTS AS EQUALIZED BY DEPARTMENT OF TAXATION, Tax including State Homestead, State Tax on Non-Homestead, SPECIAL TAXES, TOTAL TAXES, PAID, WHEN PAID, Number of Receipt, March Settlement, June Settlement, November Settlement, Collections to First Monday in January, Delinquent on First Monday in January, Total Delinquent Tax and Penalty, and REMARKS.

140-27
Logwood Shores
Linden Beach
Logwood Shores

Logwood Shores

723 1697 2322 774 774 1084 2398 3482 1160 1160

1160 31502 976 32498

37099 2965

758 2324 added

