

SUMMARY OF TAX COLLECTION

Original Levy	-	-	-	-	-	\$	52,14.18
Additions	-	-	-	-	-	\$	27.28
							\$ 52,71.46
Abatements	-	-	-	-	-	\$	121.84
							\$ 5149.62

COLLECTIONS

March Settlement	-	-	-	-	-	\$	983.33
June Settlement	-	-	-	-	-	\$	2337.44
November Settlement	-	-	-	-	-	\$	1305.90
January Settlement	-	-	-	-	-	\$	119.07
						\$	4665.74
Over Collected	-	-	-	-	-	\$	3.64
Under Collected	-	-	-	-	-	\$	
Delinquent	-	-	-	-	-	\$	487.52
						\$	482.88
Total	-	-	-	-	-	\$	5149.62

COLLECTIONS OF TAXES OF 1958

Town OF *Town of Towner*

CASS COUNTY, MINNESOTA

FUNDS	MARCH SETTLEMENT 1958	JUNE SETTLEMENT 1958	NOV. SETTLEMENT 1958	Amount Collected from Nov. 1st to First Monday in Jan. 1959	REDUCTIONS	Total Reductions and Collected	BALANCE UNCOLLECTED	ADDITIONS	Total Uncollected to First Monday in January, 1959
State-Non-Homestead	1765	4344	1723	173					
State-Homestead	2014	5434	2986	257					
County Revenue	10083	27209	14949	1286					
County Road and Bridge	5120	13816	7590	653					
County Welfare	17639	47602	26154	2250					
County Bond and Interest									
R. & B. Fed. Proj.	1707	4605	2530	217					
Co. Nurse	683	1842	1012	87					
R. & B. Bldg	683	1842	1012	87					
Town Revenue	1092	2947	1619	139					
Town Road and Bridge	3345	9027	4959	427					
Town Drag	341	921	506	44					
Town State Loan									
School Local 1 Mill	341	921	506	44					
School Special	26881	55037	36408	4650					
School State Loan									
Deficiency	9321	36039	15196	107					
Tuition									
Transportation	494	1336	734	63					
Bld. Bonds	5298	9564	7257	1146					
PERA	698	1899	1038	88					
C.O.	1480	5720	2412	17					
PERA Agri. Assn	1178 170	3178 461	1746 253	150 22					
	90333	233744	130590	11907					

	School District No.	LOCAL 1 MILL	SPECIAL	STATE LOAN	<i>Transp.</i>	<i>Bldg. Bonds</i>	<i>PERA</i>	<i>Deficiency</i>	<i>C.O.</i>	TOTALS
MARCH SETTLEMENT	317 A	193	21172		280	5298	387			27330
	un na	137	5499		199		289	8660	1375	16159
	un a	11	210		15		22	661	105	1024
	Totals	341	26881		494	5298	698	9321	1480	44513
JUNE SETTLEMENT	un a	313	6067		440		637	19111	3033	29571
	un na	269	10748		390		564	18228	2687	31586
	317 a	347	38222		506	9564	698			49339
	Totals	921	55037		1336	9564	1899	36039	5720	110516
NOVEMBER SETTLEMENT	un a	112	2243		163		236	7066	1122	10942
	un na	129	5162		187		272	8130	1290	15170
	317 a	265	29003		384	7257	530			37439
	Totals	506	36408		734	7257	1038	15196	2412	63551
NOVEMBER to JANUARY	317	42	4582		61	1146	84			5915
	un na	02	68		02		04	107	17	200
	Totals	44	4650		63	1146	88	107	17	6115
	School District No.									
ADDITIONS										
Totals										
REDUCTIONS	School District No.									
	Totals									

Real Estate

Assessment Roll and Tax List of Real Property in the *Town* of *Dovey*

Cass County, Minnesota, for Taxes for the Year 1958.

Indicate Type of Property: R-Residential, C-Commercial, I-Industrial, U-Utility, F-Farm, L-Lakeshore, T-Timber, M-Mineral

Table with columns: IN WHOSE NAME ASSESSED, TO WHOM TRANSFERRED, DESCRIPTION OF PROPERTY, TRUE AND FULL VALUATIONS, ASSESSED VALUATIONS, VALUATIONS BY SCHOOL DISTRICTS AS EQUALIZED BY DEPARTMENT OF TAXATION, SOLD FOR TAXES, PAID, WHEN PAID, Number of Receipt, March Settlement 1958, June Settlement 1959, November Settlement 1959, Penalty, Collections to First Monday in January 1960, Penalty, Delinquent on First Monday in January 1960, Total Delinquent Tax and Penalty, REMARKS.

Assessment Roll and Tax List of Real Property in the Town of Doney

Cass County, Minnesota, for Taxes for the Year 1958.

Table with columns: IN WHOSE NAME ASSESSED, TO WHOM TRANSFERRED, SUBDIVISION, TRUE AND FULL VALUATIONS (LAND, BUILDINGS, MACHINERY, TOTAL), ASSESSED VALUATIONS (RURAL, ALL OTHER), VALUATIONS BY SCHOOL DISTRICTS AS EQUALIZED BY DEPARTMENT OF TAXATION, SOLD FOR TAXES, PAID, WHEN PAID, Number of Receipts, March Settlement, June Settlement, November Settlement, Collections to First Monday in January 1960, Delinquent on First Monday in January 1960, Total Delinquent Tax and Penalty, REMARKS.

Assessment Roll and Tax List of Real Property in the *Town* of *Doney*

Indicate Type of Property: R-Residential, G-Commercial, I-Industrial, U-Utility, F-Farm, L-Lakeshore, T-Timber, M-Mineral

Cass County, Minnesota, for Taxes for the Year 1958.

Table with columns: (IN WHOSE NAME ASSESSED), TO WHOM TRANSFERRED, DESCRIPTION OF PROPERTY, TRUE AND FULL VALUATIONS, ASSESSED VALUATIONS, VALUATIONS BY SCHOOL DISTRICTS AS EQUALIZED BY DEPARTMENT OF TAXATION, SOLD FOR TAXES, SPECIAL TAXES, TOTAL TAXES, PAID, WHEN PAID, Number of Receipts, March Settlement, June Settlement, November Settlement, Collections to First Monday in January 1960, Delinquent on First Monday in January 1960, Total Delinquent Tax and Penalty, REMARKS.

Assessment Roll and Tax List of Real Property in the *Town of Dorsey*

Indicate Type of Property: R-Residential, C-Commercial, I-Industrial, U-Utility, F-Farm, L-Lakeshore, T-Timber, M-Mineral

Cass County, Minnesota, for Taxes for the Year 1958.

IN WHOSE NAME ASSESSED	TO WHOM TRANSFERRED	DESCRIPTION OF PROPERTY					TRUE AND FULL VALUATIONS										FINAL EQUALIZED VALUE	SOLD FOR TAXES	VALUATIONS BY SCHOOL DISTRICTS AS EQUALIZED BY DEPARTMENT OF TAXATION						PAID	WHEN PAID	Number of Receipt	March Settlement 1959	June Settlement 1959	Penalty 1959	November Settlement 1959	Penalty	Collections to First Monday in January 1960	Penalty	Delinquent on First Monday in January 1960	Total Delinquent Tax and Penalty	REMARKS																	
		SUBDIVISION	Sec. or Lot	Town or Block	Rng.	Number of Acres of Land	MACHINERY Permanently Attached to Real Estate	RURAL			ALL OTHER			TOTAL ASSESSED VALUE	Total Assessed Value as Equalized by the Board of Review	District No.			District No.	District No.	District No.	District No.	Tax including State Homestead	State Tax on Non-Homestead														SPECIAL TAXES	TOTAL TAXES	Month	Day	Year	\$	cts.	\$	cts.	\$	cts.	\$	cts.	\$	cts.	\$	cts.
								LAND Exclusive of Structures and Improvements	BUILDINGS and Other Structures	Homestead Up to \$4,000 20%	Over \$4,000 and Non-Homestead 33 1/3%	Timber Land Class 3e 20%	Homestead Up to \$1,000 25%			Over \$1,000 and Non-Homestead 40%			MACHINERY Permanently Attached to Real Estate 33 1/3%	No.	No.	No.																																
State of Minnesota		N E 1/4 of N E 1/4																																																				
State of Minnesota		N W 1/4 of N E 1/4																																																				
State of Minnesota		S W 1/4 of N E 1/4																																																				
State of Minnesota		S E 1/4 of N E 1/4																																																				
State of Minnesota		N E 1/4 of N W 1/4																																																				
U. S. of America		N W 1/4 of N W 1/4																																																				
U. S. of America		S W 1/4 of N W 1/4																																																				
State of Minnesota		S E 1/4 of N W 1/4																																																				
State of Minnesota		N E 1/4 of S W 1/4																																																				
State of Minnesota		N W 1/4 of S W 1/4																																																				
U. S. of America		S W 1/4 of S W 1/4																																																				
State of Minnesota		S E 1/4 of S W 1/4																																																				
<i>Clarence H. & Esther L. Heelan</i>		N E 1/4 of S E 1/4			40		NO	F		273					273																																							
U. S. of America		N W 1/4 of S E 1/4																																																				
U. S. of America		S W 1/4 of S E 1/4																																																				
<i>H. William Severson</i>		S E 1/4 of S E 1/4			40		NO	T		66					66																																							
										489					489																																							

226.02

2 HALF PAID NOV 21 1958 17712

1 HALF PAID MAY 29 1959 14987

PAID IN FULL JUN 29 1959 8788

7255

10774

Assessment Roll and Tax List of Real Property in the Town of Torrey

* Indicate Type of Property: R-Residential, C-Commercial, I-Industrial, U-Utility, F-Farm, L-Lakeshore, T-Timber, M-Mineral

Table with columns: IN WHOSE NAME ASSESSED, TO WHOM TRANSFERRED, DESCRIPTION OF PROPERTY, TRUE AND FULL VALUATIONS, ASSESSED VALUATIONS, and FINAL EQUALIZED VALUE. Includes handwritten entries for Ella Boileau, Laura B. Boileau, and others.

Cass County, Minnesota, for Taxes for the Year 1958.

Table with columns: SOLD FOR TAXES, VALUATIONS BY SCHOOL DISTRICTS AS EQUALIZED BY DEPARTMENT OF TAXATION, SPECIAL TAXES, TOTAL TAXES, PAID, WHEN PAID, Number of Receipt, March Settlement 1959, June Settlement 1959, November Settlement 1959, Collections to First Monday in January 1960, Delinquent on First Monday in January 1960, Total Delinquent Tax and Penalty, and REMARKS. Includes handwritten entries for tax payments and settlements.

Assessment Roll and Tax List of Real Property in the Town of Lacey of Lacey

* Indicate Type of Property: R-Residential, C-Commercial, I-Industrial, U-Utility, F-Farm, L-Lakeshore, T-Timber, M-Mineral

Cass County, Minnesota, for Taxes for the Year 1958.

Table with columns for 'IN WHOSE NAME ASSESSED', 'TO WHOM TRANSFERRED', 'DESCRIPTION OF PROPERTY', 'TRUE AND FULL VALUATIONS', 'ASSESSED VALUATIONS', 'VALUATIONS BY SCHOOL DISTRICTS AS EQUALIZED BY DEPARTMENT OF TAXATION', and 'TAXES'. Rows include property details for the State of Minnesota, Howard & Donnabella Landey, Ernest A & Lillie F Limberg, and Charles Aron.

Assessment Roll and Tax List of Real Property in the South of Lawry

* Indicate Type of Property: R-Residential, C-Commercial, I-Industrial, U-Utility, F-Farm, L-Lakeshore, T-Timber, M-Mineral

Table with columns: IN WHOSE NAME ASSESSED, TO WHOM TRANSFERRED, DESCRIPTION OF PROPERTY, TRUE AND FULL VALUATIONS, ASSESSED VALUATIONS, and FINAL EQUALIZED VALUE. Includes handwritten entries for various property owners like R. N. & Leone L. Franke, U.S. of America, Richard A. & Mary J. Johnson, etc.

Cass County, Minnesota, for Taxes for the Year 1958.

Table with columns: SOLD FOR TAXES, VALUATIONS BY SCHOOL DISTRICTS AS EQUALIZED BY DEPARTMENT OF TAXATION, SPECIAL TAXES, TOTAL TAXES, PAID, WHEN PAID, Number of Receipt, March Settlement 1959, June Settlement 1959, November Settlement 1959, Penalty, Collections to First Monday in January 1960, Delinquent on First Monday in January 1960, Total Delinquent Tax and Penalty, REMARKS. Includes handwritten entries for various tax payments and balances.

Assessment Roll and Tax List of Real Property in the Town of Dorsey

Indicate Type of Property: R-Residential, C-Commercial, I-Industrial, U-Utility, F-Farm, L-Lakeshore, T-Timber, M-Mineral

Cass County, Minnesota, for Taxes for the Year 1958.

Table with columns: IN WHOSE NAME ASSESSED, TO WHOM TRANSFERRED, DESCRIPTION OF PROPERTY, TRUE AND FULL VALUATIONS, ASSESSED VALUATIONS, VALUATIONS BY SCHOOL DISTRICTS AS EQUALIZED BY DEPARTMENT OF TAXATION, TAXES, PAID, WHEN PAID, SPECIAL TAXES, TOTAL TAXES, and REMARKS. Includes handwritten entries for property owners like Ralph E. & Florence M. Barnister and Joseph M. & Florence Schutta.

Lot 3 29-143-25

1457' →

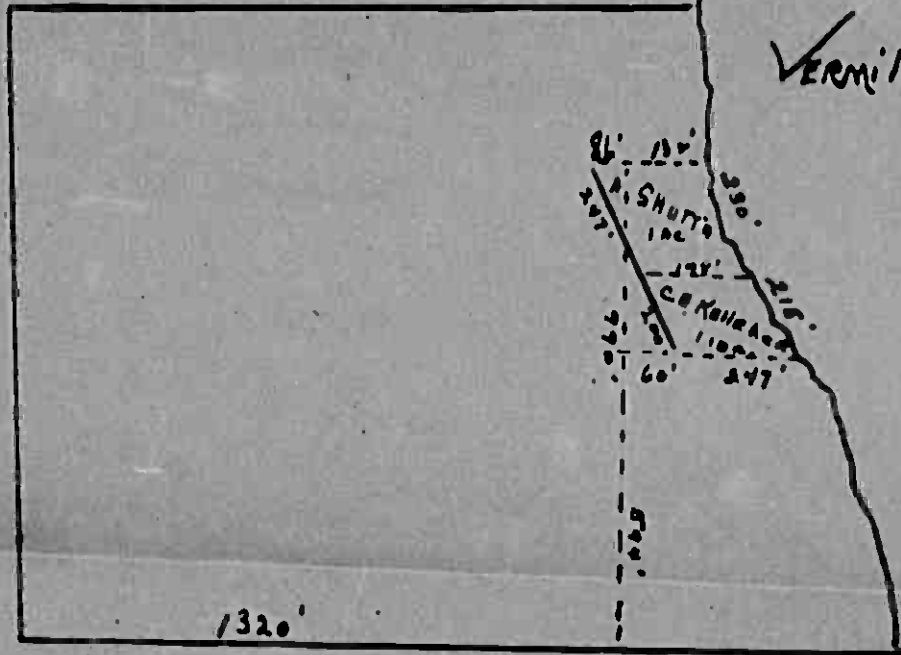

VERMILLION LAKE N



LOT 3

1320'

1320'



1948'

Assessment Roll and Tax List of Real Property in the *County* of *Dorsey*

Cass County, Minnesota, for Taxes for the Year 1958.

Indicate Type of Property: R-Residential, C-Commercial, I-Industrial, U-Utility, F-Farm, L-Lakeshore, T-Timber, M-Mineral

Table with columns: IN WHOSE NAME ASSESSED, TO WHOM TRANSFERRED, DESCRIPTION OF PROPERTY, TRUE AND FULL VALUATIONS (RURAL, ALL OTHER), VALUATIONS BY SCHOOL DISTRICTS AS EQUALIZED BY DEPARTMENT OF TAXATION, SOLD FOR TAXES, PAID, WHEN PAID, Number of Receipt, March Settlement, June Settlement, November Settlement, Collections to First Monday in January 1960, Delinquent on First Monday in January 1960, Total Delinquent Tax and Penalty, REMARKS.

Assessment Roll and Tax List of Real Property in the Down of Downey

* Indicate Type of Property: R-Residential, C-Commercial, I-Industrial, U-Utility, F-Farm, L-Lakeshore, T-Timber, M-Mineral

Cass County, Minnesota, for Taxes for the Year 1958.

Form 300 (1-5-56)

IN WHOSE NAME ASSESSED	TO WHOM TRANSFERRED	DESCRIPTION OF PROPERTY					No. School District	Indicate Homestead Yes or No	Indicate Agricultural Yes or No	Indicate Type of Property	TRUE AND FULL VALUATIONS							TOTAL ASSESSED VALUE	Total Assessed Value as Equalized by the Board of Review	FINAL EQUALIZED VALUE
		SUBDIVISION	Sec. of Lot	Town or Block	Range	Number of Acres of Land Acres 100ths					LAND Exclusive of Structures and Improvements Dollars	BUILDINGS and Other Structures Dollars	MACHINERY Permanently Attached to Real Estate Dollars	TOTAL True and Full Value Dollars	RURAL Homestead Up to \$4,000 20% Over \$4,000 and Non-Homestead 33 1/3 % Dollars	ALL OTHER Timber Land Class 3e 20% Homestead Up to \$4,000 25% Over \$4,000 and Non-Homestead 40% Dollars	MACHINERY Permanently Attached to Real Estate 33 1/3 % Dollars			
U. S. of America		NE 1/4 of NE 1/4																		
U. S. of America		NW 1/4 of NE 1/4																		
U. S. of America		SW 1/4 of NE 1/4																		
State of Minnesota		SE 1/4 of NE 1/4																		
<i>Ralph L. Helma & Suzanne Howard Helma</i>		NE 1/4 of NW 1/4																		
State of Minnesota		NW 1/4 of NW 1/4																		
State of Minnesota		SW 1/4 of NW 1/4																		
State of Minnesota		SE 1/4 of NW 1/4																		
U. S. of America		NE 1/4 of SW 1/4																		
U. S. of America		NW 1/4 of SW 1/4																		
U. S. of America		SW 1/4 of SW 1/4																		
U. S. of America		SE 1/4 of SW 1/4																		
U. S. of America		NE 1/4 of SE 1/4																		
U. S. of America		NW 1/4 of SE 1/4																		
U. S. of America		SW 1/4 of SE 1/4																		
U. S. of America		SE 1/4 of SE 1/4																		

SOLD FOR TAXES	VALUATIONS BY SCHOOL DISTRICTS AS EQUALIZED BY DEPARTMENT OF TAXATION						Tax Including State Homestead	State Tax on Non-Homestead	SPECIAL TAXES	TOTAL TAXES	PAID	WHEN PAID	Number of Receipt	March Settlement 1959	June Settlement 1959	Penalty	November Settlement 1959	Penalty	Collections to First Monday in January 1960	Penalty	Delinquent on First Monday in January 1960	Total Delinquent Tax and Penalty	REMARKS
	District No. No. Rate Mils	District No. No. Rate Mils	District No. No. Rate Mils	District No. No. Rate Mils	District No. No. Rate Mils	District No. No. Rate Mils																	

226 62

19762

14 06

Assessment Roll and Tax List of Real Property in the

Town of Tarrey

Indicate Type of Property: R-Residential, C-Commercial, I-Industrial, U-Utility, F-Farm, L-Lakeshore, T-Timber, M-Mineral

Cass County, Minnesota, for Taxes for the Year 1958.

Table with columns for: IN WHOSE NAME ASSESSED, TO WHOM TRANSFERRED, DESCRIPTION OF PROPERTY, TRUE AND FULL VALUATIONS, ASSESSED VALUATIONS, VALUATIONS BY SCHOOL DISTRICTS AS EQUALIZED BY DEPARTMENT OF TAXATION, TAXES, PAID, WHEN PAID, etc.

Assessment Roll and Tax List of Real Property in the Town of Down of Parry

Cass County, Minnesota, for Taxes for the Year 1958.

Indicate Type of Property: R-Residential, C-Commercial, I-Industrial, U-Utility, F-Farm, L-Lakeshore, T-Timber, M-Mineral

Main table with columns for 'IN WHOSE NAME ASSESSED', 'TO WHOM TRANSFERRED', 'DESCRIPTION OF PROPERTY', 'TRUE AND FULL VALUATIONS', 'ASSESSED VALUATIONS', 'VALUATIONS BY SCHOOL DISTRICTS AS EQUALIZED BY DEPARTMENT OF TAXATION', 'SOLD FOR TAXES', and 'REMARKS'.

Assessment Roll and Tax List of Real Property in the _____ of _____

Indicate Type of Property: R-Residential, C-Commercial, I-Industrial, U-Utility, F-Farm, L-Lakeshore, T-Timber, M-Mineral

Cass County, Minnesota, for Taxes for the Year 1958.

Table with columns for property description, valuations, taxes, and payments. Includes handwritten entries for 'Ralph E. & Florence M. Baunite' and section numbers 1-20.