

ASSESSMENT & TAX LIST · 1962
Salem

SUMMARY OF TAX COLLECTION

Original Levy	- - - - -	\$ 2413.88	
Additions	- - - - -	\$ 22.92	
			\$
Abatements	- - - - -	\$ 22.92	
			\$ 2413.88

COLLECTIONS

March Settlement	- - - - -	\$ 536.46	
June Settlement	- - - - -	\$ 692.94	
November Settlement	- - - - -	\$ 460.67	
January Settlement	- - - - -	\$ 5.10	\$ 1695.19
			\$
Over Collected	- - - - -	\$	
Under Collected	- - - - -	\$	
Delinquent	- - - - -	\$ 718.69	\$
Total	- - - - -		\$ 2413.88

Real Estate

PERSONAL

COLLECTIONS OF TAXES OF 1962, Town OF Salem, CASS COUNTY, MINNESOTA

FUNDS	MARCH SETTLEMENT 1963	JUNE SETTLEMENT 1963	NOV. SETTLEMENT 1963	Amount Collected from Nov. 1962 to First Monday in Jan. 1963	REDUCTIONS	Total Reductions and Collected	BALANCE UNCOLLECTED	ADDITIONS	Total Uncollected to First Monday in January, 1963
State-Non-Homestead,	15 68	8 06	8 99	—					
State-Homestead,	15 26	22 49	14 27	16					
County Revenue,	61 52	86 80	55 12	60					
County Road and Bridge,	38 37	54 13	34 37	37					
County Welfare,	95 41	134 62	85 48	93					
County Bond and Interest	26 22	37 00	23 49	26					
<i>Well Depic</i>									
<i>P&RA</i>	10 15	14 32	9 09	10					
<i>C. Nurse</i>	1 75	2 46	1 57	02					
<i>C. N. Bedg</i>	3 84	5 42	3 45	04					
Town Revenue,	19 18	27 07	17 19	19					
Town Road and Bridge,	10 55	14 89	9 45	10					
Town State Loan,									
School Local 1 Mill,									
School Special,	76 74	57 39	53 26	75					
School State Loan,	132 55								
Deficiency	132 55	187 02	118 75	129					
Tuition									
Transportation									
<i>C O</i>	25 74	36 32	23 07	25					
<i>Civ. Serv.</i>	70	1 00	63	01					
<i>Ag. Serv.</i>	96	1 35	86	01					
<i>Temp.</i>	184	2 60	1 65	02					
	536 46	692 97	460 69	510					

	School District No.	LOCAL 1 MILL	SPECIAL	Deficiency STATE-LOAN	C O	Reg	TOTALS
MARCH SETTLEMENT							
	<i>Un na</i>		76 74	132 55	25 74		235 03
	Totals		76 74	132 55	25 74		235 03
JUNE SETTLEMENT							
	<i>Un na</i>		50 87	175 76	34 13		260 76
	<i>Un na</i>		6 52	11 26	2 19		19 97
Totals		57 39	187 02	36 32		280 73	
NOVEMBER SETTLEMENT							
	<i>Un na</i>		15 48	53 49	10 39		79 36
	<i>Un na</i>		37 78	65 26	12 68		115 72
Totals		53 26	118 75	23 07		175 08	
NOVEMBER to JANUARY							
	<i>Un na.</i>		75	129	25		229
	Totals		75	129	25		229
ADDITIONS							
	Totals						
REDUCTIONS							
	Totals						

Real Estate

Assessment Roll and Tax List of Real Property in the Town of Salem

Form 500 MILLER-DAVIS CO., MINNEAPOLIS

Cass County, Minnesota, for Taxes for the Year 1962.

Table with columns: IN WHOSE NAME ASSESSED, DESCRIPTION OF PROPERTY, TRUE AND FULL VALUATIONS, ASSESSED VALUATIONS, VALUATIONS BY SCHOOL DISTRICTS AS EQUALIZED BY DEPARTMENT OF TAXATION, TAXES, PAID, WHEN PAID, Number of Receipt, March Settlement 1963, June Settlement 1963, November Settlement 1963, Penalty, Collections to First Monday in January 1964, Delinquent on First Monday in January 1964, Total Delinquent Tax and Penalty, REMARKS.

SE⁺ - SW⁺
15-143-26

20931

WOODHOUSE

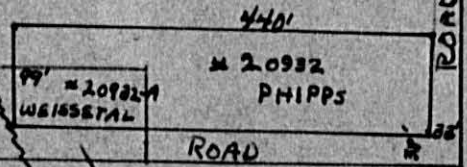

15-143-26
Salem TWP.

Assessment Roll and Tax List of Real Property in the Town of Salem, Cass County, Minnesota, for Taxes for the Year 1962.

Cass County, Minnesota, for Taxes for the Year 1962.

Form 500 MILLER-DAVIS CO., MINNEAPOLIS

Table with columns for IN WHOSE NAME ASSESSED, DESCRIPTION OF PROPERTY, TRUE AND FULL VALUATIONS, ASSESSED VALUATIONS, VALUATIONS BY SCHOOL DISTRICTS AS EQUALIZED BY DEPARTMENT OF TAXATION, and various tax and payment columns.

Assessment Roll and Tax List of Real Property in the Town of Salem, Minnesota

Form SCD MILLER-DAVIS CO., MINNEAPOLIS

Table with columns: IN WHOSE NAME ASSESSED, DESCRIPTION OF PROPERTY, TRUE AND FULL VALUATIONS, ASSESSED VALUATIONS, and FINAL EQUALIZED VALUE. Includes handwritten entries for E. E. Menton, E. E. and Hazel Menton, etc.

Cass County, Minnesota, for Taxes for the Year 1962.

Table with columns: VALUATIONS BY SCHOOL DISTRICTS AS EQUALIZED BY DEPARTMENT OF TAXATION, Tax including State Homestead, State Tax on Non-Homestead, SPECIAL TAXES, TOTAL TAXES, PAID, WHEN PAID, Number of Receipt, March Settlement 1963, June Settlement 1963, Penalty, November Settlement 1963, Penalty, Collections to First Monday in January 1964, Penalty, Delinquent on First Monday in January 1964, Total Delinquent Tax and Penalty, REMARKS. Includes handwritten entries for 1st HALF PAID, 2nd HALF PAID, etc.

Assessment Roll and Tax List of Real Property in the Town of Salem, Cass County, Minnesota, for Taxes for the Year 1962.

FORM SCD MILLER-DAVIS CO., MINNEAPOLIS

Table with columns: IN WHOSE NAME ASSESSED, DESCRIPTION OF PROPERTY, TRUE AND FULL VALUATIONS, ASSESSED VALUATIONS, VALUATIONS BY SCHOOL DISTRICTS AS EQUALIZED BY DEPARTMENT OF TAXATION, TAXES, PAID, WHEN PAID, Number of Receipt, March Settlement 1963, June Settlement 1963, Penalty, November Settlement 1963, Penalty, Collections to First Monday in January 1964, Penalty, Delinquent on First Monday in January 1964, Total Delinquent Tax and Penalty, REMARKS.

Assessment Roll and Tax List of Real Property in the Town of Salem of Cass County, Minnesota, for Taxes for the Year 1962.

Form SCD MILLER-DAVIS CO., MINNEAPOLIS

* Indicate Type of Property: R-Residential, C-Commercial, I-Industrial, U-Utility, F-Farm, L-Lakeshore, T-Timber, M-Mineral

Main table with columns: IN WHOSE NAME ASSESSED, DESCRIPTION OF PROPERTY, TRUE AND FULL VALUATIONS, ASSESSED VALUATIONS, VALUATIONS BY SCHOOL DISTRICTS AS EQUALIZED BY DEPARTMENT OF TAXATION, TAXES, PAID, WHEN PAID, Number of Receipt, March Settlement 1963, June Settlement 1963, November Settlement 1963, Penalty, Collections to First Monday in January 1964, Delinquent on First Monday in January 1964, Total Delinquent Tax and Penalty, REMARKS.

2nd HALF PAID OCT 22 1963
1st HALF PAID MAY 16 1963
2nd HALF PAID OCT 22 1963
1st HALF PAID MAY 16 1963

no tax for 1962

Myron Jacobson
" "
U.S. of America
State of Minn. (Cont. to Myron Jacobson)

20343

Personal

Assessment Roll and Tax List of Real Property in the Town of Salem, Cass County, Minnesota, for Taxes for the Year 1962.

Form 5CD MILLER-DAVIS CO., MINNEAPOLIS

* Indicate Type of Property: R-Residential, C-Commercial, I-Industrial, U-Utility, F-Farm, L-Lakeshore, T-Timber, M-Mineral

Cass County, Minnesota, for Taxes for the Year 1962.

Table with columns: IN WHOSE NAME ASSESSED, DESCRIPTION OF PROPERTY, TRUE AND FULL VALUATIONS, ASSESSED VALUATIONS, VALUATIONS BY SCHOOL DISTRICTS AS EQUALIZED BY DEPARTMENT OF TAXATION, TAXES, PAID, WHEN PAID, Number of Receipt, March Settlement 1963, June Settlement 1963, Penalty, November Settlement 1963, Collections to First Monday in January 1964, Delinquent on First Monday in January 1964, Total Delinquent Tax and Penalty, REMARKS.

Assessment Roll and Tax List of Real Property in the Town of Salem

* Indicate Type of Property: R-Residential, C-Commercial, I-Industrial, U-Utility, F-Farm, L-Lakeshore, T-Timber, M-Mineral

Cass County, Minnesota, for Taxes for the Year 1962.

Form 5CD MILLER-DAVIS CO., MINNEAPOLIS

Table with columns for IN WHOSE NAME ASSESSED, DESCRIPTION OF PROPERTY, TRUE AND FULL VALUATIONS, ASSESSED VALUATIONS, VALUATIONS BY SCHOOL DISTRICTS AS EQUALIZED BY DEPARTMENT OF TAXATION, TAXES, PAID, WHEN PAID, Number of Receipt, March Settlement 1963, June Settlement 1963, Penalty, November Settlement 1963, Penalty, Collections to First Monday in January 1964, Penalty, Delinquent on First Monday in January 1964, Total Delinquent Tax and Penalty, REMARKS.

