

ASSESSMENT & TAX LIST · 1962
Rogers

INDEX TO SECTIONS

SECTION PAGE

Sec. 1	
" 2	
" 3	
" 4	
" 5	
" 6	
" 7	
" 8	
" 9	
" 10	
" 11	
" 12	
" 13	
" 14	
" 15	
" 16	
" 17	
" 18	
" 19	
" 20	
" 21	
" 22	
" 23	
" 24	
" 25	
" 26	
" 27	
" 28	
" 29	
" 30	
" 31	
" 32	
" 33	
" 34	
" 35	
" 36	

For Convenience of Auditor in Showing Boundaries of School Districts

Township No. 142 Range No. 27 Mer. P. M.

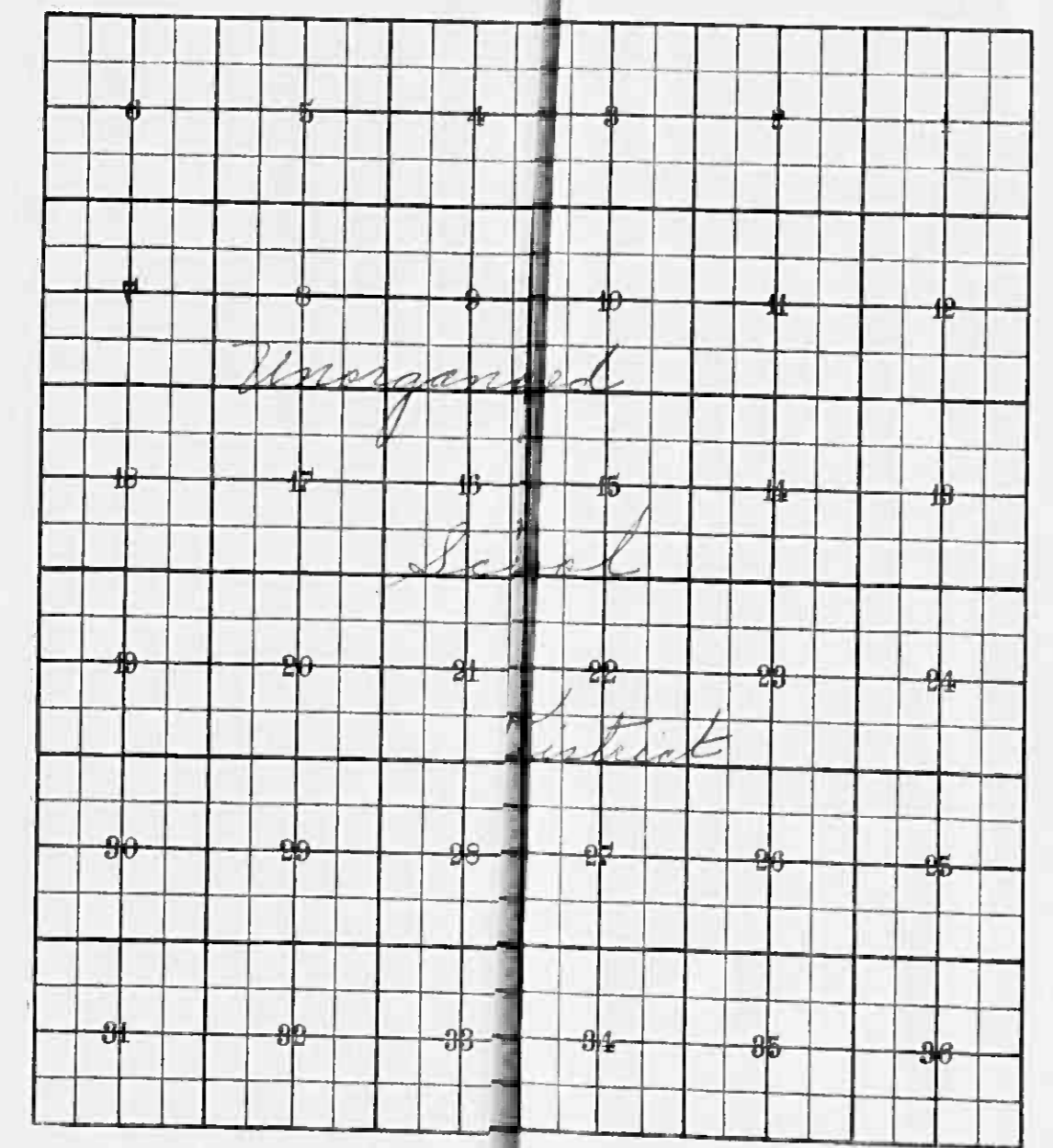

Returns Showing Grain Received in or Handled by Elevators, Warehouses and Mills in the _____ of _____ in the _____ County of _____ for the Year Ending May 1, 1962.

NAMES OF OWNERS	ADDRESS	SUBDIVISION 1				Tax of $\frac{1}{8}$ Mill per Bushel Dollars Cts.	SUBDIVISION 2						Total Subdivision 2 No. Bushels	★ Tax of $\frac{1}{4}$ Mill Per Bushel		★ Total Tax Dollars Cts.	REMARKS
		Bushels of Wheat	Bushels of Soy Beans	Bushels of Flax	Total Subdivision 1 No. Bushels		Bushels of Corn	Bushels of Barley	Bushels of Rye	Bushels of Oats	Bushels of Buckwheat	Bushels of all Other Grains		Dollars	Cts.		

Note ★ Assessors will not fill these Columns

SUMMARY OF TAX COLLECTION

Original Levy	- - - - -	\$ 7560.78	
Additions	- - - - -	\$ 235.58	
			\$
Abatements	- - - - -	\$ 23.22	
			\$ 7773.14

COLLECTIONS

March Settlement	- - - - -	\$ 562.33	
June Settlement	- - - - -	\$ 431.79	
November Settlement	- - - - -	\$ 2123.86	
January Settlement	- - - - -	\$ 48.13	\$ 7046.11
			\$
Over Collected	- - - - -	\$	
Under Collected	- - - - -	\$.04	
Delinquent	- - - - -	\$ 726.99	\$
Total	- - - - -		\$ 7773.10

Part of
Bay Park

Part of
Roberts Beach

Boy Bay Park

TABULAR SCHEDULE OF VALUATIONS,

LEVIED IN THE Town OF Rogers

RATES AND TAXES

COUNTY OF CASS, STATE OF MINNESOTA

School District No.	VALUATION BY SCHOOL DISTRICTS				RATE OF COUNTY TAXES												RATE OF TOWN TAXES							RATE OF SCHOOL TAXES			TAXES LEVIED									
	Agricultural Lands	Non-Agricultural Lands	Personal Property	Total Value of all Property except Money and Credits	Total Rate of State Tax	Rev.	R. & B.	Welfare	Well Bonds and Int. Ref.	PERM. Co. Name	Total Rate of County Tax	Rev.	R. & B.	State Loan	Total Rate of Town Tax	Local	Special	State Loan	Deficiency	Tuition	Transportation	Total Rate of Sch'l Tax	Total Rate of all Taxes	LOCAL 1 MILL AND SPECIAL SCHOOL TAXES BY DISTRICTS					ALL OTHER TAXES							
Dollars	Dollars	Dollars	Dollars	Mills	Mills	Mills	Mills	Mills	Mills	Mills	Mills	Mills	Mills	Mills	Mills	Mills	Mills	Mills	Mills	Mills	Mills	Mills	Mills	Mills	Local 1 Mill	Special	State Loan	Def. C.O.	Total School Taxes	FUNDS	Rate	Amounts				
<u>Un</u>	<u>12,855</u>	<u>11,884</u>	<u>na</u>	<u>2441</u>	<u>27,180</u>	11.	8.31	32.07	20.	49.74	13.67	5.29	.91	125.51	5.	15.	5.																			
Assessed Value	Rural <u>6057</u>	All Other	Personal Property	Total																																
Homestead	<u>6057</u>			<u>6057</u>																																
Non-Homestead	<u>18,682</u>		<u>2441</u>	<u>21,123</u>																																
Total	<u>24,739</u>		<u>2441</u>	<u>27,180</u>																																
			C2 <u>571</u>																																	
			Other <u>1870</u>																																	
			<u>2441</u>																																	

Total Levy, \$ 7560.78

Total Number of Acres 3744.79

State of Minnesota, ss. }
 COUNTY OF CASS }
 I, A. C. Peterson, Auditor of said County and State aforesaid, do hereby certify that the foregoing is a true and correct Schedule, showing the valuation of all the taxable property, in the Town of Rogers, in said County, the several rates of Taxation and Totals of the several Tax Funds levied thereon for the year A. D. 1967.

Witness my hand and official seal, this 17th day of January A. D. 1967

A. C. Peterson County Auditor
By Helen Bilhorn, Deputy

Total Taxes Real Estate 6862.80
 Pers. Prop. 697.98
 Total 7560.78

Plat of Rawn Park
 Rogers Beach
 Boy Bay Park

COLLECTIONS OF TAXES OF 1962

2nd OF Pages

CASS COUNTY, MINNESOTA

FUNDS	MARCH SETTLEMENT 1963	JUNE SETTLEMENT 1963	NOV. SETTLEMENT 1962	Amount Collected from Nov. 1962 to First Monday in Jan. 1963	REDUCTIONS	Total Reductions and Collected	BALANCE UNCOLLECTED	ADDITIONS	Total Uncollected to First Monday in January, 1963
State-Non-Homestead	12 11	106 18	42 90	243					
State-Homestead	11 90	129 05	63 16	135					
County Revenue	63 26	498 79	244 00	520					
County Road and Bridge	39 45	311 07	152 17	324					
County Welfare	98 12	773 62	378 45	808					
County Bond and Interest	26 97	212 61	104 02	223					
Wey def.	10 44	82 28	40 26	87					
P E R A	3 95	31 11	15 22	16					
C. H. Bldg	1 80	14 15	6 42	72					
Co. Nurse	9 86	77 77	38 05	81					
Town Revenue	24 59	233 30	114 13	244					
Town Road and Bridge									
Town State Loan									
Fire	9 86	77 77	38 05	81					
School Local 1 Mill									
School Special	78 64	452 18	244 76	649					
School State Loan									
Deficiency	136 31	1074 73	525 75	1122					
Tuition									
Transportation	26 47	208 72	102 10	218					
c o									
Cen. Assn	73	575	282	06					
Ague Assn	98	778	350	08					
Transp	189	1493	730	16					
	562 33	4311 79	2133 86	4813					

	LOCAL 1 MILL	SPECIAL	STATE LOAN	Deference	c. o	TOTALS
MARCH SETTLEMENT						
School District No.						
Una		26		90	17	133
Una		78 38		135 41	26 30	240 09
Totals		78 64		136 31	26 47	241 42
JUNE SETTLEMENT						
School District No.						
Una		69 96		587 20	114 04	871 20
Una		282 22		487 53	194 68	864 43
Totals		452 18		1074 73	208 72	1735 63
NOVEMBER SETTLEMENT						
School District No.						
Una		59 59		203 87	39 98	305 44
Una		185 17		319 88	6 12	567 17
Totals		244 76		525 75	102 10	872 61
NOVEMBER 10 JANUARY						
School District No.						
Una		649		1122	218	1989
Totals		649		1122	218	1989
ADDITIONS						
School District No.						
Totals						
REDUCTIONS						
School District No.						
Totals						

Part of Lawn Park Rogers Beach Boy Bay Park

Assessment Roll and Tax List of Real Property in the Town of Rogers

* Indicate Type of Property: R-Residential, C-Commercial, I-Industrial, U-Utility, F-Farm, L-Lakeshore, T-Timber, M-Mineral

Table with columns for IN WHOSE NAME ASSESSED, DESCRIPTION OF PROPERTY, TRUE AND FULL VALUATIONS, ASSESSED VALUATIONS, VALUATIONS BY SCHOOL DISTRICTS AS EQUALIZED BY DEPARTMENT OF TAXATION, TAX INCLUDING STATE HOMESTEAD, STATE TAX ON NON-HOMESTEAD, SPECIAL TAXES, TOTAL TAXES, PAID, WHEN PAID, Number of Receipt, March Settlement 1963, June Settlement 1963, Penalty November Settlement 1963, Penalty, Collections to First Monday in January 1964, Penalty, Delinquent on First Monday in January 1964, Total Delinquent Tax and Penalty, REMARKS.

Part of
Town Park
Part of
Rogers Beach
Boy Bay Park

Assessment Roll and Tax List of Real Property in the Town of Rogers

Cass County, Minnesota, for Taxes for the Year 1962.

Form 50D MILNER-DAVIS CO., MINNEAPOLIS. * Indicate Type of Property: R-Residential, C-Commercial, I-Industrial, U-Utility, F-Farm, L-Lakeshore, T-Timber, M-Mineral

Table with columns: IN WHOSE NAME ASSESSED, DESCRIPTION OF PROPERTY, TRUE AND FULL VALUATIONS, ASSESSED VALUATIONS, VALUATIONS BY SCHOOL DISTRICTS AS EQUALIZED BY DEPARTMENT OF TAXATION, TAX INCLUDING STATE HOMESTEAD, SPECIAL TAXES, TOTAL TAXES, PAID, WHEN PAID, Number of Receipt, March Settlement 1963, June Settlement 1963, Penalty, November Settlement 1963, Penalty, Collections to First Monday in January 1964, Penalties, Delinquent on First Monday in January 1964, Total Delinquent Tax and Penalty, REMARKS.

Part of Ray Park Rogers Beach Ray Bay Park

8438
Cancel 970.
970 cancelled

Assessment Roll and Tax List of Real Property in the Town of Rogers

Cass County, Minnesota, for Taxes for the Year 1962.

Form SCD - MILLER-DAVIS CO. - MINNEAPOLIS

* Indicate Type of Property: R-Residential, C-Commercial, I-Industrial, U-Utility, F-Farm, L-Lakeshore, T-Timber, M-Mineral

Table with columns: IN WHOSE NAME ASSESSED, DESCRIPTION OF PROPERTY, TRUE AND FULL VALUATIONS, ASSESSED VALUATIONS, VALUATIONS BY SCHOOL DISTRICTS AS EQUALIZED BY DEPARTMENT OF TAXATION, Tax including State Homestead, State Tax on Non-Homestead, SPECIAL TAXES, TOTAL TAXES, PAID, WHEN PAID, Number of Receipt, March Settlement 1963, June Settlement 1963, Penalty, November Settlement 1963, Penalty, Collections to First Monday in January 1964, Penalty, Delinquent on First Monday in January 1964, Total Delinquent Tax and Penalty, REMARKS.

Frank Rodfrey

State of Minnesota

Frank Rodfrey

Clarence R. & Mary Gladys Raines

" " " "

" " " "

" " " "

Harry & Selma L. Halverson

" " " "

Oscar Halverson

U. S. of America

Harry M. & Selma Halverson

" " " "

" Selma "

" " " "

U. S. of America

Part of Lawn Park

Part of Rogers Beach

Boy Bay Park

32

32

32

32

Assessment Roll and Tax List of Real Property in the Town of Rogers, Cass County, Minnesota

* Indicate Type of Property: R-Residential, C-Commercial, I-Industrial, U-Utility, F-Farm, L-Lakeshore, T-Timber, M-Mineral

Form 501-MILLER-DAVIS CO., MINNEAPOLIS

Table with columns for 'IN WHOSE NAME ASSESSED', 'DESCRIPTION OF PROPERTY', 'TRUE AND FULL VALUATIONS', and 'ASSESSED VALUATIONS'. It lists property details for various owners including the State of Minnesota, U.S. of America, Blandin Paper Company, and Boy River Club.

Cass County, Minnesota, for Taxes for the Year 1962.

Table with columns for 'VALUATIONS BY SCHOOL DISTRICTS AS EQUALIZED BY DEPARTMENT OF TAXATION', 'Tax Including State Homestead', 'State Tax on Non-Homestead', 'SPECIAL TAXES', 'TOTAL TAXES', and 'PAID WHEN PAID'. It includes tax amounts and payment dates for each property.

Plat of Boy Bay Park Rogers Beach

Assessment Roll and Tax List of Real Property in the Town of Rogers of Rogers County, Minnesota

* Indicate Type of Property: R-Residential, C-Commercial, I-Industrial, U-Utility, F-Farm, L-Lakeshore, T-Timber, M-Mineral

Form SCD MILLER-DAVIS CO., MINNEAPOLIS

IN WHOSE NAME ASSESSED	DESCRIPTION OF PROPERTY			No. School District	Indicate Homestead Yes or No	Agricultural Yes or No	Indicate Type of Property	TRUE AND FULL VALUATIONS			ASSESSED VALUATIONS					TOTAL ASSESSED VALUE	Total Assessed Value as Equalized by the Board of Review	FINAL EQUALIZED VALUE		
	SUBDIVISION	Sec. or Lot	Town or Block					Number of Acres of Land	LAND Exclusive of Structures and Improvements	BUILDINGS and Other Structures	MACHINERY Permanently Attached to Real Estate	RURAL		ALL OTHER					MACHINERY Permanently Attached to Real Estate	Seasonal and Recreational Cabins
												Acres 100ths	Dollars	Dollars	Dollars					
State of Minnesota	1	N E 1/4 of NW 1/4	20 14227	20																
U. S. of America	2	N W 1/4 of NE 1/4																		
	3	S W 1/4 of NE 1/4																		
U. S. of America	4	S E 1/4 of NE 1/4																		
	5																			
U. S. of America	6	N E 1/4 of NW 1/4																		
U. S. of America	7	N W 1/4 of NW 1/4																		
State of Minnesota	8	S W 1/4 of NW 1/4																		
State of Minnesota	9	S E 1/4 of NW 1/4																		
	10																			
	11	N E 1/4 of SW 1/4																		
U. S. of America	12	N W 1/4 of SW 1/4																		
U. S. of America	13	S W 1/4 of SW 1/4																		
	14	S E 1/4 of SW 1/4																		
	15																			
U. S. of America	16	N E 1/4 of SE 1/4																		
	17	N W 1/4 of SE 1/4																		
U. S. of America	18	S W 1/4 of SE 1/4																		
U. S. of America	19	S E 1/4 of SE 1/4																		
	20																			

Cass County, Minnesota, for Taxes for the Year 1962.

SOLD FOR TAXES	VALUATIONS BY SCHOOL DISTRICTS AS EQUALIZED BY DEPARTMENT OF TAXATION						Tax Including State Homestead	Sate Tax on Non-Homestead	SPECIAL TAXES	SPECIAL TAXES	TOTAL TAXES	PAID	WHEN PAID	Number of Receipt	March Settlement 1962	June Settlement 1962	Penalty	November Settlement 1962	Penalty	Collections to First Monday in January 1964	Penalty	Delinquent on First Monday in January 1964	Total Delinquent Tax and Penalty	REMARKS	
	District No.	District No.	District No.	District No.	District No.	District No.																			
	Rate	Rate	Rate	Rate	Rate	Rate																			
1																									
2																									
3																									
4																									
5																									
6																									
7																									
8																									
9																									
10																									
11																									
12																									
13																									
14																									
15																									
16																									
17																									
18																									
19																									
20																									

Part of Town Park Roy Bay Park

Assessment Roll and Tax List of Real Property in the Town of Rogers

* Indicate Type of Property: R-Residential, C-Commercial, I-Industrial, U-Utility, F-Farm, L-Lakeshore, T-Timber, M-Mineral

Table with columns: IN WHOSE NAME ASSESSED, DESCRIPTION OF PROPERTY, TRUE AND FULL VALUATIONS, ASSESSED VALUATIONS, FINAL EQUALIZED VALUE. Includes rows 1-20 with property descriptions and valuations.

Cass County, Minnesota, for Taxes for the Year 1962.

Table with columns: SOLD FOR TAXES, VALUATIONS BY SCHOOL DISTRICTS AS EQUALIZED BY DEPARTMENT OF TAXATION, Tax Including State Homestead, SPECIAL TAXES, TOTAL TAXES, PAID, WHEN PAID, Number of Receipt, Settlement dates, and REMARKS. Includes rows 1-20.

Plat of Bay Park Rogers Beach, Boy Bay Park

Assessment Roll and Tax List of Real Property in the Town of Rogers

* Indicate Type of Property: R-Residential, C-Commercial, I-Industrial, U-Utility, F-Farm, L-Lakeshore, T-Timber, M-Mineral

Table with columns for IN WHOSE NAME ASSESSED, DESCRIPTION OF PROPERTY, TRUE AND FULL VALUATIONS, ASSESSED VALUATIONS, VALUATIONS BY SCHOOL DISTRICTS AS EQUALIZED BY DEPARTMENT OF TAXATION, and various tax and payment details.

Assessment Roll and Tax List of Real Property in the

Town of Rogers

* Indicate Type of Property: R-Residential, C-Commercial, I-Industrial, U-Utility, F-Farm, L-Lakeshore, T-Timber, M-Mineral

Cass County, Minnesota, for Taxes for the Year 1962.

Form 301 MILLER-DAVIS CO., MINNEAPOLIS

Table with columns: IN WHOSE NAME ASSESSED, SUBDIVISION, No. School District, Indicate Homestead, Acreage, TRUE AND FULL VALUATIONS (LAND, BUILDINGS, MACHINERY, TOTAL True and Full Value), RURAL (Homestead 20%, 33 1/2%), ALL OTHER (Homestead 25%, 40%), MACHINERY, Seasonal and Recreational Cabins, TOTAL ASSESSED VALUE, Total Assessed Value as Equalized by the Board of Review, FINAL EQUALIZED VALUE.

Table with columns: SOLD FOR TAXES, VALUATIONS BY SCHOOL DISTRICTS AS EQUALIZED BY DEPARTMENT OF TAXATION (District No., Rate, Mills), Tax including State Homestead, State Tax on Non-Homestead, SPECIAL TAXES, TOTAL TAXES, PAID, WHEN PAID (Month, Day, Year), Number of Receipt, March Settlement, June Settlement, Penalty, November Settlement, Penalty, Collections to First Monday in January, 1964, Penalty, Delinquent on First Monday in January, 1964, Total Delinquent Tax and Penalty, REMARKS.

Plat of Rogers Beach Boy Bay Park

Assessment Roll and Tax List of Real Property in the Town of Rogers, Cass County, Minnesota, for Taxes for the Year 1962.

Form 5013 MILLER-DAVIS CO., MINNEAPOLIS

* Indicate Type of Property: R-Residential, C-Commercial, I-Industrial, U-Utility, F-Farm, L-Lakeshore, T-Timber, M-Mineral

Table with columns: IN WHOSE NAME ASSESSED, DESCRIPTION OF PROPERTY, TRUE AND FULL VALUATIONS, ASSESSED VALUATIONS, VALUATIONS BY SCHOOL DISTRICTS AS EQUALIZED BY DEPARTMENT OF TAXATION, TAX INCLUDING STATE HOMESTEAD, SPECIAL TAXES, TOTAL TAXES, PAID, WHEN PAID, Number of Receipt, March Settlement 1963, June Settlement 1963, Penalty, November Settlement 1963, Penalty, Collections to First Monday in January 1964, Penalty, Delinquent on First Monday in January 1964, Total Delinquent Tax and Penalty, REMARKS.

Handwritten notes: Edward F. Rosack + Stanley R. Hampel, Edward J. Sunhild E. Larson

Handwritten number: 8221

Vertical text on the right edge: Plat of Farm Park, Plat of Rogers Beach, Boy Day Park

Assessment Roll and Tax List of Real Property in the Town of Rogers of Rogers

Cass County, Minnesota, for Taxes for the Year 1962.

Form 501-MILLER-DAVIS CO., MINNEAPOLIS

* Indicate Type of Property: R-Residential, C-Commercial, I-Industrial, U-Utility, F-Farm, L-Lakeshore, T-Timber, M-Mineral

Table with columns: IN WHOSE NAME ASSESSED, DESCRIPTION OF PROPERTY, TRUE AND FULL VALUATIONS, ASSESSED VALUATIONS, VALUATIONS BY SCHOOL DISTRICTS AS EQUALIZED BY DEPARTMENT OF TAXATION, Tax including State Homestead, State Tax on Non-Homestead, SPECIAL TAXES, PAID, WHEN PAID, Number of Receipt, March Settlement 1963, June Settlement 1963, Penalty, November Settlement 1963, Collections to First Monday in January 1964, Delinquent on First Monday in January 1964, Total Delinquent Tax and Penalty, REMARKS.

Assessment Roll and Tax List of Real Property

Cass County, Minnesota, for Taxes for the Year 1962.

Form 302 MILLER-DAVIS CO., MINNEAPOLIS

* Indicate Type of Property: R-Residential, C-Commercial, I-Industrial, U-Utility, F-Farm, L-Lakeshore, T-Timber, M-Mineral

Table with multiple columns: IN WHOSE NAME ASSESSED, DESCRIPTION OF PROPERTY, TRIM AND FULL VALUATIONS, ASSESSED VALUATIONS, VALUATIONS BY SCHOOL DISTRICTS AS EQUALIZED BY DEPARTMENT OF TAXATION, Tax including State Homestead, SPECIAL TAXES, TOTAL TAXES, PAID, WHEN PAID, Number of Receipt, March Settlement 1963, June Settlement 1963, November Settlement 1963, Penalties, Delinquent Tax and Penalty, REMARKS.

Handwritten entries in the table, including names like John W. & Viola Wilson, Clef Anderson, Kertrude H. Cusack, Lerger D. & Louise Heron, Arthur M. & Kathryn H. McCullor, Lillian M. Peterson, and Robert Lee Mary Jean Biehn.

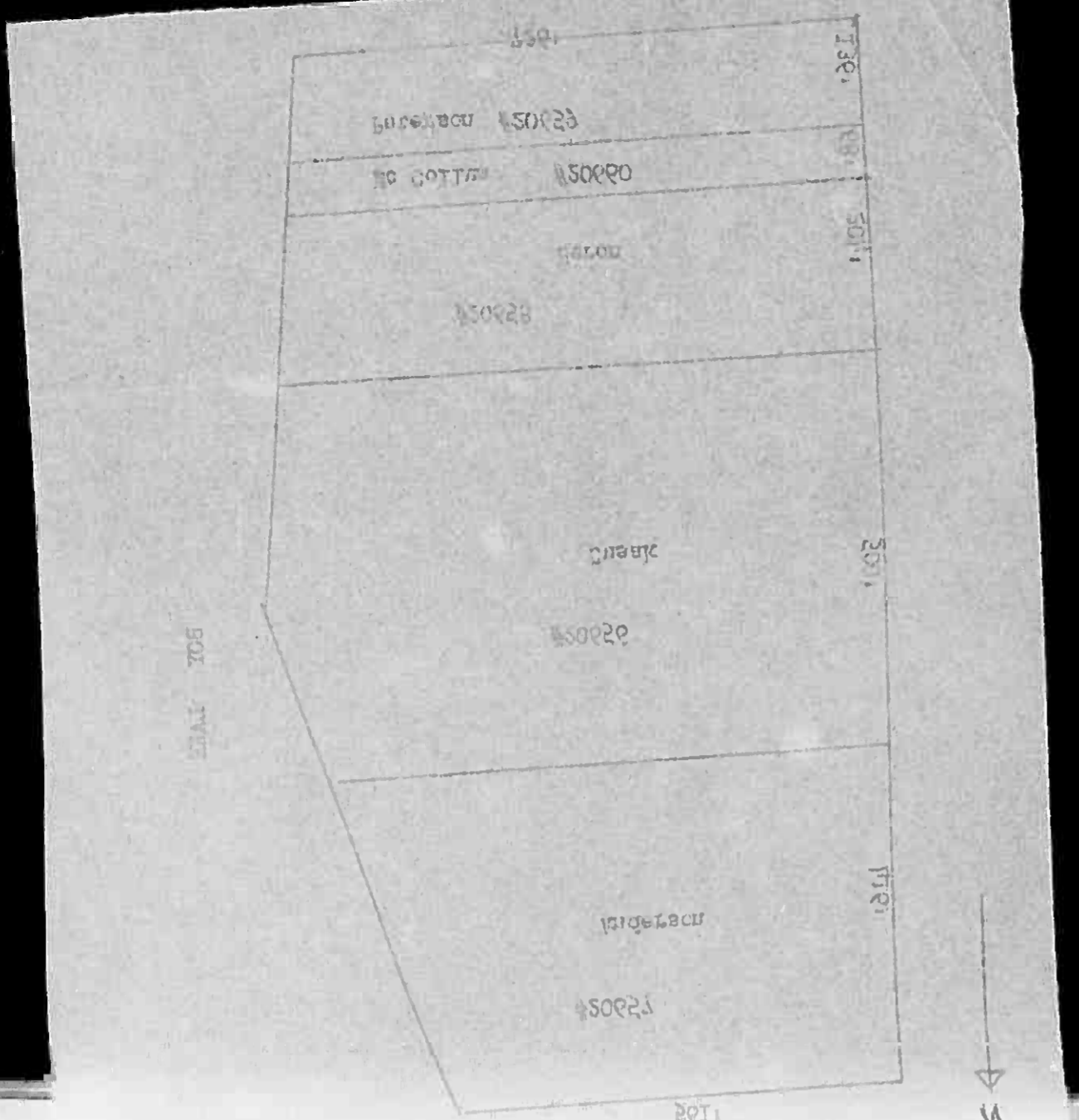

Assessment Roll and Tax List of Real Property in the Town of Rogers

Cass County, Minnesota, for Taxes for the Year 1962.

Form 300 MILLER-DAVIS CO., MINNEAPOLIS

* Indicate Type of Property: R-Residential, C-Commercial, I-Industrial, U-Utility, F-Farm, L-Lakeshore, T-Timber, M-Mineral

IN WHOSE NAME ASSESSED	DESCRIPTION OF PROPERTY					No. School District	Indicate Homestead Yes or No	Agricultural Rec. Yes or No	Indicate Type of Property	TRUE AND FULL VALUATIONS					ASSESSED VALUATIONS										FINAL EQUALIZED VALUE Dollars						
	SUBDIVISION	Sec. or Lot	Town or Block	Rng.	Number of Acres of Land					MACHINERY Permanently Attached to Real Estate	TOTAL True and Full Value	RURAL			ALL OTHER				Seasonal and Recreational Cabins	TOTAL ASSESSED VALUE	Total Assessed Value as Equalized by the Board of Review										
												LAND		BUILDINGS and Other Structures	Homestead Up to \$4,000 20%	Over \$4,000 and Non-Homestead 33 1/3%	Timber Land Class 3e 20%	Homestead Up to \$4,000 25%				Over \$4,000 and Non-Homestead 40%	MACHINERY Permanently Attached to Real Estate 33 1/3%								
												+ 50 00	+ 50 00																		
Barthelmy Mullett	NE 1/4 of Sect 1	19	D4227	60	UN	70	70	L	84	56		84	56					17	28												
									51							28	19														
Walter E. Ostalek Paul R. Jynola & Smith	SW 1/4 of Sect 2			14	70	70	L	248	165		248	165					50	83													
								150																							
Harvey & Carmen Countryman	NE 1/4 of Sect 3			35	70	70	R	217	145		217	145					138	90		138											
								132	198		412	252																			
				50	60																										

(Cont. Next Page)

SOLD FOR TAXES	VALUATIONS BY SCHOOL DISTRICTS AS EQUALIZED BY DEPARTMENT OF TAXATION						Tax Including State Homestead	State Tax on Non-Homestead	SPECIAL TAXES	SPECIAL TAXES	TOTAL TAXES	PAID	WHEN PAID	Number of Receipt	March Settlement 1963	June Settlement 1963	Penalty	November Settlement 1963	Penalty	Collections to First Monday in January 1964	Penalty	Delinquent on First Monday in January 1964	Total Delinquent Tax and Penalty	REMARKS
	District No.	District No.	District No.	District No.	District No.	District No.																		
	Rate	Rate	Rate	Rate	Rate	Rate																		
	Dollars	Dollars	Dollars	Dollars	Dollars	Dollars																		

Plat of Farm Park
Plat of Rogers Beach
Boy Bay Park

Assessment Roll and Tax List of Real Property in the Town of Rogers

* Indicate Type of Property: R-Residential, C-Commercial, I-Industrial, U-Utility, F-Farm, L-Lakeshore, T-Timber, M-Mineral

Form 501 MILLER-DAVIS CO., MINNEAPOLIS

Table with columns: IN WHOSE NAME ASSESSED, DESCRIPTION OF PROPERTY, TRUE AND FULL VALUATIONS, ASSESSED VALUATIONS, and FINAL EQUALIZED VALUE. Includes handwritten entries for various property owners like Rose E. Lippert and Mabel G. Meyer.

Cass County, Minnesota, for Taxes for the Year 1962.

Table with columns: VALUATIONS BY SCHOOL DISTRICTS AS EQUALIZED BY DEPARTMENT OF TAXATION, Tax Including State Homestead, SPECIAL TAXES, TOTAL TAXES, PAID, WHEN PAID, Number of Receipt, March Settlement, June Settlement, November Settlement, Collections to First Monday in January 1964, Delinquent on First Monday in January 1964, Total Delinquent Tax and Penalty, REMARKS. Includes handwritten notes and calculations.

Assessment Roll and Tax List of Real Property in the Town of Rogers of Cass County, Minnesota

Form 301 MILLER-DAVIS CO., MINNEAPOLIS

* Indicate Type of Property: R-Residential, C-Commercial, I-Industrial, U-Utility, F-Farm, L-Lakeshore, T-Timber, M-Mineral

Table with columns: IN WHOSE NAME ASSESSED, DESCRIPTION OF PROPERTY, TRUE AND FULL VALUATIONS (LAND, BUILDINGS, MACHINERY, TOTAL), ASSESSED VALUATIONS (RURAL, ALL OTHER, MACHINERY, Seasonal and Recreational Cabins, TOTAL ASSESSED VALUE), FINAL EQUALIZED VALUE.

(Cont. Next Page)

Cass County, Minnesota, for Taxes for the Year 1962.

Table with columns: VALUATIONS BY SCHOOL DISTRICTS AS EQUALIZED BY DEPARTMENT OF TAXATION (District No., Rate, etc.), Tax including State Homestead, State Tax on Non-Homestead, SPECIAL TAXES, TOTAL TAXES, PAID, WHEN PAID, Number of Receipt, March Settlement, June Settlement, November Settlement, Collections to First Monday in January, Delinquent on First Monday in January, Total Delinquent Tax and Penalty, REMARKS.

Plat of Lawn Park Rogers Beach Boy Bay Park

Assessment Roll and Tax List of Real Property in the Town of Rogers, Minnesota

Form 500 MILLER-DAVIS CO., MINNEAPOLIS

* Indicate Type of Property: R-Residential, C-Commercial, I-Industrial, U-Utility, F-Farm, L-Lakeshore, T-Timber, M-Mineral

Table with columns: IN WHOSE NAME ASSESSED, DESCRIPTION OF PROPERTY, TRUE AND FULL VALUATIONS, ASSESSED VALUATIONS, and FINAL EQUALIZED VALUE. Includes handwritten entries for Arthur G. Evelyn A. Emerson, John + Mildred Hultum, and Helen F. Hatt.

Cass County, Minnesota, for Taxes for the Year 1962.

Table with columns: VALUATIONS BY SCHOOL DISTRICTS AS EQUALIZED BY DEPARTMENT OF TAXATION, Tax Including State Homestead, State Tax on Non-Homestead, SPECIAL TAXES, TOTAL TAXES, PAID, WHEN PAID, Number of Receipt, March Settlement, June Settlement, November Settlement, Collections to First Monday in January 1961, Delinquent on First Monday in January 1961, Total Delinquent Tax and Penalty, and REMARKS. Includes handwritten tax payment records.

Part of Farm Park Rogers Beach Boy Bay Park

Assessment Roll and Tax List of Real Property in the Town of Rogers, Cass County, Minnesota, for Taxes for the Year 1962.

Form 301 MILLER-DAVIS CO., MINNEAPOLIS

* Indicate Type of Property: R-Residential, C-Commercial, I-Industrial, U-Utility, F-Farm, L-Lakeshore, T-Timber, M-Mineral

Main table with columns: IN WHOSE NAME ASSESSED, DESCRIPTION OF PROPERTY, TRUE AND FULL VALUATIONS, ASSESSED VALUATIONS, VALUATIONS BY SCHOOL DISTRICTS AS EQUALIZED BY DEPARTMENT OF TAXATION, Tax including State Homestead, SPECIAL TAXES, TOTAL TAXES, PAID, WHEN PAID, Number of Receipt, March Settlement 1963, June Settlement 1963, Penalty, November Settlement 1963, Collections to First Monday in January 1964, Delinquent on First Monday in January 1964, Total Delinquent Tax and Penalty, REMARKS.

Plat of Farm Park, Plat of Rogers Beach, Boy Bay Park

Assessment Roll and Tax List of Real Property in the Town of Rogers, Minnesota

Form 502 MILLER-DAVIS CO., MINNEAPOLIS

Table with columns: IN WHOSE NAME ASSESSED, DESCRIPTION OF PROPERTY, TRUE AND FULL VALUATIONS, ASSESSED VALUATIONS, and FINAL EQUALIZED VALUE. Includes entries for State of Minnesota, U.S. of America, and individuals like W.D. & Lavina Rogers.

Cass County, Minnesota, for Taxes for the Year 1962.

Table with columns: VALUATIONS BY SCHOOL DISTRICTS AS EQUALIZED BY DEPARTMENT OF TAXATION, Tax including State Homestead, SPECIAL TAXES, TOTAL TAXES, PAID, WHEN PAID, Number of Receipt, March Settlement 1963, June Settlement 1963, November Settlement 1963, Collections to First Monday in January 1964, Delinquent on First Monday in January 1964, Total Delinquent Tax and Penalty, and REMARKS. Includes tax amounts and payment dates.

Assessment Roll and Tax List of Real Property in the Town of Rogers, Cass County, Minnesota, for Taxes for the Year 1962.

Cass County, Minnesota, for Taxes for the Year 1962.

Form 500 MILLER-DAVIS CO., MINNEAPOLIS

* Indicate Type of Property: R-Residential, C-Commercial, I-Industrial, U-Utility, F-Farm, L-Lakeshore, T-Timber, M-Mineral

Main table with columns: IN WHOSE NAME ASSESSED, DESCRIPTION OF PROPERTY, TRUE AND FULL VALUATIONS, ASSESSED VALUATIONS, VALUATIONS BY SCHOOL DISTRICTS AS EQUALIZED BY DEPARTMENT OF TAXATION, Tax Including State Homestead, State Tax on Non-Homestead, SPECIAL TAXES, TOTAL TAXES, PAID, WHEN PAID, Number of Receipt, March Settlement 1963, June Settlement 1963, Penalty, November Settlement 1963, Penalty, Collections to First Monday in January 1964, Penalty, Delinquent on First Monday in January 1961, Total Delinquent Tax and Penalty, REMARKS.

Part of
Rogers Parish
Rogers Parish
Rogers Parish

Assessment Roll and Tax List of Real Property in the Town of Rosmar of Cass County, Minnesota

Cass County, Minnesota, for Taxes for the Year 1962.

Form 501 - MILLER-DAVIS CO., MINNEAPOLIS

* Indicate Type of Property: R-Residential, C-Commercial, I-Industrial, U-Utility, F-Farm, L-Lakeshore, T-Timber, M-Mineral

Table with columns: IN WHOSE NAME ASSESSED, DESCRIPTION OF PROPERTY, ASSESSED VALUATIONS (RURAL, ALL OTHER, MACHINERY, etc.), VALUATIONS BY SCHOOL DISTRICTS AS EQUALIZED BY DEPARTMENT OF TAXATION, TAXES (SOLD FOR TAXES, SPECIAL TAXES, TOTAL TAXES), PAID WHEN PAID, Number of Receipt, March Settlement, June Settlement, November Settlement, Collections to First Monday in January 1964, Delinquent on First Monday in January 1964, Total Delinquent Tax and Penalty, REMARKS.

Assessment Roll and Tax List of Real Property in the Town of Rogers, Cass County, Minnesota, for Taxes for the Year 1962.

Cass County, Minnesota, for Taxes for the Year 1962.

Form SD) MILLER-DAVIS CO., MINNEAPOLIS

Table with columns for Assessment Roll and Tax List. Includes fields for Description of Property, True and Full Valuations, Assessed Valuations, Final Equalized Value, School District, and Tax Information. Includes handwritten entries and calculations.

Part of Lawm Park, Rogers Beach, Boy Bay Park

Assessment Roll and Tax List of Real Property in the Town of Rogers, Minnesota

Form 501 MILLER-DAVIS CO., MINNEAPOLIS

Table with columns: IN WHOSE NAME ASSESSED, DESCRIPTION OF PROPERTY, TRUE AND FULL VALUATIONS, ASSESSED VALUATIONS, and FINAL EQUALIZED VALUE.

(Cont. next page)

Cass County, Minnesota, for Taxes for the Year 1962.

Table with columns: VALUATIONS BY SCHOOL DISTRICTS AS EQUALIZED BY DEPARTMENT OF TAXATION, TAXES, PAID, WHEN PAID, and REMARKS.

Plat of Farm Park, Rogers Beach, Boy Bay Park

Assessment Roll and Tax List of Real Property in the Town of Rogers, Minnesota

Form 500 MILLER-DAVIS CO., MINNEAPOLIS

Table with columns: IN WHOSE NAME ASSESSED, SUBDIVISION, Number of Acres of Land, TRUE AND FULL VALUATIONS, ASSESSED VALUATIONS, FINAL EQUALIZED VALUE.

Cass County, Minnesota, for Taxes for the Year 1962.

Table with columns: VALUATIONS BY SCHOOL DISTRICTS AS EQUALIZED BY DEPARTMENT OF TAXATION, Tax Including State Homestead, SPECIAL TAXES, TOTAL TAXES, PAID, WHEN PAID, Number of Receipt, March Settlement, June Settlement, November Settlement, Collections to First Monday in January 1961, Delinquent on First Monday in January 1961, Total Delinquent Tax and Penalty, REMARKS.

Assessment Roll and Tax List of Real Property in the Town of Rogers

* Indicate Type of Property: R-Residential, C-Commercial, I-Industrial, U-Utility, F-Farm, L-Lakeshore, T-Timber, M-Mineral

Form 501 MILLER-DAVIS CO., MINNEAPOLIS

Table with columns: IN WHOSE NAME ASSESSED, DESCRIPTION OF PROPERTY, TRUE AND FULL VALUATIONS, ASSESSED VALUATIONS, and FINAL EQUALIZED VALUE. Includes handwritten entries for various property owners like Harvey & Larner, Olaf Johnson, and James Francis & Shirley Mae Dager.

Cass County, Minnesota, for Taxes for the Year 1962.

Table with columns: VALUATIONS BY SCHOOL DISTRICTS AS EQUALIZED BY DEPARTMENT OF TAXATION, Tax including State Homestead, SPECIAL TAXES, TOTAL TAXES, PAID, WHEN PAID, Number of Receipt, and REMARKS. Includes handwritten calculations and tax payment dates.

Part of Farm Park Rogers Beach Boy Bay Park

Assessment Roll and Tax List of Real Property in the Town of Rogers, Minnesota

Form 500 MILLER-DAVIS CO., MINNEAPOLIS

Table with columns: IN WHOSE NAME ASSESSED, DESCRIPTION OF PROPERTY, TRUE AND FULL VALUATIONS, ASSESSED VALUATIONS, and FINAL EQUALIZED VALUE. Includes rows for State of Minnesota and Wheeler Bros. Bridge Supply Co.

Cass County, Minnesota, for Taxes for the Year 1962.

Table with columns: VALUATIONS BY SCHOOL DISTRICTS AS EQUALIZED BY DEPARTMENT OF TAXATION, Tax Including State Homestead, State Tax on Non-Homestead, SPECIAL TAXES, TOTAL TAXES, PAID, WHEN PAID, Number of Receipt, March Settlement, June Settlement, November Settlement, Collections to First Monday in January, Delinquent on First Monday in January, Total Delinquent Tax and Penalty, REMARKS. Includes handwritten entries like 'FORFEITED 9/23/63' and 'Cancel 7.58'.

Assessment Roll and Tax List of Real Property in the Town of Rogers, Minn.

* Indicate Type of Property: R-Residential, C-Commercial, I-Industrial, U-Utility, F-Farm, L-Lakeshore, T-Timber, M-Mineral

Form 501 MILLER-DAVIS CO., MINNEAPOLIS

Cass County, Minnesota, for Taxes for the Year 1962.

Main assessment table with columns: IN WHOSE NAME ASSESSED, DESCRIPTION OF PROPERTY, TRUE AND FULL VALUATIONS, ASSESSED VALUATIONS, VALUATIONS BY SCHOOL DISTRICTS, Tax Including State Homestead, State Tax on Non-Homestead, SPECIAL TAXES, TOTAL TAXES, PAID, WHEN PAID, Number of Receipt, March Settlement 1961, June Settlement 1961, November Settlement 1961, Collections to First Monday in January 1961, Delinquent on First Monday in January 1961, Total Delinquent Tax and Penalty, REMARKS.

Plat of Rogers Beach

Plat of Rogers Beach

Boy Bay Park

Assessment Roll and Tax List of Real Property in the Town of Rogers, Minnesota

Form 501 MILLER-DAVIS CO., MINNEAPOLIS

Table with columns: IN WHOSE NAME ASSESSED, DESCRIPTION OF PROPERTY, TRUE AND FULL VALUATIONS, ASSESSED VALUATIONS, and FINAL EQUALIZED VALUE. Includes handwritten entries for Edward E. Vallens and various land parcels.

Cass County, Minnesota, for Taxes for the Year 1962.

Table with columns: VALUATIONS BY SCHOOL DISTRICTS AS EQUALIZED BY DEPARTMENT OF TAXATION, TAX INCLUDING STATE HOMESTEAD, SPECIAL TAXES, TOTAL TAXES, PAID, WHEN PAID, Number of Receipt, March Settlement 1963, June Settlement 1963, November Settlement 1963, Collections to First Monday in January 1964, Delinquent on First Monday in January 1964, Total Delinquent Tax and Penalty, and REMARKS. Includes handwritten entries for Edward E. Vallens.

Part of Farm Park, Part of Rogers Beach, Boy Bay Park

Assessment Roll and Tax List of Real Property in the Town of Rogers of Rogers County, Minnesota
* Indicate Type of Property: R-Residential, C-Commercial, I-Industrial, U-Utility, F-Farm, L-Lakeshore, T-Timber, M-Mineral

IN WHOSE NAME ASSESSED	DESCRIPTION OF PROPERTY				No. School District	Indicate Homestead Yes or No	Agricultural Use Yes or No	Indicate Type of Property	TRUE AND FULL VALUATIONS			ASSESSED VALUATIONS							FINAL EQUALIZED VALUE		
	SUBDIVISION	Sec. or Lot	Town or Block	Number of Acres of Land					LAND Exclusive of Structures and Improvements	BUILDINGS and Other Structures	MACHINERY Permanently Attached to Real Estate	TOTAL True and Full Value	RURAL		ALL OTHER		MACHINERY Permanently Attached to Real Estate	Seasonal and Recreational Cabins		TOTAL ASSESSED VALUE	Total Assessed Value as Equalized by the Board of Review
													Acres 100ths	Homestead Up to \$4,000 20%	Over \$4,000 and Non-Homestead 33 1/3%	Timber Land Class Se 20%					
State of Minnesota				36 42.27																	
State of Minnesota																					
State of Minnesota																					
State of Minnesota																					
State of Minnesota																					
State of Minnesota																					
State of Minnesota																					
State of Minnesota																					
State of Minnesota																					
State of Minnesota																					
State of Minnesota																					
State of Minnesota																					
U.S. of America																					
State of Minnesota																					
State of Minnesota																					

Cass County, Minnesota, for Taxes for the Year 1962.

SOLD FOR TAXES	VALUATIONS BY SCHOOL DISTRICTS AS EQUALIZED BY DEPARTMENT OF TAXATION						Tax Including State Homestead	State Tax on Non-Homestead	SPECIAL TAXES	SPECIAL TAXES	TOTAL TAXES	PAID	WHEN PAID	Number of Receipt	March Settlement 1961	June Settlement 1961	Penalty	November Settlement 1961	Penalty	Collections to First Monday in January 1964	Penalty	Delinquent on First Monday in January 1964	Total Delinquent Tax and Penalty	REMARKS
	District No.	District No.	District No.	District No.	District No.	District No.																		
	Rate	Rate	Rate	Rate	Rate	Rate																		

Part of Pown Park Rogers Beach Boy Bay Park

Assessment Roll and Tax List of Real Property in the _____ of _____

* Indicate Type of Property: R-Residential, C-Commercial, I-Industrial,

Form 500 MILLER-DAVIS CO., MINNEAPOLIS

IN WHOSE NAME ASSESSED

IN WHOSE NAME ASSESSED	DESCRIPTION OF PROPERTY				No. School District	Indicate Home-Steer Yes or No	Agr or Seas-Steer Yes or No	* Indicate Type of Property	TRUE AND FULL VALUATIONS				RURAL		T	REMARKS		
	SUBDIVISION	Sec. or Lot	Town or Block	Number of Acres of Land					LAND Exclusive of Structures and Improvements	BUILDINGS and Other Structures	MACHINERY Permanently Attached to Real Estate	TOTAL True and Full Value	Homestead Up to \$4,000 20%	Over \$4,000 and Non-Homestead 33 1/3%			D	C
1	N E 1/4 of N E 1/4																	
2	N W 1/4 of N E 1/4																	
3	S W 1/4 of N E 1/4																	
4	S E 1/4 of N E 1/4																	
5																		
6	N E 1/4 of N W 1/4																	
7	N W 1/4 of N W 1/4																	
8	S W 1/4 of N W 1/4																	
9	S E 1/4 of N W 1/4																	
10																		
11	N E 1/4 of S W 1/4																	
12	N W 1/4 of S W 1/4																	
13	S W 1/4 of S W 1/4																	
14	S E 1/4 of S W 1/4																	
15																		
16	N E 1/4 of S E 1/4																	
17	N W 1/4 of S E 1/4																	
18	S W 1/4 of S E 1/4																	
19	S E 1/4 of S E 1/4																	
20																		

PAGES

40

THRU

48

BLANK

Cass County, Minnesota, for Taxes for the Year 1962.

AS SECTION	District	Tax Including State Homestead	State Tax on Non- Homestead	SPECIAL TAXES	SPECIAL TAXES	TOTAL TAXES	PAID	WHEN PAID	Number of Receipt	March Settlement 1962	June Settlement 1962	Penalty	November Settlement 1962	Penalty	Collections to First Monday in January 1964	Penalty	Delinquent on First Monday in January 1964	Total Delinquent Tax and Penalty	REMARKS																	
																				Rate	Mills	Mills	Dollars	cts.	cts.	cts.	cts.	cts.	cts.	cts.	cts.	cts.	cts.	cts.	cts.	cts.
																				Dollars	cts.	cts.	cts.	cts.	cts.	cts.	cts.	cts.	cts.	cts.	cts.	cts.	cts.	cts.	cts.	cts.
1																																				
2																																				
3																																				
4																																				
5																																				
6																																				
7																																				
8																																				
9																																				
10																																				
11																																				
12																																				
13																																				
14																																				
15																																				
16																																				
17																																				
18																																				
19																																				
20																																				

Part of Town Park, Rogers Beach, Bay Bay Park

Assessment Roll and Tax List of Real Property in the Town of Rogers

* Indicate Type of Property: R-Residential, C-Commercial, I-Industrial, U-Utility, F-Farm, L-Lakeshore, T-Timber, M-Mineral

50 MILLER-DAVIS CO., MINNEAPOLIS

Table with columns: IN WHOSE NAME ASSESSED, SUBDIVISION, DESCRIPTION OF PROPERTY, TRUE AND FULL VALUATIONS, ASSESSED VALUATIONS, and FINAL EQUALIZED VALUE. Includes handwritten entries for property owners like Marton J. Johnson and Ralph E. + Ludrun V. Swanson.

Summary of values: 510, 1200, 1710, 90, 480, 570, 630, 564, 1320, 1884, 160, 530, 792, 842, 1780, 2822, 146, 938

Cass County, Minnesota, for Taxes for the Year 1962.

Table with columns: VALUATIONS BY SCHOOL DISTRICTS AS EQUALIZED BY BOARD OF TAXATION, Tax Including State Homestead, State Tax on Non-Homestead, SPECIAL TAXES, TOTAL TAXES, PAID, WHEN PAID, Number of Receipt, March Settlement 1963, June Settlement 1963, November Settlement 1963, Delinquent on First Monday in January 1964, Total Delinquent Tax and Penalty, REMARKS. Includes handwritten entries for property owners and tax amounts.

Summary of taxes: 792, 146 = 938, 4108, 20700, 804, 25612

Plat of Fawn Park

Plat of Rogers Beach

Boy Bay Park

Assessment Roll and Tax List of Real Property in the Town of Rogers

* Indicate Type of Property: R-Residential, C-Commercial, I-Industrial, U-Utility, F-Farm, L-Lakeshore, T-Timber, M-Mineral

Table with columns: IN WHOSE NAME ASSESSED, SUBDIVISION, Sec. of Lot, Town or Rng., Number of Acres of Land, No. School District, Indicate Home-stead, Indicate Agr. or Recreational, Indicate Type of Property, TRUE AND FULL VALUATIONS (RURAL, ALL OTHER, MACHINERY, Seasonal and Recreational Cabins), ASSESSED VALUATIONS (Homestead, Over \$4,000 and Non-Homestead, Timber Land Class 3e, Over \$4,000 and Non-Homestead, MACHINERY Permanently Attached to Real Estate, Seasonal and Recreational Cabins), Total Assessed Value as Equalized by the Board of Review, FINAL EQUALIZED VALUE.

Cass County, Minnesota, for Taxes for the Year 1962.

Table with columns: SOLD FOR TAXES, VALUATIONS BY SCHOOL DISTRICTS AS EQUALIZED BY DEPARTMENT OF TAXATION (District No., Rate, etc.), Tax Including State Homestead, State Tax on Non-Homestead, SPECIAL TAXES, TOTAL TAXES, PAID, WHEN PAID (Month Day Year), Number of Receipt, March Settlement 1963, June Settlement 1963, Penalty, November Settlement 1963, Penalty, Collections to First Monday in January 1964, Delinquent on First Monday in January 1964, Total Delinquent Tax and Penalty, REMARKS.

Plat of Lawn Park

Plat of Rogers Beach

Boy Bay Park

104... 8420
8482
20824 8483
22686 8486

1 PAID IN FULL MAY 1961 12622
2 PAID IN FULL APR 1 8 1963
3 PAID IN FULL APR 2 8 1963
4 PAID IN FULL APR 2 8 1963
5 1st HALF PAID OCT 3 1 1963 20886 1336
2nd HALF PAID MAY 3 1 1963 17510
6 1st HALF PAID MAY 2 9 1963
2nd HALF PAID OCT 2 9 1963
7 1st HALF PAID MAY 2 9 1963
2nd HALF PAID OCT 2 9 1963
8 1st HALF PAID MAY 2 9 1963
2nd HALF PAID OCT 2 9 1963
9 1st HALF PAID MAY 2 9 1963
2nd HALF PAID OCT 2 9 1963
10 1st HALF PAID MAY 2 9 1963
2nd HALF PAID OCT 2 9 1963
11 1st HALF PAID MAY 2 9 1963
2nd HALF PAID OCT 2 9 1963
12 1st HALF PAID MAY 2 9 1963
2nd HALF PAID OCT 2 9 1963
13 1st HALF PAID MAY 2 9 1963
2nd HALF PAID OCT 2 9 1963
14 1st HALF PAID MAY 2 9 1963
2nd HALF PAID OCT 2 9 1963
15 1st HALF PAID MAY 2 9 1963
2nd HALF PAID OCT 2 9 1963

20798 8821

375 420 793 10 253 265 284
415 418 899 11 283
630 692 1322 17 428

478 17 = 445 478 11188 376 12042 8936 3108

