

TOWN OF PINE RIVER

Range 31 of Township 138 Range 30

Lands shaded belong to \_\_\_\_\_

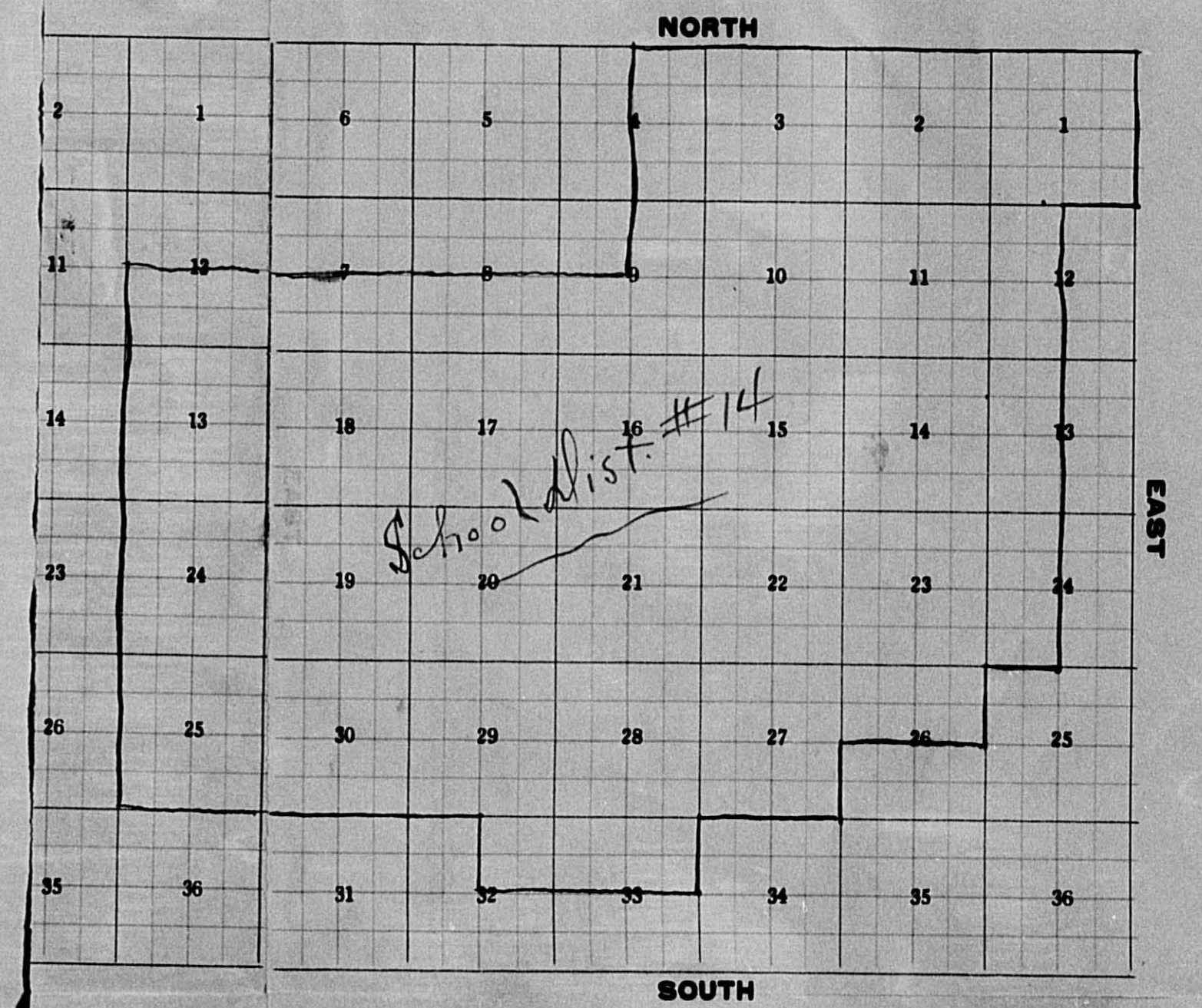

Railroads Mills\* Marshes Railroads

Auditor's Office, Cass County, Minnesota.

I, E. D. Bacon Auditor of Cass County, and  
State of Minnesota, do hereby certify that the following is a correct list of the Taxes levied on the Real and Personal  
Property in the Town of Pine River for the year 1915 (L. S.)

WITNESS my hand and official seal this 3 day of January 1916  
E. D. Bacon County Auditor.

Treasurer's Office, Cass County, State of Minnesota.

RECEIVED this, the first Monday (being the 3 day) of January, A. D. 1916, of E. D. Bacon  
Auditor of Cass County, Minnesota, the Tax List of all taxable Real and Personal Property in the Town  
of Pine River in said County of Cass for the year A. D. 1915, as specified above, and  
amounting to thirty seven hundred fifty four  $\frac{65}{100}$  Dollars.

W. J. McKeown  
Treasurer of Cass County.



State of Minnesota,

County of CASS CO.

OFFICE OF COUNTY TREASURER

Walker, Minn. Jan. 1 1917

To C. D. Bacon County Auditor:

SIR:—I herewith return to you the Tax List for the Towns of Pine River & Barclay said CASS CO. County, for the year 1915 heretofore received from you. I certify that I have compared the same with the duplicate receipts in your office, and have written opposite the amount of each tax so receipted the words "One-Half Paid" or "Paid in Full" as the case may be, and the number of my receipt given in discharge of said Tax, and each tract or lot of Real Property against which the Taxes remain unpaid is delinquent for said year.

Yours respectfully,

W. J. McKeown

County Treasurer.

Walker, Minn. Jan. 2 1917

Auditor's Office, Cass County, Minn.

RECEIVED OF

W. J. McKeown  
of Pine River & Barclay in said County of Cass

County Treasurer, the Tax List for the Towns  
for the year 1915.

C. D. Bacon

County Auditor.

E. O.



# Tax List of Real Property in the Town of Pine River

# Cass County, Minnesota, for Taxes of the Year 1915

IN WHOSE NAME ASSESSED	TO WHOM TRANSFERRED	Sold for Taxes	SUBDIVISION	Sec. or Lot	Town or Block	Rng.	No. of Acres		VALUATION	GENERAL TAXES			Ditch No.	SCHOOL DISTRICT		TOTAL TAXES	PAID	WHEN PAID	No. of Receipt	March Settlement	June Settlement	Penalty	November Settlement	Penalty	Collections to First Monday in January	Penalty	Delinquent on First Monday in January	REMARKS		
							Acres	100ths		State	Mills	State		District	District															
										School	County	School		No.	No.															
Footings Brought Forward,																														
James Westfall			NE 1/4 of NE 1/4	5	13829	40		872																						
"			NW 1/4 of NE 1/4			40																								
"			SW 1/4 of NE 1/4			40																								
"			SE 1/4 of NE 1/4			40																								
J. I. Edwards			NE 1/4 of NW 1/4			40		168																						
"			NW 1/4 of NW 1/4			40																								
"			SW 1/4 of NW 1/4			40		570																						
"			SE 1/4 of NW 1/4			40																								
Conservation Co.			NE 1/4 of SW 1/4			40		336																						
"			NW 1/4 of SW 1/4			40																								
Geo. W. Ruscoe			SW 1/4 of SW 1/4			40		168																						
Conservation Co.			SE 1/4 of SW 1/4			40		168																						
J. Goodman			NE 1/4 of SE 1/4			40																								
"			NW 1/4 of SE 1/4			40		504																						
"			SW 1/4 of SE 1/4			40																								
Jessie Munroe Westfall			SE 1/4 of SE 1/4			40		168																						
Footings Carried Forward,																														
							640		2954																					
																16143														







Tax List of Real Property in the Town of Pine River

Kimbull-Storer Co., Minneapolis, Minn.—78009

Cass County, Minnesota, for Taxes of the Year 1915

IN WHOSE NAME ASSESSED	TO WHOM TRANSFERRED	Sold for Taxes	SUBDIVISION	Sec. or Lot	Town or Block	Reg.	No. of Acres		VALUATION	GENERAL TAXES			Ditch No.	SCHOOL DISTRICT		TOTAL TAXES	PAID	WHEN PAID	No. of Receipt	March Settlement	June Settlement	Penalty	November Settlement	Penalty	Collections to First Monday in January	Penalty	Delinquent on First Monday in January	REMARKS									
							Acres	100ths		State	Mills	State		School	Ditch														District No.	District No.	Rate	Rate					
										Dollars	\$	cts.	\$	cts.	\$	cts.	\$	cts.	\$	cts.	\$	cts.	\$	cts.	\$	cts.	\$	cts.	\$	cts.							
Footings Brought Forward,																																					
James Westfall			NE 1/4 of NE 1/4				8	138	29	40	145																										
F. B. Dean			NW 1/4 of NE 1/4						40		145																										
E. Erickson			SW 1/4 of NE 1/4						40		140																										
Chas. Westfall			SE 1/4 of NE 1/4						40		140																										
J. C. Mayo			NE 1/4 of NW 1/4						40		150																										
Maudie Dyke			NW 1/4 of NW 1/4						40		300																										
"			SW 1/4 of NW 1/4						40																												
W. O. Hells			SE 1/4 of NW 1/4						40		145																										
L. M. Mann Land Co.			NE 1/4 of SW 1/4						40		168																										
Maudie Dyke			NW 1/4 of SW 1/4						40																												
"			SW 1/4 of SW 1/4						40		336																										
L. M. Mann Land Co.			SE 1/4 of SW 1/4						40		168																										
E. Erickson			NE 1/4 of SE 1/4						40		168																										
H. A. Peterson			NW 1/4 of SE 1/4						40		336																										
"			SW 1/4 of SE 1/4						40																												
"			SE 1/4 of SE 1/4						40																												
Footings Carried Forward,																																					
							606		2341																		12794										

James Westfall  
F. B. Dean  
E. Erickson  
Chas. Westfall

J. C. Mayo  
Maudie Dyke  
" "  
W. O. Hells

L. M. Mann Land Co.  
Maudie Dyke  
" "  
L. M. Mann Land Co.

E. Erickson  
H. A. Peterson  
" "  
" "  
" "

Garvey & Hill

2nd Half Paid OCT 2 1 1916 8277  
792 1st Half Paid MAY 31 1916 6155  
792 Paid in Full MAY 17 1916 3617  
766 Paid in Full MAY 31 1916 5826  
766 Paid in Full MAY 31 1916 5870

820 Paid in Full MAY 27 1916 4486  
1640 2nd Half Paid OCT 2 6 1916 8559  
1st Half Paid MAY 27 1916 4513  
792 ✓ 5710

2nd Half Paid OCT 3 1 1916 9419  
918 1st Half Paid MAY 29 1916 4598  
2nd Half Paid OCT 2 6 1916 8559  
1836 1st Half Paid MAY 27 1916 4513  
2nd Half Paid OCT 3 1 1916 9419  
918 1st Half Paid MAY 29 1916 4598

918 Paid in Full MAY 31 1916 5826  
1836 2nd Half Paid OCT 7 1916 7834  
1st Half Paid 5 31 16 6061

911 Paid subsequent to Cert. No. 3781

### Tax List of Real Property in the Town of Pine River

### Cass County, Minnesota, for Taxes of the Year 1915

IN WHOSE NAME ASSESSED	TO WHOM TRANSFERRED	Sold for Taxes	SUBDIVISION	Sec. or Lot	Town or Block	No. of Acres	VALUATION	GENERAL TAXES			Ditch No.	SCHOOL DISTRICT		TOTAL TAXES	PAID	WHEN PAID	No. of Receipt	March Settlement	June Settlement	Penalty	November Settlement	Penalty	Collections to First Monday in January	Penalty	Delinquent on First Monday in January	REMARKS				
								State	Mills	State		District No.	District No.														Rate	Rate		
							Dollars	\$	cts.	\$	cts.	\$	cts.	\$	cts.	Month	Day	Year	\$	cts.	\$	cts.	\$	cts.	\$	cts.	\$	cts.	\$	cts.
<i>Footings Brought Forward,</i>																														
<i>Sam J. Hygatt</i>	<i>Henry A. McMillan</i>		<i>NE 1/4 of NE 1/4 Lot</i>			<i>9 138 29 25 55</i>																								
<i>"</i>	<i>"</i>		<i>NW 1/4 of NE 1/4</i>			<i>40</i>																								
<i>"</i>	<i>"</i>		<i>SW 1/4 of NE 1/4</i>			<i>40</i>																								
<i>"</i>	<i>"</i>		<i>SE 1/4 of NE 1/4</i>		<i>2</i>	<i>39 40</i>																								
<i>Morrison Bros.</i>			<i>NE 1/4 of NW 1/4</i>			<i>40</i>																								
<i>"</i>			<i>NW 1/4 of NW 1/4</i>			<i>40</i>																								
<i>"</i>			<i>SW 1/4 of NW 1/4</i>			<i>40</i>																								
<i>"</i>			<i>SE 1/4 of NW 1/4</i>			<i>40</i>																								
<i>C. A. Smith</i>			<i>NE 1/4 of SW 1/4</i>			<i>40</i>																								
<i>Harriet E. Jennings</i>			<i>NW 1/4 of SW 1/4</i>			<i>40</i>																								
<i>"</i>			<i>SW 1/4 of SW 1/4</i>			<i>40</i>																								
<i>"</i>			<i>SE 1/4 of SW 1/4</i>			<i>40</i>																								
<i>Ed Donahue</i>	<i>Jay P. Brewer</i>		<i>NE 1/4 of SE 1/4</i>			<i>40</i>																								
<i>"</i>	<i>"</i>		<i>NW 1/4 of SE 1/4</i>			<i>40</i>																								
<i>"</i>	<i>"</i>		<i>SW 1/4 of SE 1/4</i>			<i>40</i>																								
<i>"</i>	<i>"</i>		<i>SE 1/4 of SE 1/4</i>			<i>40</i>																								
<i>Footings Carried Forward,</i>																														
						<i>624 95</i>	<i>2625</i>																							
													<i>14344</i>																	

Tax List of Real Property in the Town of Pine River

Cass County, Minnesota, for Taxes of the Year 1915

IN WHOSE NAME ASSESSED

TO WHOM TRANSFERRED

Sold for Taxes

SUBDIVISION

Sec. or Lot Town or Block

No. of Acres

Acres 100ths

VALUATION

Dollars \$ cts. \$ cts. \$ cts.

GENERAL TAXES

State Mills State School Bonds Ditch No.

SCHOOL DISTRICT

District No. District No. Rate Rate

TOTAL TAXES

PAID

WHEN PAID

No. of Receipt

March Settlement

June Settlement

Penalty

November Settlement

Penalty

Collections to First Monday in January

Penalty

Delinquent on First Monday in January

REMARKS

Footings Brought Forward,

First St. Park Pine River Chas. E. Glover

NE 1/4 of NE 1/4

16 138 29 40

Chas. John Johnson S. Frederick

NW 1/4 of NE 1/4

40

336

Thos. S. Avey

SW 1/4 of NE 1/4

40

168

SE 1/4 of NE 1/4

40

168

John Warner Grover Jr.

NE 1/4 of NW 1/4

40

185

Mary L. Johnson

NW 1/4 of NW 1/4

40

John Warner Grover Jr.

SW 1/4 of NW 1/4

40

361

SE 1/4 of NW 1/4

40

140

Chas. John Johnson S. Frederick

NE 1/4 of SW 1/4

40

140

Willard Rice

NW 1/4 of SW 1/4

40

SW 1/4 of SW 1/4

40

545

SE 1/4 of SW 1/4

Lot 1

37 45

Sylvester Proffit Chris A. Emerson

NE 1/4 of SE 1/4

40

168

Chas. John Johnson S. Frederick

NW 1/4 of SE 1/4

40

168

Wm. Rice

SW 1/4 of SE 1/4

32 75

328

SE 1/4 of SE 1/4

40

H. Bangston

Footings Carried Forward,

63220 2707

1836 Paid in Full APR 20 1916 2800  
2nd Half Paid OCT 31 1916  
918 1st Half Paid MAY 31 1916 9538  
918 2nd Half Paid OCT 31 1916 6494  
918 1st Half Paid MAY 31 1916 6494

1011 2nd Half Paid OCT 7 - 1916 7837  
1st Half Paid MAY 31 1916 3760

1973 Paid in Full MAR 9 1916 3126  
2nd Half Paid OCT 7 - 1916 7837  
765 1st Half Paid MAY 31 1916 3760

765 2nd Half Paid OCT 31 1916 9538  
1st Half Paid MAY 31 1916 6494

2979 2nd Half Paid OCT 3 - 1916 7772  
1st Half Paid MAY 31 1916 6496

918 Paid in Full OCT 31 1916 9242  
2nd Half Paid OCT 31 1916 9538  
918 1st Half Paid MAY 31 1916 6494  
1792 2nd Half Paid OCT 31 1916 9538  
1st Half Paid MAY 30 1916 6494

14793





Tax List of Real Property in the Town of Pine River

Statute Book Co., Minneapolis, Minn. - 70000

IN WHOSE NAME ASSESSED	TO WHOM TRANSFERRED	Sold for Taxes	SUBDIVISION	Sec. or Lot	Town or Block	Rng.	No. of Acres		VALUATION	GENERAL TAXES			Ditch No.				
							Acres	100ths		State	County	Local		State	School	Bonds	
									Dollars	\$	cts.	\$	cts.	\$	cts.		
Footings Brought Forward,																	
Tom Franklin Guinnett	Farmers State Bank (Pine River, Jay P. Brewer)		NE 1/4 of NE 1/4	19	138	29	40	185									
Benjamin Shiffer		NW 1/4 of NE 1/4				40	168										
Robert H. Shiffer		SW 1/4 of NE 1/4				40	168										
Robert W. Shiffer		SE 1/4 of NE 1/4				40	168										
John O. Thompson			NE 1/4 of NW 1/4			40	168										
Edward B. Harmon			NW 1/4 of NW 1/4			40	168										
"			SW 1/4 of NW 1/4			40	168										
Clarence Riley			SE 1/4 of NW 1/4			40	176										
Frank J. Beckford			NE 1/4 of SW 1/4			40	672										
"			NW 1/4 of SW 1/4			40											
"			SW 1/4 of SW 1/4			40											
"			SE 1/4 of SW 1/4			40											
Frank J. Hill			NE 1/4 of SE 1/4			40	672										
W. A. Spurrier			NW 1/4 of SE 1/4			40											
"			SW 1/4 of SE 1/4			40											
Frank J. Hill			SE 1/4 of SE 1/4			40											
Footings Carried Forward,									6.40	2713							

Cass County, Minnesota, for Taxes of the Year 1915

SCHOOL DISTRICT	TOTAL TAXES	PAID	WHEN PAID	No. of Receipt	March Settlement	June Settlement	Penalty	November Settlement	Penalty	Collections to First Monday in January	Penalty	Delinquent on First Monday in January	REMARKS				
														District No.	District No.	Rate	Rate
	\$	cts.	Month	Day	Year	\$	cts.	\$	cts.	\$	cts.	\$	cts.	\$	cts.	\$	cts.
	1011		DEC 1	1916	10194					1011	101						
	918		PAID in Full	OCT 31	'16	9588				918	92						
	918		PAID in Full	MAY 31	1916	9827				918							
	918		PAID in Full	OCT 31	'16	9589				918	92						
	918		PAID in Full	FEB 29	1916	1676				918							
	918		PAID in Full	DEC 20	1916	10476							1836	184			
	918		PAID in Full	DEC 20	1916	8213											
	96		1st Half Paid	MAY 31	1916	6731				482	482						
	3672		PAID in Full	DEC 20	1916	10333							1836	184			
						5123											
						5121											
	3672		PAID in Full	ACT 24	1916	8473											
			PAID in Full	MAY 31	1916	6161				918	918						
						with 8E											
						X 5322											
	14824																

1055 Paid subsequent to Cert. No. 2050.  
1055 Paid subsequent to Cert. No. 2051.

1836 1286















Tax List of Real Property in the Town of Pine River

Cass County, Minnesota, for Taxes of the Year 1915

IN WHOSE NAME ASSESSED	TO WHOM TRANSFERRED	Sold for Taxes	SUBDIVISION	Sec. or Lot	Town or Block	Rng.	No. of Acres		VALUATION	GENERAL TAXES			Ditch No.	SCHOOL DISTRICT		TOTAL TAXES	PAID	WHEN PAID	No. of Receipt	March Settlement	June Settlement	Penalty	November Settlement	Penalty	Collections to First Monday in January	Penalty	Delinquent on First Monday in January	REMARKS				
							Acres	100ths		State	County	Local		District No.	District No.														Rate	Rate	Rate	
									Dollars	\$	cts.	\$	cts.	\$	cts.	\$	cts.	Month	Day	Year	\$	cts.	\$	cts.	\$	cts.	\$	cts.	\$	cts.	\$	cts.
Footings Brought Forward,																																
Annie Anyon	H. C. Pohr		NE 1/4 of NE 1/4	3 acres of SW 1/4 NE 31	138	29	3	35																								
"	"		NW 1/4 of NE 1/4	1/2 " " "	150	140																										
"	"		SW 1/4 of NE 1/4	1/2 " " "	1150	84																										
"	"		SE 1/4 of NE 1/4																													
Erasmus Lewis			NE 1/4 of NW 1/4	5 acres of NW 1/4 NW 1/4	5	93																										
B. E. Wideman			NW 1/4 of NW 1/4																													
			SW 1/4 of NW 1/4	all West of Norway Brook Lot 3	19	87	210																									
			SE 1/4 of NW 1/4																													
			NE 1/4 of SW 1/4	1 acre of NW 1/4 SW 1/4	1	21																										
Herbert Kline			NW 1/4 of SW 1/4	3 acres of NE 1/4 SW 1/4	3	146																										
Winona Hill			SW 1/4 of SW 1/4	2 " " " "	12	42																										
Rena May Hill			SE 1/4 of SW 1/4	2 " " " "	2	322																										
John Jacob Hoffman	Lewis P. Solberg		NE 1/4 of SE 1/4	1 " " " "	1	105																										
Alfred B. Christenson			NW 1/4 of SE 1/4	3.60 " " Lot 6	360	112																										
Edwin Parker			SW 1/4 of SE 1/4	4 " " " 6	4	105																										
A. E. Snell			SE 1/4 of SE 1/4	6 " " " 6	6	See Snell's Ad. Pg. 70																										
Chas. A. Thorpe				1 " " " NW 1/4 SW 1/4	1	105																										
Footings Carried Forward,																																
							64	47	1520																							

2nd Half Paid OCT 31 1916 9633  
 1916 1st Half Paid MAY 31 1916 6386  
 765 Paid in full MAY 31 1916  
 458 Paid in full MAY 31 1916 } 6141

508 Part Paid MAY 31 1916 5406  
 1148 2nd Half Paid OCT 31 1916 10001  
 1st Half Paid MAY 15 1916 3498

114 Paid in Full FEB 21 1916 891  
 797 2nd Half Paid OCT 2 - 1916 7697  
 1st Half Paid MAY 25 1916 4340  
 229 2nd Half Paid OCT 30 1916 8763  
 1st Half Paid MAY 31 1916 6382  
 1759 2nd Half Paid OCT 31 1916 9550  
 1st Half Paid MAY 31 1916 6532

574 Paid in Full FEB 21 1916 891  
 612 2nd Half Paid OCT 17 1916 8032  
 1st Half Paid MAY 31 1916 3069

574 Paid in Full DEC 16 1916 10544  
 8303

514 Not Ass.

574 57







Tax List of Real Property in the Town of Pine River

Cass County, Minnesota, for Taxes of the Year 1915

Standard State Co., Minneapolis, Minn. - 70000

IN WHOSE NAME ASSESSED

TO WHOM TRANSFERRED

Sold for Taxes

SUBDIVISION

Sec. or Lot Town or Block Rng.

No. of Acres

Acres

100ths

100ths

100ths

100ths

100ths

100ths

100ths

100ths

100ths

100ths

100ths

100ths

100ths

100ths

100ths

100ths

100ths

100ths

100ths

100ths

100ths

100ths

100ths

100ths

100ths

100ths

100ths

100ths

100ths

100ths

100ths

100ths

100ths

100ths

100ths

100ths

100ths

100ths

100ths

100ths

100ths

100ths

100ths

100ths

100ths

100ths

100ths

100ths

100ths

100ths

100ths

100ths

100ths

100ths

100ths

100ths

100ths

100ths

100ths

100ths

100ths

100ths

100ths

100ths

100ths

100ths

100ths

100ths

100ths

100ths

100ths

100ths

100ths

100ths

100ths

100ths

100ths

100ths

100ths

100ths

100ths

100ths

100ths

100ths

100ths

100ths

100ths

100ths

100ths

100ths

100ths

100ths

100ths

100ths

100ths

100ths

100ths

100ths

100ths

100ths

100ths

100ths

100ths

100ths

100ths

100ths

100ths

100ths

100ths

100ths

100ths

100ths

100ths

100ths

100ths

100ths

100ths

100ths

100ths

100ths

100ths

100ths

100ths

100ths

100ths

100ths

100ths

100ths

100ths

100ths

100ths

100ths

100ths

100ths

100ths

100ths

100ths

100ths

100ths

100ths

100ths

100ths

100ths

100ths

100ths

100ths

100ths

100ths

100ths

100ths

100ths

100ths

100ths

100ths

100ths

100ths

100ths

100ths

100ths

100ths

100ths

100ths

100ths

100ths

100ths

100ths

100ths

100ths

100ths

100ths

100ths

100ths

100ths

100ths

100ths

100ths

100ths

100ths

100ths

100ths

100ths

100ths

100ths

100ths

100ths

100ths

100ths

100ths

100ths

100ths

100ths

100ths

100ths

100ths

100ths

100ths

100ths

100ths

100ths

100ths

100ths

100ths

100ths

100ths

100ths

100ths

100ths

100ths

100ths

100ths

100ths

100ths

100ths

100ths

100ths

100ths

100ths

100ths

100ths

100ths

100ths

100ths

100ths

100ths

100ths

100ths

100ths

100ths

100ths

100ths

100ths

100ths

100ths

100ths

100ths

100ths

100ths

100ths

100ths

100ths

100ths

100ths

100ths

100ths

100ths

100ths

100ths

100ths

100ths

100ths

100ths

100ths

100ths

100ths

100ths

100ths

100ths

100ths

100ths

100ths

100ths

100ths

100ths

100ths

100ths

100ths

100ths

100ths

100ths

100ths

100ths

100ths

100ths

100ths

100ths

100ths

100ths

Tax List of Real Property in the Town of Pine River

Cass County, Minnesota, for Taxes of the Year 1915

Kimball-Deer Co., Minneapolis, Minn. - 79055

IN WHOSE NAME ASSESSED

TO WHOM TRANSFERRED

Sold for Taxes

SUBDIVISION

Sec. or Lot  
Town or Block  
Rng.

No. of Acres

Acres 100ths

VALUATION

GENERAL TAXES

State Mills  
State Sch'l  
County  
Town  
Local Sch'l  
Total

State School Bonds

Ditch No.

SCHOOL DISTRICT

District No. 14  
District No.

TOTAL TAXES

PAID

WHEN PAID

No. of Receipt

March Settlement

June Settlement

Penalty

November Settlement

Penalty

Collections to First Monday in January

Penalty

Delinquent on First Monday in January

REMARKS

Footings Brought Forward,

H. G. + Giles H. Anderson

NE 1/4 of NE 1/4

Lot 1

1 138 30 40 02

672

NW 1/4 of NE 1/4

" 2

40 06

SW 1/4 of NE 1/4

40

SE 1/4 of NE 1/4

40

J. H. Kimball

NE 1/4 of NW 1/4

" 3

40 16

168

NW 1/4 of NW 1/4

" 4

40 14

407

SW 1/4 of NW 1/4

" 5

57 50

SE 1/4 of NW 1/4

40

168

H. G. + Giles H. Anderson

NE 1/4 of SW 1/4

" 7

42 50

183

NW 1/4 of SW 1/4

SW 1/4 of SW 1/4

" 9

28 45

120

SE 1/4 of SW 1/4

" 8

40

168

St. Paul + Chicago

D. L. Bowman

NE 1/4 of SE 1/4

40

NW 1/4 of SE 1/4

40

672

SW 1/4 of SE 1/4

40

SE 1/4 of SE 1/4

40

Footings Carried Forward,

609 83 2558

2nd Half Paid OCT 31 1916 9259  
3672 1st Half Paid MAY 31 1916 6602

1836

1836

2nd Half Paid OCT 31 1916 9259  
918 1st Half Paid MAY 31 1916 6602  
2224 1st Half Paid OCT 20 1916 8184  
451 1st Half Paid MAY 31 1916 5470

459

459

1112

1112

2nd Half Paid OCT 31 1916 9259  
918 1st Half Paid MAY 31 1916 6602

459

459

1000 Paid in Full MAY 25 1916 4248

1000

656 Paid in Full MAR 14 1916 2190

656

918 Paid in Full MAY 25 1916 4248

918

2nd Half Paid OCT 30 1916 8903  
3672 1st Half Paid MAY 31 1916 4969

1836

1836

13978

Tax List of Real Property in the Town of Pine River

Kimball Street Co., Minneapolis, Minn. - 50055

Cass County, Minnesota, for Taxes of the Year 1915

IN WHOSE NAME ASSESSED

TO WHOM TRANSFERRED

Sold for Taxes

SUBDIVISION

Sec. or Lot, Town or Block, Rng.

No. of Acres

Acres 100ths

VALUATION

GENERAL TAXES

Mills

State, State Sch., County, Town, Local Sch., Total

State

School

Bonds

Ditch No.

SCHOOL DISTRICT

District No.

Rate

Mills

District No.

Rate

Mills

TOTAL TAXES

PAID

WHEN PAID

No. of Receipt

March Settlement

June Settlement

Penalty

November Settlement

Penalty

Collections to First Monday in January

Penalty

Delinquent on First Monday in January

REMARKS

Footings Brought Forward,

Othello A. Kenworthy  
Frank Reynolds

NE 1/4 of NE 1/4

2 138 30 40

168

NW 1/4 of NE 1/4

40

168

SW 1/4 of NE 1/4

40

168

SE 1/4 of NE 1/4

40

168

Othello A. Kenworthy

NE 1/4 of NW 1/4

40

672

NW 1/4 of NW 1/4

40

SW 1/4 of NW 1/4

40

SE 1/4 of NW 1/4

40

J. P. Woolsey + J. P. Green

J. E. Geary

NE 1/4 of SW 1/4

40

672

NW 1/4 of SW 1/4

40

SW 1/4 of SW 1/4

40

SE 1/4 of SW 1/4

40

James Johnson

NE 1/4 of SE 1/4

40

672

NW 1/4 of SE 1/4

40

SW 1/4 of SE 1/4

40

SE 1/4 of SE 1/4

40

Footings Carried Forward,

640

2688

918 x 5089  
2nd Half Paid OCT 31 1916  
918 1st Half Paid MAY 26 1916 19357  
2nd Half Paid OCT 31 1916  
918 1st Half Paid MAY 26 1916 4367  
918 x 5089

3672 Paid in Full MAY 17 1916 3639

3672 ✓ 5126  
✓ 5127  
✓ 5128  
✓ 5129

3672 Paid in Full JAN 10 1916 3672

14688

918

918

1055 Paid subsequent to Cert. No. 2065

1055 Paid subsequent to Cert. No. 2066

1055 Paid subsequent to Cert. No. 2067

1055 Paid subsequent to Cert. No. 2068



Tax List of Real Property in the Town of Pine River

Cass County, Minnesota, for Taxes of the Year 1915

Kimball-Store Co., Minneapolis, Minn.—70055

IN WHOSE NAME ASSESSED

TO WHOM TRANSFERRED

Sold for Taxes

SUBDIVISION

Sec. or Lot, Town or Block, Rng.

No. of Acres, Acres 100ths

VALUATION

GENERAL TAXES: State, County, Town, Local, Total

Mills, S.P.H. 280, P.P.N. 81

SCHOOL DISTRICT

District No., District No., Rate, Rate

TOTAL TAXES

PAID

WHEN PAID

No. of Receipt

March Settlement

June Settlement

Penalty

November Settlement

Penalty

Collections to First Monday in January

Penalty

Delinquent on First Monday in January

REMARKS

Footings Brought Forward,

Gustave R. Schuman

NE 1/4 of NE 1/4

4 138 30 4089

336 1836 155 74

14

2294 1st Half Paid MAY 31 1916 9104

Daisy A. Stokes

NW 1/4 of NE 1/4

39 57

155 74

14

1147

1147

M. J. Rugg

SW 1/4 of NE 1/4

32 80

155 74

14

1928 Paid in Full MAY 25 1916 4314

1928

SE 1/4 of NE 1/4

40

155 74

14

NE 1/4 of NW 1/4

Lot 3

44 43

136 87

1

NW 1/4 of NW 1/4

Lot 4

36 90

136 87

1

2582 24729

2582

SW 1/4 of NW 1/4

Lot 5

39 50

136 87

1

SE 1/4 of NW 1/4

Lot 6

12 60

136 87

1

Florence H. Foulk

NE 1/4 of SW 1/4

40

136 87

1

7/2 S.W. 1/4 paid OCT 9 - 1916 7854

1712

Ethel Elder

NW 1/4 of SW 1/4

40

136 87

1

4564 1st Half Paid MAY 1 1916 2832

1711

Hensy S. McBride, Jay P. Brewer & John J. Allen

NE 1/4 of SE 1/4

40

168 918 116 74

14

2nd Half Paid OCT 30 1916 8979

1108 1st Half Paid MAY 31 1916 6342

554

554

John H. Miller

NW 1/4 of SE 1/4

40

336 1836 116 74

14

2216 2nd Half Paid OCT 9 - 1916 7854

1108

1108

SE 1/4 of SE 1/4

40

168 918 116 74

14

1108 2nd Half Paid AUG 1 1916 7446

1108 1st Half Paid MAY 10 1916 3307

334

554

Footings Carried Forward,

60669 2270 12404 2172 1224

15800

Tax List of Real Property in the Town of Pine River

Cass County, Minnesota, for Taxes of the Year 1915

Standard-Steel Co., Minneapolis, Minn.—1908

IN WHOSE NAME ASSESSED

TO WHOM TRANSFERRED

Sold for Taxes

SUBDIVISION

Sec. or Lot Town or Block Reg.

No. of Acres

Acres 100ths

VALUATION

GENERAL TAXES

State School County Town Local Total

Mills

S.R.H. 8.10 S.R.H. 8.1

Block No.

8.1

SCHOOL DISTRICT

District No. Rate District No. Rate

TOTAL TAXES

PAID

WHEN PAID

No. of Receipt

March Settlement

June Settlement

Penalty

November Settlement

Penalty

Collections to First Monday in January

Penalty

Delinquent on First Monday in January

REMARKS

Footings Brought Forward,

Em. Land Co.  
Florence W. Souk  
Thos. H. Francis  
Florence W. Souk  
Frank E. Souk  
Carl E. Brown  
M. Cosgrove  
J. D. Barnes  
Carl E. Brown

NE 1/4 of NE 1/4

Lot 4

5 138 30 39 30

165

902

70

71

NW 1/4 of NE 1/4

40

179

978

70

112

SW 1/4 of NE 1/4

6.66 x 46.7 x 66 ft.

39

168

918

70

112

SE 1/4 of NE 1/4

40

168

918

70

112

46.7 ft. x 66 ft. Lot 6

1

168

918

70

112

NE 1/4 of NW 1/4

Lot 5

39 75

168

918

70

112

NW 1/4 of NW 1/4

40

168

918

149

SW 1/4 of NW 1/4

40

168

918

149

SE 1/4 of NW 1/4

40

168

918

149

NE 1/4 of SW 1/4

40

168

918

112

NW 1/4 of SW 1/4

40

504

2754

149

SW 1/4 of SW 1/4

40

168

918

112

SE 1/4 of SW 1/4

40

168

918

112

J. D. Barnes  
"  
"

Florence W. Souk  
J. A. Shoom  
J. D. Barnes  
"

Florence W. Souk

NE 1/4 of SE 1/4

40

168

918

70

112

NW 1/4 of SE 1/4

40

168

918

70

112

SW 1/4 of SE 1/4

40

336

1836

112

SE 1/4 of SE 1/4

40

168

918

112

Footings Carried Forward,

6 39 03 2 696 14 732 499 1902

17124

1046 2nd Half Paid OCT 10 1916 7888  
1st Half Paid MAY 10 1916 3263  
1160 2nd Half Paid OCT 9 1916 7854  
1st Half Paid APR 22 1916 4834  
1100 2nd Half Paid OCT 18 1916 8067  
1st Half Paid MAY 10 1916 3254  
1100 2nd Half Paid OCT 9 1916 7854  
1st Half Paid APR 22 1916 4832  
1100 2nd Half Paid OCT 31 1916 9379  
1st Half Paid MAY 31 1916 5716  
1067 Paid in Full APR 1 1916 4409  
1067 Paid in Full MAY 17 1916 3628  
1067 2nd Half Paid OCT 31 1916 9379  
1st Half Paid MAY 31 1916 5716  
1030 Paid in Full MAY 12 1916 3337  
3127 Paid in Full MAY 17 1916 3628  
1100 2nd Half Paid OCT 9 1916 7854  
1st Half Paid APR 22 1916 4834  
1100 2nd Half Paid OCT 9 1916 7854  
1st Half Paid APR 22 1916 4832  
2060 Paid in Full MAY 17 1916 3628

523 523 ✓  
580 580 ✓  
550 550 ✓  
530 550 ✓  
550 550 ✓  
1067 1067  
1067 1067  
534 533 ✓  
1030 1030  
3127 3127  
1100 1100 ✓  
2060 2060







Tax List of Real Property in the Town of Pine River

Cass County, Minnesota, for Taxes of the Year 1916

IN WHOSE NAME ASSESSED	TO WHOM TRANSFERRED	Sold for Taxes	SUBDIVISION	Sec. or Lot	Town or Block	Reg.	No. of Acres	GENERAL TAXES					SCHOOL DISTRICT		TOTAL TAXES	PAID	WHEN PAID	No. of Receipt	March Settlement	June Settlement	Penalty	November Settlement	Penalty	Collections to First Monday in January	Penalty	Delinquent on First Monday in January	REMARKS	
								State	County	Local	Total	Mills	No.	No.														Rate
Footings Brought Forward,																												
Ray Eveland			NE 1/4 of NE 1/4	8	128	30	40	672	3672	163	74	1		4620	Paid in Full	MAY 27 1916	4533		4620									
"			NW 1/4 of NE 1/4				40			163	74																	
"			SW 1/4 of NE 1/4				40			163	74																	
"			SE 1/4 of NE 1/4				40			163	74																	
Christ Arbogast			NE 1/4 of NW 1/4				40	168	918	163	74	1		1153	2nd Half Paid	OCT 31 1916	9004											
L. Troutman			NW 1/4 of NW 1/4				40	336	1836	163	74	1		1153	1st Half Paid	APR 20 1916	2786		577		577							
"			SW 1/4 of NW 1/4				40			163	74	1		2310	Paid in Full	JAN 18 1916	139	2310										
Christ Arbogast			SE 1/4 of NW 1/4				40	238	1300	163	74	1		1537	2nd Half Paid	OCT 31 1916	9004											
"							40			163	74																	
<del>Grace Dick</del>	C. H. Kelley		NE 1/4 of SW 1/4				40	168	918	163	74	14		1153	2nd Half Paid	OCT 31 1916	9004											
John & Randall			NW 1/4 of SW 1/4				40	168	918	163	74	"		1153	1st Half Paid	APR 20 1916	2786		578		577							
Christ Arbogast			SW 1/4 of SW 1/4				40	168	918	163	74	"		1153	Paid in Full	MAR 9 1916	2122		1153									
"			SE 1/4 of SW 1/4				40	168	918	163	74	"		1153	Paid in Full	MAY 26 1916	4357		1153									
John Kane	R. Louisa French		NE 1/4 of SE 1/4				40	151	825	163	74	"		1062	1st Half Paid	OCT 31 1916	10003											
Christ Arbogast			NW 1/4 of SE 1/4				40	168	918	163	74	"		1153	2nd Half Paid	APR 20 1916	9004											
Axel Berge	K. H. Trustem		SW 1/4 of SE 1/4				40	336	1836	163	74	"		1153	1st Half Paid	APR 20 1916	2786		578		577							
"			SE 1/4 of SE 1/4				40			163	74	"		2310	Paid in Full	OCT 12 1916	7926											
Footings Carried Forward,																												
				640			2741	14977	3608	1184			18769															

Tax List of Real Property in the Town of Pine River

Cass County, Minnesota, for Taxes of the Year 1915

St. Paul, Minn. - 1908

IN WHOSE NAME ASSESSED	TO WHOM TRANSFERRED	Sold for Taxes	SUBDIVISION	Sec. or Lot	Town or Block	Rag.	No. of Acres	GENERAL TAXES					S. P. H. Dist. No.	SCHOOL DISTRICT		TOTAL TAXES	PAID	WHEN PAID	No. of Receipt	March Settlement	June Settlement	Penalty	November Settlement	Penalty	Collections to First Monday in January	Penalty	Delinquent on First Monday in January	REMARKS				
								VALUATION	State	Mills	County	Local		State	School														Bonds	District No.	District No.	
								Dollars	\$	cts.	\$	cts.	\$	cts.	\$	cts.	Month	Day	Year	\$	cts.	\$	cts.	\$	cts.	\$	cts.	\$	cts.	\$	cts.	
Footings Brought Forward,																																
Webber & Hill			NE 1/4 of NE 1/4				9 1/8	30	40		336	1836	291	14																		
"			NW 1/4 of NE 1/4				40						291	14																		
			SW 1/4 of NE 1/4										291	14																		
Edward Beddoe			SE 1/4 of NE 1/4				40	168			918		291	14																		
"			NE 1/4 of NW 1/4	Lot 1			32	20			87	475	281	1																		
Florence H. Touk			NW 1/4 of NW 1/4	" 4			16	75			70	383	146	1																		
Edward Beddoe			SW 1/4 of NW 1/4	" 2			39				164	896	340	1																		
"			SE 1/4 of NW 1/4	" 3			27	60			113	617	240	1																		
J. E. & Ella Sundermeyer			NE 1/4 of SW 1/4				40				392	2142	349	14																		
"			NW 1/4 of SW 1/4				40						349																			
Asel Berge	K. H. Trustem		SW 1/4 of SW 1/4				40	168			918		349	14																		
J. E. & Ella Sundermeyer			SE 1/4 of SW 1/4				40	168			918		349	14																		
Edward Beddoe			NE 1/4 of SE 1/4				40	168			918		349	14																		
J. E. & Ella Sundermeyer			NW 1/4 of SE 1/4				40	168			918		349	14																		
Lloyd S. Peabody			SW 1/4 of SE 1/4				40				536	1836	349	14																		
"			SE 1/4 of SE 1/4				40						349	14																		
Footings Carried Forward,								55555	2938		12775		4963																			

17738

3266 Paid subsequent to Cert. No. 3792

1457 Paid subsequent to Cert. No. 3793

1457 Paid subsequent to Cert. No. 3794

2534

2418 Paid Apr 5 1917 6385

291 2nd Half Paid OCT 27 1916 4720  
1st Half Paid MAY 31 1916 4849

756 2nd Half Paid OCT 27 1916 8720  
1st Half Paid MAY 31 1916 4849

529 2nd Half Paid OCT 27 1916 4849  
1st Half Paid APR 22 1916 4849

1236 2nd Half Paid OCT 27 1916 4849  
1st Half Paid MAY 31 1916 4849

857 2nd Half Paid OCT 27 1916 4849  
1st Half Paid MAY 31 1916 4849

2840 ✓ 5715

1267 Paid in Full OCT 1 2 1916 7926

1267 ✓ 5716

1267 2nd Half Paid OCT 27 1916 4849  
1st Half Paid MAY 31 1916 4849

1267 ✓ 5717

2534 Paid Apr 6 1917 6387

605

604

378

378

265

264

1046

1047

1267 127

634

634

2418

2534

Tax List of Real Property in the Town of Pine River

Marshall County, Minnesota, 1916

IN WHOSE NAME ASSESSED

TO WHOM TRANSFERRED

Sold for Taxes

SUBDIVISION

Sec. or Lot

Town or Block

Reg.

No. of Acres

Acres 100ths

VALUATION

GENERAL TAXES

Mills

State

County

Local

Total

Dollars

State

School

Bonds

No.

Rate

etc.

S. R. H.

Dist.

No.

Rate

etc.

etc.

etc.

SCHOOL DISTRICT

District

No.

Rate

Mills

District

No.

Rate

Mills

TOTAL TAXES

PAID

WHEN PAID

No. of Receipt

March Settlement

June Settlement

Penalty

November Settlement

Penalty

Collections to First Monday in January

Penalty

Delinquent on First Monday in January

REMARKS

Footings Brought Forward,

C. B. Tinszas  
H. D. Tolvenger  
Adolph M. Jerome  
C. B. Tinszas

NE 1/4 of NE 1/4  
NW 1/4 of NE 1/4  
SW 1/4 of NE 1/4  
SE 1/4 of NE 1/4

30 10 138 30 40  
40  
40  
40

238 1300  
168 918  
168 918  
168 918

H. D. Tolvenger  
" "  
H. J. Blakely  
Ralph M. Jerome

NE 1/4 of NW 1/4  
NW 1/4 of NW 1/4  
SW 1/4 of NW 1/4  
SE 1/4 of NW 1/4

40  
40  
40  
40

336 1836  
168 918  
168 918

233  
233  
233  
233

H. J. Blakely  
" "  
Ralph M. Jerome

NE 1/4 of SW 1/4  
NW 1/4 of SW 1/4  
SW 1/4 of SW 1/4  
SE 1/4 of SW 1/4

40  
40  
40  
40

168 918  
336 1836  
168 918

233  
233  
233  
233

H. J. Blakely  
A. B. Allen

NE 1/4 of SE 1/4  
NW 1/4 of SE 1/4 Lot 2  
SW 1/4 of SE 1/4

40  
54 40

168 918  
185 1011

233  
233

Hugh Traeger

SE 1/4 of SE 1/4 " 1

59 25

248 1355

254

Footings Carried Forward,

633 65 2687 14682

2589

Cass County, Minnesota, for Taxes of the Year 1915

2nd Half Paid OCT 31 1916 9823  
1300 1st Half Paid MAY 31 1916 6276  
918 1st Half Paid MAY 29 1916 4643  
918 Paid in Full MAY 22 1916 3919  
2nd Half Paid OCT 31 1916 9823  
918 1st Half Paid MAY 31 1916 6276

2302 1st Half Paid MAY 29 1916 4643

2nd Half Paid OCT 31 1916 4620  
1151 1st Half Paid MAY 31 1916 5094  
1151 Paid in Full MAY 22 1916 3919

1151 Paid in Full MAY 22 1916 3919  
2nd Half Paid OCT 31 1916 4620  
2302 1st Half Paid MAY 31 1916 5094  
1151 Paid in Full MAY 22 1916 3919

2nd Half Paid OCT 31 1916 4620  
1151 1st Half Paid MAY 31 1916 5094  
1244 Paid in Full OCT 27 1916 8711

1614 Paid in Full OCT 9 - 1916 7857

17271

650 650  
459 459  
918  
459 459  
1151  
576 576  
1151  
1151  
1151  
576 576  
1244 124  
1614 161

Tax List of Real Property in the Town of Pine River

Shelby County, Minnesota, 1915

IN WHOSE NAME ASSESSED

TO WHOM TRANSFERRED

Sold for Taxes

SUBDIVISION

Sec. or Lot  
Town or Block  
Rng.

No. of Acres

Acres 100ths

VALUATION

Dollars

GENERAL TAXES

Mills

State

County

Town

Local Sch.

Total

State

School

Bonds

Ditch

No.

cts.

Footings Brought Forward,

NE 1/4 of NE 1/4

NW 1/4 of NE 1/4

SW 1/4 of NE 1/4

SE 1/4 of NE 1/4

NE 1/4 of NW 1/4

NW 1/4 of NW 1/4

SW 1/4 of NW 1/4

SE 1/4 of NW 1/4

NE 1/4 of SW 1/4

NW 1/4 of SW 1/4

SW 1/4 of SW 1/4

SE 1/4 of SW 1/4

NE 1/4 of SE 1/4

NW 1/4 of SE 1/4

SW 1/4 of SE 1/4

SE 1/4 of SE 1/4

Footings Carried Forward,

M. B. Darby  
H. P. Ry Co.

A. A. McManes

M. B. Darby

Susan + Alexander Tollefson

Mrs. S. S. Goodrich

Allen S. Goodrich

H. P. Ry Co. Rev. L. Johnson

11 138 30 40  
40  
40  
40

191  
336  
168

160

672

40  
40  
40  
40

672

40  
40  
40  
40

672

640

2711

Cass County, Minnesota, for Taxes of the Year 1915

SCHOOL DISTRICT

District No.

Rate

Mills

District No.

Rate

Mills

TOTAL TAXES

PAID

WHEN PAID

No. of Receipt

March Settlement

June Settlement

Penalty

November Settlement

Penalty

Collections to First Monday in January

Penalty

Delinquent on First Monday in January

REMARKS

\$ cts.

\$ cts.

\$ cts.

Month Day Year

\$ cts.

\$ cts.

\$ cts.

\$ cts.

\$ cts.

\$ cts.

\$ cts.

\$ cts.

1043 Paid in Full FEB 7 - 1916 430

1836 Paid in Full JUN 19 1916 6947

918 Paid in Full FEB 7 - 1916 430

3672 2nd Half Paid OCT 31 1916 9609  
1st Half Paid MAY 25 1916 4266

3672 1/2 Sw - Pa. APR 19 1916 2772

3672 Paid in Full MAR 11 1916 2159

1043

918

1836

3672

1836 184

1836

1836

1836 2<sup>nd</sup> sw

14813

Tax List of Real Property in the Town of Pine River

Cass County, Minnesota, for Taxes of the Year 1915

IN WHOSE NAME ASSESSED	TO WHOM TRANSFERRED	Sold for Taxes	SUBDIVISION	Sec. or Lot	Town or Block	Rng.	No. of Acres		VALUATION	GENERAL TAXES			Ditch No.	SCHOOL DISTRICT		TOTAL TAXES	PAID	WHEN PAID	No. of Receipt	March Settlement	June Settlement	Penalty	November Settlement	Penalty	Collections to First Monday in January	Penalty	Delinquent on First Monday in January	REMARKS							
							Acres	100ths		State	Mills	State		School	Ditch														No.	Rate	No.	Rate			
									Dollars	\$	cts.	\$	cts.	\$	cts.	\$	cts.	Month	Day	Year	\$	cts.	\$	cts.	\$	cts.	\$	cts.	\$	cts.	\$	cts.			
Footings Brought Forward,																																			
H. S. Gilbert			NE 1/4 of NE 1/4																																
"			NW 1/4 of NE 1/4				12	138	30																										
"			SW 1/4 of NE 1/4						160																										
"			SE 1/4 of NE 1/4							714																									
David L. Bowman			NE 1/4 of NW 1/4																																
"			NW 1/4 of NW 1/4						40																										
"			SW 1/4 of NW 1/4						40																										
"			SE 1/4 of NW 1/4						40																										
H. S. Gilbert			NE 1/4 of SW 1/4																																
"			NW 1/4 of SW 1/4																																
"			SW 1/4 of SW 1/4						160																										
"			SE 1/4 of SW 1/4							601																									
J. Kline			NE 1/4 of SE 1/4																																
"			NW 1/4 of SE 1/4						40																										
"			SW 1/4 of SE 1/4						40																										
"			SE 1/4 of SE 1/4						40																										
Footings Carried Forward,																																			
									640																										
									2859												15623														

2nd Half Paid OCT 31 1916 9222  
1st Half Paid MAY 31 1916 6930

X 5093  
3672 X 5094  
X 5095  
X 5096

3287 2nd Half Paid OCT 31 1916 9222  
3744 1st Half Paid MAY 31 1916 6930

4306 Paid in Full MAY 23 1916 4092

Abatement No. 44571

Tax List of Real Property in the Town of Pine River

Kimball-Stover Co., Minnesota, Minn.—1916

IN WHOSE NAME ASSESSED	TO WHOM TRANSFERRED	Sold for Taxes	SUBDIVISION	Sec. or Lot	Town or Block	No. of Acres	VALUATION	GENERAL TAXES			Ditch No.										
								State	Mills	State											
								State Sch'l	School	Bonds											
								County			Dollars	\$	cts.	\$	cts.	\$	cts.				
								Local Sch'l													
								Total													
Footings Brought Forward,																					
J. H. Kimball			NE 1/4 of NE 1/4	13	138	30	40														
"			NW 1/4 of NE 1/4			40	672														
"			SW 1/4 of NE 1/4			40															
"			SE 1/4 of NE 1/4			40															
						40															
Mahlum Lbr. Co.			NE 1/4 of NW 1/4			40	672														
"			NW 1/4 of NW 1/4			40															
"			SW 1/4 of NW 1/4			40															
"			SE 1/4 of NW 1/4			40															
J. H. Kimball			NE 1/4 of SW 1/4			40	168														
H. S. Gilbert			NW 1/4 of SW 1/4			40	168														
J. H. Kimball			SW 1/4 of SW 1/4			40	336														
"			SE 1/4 of SW 1/4			40															
"			NE 1/4 of SE 1/4			40	672														
"			NW 1/4 of SE 1/4			40															
"			SW 1/4 of SE 1/4			40															
"			SE 1/4 of SE 1/4			40															
Footings Carried Forward,												640	2688								

Cass County, Minnesota, for Taxes of the Year 1916

SCHOOL DISTRICT		TOTAL TAXES	PAID	WHEN PAID	No. of Receipt	March Settlement	June Settlement	Penalty	November Settlement	Penalty	Collections to First Monday in January	Penalty	Delinquent on First Monday in January	REMARKS		
District No.	District Rate															
		\$	cts.	Month	Day	Year	\$	cts.	\$	cts.	\$	cts.	\$	cts.	\$	cts.
1		36	72													
2nd Half Paid OCT 20 1916																
1st Half Paid MAY 31 1916																
14		36	72													
2nd Half Paid OCT 20 1916																
1st Half Paid MAY 31 1916																
14		9	18													
2nd Half Paid OCT 20 1916																
1st Half Paid MAY 31 1916																
14		18	36													
2nd Half Paid OCT 20 1916																
1st Half Paid MAY 31 1916																
1		36	72													
2nd Half Paid OCT 20 1916																
1st Half Paid MAY 31 1916																
		146	88													

8184  
5470

7344

7344 ✓



Tax List of Real Property in the Town of Pine River

Cass County, Minnesota, for Taxes of the Year 1915

IN WHOSE NAME ASSESSED	TO WHOM TRANSFERRED	Sold for Taxes	SUBDIVISION	Sec. or Lot	Town or Block	Rag.	No. of Acres		GENERAL TAXES			State School Bonds	S. P. H. Dist. No.	SCHOOL DISTRICT		TOTAL TAXES	PAID	WHEN PAID	No. of Receipt	March Settlement	June Settlement	Penalty	November Settlement	Penalty	Collections to First Monday in January	Penalty	Delinquent on First Monday in January	REMARKS				
							Acres	100ths	State	Mills	District No.			District No.	Rate														Rate			
									Dollars	\$	cts.	\$	cts.	\$	cts.	\$	cts.	Month	Day	Year	\$	cts.	\$	cts.	\$	cts.	\$	cts.	\$	cts.	\$	cts.
Footings Brought Forward,																																
J. H. Sleeper			NE 1/4 of NE 1/4	Lot 1	15	138	30	30	33	127	693		132																			
			NW 1/4 of NE 1/4																													
			SW 1/4 of NE 1/4																													
J. H. Sleeper			SE 1/4 of NE 1/4	"	2		39	50		166	907		175																			
Meyerhauser et al.			NE 1/4 of NW 1/4	"	5		33	75		141	770		197																			
R. S. Laward			NW 1/4 of NW 1/4				40			168	918		233																			
Wm J. J. Lott			SW 1/4 of NW 1/4				40			332	1814		233																			
"			SE 1/4 of NW 1/4	"	4		39	70					233																			
John Hanson	E. W. Miller		NE 1/4 of SW 1/4				40						291																			
"	"		NW 1/4 of SW 1/4				40			605	3306		291																			
"	"		SW 1/4 of SW 1/4	"	6		24	15					175																			
"	"		SE 1/4 of SW 1/4				40						291																			
J. H. Sleeper	E. W. Miller		NE 1/4 of SE 1/4				40			168	918		233																			
John Hanson	"		NW 1/4 of SE 1/4	"	3		50	75		383	2093		233																			
"	"		SW 1/4 of SE 1/4				40						233																			
E. M. Downes	"		SE 1/4 of SE 1/4				40			168	918		233																			
Footings Carried Forward,																																
							538	18		2258	12337		3183																			

2nd Half Paid OCT 31 1916  
 825 1st Half Paid MAY 31 1916 }  
 9443 }  
 5906 }  
 2nd Half Paid OCT 31 1916  
 1082 1st Half Paid MAY 31 1916 }  
 967 483 }  
 10421 }  
 6350 }  
 483 }  
 1151 Paid in Full MAY 31 1916 6179 }  
 2nd Half Paid OCT 30 1916 8962 }  
 2280 1st Half Paid MAY 31 1916 6743 }  
 1151 }  
 1140 }  
 1140 }  
 484, 48 }  
 4354 Paid in Full MAY 3 1916 3077 }  
 4354 }  
 2nd Half Paid OCT 31 1916 9443 }  
 1151 1st Half Paid MAY 31 1916 5906 }  
 575 }  
 2559 Paid in Full MAY 3 1916 3077 }  
 2559 }  
 576 }  
 576 }  
 2nd Half Paid OCT 9 - 1916 7863 }  
 1151 1st Half Paid APR 4 1916 2452 }  
 576 }  
 576 }

15520













Tax List of Real Property in the Town of Pine River

Standard Graph Co., Minneapolis, Minn. - 1915

IN WHOSE NAME ASSESSED	TO WHOM TRANSFERRED	Sold for Taxes	SUBDIVISION	Sec. or Lot	Town or Block	Rng.	No. of Acres	VALUATION			GENERAL TAXES			S.R.H. No.
								Dollars	¢	cts.	State	County	Town	
Footings Brought Forward,														
R. I. Geddes			NE 1/4 of NE 1/4	21	138	30	31.75							277
"			NW 1/4 of NE 1/4				40	638	34	87				349
"			SW 1/4 of NE 1/4				40							349
"			SE 1/4 of NE 1/4				40							349
			NE 1/4 of NW 1/4				40	168	918					291
St. Paul & Chicago			NW 1/4 of NW 1/4	2			29.55	126	688					257
R. I. Geddes			SW 1/4 of NW 1/4	3			39.85	168	918					291
"			SE 1/4 of NW 1/4				40	168	918					291
Chas. Rohl			NE 1/4 of SW 1/4				40	336	1836					233
"			NW 1/4 of SW 1/4				40							233
St. Paul & Chicago			SW 1/4 of SW 1/4				40	168	918					233
Chas. Rohl			SE 1/4 of SW 1/4				40	168	918					233
Robert E. Snell	R. E. Snell		NE 1/4 of SE 1/4				40	168	918					291
"	"		NW 1/4 of SE 1/4				40	168	918					291
Arthur M. Handerlich			SW 1/4 of SE 1/4				40	168	918					291
"			SE 1/4 of SE 1/4				40	168	918					291
Footings Carried Forward,														
							621.15	2612	14273					4550

Cass County, Minnesota, for Taxes of the Year 1915

SCHOOL DISTRICT	TOTAL TAXES	PAID	WHEN PAID	No. of Receipt	March Settlement	June Settlement	Penalty	November Settlement	Penalty	Collections to First Monday in January	Penalty	Delinquent on First Monday in January	REMARKS	
														District No. 14
	4811	1/2	2nd Half Paid OCT 5 - 1916	7806		2406		2405						
			1st Half Paid MAY 31 1916	5669										
	1209	1/2	2nd Half Paid OCT 5 - 1916	7806		604		605						
			1st Half Paid MAY 31 1916	5669										
	945		Paid in Full MAR 14 1916	2190		945								
	1209	1/2	2nd Half Paid OCT 5 - 1916	7806		1209		1209						
			1st Half Paid MAY 31 1916	5669										
	2302	1/2	2nd Half Paid OCT 24 1916	8448		1151		1151						
			1st Half Paid MAY 31 1916	5509										
	1151		Paid in Full MAR 14 1916	2190		1151								
	1151	1/2	2nd Half Paid OCT 24 1916	8448		450		701					See Rec.	
			1st Half Paid MAY 31 1916	5509										
	1209		Paid in Full APR 19 1916	4786		418								
	1209	1/2	Paid in Full APR 19 1916	4786										
	1209		Paid in Full JAN 6 1916	18										
	1209		Paid in Full JAN 6 1916	18		3418								
Footings Carried Forward,														
							18823							



Tax List of Real Property in the Town of Pine River

Minnesota, Minn.—1915

IN WHOSE NAME ASSESSED

TO WHOM TRANSFERRED

Sold for Taxes

SUBDIVISION

Sec. or Lot, Town or Block, Rng.

No. of Acres, 100ths

VALUATION

GENERAL TAXES

State, State Sch., County, Town, Local Sch., Total

Mills

State

School

Bonds

S.P.H. Dist. No. 60

SCHOOL DISTRICT

District No., District No., Rate, Mills

TOTAL TAXES

PAID

WHEN PAID

No. of Receipt

March Settlement

June Settlement

Penalty

November Settlement

Penalty

Collections to First Monday in January

Penalty

Delinquent on First Monday in January

REMARKS

Footings Brought Forward,

Robert a Rice		all NE Sw. 24 of	22 13830 13	91	497	162
John J. Vaughn	Herbert B. Oliver	NE 1/4 of NE 1/4 K. Ry				
P. Benjamin		NW 1/4 of NE 1/4 5 acres of Sw NW	5	23	126	59
Albert Castold		SW 1/4 of NE 1/4 " " SE..	1	14	76	12
		SE 1/4 of NE 1/4 " " "	1	14	76	12
J. A. Taylor		NE 1/4 of NW 1/4 4.81 acs. of Sw NW	4 81	45	246	56
Joe Mauber	R. E. Snell	NW 1/4 of NW 1/4 " " NE SW	1	49	267	12
		SW 1/4 of NW 1/4				
		SE 1/4 of NW 1/4				
		NE 1/4 of SW 1/4				
		NW 1/4 of SW 1/4				
		SW 1/4 of SW 1/4				
		SE 1/4 of SW 1/4				
		NE 1/4 of SE 1/4				
		NW 1/4 of SE 1/4				
		SW 1/4 of SE 1/4				
		SE 1/4 of SE 1/4				

Footings Carried Forward,

25 81 236 1288 303

Cass County, Minnesota, for Taxes of the Year 1915

649 Paid in Full FEB 29 1916 1747  
 183 Paid in Full APR 18 1916 2719  
 88 Paid Feb 27 1916 627  
 88 is Half Paid DEC 30 1916 1042  
 88 is Half Paid MAY 31 1916 6350  
 2nd Half Paid OCT 2 1 1916 8210  
 302 is Half Paid MAY 31 1916 6742  
 279 ✓

649 ✓

185

44

151

151 ✓

44 ✓ 04

101 Pd Sub to Cert no. 843.

1671



Tax List of Real Property in the Town of Pine River

Cass County, Minnesota, for Taxes of the Year 1915

IN WHOSE NAME ASSESSED	TO WHOM TRANSFERRED	Sold for Taxes	SUBDIVISION	Sec. or Lot	Town or Block	No. of Acres	GENERAL TAXES			S. R. H. Dist. No.	SCHOOL DISTRICT		TOTAL TAXES	PAID	WHEN PAID	No. of Receipt	March Settlement	June Settlement	Penalty	November Settlement	Penalty	Collections to First Monday in January	Penalty	Delinquent on First Monday in January	REMARKS					
							State	County	Local		District No.	District Rate																		
							Dollars	¢	cts.	¢	cts.	¢	cts.	¢	cts.	Month	Day	Year	¢	cts.	¢	cts.	¢	cts.	¢	cts.	¢	cts.	¢	cts.
Footings Brought Forward,																														
L. D. Emery & Carrie J. Emery und. 1/2			NE 1/4 of NE 1/4	23	138	30.40				175																				
"			NW 1/4 of NE 1/4			40	672	3672		175																				
"			SW 1/4 of NE 1/4			40				175																				
"			SE 1/4 of NE 1/4			40				175																				
"			NE 1/4 of NW 1/4			40				233																				
"			NW 1/4 of NW 1/4			40	714	3902		233																				
"			SW 1/4 of NW 1/4			40				233																				
"			SE 1/4 of NW 1/4			40				233																				
D. C. Rice			NE 1/4 of SW 1/4			40	168	918		349																				
Mary E. Rice			NW 1/4 of SW 1/4			40	336	1836		349																				
"			SW 1/4 of SW 1/4			40				349																				
D. C. Rice			SE 1/4 of SW 1/4			40	214	1169		349																				
L. D. Emery & Carrie J. Emery und. 1/2			NE 1/4 of SE 1/4			40	168	918		291																				
Robert A. Rice			NW 1/4 of SE 1/4			40	336	1836		291																				
"			SW 1/4 of SE 1/4			40				291																				
L. D. Emery & Carrie J. Emery und. 1/2			SE 1/4 of SE 1/4			40	168	918		291																				
Footings Carried Forward,							640	2776	15169	4193																				

2nd Half Paid NOV 13 1916 10064  
43.72 1st Half Paid MAY 31 1916 5723

2nd Half Paid NOV 13 1916 10064  
48.34 1st Half Paid MAY 31 1916 5723

2nd Half Paid OCT 31 1916 9359  
126.7 1st Half Paid MAY 31 1916 3907  
253.4 2nd Half Paid OCT 21 1916 8198  
1st Half Paid MAR 13 1916 2176

2nd Half Paid OCT 31 1916 9359  
157.8 1st Half Paid MAY 31 1916 3907

2nd Half Paid NOV 13 1916 10064  
120.9 1st Half Paid MAY 31 1916 5723  
241.8 2nd Half Paid OCT 31 1916 7359  
1st Half Paid MAY 31 1916 3907

2nd Half Paid NOV 13 1916 10064  
120.9 1st Half Paid MAY 31 1916 5723

19361





Tax List of Real Property in the Town of Pine River

Cass County, Minnesota, for Taxes of the Year 1915

Minnesota State Co., Minneapolis, Minn. - 1908

IN WHOSE NAME ASSESSED	TO WHOM TRANSFERRED	Sold for Taxes	SUBDIVISION	Sec. or Lot	Town or Block	No. of Acres	VALUATION	GENERAL TAXES			S. R. No.	SCHOOL DISTRICT		TOTAL TAXES	PAID	WHEN PAID	No. of Receipt	March Settlement	June Settlement	Penalty	November Settlement	Penalty	Collections to First Monday in January	Penalty	Delinquent on First Monday in January	REMARKS	
								State	County	Local		District No.	District Rate														Rate
Footings Brought Forward,																											
Daniel G. Rice			NE 1/4 of NE 1/4	26	138	30	40	179	9	78	349	14			2nd Half Paid OCT 31 1916	9359											
Charley Strawsell			NW 1/4 of NE 1/4			40		336	18	36	349	14		1327	1st Half Paid MAY 31 1916	3507		664		663							
"			SW 1/4 of NE 1/4			40					349	14		2534	1st Half Paid MAY 31 1916	6633		1267		1267							
Chas. E. Webber & H. H. Hill			SE 1/4 of NE 1/4			40		168	9	18	349	14		1267	2nd Half Paid OCT 30 1916	4088		634		633							
Charley Strawsell			NE 1/4 of NW 1/4			40		214	11	69	349	14		1518	2nd Half Paid OCT 30 1916	8978				759		759					
I. M. McDowell	Chas. E. Webber & Harry H. Hill		NW 1/4 of NW 1/4			40		336	18	36	349	14		2534	1st Half Paid MAY 31 1916	6633											
"	do		SW 1/4 of NW 1/4			40					349	14			2nd Half Paid OCT 24 1916	8391		1267		1267							
Louis & Wm. Tollefson			SE 1/4 of NW 1/4			40		168	9	18	349	14		1267	1st Half Paid MAY 31 1916	6137											
"			NE 1/4 of SW 1/4			40					291	1			2nd Half Paid OCT 31 1916	10004		634		633							
"			NW 1/4 of SW 1/4			40		336	18	36	291	1		2418	1st Half Paid MAY 31 1916	5422		1209		1209							
John Martin Lbr. Co.			SW 1/4 of SW 1/4			40					291	1			2nd Half Paid OCT 31 1916	10004											
Louis & Wm. Tollefson			SE 1/4 of SW 1/4			40		168	9	18	291	1		1209	Paid in Full MAY 30 1916	4715		1209									
"						40		168	9	18	291	1		1209	1st Half Paid MAY 31 1916	10004		604		605							
G. E. Webber & H. H. Hill			NE 1/4 of SE 1/4			40		168	9	18	349	1		1267	2nd Half Paid OCT 30 1916	8966											
"			NW 1/4 of SE 1/4			31	88	336	18	36	349	1		2534	1st Half Paid MAY 23 1916	4088		1267		1267							
Geo. Robideau			SW 1/4 of SE 1/4			40		140	7	65	349	1		1114													
G. E. Webber & H. H. Hill			SE 1/4 of SE 1/4			40		191	10	44	349	1		1393	Paid in Full NOV 21 1916	10155											
"						37	84	140	7	65	349	1		1114	2nd Half Paid OCT 30 1916	8966											
"						40		168	9	18	349	1		1267	1st Half Paid MAY 23 1916	4088		633		634							
Footings Carried Forward,																											
						640	2768	15125				5353			20477												

Ref. Narr # 91555 - 8/5/25  
Abatement 612

" " "















Tax List of Real Property in the Town of Pine River

Cass County, Minnesota, for Taxes of the Year 1915

IN WHOSE NAME ASSESSED	TO WHOM TRANSFERRED	Sold for Taxes	SUBDIVISION	Sec. or Lot	Town or Block	No. of Acres	VALUATION	GENERAL TAXES			Ditch No.	SCHOOL DISTRICT		TOTAL TAXES	PAID	WHEN PAID	No. of Receipt	March Settlement	June Settlement	Penalty	November Settlement	Penalty	Collections to First Monday in January	Penalty	Delinquent on First Monday in January	REMARKS	
								State	Mills	State		District No.	District 1														
Footings Brought Forward,																											
M. D. Oberstani			NE 1/4 of NE 1/4	33	138	30	40						14		2nd Half Paid OCT 27 1916 8412												
"			NW 1/4 of NE 1/4				40								1st Half Paid MAY 31 1916 4844			20 00		1672 ✓						See Receipt	
"			SW 1/4 of NE 1/4				40																				
"			SE 1/4 of NE 1/4				40																				
Minn. Park Association			NE 1/4 of NW 1/4				40	168					14		9 18 ✓												
G. L. Atwood			NW 1/4 of NW 1/4				40	168					14		9 18 Paid in Full MAY 12 1916 3355				9 18							1055 Paid subsequent to Cert. No. 2091	
Belle G. Hagen			SW 1/4 of NW 1/4				40	168					14		9 18 Paid in Full MAY 31 1916 6903				9 18								
Minn. Park Association			SE 1/4 of NW 1/4				40	168					14		9 18 ✓												
N. P. Ry Co.			NE 1/4 of SW 1/4				40	168					1		9 18 ✓												
Belle G. Hagen			NW 1/4 of SW 1/4				40	168					1		9 18 Paid in Full MAY 31 1916 6903				9 18							1055 Paid subsequent to Cert. No. 2092	
Pearl E. Richards			SW 1/4 of SW 1/4				40	168					1		9 18 Paid in Full MAY 9 1916 3221				9 18								
G. M. Hermann Jan Root			SE 1/4 of SW 1/4				40	168					1		9 18 Paid in Full MAR 25 1916 2330				9 18								
Martin Mattison			NE 1/4 of SE 1/4				40	168					1		9 18 Paid in Full JUN 20 1916 7086												
G. O. Smith	E. E. Martin		NW 1/4 of SE 1/4				40						1							9 18 ✓ 92							
"	"		SW 1/4 of SE 1/4				40	504					1		2nd half Paid May 31 1916 5481				1377								
"	"		SE 1/4 of SE 1/4				40						1		1st Half Paid MAY 31 1916 6832				1377								
Footings Carried Forward,																											
640 2688 14688																											

Tax List of Real Property in the Town of Pine River

Cass County, Minnesota, for Taxes of the Year 1915

IN WHOSE NAME ASSESSED	TO WHOM TRANSFERRED	Sold for Taxes	SUBDIVISION	Sec. or Lot	Town or Block	Rng.	No. of Acres		VALUATION	GENERAL TAXES			State School Bonds	No. 80	SCHOOL DISTRICT		TOTAL TAXES	PAID	WHEN PAID	No. of Receipt	March Settlement	June Settlement	Penalty	November Settlement	Penalty	Collections to First Monday in January	Penalty	Delinquent on First Monday in January	REMARKS		
							Acres	100ths		State	County	Local			District No.	District 7															
							Dollars	cts.		cts.	cts.	cts.			Rate	Rate															
Footings Brought Forward,																															
L. E. Brown			NE 1/4 of NE 1/4	34	138	30	40	168	918									1151	2nd Half Paid OCT 31 1916	4715											
Arthur O. Miller			NW 1/4 of NE 1/4				40	168	918									1151	1st Half Paid MAY 31 1916	9979											
			SW 1/4 of NE 1/4																												
L. E. Brown			SE 1/4 of NE 1/4				40	168	918										233												
H. E. Toole			NE 1/4 of NW 1/4				40	168	918										1151	2nd Half Paid OCT 31 1916	9979										
A. B. Allen			NW 1/4 of NW 1/4				40	168	918										1093	1st Half Paid MAY 31 1916	6794										
H. E. Toole			SW 1/4 of NW 1/4				40	336	1836										1093	2nd Half Paid OCT 27 1916	8711										
"			SE 1/4 of NW 1/4				40												2186	1st Half Paid MAY 31 1916	6794										
"			NE 1/4 of SW 1/4				40	168	918										918	2nd Half Paid OCT 31 1916	9979										
Mpls. & St. L. Ry. Co.	E. E. Martin		NW 1/4 of SW 1/4				40												2754	1st Half Paid MAY 31 1916	6794										
"	"		SW 1/4 of SW 1/4				40	504	2754										2754	2nd Half Paid MAY 31 1916	5481										
"	"		SE 1/4 of SW 1/4				40																								
John Buck			NE 1/4 of SE 1/4				40	336	1836										1836	2nd Half Paid OCT 25 1916	8533										
"			NW 1/4 of SE 1/4				40												918	1st Half Paid MAY 31 1916	5467										
P. E. Lindberg			SW 1/4 of SE 1/4				40	168	918										918	2nd Half Paid OCT 25 1916	8533										
John Buck			SE 1/4 of SE 1/4				40	168	918										918	1st Half Paid MAY 31 1916	5467										
Footings Carried Forward,																															
							600	2520	13770										15407												







Tax List of Real Property in the Town of Pine River

Kimball-Storer Co., Minneapolis, Minn.—1906

IN WHOSE NAME ASSESSED

TO WHOM TRANSFERRED

Sold for Taxes

SUBDIVISION

Sec. or Lot, Town or Block, Rtg.

No. of Acres, Acres 100ths

VALUATION

GENERAL TAXES: State, County, Local Sch., Total

Mills, State, School, Bonds

Ditch No.

Dollars \$ cts. \$ cts. \$ cts.

Footings Brought Forward,

NE 1/4 of NE 1/4

22

NW 1/4 of NE 1/4

23

SW 1/4 of NE 1/4

24

SE 1/4 of NE 1/4

1

2

NE 1/4 of NW 1/4

3

NW 1/4 of NW 1/4

4

SW 1/4 of NW 1/4

5

SE 1/4 of NW 1/4

6

NE 1/4 of SW 1/4

7

NW 1/4 of SW 1/4

8

SW 1/4 of SW 1/4

9

SE 1/4 of SW 1/4

10

NE 1/4 of SE 1/4

11

NW 1/4 of SE 1/4

12

SW 1/4 of SE 1/4

13

SE 1/4 of SE 1/4

14

Footings Carried Forward,

100

Albert Eastvold

"

"

"

"

"

"

"

"

"

"

"

"

"

"

"

"

"

"

"

Cass County, Minnesota, for Taxes of the Year 1915

SCHOOL DISTRICT

District No., District No., Rate, Mills

TOTAL TAXES

PAID

WHEN PAID

No. of Receipt

March Settlement

June Settlement

Penalty

November Settlement

Penalty

Collections to First Monday in January

Penalty

Delinquent on First Monday in January

REMARKS

\$ cts. \$ cts.

\$ cts.

Month Day Year

\$ cts.

\$ cts.

\$ cts.

\$ cts.

\$ cts.

\$ cts.

\$ cts.

\$ cts.

\$ cts.

322 is Half Paid DEC 30 1916 10421  
is Half Paid MAY 31 1916 6350

161

161 16

137 is Half Paid DEC 30 1916  
is Half Paid MAY 31 1916

22 is Half Paid DEC 30 1916  
is Half Paid MAY 31 1916

22 is Half Paid DEC 30 1916  
is Half Paid MAY 31 1916

22 is Half Paid DEC 30 1916  
is Half Paid MAY 31 1916

10421  
6350

113

112 11

547









Tax List of Real Property in the Town of Pine River

Cass County, Minnesota, for Taxes of the Year 1915

Standard-Storage Co., Minneapolis, Minn.—70000

IN WHOSE NAME ASSESSED	TO WHOM TRANSFERRED	Sold for Taxes	SUBDIVISION	Sec. or Lot	Town or Block	Rng.	No. of Acres	VALUATION	GENERAL TAXES			Ditch No.	SCHOOL DISTRICT		TOTAL TAXES	PAID	WHEN PAID	No. of Receipt	March Settlement	June Settlement	Penalty	November Settlement	Penalty	Collections to First Monday in January	Penalty	Delinquent on First Monday in January	REMARKS	
									State	County	Local		District No.	District 1														
			Chickama Beach					Dollars	\$	cts.	\$	cts.	\$	cts.														
			Footings Brought Forward,																									
<del>Serena Johnson</del>	Ella Holman		NE 1/4 of NE 1/4	4	2			13																				
<del>"</del>	"		NW 1/4 of NE 1/4	5				13																				
<del>C. D. Miller</del>	"		SW 1/4 of NE 1/4	6				13																				
<del>"</del>	"		SE 1/4 of NE 1/4	7				84																				
<del>A. B. Ross</del>	Jacob A. Kung		NE 1/4 of NW 1/4	8				28																				
			NW 1/4 of NW 1/4	9																								
			SW 1/4 of NW 1/4																									
			SE 1/4 of NW 1/4																									
Hannah Kinler			Lillespie's Add. P.R.	1	1			6																				
M. M. Jones			NE 1/4 of SW 1/4 Lots 2 & 3					84																				
Edward W. Parker			NW 1/4 of SW 1/4 " 4, 5 & 6					84																				
Hannah Kinler			SW 1/4 of SW 1/4 " 7-8-9-10-11-12					84																				
Leo Glover			SE 1/4 of SW 1/4 " " 1-2					56																				
Jennie Kinler			NE 1/4 of SE 1/4 Lots 2-3-4-5 & 6					45																				
Peter Holmquist			NW 1/4 of SE 1/4 " 7-8-9 & 10					8																				
<del>Peter Holmquist</del>			SW 1/4 of SE 1/4 " 11 & 12					18																				
Dora Burrell (Lot 7 & 8)	Chas. E. Weber (Lots 1-2-3-4-5-6)		SE 1/4 of SE 1/4 " 1-2-3-4-5-6-7-8			3		42																				
Bessie Burrell			" 9-7	10				42																				
			Footings Carried Forward,																									
								578																				

71<sup>st</sup> Half Paid OCT 31 1916  
 71<sup>st</sup> Half Paid MAY 31 1916 } 9640  
 71<sup>st</sup> Half Paid OCT 31 1916 } 6334  
 71<sup>st</sup> Half Paid MAY 31 1916 } 336  
 71<sup>st</sup> Half Paid OCT 31 1916 } 106  
 459<sup>th</sup> Half Paid MAY 31 1916 } 8382  
 459<sup>th</sup> Half Paid OCT 24 1916 } 230  
 153 Paid in Full OCT 27 1916 8674  
 33 Paid in Full MAR 17 1916 2228 } 33  
 459 Paid in Full APR 24 1916 2872 } 459  
 459 }  
 459 Paid in Full MAR 17 1916 2228 } 459  
 306 Paid in Full JAN 19 1916 } 146 } 552  
 246 Paid in Full JAN 19 1916 }  
 44 Paid in Full JUL 21 1916 7382 } 44 } 4  
 98<sup>th</sup> Half Paid DEC 1 1916 3212 } 26  
 229 Paid in Full MAY 8 1916 3212 } 229 } 73 } 07  
 3158

Tax List of Real Property in the Town of Pine River

Cass County, Minnesota, for Taxes of the Year 1915

15

IN WHOSE NAME ASSESSED	TO WHOM TRANSFERRED	Sold for Taxes	SUBDIVISION	Sec. or Lot	Town or Block	Rag.	No. of Acres	VALUATION	GENERAL TAXES			Ditch No.	SCHOOL DISTRICT		TOTAL TAXES	PAID	WHEN PAID	No. of Receipt	March Settlement	June Settlement	Penalty	November Settlement	Penalty	Collections to First Monday in January	Penalty	Delinquent on First Monday in January	REMARKS	
									State	Mills	State		District No.	District No.														Rate
Gillespie's Add. P. R.																												
Footings Brought Forward,																												
Bessie Burrell			NE 1/4 of NE 1/4	11	12	3		42																				
E. B. Harmon	John Crossman		NW 1/4 of NE 1/4	1	2	3	14	17																				
Alice Crossman	John Crossman		SW 1/4 of NE 1/4		4	5		17																				
Helen Russell	Char. E. Heber		SE 1/4 of NE 1/4		6	7		34																				
Orman Stanley	Edw. O. & Emily K. Franks		NE 1/4 of NW 1/4		8			20																				
Marie H. Brundrett			NW 1/4 of NW 1/4		9	10		56																				
Catherine A. Kline			SW 1/4 of NW 1/4		11	12		11																				
Dorothy Countryman			SE 1/4 of NW 1/4		Market Lot # 1			6																				
Hannah Kinler			NE 1/4 of SW 1/4		Willman's Add. to P. R.	1		6																				
Rosa Gillespie	John McAllister		NW 1/4 of SW 1/4		2																							
Heber + Hill			SW 1/4 of SW 1/4		3																							
"			SE 1/4 of SW 1/4		4			78																				
"			NE 1/4 of SE 1/4		5																							
Annie Francis			NW 1/4 of SE 1/4		6			42																				
Footings Carried Forward,																												
329																												

17 95





