

ASSESSMENT & TAX LIST

Pike Bay

1943

DIRECTIONS TO ASSESSOR

OFFICE OF COUNTY AUDITOR,

1943.

APR 9

County, Minn.,

CASS

Herman Kling Assessor of the Town of Pike Bay

for the year 1943, containing a list of all

Platted and Unplatted Real Estate subject to taxation, so far as the same have come to my knowledge from any source

and I hereby direct you to assess all property and make return thereof to me as required by the law prescribing your

duties hereto annexed.

A form of the return to be signed by you is appended in this book.

Chas. E. ... County Auditor.

Extracts from Laws Relating to the Listing of Personal Property.

(Section Numbers Refer to Minnesota Statutes 1941)

WHEN LISTED AND ASSESSED

Sec. 273.01 Personal Property shall be listed... Sec. 273.02 By whom listed. Personal Property shall be listed in the name of the owner...

Sec. 273.03 Where listed in case of doubt. In case of doubt as to the proper place of listing personal property...

Sec. 273.04 Property of a partner or agent. The property of a partner or agent in the hands of an agent...

Sec. 273.05 False statement regarding taxes. Every person who is liable for the payment of taxes...

Sec. 273.06 Personal property of electric light and power companies outside of city limits. Every personal property...

Sec. 273.07 Property moved between May and July. The property of a deceased person shall be listed and assessed at the time of his death.

Sec. 273.08 Assessors and receivers. Personal property in the hands of an assignee shall be listed and assessed at the time of its assignment.

Sec. 273.09 Minnesota Statutes 1941. Assessment; Mode. The county auditor shall annually provide the necessary assessment books and blanks at the expense of the county...

Sec. 273.10 Minnesota Statutes 1941. Assessment; Mode. The county auditor shall annually provide the necessary assessment books and blanks at the expense of the county...

Sec. 273.11 Minnesota Statutes 1941. Assessment; Mode. The county auditor shall annually provide the necessary assessment books and blanks at the expense of the county...

INDEX TO SECTIONS

| SECTION | PAGE |
|---------|------|
| Sec. 1 | |
| " 2 | |
| " 3 | |
| " 4 | |
| " 5 | |
| " 6 | |
| " 7 | |
| " 8 | |
| " 9 | |
| " 10 | |
| " 11 | |
| " 12 | |
| " 13 | |
| " 14 | |
| " 15 | |
| " 16 | |
| " 17 | |
| " 18 | |
| " 19 | |
| " 20 | |
| " 21 | |
| " 22 | |
| " 23 | |
| " 24 | |
| " 25 | |
| " 26 | |
| " 27 | |
| " 28 | |
| " 29 | |
| " 30 | |
| " 31 | |
| " 32 | |
| " 33 | |
| " 34 | |
| " 35 | |
| " 36 | |

For Convenience of Auditor in Showing Boundaries of School Districts

Township No. 145 Range No. 31 Mer. P. M.



Assessor's Report on Tree Bounty in the Town of _____ County of _____, Minnesota, 1943.

| NAMES OF PERSONS CLAIMING COMPENSATION FOR TREES | POST OFFICE ADDRESS | DESCRIPTION OF LAND UPON WHICH TREES ARE GROWING | Sec. | Twp. | Range | No. of Acres of Trees | Were Trees Originally Planted no. more than 22 feet apart each way | Have the Trees been kept in that Condition by replanting all that may have died each year | Condition of Trees | REMARKS |
|--|---------------------|--|------|------|-------|-----------------------|--|---|--------------------|---------|
| | | | | | | | | | | |
| | | | | | | | | | | |
| | | | | | | | | | | |
| | | | | | | | | | | |
| | | | | | | | | | | |
| | | | | | | | | | | |
| | | | | | | | | | | |
| | | | | | | | | | | |
| | | | | | | | | | | |
| | | | | | | | | | | |
| | | | | | | | | | | |
| | | | | | | | | | | |
| | | | | | | | | | | |
| | | | | | | | | | | |
| | | | | | | | | | | |
| | | | | | | | | | | |
| | | | | | | | | | | |
| | | | | | | | | | | |
| | | | | | | | | | | |
| | | | | | | | | | | |
| | | | | | | | | | | |
| | | | | | | | | | | |
| | | | | | | | | | | |
| | | | | | | | | | | |
| | | | | | | | | | | |
| | | | | | | | | | | |
| | | | | | | | | | | |

I hereby certify this to be a true statement of the extent and condition of Groves and Lines of Trees in said Town and County, as ascertained by examination as provided by Section 348.03, of Minnesota Statutes 1941.

Dated _____ 1943.

Assessor.

Supp. Plat of Ing. S. Co. Re-Ming. Beach

Harding-Combs Arch. Co.

List of Lands in the _____ of _____, County of _____, Minn., for the Year 19_____, Which have Become Homesteads or Ceased to be Homesteads
SINCE THE LAST REAL ESTATE ASSESSMENT DATE

Form 214 Miller-Davis Company, Minneapolis, State - Form No. 67

LANDS BECOMING HOMESTEADS

DESCRIPTION OF PROPERTY

SUBDIVISION

Sec. or Lot, Town or Block, Range, Number of Acres of Land, Acres, 100ths

LANDS CEASING TO BE HOMESTEADS

DESCRIPTION OF PROPERTY

SUBDIVISION

Sec. or Lot, Town or Block, Range, Number of Acres of Land, Acres, 100ths

INCREASE OR DECREASE in Value of Property Heretofore Assessed, by the Erection or Destruction of Buildings or Structures Thereon

FORM 3 MILLER-DAVIS COMPANY, MINNEAPOLIS

Platted Property Assessed at 40 Per Cent of True and Full Value. (Homesteads up to \$4,000 True and Full Value 25 Per Cent.)

Unplatted Property Assessed at 33 1/3 Per Cent of True and Full Value. (Homesteads up to \$4,000 True and Full Value 20 Per Cent.)

NAMES OF PROPERTY OWNERS

DESCRIPTION

Sec. or Lot, Town or Block, Range

True and Full Value of Structures worth more than \$100 each

Dollars

KIND OF STRUCTURES

Assessed Value of Additional Structures

Dollars

Reduction of Assessed Value on Account of Loss occasioned by Fire, Flood or otherwise

Dollars

Albert J. Hale, Adm. H. G. Knouf, Est Lot 3

1914531

27

also see Page "new Prop"

INCREASE OR DECREASE in Value of Property Heretofore Assessed, by the Erection or Destruction of Buildings or Structures Thereon

Platted Property Assessed at 40 Per Cent of True and Full Value.
(Homesteads up to \$4,000 True and Full Value 25 Per Cent.)

Unplatted Property Assessed at 33 1/3 Per Cent of True and Full Value.
(Homesteads up to \$4,000 True and Full Value 20 Per Cent.)

FORM 3 MILLER-DAY COMPANY, MINNEAPOLIS

| NAMES OF PROPERTY OWNERS | DESCRIPTION | Sec. or Lot | Town or Block | Rng. | True and Full Value of Structures worth more than \$100 each Dollars | KIND OF STRUCTURES | Assessed Value of Additional Structures Dollars | Reduction of Assessed Value on Account of Loss occasioned by Fire, Flood or otherwise Dollars |
|--------------------------|-------------|-------------|---------------|------|---|--------------------|--|--|
| | | | | | | | | |

Real Property becoming subject to Taxation since last previous Assessment or Omitted from Assessment Rolls of previous years.
Assessor's Return of Taxable Real Property in the Town of Pike Bay, County of Cass, Minn., for the Year 1943.

Platted Property Assessed at 40 Per Cent of True and Full Value.
(Homesteads up to \$4,000 True and Full Value 25 Per Cent Class 3C.)

Unplatted Property Assessed at 33 1/3 Per Cent of True and Full Value.
(Homesteads up to \$4,000 True and Full Value 20 Per Cent Class 3B.)

FORM 3 1/2 MILLER-DAY COMPANY, MINNEAPOLIS

| NAME OF OWNER | School District | DESCRIPTION OF PROPERTY | | | | Indicate Homestead | ASSESSOR'S VALUATIONS | | | | | EQUALIZED VALUATIONS | | | | |
|---------------------|-----------------|-------------------------|---------------|--|--------|--------------------|--|--|---|--|--|--|---|---|--|--|
| | | Sec. or Lot | Twp. or Range | Number of Acres of Land | | | True and Full Value of Lands Exclusive of Structures and Improvements Dollars | STRUCTURES & IMPROVEMENTS | | Total True and Full Value of Lands including all Structures, Improvements and Machinery Dollars | Assessed Value of Homesteads up to \$4,000 at 20% Class 3B 25% Class 3C Dollars | Assessed Value of Remainder at 33 1/3 per cent Class 3 40 per cent Class 4 Dollars | Total Assessed Value of Lands Including all Structures, Improvements and Machinery Dollars | Total Assessed Value as Equalized by Board of Review Dollars | Total Assessed Value as Equalized by County Board Dollars | Total Assessed Value as Equalized by the Department of Taxation Dollars |
| | | | | Acres | 100ths | | | True and Full Value of Buildings and Other Structures Dollars | True and Full Value of Machinery Permanently Attached to Real Estate Dollars | | | | | | | |
| Gunnar Anderson | 3 | | | NE ^{1/4} of NE ^{1/4} | 20 | 150 | | | 150 | 50 | 150 | | | | | |
| " | | | | NE ^{1/4} of NW ^{1/4} | 40 | 150 | | | 150 | 50 | 150 | | | | | |
| R. H. Campbell | 3 | | | NE ^{1/4} of SE ^{1/4} | 33 | 324 | | | 324 | 108 | 108 | | | | | |
| | | | | NW ^{1/4} of SE ^{1/4} | 40 | 270 | | | 270 | 90 | 90 | | | | | |
| A. R. Rau | 3 | | | N.W. 1/4 of N.W. 1/4 | 33 | | yes | 40 NW Bldg | | 8 | 8 | | | | | |
| Carl D. Moster | | | | N.W. 1/4 of N.W. 1/4 | 32 | | " | 300 " | | 60 | 60 | | | | | |
| Henry J. Reuter | 3 | | | Lot 3 | 31 | | " | 350 Silo " | | 70 | 70 | | | | | |
| Rudolph Hansley | unorg. | | | N. 1/2 of N. 1/2 of S.E. 1/4 | 8 | | " | 40 " | | 8 | 8 | | | | | |
| Roy Stoll | 3 | | | Harding Jordahl addition 213 ft. long bought from W. A. Rogers. 16 ft. wide Lot 6 Blk B. | | | " | 75 " | 150 | 30 | 30 | | | | | |
| Everett Haugen | unorg. | | | S.W. 1/4 of N.E. 1/4 bought from Balsley | 4 | | " | 750 " | | 150 | 150 | | | | | |
| Mrs. Laura L. Flora | unorg. | | | Lot 3 | 3 | | " | 175 " | | 37 | 37 | | | | | |
| B. A. Black | 3 | | | Lot 2 | 27 | | " | 150 " | | 30 | 30 | | | | | |

Harding-Jordahl Add'n

Dupl. Part of pg. 2-20

NAME OF OWNER

Treasurer's Office, Cass County, Minnesota

RECEIVED this, the first Monday (being the 3rd day) of January,
 A. D. 1944, of Pike Bay, Auditor of said County, Minnesota,
 the Tax List of all Taxable Real and Personal Property in the Township
 of Pike Bay in said County for the year A. D. 1943,
 as specified above and amounting to six thousand five hundred
sixty one $\frac{96}{100}$ dollars.
W. J. McKeown
 County Treasurer.

Office of County Treasurer, Cass County, Minnesota

To L. G. Peterson, County Auditor:

Sir:—I herewith return to you the Tax List for the Township
 of Pike Bay in said County for the year 1943, heretofore
 received from you. I certify that I have compared the same with the duplicate receipts in
 your office, and have written opposite the amount of each tax so receipted the words "First
 Quarter Paid", "Second Quarter Paid", "Third Quarter Paid" or "Paid in full" as the
 case may be, and the number of my receipt given in discharge of said tax, and each tract
 or lot of real property against which the taxes remain unpaid is delinquent for said year.

Yours respectfully,
W. J. McKeown
 County Treasurer.

Auditor's Office, Cass County, Minnesota

I, _____ Auditor of said County, and State
 of Minnesota, do hereby certify that the following is a correct list of the Taxes levied on the
 Real and Personal Property in the _____ of _____
 for the year 1943.

WITNESS my hand and official seal, the _____ day of _____
 1944.

(SEAL) _____ County Auditor.

Auditor's Office, Cass County, Minnesota

I hereby certify that on the first Monday in January 1945, I received of _____
 _____ County Treasurer, the Tax List of the _____
 _____ of _____ in said
 County for the year 1943; that I have compared the said list with the Statements receipted
 for by said Treasurer, which are on file in my office, and that each tract or lot of real
 property therein against which the taxes, or any part thereof, remains unpaid are delin-
 quent for said year.

(SEAL) _____ County Auditor.

Assessor's

FORM 3-1-1943

NAME OF OWNER

TABULAR SCHEDULE OF VALUATIONS,

LEVIED IN THE *Lounship* OF *Pike Bay*

| School District No. | VALUATION BY SCHOOL DISTRICTS | | | | | RATE OF STATE TAXES | | | | | RATE OF COUNTY TAXES | | | | | RATE OF TOWN TAXES | | | | | | | |
|---------------------|--|--|--|---------------------------|--|---------------------|-------------------|------------------|------------------|-------------------------------|----------------------|---------------|---------------|----------------------|-------------|--------------------------------|------------|---------------|----------------|------------------|-------------------------------|------------------------------|-----|
| | Valuation of Money and Credits Dollars | Value of Lands other than Town Lots including Structures Dollars | Value of Town and City Lots including Structures thereon Dollars | Personal Property Dollars | Total Value of all Property except Money and Credits Dollars | State Rev. Mills | State Sch'l Mills | Tehr. Ins. Mills | State Debt Mills | Total Rate of State Tax Mills | Rev. Mills | R. & B. Mills | Welfare Mills | Bonds and Int. Mills | Sewer Mills | Total Rate of County Tax Mills | Rev. Mills | R. & B. Mills | Drag Tax Mills | State Loan Mills | Fire <i>Patrol Bldg</i> Mills | Total Rate of Town Tax Mills | |
| #3 | | 17177 | 6151 | 5583 | 28911 | | | | | 2.1 | 1.7 | 4.5 | 35.2 | 19.4 | .6 | 81.4 | 5. | 6. | 1. | 3. | 1. | 7. | 23. |
| Un. | | 8039 | 2722 | 4045 | 14806 | | | | | | | | | | | | | | | | | | |
| | | 25216 | 8873 | 9628 | 43717 | | | | | 5.4 | | | | | | | | | | | | | |

RATES AND TAXES

COUNTY OF CASS, STATE OF MINNESOTA

| RATE OF SCHOOL TAXES | | | | | | | | | | TAXES LEVIED | | | | | | | | | |
|--|---------|------------|------|------|----|----|-------------------------------|-------------------------------|--------------|-----------------|------------|------------|----------------|------------------|--------------------|---------------------------|------|---------|--|
| LOCAL 1 MILL AND SPECIAL SCHOOL TAXES BY DISTRICTS | | | | | | | | | | ALL OTHER TAXES | | | | | | | | | |
| Local 1 Mill | Special | State Loan | Def. | C.O. | B. | B. | Total Rate of Sch'l Tax Mills | Total Rate of all Taxes Mills | Local 1 Mill | Special | State Loan | Deficiency | Capital Outlay | Bonds & Interest | Total School Taxes | FUNDS | Rate | Amounts | |
| 1. | 15. | | 10. | | | | 26. | 131.6 | 1718 | 25766 | | 17177 | | | 44661 | State Revenue, | | | |
| 1. | 30. | | 10. | | | | 41. | 146.6 | 1173 | 35202 | | 11734 | | | 48109 | State School, | | | |
| 1. | 20. | 10. | 10. | 8. | 3. | | 52. | 157.6 | 804 | 16078 | 8039 | 8039 | 6431 | 2412 | 41803 | Teachers Insurance, | | | |
| 1. | 40. | 10. | 10. | 8. | 3. | | 72. | 177.6 | 677 | 27068 | 6767 | 6767 | 5414 | 2030 | 48723 | State Debt—Non-Homestead, | | 112 52 | |
| | | | | | | | | | | | | | | | | State Debt—Homestead, | | 52 46 | |
| | | | | | | | | | | | | | | | | County Revenue, | | 94866 | |
| | | | | | | | | | | | | | | | | County Road and Bridge, | | 19673 | |
| | | | | | | | | | | | | | | | | County Welfare, | | 153880 | |
| | | | | | | | | | | | | | | | | Bonds and Interest | | 84811 | |
| | | | | | | | | | | | | | | | | Sewer | | 7623 | |
| | | | | | | | | | | | | | | | | Town Revenue, | | 21858 | |
| | | | | | | | | | | | | | | | | Town Road and Bridge, | | 26230 | |
| | | | | | | | | | | | | | | | | Town Drag, | | 4372 | |
| | | | | | | | | | | | | | | | | Town State Loan, | | 13115 | |
| | | | | | | | | | | | | | | | | Fire Patrol Building, | | 4372 | |
| | | | | | | | | | | | | | | | | | | 30602 | |
| | | | | | | | | | | | | | | | | School Local 1 Mill, | | 4372 | |
| | | | | | | | | | | | | | | | | School Special, | | 104114 | |
| | | | | | | | | | | | | | | | | School State Loan, | | 14806 | |
| | | | | | | | | | | | | | | | | Deficiency | | 43717 | |
| | | | | | | | | | | | | | | | | Capital Outlay | | 11845 | |
| | | | | | | | | | | | | | | | | Bonds & Interest | | 4422 | |
| | | | | | | | | | | | | | | | | Money and Credits, | | 656196 | |

Total Number of Acres *8763.26*
State of Minnesota, ss. *L. C. Peterson*
 COUNTY OF CASS
 Auditor of said County and State aforesaid, do hereby certify that the foregoing is a true and correct Schedule, showing the valuation of all the taxable property, in the *Lounship* of *Pike Bay*, in said County, the several rates of Taxation and Totals of the several Tax Funds levied thereon for the year A. D. 1943.

Witness my hand and official seal, this *DEC 31 1943* day of *December*, A. D. 1943.
L. C. Peterson
 County Auditor.



131.6 / 42 / 13.09
157.6 / 41.8 / 16.13
146.6 / 40.6 / 15.06

Assessor's

COLLECTIONS OF TAXES OF 1943, Township Pike Bay OF Pike Bay, CASS COUNTY, MINNESOTA

FORM 34 - MARCH-DAYE COMPANY, INC.

NAME OF OWNER

| FUNDS | MARCH SETTLEMENT 1943 | JUNE SETTLEMENT 1943 | NOV. SETTLEMENT 1943 | Amount Collected from Nov. 19... to First Monday in Jan. 1943 | REDUCTIONS | Infected Cancellation | Total Reductions and Collected | BALANCE UNCOLLECTED | ADDITIONS | Total Uncollected to First Monday in January, 1943 |
|--|--|--|---|---|------------|--------------------------|--------------------------------------|------------------------|-----------|--|
| State Revenue, State School, Teachers Insurance, State Debt—Non-Homestead, State Debt—Homestead, | 3303 975 | 3938 2258 | 909 777 | 668 270 | | | | | | |
| County Revenue, County Road and Bridge, County Welfare, County Bond and Interest, Sewer | 17624 3655 28587 15756 487 | 40829 8467 66230 36502 1129 | 14059 2916 22806 12569 387 | 4880 10122 7916 4363 135 | | | | | | |
| Town Revenue, Town Road and Bridge, Town Drag, Town State Loan, Sic Bldg. | 4061 4872 812 2437 812 5682 | 9407 11289 1881 5645 13171 1832 | 3239 3887 648 1944 648 4535 | 1124 1349 225 675 225 1574 | | | | | | |
| School Local 1 Mill, School Special, School State Loan, Deficiency B.O. B.H. | 816 27262 3648 8121 2918 1094 | 1881 41760 5232 18816 4265 1600 | 648 14220 2176 6478 1742 653 | 225 5581 1434 2249 1147 431 | | | | | | |
| Money and Credits, | | | | | | | | | | |
| | 152921 | 276282 | 95242 | 35483 | 2844 | 9301 | | 3716 | | 107779 |

| | SCHOOL DISTRICT NO. | LOCAL 1 MILL | SPECIAL | STATE LOAN | Deficiency | B.O. | B.H. | TOTALS |
|---------------------|------------------------------|--------------------------|--------------------------------|--------------|------------------------------|--------------|-------------|----------------------------------|
| MARCH SETTLEMENT | School District No. 3 Un. | 355 474 12 354 | 516 12388 226 14122 | 118 3530 | 344 4129 118 3530 | 94 | 35 1059 | 895 16931 614 25419 |
| | Totals | 816 | 27262 | 2648 | 8121 | 2918 | 1094 | 43859 |
| JUNE SETTLEMENT | School District No. 3 Un. | 841 507 376 162 | 12620 15212 7397 6531 | 3699 7632 | 8413 5071 3699 7632 | 2959 1306 | 1110 490 | 21874 20740 19234 11756 |
| | Totals | 1881 | 41760 | 5232 | 18816 | 4265 | 1600 | 72654 |
| NOVEMBER SETTLEMENT | School District No. | | | | | | | |
| | Totals | | | | | | | |
| NOVEMBER to JANUARY | School District No. 3 Un. | 81 144 | 1935 3646 | 1434 | 815 1434 | 1147 | 431 | 2831 8236 |
| | Totals | 225 | 5581 | 1434 | 2249 | 1147 | 431 | 11067 |
| ADDITIONS | School District No. | | | | | | | |
| | Totals | | | | | | | |
| REDUCTIONS | School District No. | | | | | | | |
| | Totals | | | | | | | |

Assessment Roll and Tax List of Unplatted Real Property in the of Cass County, Minnesota, for Taxes for the Year 1943.

Table with columns: IN WHOSE NAME ASSESSED, TO WHOM TRANSFERRED, DESCRIPTION OF PROPERTY, ASSESSOR'S VALUATION, EQUALIZED VALUES, VALUATIONS BY SCHOOL DISTRICTS AS EQUALIZED BY DEPARTMENT OF TAXATION, Rate and Tax Less Homestead Exemption, State Tax on Non-Homestead, TOTAL GENERAL TAX, SPECIAL TAXES, TOTAL TAXES, PAID, WHEN PAID, Number of Receipt, March Settlement 1944, June Settlement 1944, November Settlement 1944, Penalty, Collections to First Monday in January 1945, Delinquent on First Monday in January 1945, Total Delinquent Tax and Penalty, REMARKS.

Albin H. Nelson - State of Minnesota

Ida May Balley, Frank R. Balley

State of Minnesota (cont to Edwin Bassner)

State of Minnesota, First Nat'l Bk., Park Rapids

Edward Granby, Forrest Hinckley, Walter L. Brown, Josephine E. Lind

Lars Hjelmstad, Edward Granby, Forrest Hinckley, Jay R. + Hulda Thelle, Lars Hjelmstad

Abel #4634, #1634

844, # 310, 1154, 18184, 130, 18314

Canv. (State) Dec 10, Chng 374 Laws '41, 2nd Half Paid NOV 17 1944, 1st Half Paid JUN 14 1944, 2nd Half Paid NOV 17 1944, 1st Half Paid JUN 14 1944

PAID IN FULL JUN 27 1944, PAID IN FULL JUN 26 1944, PAID IN FULL JUN 26 1944

2nd Half Paid NOV 17 1944, 1st Half Paid JUN 14 1944, PAID IN FULL JUN 26 1944, 2nd Half Paid NOV 17 1944, 1st Half Paid JUN 14 1944

584 Canv.

5424

Harding-Jordan, Add'n. Popp, First of Aug. 5-7-40, Harding Beach

Assessment Roll and Tax List of Unplatted Real Property in the of Cass County, Minnesota, for Taxes for the Year 1943.

Cass County, Minnesota, for Taxes for the Year 1943.

Table with columns: IN WHOSE NAME ASSESSED, TO WHOM TRANSFERRED, DESCRIPTION OF PROPERTY, ASSESSOR'S VALUATION, EQUALIZED VALUES, VALUATIONS BY SCHOOL DISTRICTS AS EQUALIZED BY DEPARTMENT OF TAXATION, SPECIAL TAXES, TOTAL TAXES, PAID, WHEN PAID, Number of Receipt, March Settlement 1944, June Settlement 1944, November Settlement 1944, Collections to First Monday in January 1945, Delinquent on First Monday in January 1945, Total Delinquent Tax and Penalty, REMARKS.

State of Minnesota (Cont'd) Melvin Hyland & F. J. Gangelhoff

Elmer E. Drew

Ernest Flemming, William H. Baird & Arvid Lydholm

Elmer E. Drew

Chas. Bingaman

Anna S. Johnson

Robert Jarvis

Frances E. Benford to Martin Smith 10/1/43

Resold by State 10/1/43

Supp. Part of Aug-5-40- Harding-Johnson Add'l. Harding-Borch

Assessment Roll and Tax List of Unplatted Real Property in the of Cass County, Minnesota, for Taxes for the Year 1943.

Cass County, Minnesota, for Taxes for the Year 1943.

Table with columns: IN WHOSE NAME ASSESSED, TO WHOM TRANSFERRED, DESCRIPTION OF PROPERTY, ASSESSOR'S VALUATION, EQUALIZED VALUES, VALUATIONS BY SCHOOL DISTRICTS AS EQUALIZED BY DEPARTMENT OF TAXATION, Rate and Tax Less Homestead Exemption, State Tax on Non-Homestead, TOTAL GENERAL TAX, SPECIAL TAXES, TOTAL TAXES, PAID, WHEN PAID, Number of Receipt, March Settlement 1944, June Settlement 1944, Penalty, November Settlement 1944, Penalty, Collections to First Monday in January 1945, Penalty, Delinquent on First Monday in January 1945, Total Delinquent Tax and Penalty, REMARKS.

Assessment Roll and Tax List of Unplatted Real Property in the _____ of _____, Unplatted Real Estate Assessed at 33 1/2 Per Cent of True and Full Value; Attached Machinery at 33 1/2 Per Cent of True and Full Value, Homesteads, up to True and Full Value of \$4000, Assessable at 20 per Cent, Class 3B; Remainder at 33 1/2 Per Cent, Class 3.

Cass County, Minnesota, for Taxes for the Year 1943.

Table with multiple columns: IN WHOSE NAME ASSESSED, TO WHOM TRANSFERRED, DESCRIPTION OF PROPERTY, ASSESSOR'S VALUATION, EQUALIZED VALUES, VALUATIONS BY SCHOOL DISTRICTS AS EQUALIZED BY DEPARTMENT OF TAXATION, RISE AND TAX LESS HOMESTEAD EXEMPTION, STATE TAX ON NON-HOMESTEAD, TOTAL GENERAL TAX, SPECIAL TAXES, PAID, WHEN PAID, Number of Receipt, March Settlement 1944, June Settlement 1944, November Settlement 1944, Collections to First Monday in January 1945, Delinquent on First Monday in January 1945, Total Delinquent Tax and Penalty, REMARKS.

Mark L. Burns
Carl Gehrke
Mark L. Burns
" 1 1/2 of SE 1/4 less 10 acres to Cass Lake Cemetery

State of Minnesota
Land to L.C. Kirkpatrick and Sarah E. Kirkpatrick
9 SE 1/4 of NW 1/4

Mark L. Burns
State of Minnesota
E.E. + Alice Grandy
State of Minnesota

SOLD FOR TAXES

SOLD FOR TAXES

71 1/2
1036

13634 358

13992

Harding-Jordan's Add'n. 7-11
Supp. List of Bu-5-70-
Meiling Beach

IN WHOSE NAME ASSESSED

TO WHOM TRANSFERRED

DESCRIPTION OF PROPERTY

SUBDIVISION

Sec. or Lot
 Town or Block
 Range
 Number of Acres of Land
 Acres 100ths

No. School District

Indicate Homestead

ASSESSOR'S VALUATION

True and Full Value of Lands Exclusive of Structures and Improvements
 Structures & Improvements
 True and Full Value of Buildings and Other Structures
 True and Full Value of Machinery Permanently Attached to Real Estate

Total True and Full Value of Lands Including all Structures, Improvements and Machinery

Assessed Value of Homesteads up to \$4,000 at 20 per cent Class 3B

Assessed Value of Remainder at 33 1/3 per cent Class 3

Total Assessed Value of Lands Including all Structures, Improvements and Machinery

Total Assessed Value as Equalized by the Board of Review

Total Assessed Value as Equalized by the County Board

Total Assessed Value as Equalized by the Department of Taxation

SOLD FOR TAXES

VALUATIONS BY SCHOOL DISTRICTS AS EQUALIZED BY DEPARTMENT OF TAXATION

District No. Rate
 District No. Rate
 District No. Rate
 District No. Rate

Rate and Tax Less Homestead Exemption

State Tax on Non-Homestead

TOTAL GENERAL TAX

SPECIAL TAXES

TOTAL TAXES

PAID

WHEN PAID

Number of Receipt

March Settlement 1944

June Settlement 1944

Penalty

November Settlement 1944

Penalty

Collections to First Monday in January 1945

Penalty

Delinquent on First Monday in January 1945

Total Delinquent Tax and Penalty

REMARKS

Village of Cass Lake

Exempt

15 145 31

3

1
2
3
4
5
6
7
8
9
10
11
12
13
14
15
16
17
18
19
20

NE 1/4 of NE 1/4
 NW 1/4 of NE 1/4
 SW 1/4 of NE 1/4
 SE 1/4 of NE 1/4
 NE 1/4 of NW 1/4
 NW 1/4 of NW 1/4
 SW 1/4 of NW 1/4
 SE 1/4 of NW 1/4
 NE 1/4 of SW 1/4
 NW 1/4 of SW 1/4
 SW 1/4 of SW 1/4
 SE 1/4 of SW 1/4
 NE 1/4 of SE 1/4
 NW 1/4 of SE 1/4
 SW 1/4 of SE 1/4
 SE 1/4 of SE 1/4

1
2
3
4
5
6
7
8
9
10
11
12
13
14
15
16
17
18
19
20

1
2
3
4
5
6
7
8
9
10
11
12
13
14
15
16
17
18
19
20

Hardings-Jordan, Add'l, No. 1, P. 1 of 2, 1943-44

Table with columns: IN WHOSE NAME ASSESSED, TO WHOM TRANSFERRED, DESCRIPTION OF PROPERTY, ASSESSOR'S VALUATION, EQUALIZED VALUES, VALUATIONS BY SCHOOL DISTRICTS AS EQUALIZED BY DEPARTMENT OF TAXATION, Rate and Tax Less Homestead Exemption, State Tax on Non-Homestead, TOTAL GENERAL TAX, SPECIAL TAXES, TOTAL TAXES, PAID, WHEN PAID, Number of Receipt, March Settlement 1944, June Settlement 1944, Penalty, November Settlement 1944, Penalty, Collections to First Monday in January 1945, Penalty, Delinquent on First Monday in January 1945, Total Delinquent Tax and Penalty, REMARKS.

U. S. of America
Olanna Collins
U. S. of America
Floyd Baird & Dagmar L. Baird
Cass Lake Golf Club
First Nat'l. Bk., Cass Lake
Frank L. Bennett
Cass Lake Golf Club
Fred F. De Witt
Charlie Lang
H.C. Logenbacher
Lorkel & Stella Hatland
Norm A. Clark
Charlie Lang
L. Edith K. Gordon
State of Minnesota
A.F. Atner
H.H. Turner
Charles Swanson

DESCRIPTION OF PROPERTY
Sec. Town or Range Lot Block
Number of Acres of Land
No. School District
Indicate Homestead
True and Full Value of Land Exclusive of Structures and Improvements
STRUCTURES & IMPROVEMENTS
True and Full Value of Buildings and Other Structures
True and Full Value of Machinery Permanently Attached to Real Estate
Total True and Full Value of Land Including all Structures, Improvements and Machinery
Assessed Value of Homesteads up to \$4,000 at 20 per cent Class 3B
Assessed Value of Remainder at 35 per cent Class 3
Total Assessed Value of Land Including all Structures, Improvements and Machinery
Total Assessed Value as Equalized by the Board of Review
Total Assessed Value as Equalized by the County Board
Total Assessed Value as Equalized by the Department of Taxation
SOLD FOR TAXES

VALUATIONS BY SCHOOL DISTRICTS AS EQUALIZED BY DEPARTMENT OF TAXATION
District No.
District No.
District No.
District No.
Rate and Tax Less Homestead Exemption
State Tax on Non-Homestead
TOTAL GENERAL TAX
SPECIAL TAXES
TOTAL TAXES
PAID
WHEN PAID
Number of Receipt
March Settlement 1944
June Settlement 1944
Penalty
November Settlement 1944
Penalty
Collections to First Monday in January 1945
Penalty
Delinquent on First Monday in January 1945
Total Delinquent Tax and Penalty
REMARKS

SW $\frac{1}{4}$ of SE $\frac{1}{4}$

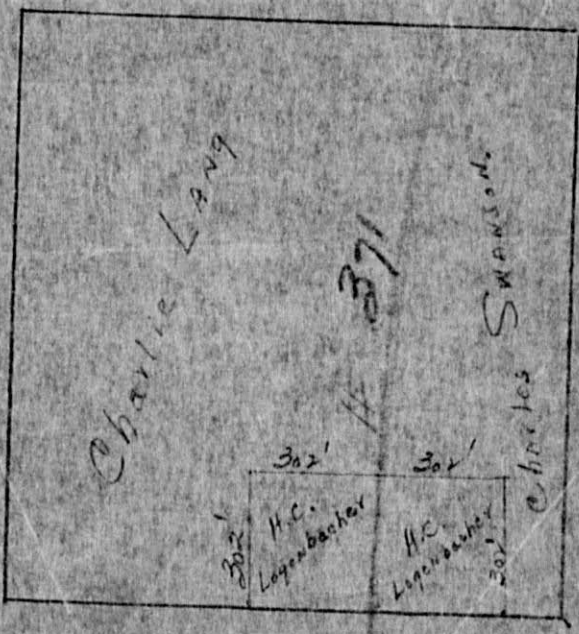

H.C.

Assessment Roll and Tax List of Unplatted Real Property in the _____ of _____

Cass County, Minnesota, for Taxes for the Year 1943.

Table with columns: IN WHOSE NAME ASSESSED, TO WHOM TRANSFERRED, DESCRIPTION OF PROPERTY, ASSESSOR'S VALUATION, EQUALIZED VALUES, VALUATIONS BY SCHOOL DISTRICTS AS EQUALIZED BY DEPARTMENT OF TAXATION, Rate and Tax Less Homestead Exemption, State Tax on Non-Homestead, TOTAL GENERAL TAX, SPECIAL TAXES, TOTAL TAXES, PAID, WHEN PAID, Number of Receipt, March Settlement 1944, June Settlement 1944, Penalty, November Settlement 1944, Penalty, Collections to First Monday in January 1945, Penalty, Delinquent on First Monday in January 1945, Total Delinquent Tax and Penalty, REMARKS.

Vertical text on the right edge: Harding-Jordahl Add'n. Dup. Int of pg. 5-7-70- We-Ming Beach

Assessment Roll and Tax List of Unplatted Real Property in the Unplatted Real Estate Assessed at 33 1/2 Per Cent of True and Full Value; Attached Machinery at 33 1/2 Per Cent of True and Full Value. Homesteads, up to True and Full Value of \$1000, Assessable at 20 per Cent, Class 3B; Remainder at 33 1/2 Per Cent, Class 3.

Cass County, Minnesota, for Taxes for the Year 1943.

Table with columns: IN WHOSE NAME ASSESSED, TO WHOM TRANSFERRED, DESCRIPTION OF PROPERTY, ASSESSOR'S VALUATION, EQUALIZED VALUES, VALUATIONS BY SCHOOL DISTRICTS AS EQUALIZED BY DEPARTMENT OF TAXATION, Rate and Tax Less Homestead Exemption, State Tax on Non-Homestead, TOTAL GENERAL TAX, SPECIAL TAXES, TOTAL TAXES, PAID, WHEN PAID, Number of Receipt, March Settlement 1944, June Settlement 1944, November Settlement 1944, Collections to First Monday in January 1945, Delinquent on First Monday in January 1945, Total Delinquent Tax and Penalty, REMARKS.

H. N. Harding
State of Minnesota (Cont. to Mrs. Emma Helsten) Defunct

State of Minnesota ("Hm. Jager")
State of Minnesota ("Swan Anderson")

State of Minnesota (Cont. to Paul Helsten)
State of Minnesota ("Harry O. Hildreth")
State of Minnesota ("Walter Anderson")

State of Minnesota (Cont. to Hm. Jager)

Emil Erlandson
Albert G. He, Adm. H. G. Knopf, Ex.

Ernest Flemming
Emil Erlandson

"

"

"

REMARKS
PAID IN FULL OCT 18 1944
PAID IN FULL SEP 27 1944
PAID IN FULL OCT 18 1944
2nd Half Paid NOV 9 1944
1st Half Paid JAN 27 1944
2nd Half Paid NOV 9 1944
1st Half Paid JAN 27 1944
2nd Half Paid NOV 9 1944
1st Half Paid JAN 27 1944
Refund W# 75162 #16.37 7-6-44
Penalty and 4.54 Abated
6.96 "
5.82 "
908
1231
1231
1830

Assessment Roll and Tax List of Unplatted Real Property in the of Cass County, Minnesota, for Taxes for the Year 1943.

FORM 4 CD WALKER-BAYNE COMPANY, MINNEAPOLIS

Table with columns: IN WHOSE NAME ASSESSED, TO WHOM TRANSFERRED, DESCRIPTION OF PROPERTY, ASSESSOR'S VALUATION, EQUALIZED VALUES, VALUATIONS BY SCHOOL DISTRICTS AS EQUALIZED BY DEPARTMENT OF TAXATION, SPECIAL TAXES, PAID, WHEN PAID, Number of Receipt, March Settlement, June Settlement, November Settlement, Collections to First Monday in January, Delinquent on First Monday in January, Total Delinquent Tax and Penalty, REMARKS.

Emma Mullen

State of Minnesota (Cont. to Cecil A. Richards) - Marion Richards

Geo. Farley

State of Minnesota (Cont. to Harold Russell)

State of Minnesota (" - Geo. T. Russell)

Peter Duncan

11.62 abated

7984

Assessment Roll and Tax List of Unplatted Real Property in the of Cass County, Minnesota, for Taxes for the Year 1943.

Cass County, Minnesota, for Taxes for the Year 1943.

Table with columns: IN WHOSE NAME ASSESSED, TO WHOM TRANSFERRED, DESCRIPTION OF PROPERTY, ASSESSOR'S VALUATION, EQUALIZED VALUES, VALUATIONS BY SCHOOL DISTRICTS AS EQUALIZED BY DEPARTMENT OF TAXATION, Rate and Tax Less Homestead Exemption, State Tax on Non-Homestead, TOTAL GENERAL TAX, SPECIAL TAXES, TOTAL TAXES, PAID, WHEN PAID, Number of Receipt, March Settlement 1944, June Settlement 1944, Penalty, November Settlement 1944, Collections to First Monday in January 1945, Delinquent on First Monday in January 1945, Total Delinquent Tax and Penalty, REMARKS.

Assessment Roll and Tax List of Unplatted Real Property in the of Cass County, Minnesota, for Taxes for the Year 1943.

FORM 4 CD MILLER-DAY COMPANY, MINNEAPOLIS

Table with columns for property details (IN WHOSE NAME ASSESSED, TO WHOM TRANSFERRED, SUBDIVISION, etc.), valuation (ASSESSOR'S VALUATION, EQUALIZED VALUES), taxes (VALUATIONS BY SCHOOL DISTRICTS AS EQUALIZED BY DEPARTMENT OF TAXATION, Rate and Tax Less Homestead Exemption, State Tax on Non-Homestead), and payment status (TOTAL TAXES, PAID, WHEN PAID, etc.).

Table with columns: IN WHOSE NAME ASSESSED, TO WHOM TRANSFERRED, DESCRIPTION OF PROPERTY, ASSESSOR'S VALUATION, EQUALIZED VALUES, VALUATIONS BY SCHOOL DISTRICTS AS EQUALIZED BY DEPARTMENT OF TAXATION, SPECIAL TAXES, PAID, WHEN PAID, Number of Receipt, March Settlement 1944, June Settlement 1944, November Settlement 1944, Collections to First Monday in January 1945, Delinquent on First Monday in January 1945, Total Delinquent Tax and Penalty, REMARKS.

Vertical text on the right edge of the page, including 'Harding-Jonahni Ad' and 'Bupp. List of Aug 5-20-40'.

Assessment Roll and Tax List of Platted Real Property in the of Cass County, Minnesota, for Taxes for the Year 1943.

Table with columns: IN WHOSE NAME ASSESSED, TO WHOM TRANSFERRED, DESCRIPTION OF PROPERTY, ASSESSOR'S VALUATION, EQUALIZED VALUES, VALUATIONS BY SCHOOL DISTRICTS AS EQUALIZED BY DEPARTMENT OF TAXATION, SPECIAL TAXES, PAID, WHEN PAID, Number of Receipt, March Settlement 1944, June Settlement 1944, November Settlement 1944, Collections to First Monday in January 1945, Delinquent on First Monday in January 1945, Total Delinquent Tax and Penalty, REMARKS.

Harding-Jondahl Ad'n.

Supp. List of Aug-5-40-Neering Beach

Assessment Roll and Tax List of Platted Real Property in the of Cass County, Minnesota, for Taxes for the Year 1943.

Form 5 C

Table with columns: IN WHOSE NAME ASSESSED, TO WHOM TRANSFERRED, DESCRIPTION OF PROPERTY, ASSESSOR'S VALUATION, EQUALIZED VALUES, VALUATIONS BY SCHOOL DISTRICTS AS EQUALIZED BY DEPARTMENT OF TAXATION, Rate and Tax Less Homestead Exemption, State Tax on Non-Homestead, TOTAL GENERAL TAX, SPECIAL TAXES, TOTAL TAXES, PAID, WHEN PAID, Number of Receipt, March Settlement 1944, June Settlement 1944, November Settlement 1944, Collections to First Monday in January 1945, Delinquent on First Monday in January 1945, Total Delinquent Tax and Penalty, REMARKS.

Nels O. Helland
Otto Norenberg
Constantine Norenberg
Elmer Kallestrom
Joseph Murkowski + Perlander Nelson
Mrs. A. Clark
W. A. Rogers
E. M. Pedrahn + Walter + June Gertgen
Nels O. Helland
Ray Train
W. A. Rogers
Harry Bates
Edward G. + Nettie Bruch.

Harding-Gondahl Addition
Lot Block
1 a
2
3
4
5
6 E 1/4 of
7 W 1/2 of Lot 6 + all
8 75 x 150' in SW cor. of
9
10
11 B
12
13
14
15 less 53.3' x 175' in 718 cor. less S 1/2 of E 1/4 125 ft.
16 S 1/4 of E 1/4 125 ft.
17 6' less to 68.11' of S. 213
18 Bal. of
19 S 1/2 of
20 S 1/2 of
6. 68.11' of S 213' of

SOLD FOR TAXES

898
496
1394
2044
210
2065

Supp. Int. of 54-5-70-1 We-Ming Beach

Assessment Roll and Tax List of Platted Real Property in the of Cass County, Minnesota, for Taxes for the Year 1943.

Form 5 C. H. L. & S. CO., ST. LOUIS, MISSOURI

Table with columns: IN WHOSE NAME ASSESSED, TO WHOM TRANSFERRED, DESCRIPTION OF PROPERTY, ASSESSOR'S VALUATION, EQUALIZED VALUES, VALUATIONS BY SCHOOL DISTRICTS AS EQUALIZED BY DEPARTMENT OF TAXATION, SPECIAL TAXES, TOTAL TAXES, PAID, WHEN PAID, Number of Receipt, March Settlement 1944, June Settlement 1944, Penalty, November Settlement 1944, Penalty, Collections to First Monday in January 1945, Penalty, Delinquent on First Monday in January 1945, Total Delinquent Tax and Penalty, REMARKS.

