

ASSESSMENT & TAX LIST - 1956

Pike Bay

INDEX TO SECTIONS

SECTION	PAGE
Sec. 1	
" 2	
" 3	
" 4	
" 5	
" 6	
" 7	
" 8	
" 9	
" 10	
" 11	
" 12	
" 13	
" 14	
" 15	
" 16	
" 17	
" 18	
" 19	
" 20	
" 21	
" 22	
" 23	
" 24	
" 25	
" 26	
" 27	
" 28	
" 29	
" 30	
" 31	
" 32	
" 33	
" 34	
" 35	
" 36	

For Convenience of Auditor in Showing Boundaries of School Districts

Township No. 145 Range No. 31 Mer. P. M.

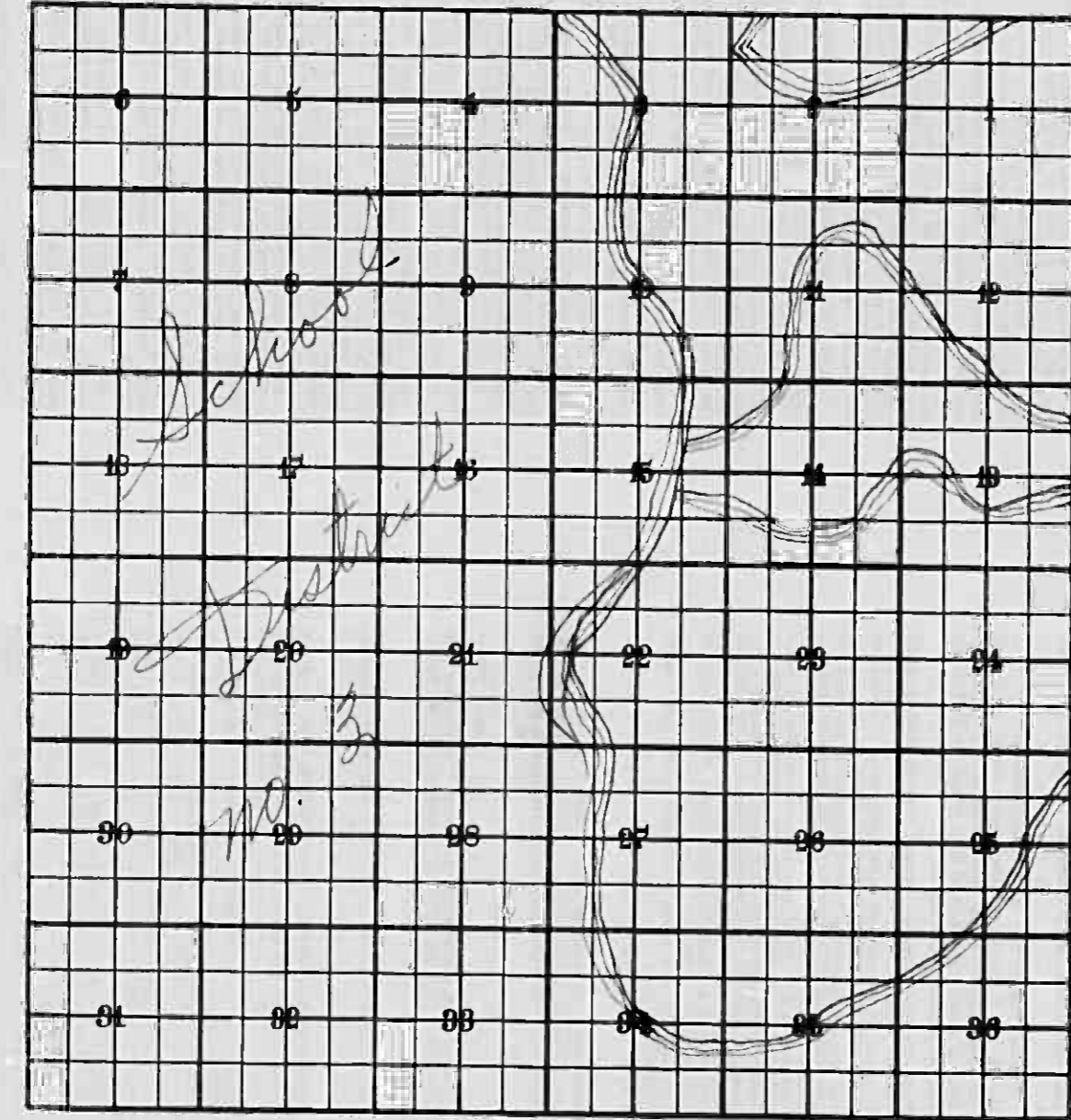

All School Dist. No. 3 as of 8.2.52

Returns Showing Grain Received in or Handled by Elevators, Warehouses and Mills in the _____ of _____ in the _____ for the Year Ending May 1, 1956.

NAMES OF OWNERS	ADDRESS	Bushels of Wheat	Bushels of Soy Beans	Bushels of Flax	Total No. of Bushels of Wheat, Soy Beans and Flax	★ Tax of 1/2 Mill per Bushel		Bushels of Corn	Bushels of Barley	Bushels of Rye	Bushels of Oats	Bushels of Buckwheat	Bushels of all Other Grains	Total No. Bushels of Corn, Barley, Rye, Oats, Buckwheat and all Other Grains	★ Tax of 1/2 Mill Per Bushel		★ Total Tax		REMARKS	
						Dollars	Cts.								Dollars	Cts.	Dollars	Cts.		

Note ★ Assessors will not fill these columns

Assessor's Return

NAMES OF OWNERS

#1. Sec. 9-10-11-12-13-15-16-17-18-19-20-21-27-28-29-30-31-32-33-34
 Harding Jurdahl - bug. E. and all P.P.
 #2. Sec. 2-3-4-5-6-7-8 + 14 1 ak Nang.

TABULAR SCHEDULE OF VALUATIONS,

LEVIED IN THE Town OF Pike Bay

School District No.	VALUATION BY SCHOOL DISTRICTS				RATE OF STATE TAXES	RATE OF COUNTY TAXES										RATE OF TOWN TAXES										RATE OF
	Agri-cultural Lands	Non-Agri-cultural Lands	Personal Property	Total Value of all Property except Money and Credits		Ref.	R. & B.	Welfare	Bonds and Int.	R. & B. Co.	Total Rate of County Tax	Ref.	R. & B.	Drag Tax	State Loan	Total Rate of Town Tax	Local	Special	State Loan	Deficiency	Tuition	Transportation	C.O. Bond			
1. 3	17,303	14,879	80,898	118,133	3.81	27.08	14.18	47.70	7.74	2.00	15	106.42	2.26	1.9	1	57	5.73	1.25	14	30	.73	10	5			
2. 3	8752	5637		14,389				7.22	wellfare Def																	
				132,522																						
					N.H. 5.34																					
					9.15																					
Assessed Value																										
Homestead				16,492	7316	23,808																				
Non-Homestead				14,207	8556	85,951	108,714																			
Total				30,699	15,872	85,951	132,522																			

RATES AND TAXES

COUNTY OF CASS, STATE OF MINNESOTA

SCHOOL TAXES			LOCAL 1 MILL AND SPECIAL SCHOOL TAXES BY DISTRICTS										ALL OTHER TAXES		
Total Rate of Sch'l Tax	Total Rate of all Taxes		Local 1 Mill	Special	State Loan	Def. Jang.	C.O. Bond	Total School Taxes	FUNDS	Rate	Amounts				
85.73	201.69		1.25	14	30	.73	10	5	State - Non-Homestead		591.06				
110.73	226.69		1.50	14	30	.73	10	5	State - Homestead		504.91				
71.73	187.69		1.25		30	.73	10	5	County Revenue		3588.58				
96.73	212.69		1.50		30	.73	10	5	County Road and Bridge		1879.16				
									County Welfare		6321.80				
									Bonds and Interest		1025.72				
									R. & B. Bldg.		265.04				
									Law Co. Ag. Assn.		66.26				
									Wellfare Deficiency		956.81				
									Town Revenue		299.50				
									Town Road and Bridge		207.79				
									Town Drag		132.52				
									Town State Loan		75.54				
									Fire		757.35				
									School Local 1 Mill		132.53				
									School Special		5848.40				
									School State Loan		1653.86				
									Deficiency		3975.66				
									Tuition		96.73				
									Transportation		1325.22				
									Capital Outlay		662.61				
									Bond & Int.		13,695.01				

Total Levy, \$29,633.20

Total Number of Acres 9272.01

I, L. C. Peterson, Auditor of said County and State aforesaid, do hereby certify that the foregoing is a true and correct Schedule, showing the valuation of all the taxable property, in the Town of Pike Bay, in said County, the several rates of Taxation and Totals of the several Tax Funds levied thereon for the year A. D. 1956.

Witness my hand and official seal, this 5th day of December, A. D. 1956.

L. C. Peterson County Auditor.
By Helen Belter Deputy

Total Taxes Real Estate 9816.38
 Pers. Prop. 19816.82
 Total 29633.20



Real Estate

Do-Ming Point
 Harding Jurdahl
 State of Minnesota
 Auditor's Plat #3

Assessor's Return

COLLECTIONS OF TAXES OF 1956 OF Town OF Pike Bay, CASS COUNTY, MINNESOTA

FUNDS	MARCH SETTLEMENT	JUNE SETTLEMENT	NOV. SETTLEMENT	Amount Collected from Nov. 1955 to First Monday in Jan. 1956	REDUCTIONS	Total Reductions and Collected	BALANCE UNCOLLECTED	ADDITIONS	Total Uncollected to First Monday in January, 1956
	1957	1957	1957						
State-Non-Homestead	411 58	65 58	52 88	5 85					
State-Homestead	296 66	88 77	67 04	6 80					
County Revenue	2108 59	702 04	490 72	41 24					
County Road and Bridge	1104 13	367 62	256 96	21 59					
County Welfare	3714 17	1236 62	864 38	72 64					
County Bond and Interest	602 67	200 66	140 26	11 79					
R + B. Aids	155 73	51 85	36 24	3 65					
Cass Co. Agri.	38 93	12 97	30 83	7 6					
Welfare Def.	562 18	187 18	9 07	10 99					
Town Revenue	175 97	58 59	40 95	3 44					
Town Road and Bridge	147 94	49 26	34 43	2 89					
Town Drag	77 87	25 92	18 13	1 52					
Town State Loan									
Tire	44 38	14 78	10 33	8 8					
School Local 1 Mill	7787	2572	1813	158					
School Special	382542	96848	65876	6091					
School State Loan	108906	26330	20548	1321					
Deficiency	233595	77775	54363	4569					
Tuition									
Transportation	5684	1874	1325	112					
C.O.	77867	25925	18120	1523					
B.+D.	38934	12961	9060	627					
TOTALS	1799395	551509	386527	32337					

	LOCAL 1 MILL	SPECIAL	STATE LOAN	Deficiency	Transp.	C.O.	B.+D.	TOTALS	
MARCH SETTLEMENT	School District No. #13A	264	6598	3694	7917	193	2639	1321	22626
	#137A	7515	375760	105212	225456	5486	75153	37576	832158
	#23A	08	184		222	05	75	37	531
	Totals	7787	382542	108906	233595	5684	22867	38934	855315
JUNE SETTLEMENT	School District No. #13A	863	21577	12094	15917	632	8637	4319	74061
	#137A	1018	50843	14236	30505	742	10168	5085	116597
	#23A	447	11179		13414	327	4472	2235	32074
	#237A	264	13229		7739	193	2646	1322	25593
Totals	2592	96848	26330	77775	1874	25925	12961	244325	
NOVEMBER SETTLEMENT	School District No. #1-3A	796	19911	11150	23873	571	7964	3983	68278
	#1-37A	672	33567	9398	20141	491	6713	3356	74338
	#2-3A	193	4879		5792	142	1927	964	13827
	#2-37A	152	7577		4547	111	1516	757	14662
Totals	1813	65876	20548	54363	1325	18120	9060	171105	
NOVEMBER to JANUARY	School District No. #1-3A	34	853	479	1026	25	342	171	2932
	#1-37A	27	1456	408	873	21	292	146	3223
	#2-3A	35	468	134	802	21	267	197	1917
	#2-37A	64	3112		1967	45	622	310	6021
Totals	150	6091	1021	4569	112	1523	627	14093	
ADDITIONS	School District No.								
Totals									
REDUCTIONS	School District No.								
Totals									

Real Estate

Assessor's Return
 Additions
 Real Estate
 Assessor's Return
 Additions
 Real Estate

Assessment Roll and Tax List of Real Property in the Town of Pike Bay

Indicate Type of Property: R-Residential, C-Commercial, I-Industrial, U-Utility, F-Farm, L-Lakeshore, T-Timber, M-Mineral

Cass County, Minnesota, for Taxes for the Year 1956

Table with columns: IN WHOSE NAME ASSESSED, TO WHOM TRANSFERRED, DESCRIPTION OF PROPERTY, TRUE AND FULL VALUATIONS, ASSESSED VALUATIONS (RURAL, ALL OTHER), VALUATIONS BY SCHOOL DISTRICTS AS EQUALIZED BY DEPARTMENT OF TAXATION, TAXES, PAID, WHEN PAID, Number of Receipt, Settlement dates, Penalties, Delinquent dates, Total Delinquent Tax and Penalty, REMARKS.

14531

Lot 1 Platted "Ahnung Point" (see Suburb)

Assessing Point, Boundary, Addition, etc.

Assessment Roll and Tax List of Real Property in the Town of Pike Bay

Cass County, Minnesota, for Taxes for the Year 1956

Indicate Type of Property: R-Residential, C-Commercial, I-Industrial, U-Utility, F-Farm, L-Lakeshore, T-Timber, M-Mineral

Table with columns: IN WHOSE NAME ASSESSED, TO WHOM TRANSFERRED, DESCRIPTION OF PROPERTY, TRUE AND FULL VALUATIONS, ASSESSED VALUATIONS, VALUATIONS BY SCHOOL DISTRICTS AS EQUALIZED BY DEPARTMENT OF TAXATION, TAXES, PAID, WHEN PAID, Number of Receipt, March Settlement 1957, June Settlement 1957, November Settlement 1957, Collections to First Monday in January 1958, Delinquent on First Monday in January 1958, Total Delinquent Tax and Penalty, REMARKS.

Assessment Roll and Tax List of Real Property in the Town of Pike Bay

Cass County, Minnesota, for Taxes for the Year 1956.

Indicate Type of Property: R-Residential, C-Commercial, I-Industrial, U-Utility, F-Farm, L-Lakeshore, T-Timber, M-Mineral

Table with columns: IN WHOSE NAME ASSESSED, TO WHOM TRANSFERRED, DESCRIPTION OF PROPERTY, TRUE AND FULL VALUATIONS, ASSESSED VALUATIONS, VALUATIONS BY SCHOOL DISTRICTS AS EQUALIZED BY DEPARTMENT OF TAXATION, TAXES, PAID, WHEN PAID, Number of Receipt, March Settlement, June Settlement, November Settlement, Collections to First Monday in January 1958, Delinquent on First Monday in January 1958, Total Delinquent Tax and Penalty, REMARKS.

Ap-Nung Point, Harding-Jordan, Address, 1956-57, Plat #3

Assessment Roll and Tax List of Real Property in the Town of Lake Park

Cass County, Minnesota, for Taxes for the Year 1956.

Table with columns: IN WHOSE NAME ASSESSED, TO WHOM TRANSFERRED, DESCRIPTION OF PROPERTY, TRUE AND FULL VALUATIONS, ASSESSED VALUATIONS, VALUATIONS BY SCHOOL DISTRICTS AS EQUALIZED BY DEPARTMENT OF TAXATION, SOLD FOR TAXES, SPECIAL TAXES, TOTAL TAXES, PAID, WHEN PAID, Number of Receipt, March Settlement 1957, June Settlement 1957, Penalty, November Settlement 1957, Penalty, Collections to First Monday in January 1958, Penalty, Delinquent on First Monday in January 1958, Total Delinquent Tax and Penalty, REMARKS.

Assessment Roll and Tax List of Real Property in the Town of Lake Park

Indicate Type of Property: R-Residential, C-Commercial, I-Industrial, U-Utility, F-Farm, L-Lakeshore, T-Timber, M-Minery

Cass County, Minnesota, for Taxes for the Year 1956.

Table with columns: IN WHOSE NAME ASSESSED, TO WHOM TRANSFERRED, DESCRIPTION OF PROPERTY, TRUE AND FULL VALUATIONS, ASSESSED VALUATIONS, VALUATIONS BY SCHOOL DISTRICTS AS EQUALIZED BY DEPARTMENT OF TAXATION, TAXES, PAID, WHEN PAID, Number of Receipt, March Settlement 1957, June Settlement 1957, November Settlement 1957, Penalty, Collections to First Monday in January 1958, Delinquent on First Monday in January 1958, Total Delinquent Tax and Penalty, REMARKS.

continued on next page

penalty 2.22

Point Harding - Condonah! Supplemental Plat Book Plat No. 43

Assessment Roll and Tax List of Real Property in the Town of Pike Bay

Indicate Type of Property: R-Residential, C-Commercial, I-Industrial, U-Utility, F-Farm, L-Lakeshore, T-Timber, M-Mineral

Table with columns: IN WHOSE NAME ASSESSED, TO WHOM TRANSFERRED, DESCRIPTION OF PROPERTY, TRUE AND FULL VALUATIONS (RURAL, ALL OTHER, TOTAL ASSESSED VALUE), and FINAL EQUALIZED VALUE. Includes handwritten entries for various property owners like Kenneth Burns and Frank Gehke.

Cass County, Minnesota, for Taxes for the Year 1956.

Table with columns: VALUATIONS BY SCHOOL DISTRICTS AS EQUALIZED BY DEPARTMENT OF TAXATION, TAX INCLUDES STATE HOMESTEAD, SPECIAL TAXES, TOTAL TAXES, PAID, WHEN PAID, Number of Receipt, March Settlement 1957, June Settlement 1957, November Settlement 1957, Collections to First Monday in January 1958, Delinquent on First Monday in January 1958, Total Delinquent Tax and Penalty, REMARKS. Includes handwritten tax payment records.

Assessment Roll and Tax List of Real Property in the Town of Pike Bay

Cass County, Minnesota, for Taxes for the Year 1956.

* Indicate Type of Property: R-Residential, C-Commercial, I-Industrial, U-Utility, F-Farm, L-Lakeshore, T-Timber, M-Mineral

IN WHOSE NAME ASSESSED	TO WHOM TRANSFERRED	DESCRIPTION OF PROPERTY				No. School District	Indicate Homestead Tax No	Indicate Agricultural Property No	Indicate Type of Property	TRUE AND FULL VALUATIONS			ASSESSED VALUATIONS						SOLD FOR TAXES	VALUATIONS BY SCHOOL DISTRICTS AS EQUALIZED BY DEPARTMENT OF TAXATION						PAID	WHEN PAID	Number of Receipt	March Settlement 1957	June Settlement 1957	Penalty	November Settlement 1957	Penalty	Collections to First Monday in January 1958	Penalty	Delinquent on First Monday in January 1958	Total Delinquent Tax and Penalty	REMARKS			
		SUBDIVISION	Sec. of Lot	Town or Block	Reg.					Number of Acres of Land	LAND Exclusive of Structures and Improvements	BUILDINGS and Other Structures	MACHINERY Permanently Attached to Real Estate	TOTAL True and Full Value	Homestead Up to \$1,000 20%	RURAL Over \$1,000 and Non-Homestead 33 1/3%	Timber Land Class 3e 20%	ALL OTHER Homestead Up to \$1,000 25%		Over \$1,000 and Non-Homestead 40%	MACHINERY Permanently Attached to Real Estate 33 1/3%	TOTAL ASSESSED VALUE	Total Assessed Value as Equalized by the Board of Review	FINAL EQUALIZED VALUE	District No.														District No.	District No.	District No.
Philip M & Helen A. Larson		1144	SE 1/4	1144	10	3	40	40	R	200	1000	1200	240		240																										
Clyde & Shirley Connor		854	NE 1/4	1144	10	4	40	T	180	600	780	156		156																											
Paul D. Smith		SW 1/4	NE 1/4	1144																																					
		SE 1/4	of NW 1/4																																						
		NW 1/4	of NW 1/4																																						
		SW 1/4	of NW 1/4																																						
		SE 1/4	of NW 1/4																																						
		NW 1/4	of SW 1/4																																						
		SW 1/4	of SW 1/4																																						
		SE 1/4	of SW 1/4																																						
		NW 1/4	of SE 1/4																																						
		SW 1/4	of SE 1/4																																						
		SE 1/4	of SE 1/4																																						
					10					880	1600	1780	396		396																										

John Harding - Jondahl
Accounting - Jondahl
Bump - Jondahl
Patterson - Jondahl
Pat #3

Assessment Roll and Tax List of Real Property in the Town of Pelle Bay

* Indicate Type of Property: R-Residential, C-Commercial, I-Industrial, U-Utility, F-Farm, L-Lakeshore, T-Timber, M-Mineral

Cass County, Minnesota, for Taxes for the Year 1956.

IN WHOSE NAME ASSESSED	TO WHOM TRANSFERRED	DESCRIPTION OF PROPERTY							TRUE AND FULL VALUATIONS								SOLD FOR TAXES		VALUATIONS BY SCHOOL DISTRICTS AS EQUALIZED BY DEPARTMENT OF TAXATION						PAID	WHEN PAID	Number of Receipt	March Settlement 1957	June Settlement 1957	Penalty	November Settlement 1957	Penalty	Collections to First Monday in January 1958	Penalty	Delinquent on First Monday in January 1958	Total Delinquent Tax and Penalty	REMARKS					
		SUBDIVISION	Sec. of Lot	Town or Block	Rng.	Number of Acres of Land	No. School District	Indicate Investment Yes or No	Indicate Agricultural Yes or No	Indicate Type of Property	LAND EXCLUSIVE OF STRUCTURES AND IMPROVEMENTS	BUILDINGS AND OTHER STRUCTURES	MACHINERY PERMANENTLY ATTACHED TO REAL ESTATE	TOTAL True and Full Value	RURAL		ALL OTHER			TOTAL ASSESSED VALUE	Total Assessed Value as Equalized by the Board of Review	FINAL EQUALIZED VALUE	VALUATIONS BY SCHOOL DISTRICTS AS EQUALIZED BY DEPARTMENT OF TAXATION																			
															Homestead Up to \$4,000 20%	Over \$4,000 and Non-Homestead 33 1/3%	Timber Land Class 20%	Homestead Up to \$4,000 25%	Over \$4,000 and Non-Homestead 40%				MACHINERY Permanently Attached to Real Estate 33 1/3%	District No.														District No.	District No.	District No.	District No.	District No.
															Dollars	Dollars	Dollars	Dollars	Dollars				Dollars	Dollars														Dollars	Dollars	Dollars	Dollars	Dollars
						Acres	100ths				Dollars	Dollars	Dollars	Dollars	Dollars	Dollars	Dollars	Dollars	Dollars	Dollars	Dollars	Dollars	Dollars	Dollars														Dollars	Dollars	Dollars	Dollars	Dollars

Harding Journal Supplemental to the Harding Beach Auditor's Plat # 3

Assessment Roll and Tax List of Real Property in the Town of Lake Park of Pike County

* Indicate Type of Property: R-Residential, C-Commercial, I-Industrial, U-Utility, F-Farm, L-Lakeshore, T-Timber, M-Mineral

Cass County, Minnesota, for Taxes for the Year 1956.

IN WHOSE NAME ASSESSED	TO WHOM TRANSFERRED	DESCRIPTION OF PROPERTY				TRUE AND FULL VALUATIONS											FINAL EQUALIZED VALUE	SOLD FOR TAXES	VALUATIONS BY SCHOOL DISTRICTS AS EQUALIZED BY DEPARTMENT OF TAXATION						PAID	WHEN PAID	Number of Receipt	March Settlement 1957	June Settlement 1957	November Settlement 1957	Penalty	Collections to First Monday in January 1958	Penalty	Delinquent on First Monday in January 1958	Total Delinquent Tax and Penalty	REMARKS					
		SUBDIVISION	Town or Lot	Acres	Number of Acres of Land	TRUE AND FULL VALUATIONS			ASSESSED VALUATIONS					TOTAL ASSESSED VALUE	District	District			District	District	District	District	Rate	Rate													Rate	Rate	Rate	Rate	Rate
						LAND EXCLUSIVE OF STRUCTURES AND IMPROVEMENTS	BUILDINGS AND OTHER STRUCTURES	MACHINERY Permanently Attached to Real Estate	TOTAL True and Full Value	Homestead Up to \$4,000 20%	RURAL Over \$4,000 and Non-Homestead 33 1/3%	Timber Land Class 3e 20%	ALL OTHER Homestead Up to \$4,000 25%																												
Fred J. Gangelhoff		NE 1/4 of NE 1/4	14 145 31		40				194	808		1002							334																						
		NW 1/4 of NE 1/4		40					194	808		1002							334																						
		SW 1/4 of NE 1/4																																							
		SE 1/4 of NE 1/4																																							
		NE 1/4 of NW 1/4																																							
		NW 1/4 of NW 1/4																																							
		SW 1/4 of NW 1/4																																							
State of Minnesota		SE 1/4 of NW 1/4 <i>Set 4 less by Rev. W. G.</i>																																							
		NE 1/4 of SW 1/4																																							
		NW 1/4 of SW 1/4																																							
		SW 1/4 of SW 1/4																																							
		SE 1/4 of SW 1/4																																							
		NE 1/4 of SE 1/4																																							
		NW 1/4 of SE 1/4																																							
		SW 1/4 of SE 1/4																																							
		SE 1/4 of SE 1/4																																							
					40				194	808		1002							334																						

Harding - Judicial
 Dept. of Registration
 Plat #3

Assessment Roll and Tax List of Real Property in the Town of Lawrence of Pike County, Minnesota

Cass County, Minnesota, for Taxes for the Year 1956.

Form 300 (3-56) Indicate Type of Property: R-Residential, C-Commercial, I-Industrial, U-Utility, F-Farm, L-Lakeshore, T-Timber, M-Mineral

Table with columns: IN WHOSE NAME ASSESSED, TO WHOM TRANSFERRED, DESCRIPTION OF PROPERTY, TRUE AND FULL VALUATIONS, ASSESSED VALUATIONS, VALUATIONS BY SCHOOL DISTRICTS AS EQUALIZED BY DEPARTMENT OF TAXATION, TAXES, PAID, WHEN PAID, Number of Receipt, March Settlement 1957, June Settlement 1957, November Settlement 1957, Collections to First Monday in January 1958, Delinquent on First Monday in January 1958, Total Delinquent Tax and Penalty, REMARKS.

U. S. of America

R.W. Campbell

U. S. of America

Floyd & Dagmar L Baird

Alice L. Lundrigan

"

Ernest A. Norenberg

Alice L. Lundrigan

"

Fred A. DeWitt

Walter S & Nora O. Raines

Belva & Betty M. Ellis

Forkel & Stella Nestland

Wm. H. Clark

Walter S & Nora O. Raines

Donald J. & Isabella J. Bohm

Paul & Carol L. Huchensat

Bollanck D. & Carol Orem

Nellie E. Hough

Harding-Jordan Supplemental Plat #3

Assessment Roll and Tax List of Real Property in the Town of Pike Bay, Cass County, Minnesota, for Taxes for the Year 1956.

Table with columns: IN WHOSE NAME ASSESSED, TO WHOM TRANSFERRED, DESCRIPTION OF PROPERTY, TRUE AND FULL VALUATIONS, ASSESSED VALUATIONS, VALUATIONS BY SCHOOL DISTRICTS AS EQUALIZED BY DEPARTMENT OF TAXATION, TAXES, PAID, WHEN PAID, Number of Receipt, March Settlement 1957, June Settlement 1957, Penalty, November Settlement 1957, Penalty, Collections to First Monday in January 1958, Delinquent on First Monday in January 1958, Total Delinquent Tax and Penalty, REMARKS.

Supplemental Plat of Harding - Jondahl Addition of Harding - Jondahl - Mining Section Auditor's Plat #3

SW 1/4 of S¹ E¹ 4¹/₄
16-145-31

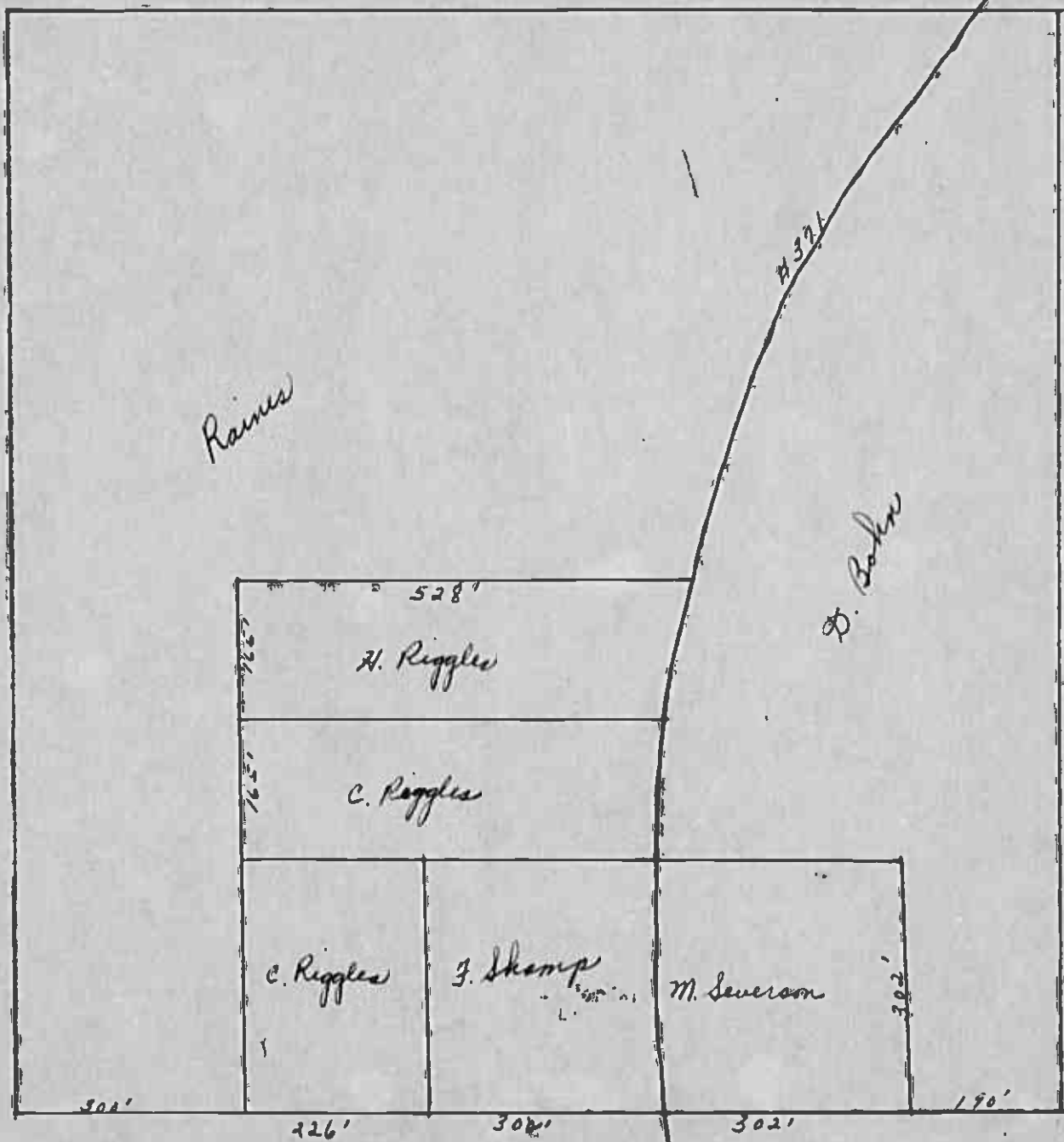

no R/W allowed

#321

Assessment Roll and Tax List of Real Property in the Town of Lake Park

Indicate Type of Property: R-Residential, C-Commercial, I-Industrial, U-Utility, F-Farm, L-Lakeshore, T-Timber, M-Mineral

Table with columns: IN WHOSE NAME ASSESSED, TO WHOM TRANSFERRED, DESCRIPTION OF PROPERTY, TRUE AND FULL VALUATIONS, ASSESSED VALUATIONS, and FINAL EQUALIZED VALUE. Includes handwritten entries for Christ Millard, Ole Hendrickson, and others.

Cass County, Minnesota, for Taxes for the Year 1956.

Table with columns: SOLD FOR TAXES, VALUATIONS BY SCHOOL DISTRICTS AS EQUALIZED BY DEPARTMENT OF TAXATION, SPECIAL TAXES, TOTAL TAXES, PAID, WHEN PAID, Number of Receipt, March Settlement 1957, June Settlement 1957, November Settlement 1957, Collections to First Monday in January 1958, Delinquent on First Monday in January 1958, Total Delinquent Tax and Penalty, and REMARKS. Includes handwritten entries for various property owners.

Handing - Ordinal, Page - Ordinal, Plat #3

Assessment Roll and Tax List of Real Property in the Town of Ripke Bay

Cass County, Minnesota, for Taxes for the Year 1956.

Form 502 (1955) MINN. STAT. ANN. § 262.01

Table with columns: IN WHOSE NAME ASSESSED, TO WHOM TRANSFERRED, DESCRIPTION OF PROPERTY, TRUE AND FULL VALUATIONS, ASSESSED VALUATIONS, VALUATIONS BY SCHOOL DISTRICTS AS EQUALIZED BY DEPARTMENT OF TAXATION, TAXES, PAID, WHEN PAID, Number of Receipt, March Settlement 1957, June Settlement 1957, November Settlement 1957, Collections to First Monday in January 1958, Delinquent on First Monday in January 1958, Total Delinquent Tax and Penalty, REMARKS.

Handwritten notes and signatures on the right margin, including 'Auditor's Plat #3' and 'Supplemental Plat #38'.

Indicate Type of Property: R-Residential, C-Commercial, I-Industrial, U-Utility, F-Farm, L-Lakeshore, T-Timber, M-Mineral

Main table with columns: IN WHOSE NAME ASSESSED, TO WHOM TRANSFERRED, DESCRIPTION OF PROPERTY, TRUE AND FULL VALUATIONS, ASSESSED VALUATIONS, VALUATIONS BY SCHOOL DISTRICTS AS EQUALIZED BY DEPARTMENT OF TAXATION, TAXES, PAID, WHEN PAID, Number of Receipt, March Settlement 1957, June Settlement 1957, November Settlement 1957, Collections to First Monday in January 1958, Delinquent on First Monday in January 1958, Total Delinquent Tax and Penalty, REMARKS.

Vertical text on the right edge: Auditor's Plat #3

Assessment Roll and Tax List of Real Property in the Town of Pike Bay

Cass County, Minnesota, for Taxes for the Year 1956.

Form 3 (12-50) Indicate Type of Property: R-Residential, C-Commercial, I-Industrial, U-Utility, F-Farm, L-Lakeshore, T-Timber, M-Mineral

Table with columns: IN WHOSE NAME ASSESSED, TO WHOM TRANSFERRED, DESCRIPTION OF PROPERTY, TRUE AND FULL VALUATIONS, ASSESSED VALUATIONS, VALUATIONS BY SCHOOL DISTRICTS AS EQUALIZED BY DEPARTMENT OF TAXATION, SOLD FOR TAXES, SPECIAL TAXES, TOTAL TAXES, PAID, WHEN PAID, Number of Receipt, March Settlement 1957, June Settlement 1957, November Settlement 1957, Collections to First Monday in January 1958, Delinquent on First Monday in January 1958, Total Delinquent Tax and Penalty, REMARKS.

Vertical text on the right edge of the page, including 'Harding-Jordan', 'Superior', 'Map', 'Plat #3'.

Indicate Type of Property: R-Residential, C-Commercial, I-Industrial, U-Utility, F-Farm, L-Lakeshore, T-Timber, M-Mineral

Table with columns: IN WHOSE NAME ASSESSED, TO WHOM TRANSFERRED, DESCRIPTION OF PROPERTY, TRUE AND FULL VALUATIONS, ASSESSED VALUATIONS, VALUATIONS BY SCHOOL DISTRICTS AS EQUALIZED BY DEPARTMENT OF TAXATION, TAXES, PAID, WHEN PAID, Number of Receipt, March Settlement 1957, June Settlement 1957, Penalty, November Settlement 1957, Penalty, Collections to First Monday in January 1958, Penalty, Delinquent on First Monday in January 1958, Total Delinquent Tax and Penalty, REMARKS.

Assessment Roll and Tax List of Real Property in the Town of Pike Lake

Cass County, Minnesota, for Taxes for the Year 1956.

Form 300-150) Indicate Type of Property: R-Residential, C-Commercial, I-Industrial, U-Utility, F-Farm, L-Lakeshore, T-Timber, M-Mineral

Table with columns: IN WHOSE NAME ASSESSED, TO WHOM TRANSFERRED, DESCRIPTION OF PROPERTY, TRUE AND FULL VALUATIONS, ASSESSED VALUATIONS, VALUATIONS BY SCHOOL DISTRICTS AS EQUALIZED BY DEPARTMENT OF TAXATION, TAXES, PAID, WHEN PAID, Number of Receipt, March Settlement 1957, June Settlement 1957, November Settlement 1957, Collections to First Monday in January 1958, Delinquent on First Monday in January 1958, Total Delinquent Tax and Penalty, REMARKS.

Vertical text on the right edge: Auditing Journal Addition, Supplemental Page 1958, Auditor's Plat #3

Assessment Roll and Tax List of Real Property in the Town of Pike Bay

Cass County, Minnesota, for Taxes for the Year 1956.

Indicate Type of Property: R-Residential, C-Commercial, L-Industrial, U-Utility, F-Farm, L-Lakeshore, T-Timber, M-Mineral

Main table with columns: IN WHOSE NAME ASSESSED, TO WHOM TRANSFERRED, DESCRIPTION OF PROPERTY, TRUE AND FULL VALUATIONS, ASSESSED VALUATIONS, VALUATIONS BY SCHOOL DISTRICTS AS EQUALIZED BY DEPARTMENT OF TAXATION, TAXES, PAID, WHEN PAID, and REMARKS.

Handwritten names: Robert J. Richards, George J. & Anna H. Russell, Guy J. & Adelheid Duncan, Peter Duncan

Handwritten numbers: 16758, 13785, 15015, 9613, 16759, 7633

Handwritten notes: Abate # 7132

Handwritten notes: 6.86 Abated, Paid Under Protest, 7.66 Abated, Paid Under Protest, 6.86 Abated, Paid Under Protest

Vertical text on the right edge: Auditor's Print #3

Indicate Type of Property: R-Residential, C-Commercial, I-Industrial, U-Utility, F-Farm, L-Lakeshore, T-Timber, M-Mineral

Main table with columns: IN WHOSE NAME ASSESSED, TO WHOM TRANSFERRED, DESCRIPTION OF PROPERTY, TRUE AND FULL VALUATIONS, ASSESSED VALUATIONS, VALUATIONS BY SCHOOL DISTRICTS AS EQUALIZED BY DEPARTMENT OF TAXATION, PAID, WHEN PAID, Number of Receipt, March Settlement 1957, June Settlement 1957, November Settlement 1957, Collections to First Monday in January 1958, Delinquent on First Monday in January 1958, Total Delinquent Tax and Penalty, REMARKS.

Earl D. + Emily Foster

Adolph + Emma Hornblad

David F. + Mary Louise, Virgil F. + Ethel M. Foster

David F. + Mary Louise, Virgil F. + Ethel M. Foster

Auditor's Plat #3

Assessment Roll and Tax List of Real Property in the Town of Pike Bay, Cass County, Minnesota

Indicate Type of Property: R-Residential, C-Commercial, I-Industrial, U-Utility, F-Farm, L-Lakeshore, T-Timber, M-Mineral

Table with columns: IN WHOSE NAME ASSESSED, TO WHOM TRANSFERRED, DESCRIPTION OF PROPERTY, TRUE AND FULL VALUATIONS, ASSESSED VALUATIONS, and FINAL EQUALIZED VALUE.

Cass County, Minnesota, for Taxes for the Year 1956.

Table with columns: SOLD FOR TAXES, VALUATIONS BY SCHOOL DISTRICTS AS EQUALIZED BY DEPARTMENT OF TAXATION, TAX INCLUDING STATE HOMESTEAD, SPECIAL TAXES, TOTAL TAXES, PAID, WHEN PAID, Number of Receipt, March Settlement 1957, June Settlement 1957, Penalty, November Settlement 1957, Penalty, Collections to First Monday in January 1958, Penalty, Delinquent on First Monday in January 1958, Total Delinquent Tax and Penalty, and REMARKS.

Vertical text on the right edge of the page, including 'Auditor's Plat #3'.

Assessment Roll and Tax List of Real Property in the Town of Pike Bay

Indicate Type of Property: R-Residential, C-Commercial, I-Industrial, U-Utility, F-Farm, L-Lakeshore, T-Timber, M-Mineral

Cass County, Minnesota, for Taxes for the Year 1956.

Table with columns: IN WHOSE NAME ASSESSED, TO WHOM TRANSFERRED, DESCRIPTION OF PROPERTY, TRUE AND FULL VALUATIONS, ASSESSED VALUATIONS, VALUATIONS BY SCHOOL DISTRICTS AS EQUALIZED BY DEPARTMENT OF TAXATION, TAXES, PAID, WHEN PAID, Number of Receipt, Merch Settlement 1957, June Settlement 1957, Penalty, November Settlement 1957, Penalty, Collections to First Monday in January 1958, Penalty, Delinquent on First Monday in January 1958, Total Delinquent Tax and Penalty, REMARKS.

Assessment Roll and Tax List of Real Property in the town of Pike Bay

* Indicate Type of Property: R-Residential, C-Commercial, I-Industrial, U-Utility, F-Farm, L-Lakeshore, T-Timber, M-Mineral

Cass County, Minnesota, for Taxes for the Year 1956.

Table with columns for property description, valuations (True and Full, Assessed), taxes (School Districts, State, Special, Total), and payment status. Includes handwritten entries for R.W. Campbell and Hilding A. Kling.

Assessment Roll and Tax List of Real Property in the Town of Pike Bay

Cass County, Minnesota, for Taxes for the Year 1956.

Indicate Type of Property: R-Residential, C-Commercial, I-Industrial, U-Utality, F-Farm, L-Lakeshore, T-Timber, M-Mineral

Table with columns: IN WHOSE NAME ASSESSED, TO WHOM TRANSFERRED, DESCRIPTION OF PROPERTY, TRUE AND FULL VALUATIONS (RURAL, ALL OTHER, MACHINERY, TOTAL ASSESSED VALUE), VALUATIONS BY SCHOOL DISTRICTS AS EQUALIZED BY DEPARTMENT OF TAXATION, TAXES (SOLD FOR TAXES, District No., Rate, etc.), SPECIAL TAXES, TOTAL TAXES, PAID, WHEN PAID, Number of Receipt, March Settlement, June Settlement, November Settlement, Collections to First Monday in January, Delinquent on First Monday in January, Total Delinquent Tax and Penalty, REMARKS.

J. C. Lundrigan

penalty 2.90

8302

16762

8302

Vertical text on the right edge of the page, including 'Auditor's Plat #3' and other administrative markings.

Assessment Roll and Tax List of Real Property in the Town of Pike Lake

Cass County, Minnesota, for Taxes for the Year 1956.

* Indicate Type of Property: R-Residential, C-Commercial, I-Industrial, U-Utility, F-Farm, L-Lakeshore, T-Timber, M-Mineral

Table with columns: IN WHOSE NAME ASSESSED, TO WHOM TRANSFERRED, SUBDIVISION, DESCRIPTION OF PROPERTY, TRUE AND FULL VALUATIONS, ASSESSED VALUATIONS, VALUATIONS BY SCHOOL DISTRICTS, TAXES, PAID, WHEN PAID, Number of Receipt, March Settlement, June Settlement, November Settlement, Penalties, Collections to First Monday in January, Delinquent on First Monday in January, Total Delinquent Tax and Penalty, REMARKS.

Ah-Nung Point

Harding-Jondahl Supplemental Plat #3 Auditor's Plat #3

Assessment Roll and Tax List of Real Property in the Town of Lake Park

Cass County, Minnesota, for Taxes for the Year 1956.

Indicate Type of Property: R-Residential, C-Commercial, I-Industrial, U-Utility, F-Farm, L-Lakeshore, T-Timber, M-Mineral

Table with columns: IN WHOSE NAME ASSESSED, TO WHOM TRANSFERRED, DESCRIPTION OF PROPERTY, TRUE AND FULL VALUATIONS, ASSESSED VALUATIONS, VALUATIONS BY SCHOOL DISTRICTS AS EQUALIZED BY DEPARTMENT OF TAXATION, TAXES, PAID, WHEN PAID, Number of Receipt, March Settlement 1957, June Settlement 1957, November Settlement 1957, Collection to First Monday in January 1958, Delinquent on First Monday in January 1958, Total Delinquent Tax and Penalty, REMARKS.

Handwritten entries in the 'IN WHOSE NAME ASSESSED' and 'TO WHOM TRANSFERRED' columns, including names like 'Rosa Martin + Mary Margaret Martin', 'Charles M + Margaret H. Larson', 'R. G. Bentrup', 'Veletta E. Bentrup', 'Elizabeth C. Bond', 'A. J. Starrs', 'Beatrice Berthold', 'Beatrice D. Lambert', 'B. Mabelle Starrs', 'Ralph W + Ber Maye Starrs', 'A. J. Starrs'.

Handwritten notes in the 'DESCRIPTION OF PROPERTY' column, including 'Ak Thung Point', 'Block B', 'Playground', and 'Exempt'.

Summary row at the bottom of the valuation columns: 1700 1750 3450 1380 1380

Summary row at the bottom of the tax columns: 1380 293 54 134 300 88

Summary row at the bottom of the settlement columns: 6760 9810 13518

Vertical text on the right edge: Harding-Jordan Addition, Supplemental Plat of Beach, Auditor's Plat #3

* Indicate Type of Property: R-Residential, C-Commercial, I-Industrial, U-Utility, F-Farm, L-Lakeshore, T-Timber, M-Mineral

Table with columns: IN WHOSE NAME ASSESSED, TO WHOM TRANSFERRED, DESCRIPTION OF PROPERTY, TRUE AND FULL VALUATIONS, ASSESSED VALUATIONS, VALUATIONS BY SCHOOL DISTRICTS AS EQUALIZED BY DEPARTMENT OF TAXATION, TAXES, PAID, WHEN PAID, etc.

Harding-Jondahl Addition

Supplemental Plat #868

Auditor's Plat #3

Assessment Roll and Tax List of Real Property in the Town of Lake Park

Cass County, Minnesota, for Taxes for the Year 1956.

Indicate Type of Property: R-Residential, C-Commercial, I-Industrial, U-Utility, F-Farm, L-Lakeshore, T-Timber, M-Mineral

Table with columns: IN WHOSE NAME ASSESSED, TO WHOM TRANSFERRED, DESCRIPTION OF PROPERTY, TRUE AND FULL VALUATIONS, ASSESSED VALUATIONS, VALUATIONS BY SCHOOL DISTRICTS AS EQUALIZED BY DEPARTMENT OF TAXATION, SOLD FOR TAXES, PAID, WHEN PAID, March Settlement 1957, June Settlement 1957, November Settlement 1957, Collections to First Monday in January 1958, Detachment on First Monday in January 1958, Total Delinquent Tax and Penalty, REMARKS.

Supplemental Plat of Due-B-Me-Ning Beach, Harding-Jondahl Addition

Auditor's Plat #3

Assessment Roll and Tax List of Real Property in the Town of Pillsbury of Cass County, Minnesota, for Taxes for the Year 1956

Table with columns: IN WHOSE NAME ASSESSED, TO WHOM TRANSFERRED, DESCRIPTION OF PROPERTY, TRUE AND FULL VALUATIONS, ASSESSED VALUATIONS, VALUATIONS BY SCHOOL DISTRICTS AS EQUALIZED BY DEPARTMENT OF TAXATION, TAXES, PAID, WHEN PAID, etc.

Al-Nung Harding-Jordahl Supplemental Plat of Bur-E-Zo-We-Ming Beach

Auditor's Plat #3

Assessment Roll and Tax List of Real Property in the Town of Pike Bay

Indicate Type of Property: R-Residential, C-Commercial, I-Industrial, U-Utility, F-Farm, L-Lakeshore, T-Timber, M-Mineral

Cass County, Minnesota, for Taxes for the Year 1956.

Table with columns: IN WHOSE NAME ASSESSED, TO WHOM TRANSFERRED, SUBDIVISION, TRUE AND FULL VALUATIONS, ASSESSED VALUATIONS, VALUATIONS BY SCHOOL DISTRICTS, TAXES, PAID, WHEN PAID, and REMARKS. Includes handwritten entries for property owners like Anna M. Hollister and Henry + Caroline E. Hanson.

Supplemental Plat of Bur-E-Zo-We-Ning Beach

Auditor's Plat #3

Assessment Roll and Tax List of Real Property in the Town of Pike Bay

Form 50 (54) Indicate Type of Property: R-Residential, C-Commercial, I-Industrial, U-Utility, F-Farm, L-Lakeshore, T-Timber, M-Mineral

Table with columns: IN WHOSE NAME ASSESSED, TO WHOM TRANSFERRED, DESCRIPTION OF PROPERTY, TRUE AND FULL VALUATIONS, ASSESSED VALUATIONS, and FINAL EQUALIZED VALUE. Includes handwritten entries for various property owners like Loren & Jeanette Zielow and State of Minnesota.

Cass County, Minnesota, for Taxes for the Year 1956.

Table with columns: SOLD FOR TAXES, VALUATIONS BY SCHOOL DISTRICTS AS EQUALIZED BY DEPARTMENT OF VALUATION, TAX INCLUDING STATE HOMESTEAD, SPECIAL TAXES, TOTAL TAXES, PAID, WHEN PAID, Number of Receipt, March Settlement 1957, June Settlement 1957, November Settlement 1957, Collections to First Monday in January 1958, Delinquent on First Monday in January 1958, Total Delinquent Tax and Penalty, and REMARKS. Includes handwritten entries for various tax payments and settlements.

Assessment Roll and Tax List of Real Property in the Town of Pike Bay

Cass County, Minnesota, for Taxes for the Year 1956.

Form 30 (56)

Indicate Type of Property: R-Residential, C-Commercial, I-Industrial, U-Utility, F-Farm, L-Lakeshore, T-Timber, M-Mineral

Supplemental Plat of ...

Table with columns for Description of Property, True and Full Valuations, Assessed Valuations, Valuations by School Districts, and various tax and payment details.

Handwritten data for row 20: 921201, Grand total, 178935, 14209, 176496, 16492, 14215, 7444, 8628, 46591, 46789, 46589, 4660, 164262, 119906, 348978, 337280, 974422, 112116, 981638

