

ASSESSMENT & TAX LIST

Pike Bay

1953

Assessment Roll and Tax List of Real Property in the Larson of Pike Bay

Form 507 (51)

IN WHOSE NAME ASSESSED	TO WHOM TRANSFERRED	DESCRIPTION OF PROPERTY				TRUE AND FULL VALUATIONS					ASSESSED VALUATIONS					FINAL EQUALIZED VALUE	
		SUBDIVISION	Sec. or Lot	Town or Block	No. of Acres of Land	LAND Exclusive of Structures and Improvements	BUILDINGS and Other Structures	MACHINERY Permanently Attached to Real Estate	TOTAL True and Full Value	RURAL		ALL OTHER		MACHINERY Permanently Attached to Real Estate	TOTAL ASSESSED VALUE		Total Assessed Value as Equalized by the Board of Review
										Homestead Up to \$4,000 20%	Over \$4,000 and Non-Homestead 33 1/8%	Homestead Up to \$4,000 25%	Over \$4,000 and Non-Homestead 40%				
<i>Philip M. & Helen A. Larson</i>		<i>NE 1/4 of SE 1/4 of NW 1/4</i>			<i>9 1/2 31</i>												
<i>William T. & Mabel Conner</i>		<i>SE 1/4 of NE 1/4 of NE 1/4</i>			<i>9 1/2 31</i>												
		<i>SW 1/4 of NE 1/4</i>															
		<i>SE 1/4 of NE 1/4</i>															
		<i>NE 1/4 of NW 1/4</i>															
		<i>NW 1/4 of NW 1/4</i>															
		<i>SW 1/4 of NW 1/4</i>															
		<i>SE 1/4 of NW 1/4</i>															
		<i>NE 1/4 of SW 1/4</i>															
		<i>NW 1/4 of SW 1/4</i>															
		<i>SW 1/4 of SW 1/4</i>															
		<i>SE 1/4 of SW 1/4</i>															
		<i>NE 1/4 of SE 1/4</i>															
		<i>NW 1/4 of SE 1/4</i>															
		<i>SW 1/4 of SE 1/4</i>															
		<i>SE 1/4 of SE 1/4</i>															

1000 added by town Bd. 300 Homestead for 1953 by Larson Ed. measurement included in June 1 page 2

Cass County, Minnesota, for Taxes for the Year 1953.

SOLD FOR TAXES	VALUATIONS BY SCHOOL DISTRICTS AS EQUALIZED BY DEPARTMENT OF TAXATION						TAX Including State Homestead	State Tax on Non-Homestead	SPECIAL TAXES	TOTAL TAXES	PAID	WHEN PAID	Number of Receipt	March Settlement 1954	June Settlement 1954	November Settlement 1954	Collections to First Monday in January 1955	Delinquent on First Monday in January 1955	Delinquent Tax and Penalty	REMARKS
	District No.	District No.	District No.	District No.	District No.	District No.														
	Rate	Rate	Rate	Rate	Rate	Rate														
1																				
2																				
3																				
4																				
5																				
6																				
7																				
8																				
9																				
10																				
11																				
12																				
13																				
14																				
15																				
16																				
17																				
18																				
19																				
20																				

71 200

41 14

141 14

PAID IN FULL MAY 30 1954 10652

46 147

71 200

41 14

141 14

46 147

Hardin

Add In

Ar-Ming Polity

Sec 1/4 of SE 1/4

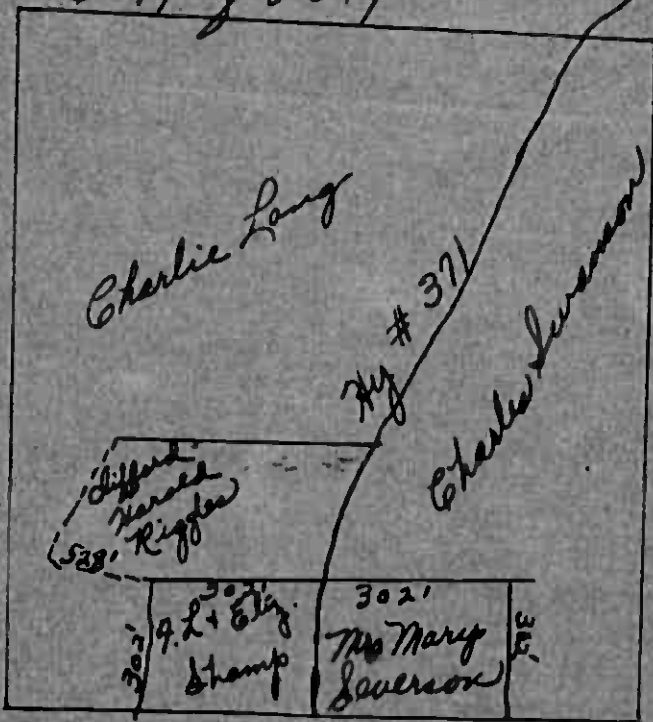

Assessment Roll and Tax List of Real Property in the Town of Pike Bay

IN WHOSE NAME ASSESSED	TO WHOM TRANSFERRED	DESCRIPTION OF PROPERTY		TRUE AND FULL VALUATIONS					ASSESSED VALUATIONS					FINAL EQUALIZED VALUE		
		SUBDIVISION	Sec. or Lot	Town or Block	Number of Acres of Land	Machinery Permanently Attached to Real Estate	BUILDINGS and Other Structures	LAND Exclusive of Structures and Improvements	RURAL		ALL OTHER		Machinery Permanently Attached to Real Estate		TOTAL ASSESSED VALUE	Total Assessed Value as Equalized by the Board of Review
									Homestead Up to \$4,000 20%	Over \$4,000 and Non-Homestead 33 1/3%	Homestead Up to \$4,000 25%	Over \$4,000 and Non-Homestead 40%				
Steve Larson		N E 1/4 of N E 1/4	33	145	31	40										
Eust Westlund		N W 1/4 of N E 1/4			40											
Herman & Hilding Kling		1/2 of 1/2 of N E 1/4			26.52	40										
Robert W. Campbell		1/2 of 1/2 of N E 1/4			40											
Herman & Hilding Kling		N E 1/4 of N W 1/4			24											
Guald R. Rau		N W 1/4 of N W 1/4			40											
		S W 1/4 of N W 1/4			40											
		1/4 of S E 1/4 of N W 1/4 of Rg			74											
Myrtle Rau		1/2 of 1/2 of N W 1/4 of Rg			8											
Carl E. Johnson		1/2 of 1/2 of S E 1/4 of S W 1/4 of Rg			6.94											
Carl E. Johnson		N W 1/4 of S W 1/4			40											
		S W 1/4 of S W 1/4			40											
James Jack Erickson		1/2 of S E 1/4 of S W 1/4 less Rg			15.50											
Hilding & Herman Kling		1/2 of Rg of S E 1/4 of N W 1/4 less Rg & Rg			25											
		1/2 of Rg of S E 1/4 of N W 1/4 less Rg & Rg			25.02											
F. W. Campbell		N E 1/4 of S E 1/4			40											
		N W 1/4 of S E 1/4			40											
		S W 1/4 of S E 1/4			40											

570 40

Cass County, Minnesota, for Taxes for the Year 1953.

SOLD FOR TAXES	VALUATIONS BY SCHOOL DISTRICTS AS EQUALIZED BY DEPARTMENT OF TAXATION						Tax Including State Homestead	State Tax on Non-Homestead	SPECIAL TAXES	TOTAL TAXES	PAID	WHEN PAID	Number of Receipt	March Settlement 1954	June Settlement 1954	November Settlement 1954	Collections to First Monday in January 1955	Delinquent on First Monday in January 1955	Total Delinquent Tax and Penalty	REMARKS
	District No.	District Rate	District No.	District Rate	District No.	District Rate														
	Dollars	Dollars	Dollars	Dollars	Dollars	Dollars														
1											PAID IN FULL DEC 4 1954									
2											PAID IN FULL MAY 17 1954									
3											2nd Half Paid OCT 30 1954									
4											1st Half Paid MAY 3 1954									
5											2nd Half Paid SEP 30 1954									
6											1st Half Paid MAY 31 1954									
7											2nd Half Paid OCT 30 1954									
8											PAID IN FULL MAY 17 1954									
9											PAID IN FULL MAY 17 1954									
10											PAID IN FULL MAY 17 1954									
11											2nd Half Paid SEP 10 1954									
12											1st Half Paid MAY 31 1954									
13											2nd Half Paid SEP 10 1954									
14											1st Half Paid MAY 31 1954									
15											2nd Half Paid SEP 10 1954									
16											1st Half Paid MAY 31 1954									
17											2nd Half Paid SEP 10 1954									
18											1st Half Paid MAY 31 1954									
19											2nd Half Paid SEP 10 1954									
20											1st Half Paid MAY 31 1954									

1149 491 162

33822 222

133544

21312

49958

1974

263

Assessment Roll and Tax List of Real Property in the Lawn of Bake Bay

Form-307 (53) JULY-1950 EDITION, MINNAPOLIS

IN WHOSE NAME ASSESSED	TO WHOM TRANSFERRED	DESCRIPTION OF PROPERTY				TRUE AND FULL VALUATIONS				ASSESSED VALUE			
		SUBDIVISION	Sec. or Lot	Town or Block	Number of Acres of Land	LAND Exclusive of Structures and Improvements	BUILDINGS and Other Structures	MACHINERY Permanently Attached to Real Estate	TOTAL True and Full Value	RURAL		ALL OTHER	
										Homestead Up to \$4,000 20%	Over \$4,000 and Non-Homestead 33 1/3%	Homestead Up to \$4,000 25%	Over \$4,000 and Non-Homestead 40%
						Dollars	Dollars	Dollars	Dollars	Dollars	Dollars	Dollars	
1		N E 1/4 of N E 1/4											
2		N W 1/4 of N E 1/4											
3		S W 1/4 of N E 1/4											
4		S E 1/4 of N E 1/4											
5													
6		N E 1/4 of N W 1/4											
7		N W 1/4 of N W 1/4											
8		S W 1/4 of N W 1/4											
9		S E 1/4 of N W 1/4											
10													
11		N E 1/4 of S W 1/4											
12		N W 1/4 of S W 1/4											
13		S W 1/4 of S W 1/4											
14		S E 1/4 of S W 1/4											
15													
16		N E 1/4 of S E 1/4											
17		N W 1/4 of S E 1/4											
18		S W 1/4 of S E 1/4											
19		S E 1/4 of S E 1/4											
20													

PAGES

33

THRU

38

BLANK

Cass County, Minnesota, for Taxes for the Year 1953.

State Tax on Non-Homestead	SPECIAL TAXES	TOTAL TAXES	PAID	WHEN PAID	Number of Receipts	March	June	November	Collections to First Monday in January 1955	Delinquent on First Monday in January 1955	Total Delinquent Tax and Penalty	REMARKS
						Settlement 1951	Settlement 1951	Settlement 1951				
cts.	\$ cts.	\$ cts.		Month Day Year		\$ cts.	\$ cts.	\$ cts.	\$ cts.	\$ cts.	\$ cts.	
1												
2												
3												
4												
5												
6												
7												
8												
9												
10												
11												
12												
13												
14												
15												
16												
17												
18												
19												
20												

Harding-Jordahl Add'n Ah-Hung Point

Assessment Roll and Tax List of Real Property in the Laurel of Pike Bay

Cass County, Minnesota, for Taxes for the Year 1953.

IN WHOSE NAME ASSESSED	TO WHOM TRANSFERRED	DESCRIPTION OF PROPERTY				TRUE AND FULL VALUATIONS										FINAL EQUALIZED VALUE
		SUBDIVISION	Sec. or Lot	Town or Block	Kng.	Number of Acres of Land	Machinery Permanently Attached to Real Estate	RURAL		ALL OTHER		Machinery Permanently Attached to Real Estate	TOTAL ASSESSED VALUE	Total Assessed Value as Equalized by the Board of Review		
								Acres	100ths	Homestead Up to \$4,000 20%	Over \$4,000 and Non-Homestead 33 1/3%				Homestead Up to \$4,000 25%	
Chas. J. Ralph & Robert Archambault		Alt-Mug-Point Sub 1 Sec 1-145-31	1	A												
Lucille Collins, Marine Nelson, Elmira Kane			2													
Florence R. Mingers			3													
J. M. & Helen Thomson		W/2 of	3													
Helen J. Thomson		E/2 of	4													
O. R. Martin			5													
John H. & Shirley W. Martin			6													
Harriet Madamot Moore			7													
" " "			8													
P. J. Starr			9													
" " "			10													
" " "			11													
Helen, Edith, & Alice Sherwood			12													
P. W. & Minnie Louise Canine		W/2 of	12													
Robert & Helen Brewster		E/2 of	12													
" " "			13													
Harold G. & Lorene E. Genden			14													
" " "			15													
Charles & Margaret R. Boreman			16													
" " "			17													
Charles Boreman			18													
" " "			19													
" " "			20													

SOLD FOR TAXES	VALUATIONS BY SCHOOL DISTRICTS AS EQUALIZED BY DEPARTMENT OF VALUATION						Tax Including State Homestead	State Tax on Non-Homestead	SPECIAL TAXES	TOTAL TAXES	PAID	WHEN PAID	Number of Receipt	March Settlement 1954	June Settlement 1954	Penalty	November Settlement 1954	Penalty	Collections to First Monday in January 1955	Penalty	Delinquent on First Monday in January 1955	Total Delinquent Tax and Penalty	REMARKS
	District No.	District No.	District No.	District No.	District No.	District No.																	
	Rate	Rate	Rate	Rate	Rate	Rate																	
1																							
2																							
3																							
4																							
5																							
6																							
7																							
8																							
9																							
10																							
11																							
12																							
13																							
14																							
15																							
16																							
17																							
18																							
19																							
20																							

Alt-Mug-Point

Harding Add'l

