

1941
May

Form A
INDEX TO SECTIONS

Section	Page
1	
2	
3	
4	
5	
6	
7	
8	
9	
10	
11	
12	
13	
14	
15	
16	
17	
18	
19	
20	
21	
22	
23	
24	
25	
26	
27	
28	
29	
30	
31	
32	
33	
34	
35	
36	

For Convenience of Auditor in Showing Boundaries of School Districts

Township No. 134 Range No. 31^{1/2} Mer. P. M.
Part 133-31

Tax Levy for 19

State Revenue	
State School Tax, 1.23 Mills	
State Teachers' Insurance and Retirement Fund	
County Revenue	
County Poor	
County 1 Mill Tax	
County Road and Bridge Tax	
County Old Age Pension	
Town Revenue Tax	
Town Road and Bridge Tax	
Special Dragging Fund	
Special Road Tax	
Special Village or City Tax	
Village Road-Bridge	
Village State Loan	
Total	

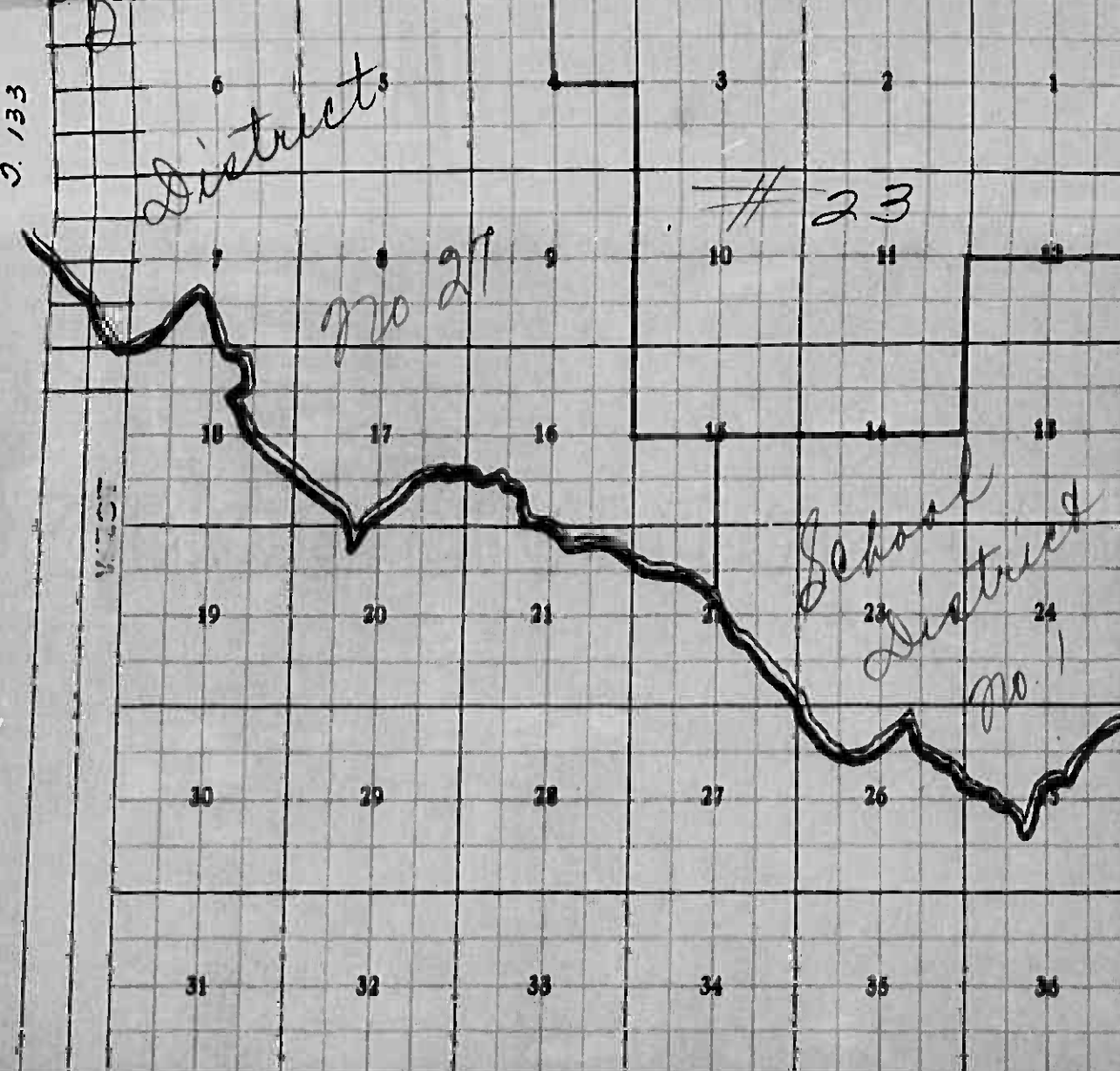
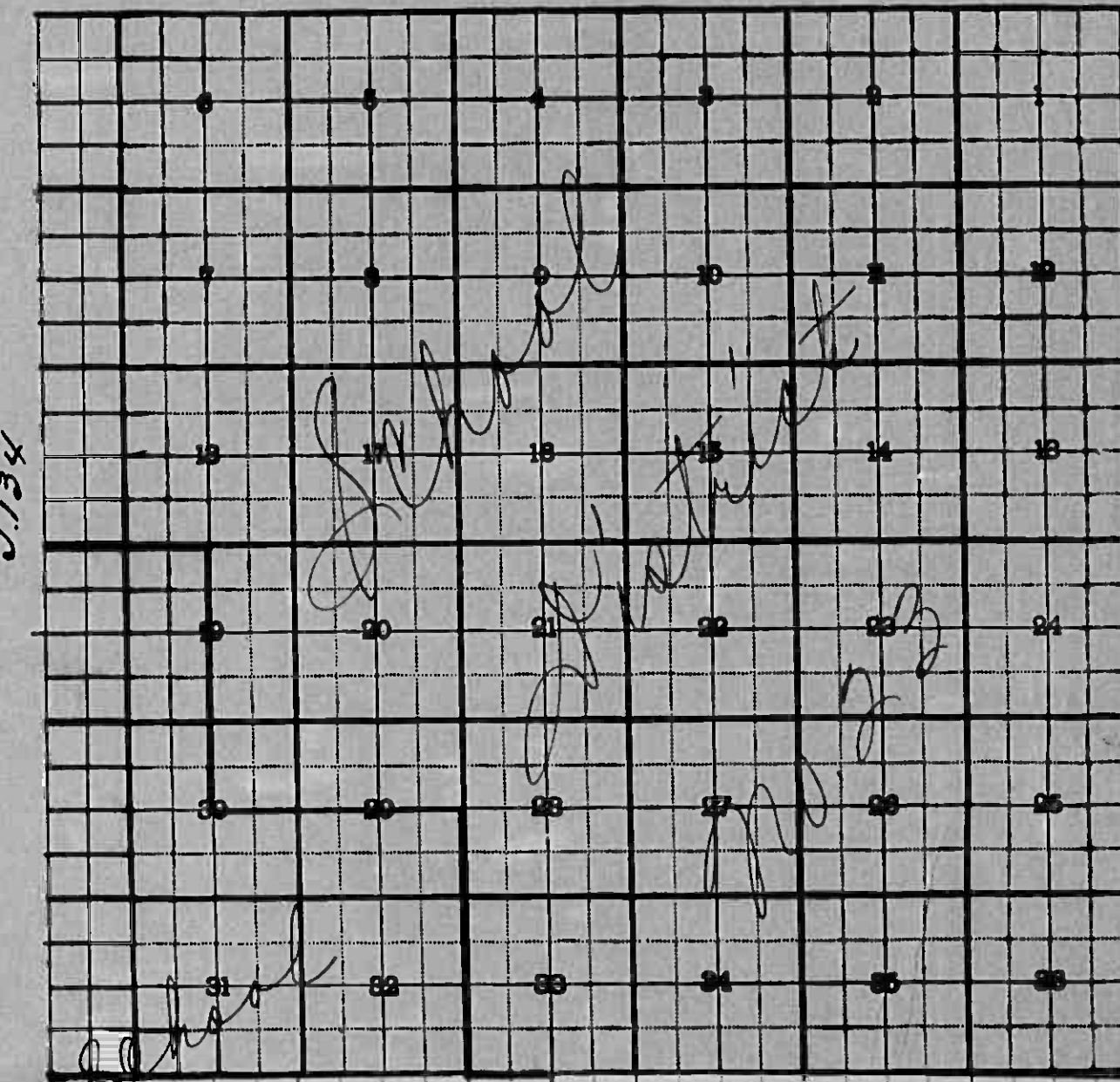

Treasurer's Office, Cass County, Minnesota

RECEIVED this, the first Monday (being the 5th day) of January, A. D. 1922, of L. C. Peterson, Auditor of said County, Minnesota, the Tax List of all Taxable Real and Personal Property in the Town of May in said County for the year A. D. 1921, as specified above and amounting to fifteen thousand four hundred eighty eight and 18/100 W. J. McKeown County Treasurer. O. M.

Office of County Treasurer, Cass County, Minnesota

To L. C. Peterson, County Auditor: Jan. 4 1922
Sir:—I herewith return to you the Tax List for the Town of May in said County for the year 1921, heretofore received from you. I certify that I have compared the same with the duplicate receipts in your office, and have written opposite the amount of each tax so received the words "One half paid" or "Paid in full" as the case may be, and the number of my receipt given in discharge of said tax, and each tract or lot of real property against which the taxes remain unpaid is delinquent for said year.
Yours Respectfully,
W. J. McKeown County Treasurer. O. M.

Auditor's Office, Cass County, Minnesota

I, _____ Auditor of said County, and State of Minnesota, do hereby certify that the following is a correct list of the Taxes levied on the Real and Personal Property in the _____ of _____ for the year 1921.
WITNESS my hand and official seal, the _____ day of _____ 1921.
(SEAL) _____ County Auditor.

Auditor's Office, Cass County, Minnesota

I hereby certify that on the first Monday in January, 1922, I received of _____, County Treasurer, the Tax List of the _____ of _____ in said County for the year 1921; that I have compared the said list with the Statements receipted for by said Treasurer, which are on file in my office, and that each tract or lot of real property therein against which the taxes, or any part thereof, remains unpaid are delinquent for said year.
(SEAL) _____ County Auditor.

COLLECTIONS OF TAXES OF 1942... Township OF May, CASS COUNTY, MINNESOTA

FUNDS	AMOUNT LEVIED 1942	ADDITIONS TO LEVY 1942	TOTAL	MARCH SETTLEMENT 1942	JUNE SETTLEMENT 1942	NOV. SETTLEMENT 1942	TAXES ABATED 1942 <i>am. + july</i>	TAXES COLLECTED FROM NOV. 1 TO FIRST MONDAY IN JANUARY	BALANCE UNCOLLECTED	TOTAL
State Revenue										
State School										
Teacher's Income Homestead	25 68			338	801	662		98		
Moneys and Credits				222						
Non-Home	58 06			11 505	142 46	92 53		18 48		
County Revenue	24 9526			328 21	778 55	643 07		95 16		
County Road and Bridge	44 512			58 55	138 88	114 72		16 98		
Sanitation Poor (Welfare)	4 23293			55 677	122 073	109 090		161 45		
Old Age Assistance Bond Int.	1 60502			211 11	500 28	413 64		61 22		
Moneys and Credits				222						
Agr. Cash	26 75			35 2	825	689		102		
Town Revenue	250 34			329 3	781 2	645 3		95 5		
Town Road and Bridge	1 30122			197 46	408 48	386 39		57 26		
Town Draying	10 700			140 7	333 9	225 6		40 8		
Town State Loan										
Ditch Levy										
Door										
Moneys and Credits				44 2						
Fire Patrol	10 700			140 7	333 9	275 8		40 8		
Em. Road	53 591			70 37	166 93	137 88		20 41		
Town Hall	29 990			39 47	92 48	72 21		11 43		
Deficiency										
Local Mill School	426 284			69 419	1286 62	1071 50		144 36		
Special School		4231 added 4171 over pd.								
State Loan School										
Moneys and Credits				44 2						
TOTALS	1648 818	8402	16572 20	23522 7	5059 40	4261 52	635 52	606 46	3757 23	16572 20
SCHOOL DISTRICTS										
School District No.	1 Mill	Special	TOTAL	1 Mill	Special	TOTAL	NOVEMBER SETTLEMENT	TAXES ABATED	BALANCE UNCOLLECTED	TOTAL
do	28 06	858 413	288 2136 915	213 1797	798	213 1797	798			
do	28 06	25150 348 55	463 1640 78 39 88	32 30	531 24 379 26	32 30	531 24 379 26			
do	7 85		21 33	15 73		15 73				
do	33 63		91 39	67 90		67 90				
do	9 88		13 55	9 99		9 99				
TOTAL	75 12 266 08 35 296		175 16 662 14 49 03	127 55 55 72 1 38 67 4						

3736 25 uncollected
2098 EARLY P.P. Tax
of A. Hauck Sec
NOTE

