

Assessment Book

FOR THE YEAR

1934

Town of May

CASS COUNTY
MINNESOTA

FREE PRESS COMPANY
PRINTERS, LITHOGRAPHERS, STATIONERS AND BINDERS
MANKATO, MINNESOTA

OFFICE OF
COUNTY AUDITOR

County, 1934,
To Assessor
of in the County aforesaid.

According to the requirements of law, I herewith deliver to you the Real and Personal Property Assessment Book of the said for the year 1934, and I hereby direct you to assess all property and make return thereof to me as required by law prescribing your duties.

A form of return to be signed by you is appended to this book.

County Auditor

Auditor's Office, Cass County, Minnesota

I, L. C. Peterson, Auditor of Cass County, and State of Minnesota, do hereby certify that the following is a correct list of taxes levied on the Real and Personal Property in the Town of May in said County, for the year 1934.

Witness my hand and official seal this 5th day of January, 1935.

(SEAL)

County Auditor.

Treasurer's Office, Cass County, Minnesota

Received this, the first Monday (being the 7th day) of January, A. D. 1935, of J. C. Peterson, Auditor of Cass County, Minnesota, the Tax List of all Taxable Real and Personal Property in the Town of May in said County, for the year A. D. 1934, as specified above, and amounting to

Twelve thousand six hundred Ninety and 3/100 DOLLARS

County Treasurer.

Office of County Treasurer, Cass County, Minnesota

To J. C. Peterson, County Auditor
January 6, 1935.

Sir: I herewith return to you the Tax List for the Town of May in said Cass County, for the year 1934, heretofore received from you. I certify that I have compared the same with the duplicate receipts in your office, and have written opposite the amount of each tax so received the words "One Half Paid," or "Paid in Full," as the case may be, and the number of my receipt given in discharge of said tax, and each tract or lot of Real Property against which the taxes remain unpaid is delinquent for said year.

County Treasurer.

Auditor's Office, Cass County, Minnesota

January 6, 1935.
I hereby certify that on the first Monday in January, 1935, I received of W. J. McKeown, County Treasurer, the Tax List of the Town of May in said County of Cass, for the year 1934, and that I have compared the said list with the statements received for by said Treasurer, which are on file in my office and that each tract or lot of real property therein against which the taxes, or any part thereof, remains unpaid are delinquent for said year.

(SEAL)

County Auditor.

TABULAR SCHEDULE OF VALUATIONS

LEVIED IN THE Town OF May

No. of School Dist.	VALUATION BY SCHOOL DISTRICT					RATE OF STATE TAXES					RATE OF COUNTY TAXES							RATE OF TOWN TAXES						
	Money and Credits Dollars	Total Acres	Average Value Per Acre Dollars	Value of Lands other than Town Lots Including Structures Dollars	Value of Town and City Lots Including Structures Dollars	Personal Property except Money and Credits Dollars	Total Value of all Taxable Property except Money and Credits Dollars	State Rev.	State Sch'l	Tchr. Ret.	Minn. Gen'l Hosp.	Total Rate of State Taxes	Co. Rev.	Co. R&B	Co. Poor	Road Main	Bond & Int.	Sink-ing	Total Rate of Co. Taxes	Town Rev.	Twn. R&B	Town Mill Drag	Twn. State Loan	Total Rate of Twn. Taxes
								Mills	Mills	Mills	Mills	Mills	Mills	Mills	Mills	Mills	Mills	Mills	Mills	Mills	Mills	Mills	Mills	Mills
23 1891 1827	302437 189121 1790483			9387 66725 22258		1123 3355 1817	10510 10280 24075	123	15	57	125	114	57	114		146	19	457	2	95	1		12	126
TOTAL	355296		98370	6445	104865																			

RATES AND TAXES

COUNTY OF CASS, STATE OF MINNESOTA

RATE OF SCHOOL TAXES							TAXES LEVIED									
Sch'l Loc'l Mill	Sch'l Sp'l Mill	Sch'l State Loan	Int. Sky	Total Rate of Sch'l Taxes	Total Rate of all Taxes	Local Mill	LOCAL 1 MILL AND SPECIAL SCHOOL TAXES BY DISTRICTS			SUMMARY OF ALL TAXES						
Mills	Mills	Mills	Mills	Mills	Mills	Local Mill	Special	Interest	Sinking	State Loan	Total School Tax	FUNDS	Rate	Amounts		
1	5558	3118		8776	15806	1051	58414			32770	92235	State Revenue		110841		
1	3	3118		2518	10548	7028	21084			219133	247245	State School		12898		
1	495	125	53	35	718	4210	2408	119171	12760	8426	30094	Teachers Ins. and Ref.		1593		
												Minn. Gen'l Hospital		5977		
												County Revenue		119756		
												County Road and Bridge		54978		
												County Poor		119756		
												Bond and Interest		153627		
												Sinking		20134		
												Town Revenue		24973		
												Town Road & Bridge		106642		
												Town 1 Mill Drag		10487		
												Town State Loan				
												School Local, 1 Mill		10487		
												School Special		198669		
												School State Loan		281997		
												School Interest		12760		
												Sinking		8426		
												Money and Credits		687		
												TOTAL		1261931		

Total Levy, \$ 126,193.18

Total Number of Acres 31

State of Minnesota, County of Cass

Witness my hand and official seal this 31st day of July, A. D. 1937

County Auditor



FUNDS	March Settlement 1933	June Settlement 1933	October Settlement 1933	Forfeited Sale 1933	Amount Collected from Nov. 1933 to first Monday in Jan. 1934	TOTAL COLLECTED	BALANCE UNCOLLECTED
State Revenue	6664	27968	18510		3126		
State School	775	3254	2154		364		
Teacher's Ins. & Ret. Fd	95	397	263		45		
Minnesota Gen. Hosp.	360	1508	998		168		
County Revenue	7201	30217	19998		3378		
County Road and Bridge	3600	15108	9999		1687		
County Poor	7201	30217	19998		3378		
County Bond & Tbt.	9236	38763	25654		4333		
Sinking	1210	5080	3362		568		
Town Revenue	1261	5292	3502		591		
Town Road and Bridge	6015	25243	16706		2821		
Town 1 Mill Drag	631	8647	1751		296		
Town Street	75	317	209		45		
School Local 1 Mill	631	2713	549		396		
School Special	8729	2647	1751		4880		
School State Loan	19404	59871	40502		8147		
School	640	6401	4568		305		
Money and Credits	123	3016	1644		202		
TOTALS	72145	325227	215956		34632		

SCHOOL DISTRICTS	March Settlement				June Settlement				October Settlement				Forfeited Settlement				Nov. to January				Total Collected	Balance Uncollected
	Local 1 Mill	Special	State Loan	Total	Local 1 Mill	Special	State Loan	Total	Local 1 Mill	Special	State Loan	Total	Local 1 Mill	Special	State Loan	Total	Local 1 Mill	Special	State Loan	Total		
School District No.																						
TOTALS																						

For Convenience of Auditor in Showing Boundaries of School Districts
 Township 134 Range No. 31 and Part of Twp 133
 Mer. P. M. R. 31

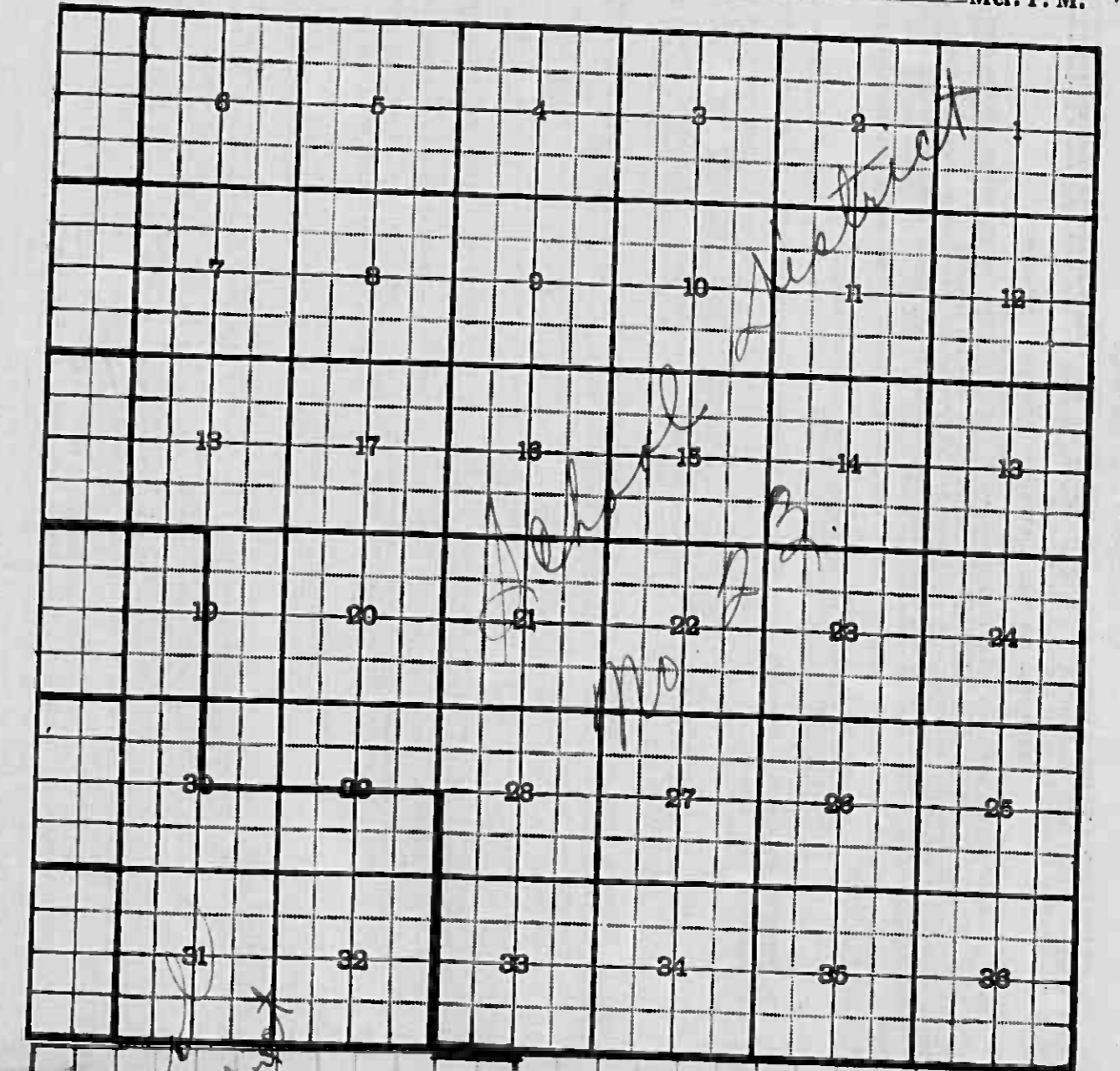

Index to Sections

Section	Page
" 1	
" 2	
" 3	
" 4	
" 5	
" 6	
" 7	
" 8	
" 9	
" 10	
" 11	
" 12	
" 13	
" 14	
" 15	
" 16	
" 17	
" 18	
" 19	
" 20	
" 21	
" 22	
" 23	
" 24	
" 25	
" 26	
" 27	
" 28	
" 29	
" 30	
" 31	
" 32	
" 33	
" 34	
" 35	
" 36	

0.134
0.135

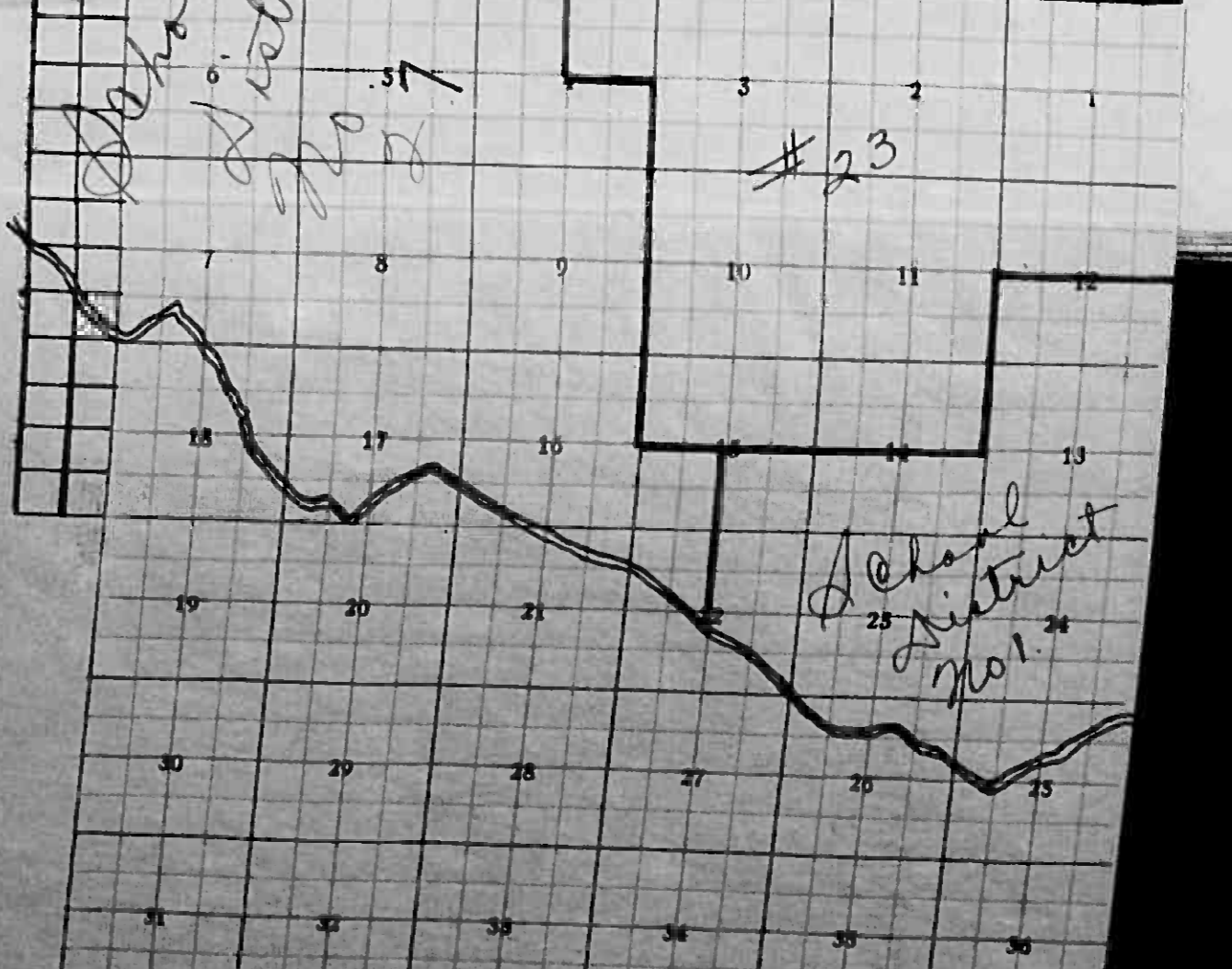

Assessment Roll and Tax List of Unplatted Real Property in the _____ of _____
 Unplatted Real Estate Assessed at 33 1/3 Per Cent of True and Full Value; Attached Machinery at 33 1/3 Per Cent of True and Full Value. Homesteads, up to true and full value of \$4000, assessable at 20 Per Cent., Class 3B; Remainder at 33 1/3 Per Cent., Class 3.

Cass County, Minnesota, for Taxes for the Year 1934.

IN WHOSE NAME ASSESSED	TO WHOM TRANSFERRED	DESCRIPTION OF PROPERTY						ASSESSOR'S VALUATIONS							EQUALIZED VALUES			SOLD FOR TAXES	
		SUBDIVISION	Sec. or Lot	Town or Block	Range	Number of Acres of Land	No. School District	Indicate Homestead	True and Full Value of Land and Structures and Improvements	Structures and Improvements True and Full Value of Buildings and other Structures	True and Full Value of Machinery Permanently Attached to Real Estate	Total True and Full Value of Land Including All Structures and Improvements and Machinery	Assessed Value of Homesteads up to \$4000 at 20 Per Cent. Class 3B	Assessed Value of Remainder at 33 1/3 Per Cent. Class 3	Total Assessed Value of Land Including all Structures and Improvements and Machinery	Total Assessed Value As Equalized by the Board of Review	Total Assessed Value As Equalized by the County Board		Total Assessed Value As Equalized by the Minnesota Tax Commission
Samuel Adams		1 NE 1/4	5	114	42	160	15	Yes	560.0	120.0		680.0	80.0	933	173.3				
O. J. Anderson		3 SW 1/4	5	114	32	160	No		580.0		580.0		1933	193.3					
Lester Howard		5 SE 1/4	5	114	32	160	No		620.0		620.0		2067	206.7					
George E. Warner		7 N 1/2 of NE 1/4	6	114	32	80	Yes	280.0	90.0		370.0	74.0		74.0					
Howard Elliott		9 S 1/2 of NE 1/4	6	114	32	80	No		280.0		280.0		933	93.3					
Oscar Johnson		11 NW 1/4	6	114	32	160	Yes	600.0	240.0		840.0	80.0	1467	226.7					
Mary Cole		13 E 1/2 of SW 1/4	6	114	32	80	Yes	280.0	120.0		400.0	70.0		70.0					
W. H. Benson		15 W 1/2 of SW 1/4	6	114	32	80	No		300.0		300.0		1000	100.0					
A. R. Sylvester		17 NE 1/4 of SE 1/4	6	114	32	40	Yes	160.0	160.0		320.0	64.0		64.0					
Do.		19 SW 1/4 of SE 1/4	6	114	32	40	Yes	120.0			120.0	16.0	133	29.3					
									3730.0	730.0		4460.0	384.0	8466	1230.6				

PROOF
 Assessed Value of Homesteads, \$3840 x 5 equals \$19200
 Assessed Value of Remainder, \$8466 x 3 equals \$25398
 Total True and Full Value, \$44598

VALUATIONS BY SCHOOL DISTRICTS AS EQUALIZED BY TAX COMMISSION				Total General Tax	SPECIAL TAXES				TOTAL TAXES	PAID	WHEN PAID	Number of Receipt	March Settlement 1935	June Settlement 1935	Penalty	November Settlement 1935	Penalty	Collections to First Monday in January 1936	Penalty	Delinquent on First Monday in January 1936	Penalty	Total Delinquent Tax and Penalty	REMARKS	
District No.	District No.	District No.	District No.		Ditch No.	Ditch No.	Ditch No.	Ditch No.																
				\$																				

UNPLATTED R. E.

Assessment Roll and Tax List of Unplatted Real Property in the Town of May, Minnesota. Unplatted Real Estate Assessed at 33 1/3 Per Cent of True and Full Value; Attached Machinery at 33 1/3 Per Cent of True and Full Value. Homesteads, up to true and full value of \$4000, assessable at 20 Per Cent, Class 3B; Remainder at 33 1/3 Per Cent, Class 3.

Cass County, Minnesota, for Taxes for the Year 1934.

Table with columns: IN WHOSE NAME ASSESSED, TO WHOM TRANSFERRED, DESCRIPTION OF PROPERTY, ASSESSOR'S VALUATIONS, EQUALIZED VALUES, VALUATIONS BY SCHOOL DISTRICTS AS EQUALIZED BY TAX COMMISSION, SPECIAL TAXES, PAID, WHEN PAID, Number of Receipt, March Settlement 1935, June Settlement 1935, Penalty, November Settlement 1935, Penalty, Collections to First Monday in January 1936, Delinquent on First Monday in January 1936, Penalty, Total Delinquent Tax and Penalty, REMARKS.

Assessment Roll and Tax List of Unplatted Real Property in the Town of May of May

Unplatted Real Estate Assessed at 33 1/3 Per Cent of True and Full Value; Attached Machinery at 33 1/3 Per Cent of True and Full Value. Homesteads, up to true and full value of \$4000, assessable at 20 Per Cent., Class 3B; remainder at 33 1/3 Per Cent., Class 3.

Table with columns: IN WHOSE NAME ASSESSED, TO WHOM TRANSFERRED, SUBDIVISION, ASSESSOR'S VALUATIONS, EQUALIZED VALUES, SOLD FOR TAXES. Includes handwritten entries for Ole Haug, C. L. Hannache, and Herbert C. Schumacher.

Cass County, Minnesota, for Taxes for the Year 1934.

Table with columns: VALUATIONS BY SCHOOL DISTRICTS AS EQUALIZED BY TAX COMMISSION, SPECIAL TAXES, PAID, WHEN PAID, Number of Receipt, March Settlement 1935, June Settlement 1935, November Settlement 1935, Collections to First Monday in January 1935, Delinquent on First Monday in January 1936, Total Delinquent Tax and Penalty, REMARKS. Includes handwritten entries for payments and settlements.

Assessment Roll and Tax List of Unplatted Real Property in the Town of May of May

Unplatted Real Estate Assessed at 33 1/3 Per Cent of True and Full Value; Attached Machinery at 33 1/3 Per Cent of True and Full Value. Homesteads, up to true and full value of \$4000, assessable at 20 Per Cent, Class 2B; Remainder at 33 1/3 Per Cent, Class 3.

Cass County, Minnesota, for Taxes for the Year 1934.

Table with columns: IN WHOSE NAME ASSESSED, TO WHOM TRANSFERRED, DESCRIPTION OF PROPERTY, ASSESSOR'S VALUATIONS, EQUALIZED VALUES, VALUATIONS BY SCHOOL DISTRICTS AS EQUALIZED BY TAX COMMISSION, SPECIAL TAXES, PAID, WHEN PAID, Number of Receipt, March Settlement 1935, June Settlement 1935, Penalty, November Settlement 1935, Penalty, Collections to First Monday in January 1936, Delinquent on First Monday in January 1936, Penalty, Total Delinquent Tax and Penalty, REMARKS. Includes handwritten entries for names like Herbert C. Schumacher and John I. Carlson.

Assessment Roll and Tax List of Unplatted Real Property in the Town of May of May

Unplatted Real Estate Assessed at 33 1/3 Per Cent of True and Full Value; Attached Machinery at 33 1/3 Per Cent of True and Full Value. Homesteads, up to true and full value of \$4000, assessable at 20 Per Cent, Class 3B; Remainder at 33 1/3 Per Cent, Class 3.

Cass County, Minnesota, for Taxes for the Year 1934.

Main table with columns: IN WHOSE NAME ASSESSED, TO WHOM TRANSFERRED, DESCRIPTION OF PROPERTY, ASSESSOR'S VALUATIONS, EQUALIZED VALUES, VALUATIONS BY SCHOOL DISTRICTS AS EQUALIZED BY TAX COMMISSION, SPECIAL TAXES, PAID, WHEN PAID, Number of Receipt, March Settlement 1935, June Settlement 1935, November Settlement 1935, Collections to First Monday in January 1936, Delinquent on First Monday in January 1936, Total Delinquent Tax and Penalty, REMARKS.

State of Minn. Dept. of Rural Credit

George His Carl Lockwood

Arthur J. His

Arthur E. Nelson

Arthur J. His

John Seadlund

John E. Stewart

Whittemore Hwy

6 or 60

5507

4878

6103

1549

1649

2274

Assessment Roll and Tax List of Unplatted Real Property in the Town of May
 Unplatted Real Estate Assessed at 33 1/3 Per Cent of True and Full Value; Attached Machinery at 33 1/3 Per Cent of True and Full Value. Homesteads, up to true and full value of \$4000, assessable at 20 Per Cent, Class 2B; Remainder at 33 1/3 Per Cent, Class 3.

IN WHOSE NAME ASSESSED	TO WHOM TRANSFERRED	DESCRIPTION OF PROPERTY				No. School District	Indicate Homestead	ASSESSOR'S VALUATIONS					EQUALIZED VALUES				SOLD FOR TAXES										
		SUBDIVISION	Sec. of Lot	Town or Block	Range			Number of Acres	Value of Land	Structures and Improvements	Total True and Full Value of Land	Assessed Value of Homesteads	Assessed Value of Remainder	Total Assessed Value	Total Assessed Value As Equalized by Board of Review	Total Assessed Value As Equalized by County Board		Total Assessed Value As Equalized by Minnesota Tax Commission									
																			ASSESSOR'S VALUATIONS					EQUALIZED VALUES			
																			Dollars	Dollars	Dollars	Dollars	Dollars	Dollars	Dollars	Dollars	Dollars
Andrew Rosvold		NE 1/4 of NE 1/4	17	133	W	40		24070			66	47															
Samuel Sheffer		NW 1/4 of NE 1/4				40		232 235			67	45															
Mamie E. Armstrong		SW 1/4 of NE 1/4 less Ry. Rty				33	25	no	210		70	50															
Andrew Rosvold		SE 1/4 of NE 1/4				35	34	yes	315 225		62	45															
Susie E. Nelson		330 ac. of Section 36				3	30	no	25			6															
Mamie E. Armstrong		NE 1/4 of NW 1/4 less Ry. Rty				38	35	no	323		108	77															
		NW 1/4 of NW 1/4				33	25	no	281 221		94	67															
		SW 1/4 of NW 1/4				24	40	no	538 384		179	128															
		SE 1/4 of NW 1/4																									
		NE 1/4 of SW 1/4				40		no	311 222		104	74															
		NW 1/4 of SW 1/4				40		no	294 202		98	70															
Mamie E. Armstrong		SW 1/4 of SW 1/4 Lot 1				40		no	294 202		98	70															
Susie E. Nelson		SE 1/4 of SW 1/4				40		no	294 202		98	70															
Andrew Rosvold		All S. of Ry. Rty of lot 5				29	43	no	252 180		84	60															
Mamie E. Armstrong		NE 1/4 of SE 1/4 Lot 5 N. of Ry				1	75	no	14			2															
		NW 1/4 of SE 1/4				49	79	no	336 240		112	80															
		SW 1/4 of SE 1/4																									
		SE 1/4 of SE 1/4																									

VALUATIONS BY SCHOOL DISTRICTS AS EQUALIZED BY TAX COMMISSION					Total General Tax	SPECIAL TAXES				TOTAL TAXES	PAID	WHEN PAID	Number of Receipt	March Settlement 1935	June Settlement 1935	Penalty	November Settlement 1935	Penalty	Collections to First Monday in January 1936		Delinquent on First Monday in January 1936		Total Delinquent Tax and Penalty	REMARKS
District No.	Rate	District No.	Rate	District No.		Rate	District No.	Rate	District No.										Rate	Penalty	Penalty			
Rate	Mills	Rate	Mills	Rate		Mills	Rate	Mills	Rate										Mills	\$	cts.			
Rate	Mills	Rate	Mills	Rate		Mills	Rate	Mills	Rate										Mills	\$	cts.			
Dollars	Dollars	Dollars	Dollars	Dollars		Dollars	Dollars	Dollars	Dollars										Dollars	\$	cts.			

Assessment Roll and Tax List of Unplatted Real Property in the Town of May of May, Minnesota

Cass County, Minnesota, for Taxes for the Year 1934.

Table with columns: IN WHOSE NAME ASSESSED, TO WHOM TRANSFERRED, DESCRIPTION OF PROPERTY, ASSESSOR'S VALUATIONS, EQUALIZED VALUES, VALUATIONS BY SCHOOL DISTRICTS AS EQUALIZED BY TAX COMMISSION, SPECIAL TAXES, PAID, WHEN PAID, Number of Receipt, March Settlement 1935, June Settlement 1935, November Settlement 1935, Collections to First Monday in January 1935, Delinquent on First Monday in January 1935, Total Delinquent Tax and Penalty, REMARKS.

Assessment Roll and Tax List of Unplatted Real Property in the Town of May

Unplatted Real Estate Assessed at 33 1/3 Per Cent of True and Full Value; Attached Machinery at 33 1/3 Per Cent of True and Full Value. Homesteads, up to true and full value of \$4000, assessable at 20 Per Cent, Class 3B; Remainder at 33 1/3 Per Cent, Class 3.

Cass County, Minnesota, for Taxes for the Year 1934.

IN WHOSE NAME ASSESSED	TO WHOM TRANSFERRED	DESCRIPTION OF PROPERTY				No. School District	ASSESSOR'S VALUATIONS						EQUALIZED VALUES			SOLD FOR TAXES	VALUATIONS BY SCHOOL DISTRICTS AS EQUALIZED BY TAX COMMISSION				SPECIAL TAXES				TOTAL TAXES	PAID	WHEN PAID	Number of Receipt	March Settlement 1935	June Settlement 1935	November Settlement 1935	Collections to First Monday in January 1936	Delinquent on First Monday in January 1936	Total Delinquent Tax and Penalty	REMARKS				
		Subdivision	Sec. or Lot	Town or Block	Range		True and Full Value of Land	True and Full Value of Structures and Improvements	True and Full Value of Machinery Permanently Attached to Real Estate	Total True and Full Value of Land Including All Structures, Improvements and Machinery	Assessed Value of Homesteads up to \$4000 at 20 Per Cent Class 3B	Assessed Value of Remainder at 33 1/3 per cent Class 3	Total Assessed Value of Land Including all Structures, Improvements and Machinery	Total Assessed Value as Equalized by the Board of Review	Total Assessed Value as Equalized by the County Board		Total Assessed Value as Equalized by the Minnesota Tax Commission	District No.	District No.	District No.	District No.	Ditch No.	Ditch No.	Ditch No.												Ditch No.	Rate	Rate	Rate
Harman A. Miller et al	alt	NE 1/4 of NE 1/4 R.R.	24	133	31	39	75	1	no	1100	1070																												
"	"	NW 1/4 of NE 1/4				40			no	326																													
"	"	SW 1/4 of NE 1/4	12	48	6	18	92		no	148																													
"	"	SE 1/4 of NE 1/4	12	23	ac				no																														
R.R. Ring	Herbert C. Schumacher	all S. of Ry of E. of NE				36	37		no	307				102	73																								
"	"	NE 1/4 of NW 1/4				40			no	420				170	100																								
"	"	NW 1/4 of NW 1/4				40			no	655				218	156																								
"	"	SW 1/4 of NW 1/4	2	86	ac	39	14		no	311				104	74																								
"	"	SE 1/4 of NW 1/4	11	49	ac	28	51		no	235				78	56																								
"	"	NE 1/4 of SW 1/4	4	36	ac																																		
"	"	NW 1/4 of SW 1/4	6	30	ac																																		
"	"	SW 1/4 of SW 1/4																																					
"	"	SE 1/4 of SW 1/4																																					
R.R. Ring	"	NE 1/4 of SE 1/4				40			no	336	124		1610	537	466																								
"	"	NW 1/4 of SE 1/4				40			no	479				160	114																								
"	"	SW 1/4 of SE 1/4				40			no	378				126	90																								
"	"	SE 1/4 of SE 1/4				40			no	470				159	112																								
						44	69			3165	458		4933																										
										4431	1274		5705																										

3982 319

727 727

6791 6899 (Statement No 303)

1138 1138

2007 2008

27073

4711

Assessment Roll and Tax List of Unplatted Real Property in the Town of May
 Unplatted Real Estate Assessed at 33 1/3 Per Cent of True and Full Value; Attached Machinery at 33 1/3 Per Cent of True and Full Value. Homesteads, up to true and full value of \$4000, assessable at 20 Per Cent, Class 3B; Remainder at 33 1/3 Per Cent, Class 3.

IN WHOSE NAME ASSESSED	TO WHOM TRANSFERRED	DESCRIPTION OF PROPERTY					No. School District	Indicate Homestead	ASSESSOR'S VALUATIONS					EQUALIZED VALUES					SOLD FOR TAXES							
		SUBDIVISION	Sec. or Lot	Town or Block	Range	Number of Acres of Land			Total True and Full Value of Land Exclusive of Structures and Improvements	Structures and Improvements True and Full Value of Buildings and other Structures Permanently Attached to Real Estate	Total True and Full Value of Land Including All Structures, Improvements and Machinery	Assessed Value of Homestead up to \$4000 at 20 Per Cent Class 3B	Assessed Value of Remainder at 33 1/3 per cent Class 3	Total Assessed Value of Land Including All Structures, Improvements and Machinery	Total Assessed Value As Equalized by the Board of Review	Total Assessed Value As Equalized by the County Board	Total Assessed Value As Equalized by the Minnesota Tax Commission									
																		Dollars		Dollars	Dollars	Dollars	Dollars	Dollars	Dollars	Dollars
																		Acre		100s	Dollars	Dollars	Dollars	Dollars	Dollars	Dollars
<i>W. H. Hardy</i>	<i>Helie Larson</i>	1	26	133	31	40	1	710	336	400	112	80														
		2				54		700	467	1027	594	180														
		3																								
<i>Minnesota Power Light Co.</i>		4				39		700	336	844	112	80														
		5																								
		6				34		700	336	744	112	80														
		7				29		700	252	744	84	60														
		8																								
		9																								
		10																								
		11																								
		12																								
		13																								
		14																								
		15																								
		16																								
		17																								
		18																								
		19																								
		20																								

203 24 *1220 100* *1350* *460 400*
1722 *134* *1954* *418 1618*

Cass County, Minnesota, for Taxes for the Year 1934.

VALUATIONS BY SCHOOL DISTRICTS AS EQUALIZED BY TAX COMMISSION				Total General Tax	SPECIAL TAXES				TOTAL TAXES	PAID	WHEN PAID	Number of Receipt	March Settlement 1935	June Settlement 1935	Penalty	November Settlement 1935	Penalty	Collections to First Monday in January 1936	Penalty	Delinquent on First Monday in January 1936	Penalty	Total Delinquent Tax and Penalty	REMARKS	
District No.	District Rate	District No.	District Rate		Ditch No.	Ditch Rate	Ditch No.	Ditch Rate																
Dollars	Mills	Dollars	Mills		Dollars	Mills	Dollars	Mills																
		101						1596	1	PAID IN FULL	JUN 4 1935	4552		4409	✓									
		178						2813	2	PAID IN FULL	JUN 4 1935													
		101						1596	4	PAID IN FULL	APR 22 1934	2944		1596	✓									
		101						1596	6	PAID IN FULL	APR 22 1934	2944		1596	✓									
		76						1201	7	PAID IN FULL	APR 22 1934	2944		1201	✓									

557

8801

Assessment Roll and Tax List of Unplatted Real Property in the Town of May of May

Unplatted Real Estate Assessed at 33 1/3 Per Cent of True and Full Value; Attached Machinery at 33 1/3 Per Cent of True and Full Value. Homesteads, up to true and full value of \$4000, assessable at 20 Per Cent, Class 3B; Remainder at 33 1/3 Per Cent, Class 3.

Cass County, Minnesota, for Taxes for the Year 1934.

Table with columns: IN WHOSE NAME ASSESSED, TO WHOM TRANSFERRED, DESCRIPTION OF PROPERTY, ASSESSOR'S VALUATIONS, EQUALIZED VALUES, VALUATIONS BY SCHOOL DISTRICTS AS EQUALIZED BY TAX COMMISSION, SPECIAL TAXES, TOTAL TAXES, PAID, WHEN PAID, Number of Receipt, March Settlement 1935, June Settlement 1935, November Settlement 1935, Penalty, Collections to First Monday in January 1936, Delinquent on First Monday in January 1935, Total Delinquent Tax and Penalty, REMARKS.

Assessment Roll and Tax List of Unplatted Real Property in the Town of May, Minnesota, for Taxes for the Year 1934.

Cass County, Minnesota, for Taxes for the Year 1934.

Main assessment table with columns: IN WHOSE NAME ASSESSED, TO WHOM TRANSFERRED, DESCRIPTION OF PROPERTY, ASSESSOR'S VALUATIONS, EQUALIZED VALUES, VALUATIONS BY SCHOOL DISTRICTS AS EQUALIZED BY TAX COMMISSION, SPECIAL TAXES, TOTAL TAXES, PAID, WHEN PAID, Number of Receipt, March Settlement 1935, June Settlement 1935, November Settlement 1935, Collections to First Monday in January 1936, Delinquent on First Monday in January 1936, Total Delinquent Tax and Penalty, REMARKS.

Assessment Roll and Tax List of Unplatted Real Property in the Town of May

Unplatted Real Estate Assessed at 33 1/3 Per Cent of True and Full Value; Attached Machinery at 33 1/3 Per Cent of True and Full Value. Homesteads, up to true and full value of \$4000, assessable at 20 Per Cent, Class 33; Remainder at 33 1/3 Per Cent, Class 3.

Table with columns: IN WHOSE NAME ASSESSED, TO WHOM TRANSFERRED, SUBDIVISION, ASSESSOR'S VALUATIONS, EQUALIZED VALUES, SOLD FOR TAXES. Includes handwritten entries for J. Durbin, W. Kendall, Jay C. Andrews, J. P. Walker & Red River Lbr. Co., and Charles E. Green & Emma B. Lorber.

Cass County, Minnesota, for Taxes for the Year 1934.

Table with columns: VALUATIONS BY SCHOOL DISTRICTS AS EQUALIZED BY TAX COMMISSION, SPECIAL TAXES, TOTAL TAXES, PAID, WHEN PAID, Number of Receipt, March Settlement 1935, June Settlement 1935, November Settlement 1935, Collections to First Monday in January 1936, Delinquent on First Monday in January 1936, Total Delinquent Tax and Penalty, REMARKS.

Assessment Roll and Tax List of Unplatted Real Property in the Town of May, Minnesota. Unplatted Real Estate Assessed at 33 1/3 Per Cent of True and Full Value; Attached Machinery at 33 1/3 Per Cent of True and Full Value. Homesteads, up to true and full value of \$4000, assessable at 20 Per Cent, Class 3B; Remainder at 33 1/3 Per Cent, Class 3.

Table with columns: IN WHOSE NAME ASSESSED, TO WHOM TRANSFERRED, SUBDIVISION, ASSESSOR'S VALUATIONS, EQUALIZED VALUES, SOLD FOR TAXES. Includes handwritten entries for Ed Bolton, Paul R. Kiesel, John M. Schmidt, Frank Swanson, Leonard Margas, Esther Widman.

Cass County, Minnesota, for Taxes for the Year 1934.

Table with columns: VALUATIONS BY SCHOOL DISTRICTS AS EQUALIZED BY TAX COMMISSION, SPECIAL TAXES, TOTAL TAXES, PAID, WHEN PAID, Number of Receipt, March Settlement 1935, June Settlement 1935, November Settlement 1935, Collections to First Monday in January 1936, Delinquent on First Monday in January 1936, Total Delinquent Tax and Penalty, REMARKS. Includes handwritten entries for 101, 1065, 1065, 113, 1192, 1192, 131, 1382, 57, 1688, 95, 1002, 1435, 1181, 1329, 1287, 149, 60, 76, 183, 1930, 1835, 19356.

Assessment Roll and Tax List of Unplatted Real Property in the Town of May

Unplatted Real Estate Assessed at 33 1/3 Per Cent of True and Full Value; Attached Machinery at 33 1/3 Per Cent of True and Full Value. Homesteads, up to true and full value of \$4000, assessable at 20 Per Cent, Class 3B; Remainder at 33 1/3 Per Cent, Class 3.

Cass County, Minnesota, for Taxes for the Year 1934.

Table with columns: IN WHOSE NAME ASSESSED, TO WHOM TRANSFERRED, DESCRIPTION OF PROPERTY, ASSESSOR'S VALUATIONS, EQUALIZED VALUES, VALUATIONS BY SCHOOL DISTRICTS AS EQUALIZED BY TAX COMMISSION, SPECIAL TAXES, TOTAL TAXES, PAID, WHEN PAID, Number of Receipt, March Settlement 1935, June Settlement 1935, November Settlement 1935, Collections to First Monday in January 1936, Delinquent on First Monday in January 1936, Total Delinquent Tax and Penalty, REMARKS.

Assessment Roll and Tax List of Unplatted Real Property in the of May

Unplatted Real Estate Assessed at 33 1/3 Per Cent of True and Full Value; Attached Machinery at 33 1/3 Per Cent of True and Full Value. Homesteads, up to true and full value of \$4000, assessable at 20 Per Cent, Class 3B; Remainder at 33 1/3 Per Cent, Class 3.

Table with columns: IN WHOSE NAME ASSESSED, TO WHOM TRANSFERRED, SUBDIVISION, Assessor's Valuations (True and Full Value of Land, Structures and Improvements, etc.), Equalized Values, and SOLD FOR TAXES.

Cass County, Minnesota, for Taxes for the Year 1934.

Table with columns: VALUATIONS BY SCHOOL DISTRICTS AS EQUALIZED BY TAX COMMISSION, SPECIAL TAXES (Ditch, etc.), TOTAL TAXES, PAID, WHEN PAID, Number of Receipt, March Settlement, June Settlement, November Settlement, Penalties, Collections to First Monday in January, Delinquent on First Monday in January, Total Delinquent Tax and Penalty, and REMARKS.

Assessment Roll and Tax List of Unplatted Real Property in the Town of May of May

Unplatted Real Estate Assessed at 33 1/3 Per Cent of True and Full Value; Attached Machinery at 33 1/3 Per Cent of True and Full Value. Homesteads, up to true and full value of \$4000, assessable at 20 Per Cent, Class 3B; Remainder at 33 1/3 Per Cent, Class 3.

Table with columns: IN WHOSE NAME ASSESSED, TO WHOM TRANSFERRED, DESCRIPTION OF PROPERTY, ASSESSOR'S VALUATIONS, EQUALIZED VALUES, SOLD FOR TAXES. Includes handwritten entries for various property lots and names like 'Wm. Munsterman' and 'Tom. Fred. Berndt'.

Cass County, Minnesota, for Taxes for the Year 1934.

Table with columns: VALUATIONS BY SCHOOL DISTRICTS AS EQUALIZED BY TAX COMMISSION, SPECIAL TAXES, TOTAL TAXES, PAID, WHEN PAID, Number of Receipt, March Settlement 1935, June Settlement 1935, November Settlement 1935, Collections to First Monday in January 1936, Delinquent on First Monday in January 1936, Total Delinquent Tax and Penalty, REMARKS. Includes handwritten tax amounts and payment dates.

Assessment Roll and Tax List of Unplatted Real Property in the Town of May of Cass County, Minnesota, for Taxes for the Year 1934.

Unplatted Real Estate Assessed at 33 1/3 Per Cent of True and Full Value; Attached Machinery at 33 1/3 Per Cent of True and Full Value. Homesteads, up to true and full value of \$4000, assessable at 20 Per Cent, Class 3B; Remainder at 33 1/3 Per Cent, Class 3.

Table with columns: IN WHOSE NAME ASSESSED, TO WHOM TRANSFERRED, DESCRIPTION OF PROPERTY, ASSESSOR'S VALUATIONS, EQUALIZED VALUES, and SOLD FOR TAXES. Includes handwritten entries for names like Albert Ellgen, N. Benedix, Otto Albert Kohler, Sam Harnego, and H. Benedix.

Cass County, Minnesota, for Taxes for the Year 1934.

Table with columns: VALUATIONS BY SCHOOL DISTRICTS AS EQUALIZED BY TAX COMMISSION, SPECIAL TAXES, and PAID WHEN PAID. Includes columns for District No., Rate, Total General Tax, and various settlement dates and amounts.

Assessment Roll and Tax List of Unplatted Real Property in the Town of May of May

Unplatted Real Estate Assessed at 33 1/3 Per Cent of True and Full Value; Attached Machinery at 33 1/3 Per Cent of True and Full Value; Homesteads, up to true and full value of \$4000, assessable at 20 Per Cent., Class 3B; Remainder at 33 1/3 Per Cent., Class 3.

Cass County, Minnesota, for Taxes for the Year 1934.

Main table with columns: IN WHOSE NAME ASSESSED, TO WHOM TRANSFERRED, DESCRIPTION OF PROPERTY, ASSESSOR'S VALUATIONS, EQUALIZED VALUES, VALUATIONS BY SCHOOL DISTRICTS AS EQUALIZED BY TAX COMMISSION, SPECIAL TAXES, PAID, WHEN PAID, Number of Receipt, March Settlement, June Settlement, November Settlement, Collections to First, Delinquent on First, Total Delinquent Tax and Penalty, REMARKS.

Handwritten names: Ferdinand C. Miller, Charles G. Brandlaw, Tom Heigl, Tom K. Mitter, Tom Mitter.

SOLD FOR TAXES

Handwritten notes: NOV 5 1933, MAY 16 1933, NOV 5 1933, MAY 7 1933, NOV 30 1933, MAY 7 1933, NOV 30 1933, MAY 7 1933, NOV 30 1933, MAY 7 1933.

Handwritten numbers: 7464, 3292, 8090, 3295.

Handwritten numbers: 1920, 104, 7888.

Handwritten note: Statement 3581.

Summary totals for columns: 5040, 13025, 4340, 615, 1400, 744, 7056, 1433, 8489, 821, 1459, 2280.

21649

7054

Assessment Roll and Tax List of Unplatted Real Property in the Town of May

Unplatted Real Estate Assessed at 33 1/3 Per Cent of True and Full Value; Attached Machinery at 33 1/3 Per Cent of True and Full Value. Homesteads, up to true and full value of \$4000, assessable at 20 Per Cent, Class 3B; Remainder at 33 1/3 Per Cent, Class 3.

Cass County, Minnesota, for Taxes for the Year 1934.

Table with columns: IN WHOSE NAME ASSESSED, TO WHOM TRANSFERRED, DESCRIPTION OF PROPERTY, ASSESSOR'S VALUATIONS, EQUALIZED VALUES, SOLD FOR TAXES, VALUATIONS BY SCHOOL DISTRICTS AS EQUALIZED BY TAX COMMISSION, SPECIAL TAXES, TOTAL TAXES, PAID, WHEN PAID, Number of Receipts, March Settlement 1935, June Settlement 1935, November Settlement 1935, Collections to First Monday in January 1936, Debit on First Monday in January 1936, Total Delinquent Tax and Penalty, REMARKS.

Assessment Roll and Tax List of Unplatted Real Property in the Town of Lawn of May County, Minnesota. Homesteads, up to true and full value of \$4000, assessable at 20 Per Cent., Class 3B; Remainder at 33 1/3 Per Cent., Class 3.

Table with columns: IN WHOSE NAME ASSESSED, TO WHOM TRANSFERRED, DESCRIPTION OF PROPERTY, ASSESSOR'S VALUATIONS, EQUALIZED VALUES, and SOLD FOR TAXES. Includes handwritten entries for Arthur J. Dahl, H. W. Conover, V. Lockwood, and Frank H. Parker.

Cass County, Minnesota, for Taxes for the Year 1934.

Table with columns: VALUATIONS BY SCHOOL DISTRICTS AS EQUALIZED BY TAX COMMISSION, SPECIAL TAXES, TOTAL TAXES, PAID, WHEN PAID, Number of Receipt, March Settlement 1935, June Settlement 1935, Penalty, November Settlement 1935, Penalty, Collections to First Monday in January 1936, Delinquent on First Monday in January 1936, Penalty, Total Delinquent Tax and Penalty, and REMARKS.

Assessment Roll and Tax List of Unplatted Real Property in the Town of May, Minnesota. Unplatted Real Estate Assessed at 33 1/3 Per Cent of True and Full Value; Attached Machinery at 33 1/3 Per Cent of True and Full Value; Homesteads, up to true and full value of \$4000, assessable at 20 Per Cent, Class 3B; Remainder at 33 1/3 Per Cent, Class 3.

DESCRIPTION OF PROPERTY, ASSESSOR'S VALUATIONS, EQUALIZED VALUES

Table with columns: IN WHOSE NAME ASSESSED, TO WHOM TRANSFERRED, SUBDIVISION, Rec. or Lot, Town or Block, Range, Number of Acres of Land, No. School District, Indicate Homestead, True and Full Value of Land, Structures and Improvements, Total True and Full Value of Land, Assessed Value of Homesteads, Assessed Value of Remainder, Total Assessed Value, Total Assessed Value As Equalized by the Board of Review, Total Assessed Value As Equalized by the County Board, Total Assessed Value As Equalized by the Minnesota Tax Commission, SOLD FOR TAXES.

Cass County, Minnesota, for Taxes for the Year 1934.

Table with columns: VALUATIONS BY SCHOOL DISTRICTS AS EQUALIZED BY TAX COMMISSION, SPECIAL TAXES, TOTAL TAXES, PAID, WHEN PAID, Number of Receipt, March Settlement 1935, June Settlement 1935, Penalty, November Settlement 1935, Penalty, Collections to First Monday in January 1936, Delinquent on First Monday in January 1936, Total Delinquent Tax and Penalty, REMARKS.

Assessment Roll and Tax List of Unplatted Real Property in the _____ of _____
 Unplatted Real Estate Assessed at 33 1/3 Per Cent of True and Full Value; Attached Machinery at 33 1/3 Per Cent of True and Full Value. Homesteads, up to true and full value of \$4000, assessable at 20 Per Cent, Class 3B; Remainder at 33 1/3 Per Cent, Class 3.

IN WHOSE NAME ASSESSED	TO WHOM TRANSFERRED	DESCRIPTION OF PROPERTY						ASSESSOR'S VALUATIONS						EQUALIZED VALUES			SOLD FOR TAXES		
		SUBDIVISION	Sec. or Lot	Town or Block	Range	Number of Acres of Land	No. School District	Indicate Homestead	True and Full Value of Land Exclusive of Structures and Improvements	Structures and Improvements		Total True and Full Value of Land Including All Structures, Improvements and Machinery	Assessed Value of Homesteads up to \$4000 at 20 Per Cent Class 3B	Assessed Value of Remainder at 33 1/3 per cent Class 3	Total Assessed Value of Lands Including all Structures, Improvements and Machinery	Total Assessed Value As Equalized by the Board of Review		Total Assessed Value As Equalized by the County Board	Total Assessed Value As Equalized by the Minnesota Tax Commission
										True and Full Value of Buildings and other Structures	True and Full Value of Machinery Permanently Attached to Real Estate								
		Dollars	Dollars	Dollars	Dollars	Dollars	Dollars	Dollars	Dollars	Dollars	Dollars	Dollars	Dollars	Dollars	Dollars	Dollars		Dollars	
1		NE 1/4 of NE 1/4																	
2		NW 1/4 of NE 1/4																	
3		SW 1/4 of NE 1/4																	
4		SE 1/4 of NE 1/4																	
5																			
6		NE 1/4 of NW 1/4																	
7		NW 1/4 of NW 1/4																	
8		SW 1/4 of NW 1/4																	
9		SE 1/4 of NW 1/4																	
10																			
11		NE 1/4 of SW 1/4																	
12		NW 1/4 of SW 1/4																	
13		SW 1/4 of SW 1/4																	
14		SE 1/4 of SW 1/4																	
15																			
16		NE 1/4 of SE 1/4																	
17		NW 1/4 of SE 1/4																	
18		SW 1/4 of SE 1/4																	
19		SE 1/4 of SE 1/4																	
20																			

Tabular Statement of Taxable Unplatted Real Estate Assessment of the Town of _____, County of _____, Minn., for the Year 1934.
 HOMESTEADS, up to True and Full Value of \$4,000.00, Assessable at 20 per cent, Class 3B, Remainder at 33 1/3 per cent, Class 3.

No. OF ACRES OF LAND	Indicate Homestead	ASSESSOR'S VALUATIONS										EQUALIZED VALUATIONS		
		True and Full Value of Land Exclusive of Structures and Improvements	STRUCTURES AND IMPROVEMENTS		Total True and Full Value of Land Including all Structures, Improvements and Machinery	Assessed Value of Homesteads up to \$4,000 at 20 per cent Class 3B	Assessed Value of Remainder at 33 1/3 per cent Class 3	Total Assessed Value of Land Including all Structures, Improvements and Machinery	Total Assessed Value as Equalized by Board of Review	Total Assessed Value as Equalized by County Board	Total Assessed Value as Equalized by the Minnesota Tax Commission			
			True and Full Value of Buildings and other Structures	True and Full Value of Machinery Permanently Attached to Real Estate										
		Dollars	Dollars	Dollars	Dollars	Dollars	Dollars	Dollars	Dollars	Dollars	Dollars			
640		5208		5208		1736	1736							
630 72		5192	1557	6607	1288	1240	2082	1555						
626 40		4419	213	4632	531	1256	1787							
623 68		4717	1343	6060	1180	1860	1860							
624 21		1354	1536	2890	585	886	1481	2373						
935 92		2226	1396	3622	662	1104	1772							
820 36		8423	1890	10313	1079	1640	2719							
640		2187	1760	3947	828	1198	2026							
480		3712	1734	5446	1125	1495	1995							
640		4887	984	5871	1237	2437	2501							
520		3780	1320	5100	1238	140	1378							
640		2240	231	2471	523	532	1055							
600		4783	1155	5938	1806	469	1775							
640		4617	1050	5667	1174	325	1513							
640		6028	440	6468	645	1081	1726							
440 55		4578	423	5001	438	389	1412							
459 36		3564	284	3848	197	857	1056							
33 49		281		281		94	94							
9 72		84		84		28	28							
216 38		155		155		43	43							

