

Assessment & Tax List - 1963
Hiram

DIRECTIONS TO ASSESSOR

OFFICE OF COUNTY AUDITOR, 1963.

To _____ County, Minn. Assessor of the _____

According to the requirements of law, I herewith deliver to you the Assessment Books for the _____ of _____ for the year 1963, as the same has come to my knowledge from any source, and I hereby direct you to assess such Real Estate and all Personal Property, and make such changes in Real Estate as are required in the old-numbered year, and make return thereof as required by the laws of the State of Minnesota prescribing the duties of the assessor.

A form of the return to be signed by you is appended in this book.

County Auditor.

Extracts from Laws Relating to the Listing of Personal Property Section Numbers refer to Minnesota Statutes

Sec. 272.01. PROPERTY SUBJECT TO TAXATION. All real and personal property in this state, and all personal property of persons residing therein, is taxable, except such as is by law exempt from taxation.

WHEN LISTED AND ASSESSED Sec. 273.01. Personal Property shall be listed and assessed on the first day, shall be listed by or for the persons acquiring it.

Sec. 273.22. By whom listed. Personal Property shall be listed in the manner following: 1. Every person of full age and sound mind, being a resident of this state, shall list the real estate owned by him in the town or district where the same is located, and in the name of his principal, as merchant, agent, partner or otherwise.

Sec. 273.26. Where listed. Except as otherwise in this chapter provided, the property of a person shall be listed in the town or district in which the principal place of business of such person is located.

Sec. 273.30. Farm property of non-resident. When the owner of real estate in this state is a non-resident, the property shall be listed in the town or district in which the principal place of business of the owner is located.

Sec. 273.33. Pipeline Companies. Subdivision 1. Personal property of pipeline companies engaged in the business of transporting gas or oil through pipelines in this state shall be listed and assessed in the county, town, or district where the same is usually kept.

Sec. 273.35. Gas and Water Companies. The personal property of gas and water companies shall be listed and assessed in the town or district in which the principal place of business of the company is located.

Sec. 273.37. Electric Light and Power Companies and others supplying electric light and power. The personal property of electric light and power companies shall be listed and assessed in the town or district in which the principal place of business of the company is located.

Sec. 273.39. Electric Light and Power Companies and others supplying electric light and power. The personal property of electric light and power companies shall be listed and assessed in the town or district in which the principal place of business of the company is located.

Sec. 273.41. Electric Light and Power Companies and others supplying electric light and power. The personal property of electric light and power companies shall be listed and assessed in the town or district in which the principal place of business of the company is located.

Sec. 273.43. Electric Light and Power Companies and others supplying electric light and power. The personal property of electric light and power companies shall be listed and assessed in the town or district in which the principal place of business of the company is located.

Sec. 273.45. Electric Light and Power Companies and others supplying electric light and power. The personal property of electric light and power companies shall be listed and assessed in the town or district in which the principal place of business of the company is located.

Sec. 273.47. Electric Light and Power Companies and others supplying electric light and power. The personal property of electric light and power companies shall be listed and assessed in the town or district in which the principal place of business of the company is located.

Sec. 273.49. Electric Light and Power Companies and others supplying electric light and power. The personal property of electric light and power companies shall be listed and assessed in the town or district in which the principal place of business of the company is located.

Sec. 273.51. Electric Light and Power Companies and others supplying electric light and power. The personal property of electric light and power companies shall be listed and assessed in the town or district in which the principal place of business of the company is located.

Sec. 273.53. Electric Light and Power Companies and others supplying electric light and power. The personal property of electric light and power companies shall be listed and assessed in the town or district in which the principal place of business of the company is located.

Sec. 273.55. Electric Light and Power Companies and others supplying electric light and power. The personal property of electric light and power companies shall be listed and assessed in the town or district in which the principal place of business of the company is located.

Sec. 273.57. Electric Light and Power Companies and others supplying electric light and power. The personal property of electric light and power companies shall be listed and assessed in the town or district in which the principal place of business of the company is located.

Sec. 273.59. Electric Light and Power Companies and others supplying electric light and power. The personal property of electric light and power companies shall be listed and assessed in the town or district in which the principal place of business of the company is located.

Sec. 273.61. Electric Light and Power Companies and others supplying electric light and power. The personal property of electric light and power companies shall be listed and assessed in the town or district in which the principal place of business of the company is located.

Sec. 273.63. Electric Light and Power Companies and others supplying electric light and power. The personal property of electric light and power companies shall be listed and assessed in the town or district in which the principal place of business of the company is located.

Sec. 273.65. Electric Light and Power Companies and others supplying electric light and power. The personal property of electric light and power companies shall be listed and assessed in the town or district in which the principal place of business of the company is located.

Sec. 273.67. Electric Light and Power Companies and others supplying electric light and power. The personal property of electric light and power companies shall be listed and assessed in the town or district in which the principal place of business of the company is located.

Sec. 273.69. Electric Light and Power Companies and others supplying electric light and power. The personal property of electric light and power companies shall be listed and assessed in the town or district in which the principal place of business of the company is located.

Sec. 273.71. Electric Light and Power Companies and others supplying electric light and power. The personal property of electric light and power companies shall be listed and assessed in the town or district in which the principal place of business of the company is located.

Sec. 273.73. Electric Light and Power Companies and others supplying electric light and power. The personal property of electric light and power companies shall be listed and assessed in the town or district in which the principal place of business of the company is located.

Sec. 273.75. Electric Light and Power Companies and others supplying electric light and power. The personal property of electric light and power companies shall be listed and assessed in the town or district in which the principal place of business of the company is located.

Sec. 273.77. Electric Light and Power Companies and others supplying electric light and power. The personal property of electric light and power companies shall be listed and assessed in the town or district in which the principal place of business of the company is located.

Sec. 273.79. Electric Light and Power Companies and others supplying electric light and power. The personal property of electric light and power companies shall be listed and assessed in the town or district in which the principal place of business of the company is located.

Sec. 273.81. Electric Light and Power Companies and others supplying electric light and power. The personal property of electric light and power companies shall be listed and assessed in the town or district in which the principal place of business of the company is located.

Sec. 273.83. Electric Light and Power Companies and others supplying electric light and power. The personal property of electric light and power companies shall be listed and assessed in the town or district in which the principal place of business of the company is located.

Sec. 273.85. Electric Light and Power Companies and others supplying electric light and power. The personal property of electric light and power companies shall be listed and assessed in the town or district in which the principal place of business of the company is located.

Sec. 273.87. Electric Light and Power Companies and others supplying electric light and power. The personal property of electric light and power companies shall be listed and assessed in the town or district in which the principal place of business of the company is located.

Sec. 273.89. Electric Light and Power Companies and others supplying electric light and power. The personal property of electric light and power companies shall be listed and assessed in the town or district in which the principal place of business of the company is located.

Sec. 273.91. Electric Light and Power Companies and others supplying electric light and power. The personal property of electric light and power companies shall be listed and assessed in the town or district in which the principal place of business of the company is located.

Sec. 273.93. Electric Light and Power Companies and others supplying electric light and power. The personal property of electric light and power companies shall be listed and assessed in the town or district in which the principal place of business of the company is located.

Sec. 273.95. Electric Light and Power Companies and others supplying electric light and power. The personal property of electric light and power companies shall be listed and assessed in the town or district in which the principal place of business of the company is located.

Sec. 273.97. Electric Light and Power Companies and others supplying electric light and power. The personal property of electric light and power companies shall be listed and assessed in the town or district in which the principal place of business of the company is located.

The forms in this book are prescribed for the 1963 assessment by The Commissioner of Taxation

Minnesota Statutes, Section 270.07. The commissioner of taxation shall prescribe the form of all blanks and books required under this chapter . . .

Minnesota Statutes, Section 273.03. The county auditor shall annually provide the necessary assessment books and blanks at the expense of the county, for and to correspond with each assessment district. He shall make out, in the real property assessment book, complete lists of all lands or lots subject to taxation, showing the names of the owners, if to him known; and, if unknown, so stated opposite each tract or lot, the number of acres, and the lots or parts of lots or blocks included in each description of property. . . .

Minnesota Statutes, Section 273.04. The assessors and at least one member of each local board of review shall meet at the office of the county auditor on a day to be fixed by the commissioner of taxation for the purpose of receiving instructions as to their duties under the laws of the state. Each assessor attending such meetings shall receive as compensation for such service the sum of \$7.50 per day for each day necessarily consumed in attending such meeting, and mileage at the rate of seven cents per mile, and each board of review member the sum of \$6.00 per day and mileage at the rate of five cents per mile for each mile necessarily traveled in going from his home to and returning from the county seat, to be computed by the usually traveled route, and paid out of the county treasury upon the warrant of the county auditor.

REAL PROPERTY BECOMING SUBJECT TO TAXATION SINCE THE LAST PREVIOUS ASSESSMENT OR OMITTED FROM ASSESSMENT ROLLS THE PREVIOUS YEARS.
Assessment of Taxable Real Property in the _____ of _____, County of _____, Minn., for the Year 19____.
** Indicate Type of Property: R-Residential, C-Commercial, I-Industrial, U-Utility, F-Farm, L-Lakeshore, T-Timber, M-Mineral*

Form 314 - VALUE-DATA COMPANY, MINNEAPOLIS

NAME OF OWNER	School District	DESCRIPTION OF PROPERTY						TRUE AND FULL VALUATIONS										FINAL EQUALIZED VALUE Dollars					
		SUBDIVISION	Sec. or Lot	Twp. or Block	Rng.	Number of Acres of Land		Indicate Homestead Yes or No	Indicate Agricultural Yes or No	Indicate Type of Property	BY WHOM VALUED	LAND Exclusive of Structures and Improvements Dollars	BUILDINGS and Other Structures Dollars	MACHINERY Permanently Attached to Real Estate Dollars	TOTAL True and Full Value Dollars	ASSESSED VALUATIONS				TOTAL ASSESSED VALUE Dollars			
						Acres	100ths									RURAL	ALL OTHER		MACHINERY				
															Homestead Up to \$4,000 20% Dollars	Over \$4,000 and Non-Homestead 33 1/3 % Dollars	Homestead Up to \$4,000 25% Dollars	Over \$4,000 and Non-Homestead 40% Dollars	Permanently Attached to Real Estate 33 1/3 % Dollars				
1																							
2																							
3																							
4																							
5																							
6																							
7																							
8																							

Total No. of Acres _____
 Total Value as Equalized by _____
 Total Value as Assessed by _____

SUMMARY OF TAX COLLECTION

Original Levy	- - - - -	\$ 57,116.02
Additions	- - - - -	\$ _____
Abatements	- - - - -	\$ 126.98
		\$ 36,989.04

COLLECTIONS

March Settlement	- - - - -	\$ 4,139.43
June Settlement	- - - - -	\$ 20,751.73
November Settlement	- - - - -	\$ 9,112.05
January Settlement	- - - - -	\$ 2,985.90
		\$ _____
Over Collected	- - - - -	\$ 4.70
Under Collected	- - - - -	\$ _____
Delinquent	- - - - -	\$ 2,694.63
Total	- - - - -	\$ 36,989.04

LONG BEACH SHADY SHORES WHITE PINE BEACH PULMOUTH BEACH THE ARRANGEMENT OF LOT 20 NORTH RITZLAND

NAME OF OWNER

TABULAR SCHEDULE OF VALUATIONS,

LEVIED IN THE Town OF Hiram

RATES AND TAXES

COUNTY OF CASS, STATE OF MINNESOTA

School District No.	VALUATION BY SCHOOL DISTRICTS				RATE OF STATE TAXES	RATE OF COUNTY TAXES								RATE OF TOWN TAXES										RATE OF SCHOOL TAXES		TAXES LEVIED											
	Agri-cultural Lands	Non-Agri-cultural Lands	Personal Property	Total Value of all Property except Money and Credits		Rev.	R. & B.	Welfare	Bonds and Int.	C.H. Bldg. Law	Total Rate of County Tax	Rev.	R. & B.	State Loan	Fire	Local	Special	State Loan	Deficiency	Tuition	Transportation	Local	Special	State Loan	Deficiency	Tuition	Transportation	Local 1 Mill	Special	State Loan	Deficiency	Tuition	Transportation	FUNDS	Rate	Amounts	
1	Um	65,412	62,757	11,496	139,665	11.822	31.51	20.59	51.19	2.51	5.17	122.83	4.66	15.76	5.																						
2																																					
3																																					
4																																					
5	Assessed Value	Rural	All Other	Personal Property	Total																																
5	Homestead	20,170			20,170																																
5	Non-Homestead	107,999		11,496	119,495																																
5	Total	128,169		11,496	139,665																																
6																																					
7																																					
8																																					

Total Levy, \$ 37,116.02

Total Number of Acres 6,226.90

State of Minnesota, }
 COUNTY OF CASS }
 Auditor of said County and State aforesaid, do hereby certify that the foregoing is a true and correct Schedule, showing the valuation of all the taxable property, in the County of Hiram, in said County, the several rates of Taxation and Totals of the several Tax Funds levied thereon for the year A. D. 1963, Pyralle 1964

Witness my hand and official seal, this 26th day of December, A. D. 1963

SEAL

Edwin J. Barney County Auditor

Total Taxes Real Estate 34,068.08
 Pers. Prop. 3,047.94
 Total 37,116.02

LONG BEACH SHADY SHORES WHITE PINE BEACH PLYMOUTH BEACH THE ARRANGEMENT OF LOT 29 NORTH OF WHITE PINE BEACH RITZLAND

Assessment of T

COLLECTIONS OF TAXES OF 196

OF

CASS COUNTY, MINNESOTA

Form 316 - MARCH 1964

NAME OF OWNER

1

2

3

4

5

6

7

8

FUNDS	MARCH SETTLEMENT 1964	JUNE SETTLEMENT 1964	NOV. SETTLEMENT 1964	Amount Collected from Nov. 19, 1964, to First Monday in Jan. 1965	REDUCTIONS	Total Reductions and Collected	BALANCE UNCOLLECTED	ADDITIONS	Total Uncollected to First Monday in January, 1965
State-Non-Homestead,	72 06	600 10	248 36	7 34					
State-Homestead,	71 81	636 44	277 81	8 79					
County Revenue,	492 89	2460 64	1081 83	35 68					
County Road and Bridge,	312 84	1861 82	686 66	22 65					
County Welfare,	930 88	4647 18	2043 16	67 38					
County Bond and Interest,	30 03	149 93	65 92	2 17					
Ague. Anon	751	37 48	16 48	5 4					
Transp.	18 46	92 15	40 51	1 33					
Co. Nurse	13 76	68 72	30 22	1 00					
Town Revenue,	72 89	363 90	159 99	5 28					
Town Road and Bridge,	246 52	1230 71	541 09	17 85					
Town State Loan,									
P.C.P.A.	80 89	403 73	177 50	5 85					
Civil Defense	2 83	14 06	6 18	2 1					
C.H. Bldg.	31 28	156 18	68 67	2 27					
Fire	78 22	390 45	171 66	5 66					
School Local 1 Mill,									
School Special,	549 85	2318 36	1023 01	30 34					
School State Loan,									
Deficiency	1126 72	5624 88	2473 00	81 56					
Tuition									
Transportation									
	4139 43	20751 73	9112 05	295 90					

	LOCAL 1 MILL	SPECIAL	STATE LOAN	Deficiency	TOTALS
MARCH SETTLEMENT		75 87		278 20	349 07
		473 98		853 52	1327 50
Totals		549 85		1126 72	1676 57
JUNE SETTLEMENT		810 28		2918 21	3728 49
		1503 08		2706 67	4209 75
Totals		2313 36		5624 88	7938 24
NOVEMBER SETTLEMENT		350 31		1261 64	1611 95
		672 70		1211 36	1884 06
Totals		1023 01		2473 00	3496 01
NOVEMBER to JANUARY		14 97		53 88	68 85
		15 37		27 68	43 05
Totals		30 34		81 56	111 90
ADDITIONS					
Totals					
REDUCTIONS					
Totals					

LONG BEACH SHADY SHOES WHITE PINE BEACH PLANTERS BEACH RE ARRANGEMENT OF LOT 19 AUGUST RITZLAND

Assessment Roll and Tax List of Real Property in the Town of Hiram,
 * Indicate Type of Property: R-Residential, C-Commercial, I-Industrial, U-Utility, F-Farm, L-Lakeshore, T-Timber, M-Mineral

Cass County, Minnesota, for Taxes for the Year 1963.

Form 5CD MILLER-DAVIS CO., MINNEAPOLIS

Real Estate

IN WHOSE NAME ASSESSED	DESCRIPTION OF PROPERTY				No. School District	Indicate Homestead Yes or No	Agricultural Recr. Yes or No	* Indicate Type of Property	TRUE AND FULL VALUATIONS				ASSESSED VALUATIONS						FINAL EQUALIZED VALUE		
	SUBDIVISION	Sec. or Lot	Town or Block	Number of Acres of Land					LAND Exclusive of Structures and Improvements	BUILDINGS and Other Structures	MACHINERY Permanently Attached to Real Estate	TOTAL True and Full Value	RURAL		ALL OTHER		MACHINERY Permanently Attached to Real Estate	Seasonal and Recreational Cabins		TOTAL ASSESSED VALUE	Total Assessed Value as Equalized by the Board of Review
													Acres	100ths	Homestead Up to \$4,000	Over \$4,000 and Non-Homestead					
									Dollars	Dollars	Dollars	Dollars	Dollars	Dollars	Dollars	Dollars	Dollars				
	NE 1/4 of NE 1/4	2	141 31		Un																
	NW 1/4 of NE 1/4																				
	SW 1/4 of NE 1/4																				
	SE 1/4 of NE 1/4																				
	NE 1/4 of NW 1/4																				
	NW 1/4 of NW 1/4																				
	SW 1/4 of NW 1/4																				
	SE 1/4 of NW 1/4																				
	NE 1/4 of SW 1/4																				
	NW 1/4 of SW 1/4																				
	SW 1/4 of SW 1/4																				
	SE 1/4 of SW 1/4																				
	NE 1/4 of SE 1/4																				
	NW 1/4 of SE 1/4																				
	SW 1/4 of SE 1/4																				
	SE 1/4 of SE 1/4																				

SOLD FOR TAXES	VALUATIONS BY SCHOOL DISTRICTS AS EQUALIZED BY DEPARTMENT OF TAXATION						Tax Including State Homestead	State Tax on Non-Homestead	SPECIAL TAXES	SPECIAL TAXES	TOTAL TAXES	PAID	WHEN PAID	Number of Receipt	March Settlement 1964	June Settlement 1964	Penalty 1964	November Settlement 1964	Penalty	Collections to First Monday in January 1965	Penalty	Delinquent on First Monday in January 1965	Total Delinquent Tax and Penalty	REMARKS
	District No.	District No.	District No.	District No.	District No.	District No.																		
	Rate	Rate	Rate	Rate	Rate	Rate																		

LONG BEACH SHADY SHORES WHITE PINE BEACH PLYMOUTH BEACH BE ARRANGEMENT OF LOT 19 WEST RITZWOOD

Assessment Roll and Tax List of Real Property in the Town of Hiram

Form SCD - MILLER-DAVIS CO., MINNEAPOLIS

Table with columns: IN WHOSE NAME ASSESSED, DESCRIPTION OF PROPERTY, TRUE AND FULL VALUATIONS, ASSESSED VALUATIONS, FINAL EQUALIZED VALUE. Includes handwritten entries for Helen A. Dalton, Ernest F. + Alma M. Matthias, Gilbert A. + Grace Johnson, etc.

(continued)

2192

Cass County, Minnesota, for Taxes for the Year 1963.

Table with columns: SOLD FOR TAXES, VALUATIONS BY SCHOOL DISTRICTS AS EQUALIZED BY DEPARTMENT OF TAXATION, Tax Including State Homestead, State Tax on Non-Homestead, SPECIAL TAXES, TOTAL TAXES, PAID, WHEN PAID, Number of Receipt, March Settlement, June Settlement, Penalty, November Settlement, Collections to First Monday in January, Delinquent on First Monday in January, Total Delinquent Tax and Penalty, REMARKS.

LONG BEACH, SHADY SHORES, WHITE PINE BEACH, PLANTYER BEACH, ARRANGEMENT OF LOT 19, WHITE PINE BEACH, HURST, RYLAND

Assessment Roll and Tax List of Real Property in the Town of Hiram

* Indicate Type of Property: R-Residential, C-Commercial, I-Industrial, U-Utility, F-Farm, L-Lakeshore, T-Timber, M-Mineral

Cass County, Minnesota, for Taxes for the Year 1963.

Table with columns: IN WHOSE NAME ASSESSED, DESCRIPTION OF PROPERTY, TRUE AND FULL VALUATIONS, ASSESSED VALUATIONS, VALUATIONS BY SCHOOL DISTRICTS AS EQUALIZED BY DEPARTMENT OF TAXATION, Tax including State Homestead, SPECIAL TAXES, TOTAL TAXES, PAID, WHEN PAID, Number of Receipt, March Settlement 1964, June Settlement 1964, November Settlement 1964, Collections to First Monday in January 1965, Delinquent on First Monday in January 1965, Total Delinquent Tax and Penalty, REMARKS.

(Continued)

LONG BEACH, SHADY SHORES, WHITE PINE BEACH, PLANTATION BEACH, ARRANGEMENT OF LOT 19, WHITE PINE BEACH, HURST, RITZLAND

Assessment Roll and Tax List of Real Property in the Town of Hiram

Cass County, Minnesota, for Taxes for the Year 1963.

Form 500 MILLER-DAVIS CO., MINNEAPOLIS

* Indicate Type of Property: R-Residential, C-Commercial, I-Industrial, U-Utility, F-Farm, L-Lakeshore, T-Timber, M-Mineral

Main table with columns: IN WHOSE NAME ASSESSED, DESCRIPTION OF PROPERTY, TRUE AND FULL VALUATIONS, VALUATIONS BY SCHOOL DISTRICTS AS EQUALIZED BY DEPARTMENT OF TAXATION, TAXES, PAID, WHEN PAID, etc.

LONG BEACH, SHADY SHORES, WHITE PINE BEACH, PLATINUM BEACH, ARRANGEMENT OF LOT 19 OF WHITE PINE BEACH, HIRAM, RITZWOOD

Assessment Roll and Tax List of Real Property in the Town of Hiram

Form 5CD MILLER-DAVIS CO., MINNEAPOLIS

* Indicate Type of Property: R-Residential, C-Commercial, I-Industrial, U-Utility, F-Farm, L-Lakeshore, T-Timber, M-Mineral

Cass County, Minnesota, for Taxes for the Year 1963.

Main table with columns: IN WHOSE NAME ASSESSED, DESCRIPTION OF PROPERTY, TRUE AND FULL VALUATIONS, ASSESSED VALUATIONS, VALUATIONS BY SCHOOL DISTRICTS AS EQUALIZED BY DEPARTMENT OF TAXATION, TAXES, PAID, WHEN PAID, etc.

Handwritten calculations: 248.50, 8.92, 257.42

(Continued)

403

270 14

27434

10566

15194

1674

Vertical text on the right edge: LONG BEACH, SHADY SHORES, WHITE PINE BEACH, PLANTATION BEACH, etc.

Assessment Roll and Tax List of Real Property in the Town of Hiram

* Indicate Type of Property: R-Residential, C-Commercial, I-Industrial, U-Utility, F-Farm, L-Lakeshore, T-Timber, M-Mineral

Cass County, Minnesota, for Taxes for the Year 1963.

Form 504 MILLER-DAVIS CO., MINNEAPOLIS

Table with columns: IN WHOSE NAME ASSESSED, DESCRIPTION OF PROPERTY, TRUE AND FULL VALUATIONS, ASSESSED VALUATIONS, VALUATIONS BY SCHOOL DISTRICTS AS EQUALIZED BY DEPARTMENT OF TAXATION, Tax including State Homestead, State Tax on Non-Homestead, SPECIAL TAXES, TOTAL TAXES, PAID, WHEN PAID, Number of Receipt, March Settlement 1964, June Settlement 1964, Penalty, November Settlement 1964, Collections to First Monday in January 1965, Delinquent on First Monday in January 1965, Total Delinquent Tax and Penalty, REMARKS.

Clayton L. + Lee F. Trapp

Alfred E. + Burton A. Wood

Robert E. + Lois Barr

Earl Marvin + Elizabeth Carlson

Andrew J. + Bessie V. Bray

GOVT LOT 3

77

GOVT LOT 1

GOVT LOT 2 less N. 300'

N. 100' of GOVT LOT 2

S. 200' of N. 300' of GOVT LOT 2

GOVT LOT 3

17 140 31 31

2

2

4

40

17 140 31 31

Unv no yes R

no no L

" yes T

no no L

yes yes T

1300 added by T.B.

568

28

216

H 41

568

141 14 506

752 24

274 10

5800 192

1018

15406 6552 21958

146 20

276

284

5992

1018

22690

PAID IN FULL MAY 28 1964

2nd HALF PAID OCT 30 1964

1st HALF PAID MAY 29 1964

PAID IN FULL MAY 13 1964

2nd HALF PAID OCT 30 1964

1st HALF PAID MAY 29 1964

10724

388

8680

4652

509

21993

146 20

388

284

5992

1018

22690

146 20

388

284

5992

1018

22690

146 20

388

284

5992

1018

22690

146 20

388

284

5992

1018

22690

146 20

388

284

5992

1018

22690

146 20

388

284

5992

1018

22690

146 20

388

284

5992

1018

22690

146 20

388

284

5992

1018

22690

146 20

388

284

5992

1018

22690

146 20

388

284

5992

1018

22690

LONG BEACH SANDY SHORES WHITE PINE BEACH PIAIWIW BEACH BE ARRANGEMENT OF LOT 19 OF WHITE PINE BEACH PIAIWIW, VA. AUGUST RITZGROUND

Assessment Roll and Tax List of Real Property in the Town of Huron

Form 500 - MILLER-DAVIS CO., MINNEAPOLIS

Table with columns: IN WHOSE NAME ASSESSED, DESCRIPTION OF PROPERTY, No. School District, Indicate Home, Indicate Sea, Indicate Type of Property, and various valuation columns.

(Continued)

88 66

Cass County, Minnesota, for Taxes for the Year 1963.

Table with columns: SOLD FOR TAXES, VALUATIONS BY SCHOOL DISTRICTS AS EQUALIZED BY DEPARTMENT OF TAXATION, Tax Including State Homestead, State Tax on Non-Homestead, SPECIAL TAXES, TOTAL TAXES, PAID, WHEN PAID, Number of Receipt, March Settlement, June Settlement, Penalty, November Settlement, Penalty, Collections to First Monday in January 1965, Penalty, Delinquent on First Monday in January 1965, Total Delinquent Tax and Penalty, REMARKS.

Handwritten calculations: 424 = 424, 147 = 147, 171 = 171, 2448 = 2448, 24946 = 24946, 29194 = 29194, 960 = 960, 30154 = 30154.

LONG BEACH, SHADY SHORES, WHITE PINE BEACH, PLAINVIEW BEACH, HIGGINSACK BAY, ARRANGEMENT OF LOT 19 OF WHITE PINE BEACH, ALBERT VALLEY, HURON, RITZLAND

Assessments and Tax List of Real Property in the

Form SCD MILLER-BATES CO., MINNEAPOLIS

IN WHOSE NAME ASSESSED	DESCRIPTION OF PROPERTY				No. School District	Indicate Year or No	Agricultural or Non-Agricultural	Indicate Type of Property	LANI Excludes Structures and Improvements	Dollars
	SUBDIVISION	Sec. or Lot	Town or Block	Number of Acres of Land						
Robert Bisson	E. 50' of GOVT LOT 1 + W. 100' of GOVT LOT 2	18	140	31	5.41	Un	70	70	L	
Gertrude D. + Douglas A. Woodbeck	E. 75' of W. 250' of GOVT LOT 2				2.50	"	"	"	"	
Gertrude Woodbeck	E. 75' of W. 175' of GOVT LOT 2				2.50	"	"	"	"	
Emil H. + Margaret M. Drausnick	E. 150' of W. 400' of GOVT LOT 2				4.88	"	"	"	"	
Emil H. + Margaret Hawkins Drausnick	E. 150' of W. 550' of GOVT LOT 2				5.10	"	"	"	"	
Theodore A. + Lucille V. Loveland	E. 150' of W. 700' of GOVT LOT 2				5.27	"	"	"	"	
"	E. 300' of W. 1000' of GOVT LOT 2				12.75	"	"	"	"	
Anthony L. + Lucille A. Boyer	E. 150' of W. 1150' of GOVT LOT 2				6.39	"	"	"	"	
"	E. 150' of W. 1300' of GOVT LOT 2				6.36	"	"	"	"	
Gordon A. Mikkelsen	E. 20' of GOVT LOT 2 + W. 130' of GOVT LOT 3				6.01	"	"	"	"	
Gordon A. + Ruth E. Mikkelsen	E. 150' of W. 280' of GOVT LOT 3				5.66	"	"	"	"	
Marlys V. Peterson	E. 150' of W. 430' of GOVT LOT 3				5.50	"	"	"	"	
Edward E. Nielsen	E. 150' of W. 580' of GOVT LOT 3				5.40	"	"	"	"	
Arnold L. + Dorothy L. Melin	E. 150' of W. 730' of GOVT LOT 3				5.66	"	"	"	"	
"	E. 150' of W. 880' of GOVT LOT 3				5.96	"	"	"	"	
William B. Lenk	E. 150' of W. 1030' of GOVT LOT 3				6.19	"	"	"	"	
Ralph E. Bannister	E. 150' of W. 1180' of GOVT LOT 3				6.19	"	"	"	"	
Harold L. + Margaret Bateman	E. 140' of GOVT LOT 3 (OR LOT 3 EXCEPT W. 1180')				5.73	"	"	"	"	
	SHOW SEW									

Lot 3 18-140-31

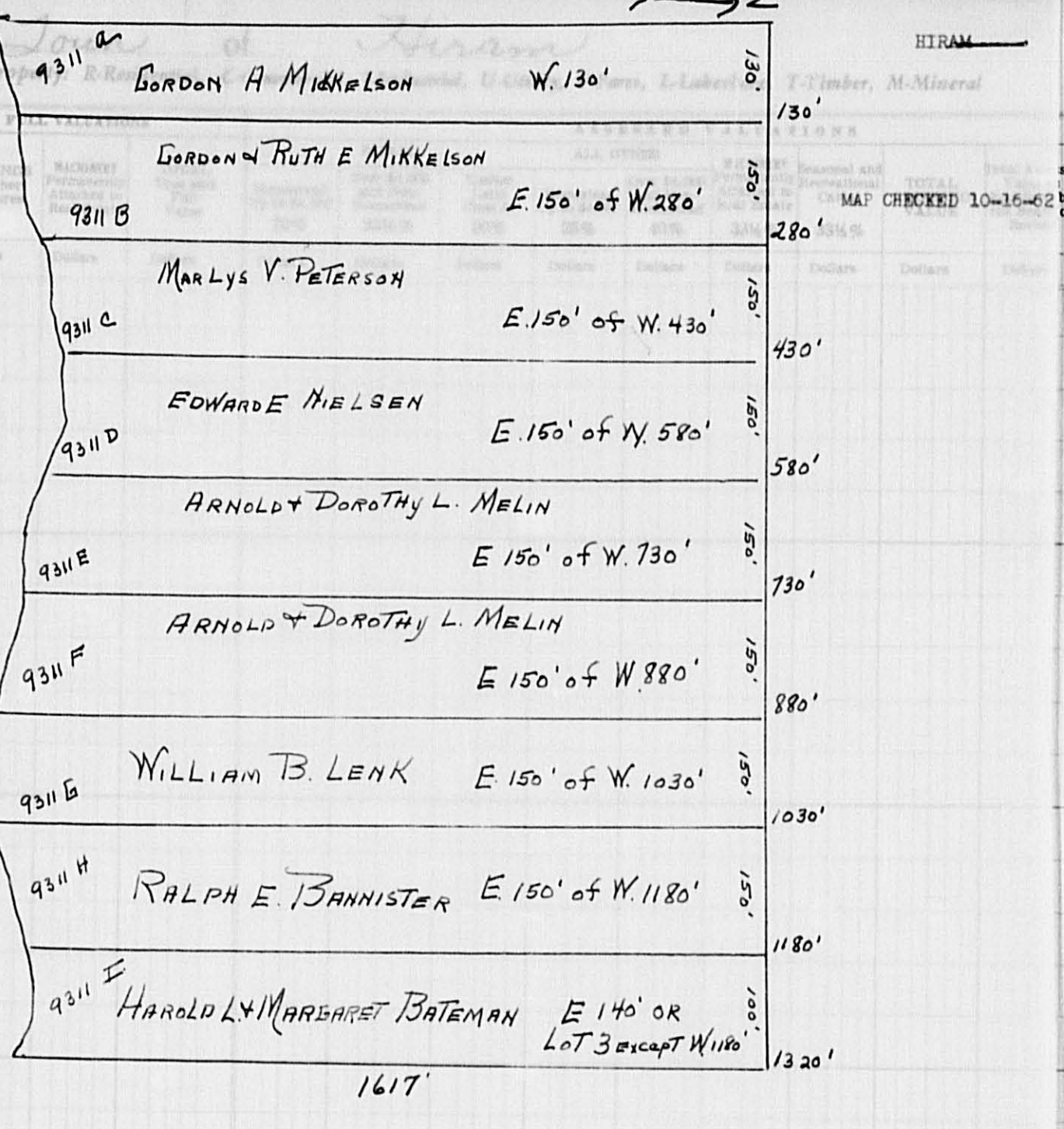

HIRAM

MAP CHECKED 10-16-62

FINAL EQUALIZED VALUE

Dollars

Cass County, Minnesota, for Taxes for the Year 1963.

SOLD FOR TAXES	VALUATIONS BY SCHOOL DISTRICTS AS EQUALIZED BY DEPARTMENT OF TAXATION						Tax including State Homestead	State Tax on Non-Homestead	SPECIAL TAXES	SPECIAL TAXES	TOTAL TAXES	PAID	WHEN PAID	Number of Receipt	March Settlement 1964	June Settlement 1964	Penalty	November Settlement 1964	Penalty	Collections to First Monday in January 1965	Penalty	Delinquent on First Monday in January 1965	Total Delinquent Tax and Penalty	REMARKS	
	District No.	District No.	District No.	District No.	District No.	District No.																			Dollars
1						97	26.04	86			26.90	1 PAID IN FULL APR 20 1964	6880										9488		
2						123	33.02	110			34.12	2 1st HALF PAID MAY 29 1964									16128	1773	24423	9484	
3						21	5.64	18			5.82	3 1st HALF PAID MAY 29 1964	12447									382	420		
4						142	38.12	126			39.38	4 PAID IN FULL MAY 11 1964												9538	
5						124	33.30	110			34.40	5 PAID IN FULL MAY 11 1964	2518												
6						232	62.30	206			64.36	6 1st HALF PAID MAY 29 1964											24477	9540	
7						103	27.66	92			28.58	7 1st HALF PAID MAY 29 1964	10725												
8						42	11.28	38			11.66	8 PAID IN FULL APR 29 1964												9529	
9						42	11.28	38			11.66	9 PAID IN FULL APR 29 1964	8563												
10						42	11.28	38			11.66	10													
11						198	53.16	176			54.92	11 2nd HALF PAID OCT 30 1964	20941										1166	1283	9589
12						168	45.10	150			46.60	12 1st HALF PAID MAY 29 1964	16882												
13	SOLD FOR TAXES					198	53.16	176			54.92	13													
14						42	11.28	38			11.66	14 2nd HALF PAID NOV 20 1964	18151												
15						168	45.10	150			46.60	15 1st HALF PAID MAY 29 1964	12776												
16						42	11.28	38			11.66	16 PAID IN FULL JUL 16 1964	7066												
17						99	26.58	88			27.46	17 PAID IN FULL MAY 29 1964	13088												
18						116	31.14	104			32.18	18 PAID IN FULL MAY 5 1964	9135												
19												19													
20												20													
							1999	70	53672	1782	55454														

103.46

LONG BEACH, SADDY SHORES, WHITE PINE BEACH, PLANTATION BEACH, HICKORY BEACH, BE ARRANGEMENT OF LOT 19 OF WHITE PINE BEACH, PLANTATION VA, HURON, RITZLAND

Assessment Roll and Tax List of Real Property in the Town of Hiram

Cass County, Minnesota, for Taxes for the Year 1963.

Form SCD MILLER-DAVIS CO., MINNEAPOLIS * Indicate Type of Property: R-Residential, C-Commercial, I-Industrial, U-Utility, F-Farm, L-Lakeshore, T-Timber, M-Mineral

Table with columns: IN WHOSE NAME ASSESSED, DESCRIPTION OF PROPERTY, TRUE AND FULL VALUATIONS, ASSESSED VALUATIONS, VALUATIONS BY SCHOOL DISTRICTS AS EQUALIZED BY DEPARTMENT OF TAXATION, TAXES, PAID, WHEN PAID, Number of Receipt, March Settlement 1964, June Settlement 1964, November Settlement 1964, Collections to First Monday in January 1965, Delinquent on First Monday in January 1965, Total Delinquent Tax and Penalty, REMARKS.

Mrs. Bessie Bray

Ralph A. + Lorraine S. Hoopman

2nd HALF PAID OCT 30 1964
1st HALF PAID MAY 29 1964
2nd HALF PAID OCT 30 1964
1st HALF PAID MAY 29 1964
2nd HALF PAID OCT 30 1964
1st HALF PAID MAY 29 1964

LONG BEACH SHADY SHORES WHITE PINE BEACH PLANTATION BEACH HARBORSIDE BEACH PALMVIEW VALLEY RE ARRANGEMENT OF LOT 19 OF WHITE PINE BEACH

Assessment Roll and Tax List of Real Property in the Town of Hiram

* Indicate Type of Property: R-Residential, C-Commercial, I-Industrial, U-Utility, F-Farm, L-Lakeshore, T-Timber, M-Mineral

Cass County, Minnesota, for Taxes for the Year 1963.

Table with columns: IN WHOSE NAME ASSESSED, DESCRIPTION OF PROPERTY, TRUE AND FULL VALUATIONS, ASSESSED VALUATIONS, and FINAL EQUALIZED VALUE. Includes entries for Northwest Paper Co. and Arnold F. Lading.

Table with columns: VALUATIONS BY SCHOOL DISTRICTS AS EQUALIZED BY DEPARTMENT OF TAXATION, TAXES, PAID, WHEN PAID, and REMARKS. Includes handwritten tax amounts and payment dates.

LONG BEACH, SHADY SHORES, WHITE PINE BEACH, PLANTING BEACH, HAKKENSACK BEACH, BE ARRANGEMENT OF LOT 19 OF WHITE PINE BEACH, PALOUIL VAL, HURST, RITZLAUND

Assessment Roll and Tax List of Real Property in the Town of Hiram, Minnesota

Form 500 - MILLER-DAVIS CO., MINNEAPOLIS

* Indicate Type of Property: R-Residential, C-Commercial, I-Industrial, U-Utility, F-Farm, L-Lakeshore, T-Timber, M-Mineral

Table with columns: IN WHOSE NAME ASSESSED, DESCRIPTION OF PROPERTY, TRUE AND FULL VALUATIONS, ASSESSED VALUATIONS (RURAL, ALL OTHER), and FINAL EQUALIZED VALUE.

320

Cass County, Minnesota, for Taxes for the Year 1963.

Table with columns: VALUATIONS BY SCHOOL DISTRICTS AS EQUALIZED BY DEPARTMENT OF TAXATION, TAXES, PAID, WHEN PAID, Number of Receipt, March Settlement 1964, June Settlement 1964, Penalty, November Settlement 1964, Penalty, Collections to First Monday in January 1965, Delinquent on First Monday in January 1965, Total Delinquent Tax and Penalty, REMARKS.

LONG BEACH, SHADY SHORES, WHITE PINE BEACH, PLUMVIEW BEACH, HAKERSACK BEACH, BE ARRANGEMENT OF LOT 19, WHITE PINE BEACH, PLUMVIEW VA, FIRST, RITZGROUND

Assessment Roll and Tax List of Real Property in the Town of Hiram, Cass County, Minnesota, for Taxes for the Year 1963.

Form SCD MILLER-DAVIS CO., MINNEAPOLIS

* Indicate Type of Property: R-Residential, C-Commercial, I-Industrial, U-Utility, F-Farm, L-Lakeshore, T-Timber, M-Mineral

Table with columns: IN WHOSE NAME ASSESSED, DESCRIPTION OF PROPERTY, TRUE AND FULL VALUATIONS, ASSESSED VALUATIONS, and FINAL EQUALIZED VALUE.

Cass County, Minnesota, for Taxes for the Year 1963.

Table with columns: VALUATIONS BY SCHOOL DISTRICTS AS EQUALIZED BY DEPARTMENT OF TAXATION, TAX INCLUDING STATE HOMESTEAD, SPECIAL TAXES, TOTAL TAXES, PAID, WHEN PAID, and REMARKS.

LONG BEACH, SHADY SHORES, WHITE PINE BEACH, PILGRIM BEACH, HICKORY BEACH, ARRANGEMENT OF LOT 19, WHITE PINE BEACH, RITZGROUND

Assessment Roll and Tax List of Real Property in the

Town of *Niram*

Cass County, Minnesota, for Taxes for the Year 1963.

* Indicate Type of Property: R-Residential, C-Commercial, I-Industrial, U-Utility, F-Farm, L-Lakeshore, T-Timber, M-Mineral

Form 50 MILLER-DAVIS CO., MINNEAPOLIS

J. H. Hansel

IN WHOSE NAME ASSESSED	DESCRIPTION OF PROPERTY				No. School District	Indicate Homestead Yes or No	Agri. or Sear. Yes or No	Indicate Type of Property	TRUE AND FULL VALUATIONS													FINAL EQUALIZED VALUE				
	Long Beach SUBDIVISION	Sec. or Lot	Town or Block	Rng.					Number of Acres of Land	LAND EXCLUSIVE OF STRUCTURES AND IMPROVEMENTS				BUILDINGS AND OTHER STRUCTURES				MACHINERY Permanently Attached to Real Estate		TOTAL True and Full Value	ASSESSED VALUATIONS					
										Acres	100ths	LAND EXCLUSIVE OF STRUCTURES AND IMPROVEMENTS	BUILDINGS AND OTHER STRUCTURES	MACHINERY Permanently Attached to Real Estate	TOTAL True and Full Value	Homestead Up to \$4,000 20%	Over \$4,000 and Non-Homestead 33 1/4%	Timber Land Class 3e 20%	Homestead Up to \$4,000 25%		Over \$4,000 and Non-Homestead 40%		MACHINERY Permanently Attached to Real Estate 33 1/4%	Seasonal and Recreational Cabins 33 1/4%	TOTAL ASSESSED VALUE	Total Assessed Value as Equalized by the Board of Review
									Dollars	Dollars	Dollars	Dollars	Dollars	Dollars	Dollars	Dollars	Dollars	Dollars	Dollars	Dollars	Dollars	Dollars	Dollars	Dollars		

SOLD FOR TAXES	VALUATIONS BY SCHOOL DISTRICTS AS EQUALIZED BY DEPARTMENT OF TAXATION						Tax Including State Homestead	State Tax on Non-Homestead	SPECIAL TAXES	SPECIAL TAXES	TOTAL TAXES	PAID	WHEN PAID	Number of Receipt	March Settlement 1964	June Settlement 1964	Penalty	November Settlement 1964	Penalty	Collections to First Monday in January 1965	Penalty	Delinquent on First Monday in January 1965	Total Delinquent Tax and Penalty	REMARKS																
	District No.	District No.	District No.	District No.	District No.	District No.																			Dollars	Dollars	Dollars	Dollars	Dollars	Dollars	Dollars	Dollars	Dollars	Dollars	Dollars	Dollars	Dollars	Dollars	Dollars	Dollars
	Rate	Rate	Rate	Rate	Rate	Rate																			Mills	Mills	Mills	Mills	Mills	Mills	Mills	Mills	Mills	Mills	Mills	Mills	Mills	Mills	Mills	Mills

SUNSET BEACH SHADY SHORES WHITE PINE BEACH PLANTATION BEACH HACKENSACK BERTIN BEACH MAGNETO VALLEY HURST RITZLAUND

Assessment Roll and Tax List of Real Property in the Town of Hiram, Cass County, Minnesota, for Taxes for the Year 1963.

Cass County, Minnesota, for Taxes for the Year 1963.

Form 50 MILLER-DAVIS CO., MINNEAPOLIS

Table with columns: IN WHOSE NAME ASSESSED, DESCRIPTION OF PROPERTY, TRUE AND FULL VALUATIONS, ASSESSED VALUATIONS, FINAL EQUALIZED VALUE. Includes entries for Ralph O. + Ellen P. Mills, Margaret Lits, Lloyd W. + Ethelyn F. Reed, John B. Anthonisen, Harry Kneeland.

Table with columns: VALUATIONS BY SCHOOL DISTRICTS AS EQUALIZED BY DEPARTMENT OF TAXATION, Tax Including State Homestead, State Tax on Non-Homestead, SPECIAL TAXES, TOTAL TAXES, PAID, WHEN PAID, Number of Receipt, March Settlement 1964, June Settlement 1964, Penalty Settlement 1964, Collections to First Monday in January 1965, Delinquent on First Monday in January 1965, Total Delinquent Tax and Penalty, REMARKS. Includes tax payment details and dates.

2211 1324 = 3535
54942
NO 35548 3150
90490
93640
85944
7696

SUNSET BEACH SHADY SHORES WHITE PINE BEACH FLD AVIATION BEACH HICKORYSACK BATHING BEACH PALMVIEW VALLEY HURST RITZLAND

Assessment Roll and Tax List of Real Property in the Town of Hiram, Cass County, Minnesota, for Taxes for the Year 1963.

Form 50 MILLER-DAVIS CO., MINNEAPOLIS

* Indicate Type of Property: R-Residential, C-Commercial, I-Industrial, U-Utility, F-Farm, L-Lakeshore, T-Timber, M-Mineral

Table with columns: IN WHOSE NAME ASSESSED, DESCRIPTION OF PROPERTY, TRUE AND FULL VALUATIONS, ASSESSED VALUATIONS, FINAL EQUALIZED VALUE. Includes names like George C. Brandt, L.F. + June C. Bryngelson, Harry E. + Leona C. Rumpel, etc.

Table with columns: VALUATIONS BY SCHOOL DISTRICTS AS EQUALIZED BY DEPARTMENT OF TAXATION, TAX INCLUDING STATE HOMESTEAD, SPECIAL TAXES, TOTAL TAXES, PAID, WHEN PAID, Number of Receipt, March Settlement, June Settlement, Penalty, November Settlement, Collections to First Monday in January 1965, Delinquent on First Monday in January 1965, Total Delinquent Tax and Penalty, REMARKS. Includes tax amounts and payment dates.

SHADY SHORES ALONG BEACH

SUNSET BEACH, CHANTON BEACH, WHITE PINE BEACH, PLANTATION BEACH, HAKKENSACK BATHING BEACH, RE ARRANGEMENT OF LOT 19 OF WHITE PINE BEACH, PALMISTUL VALLEY, BURST, RITZLAND

Assessment Roll and Tax List of Real Property in the Town of Hiram, Cass County, Minnesota, for Taxes for the Year 1963.

* Indicate Type of Property: R-Residential, C-Commercial, I-Industrial, U-Utility, F-Farm, L-Lakeshore, T-Timber, M-Mineral

Form 5C - MILLER-DAVIS CO., MINNEAPOLIS

Table with columns: IN WHOSE NAME ASSESSED, Shady Shores SUBDIVISION, Description of Property, True and Full Valuations (Rural, All Other, Machinery, Seasonal and Recreational Cabins, Total Assessed Value), Final Equalized Value.

Cass County, Minnesota, for Taxes for the Year 1963.

Table with columns: VALUATIONS BY SCHOOL DISTRICTS AS EQUALIZED BY DEPARTMENT OF TAXATION, Tax Including State Homestead, State Tax on Non-Homestead, Special Taxes, Total Taxes, PAID, WHEN PAID, Number of Receipt, March Settlement, June Settlement, November Settlement, Collections to First Monday in January, Delinquent on First Monday in January, Total Delinquent Tax and Penalty, REMARKS.

SHADY SHORES ALONG BEACH, SHADY SHORES, SUNSET BEACH, CHARLTON BE, WHITE PINE BEACH, PLANTING BEACH, HICKSACK BATHING BEACH, BE ARRANGEMENT OF LOT 10 OF WHITE PINE BEACH, MACEVIL VA, BURST, RITZGROUND

Assessment Roll and Tax List of Real Property in the Town of Hiram

* Indicate Type of Property: R-Residential, C-Commercial, I-Industrial, U-Utility, F-Farm, L-Lakeshore, T-Timber, M-Mineral

Form 50 - MILLER-DAVIS CO., MINNEAPOLIS

Cass County, Minnesota, for Taxes for the Year 1963.

Table with columns: IN WHOSE NAME ASSESSED, DESCRIPTION OF PROPERTY, TRUE AND FULL VALUATIONS, ASSESSED VALUATIONS, VALUATIONS BY SCHOOL DISTRICTS AS EQUALIZED BY DEPARTMENT OF TAXATION, Tax including State Homestead, State Tax on Non-Homestead, SPECIAL TAXES, TOTAL TAXES, PAID, WHEN PAID, Number of Receipt, March Settlement 1964, June Settlement 1964, Penalty, November Settlement 1964, Penalty, Collections to First Monday in January 1965, Penalty, Delinquent on First Monday in January 1965, Total Delinquent Tax and Penalty, REMARKS.

Robert H. + Mabel M. Mayer

James W. + Viola Baird

Henry + Emma Bunkofski 1/2 int.

E. H. + Louise R. Cutshall 1/2 int.

Rufus + Minnie Olthoff

19 Lots 58-110 incl. vacated

24536 9412

24537 9411

9258

4459 1626 2085 na55978 1450 57428

28866 28562

SUNSET BEACH CHATTON BEACH WHITE PINE BEACH PLANTATION BEACH HACKENSACK BEACHING BEACH ARRANGEMENT OF LOT 19 OF WHITE PINE BEACH PALM TUL VA 19 FIRST RITZLAND

Assessment Roll and Tax List of Real Property in the Town of Hiram

* Indicate Type of Property: R-Residential, C-Commercial, I-Industrial, U-Utility, F-Farm, L-Lakeshore, T-Timber, M-Mineral

Cass County, Minnesota, for Taxes for the Year 1963.

Form 50 MILLER-DAVIS CO., MINNEAPOLIS

Table with columns: IN WHOSE NAME ASSESSED, DESCRIPTION OF PROPERTY, TRUE AND FULL VALUATIONS, ASSESSED VALUATIONS, VALUATIONS BY SCHOOL DISTRICTS AS EQUALIZED BY DEPARTMENT OF TAXATION, TAX INCLUDING STATE HOMESTEAD, SPECIAL TAXES, TOTAL TAXES, PAID, WHEN PAID, Number of Receipt, March Settlement 1964, June Settlement 1964, November Settlement 1964, Collections to First Monday in January 1965, Delinquent on First Monday in January 1965, Total Delinquent Tax and Penalty, REMARKS.

SHADY SHORES LONG BEACH

WHITE PINE BEACH

SUNSET BEACH

CHATTAHOOC BEACH

FRANCIS BEACH

PLANTATION BEACH

HACKENSACK BEATING BEACH

RE ARRANGEMENT OF LOT 19 OF WHITE PINE BEACH

FRANCIS VA BEACH

HURST BEACH

RITZLAND BEACH

Assessment Roll and Tax List of Real Property in the Town of Hiram, Cass County, Minnesota, for Taxes for the Year 1963.

Form 50 MILLER-DAVIS CO., MINNEAPOLIS

* Indicate Type of Property: R-Residential, C-Commercial, I-Industrial, U-Utility, F-Farm, L-Lakeshore, T-Timber, M-Mineral

Table with columns: IN WHOSE NAME ASSESSED, DESCRIPTION OF PROPERTY, TRUE AND FULL VALUATIONS, ASSESSED VALUATIONS, and FINAL EQUALIZED VALUE. Includes handwritten entries for Carl W. + Clara Johnson, Frank F. + Lotta H. Murray, John B. Anthonisen, Arthur C. + Mildred F. Loepp, Ruth W. Abrahamson, Ida + Levida Rausch, Mabel Bostrom, and Edwin + Willard Bostrom.

Cass County, Minnesota, for Taxes for the Year 1963.

Table with columns: SOLD FOR TAXES, VALUATIONS BY SCHOOL DISTRICTS AS EQUALIZED BY DEPARTMENT OF TAXATION, Tax including State Homestead, SPECIAL TAXES, TOTAL TAXES, PAID, WHEN PAID, Number of Receipt, March Settlement 1964, June Settlement 1964, Penalty, November Settlement 1964, Collections to First Monday in January 1965, Delinquent on First Monday in January 1965, Total Delinquent Tax and Penalty, and REMARKS. Includes handwritten entries for Carl W. + Clara Johnson, Frank F. + Lotta H. Murray, John B. Anthonisen, Arthur C. + Mildred F. Loepp, Ruth W. Abrahamson, Ida + Levida Rausch, Mabel Bostrom, and Edwin + Willard Bostrom.

Assessment Roll and Tax List of Real Property in the Town of Hiram, Cass County, Minnesota, for Taxes for the Year 1963.

Cass County, Minnesota, for Taxes for the Year 1963.

Form 5C - MILLER-DAVIS CO., MINNEAPOLIS

* Indicate Type of Property: R-Residential, C-Commercial, I-Industrial, U-Utility, F-Farm, L-Lakeshore, T-Timber, M-Mineral

Table with columns for IN WHOSE NAME ASSESSED, DESCRIPTION OF PROPERTY, TRUE AND FULL VALUATIONS, ASSESSED VALUATIONS, VALUATIONS BY SCHOOL DISTRICTS AS EQUALIZED BY DEPARTMENT OF TAXATION, and various tax and payment details.

Handwritten entries: A.E. + Selma N. Wood, The Luedtke Company, Richard G. Garbisch, Sven K. + Esther A. Modness, The Luedtke Company

Handwritten descriptions: OUTLOT A 3, B less sold, PART of B, B, OUTLOT C

Handwritten tax and payment details: 196, 5262, 174, 5436, 224, 8, 232, 224, 8, 232, 224, 8, 232, 372, 14, 386, 15, 196, 1044, 5262, 6306, 212, 6518, 3143, 3375

SHADY SHORES, SUNSET BEACH, WHITE PINE BEACH, PLAINVIEW BEACH, ARRANGEMENT OF LOTS, PLAINVIEW BEACH, ELMHURST, RITZGROUND

1st ADD'N TO PERFORMANCE, CHARLTON BEACH, COUGHLIN BEACH, PLEASUREL SI BORO, HICKENSACK BATHING BEACH, PLEASUREL VALLEY, SUNSET VIEW

Assessment Roll and Tax List of Real Property in the Town of Hiram, Minnesota

Form 5C MILLER-DAVIS CO., MINNEAPOLIS

Table with columns: IN WHOSE NAME ASSESSED, DESCRIPTION OF PROPERTY, TRUE AND FULL VALUATIONS, ASSESSED VALUATIONS, and FINAL EQUALIZED VALUE.

Cass County, Minnesota, for Taxes for the Year 1963.

Table with columns: VALUATIONS BY SCHOOL DISTRICTS AS EQUALIZED BY DEPARTMENT OF TAXATION, TAXES, PAID, WHEN PAID, and REMARKS.

SHADY SHORES SUNSET BEACH, CHARITON BEACH, WHITE PINE BEACH, PLAINVIEW BEACH, PLAINVIEW BEACH, ARRANGEMENT OF LOTS IN PINE BEACH, ELMHURST, RITZGROUND

1st ADD'N TO PLAINVIEW BEACH, PLAINVIEW BEACH, HICKENSACK BATHING BEACH, PLAINVIEW VALLEY, SUNSET VIEW

Assessment Roll and Tax List of Real Property in the Town of Hiram, Cass County, Minnesota, for Taxes for the Year 1963.

Form 5C MILLER-DAVIS CO., MINNEAPOLIS

* Indicate Type of Property: R-Residential, C-Commercial, I-Industrial, U-Utility, F-Farm, L-Lakeshore, T-Timber, M-Mineral

Table with columns: IN WHOSE NAME ASSESSED, DESCRIPTION OF PROPERTY, TRUE AND FULL VALUATIONS, ASSESSED VALUATIONS, and FINAL EQUALIZED VALUE. Includes entries for Blanche Groth, Henry + Alma Groskrentz, Jay E. + Ruth M. Laker, George + Lillian J. Wessale, Emma A. Funk, Paul Wm. Moskier, John F. + Alma S. Greer, C.C. Ecklund, E.H. + Dorothy Strobridge, Newman J. Nies, Newman F. + Larue Fink Nies, Newman Francis Nies, Newman Frank Nies, La Verne Louis Nies, La Verne L. Nies.

Cass County, Minnesota, for Taxes for the Year 1963.

Table with columns: SOLD FOR TAXES, VALUATIONS BY SCHOOL DISTRICTS AS EQUALIZED BY DEPARTMENT OF TAXATION, Tax Including State Homestead, SPECIAL TAXES, TOTAL TAXES, PAID, WHEN PAID, Number of Receipt, March Settlement, June Settlement, November Settlement, Collections to First Monday in January 1965, Delinquent on First Monday in January 1965, Total Delinquent Tax and Penalty, REMARKS. Includes entries for 1-20 with tax amounts and payment dates.

SUNSET BEACH, CHARTON BEACH, PEACEFUL SHORES, PLAINVIEW BEACH, PINE BEACH, ARRANGEMENT OF LOTS 9, ELMHURST, RITZLAUND

1st ADD'N TO PEACEFUL SHORES, COUGHLIN BEACH, HICKENSBACK BATHING BEACH, PEACEFUL VALLEY, SUNSET VIEW

Assessment Roll and Tax List of Real Property in the Town of Hiram

* Indicate Type of Property: R-Residential, C-Commercial, I-Industrial, U-Utility, F-Farm, L-Lakeshore, T-Timber, M-Mineral

Form 5C MILLER-DAVIS CO., MINNEAPOLIS

Table with columns: IN WHOSE NAME ASSESSED, DESCRIPTION OF PROPERTY, TRUE AND FULL VALUATIONS, ASSESSED VALUATIONS, and FINAL EQUALIZED VALUE. Includes handwritten entries for various property owners like J. K. + Mollie Markfelder and Paul William Moshier.

Cass County, Minnesota, for Taxes for the Year 1963.

Table with columns: VALUATIONS BY SCHOOL DISTRICTS AS EQUALIZED BY DEPARTMENT OF TAXATION, Tax including State Homestead, State Tax on Non-Homestead, SPECIAL TAXES, TOTAL TAXES, PAID, WHEN PAID, Number of Receipt, March Settlement, June Settlement, November Settlement, Penalty, Collections to First Monday in January 1965, Delinquent on First Monday in January 1965, Total Delinquent Tax and Penalty, and REMARKS. Includes handwritten tax amounts and payment dates.

Assessment Roll and Tax List of Real Property in the Town of Hiram

Form SC - MILLS-DAVIS CO., MINNEAPOLIS

* Indicate Type of Property: R-Residential, C-Commercial, I-Industrial, U-Utility, F-Farm, L-Lakeshore, T-Timber, M-Mineral

Table with columns: IN WHOSE NAME ASSESSED, DESCRIPTION OF PROPERTY, TRUE AND FULL VALUATIONS, ASSESSED VALUATIONS (RURAL, ALL OTHER), and FINAL EQUALIZED VALUE.

Cass County, Minnesota, for Taxes for the Year 1963.

Table with columns: SOLD FOR TAXES, VALUATIONS BY SCHOOL DISTRICTS AS EQUALIZED BY DEPARTMENT OF TAXATION, Tax Including State Homestead, SPECIAL TAXES, TOTAL TAXES, PAID, WHEN PAID, Number of Receipt, March Settlement, June Settlement, November Settlement, Collections to First Monday in January 1965, Delinquent on First Monday in January 1965, Total Delinquent Tax and Penalty, REMARKS.

Assessment Roll and Tax List of Real Property in the Town of Hiram

* Indicate Type of Property: R-Residential, C-Commercial, I-Industrial, U-Utility, F-Farm, L-Lakeshore, T-Timber, M-Mineral

Form 5C - MILLER-DAVIS CO., MINNEAPOLIS

SUNSET BEACH CHARIOT BEACH PEACEFUL SHORES PLAINVIEW BEACH HICKENSACK BATHING BEACH VALLEY PEACEFUL ELMHURST RITZLAUND

1st ADD'N TO PEACEFUL SHORES

PEACEFUL SHORES

PEACEFUL SHORES

PEACEFUL SHORES

PEACEFUL SHORES

PEACEFUL SHORES

PEACEFUL SHORES

PEACEFUL SHORES

PEACEFUL SHORES

IN WHOSE NAME ASSESSED	DESCRIPTION OF PROPERTY				No. School District	Indicate Homestead Yes or No	Agr. or Sea. Rec. Yes or No	Indicate Type of Property	TRUE AND FULL VALUATIONS				ASSESSED VALUATIONS							FINAL EQUALIZED VALUE		
	1st Add'n. to Peaceful Shores SUBDIVISION	Sec. of Lot	Town or Block	Number of Acres of Land					LAND Exclusive of Structures and Improvements	BUILDINGS and Other Structures	MACHINERY Permanently Attached to Real Estate	TOTAL True and Full Value	RURAL		ALL OTHER			MACHINERY Permanently Attached to Real Estate	Seasonal and Recreational Cabins		TOTAL ASSESSED VALUE	Total Assessed Value as Equalized by the Board of Review
													Acres 100ths	Homestead Up to \$4,000 20%	Over \$4,000 and Non-Homestead 33 1/3%	Timber Land Class 3e 20%	Homestead Up to \$4,000 25%					
Carl A. Ryan	1	71			Un	no	no	L														
Paul Wm. Mosher	2	72			"	"	"															
"	3	73			"	"	"															
"	4	74			"	"	"															
"	5	75			"	"	"															
"	6	76			"	"	"															
"	7	77			"	"	"															
Ervin R. + Norma L. Van Sickle	8	78			"	"	"															
"	9	79			"	"	"															
John F. + Alma S. Greer	10	80			"	"	"															
"	11	81			"	"	"															
"	12	82			"	"	"															
"	13	83			"	"	"															
Carl A. Ryan	14	84			"	"	"															
"	15	85			"	"	"															
"	16	86			"	"	"															
Leonard Hendricks	17		OUTLOT D		"	"	"															
Theodore P. Goldschmitz	18		E less sold		yes	no	R															
Township of Hiram	19		F Road																			
	20																					

Cass County, Minnesota, for Taxes for the Year 1963.

SOLD FOR TAXES	VALUATIONS BY SCHOOL DISTRICTS AS EQUALIZED BY DEPARTMENT OF TAXATION						Tax Including State Homestead	State Tax on Non-Homestead	SPECIAL TAXES	SPECIAL TAXES	TOTAL TAXES	PAID	WHEN PAID	Number of Receipt	March Settlement 1964	June Settlement 1964	Penalty	November Settlement 1964	Penalty	Collections to First Monday in January 1965	Penalty	Delinquent on First Monday in January 1965	Total Delinquent Tax and Penalty	REMARKS
	District No.	District No.	District No.	District No.	District No.	District No.																		
	Rate	Rate	Rate	Rate	Rate	Rate																		
1																								
2																								
3																								
4																								
5																								
6																								
7																								
8																								
9																								
10																								
11																								
12																								
13																								
14																								
15																								
16																								
17																								
18																								
19																								
20																								

COUCHMAN BEACH

LONG PINE

NORTHWEST SHORES

TEN

SUB-DIVISION PART LOT 9

Assessment Roll and Tax List of Real Property in the Town of Hiram, Cass County, Minnesota, for Taxes for the Year 1963.

Form 5C MILLER-DAVIS CO., MINNEAPOLIS

* Indicate Type of Property: R-Residential, C-Commercial, I-Industrial, U-Utility, F-Farm, L-Lakeshore, T-Timber, M-Mineral

Table with columns: IN WHOSE NAME ASSESSED, DESCRIPTION OF PROPERTY, TRUE AND FULL VALUATIONS, ASSESSED VALUATIONS, FINAL EQUALIZED VALUE. Includes entries for William A. & Catherine Lindenau and William D. Schneider.

Cass County, Minnesota, for Taxes for the Year 1963.

Table with columns: VALUATIONS BY SCHOOL DISTRICTS AS EQUALIZED BY DEPARTMENT OF TAXATION, TAX INCLUDING STATE HOMESTEAD, State Tax on Non-Homestead, SPECIAL TAXES, TOTAL TAXES, PAID, WHEN PAID, Number of Receipt, March Settlement 1964, June Settlement 1964, November Settlement 1964, Penalty, Collections to First Monday in January 1965, Delinquent on First Monday in January 1965, Total Delinquent Tax and Penalty, REMARKS.

Vertical text on the left margin: SUNSET BEACH, CHARTER BEACH, PEACEFUL SHORES, PLAINVIEW BEACH, BACKSACK BATTING BEACH, VALLEY, PEACEFUL, SUNSET VIEW, RITZLAUND, ELMHURST, ARRANGEMENT OF LOTS 9, RITZLAUND.

Vertical text on the right margin: COUGHLIN BEACH, LONG PINE, NORTHWEST SHORES TEN, SUB-DIVISION PART LOT 9.

Assessment Roll and Tax List of Real Property in the Town of Hiram

Form 5C - MILLER-DAVIS CO., MINNEAPOLIS

* Indicate Type of Property: R-Residential, C-Commercial, I-Industrial, U-Utility, F-Farm, L-Lakeshore, T-Timber, M-Mineral

Table with columns: IN WHOSE NAME ASSESSED, DESCRIPTION OF PROPERTY, TRUE AND FULL VALUATIONS, ASSESSED VALUATIONS, and FINAL EQUALIZED VALUE. Includes handwritten entries for Alfred E. Wook, Joseph + Ella Welsch, and John W. + Blanche S. Coughlin.

Cass County, Minnesota, for Taxes for the Year 1963.

Table with columns: VALUATIONS BY SCHOOL DISTRICTS AS EQUALIZED BY DEPARTMENT OF TAXATION, TAX INCLUDING STATE HOMESTEAD, SPECIAL TAXES, TOTAL TAXES, PAID, WHEN PAID, Number of Receipt, March Settlement, June Settlement, November Settlement, Penalty, Collections to First Monday in January 1965, Delinquent on First Monday in January 1965, Total Delinquent Tax and Penalty, and REMARKS. Includes handwritten tax amounts and payment dates.

Vertical text on the left margin: RITZLAUND, SUNSET VIEW, ELMHURST, ARRANGEMENT OF LOTS 9, BACKSACK VALLEY, PLAINVIEW BEACH, PEACEFUL SHORES, CHARTER BEACH, SUNSET BEACH, 1st ADD'N TO PEACEFUL SHORES.

Vertical text on the right margin: LONG PINE, NORTHWEST SHORES TEN MILE LAKE, SUB-DIVISION PART LOT 9.

Assessment Roll and Tax List of Real Property in the Town of Hiram

* Indicate Type of Property: R-Residential, C-Commercial, I-Industrial, U-Utility, F-Farm, L-Lakeshore, T-Timber, M-Mineral

Form 50 MILLER-DAVIS CO., MINNEAPOLIS

Table with columns: IN WHOSE NAME ASSESSED, DESCRIPTION OF PROPERTY, TRUE AND FULL VALUATIONS, ASSESSED VALUATIONS, and FINAL EQUALIZED VALUE. Includes entries for Robert W. + E. Jane Anderson, Laurence F. + June C. Bryngelson, etc.

Cass County, Minnesota, for Taxes for the Year 1963.

Table with columns: VALUATIONS BY SCHOOL DISTRICTS AS EQUALIZED BY DEPARTMENT OF TAXATION, Tax Including State Homestead, SPECIAL TAXES, TOTAL TAXES, PAID, WHEN PAID, Number of Receipt, March Settlement 1964, June Settlement 1964, November Settlement 1964, Collections to First Monday in January 1965, Delinquent on First Monday in January 1965, Total Delinquent Tax and Penalty, REMARKS. Includes entries for Robert W. + E. Jane Anderson, etc.

Vertical text on the left margin: SUNSET BEACH, CHAPELL BEACH, COUGHLIN BEACH, LONG PINE, PLAINVIEW BEACH, PEACEFUL SHORES, PEACEFUL VALLEY, BACKSACK BEACH, ELAHEURST, SUNSET VIEW, RITZLAUND, ARRANGEMENT OF LOTS 9, PEACEFUL VALLEY, PEACEFUL SHORES, TEN MILE LAKE, SUB-DIVISION FARM LOT 9

Vertical text on the right margin: NORTHWEST SHORES, TEN MILE LAKE, SUB-DIVISION FARM LOT 9

Assessment Roll and Tax List of Real Property in the Town of Hiram

Form 50 - MILLER-DAVIS CO., MINNEAPOLIS

Table with columns: IN WHOSE NAME ASSESSED, DESCRIPTION OF PROPERTY, TRUE AND FULL VALUATIONS, ASSESSED VALUATIONS, and FINAL EQUALIZED VALUE. Includes handwritten entries for A.E. + Selma N. Woodcock + F.J. + Madge A. Hagan and Daniel Gaine, Jr.

Elgin G. Stallard

Cass County, Minnesota, for Taxes for the Year 1963.

Table with columns: VALUATIONS BY SCHOOL DISTRICTS AS EQUALIZED BY DEPARTMENT OF TAXATION, Tax Including State Homestead, State Tax on Non-Homestead, SPECIAL TAXES, TOTAL TAXES, PAID, WHEN PAID, Number of Receipt, March Settlement, June Settlement, Penalty, November Settlement, Collections to First Monday in January 1965, Delinquent on First Monday in January 1965, Total Delinquent Tax and Penalty, and REMARKS. Includes handwritten entries for 10, 14, 14, 14, 14, 14, 12, 10, 12, 26, 37, 37, 37, 37, 37, 37, 37, 37, 37, 37, 510.

SUB-DIVISION PART OF LOTS 9

Assessment Roll and Tax List of Real Property in the Town of Hiram

Form 50 MILLER-DAVIS CO., MINNEAPOLIS

* Indicate Type of Property: R-Residential, C-Commercial, I-Industrial, U-Utility, F-Farm, L-Lakeshore, T-Timber, M-Mineral

Table with columns: IN WHOSE NAME ASSESSED, SUBDIVISION, Sec. or Lot, Town or Block, Rng., Number of Acres of Land, TRUE AND FULL VALUATIONS, ASSESSED VALUATIONS, FINAL EQUALIZED VALUE.

Cass County, Minnesota, for Taxes for the Year 1963.

Table with columns: SOLD FOR TAXES, VALUATIONS BY SCHOOL DISTRICTS AS EQUALIZED BY DEPARTMENT OF TAXATION, Tax Including State Homestead, SPECIAL TAXES, TOTAL TAXES, PAID, WHEN PAID, Number of Receipt, March Settlement, June Settlement, November Settlement, Collections to First Monday in January 1965, Delinquent on First Monday in January 1965, Total Delinquent Tax and Penalty, REMARKS.

Vertical text on the left margin: SUNSET BEACH, 1st ADD'N TO PLEACEFUL SHORES, PLEACEFUL SHORES, COUGHLIN BEACH, LONG PINE, WEST SHORES TEN MILE LAKE, SUB-DIVISION PART OF LOT 9, RITZGROUND, FIMHURST.

Vertical text on the right margin: Personal