

ASSESSMENT & TAX LIST - 1956

Hiram

Returns Showing Grain Received in or Handled by Elevators, Warehouses and Mills in the _____ of _____ in the
 County of _____ for the Year Ending May 1, 1956.

INDEX TO SECTIONS

SECTION	PAGE
Sec. 1	
" 2	
" 3	
" 4	
" 5	
" 6	
" 7	
" 8	
" 9	
" 10	
" 11	
" 12	
" 13	
" 14	
" 15	
" 16	
" 17	
" 18	
" 19	
" 20	
" 21	
" 22	
" 23	
" 24	
" 25	
" 26	
" 27	
" 28	
" 29	
" 30	
" 31	
" 32	
" 33	
" 34	
" 35	
" 36	

For Convenience of Auditor in Showing Boundaries of School Districts

Township No. 140 Range No. 31 Mer. P. M.



NAMES OF OWNERS	ADDRESS	Bushels of Wheat	Bushels of Soy Beans	Bushels of Flax	Total No. of Bushels of Wheat, Soy Beans and Flax	★ Tax of $\frac{1}{2}$ Mill per Bushel		Bushels of Corn	Bushels of Barley	Bushels of Rye	Bushels of Oats	Bushels of Buckwheat	Bushels of all Other Grains	Total No. Bushels Corn, Barley, Rye, Oats, Buckwheat and all Other Grains	★ Tax of $\frac{1}{4}$ Mill Per Bushel		★ Total Tax		REMARKS		
						Dollars	Cts.								Dollars	Cts.	Dollars	Cts.			

Note ★ Assessors will not fill these Columns

Long Beach Shady Shores White Pine Beach Plainview Beach

Assessor's Return of Exempt Real Property in the _____ of _____ County of _____, Minnesota, for the Year 1956

FORM 2 MILLER-SAYRE COMPANY, MINNEAPOLIS

NAMES OF OWNERS	DESCRIPTION				No. of Acres		FOR WHAT PURPOSE USED	TRUE AND FULL VALUATIONS				ASSESSED VALUATIONS		REMARKS
	SUBDIVISION	Sec. or Lot	Town or Block	Range	Acres	100ths		LAND Exclusive of Structures and Improvements Dollars	BUILDINGS and Other Structures Dollars	MACHINERY Permanently Attached to Real Estate Dollars	TOTAL True and Full Value Dollars	Rural Including Machinery 33 1/3%	All Other 40%	
<i>Collegiate Presbyterian Church</i>	<i>Lot 6</i>	<i>13</i>	<i>140</i>	<i>31</i>			<i>189</i>			<i>189</i>	<i>63</i>		<i>5</i>	
<i>Town of Hiram</i>	<i>1st addn. to Peaceful Shores</i>						<i>51</i>			<i>51</i>	<i>17</i>		<i>4</i>	
										<i>240</i>		<i>80</i>		

Assessor's Return of Exempt Real Property in the _____ of _____ County of _____, Minnesota, for the Year 1956

FORM 2 MILLER-BUY COMPANY, MINNEAPOLIS

NAMES OF OWNERS	DESCRIPTION					No. of Acres	FOR WHAT PURPOSE USED	TRUE AND FULL VALUATIONS				ASSESSED VALUATIONS		REMARKS
	SUBDIVISION	Sec. or Lot	Town or Block	Range	LAND Exclusive of Structures and Improvements Dollars			BUILDINGS and Other Structures Dollars	MACHINERY Permanently Attached to Real Estate Dollars	TOTAL True and Full Value Dollars	Rural Including Machinery 33 1/3%	All Other 40%		
													Acres	

SUMMARY OF TAX COLLECTION

Original Levy - - - - -	\$16,643.46		
Additions - - - - -	\$		
			\$16,643.46
Abatements - - - - -	\$ 2,061.24		
			\$16,437.22
COLLECTIONS			
March Settlement - - - - -	\$2,648.26	Cancelled 1.86	
June Settlement - - - - -	\$3,211.45	" 4.18	
November Settlement - - - - -	\$2,998.96		
January Settlement - - - - -	\$243.31		
			\$15,211.98
Over Collected - - - - -	\$		
Under Collected - - - - -	\$		
Delinquent - - - - -	\$1,231.28		
Total - - - - -	\$16,443.26		(6,04)

NAMES OF OWNERS

TABULAR SCHEDULE OF VALUATIONS,

LEVIED IN THE Town of Hiram OF County of Cass, STATE OF MINNESOTA

RATES AND TAXES

COUNTY OF CASS, STATE OF MINNESOTA

School District No.	VALUATION BY SCHOOL DISTRICTS				RATE OF STATE TAXES	RATE OF COUNTY TAXES									RATE OF TOWN TAXES								RATE OF						
	Agri-cultural Lands	Non-Agri-cultural Lands	Personal Property	Total Value of all Property except Money and Credits		Total Rate of State Tax	Rev.	R. & B.	Wel-fare	Bonds and Int.	R. S. B. Cass Co. Bldg. Equip	Total Rate of County Tax	Rev.	R. & B.	Drag Tax	State Loan	Total Rate of Town Tax	Local	Spe-cial	State Loan	Defi-ciency	Tui-tion	Trans-portion	C. O.					
<u>Un</u>	Dollars <u>18,508</u>	Dollars <u>44,848</u>	Dollars <u>10,364</u>	Dollars <u>73,720</u>	11.381	27.08	14.18	47.70	7.74	2.00	106.42	47.8	13.57	1.72	19.32	1.28	40.	40.	.73	15.									
Assessed Value	Rural	All Other	Personal Property	Total																									
Homestead	<u>11,591</u>			<u>11,591</u>																									
Non-Homestead	<u>51,765</u>		<u>10,364</u>	<u>62,129</u>																									
Total	<u>63,356</u>		<u>10,364</u>	<u>73,720</u>																									

SCHOOL TAXES	LOCAL 1 MILL AND SPECIAL SCHOOL TAXES BY DISTRICTS											ALL OTHER TAXES			
	Total Rate of Sch'l Tax	Total Rate of all Taxes	Local 1 Mill	Special	State Loan	Total School Taxes	FUNDS	Rate	Amounts						
<u>76.73</u>	<u>26.28</u>	<u>1851</u>	<u>37016</u>	<u>74032</u>	<u>1351</u>	<u>27762</u>	State-Non-Homestead,		<u>33282</u>						
<u>96.73</u>	<u>226.28</u>	<u>5521</u>	<u>220848</u>	<u>220848</u>	<u>4030</u>	<u>82818</u>	State-Homestead,		<u>28032</u>						
		<u>7372</u>	<u>257864</u>	<u>294880</u>	<u>5381</u>	<u>110580</u>	County Revenue,		<u>199634</u>						
							County Road and Bridge,		<u>104535</u>						
							County Welfare,		<u>357644</u>						
							Bonds and Interest		<u>57059</u>						
							R. S. B. Bldg.		<u>14744</u>						
							Cass Co. Equip. Assn.		<u>3686</u>						
							Welfare Ref.		<u>53226</u>						
							Town Revenue,		<u>35017</u>						
							Town Road and Bridge,		<u>100038</u>						
							Town Drag,		<u>7372</u>						
							Town State Loan,		<u>142427</u>						
							School Local 1 Mill,		<u>7372</u>						
							School Special,		<u>257864</u>						
							School State Loan,		<u>294880</u>						
							Deficiency		<u>5381</u>						
							Tuition		<u>110580</u>						
							Transportation		<u>676077</u>						
							Capital Outlay								

Total Number of Acres 7629.34 }
 State of Minnesota, ss.
 COUNTY OF CASS
 I, J. C. Peterson, Auditor of said County and State aforesaid, do hereby certify that the foregoing is a true and correct Schedule, showing the valuation of all the taxable property, in the Town of Hiram, in said County, the several rates of Taxation and Totals of the several Tax Funds levied thereon for the year A. D. 1956.
 Witness my hand and official seal, this 19 day of December, A. D. 1956.
 By J. C. Peterson, Deputy Auditor

Total Taxes Real Estate 14242.82
 Pers. Prop. 2400.64
 Total 16643.46

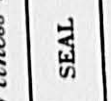

Assessor's Return of

COLLECTIONS OF TAXES OF 1956

Town of *Lincoln*

CASS COUNTY, MINNESOTA

FORM 2 MILLER-DAY COMPANY, MINNEAPOLIS

FUNDS	MARCH SETTLEMENT	JUNE SETTLEMENT	NOV. SETTLEMENT	Amount Collected from Nov. 15 to First Monday in Jan. 1957	REDUCTIONS	Total Reductions and Collected	BALANCE UNCOLLECTED	ADDITIONS	Total Uncollected to First Monday in January, 1957
	1956	1956	1957						
State-Non-Homestead,	5815	18567	5110	396					
State-Homestead,	4392	15720	5110	410					
County Revenue,	31218	111732	36322	2918					
County Road and Bridge,	16347	58507	19020	1528					
County Welfare,	54989	196812	63980	5740					
County Bond and Interest,	8723	31935	10382	834					
R. & B. Bldg.	2306	8252	2682	216					
Wil. Def.	8323	29789	9684	778					
Cass Co. Agri.	576	2063	676	54					
Town Revenue,	5476	19578	6372	512					
Town Road and Bridge,	15644	55990	18209	1462					
Town Drag,	1153	4126	1346	109					
Town State Loan,									
School Local 1 Mill,	1152	4125	1341	108					
School Special,	44266	144984	44929	3862					
School State Loan,									
Deficiency	46112	165040	53652	4311					
Tuition									
Transportation	841	3012	978	78					
C. O.	17293	61893	20120	1616					
	264826	832145	299896	24331					

	SCHOOL DISTRICT NO.	LOCAL 1 MILL	SPECIAL	STATE LOAN	Deficiency	Transp.	C. O.	TOTALS
MARCH SETTLEMENT								
		92	1846		3692	67	1385	7082
		1060	42420		42420	774	15908	102582
Totals		1152	44266		46112	841	17293	109664
JUNE SETTLEMENT								
		1002	20054		40110	732	15044	76942
		3123	124930		124930	2280	46849	302112
Totals		4125	144984		165040	3012	61893	379054
NOVEMBER SETTLEMENT								
		436	8724		17447	318	6543	33468
		905	36205		36205	660	13577	87552
Totals		1341	44927		53652	978	20120	121020
NOVEMBER to JANUARY								
		22	448		897	16	336	1719
		86	3414		3414	62	1290	7256
Totals		108	3862		4311	78	1616	9975
ADDITIONS	School District No.							
	Totals							
REDUCTIONS	School District No.							
	Totals							

Assessment Roll and Tax List of Real Property in the Town of Avon of Avon

* Indicate Type of Property: R-Residential, C-Commercial, I-Industrial, U-Utility, F-Farm, L-Lakeshore, T-Timber, M-Mineral

Form 50D (56) WILCO-DAY COMPANY, MINNEAPOLIS

Table with columns: IN WHOSE NAME ASSESSED, TO WHOM TRANSFERRED, DESCRIPTION OF PROPERTY, TRUE AND FULL VALUATIONS, ASSESSED VALUATIONS, and FINAL EQUALIZED VALUE. Includes handwritten entries for names like Hannah Thomas, Albert & Lydia Thomas, etc.

(continued on next page)

Cass County, Minnesota, for Taxes for the Year 1956.

Table with columns: SOLD FOR TAXES, VALUATIONS BY SCHOOL DISTRICTS AS EQUALIZED BY DEPARTMENT OF TAXATION, SPECIAL TAXES, TOTAL TAXES, PAID, WHEN PAID, and REMARKS. Includes handwritten entries for tax amounts and payment dates.

Assessment Roll and Tax List of Real Property in the Town of Loun of Siam

* Indicate Type of Property: R-Residential, C-Commercial, I-Industrial, U-Utility, F-Farm, L-Lakeshore, T-Timber, M-Mineral

Form SCD (56) HILLS-BLVD COMPANY, MINNEAPOLIS

IN WHOSE NAME ASSESSED	TO WHOM TRANSFERRED	SUBDIVISION	Sec. or Lot	Town or Block	Reg.	Number of Acres of Land	No. School District	Indicate Homestead Yes or No	Indicate Agricultural Yes or No	* Indicate Type of Property	TRUE AND FULL VALUATIONS				ASSESSED VALUATIONS						FINAL EQUALIZED VALUE
											LAND Exclusive of Structures and Improvements	BUILDINGS and Other Structures	MACHINERY Permanently Attached to Real Estate	TOTAL True and Full Value	RURAL		ALL OTHER			MACHINERY Permanently Attached to Real Estate	
		Acres		100ths		Dollars		Dollars		Dollars		Dollars		Dollars		Dollars		Dollars		Dollars	
		NE 1/4 of NE 1/4	1	140 31																	
		NW 1/4 of NE 1/4	2																		
		SW 1/4 of NE 1/4	3																		
		SE 1/4 of NE 1/4	4																		
		NE 1/4 of NW 1/4	6																		
		NW 1/4 of NW 1/4	7																		
		SW 1/4 of NW 1/4	8																		
		SE 1/4 of NW 1/4	9																		
		NE 1/4 of SW 1/4	11																		
		NW 1/4 of SW 1/4	12																		
Harry & David Wayne Lundberg		72150' of S. 933' of Lot 6 of NW 1/4 SW 1/4 of SW 1/4 road	13					Yes	Yes	R	75		75	15			15				
Harry W. Lundberg		SE 1/4 of SW 1/4 less S 1/4	14			30		"	"	T	135		135	27			27				
Walton Zapke & Gordon Peterson		NE 1/4 of SW 1/4 of SW 1/4	15			10		No	"	"	99		99	33			33				
James A. Hance		NE 1/4 of SE 1/4	16			40		"	"	"	102		102	34			34				
Adair & Ernest Rausch		NW 1/4 of SE 1/4	17			40		"	"	"	102		102	34			34				
Ralph G. & Martha Dahley		SW 1/4 of SE 1/4 less 1 ac. school	18			39		Yes	"	R	134	236	370	74			74				
Lloyd W. & Ethelwyn Reed		SE 1/4 of SE 1/4	19			40		No	"	T	132		132	44			44				
Edwards & Co. Inc. & J. M. Peterson		2 1/2 of 2 1/2 of 2 1/2 of 2 1/2	20			5															
						199					779	236	1015	116	145			261			

Cass County, Minnesota, for Taxes for the Year 1956.

SOLD FOR TAXES	VALUATIONS BY SCHOOL DISTRICTS AS EQUALIZED BY DEPARTMENT OF TAXATION						Tax including State Homestead	State Tax on Non-Homestead	SPECIAL TAXES	TOTAL TAXES	PAID	WHEN PAID	Number of Receipt	March Settlement 1957	June Settlement 1957	Penalty	November Settlement 1957	Penalty	Collections to First Monday in January 1958	Penalty	Delinquent on First Monday in January 1958	Total Delinquent Tax and Penalty	REMARKS
	District No.	District No.	District No.	District No.	District No.	District No.																	
	Rate Mills	Rate Mills	Rate Mills	Rate Mills	Rate Mills	Rate Mills																	

Harry & David Wayne Lundberg
 Harry W. Lundberg
 Walton Zapke & Gordon Peterson
 James A. Hance
 Adair & Ernest Rausch
 Ralph G. & Martha Dahley
 Lloyd W. & Ethelwyn Reed
 Edwards & Co. Inc. & J. M. Peterson

1526
 932
 3156
 1025
 3156

to be on file
 10 ac. school tax
 all 4 names.

Long Beach
 Shady Shores
 White Pine Beach
 Plainview Beach

Assessment Roll and Tax List of Real Property in the Town of Laramie

* Indicate Type of Property: R-Residential, C-Commercial, I-Industrial, U-Utility, F-Farm, L-Lakeshore, T-Timber, M-Mineral

Form 50D (56) MILLER-SILVER COMPANY, MINNEAPOLIS

IN WHOSE NAME ASSESSED	TO WHOM TRANSFERRED	DESCRIPTION OF PROPERTY				No. School District	Indicate Homestead Yes or No	Indicate Agricultural Yes or No	* Indicate Type of Property	TRUE AND FULL VALUATIONS				ASSESSED VALUATIONS					Total Assessed Value as Equalized by the Board of Review	FINAL EQUALIZED VALUE		
		SUBDIVISION	Sec. of Lot	Town or Block	Rng.					Number of Acres of Land	LAND Exclusive of Structures and Improvements	BUILDINGS and Other Structures	MACHINERY Permanently Attached to Real Estate	TOTAL True and Full Value	RURAL		ALL OTHER				MACHINERY Permanently Attached to Real Estate	TOTAL ASSESSED VALUE
															Acres	100ths	Homestead Up to \$4,000 20%	Over \$4,000 and Non-Homestead 33 1/3%				
<i>Mathilda Blateman</i>		That part of Lot 3, Sec. 8-140-31 Described as follows: Beg. at a point 23 rds W. & 14 rds S. of the NE cor. of said Lot 3 thence S. 14 rds; E. to Ten Mile Lake N. following lakeshore to a point 14 rds S. of N. line of said Lot 3; thence W. to place of beg.	8-140-31	Quadrant NW	10	Yes	T		30				30	10		10						
		6 NE 1/4 of NW 1/4																				
		7 NW 1/4 of NW 1/4																				
		8 SW 1/4 of NW 1/4																				
		9 SE 1/4 of NW 1/4																				
		10																				
		11 NE 1/4 of SW 1/4																				
		12 NW 1/4 of SW 1/4																				
		13 SW 1/4 of SW 1/4																				
		14 SE 1/4 of SW 1/4																				
		15																				
		16 NE 1/4 of SE 1/4																				
		17 NW 1/4 of SE 1/4																				
		18 SW 1/4 of SE 1/4																				
		19 SE 1/4 of SE 1/4																				
		20							30				30	10		10						

Cass County, Minnesota, for Taxes for the Year 1956.

SOLD FOR TAXES	VALUATIONS BY SCHOOL DISTRICTS AS EQUALIZED BY DEPARTMENT OF TALENT						Tax including State Homestead	State Tax on Non-Homestead	SPECIAL TAXES	TOTAL TAXES	PAID	WHEN PAID	Number of Receipt	March Settlement 1957	June Settlement 1957	Penalty	November Settlement 1957	Penalty	Collections to First Monday in January 1958	Penalty	Delinquent on First Monday in January 1958	Total Delinquent Tax and Penalty	REMARKS
	District No.	District No.	District No.	District No.	District No.	District No.																	
	Rate	Rate	Rate	Rate	Rate	Rate																	
	Mills	Mills	Mills	Mills	Mills	Mills																	
1		10					206	06	212	1	PAID IN FULL	MAR 22 1956	5760										
2										2													
3										3													
4										4													
5										5													
6										6													
7										7													
8										8													
9										9													
10										10													
11										11													
12										12													
13										13													
14										14													
15										15													
16										16													
17										17													
18										18													
19										19													
20										20													

Long Beach Sandy Shores White Pine Beach Plainview Beach

Assessment Roll and Tax List of Real Property in the Dawn of Heward,

* Indicate Type of Property: R-Residential, C-Commercial, I-Industrial, U-Utility, F-Farm, L-Lakeshore, T-Timber, M-Mineral

Form 5CD (56) HILLS-BLAIR COUNTY, MINNESOTA

IN WHOSE NAME ASSESSED	TO WHOM TRANSFERRED	DESCRIPTION OF PROPERTY				No. School District	Indicate Homestead Yes or No	Indicate Agricultural Yes or No	Indicate Type of Property	TRUE AND FULL VALUATIONS				ASSESSED VALUATIONS							FINAL EQUALIZED VALUE																	
		SUBDIVISION	Sec. of Lot	Town or Block	Rng.					Number of Acres of Land	LAND Exclusive of Structures and Improvements	BUILDINGS and Other Structures	MACHINERY Permanently Attached to Real Estate	TOTAL True and Full Value	RURAL		ALL OTHER			MACHINERY Permanently Attached to Real Estate		TOTAL ASSESSED VALUE	Total Assessed Value as Equalized by the Board of Review															
															Acres	100ths	Homestead Up to \$4,000 20%	Over \$4,000 and Non-Homestead 33 1/3%	Timber Land Class 3e 20%					Homestead Up to \$4,000 25%	Over \$4,000 and Non-Homestead 40%	33 1/3%	Dollars	Dollars	Dollars	Dollars	Dollars	Dollars						
<i>George C. Brandt, Jr.</i>		NE 1/4 of NE 1/4	9	140	31	1932			R	207	1752		1959		652		652																					
		NW 1/4 of NE 1/4																																				
		SW 1/4 of NE 1/4																																				
		SE 1/4 of NE 1/4																																				
		NE 1/4 of NW 1/4																																				
		NW 1/4 of NW 1/4																																				
		SW 1/4 of NW 1/4																																				
		SE 1/4 of NW 1/4																																				
		NE 1/4 of SW 1/4																																				
<i>Carl August Lind.</i>		NW 1/4 of SW 1/4							L	126			126		42		42																					
		SE 1/4 of SW 1/4				1			L																													
		NE 1/4 of SE 1/4																																				
		NW 1/4 of SE 1/4																																				
		SW 1/4 of SE 1/4																																				
		SE 1/4 of SE 1/4																																				

Cass County, Minnesota, for Taxes for the Year 1956.

SOLD FOR TAXES	VALUATIONS BY SCHOOL DISTRICTS AS EQUALIZED BY DEPARTMENT OF TAXATION						Tax including State Homestead	State Tax on Non-Homestead	SPECIAL TAXES	TOTAL TAXES	PAID	WHEN PAID	Number of Receipt	March Settlement 1957	June Settlement 1957	Penalty	November Settlement 1957	Penalty	Collections to First Monday in January 1958	Penalty	Delinquent on First Monday in January 1958	Total Delinquent Tax and Penalty	REMARKS
	District No.	District No.	District No.	District No.	District No.	District No.																	
	Rate	Rate	Rate	Rate	Rate	Rate																	

Long Beach
Shady Shores
White Pine Beach
Plainview Beach

Assessment Roll and Tax List of Real Property in the Dawn of Airam

* Indicate Type of Property: R-Residential, C-Commercial, I-Industrial, U-Utility, F-Farm, L-Lakeshore, T-Timber, M-Mineral

Form SCID (56) WILSON-BATE COMPANY, MINNEAPOLIS

Table with columns: IN WHOSE NAME ASSESSED, TO WHOM TRANSFERRED, DESCRIPTION OF PROPERTY, TRUE AND FULL VALUATIONS, ASSESSED VALUATIONS, and FINAL EQUALIZED VALUE. Includes handwritten entries for properties owned by Helen A. Dalton, John F. & Alma M. Matthias, Marjorie Foxgman, Cabner J. & Amelia Borseth, Dr. Harold & Virginia B. Gov, Lillian Margaret & Jennie R. Wilson, and Harry Alton & Esther Augusta Johnson.

(Continued on next page)

Cass County, Minnesota, for Taxes for the Year 1956.

Table with columns: VALUATIONS BY SCHOOL DISTRICTS AS EQUALIZED BY DEPARTMENT OF TAXATION, Tax including State Homestead, State Tax on Non-Homestead, SPECIAL TAXES, TOTAL TAXES, PAID, WHEN PAID, Number of Receipt, March Settlement 1957, June Settlement 1957, Penalty, November Settlement 1957, Penalty, Collections to First Monday in January 1958, Delinquent on First Monday in January 1958, Total Delinquent Tax and Penalty, REMARKS. Includes handwritten notes like 'PAID IN FULL' and 'PAID ON FULL'.

Long Beach, Sandy Shores, White Pine Beach, Plainview Beach

Assessment Roll and Tax List of Real Property in the Town of Avion,

* Indicate Type of Property: R-Residential, C-Commercial, I-Industrial, U-Utility, F-Farm, L-Lakeshore, T-Timber, M-Mineral

Form SCD (1957) BILLS-BAYNE COMPANY, MINNEAPOLIS

IN WHOSE NAME ASSESSED	TO WHOM TRANSFERRED	DESCRIPTION OF PROPERTY				No. School District	Indicate Homestead Yes or No	Indicate Agricultural Yes or No	Indicate Type of Property	TRUE AND FULL VALUATIONS				ASSESSED VALUATIONS						FINAL EQUALIZED VALUE		
		SUBDIVISION	Sec. or Lot	Town or Block	Rng.					Number of Acres of Land	LAND Exclusive of Structures and Improvements	BUILDINGS and Other Structures	MACHINERY Permanently Attached to Real Estate	TOTAL True and Full Value	RURAL		ALL OTHER		MACHINERY Permanently Attached to Real Estate		TOTAL ASSESSED VALUE	Total Assessed Value as Equalized by the Board of Review
															Acres	100ths	Homestead Up to \$1,000 20%	Over \$4,000 and Non-Homestead 33 1/3%				
M. B. & Luu Mae Lathrop	Part of Lot 1 formerly Lot 1-12, Blk 2; Lot 1-10, Blk 4; Lot 1-19, Blk 5; Lot 1-7, Blk 6, Plat of Long Beach, less 5.68'				11-170-31	6	No	No	R	300	807		1107	369		369						
Bernice & Leonard M. Stabler	Part of Lot 1 formerly Lot 14, Blk 6, Plat of Long Beach						No	No	L	51			51	17		17						
E. D. Ramaley	Part of Lot 1 formerly Lots 8 to 13 in Blk 6, Plat of Long Beach						No	No	L	150			150	50		50						
David P. & Helen B. Anderson	5.68 ac of Lot 1 (300' in Lot 1-6, Blk 6, Plat of Long Beach)					5.68	No	No	R	300	921		1221	407		407						
	NE 1/4 of NW 1/4																					
	NW 1/4 of NW 1/4																					
	SW 1/4 of NW 1/4																					
	SE 1/4 of NW 1/4																					
Robert H. & Mahab Mayer	Part of Lot 3 formerly lots 54 to 78 "Shady Shores"					6.50	Yes	Yes	T	40			40	8		8						
	NE 1/4 of SW 1/4																					
	NW 1/4 of SW 1/4																					
Helen A. Dalton & Catherine A. Kram	SW 1/4 of SW 1/4 Lot 4					36	No	No	C	540	1587 660		2787	240 529		769						
	SE 1/4 of SW 1/4																					
Blair J. Moore, Elgin & Caroline Stalla	Lot 3 less vacated lots 54 to 78 "Shady Shores"					8.90	No	No	L	54			54	18		18						
	NE 1/4 of SE 1/4																					
	NW 1/4 of SE 1/4																					
	SW 1/4 of SE 1/4																					
The Leudtke Company	Platted to Sunset Beach Lot 2					40	No	Yes	T	321			321	107		107						
	SE 1/4 of SE 1/4																					
						103.04				1756	3975		5731	248 1497		1745						

Cass County, Minnesota, for Taxes for the Year 1956.

SOLD FOR TAXES	VALUATIONS BY SCHOOL DISTRICTS AS EQUALIZED BY DEPARTMENT OF TAXATION						Tax including State Homestead	State Tax on Non-Homestead	SPECIAL TAXES	TOTAL TAXES	PAID	WHEN PAID	Number of Receipt	March Settlement 1957	June Settlement 1957	Penalty	November Settlement 1957	Penalty	Collections to First Monday in January 1958	Penalty	Delinquent on First Monday in January 1958	Total Delinquent Tax and Penalty	REMARKS
	District No.	District No.	District No.	District No.	District No.	District No.																	
	Rate	Rate	Rate	Rate	Rate	Rate																	
1							8350	198		8548	PAID IN FULL	MAY 27 1957	7805										
2																							
3							384	10		394													394
4							1132	26		1158													1158
5							9210	218		9428	PAID IN FULL	JUL 7 1957	1739										9428
6																							
7																							
8																							
9																							
10							166			166	PAID IN FULL	JUN 29 1957	129.02										166.06
11																							
12																							
13							174.00	282		17682	PAID IN FULL	APR 22 1957	3739										17682
14																							
15							408	10		418	PAID IN FULL	APR 15 1957	5996										418
16																							
17																							
18																							
19							2208	58		2266	2nd time PAID	OCT 26 1957	15681										1133
20							107			107													
							107			107													
							115			115													
							1390	1497		1630													
							248	1745		2374													
							36884	802		39258													
							40060			40060													
							9428	27781		1299													
							1552																

Long Beach, Shady Shores, White Pine Beach, Plainview Beach

Assessment Roll and Tax List of Real Property in the Town of *Down* of *Stearns*

* Indicate Type of Property: R-Residential, C-Commercial, I-Industrial, U-Utility, F-Farm, L-Lakeshore, T-Timber, M-Mineral

IN WHOSE NAME ASSESSED	TO WHOM TRANSFERRED	SUBDIVISION	Sec. of Lot	Town or Block	Rng.	Number of Acres of Land	TRUE AND FULL VALUATIONS				ASSESSED VALUATIONS					FINAL EQUALIZED VALUE		
							LAND Exclusive of Structures and Improvements	BUILDINGS and Other Structures	MACHINERY Permanently Attached to Real Estate	TOTAL True and Full Value	RURAL		ALL OTHER				TOTAL ASSESSED VALUE	Total Assessed Value as Equalized by the Board of Review
											Homestead Up to \$4,000 20%	Over \$4,000 and Non-Homestead 33 1/3%	Timber Land Class 3e 20%	Homestead Up to \$4,000 25%	Over \$4,000 and Non-Homestead 40%			
Hazel E. Kent		NE 1/4 of NE 1/4	12	140	31	40	198	197	395	79				79				
J. A. Mack		NW 1/4 of NE 1/4				20	60		60		20			20				
Mrs Oscar Postrom		SW 1/4 of NE 1/4				40	70		70		14			14				
Mary Foster		SE 1/4 of NE 1/4				40	201		201		67			67				
Joseph Daniel & Anna E. Moran		NE 1/4 of NE 1/4 of NE 1/4				20	110	620	730	146				146				
Arvid & Lorraine Anderson		NE 1/4 of NW 1/4				40	300		300		100			100				
Frank Fairfield Murray, Jr.		NW 1/4 of NW 1/4 "Columbia"				10	80	375	455	91				91				
H. C. Johnson		SW 1/4 of NW 1/4 "Pine Beach" "A" add.				25	83	152	235	47				47				
Oscar & Mabel Postrom		SE 1/4 of NW 1/4				40	160		160	32				32				
Emma Marie E. Carlson		SW 1/4 of NW 1/4				40	149	832	981	327				327				
H. C. Johnson		NE 1/4 of SW 1/4				40	70		70	14				14				
"		NW 1/4 of SW 1/4 less sold				40	115		115	23				23				
Frank Wood		SW 1/4 of SW 1/4				40	328	242	570	114				114				
R. E. Stella D. & Jas. H. Buchanan		SE 1/4 of SW 1/4 Lot 5				30.50	306		306		102			102				
Oscar Postrom		435' x 700' Side of road, Lot 1				6	36	464	500	100				100				
Mabel Postrom		NE 1/4 of SE 1/4				40	160		160	32				32				
"		NW 1/4 of SE 1/4				40	100		100	20				20				
John Fredrickson		SW 1/4 of SE 1/4 Lot 4				29	168		168		56			56				
"		Lot 3 less 20' of 300' of E. 800' & less 20' of E. 200' of E. 500' & less E. SE 1/4 of SE 1/4 200' x less N. 103 1/2' of E. 300'				13.02	90		90		30			30				
Donald Hemmingfield		2x100' of E. 300' of Lot 3				2.56	75	120	195	65				65				
(Continued on next page)							556.08	2859	3002	5861	712	769		1499				

Cass County, Minnesota, for Taxes for the Year 1956.

SOLD FOR TAXES	VALUATIONS BY SCHOOL DISTRICTS AS EQUALIZED BY DEPARTMENT OF TAXATION						Tax Including State Homestead	State Tax on Non-Homestead	SPECIAL TAXES	TOTAL TAXES	PAID	WHEN PAID	Number of Receipt	March Settlement 1957	June Settlement 1957	Penalty	November Settlement 1957	Penalty	Collections to First Monday in January 1958	Penalty	Delinquent on First Monday in January 1958	Total Delinquent Tax and Penalty	REMARKS	
	District No.	District No.	District No.	District No.	District No.	District No.																		
	Rate	Rate	Rate	Rate	Rate	Rate																		
	Mills	Mills	Mills	Mills	Mills	Mills																		
	H 79					16.30			16.30	1	PAID IN FULL MAY 15 1957	6153		16.30										
	H 20					4.12	10		4.22	2	PAID IN FULL MAY 31 1957	10672		4.22										
SOLD FOR TAXES	H 14					2.88			2.88	3											2.88			
SOLD FOR TAXES	H 67					13.87	36		14.18	4	PAID IN FULL APR 15 1957	15056		14.18		50								
	H 146					30.12			30.12	5	PAID IN FULL NOV 25 1957	17131						30.12	2.41					
	H 100					20.62	54		21.16	6											21.16	23.28		
	H 91					18.78			18.78	7	PAID IN FULL MAY 20 1957	8156		18.78										
	H 47					9.70			9.70	8	PAID IN FULL APR 13 1957	5599		9.70										
SOLD FOR TAXES	H 32					6.60			6.60	9											6.60			
						7.40	1.74		7.74	10	PAID IN FULL APR 22 1957	3742		7.74										
	H 14					2.88			2.88	11	PAID IN FULL APR 13 1957			2.88										
	H 23					4.74			4.74	12	PAID IN FULL APR 13 1957	5599		4.74										
	H 114					23.57			23.57	13	PAID IN FULL MAY 31 1957	8526		23.57										
						21.04	54		21.58	14	PAID IN FULL JAN 17 1957	68	21.58											
SOLD FOR TAXES	H 100					20.62			20.62	15											20.62			
SOLD FOR TAXES	H 32					6.60			6.60	16											6.60			
SOLD FOR TAXES	H 20					4.12			4.12	17											4.12			
						11.56	30		11.86	18	PAID IN FULL APR 11 1957	5147		11.86								11.86	18.20	
						6.18	16		6.34	19	PAID IN FULL APR 11 1957			6.34										
						14.70	34		15.04	20	PAID IN FULL MAY 31 1957	10609		15.04										
	H 712					3.25			3.25															
						108.7			108.7															
						392.767			392.767															
						147.9			147.9															
						224.20			224.20															
						408			408															
						312.90			312.90															
						215.8			215.8															
						189.12			189.12															
						14.18			14.18															
						30.12			30.12															
						61.98			61.98															

Long Beach
Stacy Shores
White Pine Beach
Plainview Beach
Re-arrangement of 104

Assessment Roll and Tax List of Real Property in the Town of *Louis* of *Hiram*

* Indicate Type of Property: R-Residential, C-Commercial, I-Industrial, U-Utility, F-Farm, L-Lakeshore, T-Timber, M-Mineral

IN WHOSE NAME ASSESSED	TO WHOM TRANSFERRED	DESCRIPTION OF PROPERTY				TRUE AND FULL VALUATIONS											FINAL EQUALIZED VALUE																				
		SUBDIVISION	Sec. of Lot	Town or Block	Reg.	Number of Acres of Land	No. School District	Indicate Homestead Yes or No	Indicate Agricultural Yes or No	Indicate Type of Property	LAND EXCLUSIVE OF STRUCTURES AND IMPROVEMENTS				BUILDINGS AND OTHER STRUCTURES				MACHINERY Permanently Attached to Real Estate		TOTAL True and Full Value		RURAL		ALL OTHER			MACHINERY Permanently Attached to Real Estate	TOTAL ASSESSED VALUE	Total Assessed Value as Equalized by the Board of Review							
											Dollars	Dollars	Dollars	Dollars	Dollars	Dollars		Dollars	Dollars	Dollars	Dollars	Dollars	Dollars	Dollars	Dollars	Dollars	Dollars				Homestead Up to \$1,000		Over \$1,000 and Non-Homestead	Timber Land Class 3e	Homestead Up to \$1,000	Over \$1,000 and Non-Homestead	Dollars
																															20%	33 1/3%					
<i>M. C. & Lou Mae Lathrop</i>		<i>2 acres of Lot 24 of NW 1/4 of S 10 N 14</i>	<i>12</i>	<i>190</i>	<i>31</i>				<i>No</i>	<i>No</i>	<i>R</i>	<i>15</i>								<i>15</i>						<i>5</i>				<i>5</i>							
<i>Henry H. & Ann L. Bancroft</i>		<i>200' of Lot 3 NW 1/4 of NE 1/4</i>				<i>5.12</i>			<i>No</i>	<i>No</i>	<i>R</i>	<i>150</i>	<i>201</i>							<i>351</i>	<i>117</i>					<i>117</i>				<i>117</i>							
<i>Erwin J. & Madeline Feldbrugge</i>		<i>21' 100' of E. 1/2 of Lot 3 SW 1/4 of NE 1/4</i>				<i>2.56</i>			<i>No</i>	<i>No</i>	<i>R</i>	<i>75</i>	<i>366</i>							<i>441</i>	<i>147</i>					<i>147</i>				<i>147</i>							
<i>Hertude M. Hitzman, H.F. & Carl D. Milander</i>		<i>85' x 200' of Lot 1 NE 1/4 of NW 1/4</i>				<i>40</i>			<i>No</i>	<i>No</i>	<i>R</i>	<i>84</i>	<i>276</i>							<i>360</i>	<i>120</i>					<i>120</i>				<i>120</i>							
<i>Eugene & Alta S. Byrne</i>		<i>21' 100' of E. 1/2 of Lot 3 SW 1/4 of NW 1/4</i>				<i>2.56</i>			<i>No</i>	<i>No</i>	<i>R</i>	<i>75</i>	<i>135</i>							<i>210</i>	<i>70</i>					<i>70</i>				<i>70</i>							
<i>Hertude M. Hitzman & H.F. Carl D. Milander</i>		<i>85' x 200' of Lot 1 NE 1/4 of SW 1/4</i>				<i>40</i>			<i>No</i>	<i>No</i>	<i>R</i>	<i>85</i>	<i>80</i>							<i>165</i>	<i>55</i>					<i>55</i>				<i>55</i>							
<i>Max E. Mc Kay</i>		<i>21' 100' of E. 1/2 of Lot 3 NW 1/4 of SW 1/4</i>				<i>2.56</i>			<i>Yes</i>	<i>No</i>	<i>R</i>	<i>75</i>	<i>195</i>							<i>270</i>	<i>54</i>					<i>54</i>				<i>54</i>							
<i>Don E. & Ruth H. Rice</i>		<i>7' 20' of E. 1/2 of Lot 1 SW 1/4 of SW 1/4 Co. Road</i>							<i>Yes</i>	<i>No</i>	<i>R</i>	<i>20</i>								<i>20</i>	<i>4</i>					<i>4</i>				<i>4</i>							
<i>Mary E. Bennethan</i>		<i>7' 20' of E. 1/2 of Lot 1 NE 1/4 of SE 1/4</i>							<i>Yes</i>	<i>No</i>	<i>R</i>	<i>100</i>	<i>1365</i>							<i>1465</i>	<i>293</i>					<i>293</i>				<i>293</i>							
<i>Clarence L. & Bernice M. Huse</i>		<i>E. 1/2 of Lot 2 SW 1/4 of SE 1/4</i>							<i>No</i>	<i>No</i>	<i>R</i>	<i>75</i>	<i>222</i>							<i>297</i>	<i>99</i>					<i>99</i>				<i>99</i>							
<i>Marc St. Wheeler</i>		<i>E. 1/2 of Lot 2 SW 1/4 of SE 1/4</i>				<i>8.12</i>			<i>No</i>	<i>No</i>	<i>R</i>	<i>51</i>	<i>192</i>							<i>243</i>	<i>81</i>					<i>81</i>				<i>81</i>							
						<i>104.12</i>						<i>805</i>	<i>3032</i>							<i>3837</i>	<i>361</i>					<i>1045</i>				<i>1045</i>							

Cass County, Minnesota, for Taxes for the Year 1956.

SOLD FOR TAXES	VALUATIONS BY SCHOOL DISTRICTS AS EQUALIZED BY DEPARTMENT OF TAXATION						Tax Including State Homestead	State Tax on Non-Homestead	SPECIAL TAXES	TOTAL TAXES	PAID	WHEN PAID	Number of Receipt	March Settlement 1957	June Settlement 1957	November Settlement 1957	Penalty	Collections to First Monday in January 1958	Penalty	Delinquent on First Monday in January 1958	Total Delinquent Tax and Penalty	REMARKS		
	District No.	Rate	District No.	Rate	District No.	Rate																		
	Dollars	Dollars	Dollars	Dollars	Dollars	Dollars																		
	Dollars	Dollars	Dollars	Dollars	Dollars	Dollars																		
1							<i>02</i>		<i>106</i>	<i>1</i>	<i>PAID IN FULL MAY 27 1957</i>	<i>7805</i>											<i>-116</i>	
2				<i>117</i>			<i>62</i>		<i>2710</i>	<i>2</i>	<i>PAID IN FULL MAY 31 1957</i>	<i>10606</i>											<i>-2710</i>	
3				<i>147</i>			<i>78</i>		<i>3404</i>	<i>3</i>	<i>PAID IN FULL APR 22 1957</i>	<i>3744</i>											<i>-3404</i>	
5				<i>120</i>			<i>64</i>		<i>2780</i>	<i>5</i>	<i>2nd Half Paid OCT 31 1957</i> <i>1st Half Paid MAY 31 1957</i>	<i>16128</i> <i>10608</i>										<i>-1390</i>	<i>1390</i>	
8				<i>70</i>			<i>38</i>		<i>1584</i>	<i>8</i>	<i>PAID IN FULL MAY 31 1957</i>	<i>10607</i>											<i>-1622</i>	
10				<i>55</i>			<i>30</i>		<i>1244</i>	<i>10</i>	<i>2nd Half Paid OCT 31 1957</i> <i>1st Half Paid MAY 31 1957</i>	<i>16128</i> <i>10608</i>											<i>-637</i>	<i>637</i>
12				<i>454</i>			<i>22</i>		<i>1272</i>	<i>12</i>	<i>PAID IN FULL MAY 3 1957</i>	<i>6005</i>											<i>-1222</i>	
13				<i>44</i>			<i>90</i>		<i>90</i>	<i>13</i>	<i>PAID IN FULL APR 22 1957</i>	<i>3743</i>											<i>-90</i>	
15				<i>293</i>			<i>30</i>		<i>6630</i>	<i>15</i>	<i>PAID IN FULL APR 22 1957</i>	<i>6630</i>											<i>-6630</i>	
16				<i>99</i>			<i>50</i>		<i>2240</i>	<i>16</i>	<i>PAID IN FULL MAY 28 1957</i>	<i>7819</i>											<i>-2292</i>	
20				<i>81</i>			<i>44</i>		<i>1832</i>	<i>20</i>	<i>PAID IN FULL MAY 31 1957</i>	<i>8217</i>											<i>-1876</i>	
				<i>5</i>			<i>370</i>		<i>23532</i>	<i>5</i>													<i>-21979</i>	<i>2027</i>

Assessment Roll and Tax List of Real Property in the Town of Aurora of Illinois

* Indicate Type of Property: R-Residential, C-Commercial, I-Industrial, U-Utility, F-Farm, L-Lakeshore, T-Timber, M-Mineral

IN WHOSE NAME ASSESSED	TO WHOM TRANSFERRED	DESCRIPTION OF PROPERTY				TRUE AND FULL VALUATIONS							ASSESSED VALUATIONS				FINAL EQUALIZED VALUE
		Subdivision	Sec. or Lot	Town or Block	Acres	LAND Exclusive of Structures and Improvements	BUILDINGS and Other Structures	MACHINERY Permanently Attached to Real Estate	TOTAL True and Full Value	RURAL Homestead Up to \$4,000 20%	Over \$4,000 and Non-Homestead 33 1/3%	Timber Land Class 3e 20%	ALL OTHER Homestead Up to \$4,000 25%	Over \$4,000 and Non-Homestead 40%	MACHINERY Permanently Attached to Real Estate 33 1/3%	TOTAL ASSESSED VALUE	
Peter & Esther Swanson		E. 1/2 of Lot 1 N.E. 1/4 of N.E. 1/4	14	31	18	210	651		861		287				287		
		N.W. 1/4 of N.E. 1/4															
		S.W. 1/4 of N.E. 1/4															
Chas Murray		2 1/2 acres of Lot 1 S.E. 1/4 of N.E. 1/4			18	240			240		80				80		
Karl & Eva M. Martin		500 ft wide on E. side of Lot 2			11	164	700		864		288				288		
E. Arthur & Nellie Ericson		N.E. 1/4 of N.W. 1/4 Lot 3			75	60			60		20				20		
George C. & Opal Dietz		Lot 4 less plat of Raymond			10.30	123			123		41				41		
Helma N. & Alfred C. Skoock		S.W. 1/4 of N.W. 1/4 Lot 5			39	130			130	26					26		
Isabella H. Johnstone		S.E. 1/4 of N.W. 1/4 Lot 6			36	230			230		110				110		
Victor E. Martin		N.E. 1/4 of S.W. 1/4			40	140			140		28				28		
State of Minnesota		N.W. 1/4 of S.W. 1/4									38				38		
Wilbert A. Johnson		S.W. 1/4 of S.W. 1/4			40	114			114		38				38		
Victor E. Martin		S.E. 1/4 of S.W. 1/4			40	185	720		905	181					181		
State of Minnesota		Lot 9															
Adam M. & Helen Larigues Smith		N.E. 1/4 of S.E. 1/4 Lot 7 less S. 9.6 ac.			37.65	379	242		621		207				207		
Victor E. Martin		S.W. 1/4 of S.E. 1/4 Lot 8			13.50	180	270		450	36	90				126		
Isabella H. Johnstone		S.E. 1/4 of S.E. 1/4				93	1329		1422		474				474		
		S. 9.6 ac of Lot 7			9.60												
					313.90	2348	3912		6260	271	1635				1906		

Cass County, Minnesota, for Taxes for the Year 1956.

SOLD FOR TAXES	VALUATIONS BY SCHOOL DISTRICTS AS EQUALIZED BY DEPARTMENT OF TAXATION						Tax including State Homestead	State Tax on Non-Homestead	SPECIAL TAXES	TOTAL TAXES	PAID	WHEN PAID	Number of Receipt	March Settlement 1957	June Settlement 1957	November Settlement 1957	Penalty	Collections to First Monday in January 1958	Penalty	Delinquent on First Monday in January 1958	Total Delinquent Tax and Penalty	REMARKS
	District No.	District Rate	District No.	District Rate	District No.	District Rate																
	Dollars	Dollars	Dollars	Dollars	Dollars	Dollars																
							59.40	154		60.74	1	PAID IN FULL	MAY 31 1957	10613		60.74						
							16.50	42		16.92	4	PAID IN FULL	MAY 31 1957	10612		16.92						
							59.40	154		60.74	5	2nd Half Paid	OCT 21 1957	16129			30.47					
												1st Half Paid	JUL 21 1957	13049			30.47		91			
										46.7	6	PAID IN FULL	AUG 5 1957	13382					46.2	09		
										8.46	7	PAID IN FULL	MAY 31 1957	10678					8.68			
										4	26	2nd Half Paid	OCT 31 1957	16140								
										5.36	8	1st Half Paid	MAY 31 1957	7941					2.68		2.68	
										22.70	9	PAID IN FULL	MAY 31 1957	10614					23.28			
										4	28	PAID IN FULL	MAY 14 1957	6100					5.78			
										7.84	13	PAID IN FULL	MAY 31 1957	10611					8.04			
										4	181	PAID IN FULL	MAY 14 1957	6100					37.34			
										20.7	17	PAID IN FULL	MAY 31 1957	10614					43.80			
										4	36	PAID IN FULL	MAY 14 1957	6100					26.48			
										90	40											
										97.78	20	PAID IN FULL	MAY 31 1957	10614					100.32			
										389.06	20											
										16.15	20											
										19.06	20											
										393.58	20								384.06		68.24	

Assessment Roll and Tax List of Real Property in the *Town of Spring* of *Minnesota*

* Indicate Type of Property: R-Residential, C-Commercial, I-Industrial, U-Utility, F-Farm, L-Lakeshore, T-Timber, M-Mineral

Table with columns: IN WHOSE NAME ASSESSED, TO WHOM TRANSFERRED, DESCRIPTION OF PROPERTY, TRUE AND FULL VALUATIONS, ASSESSED VALUATIONS, and FINAL EQUALIZED VALUE. Includes handwritten entries for property owners like Gerald E. Knoch and Alfred Knoch.

(Continued on next page)

Cass County, Minnesota, for Taxes for the Year 1956.

Table with columns: VALUATIONS BY SCHOOL DISTRICTS AS EQUALIZED BY DEPARTMENT OF TAXATION, Tax including State Homestead, SPECIAL TAXES, TOTAL TAXES, PAID, WHEN PAID, Number of Receipt, March Settlement, June Settlement, November Settlement, Collections to First Monday in January 1956, Delinquent on First Monday in January 1956, Total Delinquent Tax and Penalty, and REMARKS. Includes handwritten entries for tax payments and dates.

Assessment Roll and Tax List of Real Property in the Town of... of Minnesota

Indicate Type of Property: R-Residential, C-Commercial, I-Industrial, U-Utility, F-Farm, L-Lakeshore, T-Timber, M-Mineral

Table with columns: IN WHOSE NAME ASSESSED, TO WHOM TRANSFERRED, DESCRIPTION OF PROPERTY, TRUE AND FULL VALUATIONS, ASSESSED VALUATIONS, FINAL EQUALIZED VALUE. Includes handwritten entries for property owners like Carl W. Lorrain, W. H. Fox, etc.

Cass County, Minnesota, for Taxes for the Year 1956.

Table with columns: VALUATIONS BY SCHOOL DISTRICTS AS EQUALIZED BY DEPARTMENT OF TAXATION, Tax including State Homestead, SPECIAL TAXES, TOTAL TAXES, PAID, WHEN PAID, Number of Receipt, March Settlement, June Settlement, November Settlement, Collections to First Monday in January, Delinquent on First Monday in January, Total Delinquent Tax and Penalty, REMARKS. Includes handwritten notes and calculations.

Assessment Roll and Tax List of Real Property in the Town of *Down* of *Hiram*

* Indicate Type of Property: R-Residential, C-Commercial, I-Industrial, U-Utility, F-Farm, L-Lakeshore, T-Timber, M-Mineral

Form 500 (56) WILCOX-BAYNE COMPANY, MINNEAPOLIS

Table with columns: IN WHOSE NAME ASSESSED, TO WHOM TRANSFERRED, DESCRIPTION OF PROPERTY, TRUE AND FULL VALUATIONS, ASSESSED VALUATIONS, VALUATIONS BY SCHOOL DISTRICTS AS EQUALIZED BY DEPARTMENT OF TAXATION, TAXES, PAID, WHEN PAID, Number of Receipt, March Settlement 1957, June Settlement 1957, November Settlement 1957, Penalty, Collections to First Monday in January 1958, Delinquent on First Monday in January 1958, Total Delinquent Tax and Penalty, REMARKS.

(Continued on next page)

9.84 Ave. Log

9.84

Assessment Roll and Tax List of Real Property in the Town of Down of Wisconsin

* Indicate Type of Property: R-Residential, C-Commercial, I-Industrial, U-Utility, F-Farm, L-Lakeshore, T-Timber, M-Mineral

Form 501 (56) MILLER-BAYNE COMPANY, MINNEAPOLIS

Table with columns: IN WHOSE NAME ASSESSED, TO WHOM TRANSFERRED, DESCRIPTION OF PROPERTY, TRUE AND FULL VALUATIONS, ASSESSED VALUATIONS, FINAL EQUALIZED VALUE. Includes handwritten entries for property owners like Joseph L. & Mary J. Major and Henry & Janet Heinsch.

Cass County, Minnesota, for Taxes for the Year 1956.

Table with columns: SOLD FOR TAXES, VALUATIONS BY SCHOOL DISTRICTS AS EQUALIZED BY DEPARTMENT OF TAXATION, SPECIAL TAXES, TOTAL TAXES, PAID, WHEN PAID, Number of Receipt, March Settlement 1957, June Settlement 1957, November Settlement 1957, Collections to First Monday in January 1958, Delinquent on First Monday in January 1958, Total Delinquent Tax and Penalty, REMARKS. Includes handwritten entries for property owners like Henry & Janet Heinsch.

Assessment Roll and Tax List of Real Property in the Lawn of Linn,

* Indicate Type of Property: R-Residential, C-Commercial, I-Industrial, U-Utility, F-Farm, L-Lakeshore, T-Timber, M-Mineral

Form 502 (56) WELLS-GARY COMPANY, MINNEAPOLIS

Table with columns: IN WHOSE NAME ASSESSED, TO WHOM TRANSFERRED, DESCRIPTION OF PROPERTY, TRUE AND FULL VALUATIONS, ASSESSED VALUATIONS, and FINAL EQUALIZED VALUE. Contains handwritten entries and calculations.

Cass County, Minnesota, for Taxes for the Year 1956.

Table with columns: SOLD FOR TAXES, VALUATIONS BY SCHOOL DISTRICTS AS EQUALIZED BY DEPARTMENT OF TAXATION, Tax including State Homestead, State Tax on Non-Homestead, SPECIAL TAXES, TOTAL TAXES, PAID, WHEN PAID, Number of Receipt, March Settlement, June Settlement, November Settlement, Collections to First Monday, Delinquent on First Monday, Total Delinquent Tax and Penalty, and REMARKS. Contains handwritten entries and calculations.

Assessment Roll

Form SCD (56) BULLER-BAYB COMPANY, MINNEAPOLIS

IN WHOSE NAME ASSESSED TO WHOM TRANSFERRED

State of Minnesota 1 N
John Carlsson 2 N
William H. + Edna K. Katz 3 S
State of Minnesota 4 S
L. E. + Selma R. Brown + Merrill W. Z... 5 S
Robert J. Coocke 6 N
Edward O. Schaffer + Jim Armstrong 7 N
Charles Rabash 8 S
Ruth Swenson 9 S
Harold + Alice M. Kostka 10 N
Raymond M. Young 11 N
Jerome F. + Patricia S. Katz 12 N
State of Minnesota 13 S
State of Minnesota 14 S
Blanche H. Stokes 15 S
State of Minnesota 16 N
State of Minnesota 17 N W 1/4 of S E 1/4 Lot 5
State of Minnesota 18 S W 1/4 of S E 1/4
Andrew J. (cont. to Mrs. Jessie B. Day) 19 S E 1/4 of S E 1/4
20

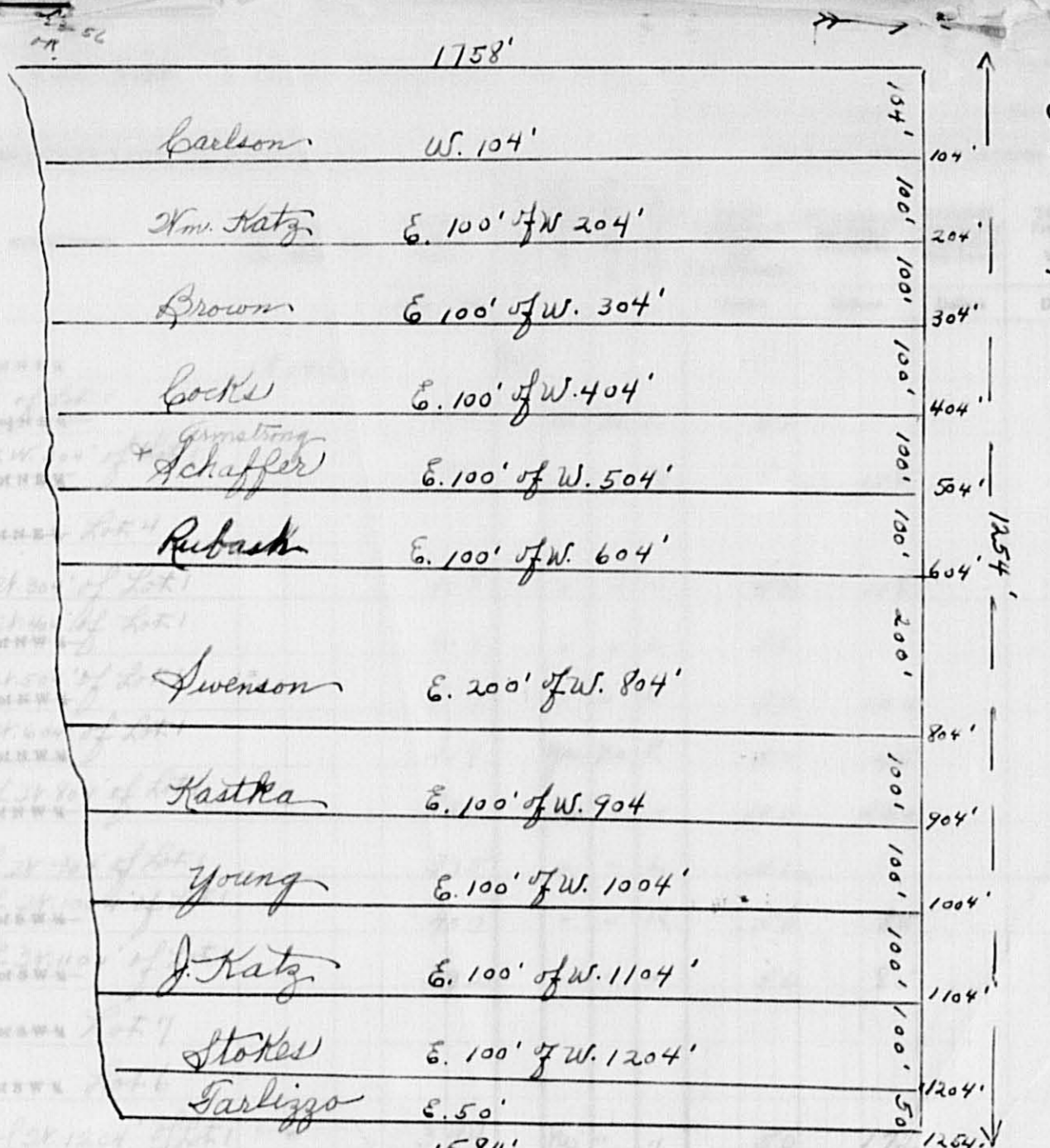

Commercial, I-Industrial, U-Utility, F-Farm, L-Lakeshore, T-Timber, M-Mineral

Table with columns: RURAL, ALL OTHER, MACHINERY, TOTAL ASSESSED VALUE, Total Assessed Value as Equalized by the Board of Review, FINAL EQUALIZED VALUE. Rows 1-20.

Table with columns: VALUATIONS BY SCHOOL DISTRICTS AS EQUALIZED BY DEPARTMENT OF TAXATION, Tax Including State Homestead, State Tax on Non-Homestead, SPECIAL TAXES, TOTAL TAXES, PAID, WHEN PAID, Number of Receipt, March Settlement 1957, June Settlement 1957, Penalty, November Settlement 1957, Penalty, Collections to First Monday in January 1958, Penalty, Delinquent on First Monday in January 1958, Total Delinquent Tax and Penalty, REMARKS. Rows 1-20.

(continued on next page)

8866 1163 947 1710 51 485 336

Cass County, Minnesota, for Taxes for the Year 1956.

Long Beach, Shady Shores, White Pine Beach, Fairview Beach, Po-arrangement of lot

Assessment Roll and Tax List of Real Property in the Town of Miami of Miami

Indicate Type of Property: R-Residential, C-Commercial, I-Industrial, U-Utility, F-Farm, L-Lakeshore, T-Timber, M-Mineral

Form 561 (16) MINN. STATE DEPT. OF TAXATION

Table with columns: IN WHOSE NAME ASSESSED, TO WHOM TRANSFERRED, DESCRIPTION OF PROPERTY, TRUE AND FULL VALUATIONS, ASSESSED VALUATIONS, FINAL EQUALIZED VALUE. Includes handwritten entries for various lots and owners like John Carlson and William H. & Alma S. Katz.

(continued on next page)

Cass County, Minnesota, for Taxes for the Year 1956.

Table with columns: SOLD FOR TAXES, VALUATIONS BY SCHOOL DISTRICTS AS EQUALIZED BY DEPARTMENT OF TAXATION, PAID, WHEN PAID, Number of Receipt, March Settlement 1957, June Settlement 1957, November Settlement 1957, Collections to First Monday in January 1958, Delinquent on First Monday in January 1958, Total Delinquent Tax and Penalty, REMARKS. Includes handwritten entries for various lots and owners.

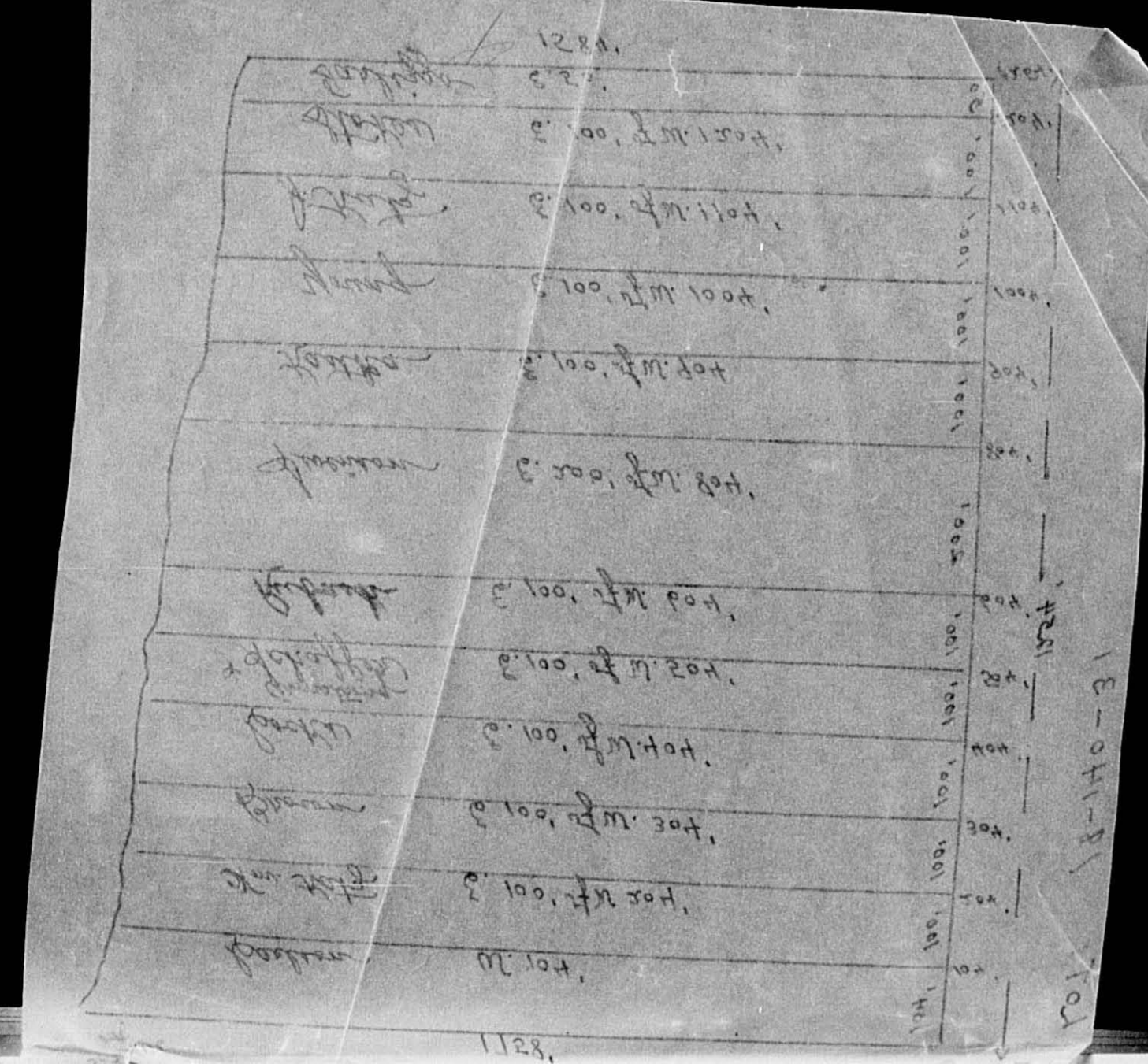

Assessment Roll Tax List of Real Estate in the Township of Cass County, Minnesota, for the Year 1956.

FORM 501 (56) BILLS-BAYNE COMPANY, MINNEAPOLIS

IN WHOSE NAME ASSESSED TO WHOM TRANSFERRED

Angelo & Darliggo West Robert Bissonnet 1
Lorette D. & Douglas W. Woodbeck 2
Lorette Woodbeck 3
Emil H. & Margret Schausnick 4
Ralph E. & Florence M. Bannister 5
Theodore W. & Mary V. Loveland 6
" " " 7
Anthony L. & Lucille A. Boyer 8
" " " 9
Arthur Miller Gordon A. Mickelson 10
Gordon A. & Harris R. Mickelson 11
Marlys J. Peterson 12
Edward C. Nielsen 13
Ralph E. & Florence M. Bannister 14
Arnold L. & Dorothy L. Melin 15
William C. Lentz 16
Ralph E. Bannister 17
Leo C. Brown 18

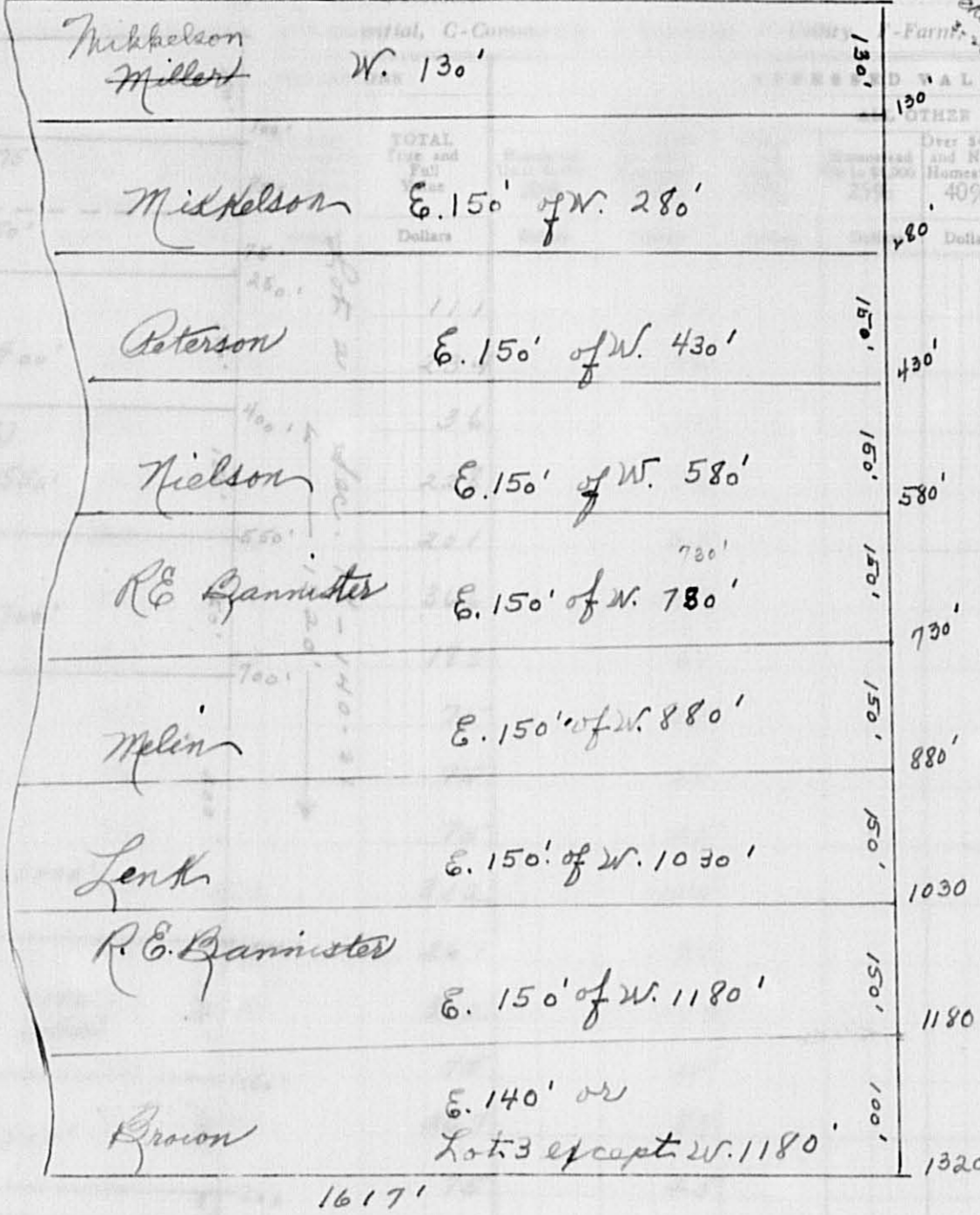
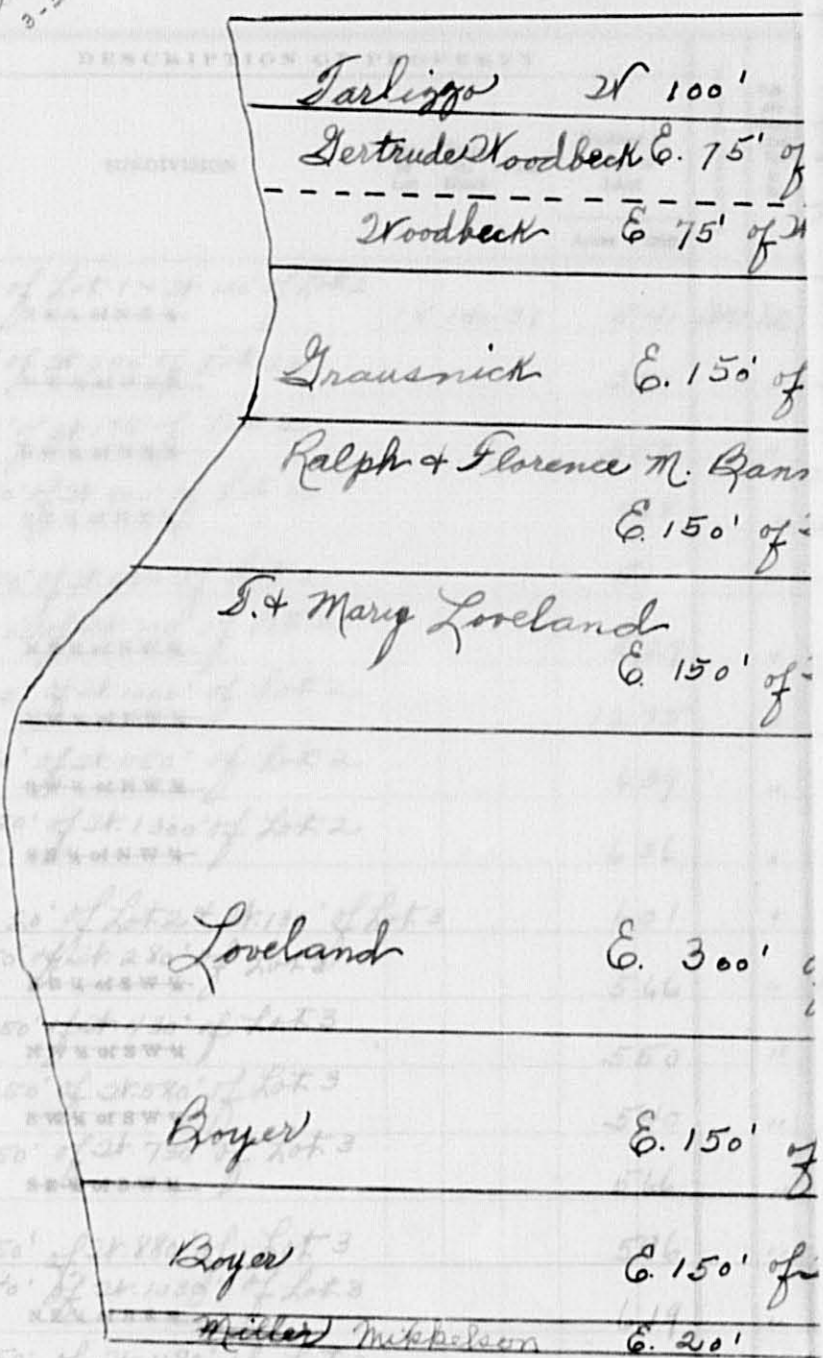

Table with columns: TOTAL ASSESSED VALUE, Total Assessed Value as Equalized by the Board of Review, FINAL EQUALIZED VALUE. Includes handwritten notes like 'Machinery permanently attached to real estate 40%' and 'Dollars'.

Table with columns: SOLD FOR TAXES, VALUATIONS BY SCHOOL DISTRICTS AS EQUALIZED BY DEPARTMENT OF TALLION, Tax Including State Homestead, State Tax on Non-Homestead, SPECIAL TAXES, TOTAL TAXES, PAID, WHEN PAID, Number of Receipt, March Settlement 1957, June Settlement 1957, Penalty, November Settlement 1957, Penalty, Collections to First Monday in January 1958, Penalty, Delinquent on First Monday in January 1958, Total Delinquent Tax and Penalty, REMARKS.

Summary table with columns: TOTAL ASSESSED VALUE, Total Assessed Value as Equalized by the Board of Review, FINAL EQUALIZED VALUE. Totals: 10346, 1331, 1909, 3240, 1080, 1080.

Cass County, Minnesota, for Taxes for the Year 1956.

Main tax table with columns: SOLD FOR TAXES, VALUATIONS BY SCHOOL DISTRICTS AS EQUALIZED BY DEPARTMENT OF TALLION, Tax Including State Homestead, State Tax on Non-Homestead, SPECIAL TAXES, TOTAL TAXES, PAID, WHEN PAID, Number of Receipt, March Settlement 1957, June Settlement 1957, Penalty, November Settlement 1957, Penalty, Collections to First Monday in January 1958, Penalty, Delinquent on First Monday in January 1958, Total Delinquent Tax and Penalty, REMARKS.

Summary table with columns: TOTAL ASSESSED VALUE, Total Assessed Value as Equalized by the Board of Review, FINAL EQUALIZED VALUE. Totals: 10346, 1331, 1909, 3240, 1080, 1080.

Assessment Roll Tax List of Real Property in the ... of ...

Table with columns: IN WHOSE NAME ASSESSED, TO WHOM TRANSFERRED, TRUTH AND JUSTICE, ASSESSED VALUATIONS (RURAL, ALL OTHER, MACHINERY), TOTAL ASSESSED VALUE, and FINAL EQUALIZED VALUE.

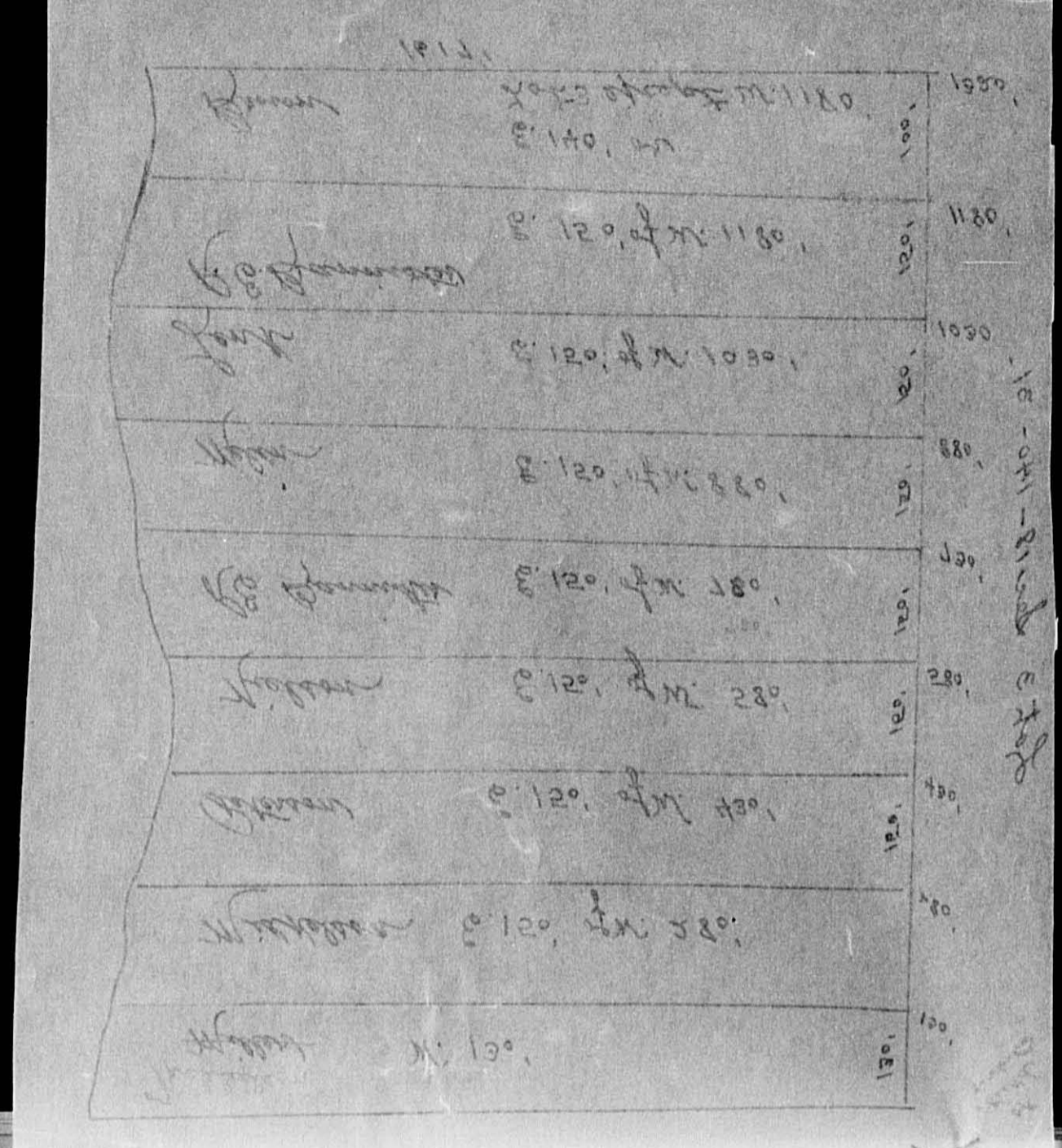

Cass County, Minnesota, for Taxes for the Year 1956.

Table with columns: VALUATIONS BY SCHOOL DISTRICTS AS EQUALIZED BY DEPARTMENT OF TAXATION, TAXES (SOLD FOR TAXES, PAID, WHEN PAID), and REMARKS.

Long Beach, Shady Shores, White Pine Beach, Plainview Beach

Assessment Roll and Tax List of Real Property in the Town of Down of Hennepin

Indicate Type of Property: R-Residential, C-Commercial, I-Industrial, U-Utility, F-Farm, L-Lakeshore, T-Timber, M-Mineral

Table with columns: IN WHOSE NAME ASSESSED, TO WHOM TRANSFERRED, DESCRIPTION OF PROPERTY, TRU AND FULL VALUATIONS, ASSESSED VALUATIONS (RURAL, ALL OTHER), TOTAL ASSESSED VALUE, and FINAL EQUALIZED VALUE.

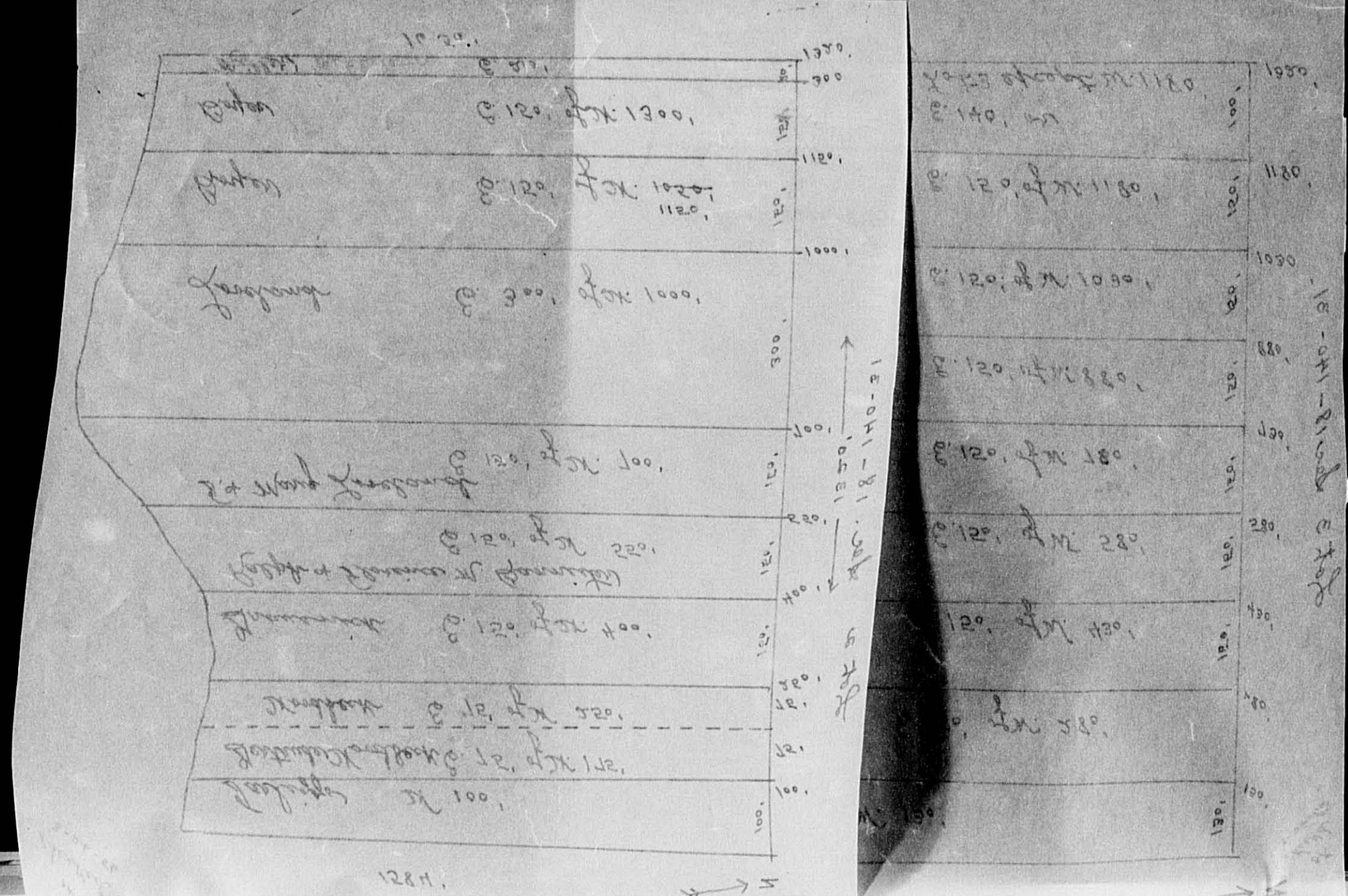

Cass County, Minnesota, for Taxes for the Year 1956.

Table with columns: VALUATIONS BY SCHOOL DISTRICTS AS EQUALIZED BY DEPARTMENT OF TAXATION, TAXES (SPECIAL, TOTAL), PAID, WHEN PAID, and REMARKS.

Vertical text on the right edge of the page: Long Beach, Shady Shores, White Pine Beach, Palmview Beach, Parkview Beach, etc.

Assessment Roll and Tax List of Real Property in the *South* of *Avon*

Indicate Type of Property: R-Residential, C-Commercial, I-Industrial, U-Utility, F-Farm, L-Lakeshore, T-Timber, M-Mineral

Table with columns: IN WHOSE NAME ASSESSED, TO WHOM TRANSFERRED, DESCRIPTION OF PROPERTY, TRUE AND FULL VALUATIONS, ASSESSED VALUATIONS, and FINAL EQUALIZED VALUE. Includes handwritten entries for property owners like 'State of Minnesota', 'Byron Scher', and 'Arnold & Margaret B. Kading'.

Table for TAXES and PAID. Columns include: VALUATIONS BY SCHOOL DISTRICTS AS EQUALIZED BY DEPARTMENT OF TAXATION, TAX including State Homestead, SPECIAL TAXES, TOTAL TAXES, PAID, WHEN PAID, and Remarks. Contains handwritten notes like 'PAID IN FULL' and 'SOLD FOR TAXES'.

Long Beach, Sandy Shores, White Pine Beach, Plainview Beach, B-Arrangement of lot

Assessment Roll and Tax List of Real Property in the Down of Sherburne

* Indicate Type of Property: R-Residential, C-Commercial, I-Industrial, U-Utility, F-Farm, L-Lakeshore, T-Timber, M-Mineral

Cass County, Minnesota, for Taxes for the Year 1956.

Table with columns: IN WHOSE NAME ASSESSED, TO WHOM TRANSFERRED, DESCRIPTION OF PROPERTY (SUBDIVISION, Acres, 100ths), TRUE AND FULL VALUATIONS (LAND, BUILDINGS, MACHINERY, TOTAL True and Full Value), ASSESSED VALUATIONS (RURAL, ALL OTHER, MACHINERY, TOTAL ASSESSED VALUE), VALUATIONS BY SCHOOL DISTRICTS AS EQUALIZED BY DEPARTMENT OF TAXATION (District No., Rate, Mills), PAID (Month, Day, Year), WHEN PAID, Number of Receipt, March Settlement, June Settlement, November Settlement, Penalty, Collections to First Monday in January 1958, Delinquent on First Monday in January 1958, Total Delinquent Tax and Penalty, REMARKS.

Long Beach, Shady Shores, White Pine Beach, Plainview Beach, No Arrangement of Lots

Assessment Roll and Tax List of Real Property in the Lewis of Hiram

* Indicate Type of Property: R-Residential, C-Commercial, I-Industrial, U-Utility, F-Farm, L-Lakeshore, T-Timber, M-Mineral

IN WHOSE NAME ASSESSED	TO WHOM TRANSFERRED	DESCRIPTION OF PROPERTY			No. School District	Indicate Homestead Yes or No	Indicate Agricultural Yes or No	Indicate Type of Property	TRUE AND FULL VALUATIONS				ASSESSED VALUATIONS						FINAL EQUALIZED VALUE			
		SUBDIVISION	Sec. of Lot	Town or Block					Rng.	Number of Acres of Land	LAND Exclusive of Structures and Improvements	BUILDINGS and Other Structures	MACHINERY Permanently Attached to Real Estate	TOTAL True and Full Value	RURAL		ALL OTHER			TOTAL ASSESSED VALUE	Total Assessed Value as Equalized by the Board of Review	
															Acres	100ths	Homestead Up to \$1,000 20%	Over \$1,000 and Non-Homestead 33 1/3%				Timber Land Class 3e 20%
									Dollars	Dollars	Dollars	Dollars	Dollars	Dollars	Dollars	Dollars	Dollars	Dollars				
State of Minnesota																						
John A. Martin																						
State of Minnesota																						
State of Minnesota																						
State of Minnesota																						
State of Minnesota																						
State of Minnesota																						
State of Minnesota																						
State of Minnesota																						
State of Minnesota																						
State of Minnesota																						
State of Minnesota																						

Cass County, Minnesota, for Taxes for the Year 1956.

SOLD FOR TAXES	VALUATIONS BY SCHOOL DISTRICTS AS EQUALIZED BY DEPARTMENT OF TAXATION						Tax including State Homestead	State Tax on Non-Homestead	SPECIAL TAXES	TOTAL TAXES	PAID	WHEN PAID	Number of Receipt	March Settlement 1957	June Settlement 1957	Penalty 1957	November Settlement 1957	Penalty	Collections to First Monday in January 1958	Penalty	Delinquent on First Monday in January 1958	Total Delinquent Tax and Penalty	REMARKS
	District No.	District No.	District No.	District No.	District No.	District No.																	
	Rate	Rate	Rate	Rate	Rate	Rate																	

Long Beach
 Shady Shores
 White Pine Beach
 Plainview Beach
 No Arrangement of Lots

Assessment Roll and Tax List of Real Property in the Town of Down of Wisconsin

Cass County, Minnesota, for Taxes for the Year 1956.

Form 501 (56) WISCONSIN DEPARTMENT OF REVENUE, MADISON

* Indicate Type of Property: R-Residential, C-Commercial, I-Industrial, U-Utility, F-Farm, L-Lakeshore, T-Timber, M-Mineral

Table with columns for IN WHOSE NAME ASSESSED, TO WHOM TRANSFERRED, DESCRIPTION OF PROPERTY, TRUE AND FULL VALUATIONS, ASSESSED VALUATIONS, VALUATIONS BY SCHOOL DISTRICTS, TAXES, PAID, WHEN PAID, Number of Receipt, March Settlement, June Settlement, November Settlement, Collections to First Monday, Delinquent on First Monday, Total Delinquent Tax and Penalty, REMARKS. Includes handwritten entries for Barbara A. & Carl Ford, Marjorie D. Reason, etc.

Assessment Roll and Tax List of Real Property in the Douglas of Wisconsin

* Indicate Type of Property: R-Residential, C-Commercial, I-Industrial, U-Utility, F-Farm, L-Lakeshore, T-Timber, M-Mineral

IN WHOSE NAME ASSESSED	TO WHOM TRANSFERRED	DESCRIPTION OF PROPERTY		TRUE AND FULL VALUATIONS											FINAL EQUALIZED VALUE			
				LAND EXCLUSIVE OF IMPROVEMENTS				RURAL		ALL OTHER				TOTAL ASSESSED VALUE		Total Assessed Value as Equalized by the Board of Review		
				Dollars	Dollars	Dollars	Dollars	Homestead Up to \$4,000 20%	Over \$4,000 and Non-Homestead 33 1/3%	Timber Land Class 3c 20%	Homestead Up to \$4,000 25%	Over \$4,000 and Non-Homestead 40%	MACHINERY Permanently Attached to Real Estate 33 1/3%					
Everett W. Chadwick & Caroline J. Munn		NE 1/4 of NE 1/4 Lot 1	25 140 31	320	no	no	yes	F	141				141	47		47		
W. L. Smith		NW 1/4 of NE 1/4 Lot 2		3650	yes		F	304	201				505	101		101		
Gay Forest	State of Minnesota	SW 1/4 of NE 1/4		40	no		F	162					162	54		54		
David Roelke		SE 1/4 of NE 1/4		40	"	"	"	162					162	54		54		
Leon W. Fleischer		NE 1/4 of NW 1/4		40	yes		R	225	950				1175	235		235		
Blairance & Bessie W. Kendall		NW 1/4 of NW 1/4		40	no		F	141					141	47		47		
Frank M. & Lena M. Glose		SW 1/4 of NW 1/4		40	yes		R	235	1200				1435	287		287		
Ratie Linn		SE 1/4 of NW 1/4		40	"	"	F	324	36				360	72		72		
Walter & Anne C. Carlson		NE 1/4 of SW 1/4		40	yes		"	410					410	82		82		
"	"	NW 1/4 of SW 1/4		40	"	"	"	330	520				850	170		170		
"	"	SW 1/4 of SW 1/4		40	"	"	"	145					145	29		29		
"	"	SE 1/4 of SW 1/4		40	"	"	F	145					145	29		29		
State of Minnesota		NE 1/4 of SE 1/4																
State of Minnesota		NW 1/4 of SE 1/4																
State of Minnesota		SW 1/4 of SE 1/4																
State of Minnesota		SE 1/4 of SE 1/4																
				46850					2724	2907			5631	1005	202			1207

Cass County, Minnesota, for Taxes for the Year 1956.

SOLD FOR TAXES	VALUATIONS BY SCHOOL DISTRICTS AS EQUALIZED BY DEPARTMENT OF TAXATION						Tax including State Homestead	State Tax on Non-Homestead	SPECIAL TAXES	TOTAL TAXES	PAID	WHEN PAID	Number of Receipt	March Settlement 1957	June Settlement 1957	Penalty	November Settlement 1957	Penalty	Collections to First Monday in January 1958	Penalty	Delinquent on First Monday in January 1958	Total Delinquent Tax and Penalty	REMARKS
	District No.	District No.	District No.	District No.	District No.	District No.																	
	Rate	Rate	Rate	Rate	Rate	Rate																	
	47						970	26	996	1	PAID IN FULL APR 22 1957	3750		996									
	101						2084		2084	2	2nd Half Paid OCT 31 1957 1st Half Paid MAY 31 1957	1627 10642		1042		1042							
HOLD FOR TAXES	54						1114	28	1142	3	Forfeited 10-1-57											11.42 Cancelled	
HOLD FOR TAXES	54						1114	28	1142	4												11.42	
	235						4848		4848	6	PAID IN FULL MAY 31 1957	10646		4848									
	47						970	26	996	7	2nd Half Paid OCT 17 1957 1st Half Paid MAY 23 1957	15391 6474		498		498							
	287						5920		5920	8	PAID IN FULL FEB 2 1956	679	5920										
	72						1486		1486	9												1486	
	82						1692		1692	11	2nd Half Paid OCT 21 1957												
	170						3506		3506	12	1st Half Paid MAY 22 1957 2nd Half Paid OCT 21 1957			3197		3197							
	29						598		598	13	2nd Half Paid OCT 21 1957 1st Half Paid MAY 22 1957	6814 25402											
	29						598		598	14	2nd Half Paid OCT 21 1957 1st Half Paid MAY 22 1957												
	1005						24900	108	25008				5920	10581		4737						2628	11.42

Long Beach, Shady Shores, White Pine Beach, Plainview Beach, P. O. Arrangement of 1957

Assessment Roll and Tax List of Real Property in the Lower of Winn

* Indicate Type of Property: R-Residential, C-Commercial, I-Industrial, U-Utility, F-Farm, L-Lakeshore, T-Timber, M-Mineral

Form 5CD (56) MILLER-BLYE COMPANY, MINNEAPOLIS

Table with columns: IN WHOSE NAME ASSESSED, TO WHOM TRANSFERRED, SUBDIVISION, TRUE AND FULL VALUATIONS (LAND, BUILDINGS, MACHINERY, TOTAL), ASSESSED VALUATIONS (RURAL, ALL OTHER, MACHINERY, TOTAL ASSESSED), FINAL EQUALIZED VALUE. Includes handwritten entries for John P. Sullivan, E. B. Sullivan, Navillus Land Co., Carl Goff, and various Forrester families.

Cass County, Minnesota, for Taxes for the Year 1956.

Table with columns: VALUATIONS BY SCHOOL DISTRICTS AS EQUALIZED BY DEPARTMENT OF TAXATION (District No., Rate, Mills), Tax including State Homestead, State Tax on Non-Homestead, SPECIAL TAXES, TOTAL TAXES, PAID, WHEN PAID, Number of Receipt, March, June, November Settlement, Penalty, Collections to First Monday in January 1958, Delinquent on First Monday in January 1958, Total Delinquent Tax and Penalty, REMARKS. Includes handwritten notes on payments and balances.

Assessment Roll and Tax List of Real Property in the Lower of Stream,

Cass County, Minnesota, for Taxes for the Year 1956.

* Indicate Type of Property: R-Residential, C-Commercial, I-Industrial, U-Utility, F-Farm, L-Lakeshore, T-Timber, M-Mineral

Form SCD (56) DALLAS-SAYRE COMPANY, MINNEAPOLIS

IN WHOSE NAME ASSESSED	TO WHOM TRANSFERRED	DESCRIPTION OF PROPERTY				No. School District	Indicate Homestead Yes or No	Indicate Agricultural Yes or No	Indicate Type of Property	TRUE AND FULL VALUATIONS				ASSESSED VALUATIONS					FINAL EQUALIZED VALUE	
		SUBDIVISION	Sec. or Lot	Town or Block	Rng.					Number of Acres of Land	LAND Exclusive of Structures and Improvements	BUILDINGS and Other Structures	MACHINERY Permanently Attached to Real Estate	TOTAL True and Full Value	RURAL			TOTAL ASSESSED VALUE		Total Assessed Value as Equalized by the Board of Review
															Homestead Up to \$1,000 20%	Over \$1,000 and Non-Homestead 33 1/8%	Timber Land Class 3e 20%			
Dollars	Dollars	Dollars	Dollars	Dollars	Dollars	Dollars	Dollars	Dollars	Dollars	Dollars	Dollars	Dollars	Dollars	Dollars	Dollars					
State of Minnesota		NE 1/4 of NE 1/4	28	140	31															
State of Minnesota		NW 1/4 of NE 1/4																		
<u>Arnold E. Kading</u>		SW 1/4 of NE 1/4 Lot 2				30	Yes	Yes	T	120			120	24		24				
State of Minnesota		SE 1/4 of NE 1/4 Lot 1																		
<u>Arnold F. Kading</u>		NE 1/4 of NW 1/4				40	Yes	"	R	160	885		1045	209		209				
<u>O. H. Kading</u>		NW 1/4 of NW 1/4				40	No	"	T	114			114	38		38				
"		SW 1/4 of NW 1/4				40	"	"	"	120			120	40		40				
<u>Arnold F. Kading</u>		SE 1/4 of NW 1/4 Lot 3				39	Yes	"	"	85			85	17		17				
State of Minnesota		NE 1/4 of SW 1/4 Lot 4																		
State of Minnesota		NW 1/4 of SW 1/4																		
State of Minnesota		SW 1/4 of SW 1/4																		
<u>O. H. Kading</u>	State of Minnesota	SE 1/4 of SW 1/4 Lot 5				28	No	"	"	84			84	28		28 Forfeited				
<u>Arnold F. Marguerite B. Kading</u>		NE 1/4 of SE 1/4 Lot 7				12.50	"	"	"	48			48	16		16				
		NW 1/4 of SE 1/4																		
		SW 1/4 of SE 1/4																		
State of Minnesota		SE 1/4 of SE 1/4 Lot 6																		
						229.50				181	886		1616	250	122	312				
										647			1582	94	94	344				

SOLD FOR TAXES	VALUATIONS BY SCHOOL DISTRICTS AS EQUALIZED BY DEPARTMENT OF TAXATION						Tax including State Homestead	State Tax on Non-Homestead	SPECIAL TAXES	TOTAL TAXES	PAID	WHEN PAID	Number of Receipt	March Settlement 1957	June Settlement 1957	Penalty	November Settlement 1957	Penalty	Collections to First Monday in January 1958	Penalty	Delinquent on First Monday in January 1958	Total Delinquent Tax and Penalty	REMARKS	
	District No. No. 7	District No. No. 7	District No. No. 7	District No. No. 7	District No. No. 7	District No. No. 7																		
	Dollars	Dollars	Dollars	Dollars	Dollars	Dollars																		
3						# 24	496		496														496	
6						# 209	4312		4312															4312
7						38	784	20	804															804
8						40	826	22	848															848 132
9						# 17	350		350															350
16						16	330	08	338															338
							7098	50	7148															1652 5496

Long Beach
Shady Shores
White Pine Beach
Plainview Beach
Re-arrangement of lots

Assessment Roll and Tax List of Real Property in the Down of Hiram

* Indicate Type of Property: R-Residential, C-Commercial, I-Industrial, U-Utility, F-Farm, L-Lakeshore, T-Timber, M-Mineral

Form SCD (56) MILLER-DAY DEPT. MINNAPOLIS

Table with columns: IN WHOSE NAME ASSESSED, TO WHOM TRANSFERRED, DESCRIPTION OF PROPERTY, TRUE AND FULL VALUATIONS, ASSESSED VALUATIONS, and FINAL EQUALIZED VALUE. Rows include property details for lots 1 through 20, with handwritten annotations and numerical values.

Cass County, Minnesota, for Taxes for the Year 1956.

Table with columns: SOLD FOR TAXES, VALUATIONS BY SCHOOL DISTRICTS AS EQUALIZED BY DEPARTMENT OF TAXATION, Tax including State Homestead, State Tax on Non-Homestead, SPECIAL TAXES, TOTAL TAXES, PAID, WHEN PAID, Number of Receipt, March Settlement, June Settlement, Penalty, November Settlement, Penalty, Collections to First Monday in January, Penalty, Delinquent on First Monday in January, Total Delinquent Tax and Penalty, and REMARKS. Rows correspond to lots 1 through 20, showing tax amounts and payment dates.

Long Beach
Shady Shores
White Pine Beach
Plaintiver Beach
Perrin General, 80 1/2

Assessment Roll and Tax List of Real Property in the *Town of Hiram* of *Hiram*

Cass County, Minnesota, for Taxes for the Year 1956.

Form 501 (56) WILCO-DAVIS COMPANY, MINNEAPOLIS

* Indicate Type of Property: R-Residential, C-Commercial, I-Industrial, U-Utility, F-Farm, L-Lakeshore, T-Timber, M-Mineral

Main table with columns: IN WHOSE NAME ASSESSED, TO WHOM TRANSFERRED, DESCRIPTION OF PROPERTY, TRUE AND FULL VALUATIONS, ASSESSED VALUATIONS, VALUATIONS BY SCHOOL DISTRICTS AS EQUALIZED BY DEPARTMENT OF TAXATION, TAXES, PAID, WHEN PAID, etc.

Long Beach, Shady Shores, White Pine Beach, Plainview Beach, The Arrangement of Lots

Assessment Roll and Tax List of Real Property in the _____ of _____

Cass County, Minnesota, for Taxes for the Year 1956.

Form 50D (56) WILSON-GRACE COMPANY, MINNEAPOLIS

* Indicate Type of Property: R-Residential, C-Commercial, I-Industrial, U-Utility, F-Farm, L-Lakeshore, T-Timber, M-Mineral

Table with columns for Description of Property, True and Full Valuations, Assessed Valuations, and Valuations by School Districts. Includes rows for property owners like 'State of Minnesota', 'Albert + Lydia E. Thomas', and 'Richard Salminen'.

Long Beach
Steady Shores
White Pine Beach
Fairview Beach
Arrangement of 1956

Form SCD-56-56 WILLIAM SAWE COMPANY, MINNEAPOLIS * Indicate Type of Property: R-Residential, C-Commercial, I-Industrial, U-Utility, F-Farm, L-Lakeshore, T-Timber, M-Mineral

Main table with columns: IN WHOSE NAME ASSESSED, TO WHOM TRANSFERRED, DESCRIPTION OF PROPERTY, TRUE AND FULL VALUATIONS, ASSESSED VALUATIONS, VALUATIONS BY SCHOOL DISTRICTS AS EQUALIZED BY DEPARTMENT OF TAXATION, SOLD FOR TAXES, PAID, WHEN PAID, Number of Receipt, March Settlement, June Settlement, Penalty, November Settlement, Collections to First Monday in January, Delinquent on First Monday in January, Total Delinquent Tax and Penalty, REMARKS.

State of Minnesota

NE 1/4 of NE 1/4

36 1/4 31

201

RURAL: Homestead Up to \$4,000 20%, Over \$4,000 and Non-Homestead 33 1/8%, Timber Land Class 3e 20%, ALL OTHER: Homestead Up to \$4,000 25%, Over \$4,000 and Non-Homestead 40%, MACHINERY Permanently Attached to Real Estate 33 1/8%.

VALUATIONS BY SCHOOL DISTRICTS AS EQUALIZED BY DEPARTMENT OF TAXATION. District No. 1, Rate 2.0 Mills.

Tax including State Homestead: \$ cts., State Tax on Non-Homestead: 5.3 Mills.

TOTAL TAXES, PAID, WHEN PAID, Number of Receipt, March Settlement, June Settlement, Penalty, November Settlement, Collections to First Monday in January, Delinquent on First Monday in January, Total Delinquent Tax and Penalty.

State of Minnesota

NW 1/4 of SW 1/4

40

70 40 T

201

TOTAL True and Full Value: 201

RURAL: Over \$4,000 and Non-Homestead: 67

TOTAL ASSESSED VALUE: 67

DISTRICT 67: Rate 6.7 Mills

Tax including State Homestead: 1382, State Tax on Non-Homestead: 36

TOTAL TAXES: 1418

1418

State of Minnesota

SE 1/4 of SE 1/4

40

201

TOTAL True and Full Value: 201

RURAL: Over \$4,000 and Non-Homestead: 67

TOTAL ASSESSED VALUE: 67

DISTRICT 67: Rate 6.7 Mills

Tax including State Homestead: 1382, State Tax on Non-Homestead: 36

TOTAL TAXES: 1418

1418

Long Beach, Shady Shores, White Pine Beach, Plainview Beach, No Arrangement of 10th St. White Pine Beach

Assessment Roll and Tax List of Real Property in the _____ of _____

* Indicate Type of Property: R-Residential, C-Commercial, I-Industrial, U-Utility, F-Farm, L-Lakeshore, T-Timber, M-Mineral

Form 5CD (56) 1955-56

Table with columns: IN WHOSE NAME ASSESSED, TO WHOM TRANSFERRED, DESCRIPTION OF PROPERTY, TRUE AND FULL VALUATIONS, ASSESSED VALUATIONS, and FINAL EQUALIZED VALUE. Includes sub-headers for Rural and All Other valuations.

Cass County, Minnesota, for Taxes for the Year 1956.

Table with columns: VALUATIONS BY SCHOOL DISTRICTS AS EQUALIZED BY DEPARTMENT OF TAXATION, SOLD FOR TAXES, PAID, WHEN PAID, and various settlement and penalty columns.

Long Beach, Stady Stores, White Pine Beach, Plainview Beach, Arrangement of 10th, 11th, 12th, 13th, 14th, 15th, 16th, 17th, 18th, 19th, 20th

Assessment Roll and Tax List of Real Property in the _____ of _____

* Indicate Type of Property: R-Residential, C-Commercial, I-Industrial,

Form SCD (56) WILSON-JAY COMPANY, MINNEAPOLIS

IN WHOSE NAME ASSESSED	TO WHOM TRANSFERRED	DESCRIPTION OF PROPERTY				TRUE AND FULL VALUATIONS										REMARKS						
		SUBDIVISION	Sec. or Lot	Town or Block	No. of Acres of Land	No. School District	Indicate Homestead Yes or No	Indicate Agricultural Yes or No	Indicate Type of Property	LAND EXCLUSIVE OF STRUCTURES AND IMPROVEMENTS			BUILDINGS AND OTHER STRUCTURES		MACHINERY Permanently Attached to Real Estate		TOTAL True and Full Value	RURAL				
										Dollars	Dollars	Dollars	Dollars	Dollars				Dollars	Dollars	Dollars		
		1 NE ¼ of NE ¼																				
		2 NW ¼ of NE ¼																				
		3 SW ¼ of NE ¼																				
		4 SE ¼ of NE ¼																				
		5																				
		6 NE ¼ of NW ¼																				
		7 NW ¼ of NW ¼																				
		8 SW ¼ of NW ¼																				
		9 SE ¼ of NW ¼																				
		10																				
		11 NE ¼ of SW ¼																				
		12 NW ¼ of SW ¼																				
		13 SW ¼ of SW ¼																				
		14 SE ¼ of SW ¼																				
		15																				
		16 NE ¼ of SE ¼																				
		17 NW ¼ of SE ¼																				
		18 SW ¼ of SE ¼																				
		19 SE ¼ of SE ¼																				
		20																				

PAGES

45

THRU

54

BLANK

Cass County, Minnesota, for Taxes for the Year 1956.

District	Tax including State Homestead	State Tax on Non-Homestead	SPECIAL TAXES	TOTAL TAXES	PAID	WHEN PAID	Number of Receipt	March Settlement 1957	June Settlement 1957	November Settlement 1957	Penalty	Collections to First Monday in January 1958	Penalty	Delinquent on First Monday in January 1958	Total Delinquent Tax and Penalty	REMARKS
Dollars	\$ cts.	\$ cts.	\$ cts.	\$ cts.		Month Day Year		\$ cts.	\$ cts.	\$ cts.	\$ cts.	\$ cts.	\$ cts.	\$ cts.	\$ cts.	
																1
																2
																3
																4
																5
																6
																7
																8
																9
																10
																11
																12
																13
																14
																15
																16
																17
																18
																19
																20

Long Beach
Stady Shores
White Pine Beach
Plainview Beach
P-Arrangement of Lot

Assessment Roll and Tax List of Real Property in the Town of Hiram

Indicate Type of Property: R-Residential, C-Commercial, I-Industrial, U-Utility, F-Farm, L-Lakeshore, T-Timber, M-Mineral

ITEM 5C (56) MILLER-DAVIS COMPANY, MINNEAPOLIS

Table with columns: IN WHOSE NAME ASSESSED, TO WHOM TRANSFERRED, SUBDIVISION, DESCRIPTION OF PROPERTY, TRUE AND FULL VALUATIONS, ASSESSED VALUATIONS, FINAL EQUALIZED VALUE.

Cass County, Minnesota, for Taxes for the Year 1956.

Table with columns: VALUATIONS BY SCHOOL DISTRICTS AS EQUALIZED BY DEPARTMENT OF TALLATION, TAXES, PAID, WHEN PAID, Number of Receipt, March Settlement, June Settlement, Penalty, November Settlement, Collections to First Monday in January 1958, Delinquent on First Monday in January 1958, Total Delinquent Tax and Penalty, REMARKS.

Assessment Roll and Tax List of Real Property in the Long Beach of Hiram

* Indicate Type of Property: R-Residential, C-Commercial, I-Industrial, U-Utility, F-Farm, L-Lakeshore, T-Timber, M-Mineral

Form 5C (56) BULLOCK-BATH COMPANY, MINNEAPOLIS

IN WHOSE NAME ASSESSED	TO WHOM TRANSFERRED	DESCRIPTION OF PROPERTY						TRUE AND FULL VALUATIONS										FINAL EQUALIZED VALUE										
		SUBDIVISION	Sec. or Lot	Town or Block	Rng.	Number of Acres of Land	No. School District	Indicate Homestead Yes or No	Indicate Agricultural Yes or No	Indicate Type of Property	LAND EXCLUSIVE OF STRUCTURES AND IMPROVEMENTS			BUILDINGS AND OTHER STRUCTURES			MACHINERY Permanently Attached to Real Estate		TOTAL True and Full Value	ASSESSED VALUATIONS								
											RURAL		ALL OTHER		MACHINERY Permanently Attached to Real Estate	TOTAL ASSESSED VALUE	Total Assessed Value as Equalized by the Board of Review		Dollars	RURAL		ALL OTHER		Dollars	Dollars	Dollars	Dollars	Dollars
											Homestead Up to \$1,000 20%	Over \$4,000 and Non-Homestead 33 1/3%	Timber Land Class 1e 20%	Homestead Up to \$1,000 25%						Over \$4,000 and Non-Homestead 40%								
									Dollars	Dollars	Dollars	Dollars	Dollars	Dollars	Dollars	Dollars	Dollars	Dollars	Dollars	Dollars	Dollars	Dollars	Dollars	Dollars				
Burton C. Ford		Long Beach	1	3			No	No	L	24					24													
Avar C. & Rose L. Sigveland		Long Beach	2	3			"	"		51					51													
Lloyd W. & Ethelwyn F. Reed		Part part of Blk 3 Plat of Long Beach lying N. of center line of Lot 17 Blk 2, Plat of Long Beach as extended to E. line of said Block 3.	3				"	"		24					24													
D. E. Kuehl		Outlot a	6				"	"		24					24													
Note:		Lot 1 thru 10 Block 4 Vacated	11	4																								
		Lot 1 thru 19 Block 5 "	12	5																								
		Lot 1 thru 14 Block 6 "	13	6																								
		also streets	14																									

123 123 41 41

Cass County, Minnesota, for Taxes for the Year 1956.

SOLD FOR TAXES	VALUATIONS BY SCHOOL DISTRICTS AS EQUALIZED BY DEPARTMENT OF TAXATION						Tax including State Homestead	State Tax on Non-Homestead	SPECIAL TAXES	TOTAL TAXES	PAID	WHEN PAID	Number of Receipt	March Settlement 1957	June Settlement 1957	Penalty	November Settlement 1957	Penalty	Collections to First Monday in January 1958	Penalty	Delinquent on First Monday in January 1958	Total Delinquent Tax and Penalty	REMARKS
	District No. No. Rate Mills	District No. No. Rate Mills	District No. No. Rate Mills	District No. No. Rate Mills	District No. No. Rate Mills	District No. No. Rate Mills																	
	Dollars	Dollars	Dollars	Dollars	Dollars	Dollars																	
	\$ cts.	\$ cts.	\$ cts.	\$ cts.	\$ cts.	\$ cts.																	
1						8	182	04	186	1	PAID IN FULL MAY 3 1 1957	10656									93 102		
2						17	384	10	394	2	PAID IN FULL MAY 3 1 1957	10657										394	
3						8	182	04	186	3												186 205	
4										4													
5										5													
6										6	PAID IN FULL MAY 3 1 1957	10660											186
7										7													
8										8													
9										9													
10										10													
11										11													
12										12													
13										13													
14										14													
15										15													
16										16													
17										17													
18										18													
19										19													
20										20													

41 930 22 952 673 279

Long Beach

Administrative Record - White Pine Beach - Arrangement of 19 of White Pine Beach

Assessment Roll and Tax List of Real Property in the _____ of _____

* Indicate Type of Property: R-Residential, C-Commercial, I-Industrial, U-Utility, F-Farm, L-Lakeshore, T-Timber, M-Mineral

Form 5C (56) MILLER-DAY COMPANY, MINNEAPOLIS

Long Beach
Shady Shores

IN WHOSE NAME ASSESSED	TO WHOM TRANSFERRED	DESCRIPTION OF PROPERTY				No. School District	Indicate Homestead Yes or No	Indicate Agricultural Yes or No	Indicate Type of Property	TRUE AND FULL VALUATIONS			ASSESSED VALUATIONS					Total Assessed Value as Equalized by the Board of Review	FINAL EQUALIZED VALUE			
		SUBDIVISION	Sec. of Lot	Town or Block	Reg.					Number of Acres of Land	LAND Excludes of Structures and Improvements	BUILDINGS and Other Structures	MACHINERY Permanently Attached to Real Estate	TOTAL True and Full Value	RURAL		ALL OTHER			MACHINERY Permanently Attached to Real Estate	TOTAL ASSESSED VALUE	
															Acres	100ths	Homestead Up to \$4,000 20%					Over \$4,000 and Non-Homestead 33 1/3%
Donald W. & Altha B. Gray		Shady Shores Lot 3 - Sec. 11-140-31	20				No	No	R	50	550			600	200		200					
"	"	E 1/2 of	21				"	"	L	24				24	8		8					
Florence N. Walls		W 1/2 of Lot 21 + all	22				"	"	R	74	400			474	158		158					
Alice Pearson Fahn			23				"	"	"	51	291			342	114		114					
"	"		24				"	"	L	51				51	17		17					
"	"		25				"	"	"	51				51	17		17					
Helen W. Dalton & Katherine W. Crum			26				"	"	"	51				51	17		17					
M.J. & Marion Faragher			27				"	"	R	50	289			339	113		113					
Peter B. & Alice V. Rasmussen			28				"	"	L	51				51	17		17					
"	"		29				"	"	"	51				51	17		17					
"	"		30				"	"	"	51				51	17		17					
"	"		31				"	"	"	51	21			72	24		24					
"	"		32				"	"	"	51				51	17		17					
"	"		33				"	"	R	50	316			366	122		122					
"	"		34				"	"	L	51				51	17		17					
Sherman E. & Olena Hughes			35				Yes	"	R	50	360		82	410	82		82					
"	"		36				"	"	L	50			10	50	10		10					
Alfonso L. & Opita M. Burrows			37				"	"	R	50	305		71	355	71		71					
Alfonso L. & Opita M. Burrows			38				No	"	L	51			17	51	17		17					
E. Arthur & Nellie M. Ericson			39				"	"	R	50	244		98	294	98		98					
										1009	2776			3785	163	990		1153				

Cass County, Minnesota, for Taxes for the Year 1956.

SOLD FOR TAXES	VALUATIONS BY SCHOOL DISTRICTS AS EQUALIZED BY DEPARTMENT OF TAXATION						Tax Including State Homestead	State Tax on Non-Homestead	SPECIAL TAXES	TOTAL TAXES	PAID	WHEN PAID	Number of Receipt	March Settlement 1957	June Settlement 1957	Penalty	November Settlement 1957	Penalty	Collections to First Monday in January 1958	Penalty	Delinquent on First Monday in January 1958	Total Delinquent Tax and Penalty	REMARKS															
	District No.	District No.	District No.	District No.	District No.	District No.																		Rate	Rate	Rate	Rate	Rate	Rate	Rate	Rate	Rate	Rate	Rate	Rate	Rate	Rate	Rate
	Dollars	Dollars	Dollars	Dollars	Dollars	Dollars																		Mills	Mills	Mills	Mills	Mills	Mills	Mills	Mills	Mills	Mills	Mills	Mills	Mills	Mills	Mills
1							4526	106		4632	1	PAID IN FULL MAY 31 1957																										
2							182	04		186	2	PAID IN FULL MAY 31 1957																										
3							3576	84		3660	3	PAID IN FULL FEB 7 1957	1735	3660																								
4							2580	60		2640	4	PAID IN FULL SEP 28 1957																										
5							384	10		394	5	PAID IN FULL SEP 28 1957	1470							3428	102																	
6							384	10		394	6	PAID IN FULL SEP 28 1957																										
7							384	10		394	7	PAID IN FULL APR 22 1957	3739																									
8							2556	60		2616	8	PAID IN FULL MAY 31 1957	10664																									
9							384	10		394	9	PAID IN FULL MAY 14 1957																										
10							384	10		394	10	PAID IN FULL MAY 14 1957																										
11							384	10		394	11	PAID IN FULL MAY 14 1957																										
12							544	12		556	12	PAID IN FULL MAY 14 1957	6658																									
13							384	10		394	13	PAID IN FULL MAY 14 1957																										
14							2760	66		2826	14	PAID IN FULL MAY 14 1957																										
15							384	10		394	15	PAID IN FULL MAY 14 1957																										
16							1856			1856	16	PAID IN FULL MAY 13 1957																										
17							226			226	17	PAID IN FULL MAY 13 1957	6194																									
18							1606			1606	18	PAID IN FULL MAY 31 1957																										
19							384	10		394	19	PAID IN FULL MAY 31 1957	10669																									
20							2218	52		2270	20	PAID IN FULL JUN 29 1957	12902							2270	43																	
										26086	534			26620					3660	17262		5678																

Parcefil Tallev
Ritzmund
Sunset Beach
White Pine Beach
Parcefil Shores
Plainsview Beach
P.A. Arrangement of 1957
19 of White Pine Beach

Assessment Roll and Tax List of Real Property in the Town of Adams, of Adams County, Minnesota

* Indicate Type of Property: R-Residential, C-Commercial, I-Industrial, U-Utility, F-Farm, L-Lakeshore, T-Timber, M-Mineral

Form 50 (56) MINN. STATE GOVERNMENT, ST. PAUL, MINN.

Table with columns: IN WHOSE NAME ASSESSED, TO WHOM TRANSFERRED, SUBDIVISION, DESCRIPTION OF PROPERTY, TRUE AND FULL VALUATIONS, ASSESSED VALUATIONS, and FINAL EQUALIZED VALUE.

Cass County, Minnesota, for Taxes for the Year 1956.

Table with columns: VALUATIONS BY SCHOOL DISTRICTS AS EQUALIZED BY DEPARTMENT OF TALENTATION, TAX INCLUDING STATE HOMESTEAD, SPECIAL TAXES, TOTAL TAXES, PAID, WHEN PAID, and REMARKS.

Long Beach, White Pine Beach, Sandy Shores

Peaceful Valley, Sunset Beach, Christion Beach, Peaceful Shores, Re-arrangement of 1st 19 1/2 of White Pine Beach

For Lot 20 See Re-arrangement of 1st 19 1/2

72 abated, 6.72, 1.68

9.12

Assessment Roll and Tax List of Real Property in the Town of Adams, of Adams County, Minnesota

Indicate Type of Property: R-Residential, C-Commercial, I-Industrial, U-Utility, F-Farm, L-Lakeshore, T-Timber, M-Mineral

Form 5C (56) MULLER-SAYRE COMPANY, MINNEAPOLIS

Table with columns: IN WHOSE NAME ASSESSED, TO WHOM TRANSFERRED, SUBDIVISION (Plainview Beach), DESCRIPTION OF PROPERTY, TRUE AND FULL VALUATIONS, ASSESSED VALUATIONS (RURAL, ALL OTHER, MACHINERY), VALUATIONS BY SCHOOL DISTRICTS AS EQUALIZED BY DEPARTMENT OF TAXATION, TAXES, PAID, WHEN PAID, Number of Receipt, March Settlement, June Settlement, November Settlement, Penalty, Collections to First Monday in January 1958, Delinquent on First Monday in January 1958, Total Delinquent Tax and Penalty, REMARKS.

Long Beach, White Pine Beach, Plainview Beach, Andy Shores

Cass County, Minnesota, for Taxes for the Year 1956.

Table with columns: SOLD FOR TAXES, VALUATIONS BY SCHOOL DISTRICTS AS EQUALIZED BY DEPARTMENT OF TAXATION, TAXES, PAID, WHEN PAID, Number of Receipt, March Settlement, June Settlement, November Settlement, Penalty, Collections to First Monday in January 1958, Delinquent on First Monday in January 1958, Total Delinquent Tax and Penalty, REMARKS.

Peaceful Valley, Elmhurst, Rt 240, Sunset Beach, Quarryton Beach, Peaceful Shores, Peaceful Shores

Assessment Roll and Tax List of Real Property in the Town of Down of Hiram

* Indicate Type of Property: R-Residential, C-Commercial, I-Industrial, U-Utility, F-Farm, L-Lakeshore, T-Timber, M-Mineral

Form 5C (56) HILL-BURDELL COMPANY, MINNEAPOLIS

IN WHOSE NAME ASSESSED	TO WHOM TRANSFERRED	DESCRIPTION OF PROPERTY				No. School District	Indicate Home-stead Yes or No	Indicate Apts. or other Type of Prop-erty	TRUE AND FULL VALUATIONS				ASSESSED VALUATIONS						FINAL EQUALIZED VALUE	
		SUBDIVISION	Sec. or Lot	Town or Block	Rng. Number of Acres of Land				LAND Exclusive of Structures and Improvements	BUILDINGS and Other Structures	MACHINERY Permanently Attached to Real Estate	TOTAL True and Full Value	RURAL		ALL OTHER		MACHINERY Permanently Attached to Real Estate	TOTAL ASSESSED VALUE		Total Assessed Value as Equalized by the Board of Review
													Homestead Up to \$1,000 20%	Over \$1,000 and Non-Homestead 33 1/3%	Timber Land Class 3e 20%	Homestead Up to \$1,000 25%				
Paul William Moshier		Peaceful Shores	20			20	No	L	159					53		53				
Carl A. Ryan	W. Moshier		21				"	"	126					42		42				
Lorgrim Evenson			22				"	"	126					42		42				
John C. & Marie K. Jansen		2 1/2 of 23	23				"	L	51					17		17				
Lewis J. & Ruth L. Falk		1/2 of 23	23				"	"	51					17		17				
Wendell L. & Laverne L. Nies			24				"	"	99					33		33				
Carl A. Ryan			25				"	"	99					33		33				
Laverne L. & Sybil L. Nies			26				"	"	99					33		33				
William C. & Ruth M. Mann			27				"	"	99					33		33				
"	"		28				"	"	99					33		33				
Newman D. Nies			29				"	"	99					33		33				
Roy C. & Grace J. Nies			30	less 1/2 of 20'			"	R	81	237			106		106					
Michael Kaston, Jr. & Annie C. Kaston		Noly 20' of Lot 304 or 31					"	R	120	207			109		109					
Floyd L. & Vera Elene Brady			32				"	L	99				33		33					
Carl A. Ryan			33				"	"	99				33		33					
Stephan A. & Elizabeth M. Weinhandl			34				"	C	99	261			120		120					
"	"		35				"	"	99	399			166		166					
"	"		36				"	"	100	200			100		100					
Ralph C. & Lora Lee Urbaugh			37				"	"	99	702			267		267					
"	"		38				yes	R	100	325		85	85		85					
									2003	2331			4334	85	1303					

Cass County, Minnesota, for Taxes for the Year 1956.

SOLD FOR TAXES	VALUATIONS BY SCHOOL DISTRICTS AS EQUALIZED BY DEPARTMENT OF TAXATION						Tax including State Homestead	State Tax on Non-Homestead	SPECIAL TAXES	TOTAL TAXES	PAID	WHEN PAID	Number of Receipts	March Settlement 1957	June Settlement 1957	Penalty	November Settlement 1957	Penalty	Collections to First Monday in January 1958	Penalty	Delinquent on First Monday in January 1958	Total Delinquent Tax and Penalty	REMARKS
	District No.	District No.	District No.	District No.	District No.	District No.																	
	Rate	Rate	Rate	Rate	Rate	Rate																	
1						53	1200	28	1228	1	PAID IN FULL	MAY 31 1957	10698										
2						42	950	22	972	2	PAID IN FULL	MAY 31 1957	10700										
3						42	950	22	972	3	PAID IN FULL	FEB 7 1957	1740	972									
4						17	384	10	394	4	PAID IN FULL	MAY 31 1957	10718										
5						17	384	10	394	5	PAID IN FULL	JUL 15 1957	12951				394						
6						33	746	18	764	6	1st Half Paid	MAY 31 1957	8220								382	420	
7						33	746	18	764	7	PAID IN FULL	MAY 31 1957											
8						33	746	18	764	8	PAID IN FULL	MAY 31 1957	8826										
9						33	746	18	764	9	1st Half Paid	JUL 20 1957	13050				764						
10						33	746	18	764	10	2nd Half Paid	OCT 23 1957											
11						33	746	18	764	11	1st Half Paid	JUL 20 1957	15633										
12						33	746	18	764	12	2nd Half Paid	OCT 31 1957	15573										
13						106	2398	56	2454	13	1st Half Paid	MAY 4 1957	6020				382						
14						109	2466	58	2524	14	PAID IN FULL	MAY 31 1957	9606										
15						33	746	18	764	15	PAID IN FULL	FEB 27 1957	3215	2524									
16						33	746	18	764	16	PAID IN FULL	MAY 31 1957	10704										
17						120	2716	64	2780	17	PAID IN FULL	MAY 31 1957	8826										
18						166	3756	88	3844	18	2nd Half Paid	OCT 31 1957											
19						100	2262	54	2316	19	1st Half Paid	MAY 31 1957	1637										
20						267	6042	142	6184	20	2nd Half Paid	OCT 31 1957	10701				4470						
						85	1924		1924		1st Half Paid	APR 24 1957	4317										
						85	1924		1924		2nd Half Paid	APR 24 1957	3758				4054						
													3490	17372		10828						382	

Plainsview Beach, Chariton Beach, Peaceful Shores, Sunset Beach, Elmhurst, Peaceful Valley, Sunset View, 1st Addition to Peaceful Shores, (Out of order) Peaceful Shores Beach

Assessment Roll and Tax List of Real Property in the Town of Hiram

* Indicate Type of Property: R-Residential, C-Commercial, I-Industrial, U-Utility, F-Farm, L-Lakeshore, T-Timber, M-Mineral

Form 5C (56) 1956

Table with columns: IN WHOSE NAME ASSESSED, TO WHOM TRANSFERRED, SUBDIVISION, TRUE AND FULL VALUATIONS, ASSESSED VALUATIONS, and FINAL EQUALIZED VALUE. Includes handwritten entries for Paul E. Luckleberry, Gerald H. & Helen M. Darrow, Oscar M. & Hazel M. Magnuson, Irving A. & Hazel M. Kellum, Henry E. & Fay Sigau, Carl A. Ryan, James M. Hicks, John F. & Alma S. Greer, and Carl A. Ryan.

Peaceful Shores, Sunset Beach, Chariton Beach, Peaceful Shores, 1st Addition to Peaceful Shores, (Out of order) Peaceful Shores Beach

Cass County, Minnesota, for Taxes for the Year 1956.

Table with columns: SOLD FOR TAXES, VALUATIONS BY SCHOOL DISTRICTS AS EQUALIZED BY DEPARTMENT OF TAXATION, Tax including State Homestead, State Tax on Non-Homestead, SPECIAL TAXES, TOTAL TAXES, PAID, WHEN PAID, Number of Receipt, March Settlement 1957, June Settlement 1957, November Settlement 1957, Penalty, Collections to First Monday in January 1958, Delinquent on First Monday in January 1958, Total Delinquent Tax and Penalty, REMARKS. Includes handwritten entries for Paul E. Luckleberry, Gerald H. & Helen M. Darrow, Oscar M. & Hazel M. Magnuson, Irving A. & Hazel M. Kellum, Henry E. & Fay Sigau, Carl A. Ryan, James M. Hicks, John F. & Alma S. Greer, and Carl A. Ryan.

Peaceful Valley, Sunset View, 1st Addition to Peaceful Shores, (Out of order) Peaceful Shores Beach

Assessment Roll and Tax List of Real Property in the Town of *Lyon* of *Linn* County, Minnesota

Form 5C (56) JULY 1954 COMPANY, MINNESOTA

* Indicate Type of Property: R-Residential, C-Commercial, I-Industrial, U-Utility, F-Farm, L-Lakeshore, T-Timber, M-Mineral

Table with columns: IN WHOSE NAME ASSESSED, TO WHOM TRANSFERRED, SUBDIVISION, Sec. or Lot, Town or Block, Rng., Number of Acres of Land, No. School District, Indicate Homesteaded, Indicate Agricultural, Indicate Type of Property, TRUE AND FULL VALUATIONS (LAND, BUILDINGS, MACHINERY, TOTAL), ASSESSED VALUATIONS (RURAL, ALL OTHER, MACHINERY, TOTAL ASSESSED VALUE, Total Assessed Value as Equalized by the Board of Review, FINAL EQUALIZED VALUE).

Cass County, Minnesota, for Taxes for the Year 1956.

Table with columns: VALUATIONS BY SCHOOL DISTRICTS AS EQUALIZED BY DEPARTMENT OF TAXATION (District No., Rate, etc.), Tax including State Homestead, State Tax on Non-Homestead, SPECIAL TAXES, TOTAL TAXES, PAID, WHEN PAID, Number of Receipt, March Settlement 1957, June Settlement 1957, November Settlement 1957, Penalty, Collections to First Monday in January 1958, Delinquent on First Monday in January 1958, Total Delinquent Tax and Penalty, REMARKS.

Peaceful Valley, Sunset Beach, Peaceful Shores, Peaceful Shores, Peaceful Shores

Peaceful Valley, Sunset Beach, Peaceful Shores, Peaceful Shores, Peaceful Shores

(Out of order) 1019, Peaceful Shores 1-19

Assessment Roll and Tax List of Real Property in the Town of *Peaceful*, of *Hiram* County, Minnesota

* Indicate Type of Property: R-Residential, C-Commercial, I-Industrial, U-Utility, F-Farm, L-Lakeshore, T-Timber, M-Mineral

MINN. SEC. 560 - BILLS - STATE COMPTROLLER, MINNAPOLIS

Main assessment table with columns: IN WHOSE NAME ASSESSED, TO WHOM TRANSFERRED, SUBDIVISION, Sec. or Lot, Town or Block, No. of Acres, TRUE AND FULL VALUATIONS, ASSESSED VALUATIONS (RURAL, ALL OTHER, MACHINERY), and FINAL EQUALIZED VALUE.

Cass County, Minnesota, for Taxes for the Year 1956.

Tax payment table with columns: SOLD FOR TAXES, VALUATIONS BY SCHOOL DISTRICTS, Tax including State Homestead, SPECIAL TAXES, TOTAL TAXES, PAID, WHEN PAID, Number of Receipt, March Settlement 1957, June Settlement 1957, November Settlement 1957, Penalty, Collections to First Monday in January 1958, Delinquent on First Monday in January 1958, Total Delinquent Tax and Penalty, and REMARKS.

Peaceful Valley, Sunset Beach, Peaceful Shores, Peaceful Shores

Peaceful Shores, Sunset View, Peaceful Shores

Assessment Roll and Tax List of Real Property in the Town of *Liam*

* Indicate Type of Property: R-Residential, C-Commercial, I-Industrial, U-Utility, F-Farm, L-Lakeshore, T-Timber, M-Mineral

Form 5C (56) MARCH 1955 EDITION, MINNAPOLIS

Table with columns: IN WHOSE NAME ASSESSED, TO WHOM TRANSFERRED, DESCRIPTION OF PROPERTY, TRUE AND FULL VALUATIONS, ASSESSED VALUATIONS, FINAL EQUALIZED VALUE. Includes handwritten entries for Carl A. Ryan and Jennie A. Peterson.

Cass County, Minnesota, for Taxes for the Year 1956.

Table with columns: VALUATIONS BY SCHOOL DISTRICTS AS EQUALIZED BY DEPARTMENT OF TAXATION, Tax including State Homestead, State Tax on Non-Homestead, SPECIAL TAXES, TOTAL TAXES, PAID, WHEN PAID, Number of Receipt, March Settlement 1957, June Settlement 1957, Penalty, November Settlement 1957, Collections to First Monday in January 1958, Delinquent on First Monday in January 1958, Total Delinquent Tax and Penalty, REMARKS.

Vertical text on the left edge: Hiram, Peaceful Valley, Sunset Beach, Chariton Beach, Peaceful Shores, Peaceful Beach, Hacking Back, Bathing Beach, 19-Arrangement of Lot, 18-Arrangement of Lot, 17-Arrangement of Lot, 16-Arrangement of Lot, 15-Arrangement of Lot, 14-Arrangement of Lot, 13-Arrangement of Lot, 12-Arrangement of Lot, 11-Arrangement of Lot, 10-Arrangement of Lot, 9-Arrangement of Lot, 8-Arrangement of Lot, 7-Arrangement of Lot, 6-Arrangement of Lot, 5-Arrangement of Lot, 4-Arrangement of Lot, 3-Arrangement of Lot, 2-Arrangement of Lot, 1-Arrangement of Lot.

Vertical text on the right edge: Sunset View, 1st Addition to Peaceful Shores, (Out of order) 1st Addition to Peaceful Shores 1-19.

Assessment Roll and Tax List of Real Property in the Town of Harvard

** Indicate Type of Property: R-Residential, C-Commercial, I-Industrial, U-Utility, F-Farm, L-Lakeshore, T-Timber, M-Mineral*

Form 86 (56) MULLER-DAY COMPANY, MINNEAPOLIS

IN WHOSE NAME ASSESSED	TO WHOM TRANSFERRED	DESCRIPTION OF PROPERTY				No. School District	TRUE AND FULL VALUATIONS				ASSESSED VALUATIONS						FINAL EQUALIZED VALUE				
		Subdivision	Sec. of Lot	Town of Block	Rtg. No.		Number of Acres of Land	LAND Exclusive of Structures and Improvements	BUILDINGS and Other Structures	MACHINERY Permanently Attached to Real Estate	TOTAL True and Full Value	RURAL		ALL OTHER		MACHINERY Permanently Attached to Real Estate		TOTAL ASSESSED VALUE	Total Assessed Value as Equalized by the Board of Review		
												Homestead Up to \$4,000	Over \$4,000 and Non-Homestead 33 1/3%	Timber Land Class 3e 20%	Homestead Up to \$4,000 25%					Over \$4,000 and Non-Homestead 40%	
William H. & Martha E. Kimberley		Swansea	24	170	31	Acres	100%			100	70	R	30	462	492	164		164			
Exeter L. & Mary C. Shepard, & Ethel M. & James C. Carroll		Swansea	24	170	31	Acres	100%					L	24	24	24	8		8			
William H. & Martha E. Kimberley		Swansea	24	170	31	Acres	100%					"	21	21	21	7		7			
Melvin G. & Emily C. Willard		Swansea	24	170	31	Acres	100%					"	21	21	21	7		7			
Carl L. & Barbara W. Forth		Swansea	24	170	31	Acres	100%					"	21	21	21	7		7			
Edward C. & Eileen C. Godenhofer		Swansea	24	170	31	Acres	100%					"	21	21	21	7		7			
Norman & Betty Ann Case		Swansea	24	170	31	Acres	100%					"	21	21	21	7		7			
Lorraine Godenhofer		Swansea	24	170	31	Acres	100%					"	21	21	21	7		7			
Laurence W. & Iris A. Nelson		Swansea	24	170	31	Acres	100%					"	21	21	21	7		7			
Wm. C. & Anna C. Godenhofer		Swansea	24	170	31	Acres	100%					"	21	21	21	7		7			
Earl & Barbara Ford		Swansea	24	170	31	Acres	100%					"	21	21	21	7		7			
" " " "		Swansea	24	170	31	Acres	100%					"	21	21	21	7		7			

SOLD FOR TAXES	VALUATIONS BY SCHOOL DISTRICTS AS EQUALIZED BY DEPARTMENT OF TAXATION						Tax including State Homestead	State Tax on Non-Homestead	SPECIAL TAXES	TOTAL TAXES	PAID	WHEN PAID	Number of Receipt	March Settlement 1957	June Settlement 1957	Penalty	November Settlement 1957	Penalty	Collections to First Monday in January 1958	Penalty	Delinquent on First Monday in January 1958	Total Delinquent Tax and Penalty	REMARKS
	District No. No.	District No. No.	District No. No.	District No. No.	District No. No.	District No. No.																	

1st Addition to Peaceful Shores

(Out of order) 1st Addition to Peaceful Shores 1-19

Assessment Roll and Tax List of Real Property in the Town of Hiram,

Indicate Type of Property: R-Residential, C-Commercial, I-Industrial, U-Utility, F-Farm, L-Lakeshore, T-Timber, M-Mineral

Table with columns: IN WHOSE NAME ASSESSED, TO WHOM TRANSFERRED, SURVIVORS, DESCRIPTION OF PROPERTY, TRUE AND FULL VALUATIONS, ASSESSED VALUATIONS (RURAL, ALL OTHER, MACHINERY), TOTAL ASSESSED VALUE, FINAL EQUALIZED VALUE.

Cass County, Minnesota, for Taxes for the Year 1956.

Table with columns: SOLD FOR TAXES, VALUATIONS BY SCHOOL DISTRICTS AS EQUALIZED BY DEPARTMENT OF TALLION, SPECIAL TAXES, TOTAL TAXES, PAID, WHEN PAID, Number of Receipt, March Settlement, June Settlement, Penalty, November Settlement, Collections to First Monday in January 1955, Delinquent on First Monday in January 1955, Total Delinquent Tax and Penalty, REMARKS.

