

ASSESSMENT & TAX LIST

Hiram

1947



List of Lands in the \_\_\_\_\_ of \_\_\_\_\_, County of \_\_\_\_\_, Minn., for the Year 19\_\_\_\_, Which have Become Homesteads or Ceased to be Homesteads  
 SINCE THE LAST REAL ESTATE ASSESSMENT DATE

Form 214 Miller-Davis Company, Minneapolis, State Form No. 67

LANDS BECOMING HOMESTEADS					LANDS CEASING TO BE HOMESTEADS								
NAME OF OWNER	School District	DESCRIPTION OF PROPERTY SUBDIVISION	Sec. or Lot		Town or Range	Number of Acres of Land Acres 10ths	NAME OF OWNER	School District	DESCRIPTION OF PROPERTY SUBDIVISION	Sec. or Lot		Town or Range	Number of Acres of Land Acres 10ths
			or	Block						or	Block		
Martin Horn Hosaki -		Lot 7 - Plainview Beach ✓											
Husman (Burrhead)		Lot 2	19		16 31								
Landsberg		Lot 4	16		16 31 ?								
Andrews		Lot 3	16		14 31								
Lawson		Lot 39 - Pearly Shores ✓											

(Self Lot 4 less 2 lots 100' x 200' they already got clear.)

Long Beach  
Stady Shores  
White Pine Beach  
Plainview Beach  
He-Arrang  
White Pine Beach



Assessment of

Form 3 1/2 WILCOX-DAVIS COMPANY, MINNEAPOLIS

NAME OF OWNER

1  
2  
3  
4  
5  
6  
7  
8

Treasurer's Office, Cass County, Minnesota

RECEIVED this, the first Monday (being the 5th day) of January, A. D. 1948, of L. C. Peterson, Auditor of said County, Minnesota, the Tax List of all Taxable Real and Personal Property in the Town of Hiram in said County for the year A. D. 1947 as specified above and amounting to 100 Dollars

Paul D. Jewell  
County Treasurer.

Auditor's Office, Cass County, Minnesota

I, \_\_\_\_\_ Auditor of said County, and State of Minnesota, do hereby certify that the following is a correct list of the Taxes levied on the Real and Personal Property in the \_\_\_\_\_ of \_\_\_\_\_ for the year 1947.

WITNESS my hand and official seal, the \_\_\_\_\_ day of \_\_\_\_\_ 1948.

(SEAL) \_\_\_\_\_ County Auditor.

JAN - 3 1949 194

Office of County Treasurer, Cass County, Minnesota

To L. C. Peterson, County Auditor:

Sir: I herewith return to you the Tax List for the Town of Hiram

in said County for the year 1947, heretofore received from you. I certify that I have compared the same with the duplicate receipts in your office, and have written opposite the amount of each tax so receipted the words "First Quarter Paid", "Second Quarter Paid", "Third Quarter Paid" or "Paid in full" as the case may be, and the number of my receipt given in discharge of said tax, and each tract or lot of real property against which the taxes remain unpaid is delinquent for said year.

Yours respectfully,  
Paul D. Jewell  
County Treasurer.

Auditor's Office, Cass County, Minnesota

I hereby certify that on the first Monday in January 1949, I received of \_\_\_\_\_ County Treasurer, the Tax List of the \_\_\_\_\_ of \_\_\_\_\_ in said County for the year 1947; that I have compared the said list with the Statements receipted for by said Treasurer, which are on file in my office, and that each tract or lot of real property therein against which the taxes, or any part thereof, remains unpaid are delinquent for said year.

(SEAL) \_\_\_\_\_ County Auditor.































































































































Assessment Roll and Tax List of Real Estate

Form 4-C WILCOX-DAVIS COMPANY, MINNEAPOLIS

IN WHOSE NAME ASSESSED	TO WHOM TRANSFERRED	SUBDIVISION	Sec. of Lot	Town or Block
		Chariton Beach (Lots 1+2 Sec 3-140-31)		
A. R. Buck	Anne Frances Buck		1	
Allie L. Kridelbaugh	Ivar E. Jr. + Spirley B. Siaveland		2	
Helen Reese			3	
Ruth A. Goskin			4	
William E. Ekenberg			5	
"			6	
Jane + Allen L. Dewey			7	
Mary E. Shelton			8	
Jane + Allen E. Dewey	Chas. A. + Anna E. Powell		9	
Allie C. + June Cochran			10	
Alfred C. + Sigrid West			11	
Elmer L. Goskin			12	
Allie L. Kridelbaugh		That part of lot 13 lying S. of N. line of T. 140. Rge 31	13	
Sam V. Carpenter		" " " 14 " S. of N. " " "	14	
Allie L. Kridelbaugh	Arthur B. + Evelyn B. Hunt	" " " 15 " S. of N. " " "	15	
Jane + Allen L. Dewey		" " " 16 " S. of N. " " "	16	

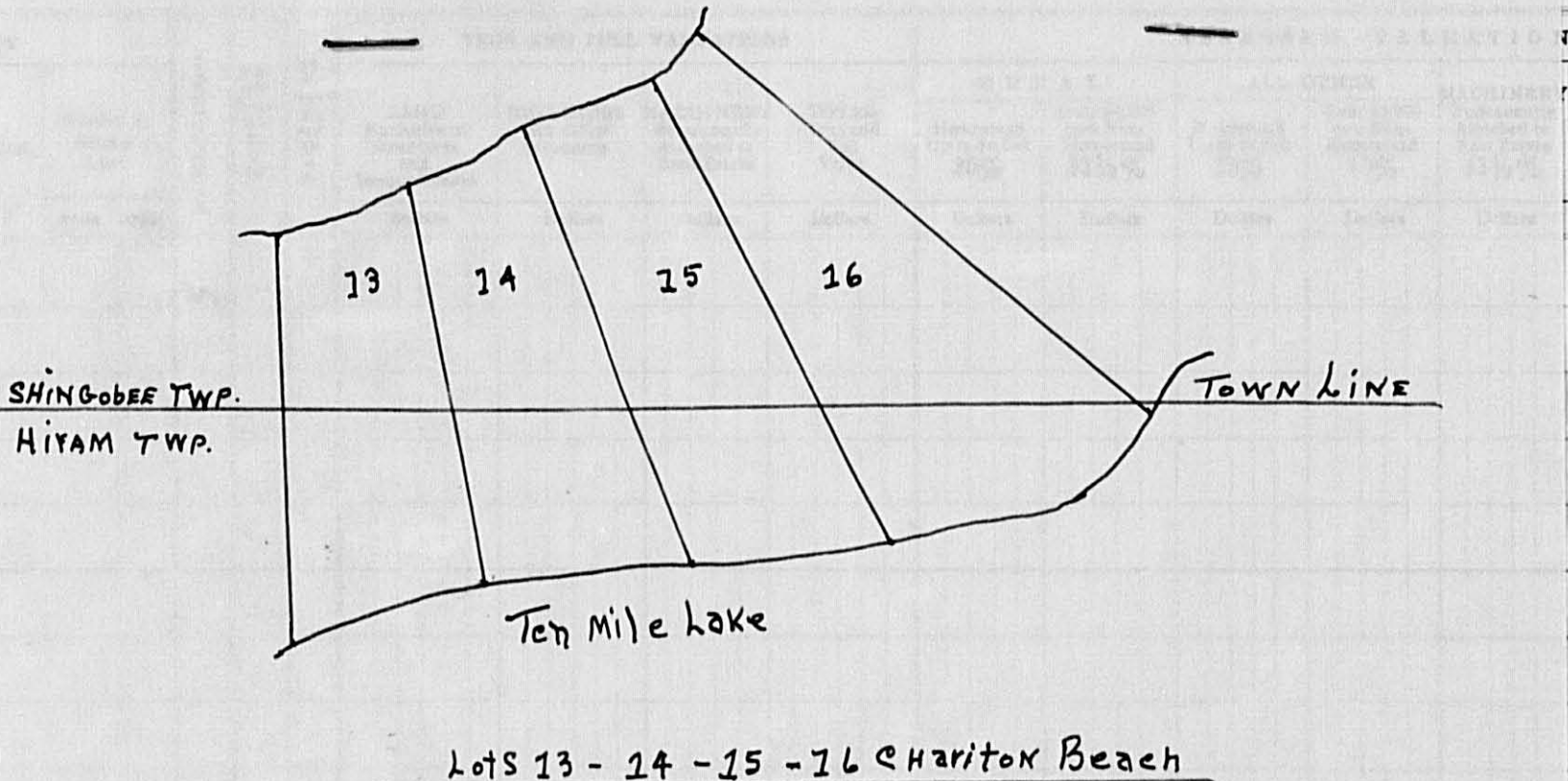

SOLD FOR TAXES	VALUATIONS BY SCHOOL DISTRICTS AS EQUALIZED BY DEPARTMENT OF TAXATION						Tax including State Homestead	State Tax on Non Homestead	SPECIAL TAXES	TOTAL TAXES	PAID	WHEN PAID	Number of Receipt	March Settlement 1948	June Settlement 1948	Penalty	November Settlement 1948	Penalty	Collections to First Monday in January 1949	Penalty	Delinquent on First Monday in January 1949	Total Delinquent Tax and Penalty	REMARKS	
	District No.	District No.	District No.	District No.	District No.	District No.																		Dollars
1							163			3274	66	3340	1	PAID IN FULL FEB - 9 1948	918	3340								
2							89			1788	36	1824	2	PAID IN FULL JAN 12 1948	104	1824								
3							110			2210	44	2254	3	PAID IN FULL JUN 14 1948	1491		2254							
4							62			1246	26	1272	4	PAID IN FULL MAY 20 1948	5370		1272							
5							138			2772	56	2828	5	PAID IN FULL JUN 30 1948	9204		2828							
6							155			3112	64	3176	6	PAID IN FULL APR 27 1948	4663		3176							
7							169			3394	68	3462	7	PAID IN FULL APR - 1 1948	4304		3462							
8							128			2570	52	2622	8	PAID IN FULL FEB 25 1948	1753	2622								
9							25			502	10	512	9	PAID IN FULL MAR 1 - 1948	2335	512								
10							25			502	10	512	10	PAID IN FULL FEB 5 1948	854	512								
11							25			502	10	512	11	PAID IN FULL MAY 14 1948	5158		512							
12							25			502	10	512	12	PAID IN FULL MAY 20 1948	5370		512							
13							17			342	06	348	13	PAID IN FULL JAN 12 1948	104	348								
14							17			342	06	348	14	PAID IN FULL MAY 17 1948	5297		348							
15							17			342	06	348	15	PAID IN FULL JAN 12 1948	104	348								
16							17			342	06	348	16	PAID IN FULL MAY - 5 1948	4845		348							
17													17											
18													18											
19													19											
20													20											
							1182			23742	476	24218												

















