

2008

11

INDEX TO SECTIONS

SECTION	PAGE
Sec. 1	
" 2	
" 3	
" 4	
" 5	
" 6	
" 7	
" 8	
" 9	
" 10	
" 11	
" 12	
" 13	
" 14	
" 15	
" 16	
" 17	
" 18	
" 19	
" 20	
" 21	
" 22	
" 23	
" 24	
" 25	
" 26	
" 27	
" 28	
" 29	
" 30	
" 31	
" 32	
" 33	
" 34	
" 35	
" 36	

For Convenience of Auditor in Showing Boundaries of School Districts

Township No. 140 Range No. 21 Mer. P. M.

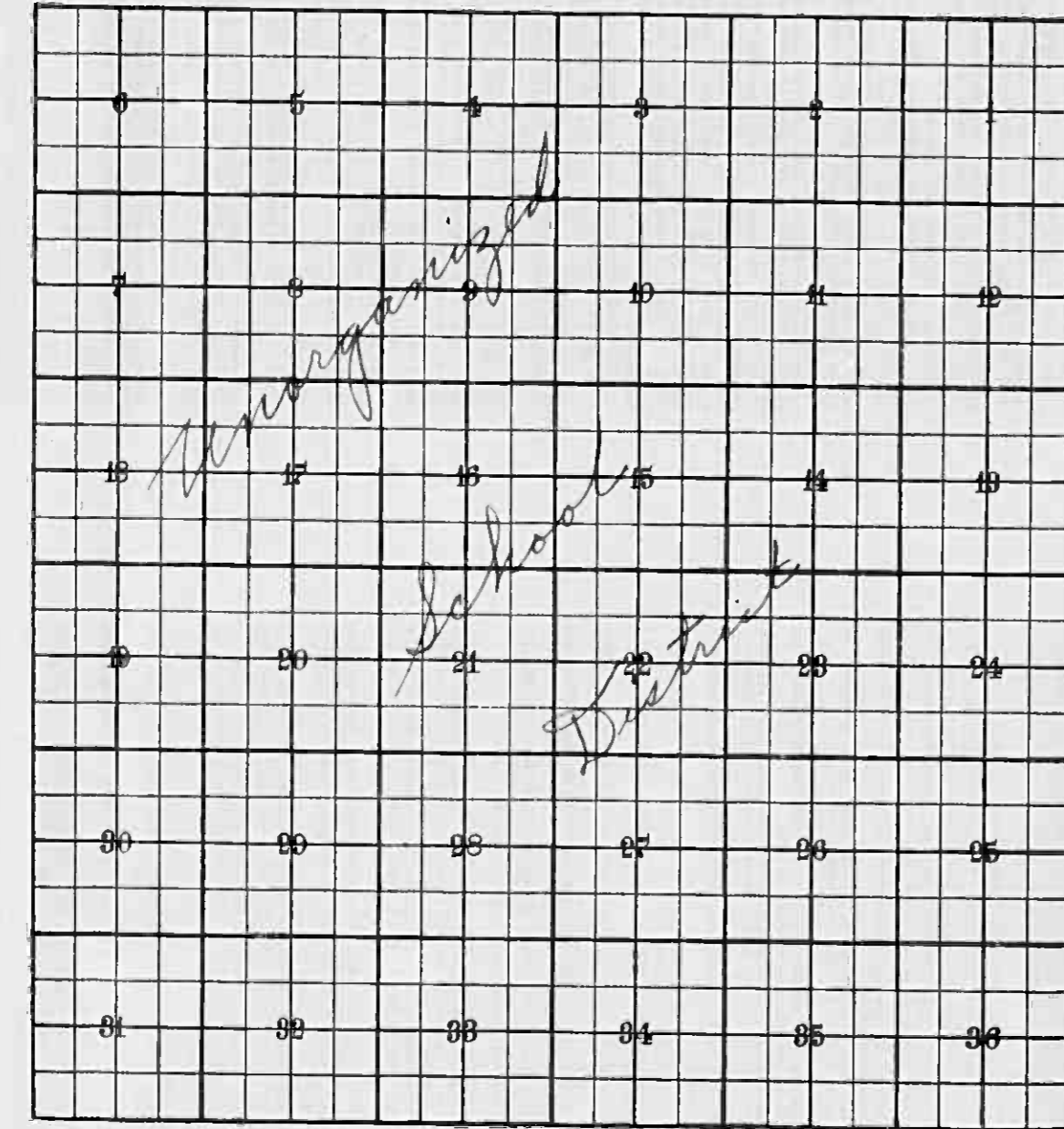

Returns Showing Grain Received in or Handled by Elevators, Warehouses and Mills in the \_\_\_\_\_ of \_\_\_\_\_ in the  
County of \_\_\_\_\_ for the Year Ending May 1, 1958.

NAMES OF OWNERS	ADDRESS	Bushels of Wheat	Bushels of Soy Beans	Bushels of Flax	Total No. of Bushels of Wheat, Soy Beans and Flax	★ Tax of $\frac{1}{4}$ Mill per Bushel		Bushels of Corn	Bushels of Barley	Bushels of Ry	Bushels of Oats	Bushels of Buckwheat	Bushels of all Other Grains	Total No. Bushels of Corn, Barley, Ry, Oats, Buckwheat and all Other Grains	★ Tax of $\frac{1}{4}$ Mill Per Bushel		★ Total Tax		REMARKS		
						Dollars	Cts.								Dollars	Cts.	Dollars	Cts.			

Note ★ Assessors will not fill these Columns

Real Estate  
 Lone Pine  
 Shady Shores  
 Pine Beach  
 Fairview Beach  
 Fragment of Lot  
 Parcel  
 Parcel  
 Parcel

SUMMARY OF TAX COLLECTION

Original Levy	-	-	-	-	-	\$	19522.78
Additions	-	-	-	-	-	\$	1134
							\$19640.32
Abatements	-	-	-	-	-	\$	156.14
							\$19484.18

COLLECTIONS

March Settlement	-	-	-	-	-	\$	3087.05
June Settlement	-	-	-	-	-	\$	11706.85
November Settlement	-	-	-	-	-	\$	3096.22
January Settlement	-	-	-	-	-	\$	371.75
						\$	18261.87
Over Collected	-	-	-	-	-	\$	7.44
Under Collected	-	-	-	-	-	\$	
Delinquent	-	-	-	-	-	\$	1229.35
						\$	1222.31
Total	-	-	-	-	-	\$	19484.18

Real Estate

Low Beach  
Ready Shores  
Pine Beach  
Plainview Beach  
Prangemont of Lot  
The Pine Beach  
Hurst  
Lisbon

TABULAR SCHEDULE OF VALUATIONS,

LEVIED IN THE Iowa OF Hiram

School District No.	VALUATION BY SCHOOL DISTRICTS				RATE OF STATE TAXES		RATE OF COUNTY TAXES										RATE OF TOWN TAXES										RATE OF									
	Agri-cultural Lands	Non-Agri-cultural Lands	Personal Property	Total Value of all Property except Money and Credits	Total Rate of State Tax	Total Rate of County Tax	Rev.	R. & B.	Wel-fare	Bonds and Int.	PERA	RJB Fed Prop.	Total Rate of County Tax	Rev.	R. & B.	Drag Tax	State Loan	Total Rate of Town Tax	Local	Spe-cial	State Loan	Defi-ciency	Tui-tion	Trans-portion	PERA C.O.	Local	Spe-cial	State Loan	Defi-ciency	Tui-tion	Trans-portion	PERA C.O.				
	Dollars	Dollars	Dollars	Dollars	Mills	Mills	Mills	Mills	Mills	Mills	Mills	Mills	Mills	Mills	Mills	Mills	Mills	Mills	Mills	Mills	Mills	Mills	Mills	Mills	Mills	Mills	Mills	Mills	Mills	Mills	Mills	Mills				
Un	13,218	51,849	11,011	76,078	5.90	2954	15.	57.68	-	3.45	5.	109.17	4.6	16.4	1.		22.	1.	20.	63.		1.45	2.1	10.		1.	40.	63.		1.45	2.1	10.				
					N.H. 6.52		Co. Nurse 2.00		R & B Bldg. 2.00		Agricult. Assn. .5																									
					12.42																															
Assessed Value	Rural	All Other	Personal Property	Total																																
Homestead	12,235			12,235																																
Non-Homestead	52,832		11,011	63,843																																
Total	65,067		11,011	76,078																																

RATES AND TAXES

COUNTY OF CASS, STATE OF MINNESOTA

SCHOOL TAXES			LOCAL 1 MILL AND SPECIAL SCHOOL TAXES BY DISTRICTS										ALL OTHER TAXES		
Total Rate of Sch'l Tax	Total Rate of all Taxes		Local 1 Mill	Special	State Loan	Def.	Transp.	PERA	C.O.	Total School Taxes	FUNDS	Rate	Amounts		
97.55	234.62		13.21	264.36		832.73	1917	2776	13218	128941	State - Non-Homestead		417.42		
117.55	254.62		62.86	2514.40		396018	9115	13201	62860	738920	State - Homestead		447.79		
			76.07	2778.76		479291	11032	15977	76078	867861	County Revenue		224734		
													County Road and Bridge		114117
													County Welfare		393171
													Roads and Interm.		26247
													R. & Bridge Fed. Prop.		38039
													Co. Nurse		15216
													Town Revenue		34996
													Town Road and Bridge		124768
													Town Drag		7608
													Town State Loan		167372
													School Local 1 Mill		7607
													School Special		277876
													School State Loan		479291
													Deficiency		
													Tuition		
													Transportation		
													P.E.R.A.		
													C.O.		
															867861
															1952298

County: R & B Bldg. 15216  
Agricult. Assn. 3804  
830544

Total Number of Acres 7142.75  
State of Minnesota, ss.  
COUNTY OF CASS  
Auditor of said County and State aforesaid, do hereby certify that the foregoing is a true and correct Schedule, showing the valuation of all the taxable property, in the State of Iowa, in said County, the several rates of Taxation and Totals of the several Tax Funds levied thereon for the year A. D. 1938.

Witness my hand and official seal, this 31st day of December A. D. 1938.  
SEAL  
L. C. Peterson County Auditor  
By Helen Bullen, Deputy

Total Taxes Real Estate 16,647.54  
Pers. Prop. 2875.44  
Total 19522.98

COLLECTIONS OF TAXES OF 1958

Town OF *Wanam*

CASS COUNTY, MINNESOTA

FUNDS	MARCH SETTLEMENT 1958	JUNE SETTLEMENT 1958	NOV. SETTLEMENT 1958	Amount Collected from Nov. 1957 to First Monday in Jan. 1958	REDUCTIONS	Total Reductions and Collected	BALANCE UNCOLLECTED	ADDITIONS	Total Uncollected to First Monday in January, 1958
State - Non-Homestead	7643	25327	5320	560					
State - Homestead	6993	26884	7187	871					
County Revenue	35013	134602	35984	4362					
County Road and Bridge	17778	68349	18272	2215					
County Welfare	61254	235486	62954	7630					
County Bond and Interest									
R. + B. Fed. Proj.	5926	22783	6091	738					
Co. Nurse	2370	9113	2436	295					
R. + B. Bldg.	2370	9113	2436	295					
Town Revenue	5452	20960	5603	679					
Town Road and Bridge	19438	74728	19975	2421					
Town Drag	1185	4557	1218	148					
Town State Loan									
School Local 1 Mill	1185	4556	1218	148					
School Special	46687	167416	42863	4926					
School State Loan									
Deficiency	74669	287067	76743	9302					
Tuition									
Transportation	1718	6628	1767	214					
C. O.	11854	45566	12181	1476					
PERA	2489	9569	3559	311					
PERA	4089	15720	4203	509					
Agri. Ass'n	592	2279	609	75					
	308765	1170685	309622	37175					

	SCHOOL DISTRICT NO.	LOCAL 1 MILL	SPECIAL	STATE LOAN	Deficiency	Transp.	C. O.	PERA	TOTALS
MARCH SETTLEMENT	Un A	36	722		2274	52	362	76	5522
	Un TA	1149	45965		72395	1666	11492	2413	135080
	Totals	1185	46687		74669	1718	11854	2489	138602
JUNE SETTLEMENT	Un A	742	14848		46773	1077	7424	1559	72443
	Un TA	3814	152568		240294	5531	38142	8010	448359
	Totals	4556	167416		287067	6608	45566	9569	520802
NOVEMBER SETTLEMENT	Un A	293	5862		18466	425	2931	616	28593
	Un TA	925	37001		58277	1342	9250	1943	108738
	Totals	1218	42863		76743	1767	12181	2559	137331
NOVEMBER to JANUARY	Un A	49	980		3086	71	490	103	4779
	Un TA	99	3926		6216	143	996	208	14548
	Totals	148	4926		9302	214	1476	311	16327
ADDITIONS									
REDUCTIONS									
	Totals								

Real Estate  
 Lake Park  
 Sandy Shores  
 Pine Beach  
 Rainier Beach  
 Management of Lot  
 Hurst  
 Itasca

Assessment Roll and Tax List of Real Property in the Town of Niram

Indicate Type of Property: R-Residential, C-Commercial, I-Industrial, U-Utility, F-Farm, L-Lakeshore, T-Timber, M-Mineral

Cass County, Minnesota, for Taxes for the Year 1958.

Table with columns: IN WHOSE NAME ASSESSED, TO WHOM TRANSFERRED, DESCRIPTION OF PROPERTY, TRUE AND FULL VALUATIONS, ASSESSED VALUATIONS, FINAL EQUALIZED VALUE.

Table with columns: SOLD FOR TAXES, VALUATIONS BY SCHOOL DISTRICTS AS EQUALIZED BY DEPARTMENT OF TAXATION, Tax Including State Homestead, State Tax on Non-Homestead, SPECIAL TAXES, TOTAL TAXES, PAID, WHEN PAID, Number of Receipt, March Settlement 1959, June Settlement 1959, November Settlement 1959, Collection to First Monday in January 1960, Delinquent on First Monday in January 1960, Total Delinquent Tax and Penalty, REMARKS.

Real Estate

Shores Pine Beach Plainview Beach

(Continued Next Page)



Assessment Roll and Tax List of Real Property in the Town of Hiram

Indicate Type of Property: R-Residential, C-Commercial, I-Industrial, U-Utility, F-Farm, L-Lakeshore, T-Timber, M-Mineral

Cass County, Minnesota, for Taxes for the Year 1958.

IN WHOSE NAME ASSESSED	TO WHOM TRANSFERRED	DESCRIPTION OF PROPERTY				TRUE AND FULL VALUATIONS												FINAL EQUALIZED VALUE
		SUBDIVISION	Sec or Lot	Town or Block	Number of Acres of Land Acres 100ths	RURAL				ALL OTHER				MACHINERY Permanently Attached to Real Estate	TOTAL ASSESSED VALUE	Total Assessed Value as Equalized by the Board of Review		
						LAND Exclusive of Structures and Improvements	BUILDINGS and Other Structures	TOTAL True and Full Value	Homestead Up to \$4,000 20%	Over \$4,000 and Non-Homestead 33 1/3%	Timber Land Class Je 20%	Homestead Up to \$1,000 25%	Over \$4,000 and Non-Homestead 40%				MACHINERY Permanently Attached to Real Estate 33 1/3%	
						Dollars	Dollars	Dollars	Dollars	Dollars	Dollars	Dollars	Dollars	Dollars	Dollars	Dollars		

SOLD FOR TAXES	VALUATIONS BY SCHOOL DISTRICTS AS EQUALIZED BY DEPARTMENT OF TAXATION						Tax including State Homestead	State Tax on Non-Homestead	SPECIAL TAXES	TOTAL TAXES	PAID	WHEN PAID	Number of Receipt	March Settlement 1959	June Settlement 1959	Penalty	November Settlement 1959	Penalty	Collections to First Monday in January 1960	Penalty	Delinquent on First Monday in January 1960	Total Delinquent Tax and Penalty	REMARKS
	District No.	District No.	District No.	District No.	District No.	District No.																	
	Rate	Rate	Rate	Rate	Rate	Rate																	

Shady Stores Pine Beach Plainview Beach Prangment of Lot Pine Beach









Assessment Roll and Tax List of Real Property in the Town of Hiawatha

Indicate Type of Property: R-Residential, C-Commercial, I-Industrial, U-Utility, F-Farm, L-Lakeshore, T-Timber, M-Mineral

Cass County, Minnesota, for Taxes for the Year 1958.

Table with columns for 'IN WHOSE NAME ASSESSED', 'TO WHOM TRANSFERRED', 'DESCRIPTION OF PROPERTY', 'TRUE AND FULL VALUATIONS', 'ASSESSED VALUATIONS', 'VALUATIONS BY SCHOOL DISTRICTS AS EQUALIZED BY DEPARTMENT OF TAXATION', 'PAID', and 'REMARKS'. Rows include entries for 'State of Minnesota' with various lot descriptions and tax details.

Shady Shore Pine Beach Plainview Beach ...

Assessment Roll and Tax List of Real Property in the Town of Hiram

\* Indicate Type of Property: R-Residential, C-Commercial, I-Industrial, U-Utility, F-Farm, L-Lakeshore, T-Timber, M-Mineral

Table with columns: IN WHOSE NAME ASSESSED, TO WHOM TRANSFERRED, DESCRIPTION OF PROPERTY, TRUE AND FULL VALUATIONS, ASSESSED VALUATIONS (RURAL, ALL OTHER), TOTAL ASSESSED VALUE, and FINAL EQUALIZED VALUE.

Cass County, Minnesota, for Taxes for the Year 1958.

Table with columns: VALUATIONS BY SCHOOL DISTRICTS AS EQUALIZED BY DEPARTMENT OF TAXATION (District No., Rate, etc.), SPECIAL TAXES, TOTAL TAXES, PAID, WHEN PAID, Number of Receipt, March/June/November Settlement, Penalty, Collections to First Monday in January 1960, Delinquent on First Monday in January 1960, Total Delinquent Tax and Penalty, and REMARKS.

Shady Shores Pine Beach Plainview Beach Pragnose Parkview Forest Parkview



Assessment Roll and Tax List of Real Property in the Town of Hiawatha of Missouri

\* Indicate Type of Property: R-Residential, C-Commercial, I-Industrial, U-Utility, F-Farm, L-Lakeshore, T-Timber, M-Mineral

IN WHOSE NAME ASSESSED	TO WHOM TRANSFERRED	DESCRIPTION OF PROPERTY																					
		SUBDIVISION	Sec. or Lot	Town or Block	Kdg.	Number of Acres of Land	Indicate School District	Indicate Homestead Tax or No.	Indicate Agricultural Tax or No.	Indicate Type of Property	TRUE AND FULL VALUATIONS				ASSESSED VALUATIONS					FINAL EQUALIZED VALUE			
											LAND Exclusive of Structures and Improvements	BUILDINGS and Other Structures	MACHINERY Permanently Attached to Real Estate	TOTAL True and Full Value	RURAL		ALL OTHER				MACHINERY Permanently Attached to Real Estate	TOTAL ASSESSED VALUE	Total Assessed Value as Equalized by the Board of Review
															Homestead Up to \$4,000 20%	Over \$4,000 and Non-Homestead 33 1/3%	Timber Land Class 3e 20%	Homestead Up to \$4,000 25%	Over \$4,000 and Non-Homestead 40%				
<i>Mathilda Blakemore</i>	That part of lot 3, Sec. 8-110-31 Described as follows: Beg. at a point 23 rds. W. & 14 rds. S. of the NE Cor. of said lot 3 thence S. 14 rds. E. to Ten Mile Lake N. following lakeshore to a point 14 rds. S. of N. line of said lot 3 thence W. to place of Beg.	8	14	31	2				T	30					30		10			10			

Cass County, Minnesota, for Taxes for the Year 1958.

SOLD FOR TAXES	VALUATIONS BY SCHOOL DISTRICTS AS EQUALIZED BY DEPARTMENT OF TALLATION						Tax includes State Homestead	State Tax on Non-Homestead	SPECIAL TAXES	TOTAL TAXES	PAID	WHEN PAID	Number of Receipt	March Settlement 1959	June Settlement 1959	Penalty	November Settlement 1959	Penalty	Collections to First Monday in January 1960	Penalty	Delinquent on First Monday in January 1960	Total Delinquent Tax and Penalty	REMARKS	
	District No.	District No.	District No.	District No.	District No.	District No.																		
	Rate	Rate	Rate	Rate	Rate	Rate																		
	Mills	Mills	Mills	Mills	Mills	Mills																		
1									234	06	240	1	PAID IN FULL	MAR 23 1959	6766						240			
2																								
3																								
4																								
5																								
6																								
7																								
8																								
9																								
10																								
11																								
12																								
13																								
14																								
15																								
16																								
17																								
18																								
19																								
20																								

Beady Scores Fine Beach Fine Beach Standard Beach Fine Beach

Assessment Roll and Tax List of Real Property in the Town of Miami

Indicate Type of Property: R-Residential, C-Commercial, I-Industrial, U-Utility, F-Farm, L-Lakeshore, T-Timber, M-Mineral

Form 301

IN WHOSE NAME ASSESSED	TO WHOM TRANSFERRED	DESCRIPTION OF PROPERTY						TRUE AND FULL VALUATIONS						ASSESSED VALUATIONS					FINAL EQUALIZED VALUE			
		SUBDIVISION	Sec. or Lot	Town or Block	Rng.	Number of Acres of Land	No. School District	Indicate Homestead Yes or No	Indicate Agricultural Yes or No	Indicate Type of Property	LAND Exclusive of Structures and Improvements	BUILDINGS and Other Structures	MACHINERY Permanently Attached to Real Estate	TOTAL True and Full Value	RURAL		ALL OTHER			MACHINERY Permanently Attached to Real Estate	TOTAL ASSESSED VALUE	Total Assessed Value as Equalized by the Board of Review
															Acres	100ths	Homestead Up to \$4,000 20%	Over \$4,000 and Non-Homestead 33 1/3%				
<i>George C. Brandt, Jr.</i>		N E 1/4 of N E 1/4 Lot 2	9	140	31	1432	M M 70	R	207	232	172	2439	7757	813	653		25%	40%	813	1.8	653	
																						2
																						3
																						4
																						5
																						6
																						7
																						8
																						9
																						10
<i>Carl Auguste Lind</i>		S W 1/4 of S W 1/4 Lot 1					no no 23	LS	51	126	51	126	17	42		25%	40%	17		42		
																					14	
																					15	
																					16	
																					17	
																					18	
																					19	
																					20	
																					21	
																					22	

Cass County, Minnesota, for Taxes for the Year 1958.

SOLD FOR TAXES	VALUATIONS BY SCHOOL DISTRICTS AS EQUALIZED BY DEPARTMENT OF TAXATION						Tax including State Homestead	State Tax on Non-Homestead	SPECIAL TAXES	TOTAL TAXES	PAID	WHEN PAID	Number of Receipt	March Settlement 1959	June Settlement 1959	Penalty	November Settlement 1959	Penalty	Collections to First Monday in January 1960	Penalty	Delinquent on First Monday in January 1960	Total Delinquent Tax and Penalty	REMARKS	
	District No.	District No.	District No.	District No.	District No.	District No.																		
	Rate	Rate	Rate	Rate	Rate	Rate																		
	Mills	Mills	Mills	Mills	Mills	Mills																		
1						813				19074	530	19604	1	PAID IN FULL	MAY 20 1959	9643		19604						
2																								
3																								
4																								
5																								
6																								
7																								
8																								
9																								
10																								
11																								
12																								
13						17				432	12	444	13	PAID IN FULL	APR 13 1959	5176		444						
14																								
15																								
16																								
17																								
18																								
19																								
20																								
20						813				19074	432	20048												

Boundary Shows  
 Pine Beach  
 Fairview Beach  
 Arrangement of Lot  
 Pine Beach  
 Parishes  
 Pursuant to Minnesota Statutes



Assessment Roll and Tax List of Real Property in the Town of Hiram

\* Indicate Type of Property: R-Residential, C-Commercial, I-Industrial, U-Utility, F-Farm, L-Lakeshore, T-Timber, M-Mineral

Table with columns: IN WHOSE NAME ASSESSED, TO WHOM TRANSFERRED, SUBDIVISION, TRUE AND FULL VALUATIONS, ASSESSED VALUATIONS, and FINAL EQUALIZED VALUE. Includes handwritten entries for various lots and owners like Helen A. Dalton and Ernest F. & Alma M. Matthias.

Cass County, Minnesota, for Taxes for the Year 1958.

Table with columns: VALUATIONS BY SCHOOL DISTRICTS AS EQUALIZED BY DEPARTMENT OF TAXATION, TAX INCLUDING STATE HOMESTEAD, SPECIAL TAXES, TOTAL TAXES, PAID, WHEN PAID, Number of Receipt, March Settlement 1959, June Settlement 1959, Penalty, November Settlement 1959, Collections to First Monday in January 1960, Delinquent on First Monday in January 1960, Total Delinquent Tax and Penalty, REMARKS. Includes handwritten notes like 'PAID IN FULL' and '57.44 added 6-6-60'.

(Continued Next Page)

This value not included until?

Shady Stores Pine Beach Plainview Beach

Assessment Roll and Tax List of Real Property in the Town of *Hiram*

Indicate Type of Property: R-Residential, C-Commercial, I-Industrial, U-Utility, F-Farm, L-Lakeshore, T-Timber, M-Mineral

Form SCD

Cass County, Minnesota, for Taxes for the Year 1958.

Table with columns for Description of Property, True and Full Valuations, Assessed Valuations (Rural, All Other, Machinery), Total Assessed Value, and Final Equalized Value. Includes handwritten entries for property owners like 'Sinnaus G. + Gladys A. Edstrom' and 'William F. + Hazel E. Knuth'.

Table with columns for Sold for Taxes, Valuations by School Districts, Special Taxes, Total Taxes, PAID, WHEN PAID, Number of Receipt, March Settlement, June Settlement, November Settlement, Collections to First Monday in January 1960, Delinquent on First Monday in January 1960, Total Delinquent Tax and Penalty, and REMARKS. Includes handwritten notes like 'PAID FOR TAXES' and 'PAID IN FULL'.

Shady Stores Pine Beach Plainview Beach ... arranged of lot ... Hiram



Assessment Roll and Tax List of Real Property in the Town of Miami

Indicate Type of Property: R-Residential, C-Commercial, I-Industrial, U-Utility, F-Farm, L-Lakeshore, T-Timber, M-Mineral

Form 300 (1958)

Table with columns: IN WHOSE NAME ASSESSED, TO WHOM TRANSFERRED, DESCRIPTION OF PROPERTY, TRUE AND FULL VALUATIONS, ASSESSED VALUATIONS, and FINAL EQUALIZED VALUE. Includes handwritten entries for Hazel E. Kent, J. R. Mull, Mrs. Oscar Bastrom, etc.

Continued next page

Cass County, Minnesota, for Taxes for the Year 1958.

Table with columns: VALUATIONS BY SCHOOL DISTRICTS AS EQUALIZED BY DEPARTMENT OF TAXATION, SOLD FOR TAXES, SPECIAL TAXES, TOTAL TAXES, PAID, WHEN PAID, Number of Receipt, March Settlement 1959, June Settlement 1959, Penalty, November Settlement 1959, Penalty, Collections to First Monday in January 1960, Delinquent on First Monday in January 1960, Total Delinquent Tax and Penalty, REMARKS. Includes handwritten entries for Hazel E. Kent, J. R. Mull, etc.

Shady Shores Pine Beach Plainview Beach Fringement of Lot 14 around



Assessment Roll and Tax List of Real Property in the Town of Miram

\* Indicate Type of Property: R-Residential, C-Commercial, I-Industrial, U-Utility, F-Farm, L-Lakeshore, T-Timber, M-Mineral

Cass County, Minnesota, for Taxes for the Year 1958.

IN WHOSE NAME ASSESSED	TO WHOM TRANSFERRED	DESCRIPTION OF PROPERTY					TRUE AND FULL VALUATIONS											SOLD FOR TAXES	VALUATIONS BY SCHOOL DISTRICTS AS EQUALIZED BY DEPARTMENT OF TAXATION						PAID	WHEN PAID	Number of Receipt	March Settlement 1959	June Settlement 1959	Penalty	November Settlement 1959	Penalty	Collections to First Monday in January 1960	Penalty	Delinquent on First Monday in January 1960	Total Delinquent Tax and Penalty	REMARKS																		
		SUBDIVISION	Sec. or Lot	Town or Block	Ang.	Number of Acres of Land	LAND Exclusive of Structures and Improvements	BUILDINGS and Other Structures	MACHINERY Permanently Attached to Real Estate	TOTAL True and Full Value	RURAL Homestead Up to \$4,000 20%	RURAL Over \$4,000 and Non-Homestead 33 1/3%	TIMBER Land Class. 1e 20%	ALL OTHER Homestead Up to \$4,000 25%	ALL OTHER Over \$4,000 and Non-Homestead 40%	MACHINERY Permanently Attached to Real Estate 33 1/3%	TOTAL ASSESSED VALUE		Total Assessed Value as Equalized by the Board of Review	FINAL EQUALIZED VALUE	District No.	District Rate	District No.	District Rate														District No.	District Rate	Tax including State Homestead	State Tax on Non-Homestead	SPECIAL TAXES	TOTAL TAXES	Months	Day	Year	\$	cts.	\$	cts.	\$	cts.	\$	cts.	\$
		13 140 31																																																					
Claf & Jennie S. Shirley					3250		no 354	no 1008	R 1362						454		454																																						
Collegiate Presbyterian Church, <u>James</u>					1267		Exempt																																																
R. E. Buchanan,	Walter Barlow				2		no 100	no 281	R 381						127		727																																						
					1		no 49	no 200	R 249						83		83																																						
Jack C. - <u>Walter B. Bodenhofer</u>	W. C. & <u>C. Bodenhofer</u>				3		no 90	no 450	C 798						108		794																																						
		51-17								593	2197				2790	108	750																																						

Shady Shores  
 Pine Beach  
 Plainville Beach  
 Mansack Heights  
 Prussing of Lot  
 Pine Beach  
 Mansack  
 Mansack



Assessment Roll and Tax List of Real Property in the Town of Winona of Minnesota

\* Indicate Type of Property: R-Residential, C-Commercial, I-Industrial, U-Utility, F-Farm, L-Lakeshore, T-Timber, M-Mineral

Table with columns: IN WHOSE NAME ASSESSED, TO WHOM TRANSFERRED, DESCRIPTION OF PROPERTY, TRUE AND FULL VALUATIONS, ASSESSED VALUATIONS, and FINAL EQUALIZED VALUE. Includes entries for Gerald E. Wood, Alfred Wood, A. E. Wood, Anna C. Blanchard, State of Minnesota, Arne & Selma Carlson, Earl A. & Lorraine S. Anderson, Victor Martin, Charles F. & Alice K. Altstatt, Arne & Selma Carlson, Arne Carlson, and State of Minnesota.

(Continued Next Page)

Cass County, Minnesota, for Taxes for the Year 1958.

Table with columns: VALUATIONS BY SCHOOL DISTRICTS AS EQUALIZED BY DEPARTMENT OF TAXATION, TAXES, PAID, WHEN PAID, and REMARKS. Includes entries for SOLD FOR TAXES, PAID IN FULL, and various tax payment dates and amounts.

Handy Stores Pine Beach Plainview Beach





Assessment Roll and Tax List of Real Property in the Town of Huron, Minnesota

Cass County, Minnesota, for Taxes for the Year 1958.

Form SD-1 (1-1-57) MINN. STAT. ANN. § 262.01

Table with columns: IN WHOSE NAME ASSESSED, TO WHOM TRANSFERRED, DESCRIPTION OF PROPERTY, TRUE AND FULL VALUATIONS, ASSESSED VALUATIONS, and FINAL EQUALIZED VALUE. Includes entries for Ernest E. & Lucy L. Patrick, Charles F. & Alice K. Altstadt, Levi C. & Lucille Frederick, Wilbur Olson, John W. & Mildred D. Kessell, Wilbur E. Olson, Jake R. & Alice E. Elisaker, H. W. & Edith M. Jensen, Nelson & C. Soren M. Simonson, State of Minnesota, William J. Lewick, August L. Lewick, Lillian S. Lewick & Belle Joy Lewick, Walters H. Wittte, and William D. & Betty L. Greene.

Table with columns: SOLD FOR TAXES, VALUATIONS BY SCHOOL DISTRICTS AS EQUALIZED BY DEPARTMENT OF TAXATION, Tax Including State Homestead, State Tax on Non-Homestead, SPECIAL TAXES, TOTAL TAXES, PAID, WHEN PAID, Number of Receipt, March Settlement 1959, June Settlement 1959, November Settlement 1959, Collections to First Monday in January 1960, Delinquent on First Monday in January 1960, Total Delinquent Tax and Penalty, and REMARKS. Includes entries for Ernest E. & Lucy L. Patrick, Charles F. & Alice K. Altstadt, Levi C. & Lucille Frederick, Wilbur Olson, John W. & Mildred D. Kessell, Wilbur E. Olson, Jake R. & Alice E. Elisaker, H. W. & Edith M. Jensen, Nelson & C. Soren M. Simonson, State of Minnesota, William J. Lewick, August L. Lewick, Lillian S. Lewick & Belle Joy Lewick, Walters H. Wittte, and William D. & Betty L. Greene.

Shady Shores Pine Beach Plainview Beach Mansfield Barringer Management of Lot 1st & 4th around







1758'

Carlson	W. 104'	104'
Wm. Katz	E. 100' of W. 204'	100'
Zahn	E. 100' of W. 304'	100'
Cocks	E. 100' of W. 404'	100'
Schaffer	E. 100' of W. 504'	100'
Ruibach	E. 100' of W. 604'	100'
Svenson	E. 200' of W. 804'	200'
Kastka	E. 100' of W. 804'	100'
Young	E. 100' of W. 1004'	100'
Jr. F. Katz	E. 100' of W. 1104'	100'
Stokes	E. 100' of W. 1204'	100'
Judith B. Busson	E. 50'	50'

Plot 1 Dec. 18. 140-31

1254'

1584'

1254'

Assessment Roll and Tax List of Real Property in the Town of Miami of Miami

Cass County, Minnesota, for Taxes for the Year 1958.

Indicate Type of Property: R-Residential, C-Commercial, L-Industrial, U-Utility, F-Farm, L-Lakeshore, T-Timber, M-Mineral

Table with columns: IN WHOSE NAME ASSESSED, TO WHOM TRANSFERRED, SUBDIVISION, TRUE AND FULL VALUATIONS (LAND, BUILDINGS, MACHINERY, TOTAL), ASSESSED VALUATIONS (RURAL, ALL OTHER, MACHINERY, TOTAL), and FINAL EQUALIZED VALUE.

Table with columns: SOLD FOR TAXES, VALUATIONS BY SCHOOL DISTRICTS AS EQUALIZED BY DEPARTMENT OF TAXATION, Tax Including State Homestead, State Tax on Non-Homestead, SPECIAL TAXES, TOTAL TAXES, PAID, WHEN PAID, Number of Receipt, March Settlement, June Settlement, November Settlement, Penalty, Collections to First Monday in January 1960, Delinquent on First Monday in January 1960, Total Delinquent Tax and Penalty, REMARKS.

Handy Scores Pine Beach Plainview Beach Parkenack Bathing Parkenack of Lot 15 around 15 around

Neimans  
1958

1584'

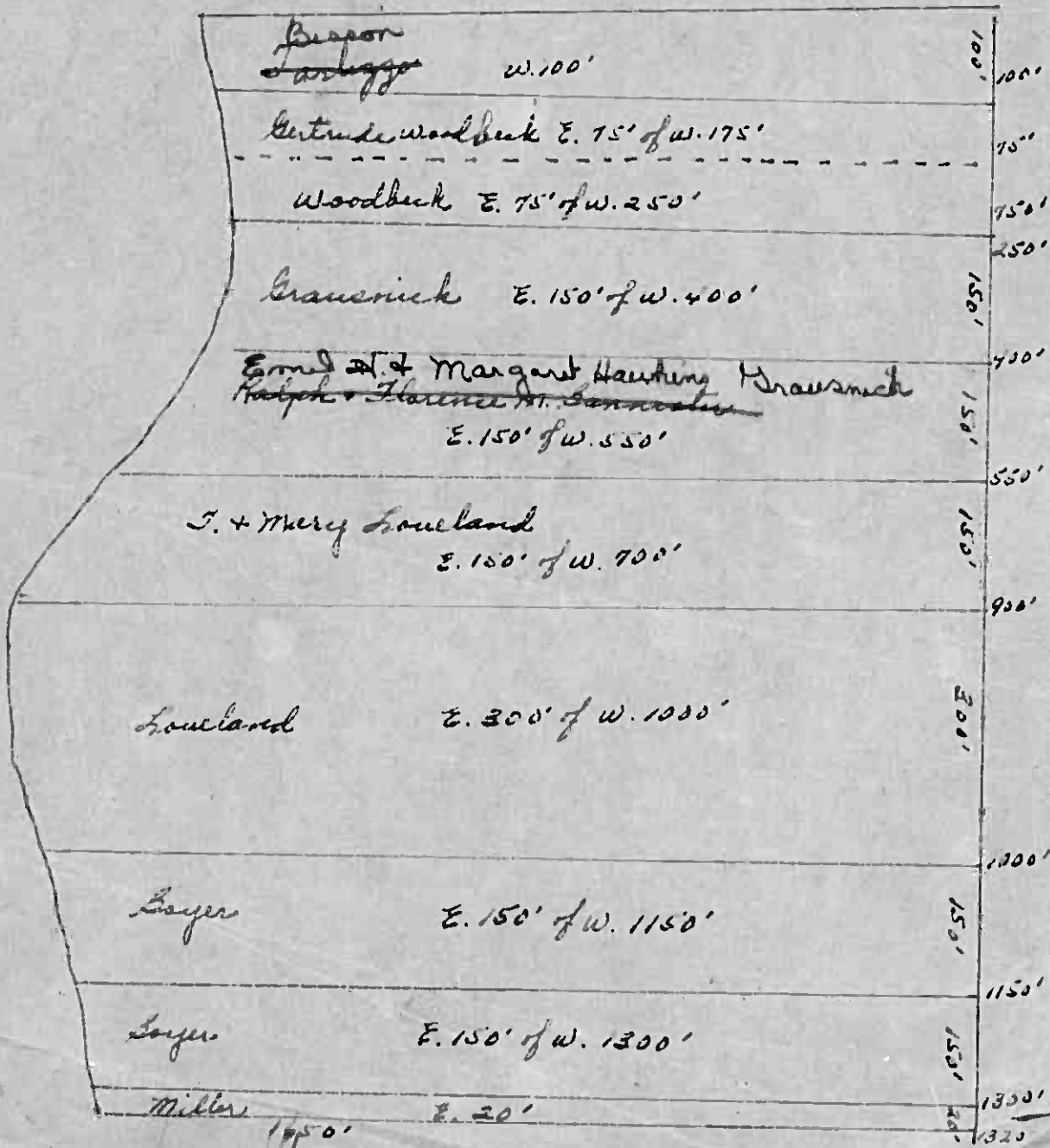
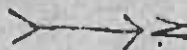

LOT 2 - 18-140-31



Hudson  
1958

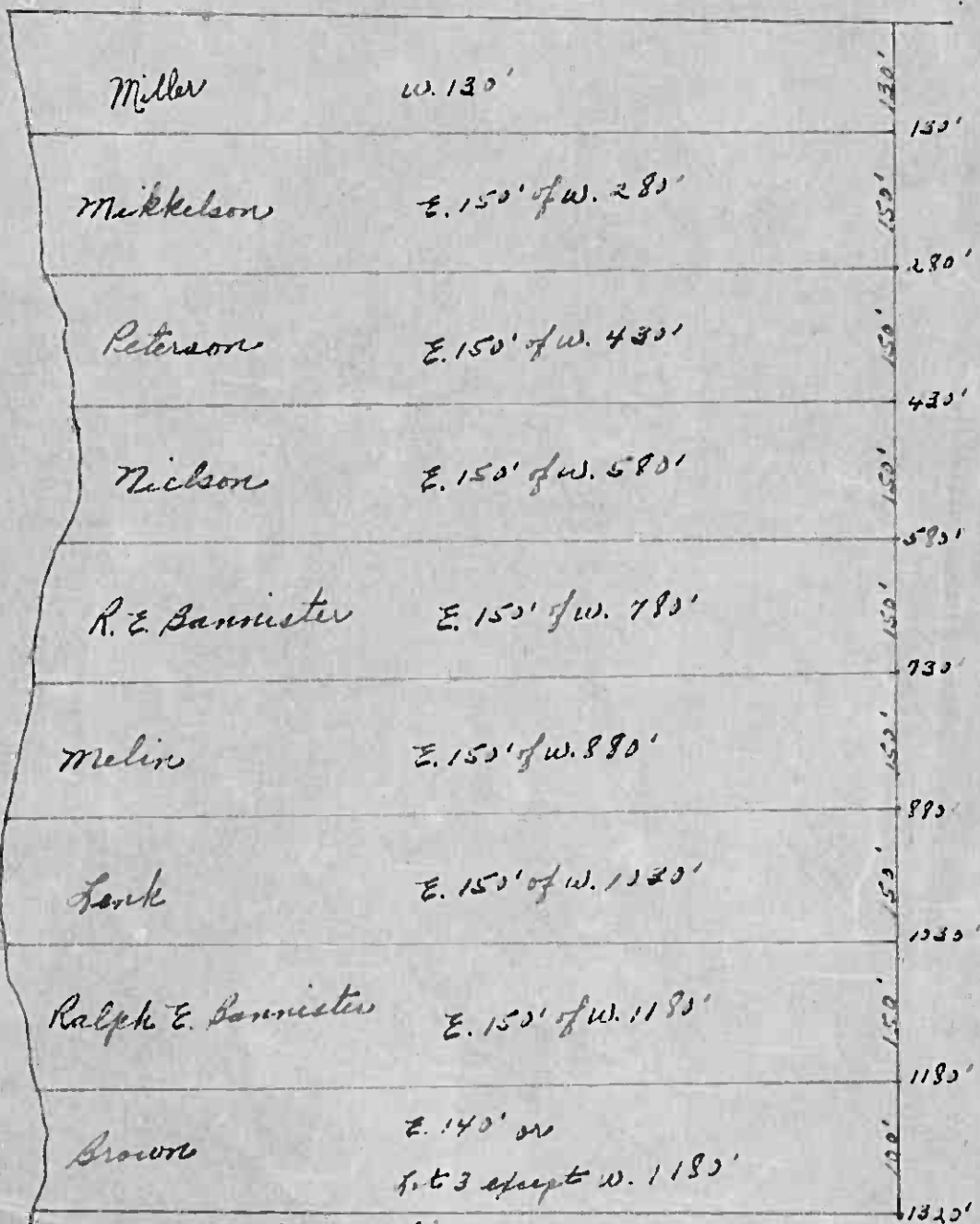

Lot 3  
18-140-31

1617'







Assessment Roll and Tax List of Real Property in the Town of ... of ...

Indicate Type of Property: R-Residential, C-Commercial, I-Industrial, U-Utility, F-Farm, L-Lakeshore, T-Timber, M-Mineral

Cass County, Minnesota, for Taxes for the Year 1958.

IN WHOSE NAME ASSESSED	TO WHOM TRANSFERRED	DESCRIPTION OF PROPERTY					TRUE AND FULL VALUATIONS											FINAL EQUALIZED VALUE	SOLD FOR TAXES	VALUATIONS BY SCHOOL DISTRICTS AS EQUALIZED BY DEPARTMENT OF TAXATION						SPECIAL TAXES	TOTAL TAXES	PAID	WHEN PAID	Number of Receipt	March Settlement 1959	June Settlement 1959	Penalty	November Settlement 1959	Penalty	Collections to First Monday in January 1960	Penalty	Delinquent on First Monday in January 1960	Total Delinquent Tax and Penalty	REMARKS			
		SUBDIVISION	Sec. of Lot	Town or Block	Rng.	Number of Acres of Land	LAND EXCLUSIVE OF IMPROVEMENTS	BUILDINGS AND OTHER STRUCTURES	MACHINERY Permanently Attached to Real Estate	TOTAL True and Full Value	RURAL		ALL OTHER			MACHINERY Permanently Attached to Real Estate	TOTAL ASSESSED VALUE			Total Assessed Value as Equalized by the Board of Review	District No.	District No.	District No.	District No.	District No.																Tax including State Homestead	State Tax on Non-Homestead	
											Homestead Up to \$4,000 20%	Over \$4,000 and Non-Homestead 33 1/4%	Timber Land Class 3c 20%	Homestead Up to \$4,000 25%	Over \$4,000 and Non-Homestead 40%																												MACHINERY Permanently Attached to Real Estate 33 1/4%
Aldrich Johnson																																											
Arne Carlson																																											
" "																																											
Aldrich Johnson																																											
State of Minnesota																																											
Arne & Selma Carlson																																											
State of Minnesota																																											
State of Minnesota																																											
State of Minnesota																																											
State of Minnesota																																											
State of Minnesota																																											
State of Minnesota																																											
State of Minnesota																																											
State of Minnesota																																											
David Peterson																																											
Wilbert Johnson																																											
State of Minnesota																																											
Wilbert Johnson																																											

Madly Shores  
Pine Beach  
Plainview Beach  
Frankenmuth  
Wabasha  
St. Cloud  
Hudson  
Cass County, Minnesota  
First Seasoned



Assessment Roll and Tax List of Real Property in the Town of Hiram

Cass County, Minnesota, for Taxes for the Year 1958.

Form 307

Indicate Type of Property: R-Residential, C-Commercial, I-Industrial, U-Utility, F-Farm, L-Lakeshore, T-Timber, M-Mineral

Main assessment table with columns: IN WHOSE NAME ASSESSED, TO WHOM TRANSFERRED, DESCRIPTION OF PROPERTY, TRUE AND FULL VALUATIONS, ASSESSED VALUATIONS, and FINAL EQUALIZED VALUE.

Tax and payment table with columns: VALUATIONS BY SCHOOL DISTRICTS AS EQUALIZED BY DEPARTMENT OF TAXATION, TAXES, PAID, WHEN PAID, SPECIAL TAXES, TOTAL TAXES, and REMARKS.

Handy Stores Pine Beach Platinview Beach Pine Beach





Assessment Roll and Tax List of Real Property in the Town of Hibbard

Indicate Type of Property: R-Residential, C-Commercial, I-Industrial, U-Utility, F-Farm, L-Lakeshore, T-Timber, M-Mineral

Cass County, Minnesota, for Taxes for the Year 1958.

Table with columns: IN WHOSE NAME ASSESSED, TO WHOM TRANSFERRED, SUBDIVISION, SEC. OR LOT, TOWN OR BLOCK, REG., NUMBER OF ACRES OF LAND, and TRUE AND FULL VALUATIONS (LAND, BUILDINGS, MACHINERY, TOTAL, RURAL, ALL OTHER).

Table with columns: VALUATIONS BY SCHOOL DISTRICTS AS EQUALIZED BY DEPARTMENT OF TAXATION, SOLD TAXES, SPECIAL TAXES, TOTAL TAXES, PAID, WHEN PAID, Number of Receipts, March Settlement, June Settlement, November Settlement, Collections to First Monday in January 1960, Delinquent on First Monday in January 1960, Total Delinquent Tax and Penalty, REMARKS.

Shady Stores Pine Beach Plainview Beach Orange Beach Hibbard 1st and 14th and

Assessment Roll and Tax List of Real Property in the Town of Hiram

Indicate Type of Property: R-Residential, C-Commercial, I-Industrial, U-Utility, F-Farm, L-Lakeshore, T-Timber, M-Mineral

Cass County, Minnesota, for Taxes for the Year 1958.

Table with columns: IN WHOSE NAME ASSESSED, TO WHOM TRANSFERRED, DESCRIPTION OF PROPERTY, TRUE AND FULL VALUATIONS, ASSESSED VALUATIONS, FINAL EQUALIZED VALUE.

Table with columns: SOLD FOR TAXES, VALUATIONS BY SCHOOL DISTRICTS AS EQUALIZED BY DEPARTMENT OF TAXATION, SPECIAL TAXES, TOTAL TAXES, PAID, WHEN PAID, Number of Receipt, March Settlement 1959, June Settlement 1959, November Settlement 1959, Collections to First Monday in January 1960, Delinquent on First Monday in January 1960, Total Delinquent Tax and Penalty, REMARKS.

Shady Stores Pine Beach Plainview Beach arrangement of lot forest 14 standard





Assessment Roll and Tax List of Real Property in the Town of Agram of Stearns County, Minnesota.

Cass County, Minnesota, for Taxes for the Year 1958.

Form SCD 1958-5-16 (REVISED)

\* Indicate Type of Property: R-Residential, C-Commercial, I-Industrial, U-Utility, F-Farm, L-Lakeshore, T-Timber, M-Mineral

Table with columns for IN WHOSE NAME ASSESSED, TO WHOM TRANSFERRED, DESCRIPTION OF PROPERTY, TRUE AND FULL VALUATIONS, ASSESSED VALUATIONS, VALUATIONS BY SCHOOL DISTRICTS AS EQUALIZED BY DEPARTMENT OF TAXATION, TAXES, PAID, WHEN PAID, and REMARKS. Includes handwritten entries for William H. Teering, Paul W. & Luella F. Miller, and Lund M. Peterson.









Assessment Roll and Tax List of Real Property in the Town of Nissau of Minnesota

Indicate Type of Property: R-Residential, C-Commercial, I-Industrial, U-Utility, F-Farm, L-Lakeshore, T-Timber, M-Mineral

Table with columns: IN WHOSE NAME ASSESSED, TO WHOM TRANSFERRED, DESCRIPTION OF PROPERTY (SUBDIVISION, Acres, 100As), TRUE AND FULL VALUATIONS (LAND, BUILDINGS, MACHINERY, TOTAL), ASSESSED VALUATIONS (RURAL, ALL OTHER, MACHINERY, TOTAL ASSESSED VALUE), and FINAL EQUALIZED VALUE.

Cass County, Minnesota, for Taxes for the Year 1958.

Table with columns: SOLID FOR TAXES, VALUATIONS BY SCHOOL DISTRICTS AS EQUALIZED BY DEPARTMENT OF TAXATION (District No., Rate, Mills), Tax including State Homestead, State Tax on Non-Homestead, SPECIAL TAXES, TOTAL TAXES, PAID, WHEN PAID, Number of Receipt, March Settlement 1959, June Settlement 1959, Penalty, November Settlement 1959, Collections to First Monday in January 1960, Delinquent on First Monday in January 1960, Total Delinquent Tax and Penalty, REMARKS.

Low Beach, Sandy Shores, Pine Beach, Plainview Beach, Macintosh, Bathing, Arrangement of Lot, Hurst, 11 around

Assessment Roll and Tax List of Real Property in the Town of Hiram, Minnesota

Cass County, Minnesota, for Taxes for the Year 1958.

Form 507 (MAY 1954 EDITION, MINNAPOLIS) \* Indicate Type of Property: R-Residential, C-Commercial, I-Industrial, U-Utility, F-Farm, L-Lakeshore, T-Timber, M-Mineral

Table with columns: IN WHOSE NAME ASSESSED, TO WHOM TRANSFERRED, DESCRIPTION OF PROPERTY, TRUE AND FULL VALUATIONS, ASSESSED VALUATIONS, and FINAL EQUALIZED VALUE.

Table with columns: VALUATIONS BY SCHOOL DISTRICTS AS EQUALIZED BY DEPARTMENT OF TAXATION, TAXES, PAID, WHEN PAID, and REMARKS.

Shady Shores, Pine Beach, Plainview Beach, Frongmont of Lot 18, Hurst & around

Assessment Roll and Tax List of Real Property in the Town of Hiram

Indicate Type of Property: R-Residential, C-Commercial, I-Industrial, U-Utility, F-Farm, L-Lakeshore, T-Timber, M-Mineral

Cass County, Minnesota, for Taxes for the Year 1958.

Table with columns for 'IN WHOSE NAME ASSESSED', 'TO WHOM TRANSFERRED', 'DESCRIPTION OF PROPERTY', 'TRUE AND FULL VALUATIONS', 'ASSESSED VALUATIONS', and 'FINAL EQUALIZED VALUE'. Includes entries for State of Minnesota and Richard Salminen.

Table for tax details with columns for 'SOLD FOR TAXES', 'VALUATIONS BY SCHOOL DISTRICTS AS EQUALIZED BY DEPARTMENT OF TAXATION', 'TAXES', 'PAID', 'WHEN PAID', and 'REMARKS'. Includes handwritten entries for 'SOLD FOR TAXES' and '1646 X 1778'.

Long Beach, Shady Shores, Pine Beach, Fairview Beach, Hennepin Beach, Management of Lot, Hurst, Itasca



Assessment Roll and Tax List of Real Property in the Town of *Hiram*

Cass County, Minnesota, for Taxes for the Year 1958.

Form 30

Indicate Type of Property: R-Residential, C-Commercial, I-Industrial, U-Utility, F-Farm, L-Lakeshore, T-Timber, M-Mineral

Table with columns: IN WHOSE NAME ASSESSED, TO WHOM TRANSFERRED, SUBDIVISION, TRUE AND FULL VALUATIONS, ASSESSED VALUATIONS, and FINAL EQUALIZED VALUE. Includes property details for Long Beach subdivision.

Table with columns: VALUATIONS BY SCHOOL DISTRICTS AS EQUALIZED BY DEPARTMENT OF TAXATION, TAX, SPECIAL TAXES, TOTAL TAXES, PAID, WHEN PAID, and REMARKS. Includes tax rates and payment dates for various districts.

Long Beach

Sunset Beach

Shady Shores

Pine Beach

Plainview Beach

Hackensack Beach

Franklin Beach

White Pine Beach

Lyndon



Assessment Roll and Tax List of Real Property in the Town of Hiram of Minnesota  
\* Indicate Type of Property: R-Residential, C-Commercial, I-Industrial, U-Utility, F-Farm, L-Lakeshore, T-Timber, M-Mineral

Cass County, Minnesota, for Taxes for the Year 1958.

Table with multiple columns: WHOSE NAME ASSESSED, TO WHOM TRANSFERRED, SUBDIVISION, TRUE AND FULL VALUATIONS (LAND, BUILDINGS, MACHINERY, TOTAL TRUG AND FULL VALUE), ASSESSED VALUATIONS (RURAL, ALL OTHER, MACHINERY ATTACHED TO REAL ESTATE, TOTAL ASSESSED VALUE), VALUATIONS BY SCHOOL DISTRICTS AS EQUALIZED BY DEPARTMENT OF TAXATION, TAXES (SOLD FOR TAXES, District, Rate, etc.), PAID, WHEN PAID, Number of Receipt, March Settlement 1959, June Settlement 1959, Penalty, November Settlement 1959, Collections to First Monday in January 1960, Delinquent on First Monday in January 1960, Total Delinquent Tax and Penalty, REMARKS.









Assessment Roll and Tax List of Real Property in the Town of Hiram

Cass County, Minnesota, for Taxes for the Year 1958.

\* Indicate Type of Property: R-Residential, C-Commercial, I-Industrial, U-Utility, F-Farm, L-Lakeshore, T-Timber, M-Mineral

Table with columns for Property Description, Valuations (True and Full, Assessed), Taxes (SOLD FOR TAXES, VALUATIONS BY SCHOOL DISTRICTS), and Remarks. Includes handwritten entries for Robert H. + Mahel M. Meyer, James W. + Viola Baird, and Peter B. + Alice V. Rasmussen.

Shady Shores

Sunset Beach, White Pine Beach, Plainview Beach, Willsie Fine Beach, Hacksensack's Bathing Beach, Management of Lot, Sunset Beach, Hiram

Assessment Roll and Tax List of Real Property in the Town of Hiram

Cass County, Minnesota, for Taxes for the Year 1958.

Indicate Type of Property: R-Residential, C-Commercial, I-Industrial, U-Utility, F-Farm, L-Lakeshore, T-Timber, M-Mineral

Table with columns: IN WHOSE NAME ASSESSED, TO WHOM TRANSFERRED, SUBDIVISION, TRUE AND FULL VALUATIONS, ASSESSED VALUATIONS, VALUATIONS BY SCHOOL DISTRICTS, SOLD FOR TAXES, SPECIAL TAXES, TOTAL TAXES, PAID, WHEN PAID, Number of Receipt, March Settlement, June Settlement, November Settlement, Collections to First Monday in January 1960, Delinquent on First Monday in January 1960, Total Delinquent Tax and Penalty, REMARKS.

White Pine Beach

Sunset Beach, Beach District on Beach, Addition to Peace, Plainview Beach, Rearrangement of Lot 14 on Pine Beach, Hensack Building, Sunset Beach, Hensack Building

For lot 19 see "Rearrangement of Lot 19"

82 & cancelled - Abated, 7.58 Abated, 1.90 Abated

10.30 Abated

Assessment Roll and Tax List of Real Property in the Town of Louisa of Wisconsin

Cass County, Minnesota, for Taxes for the Year 1958.

Form 5C \* Indicate Type of Property: R-Residential, C-Commercial, I-Industrial, U-Utility, F-Farm, L-Lakeshore, T-Timber, M-Mineral

IN WHOSE NAME ASSESSED	TO WHOM TRANSFERRED	DESCRIPTION OF PROPERTY					TRUE AND FULL VALUATIONS										FINAL EQUALIZED VALUE			
		SUBDIVISION	Sec. of Lot	Town or Block	Number of Acres of Land	No. School District	Indic. Homestead Yes No	Indic. Calc. Val. Yes No	Indic. Type of Property	LAND EXCLUSIVE OF STRUCTURES AND IMPROVEMENTS	BUILDINGS AND OTHER STRUCTURES	MACHINERY PERMANENTLY ATTACHED TO REAL ESTATE	TOTAL True and Full Value	RURAL				TOTAL ASSESSED VALUE	Total Assessed Value as Equalized by the Board of Review	
														Homestead Up to \$4,000 20%	Over \$4,000 and Non-Homestead 33 1/3%	Timber Land Class 3e 20%				Homestead Up to \$4,000 25%
Joe Welsch		Plainview Beach	1				no	no	R	50	910	960	192			192				
Hallie M. & Agnes M. Breckner		Part of Lot 1 Sec. 15-140-31	2				no	no	R	57	366	417		137		137				
Geo. L. Page			3				no	no	LS	57		57		17		17				
"			4				no	no	R	57	177	228		76		76				
William H. Fox			5				yes	no	LS	50		50	10			10				
W. H. Fox			6				yes	no	R	50	395	445	89			89				
Martin & Curwin Horn			7				no	no	R	50	675	825	145			145				
Anna Benesh			8				no	no	R	57	408	465		953		153				
Cesar & Caroline Bakken			9				no	no	LS	57		57		17		17				
"			10				no	no	R	50	379	429		143		143				
			11																	
			12																	
			13																	
			14																	
			15																	
			16																	
			17																	
			18																	
			19																	
			20																	
												500	3310	3815	436	545		981		

SOLD FOR TAXES	VALUATIONS BY SCHOOL DISTRICTS AS EQUALIZED BY DEPARTMENT OF TAXATION						Tax Including State Homestead	State Tax on Non-Homestead	SPECIAL TAXES	TOTAL TAXES	PAID	WHEN PAID	Number of Receipt	March Settlement 1959	June Settlement 1959	Penalty	November Settlement 1959	Penalty	Collections to First Monday in January 1960	Penalty	Delinquent on First Monday in January 1960	Total Delinquent Tax and Penalty	REMARKS		
	District No.	District No.	District No.	District No.	District No.	District No.																			
	Rate	Rate	Rate	Rate	Rate	Rate																			
1																									
2																									
3																									
4																									
5																									
6																									
7																									
8																									
9																									
10																									
11																									
12																									
13																									
14																									
15																									
16																									
17																									
18																									
19																									
20																									
												24978	358		25336										

Plainview Beach, White Pine Beach, Sunset Beach, Deception Beach, Peaceful Shores, Hackensack Beach, Rearrangement of Lot 19 White Pine Beach, Mt. Airy

REMARKS: 8414, 9539, 9529, 8200, 4515

Assessment Roll and Tax List of Real Property in the Town of Hiram, Minnesota

Indicate Type of Property: R-Residential, C-Commercial, I-Industrial, U-Utility, F-Farm, L-Lakeshore, T-Timber, M-Mineral

Table with columns: IN WHOSE NAME ASSESSED, TO WHOM TRANSFERRED, DESCRIPTION OF PROPERTY, TRUE AND FULL VALUATIONS, ASSESSED VALUATIONS, and FINAL EQUALIZED VALUE.

Cass County, Minnesota, for Taxes for the Year 1958.

Table with columns: SOLD FOR TAXES, VALUATIONS BY SCHOOL DISTRICTS AS EQUALIZED BY DEPARTMENT OF TAXATION, State Tax on Non-Homestead, SPECIAL TAXES, TOTAL TAXES, PAID, WHEN PAID, Number of Receipt, March Settlement 1959, June Settlement 1959, Penalty, November Settlement 1959, Collections to First Monday in January 1960, Delinquent on First Monday in January 1960, Total Delinquent Tax and Penalty, REMARKS.









Assessment Roll and Tax List of Real Property in the Town of Hiram

Cass County, Minnesota, for Taxes for the Year 1958.

Form 30 Indicate Type of Property: R-Residential, C-Commercial, I-Industrial, U-Utility, F-Farm, L-Lakeshore, T-Timber, M-Mineral

Table with columns: IN WHOSE NAME ASSESSED, TO WHOM TRANSFERRED, DESCRIPTION OF PROPERTY, TRUE AND FULL VALUATIONS, ASSESSED VALUATIONS, VALUATIONS BY SCHOOL DISTRICTS AS EQUALIZED BY DEPARTMENT OF TAXATION, TAXES, PAID, WHEN PAID, and REMARKS. Includes handwritten entries for Garbisch and Maxmese families.

Shor Sunset, Pine Beach, White Pine Beach, Arvler Beach, Lot Pine Beach, Elmhurst, Fitzhugh

Sungst View, Charlton Beach, 1st Addition to Peaceful Shores, Hackensack Bayshore Beach, Peaceful Valley

Assessment Roll and Tax List of Real Property in the Town of Huron of Huron

Cass County, Minnesota, for Taxes for the Year 1958.

\*Indicate Type of Property: R-Residential, C-Commercial, I-Industrial, U-Utility, F-Farm, L-Lakeshore, T-Timber, M-Mineral

Main table with columns: IN WHOSE NAME ASSESSED, TO WHOM TRANSFERRED, DESCRIPTION OF PROPERTY, TRUE AND FULL VALUATIONS, ASSESSED VALUATIONS, VALUATIONS BY SCHOOL DISTRICTS AS EQUALIZED BY DEPARTMENT OF TAXATION, SOLD FOR TAXES, PAID, WHEN PAID, Number of Receipt, March Settlement 1959, June Settlement 1959, Penalty, November Settlement 1959, Collections to First Monday in January 1960, Delinquent on First Monday in January 1960, Total Delinquent Tax and Penalty, REMARKS.

Vertical text on the left margin: Sunset, Pine Beach, White Pine Beach, Inview Beach, Segment of lot Pine Beach, Elmhurst, and other neighborhood names.

Vertical text on the right margin: Sunset View, Charlton Beach, 1st Addition to Peaceful Shores, Mackensack's Bathing Beach, Peaceful Valley.



Assessment Roll and Tax List of Real Property in the Town of Nisam

Cass County, Minnesota, for Taxes for the Year 1958.

\* Indicate Type of Property: R-Residential, C-Commercial, I-Industrial, U-Utility, F-Farm, L-Lakeshore, T-Timber, M-Mineral

Table with columns: IN WHOSE NAME ASSESSED, TO WHOM TRANSFERRED, SUBDIVISION, TRUE AND FULL VALUATIONS, ASSESSED VALUATIONS, VALUATIONS BY SCHOOL DISTRICTS AS EQUALIZED BY DEPARTMENT OF TAXATION, TAXES, PAID, WHEN PAID, and REMARKS. Includes handwritten entries for various property owners like Anne Frances Buck and various tax amounts.

Vertical text on the left margin: Sunset Beach, Charterton Beach, Envior Beach, Lot Pine Beach, Engagement of Lot Pine Beach, Sunset Beach, and Sunset Beach.

Vertical text on the right margin: Sunset View, Addition to Peaceful Shores, Peaceful Shores, Beckensack, Bathing, Peaceful Valley.

Indicate Type of Property: R-Residential, C-Commercial, I-Industrial, U-Utility, F-Farm, L-Lakeshore, T-Timber, M-Mineral

Table with columns: IN WHOSE NAME ASSESSED, TO WHOM TRANSFERRED, SUBDIVISION, DESCRIPTION OF PROPERTY, TRUE AND FULL VALUATIONS, ASSESSED VALUATIONS, VALUATIONS BY SCHOOL DISTRICTS AS EQUALIZED BY DEPARTMENT OF TAXATION, SOLD FOR TAXES, PAID, WHEN PAID, Number of Receipt, March Settlement, June Settlement, November Settlement, Collections to First Monday in January, Delinquent on First Monday in January, Total Delinquent Tax and Penalty, REMARKS. Includes handwritten entries for Mrs. Blanche Grath, Henry + Alma Buskrentz, Jay E. + Ruth M. Laker, Frank + Jessie Green, George + Lillian F. Weasale, Emma G. Funk, Paul William Mosher, John F. + Alma S. Greer, C. C. Eklund, Floyd E. + Elizabeth Eichorn, Newman J. Nies, Wanda J. Nies, Newman Francis Nies, LaVerne Louis Nies, LaVerne S. Nies.

Sunset Beach, Chertion Beach, Peaceful Shores, Elmhurst, Elmwood, Peaceful Valley

Sunset View, Peaceful Shores, Coushlin B., Hancock's Building, Peaceful Valley

16.70 added - Bureau Rec. 16.70 deducted 4/27/59



Assessment Roll and Tax List of Real Property in the Town of Hiram

Indicate Type of Property: R-Residential, C-Commercial, I-Industrial, U-Utility, F-Farm, L-Lakeshore, T-Timber, M-Mineral

Table with columns: IN WHOSE NAME ASSESSED, TO WHOM TRANSFERRED, SUBDIVISION, TRUE AND FULL VALUATIONS, ASSESSED VALUATIONS, and FINAL EQUALIZED VALUE. Includes handwritten entries for various property owners like Ralph C. & Cora Lee Krbaugh.

Cass County, Minnesota, for Taxes for the Year 1958.

Table with columns: SOLD FOR TAXES, VALUATIONS BY SCHOOL DISTRICTS AS EQUALIZED BY DEPARTMENT OF TAXATION, SPECIAL TAXES, TOTAL TAXES, PAID, WHEN PAID, and REMARKS. Includes handwritten entries for various districts and tax amounts.

Vertical text on the left margin: Sunset View, Chartion Beach, Peaceful Shores, Management of Fine Beach, Elmhurst, and Walnut.

Vertical text on the right margin: Sunset View, 1st Addition to Peaceful Shores, Oughlin B, Hackensack Beach, and Peaceful Valley.









Assessment Roll and Tax List of Real Property in the

Town of *Hiram*

Cass County, Minnesota, for Taxes for the Year 1958.

IN WHOSE NAME ASSESSED		TO WHOM TRANSFERRED		DESCRIPTION OF PROPERTY		No. School District	Indicates Homesteaded	Indicates Aged	Indicates Type of Property	TRUE AND FULL VALUATIONS				ASSESSED VALUATIONS						FINAL EQUALIZED VALUE	SOLD FOR TAXES	VALUATIONS BY SCHOOL DISTRICTS AS EQUALIZED BY DEPARTMENT OF TAXATION						Taxes Including State Homestead	State Tax on Non-Homestead	SPECIAL TAXES	TOTAL TAXES	PAID	WHEN PAID	Number of Receipt	March Settlement 1959	June Settlement 1959	Penalty	November Settlement 1959	Penalty	Collections to First Monday in January 1960	Penalty	Delinquent on First Monday in January 1960	Total Delinquent Tax and Penalty	REMARKS									
Subdivision	Sec. of Lot	Town or Block	Rng.	Number of Acres of Land	Land Exclusion of Structures and Improvements					BUILDINGS and Other Structures	MACHINERY Permanently Attached to Real Estate	TOTAL True and Full Value	RURAL Homestead Up to \$4,000 20%	Over \$4,000 and Non-Homestead 33 1/3%	TIMBER Land Class 3e 20%	ALL OTHER Homestead Up to \$4,000 25%	Over \$4,000 and Non-Homestead 40%	MACHINERY Permanently Attached to Real Estate 33 1/3%	TOTAL ASSESSED VALUE			1st District	2nd District	3rd District	4th District	5th District	6th District																		District Rate	Rate	Rate	Rate	Rate	Rate	Rate	Rate	Rate
<i>William W. &amp; Martha Elsie Wemberly</i>	<i>1</i>	<i>Sunset View</i>	<i>1</i>	<i>1/4 sec 7.50' of 8.80'</i>	<i>No</i>	<i>No</i>	<i>No</i>	<i>R</i>	<i>30</i>	<i>197</i>				<i>197</i>																																							
<i>Ester B. &amp; Mary E. Shepard &amp; Ethel M. James E. Cornell</i>	<i>1</i>	<i>890' of 77.50' of 1</i>			<i>No</i>	<i>No</i>	<i>LS</i>		<i>24</i>	<i>8</i>				<i>8</i>																																							
<i>William W. &amp; Martha Elsie Wemberly</i>	<i>3</i>	<i>2</i>			<i>No</i>	<i>No</i>	<i>LS</i>		<i>21</i>	<i>7</i>				<i>7</i>																																							
<i>Melvin G. &amp; Emily C. Willard</i>	<i>4</i>	<i>3</i>			<i>No</i>	<i>No</i>	<i>LS</i>		<i>21</i>	<i>7</i>				<i>7</i>																																							
<i>Earl B. &amp; Barbara A. Ford</i>	<i>5</i>	<i>4</i>			<i>No</i>	<i>No</i>	<i>LS</i>		<i>21</i>	<i>7</i>				<i>7</i>																																							
<i>Edward E. &amp; Eileen E. Bodenhofer</i>	<i>6</i>	<i>5</i>			<i>No</i>	<i>No</i>	<i>LS</i>		<i>21</i>	<i>7</i>				<i>7</i>																																							
<i>Norman &amp; Betty Ann Bass</i>	<i>7</i>	<i>6</i>			<i>No</i>	<i>No</i>	<i>LS</i>		<i>21</i>	<i>7</i>				<i>7</i>																																							
<i>Lorraine Bodenhofer</i>	<i>8</i>	<i>7</i>			<i>No</i>	<i>No</i>	<i>LS</i>		<i>21</i>	<i>7</i>				<i>7</i>																																							
<i>Lawrence E. &amp; Gertrude Nelson</i>	<i>9</i>	<i>8</i>			<i>No</i>	<i>No</i>	<i>LS</i>		<i>21</i>	<i>7</i>				<i>7</i>																																							
<i>Walter E. &amp; Gertrude Bodenhofer</i>	<i>10</i>	<i>9</i>			<i>No</i>	<i>No</i>	<i>LS</i>		<i>21</i>	<i>7</i>				<i>7</i>																																							
<i>Earl &amp; Barbara Ford</i>	<i>10</i>	<i>10</i>			<i>No</i>	<i>No</i>	<i>LS</i>		<i>21</i>	<i>7</i>				<i>7</i>																																							
	<i>12</i>	<i>11</i>			<i>No</i>	<i>No</i>	<i>LS</i>		<i>21</i>	<i>7</i>				<i>7</i>																																							
	<i>13</i>				<i>No</i>	<i>No</i>	<i>LS</i>		<i>21</i>	<i>7</i>				<i>7</i>																																							
	<i>14</i>																																																				
	<i>15</i>																																																				
	<i>16</i>																																																				
	<i>17</i>																																																				
	<i>18</i>																																																				
	<i>19</i>																																																				
	<i>20</i>																																																				

264 561 825 295

275

275

7002 124

7174

6537

637

Real Estate  
Sunset View  
Chartion Beach  
Peaceful Shores  
Hackettsack Bathing Beach  
Long Pine  
W. Shores  
St. Addition to Peaceful Shores  
Coughlin Beach

80  
St. Addition to Peaceful Shores  
Coughlin Beach  
Long Pine  
W. Shores

Assessment Roll and Tax List of Real Property in the Town of Huron, Minnesota

Cass County, Minnesota, for Taxes for the Year 1958.

Table with columns for Description of Property, True and Full Valuations, Assessed Valuations, Valuations by School Districts, and Tax Information. Includes handwritten notes and calculations.

Peaceful Shores, 1st Addition to Peaceful Shores, Peaceful Shores, 1st Addition to Peaceful Shores, Peaceful Shores, 1st Addition to Peaceful Shores, Peaceful Shores, 1st Addition to Peaceful Shores, Peaceful Shores, 1st Addition to Peaceful Shores, Peaceful Shores, 1st Addition to Peaceful Shores, Peaceful Shores, 1st Addition to Peaceful Shores

Coughlin Beach, Long Pine, W. Shores Trp. Mile





Assessment Roll and Tax List of Real Property in the Town of Hiram

Cass County, Minnesota, for Taxes for the Year 1958.

Table with columns: IN WHOSE NAME ASSESSED, TO WHOM TRANSFERRED, DESCRIPTION OF PROPERTY, TRUE AND FULL VALUATIONS, ASSESSED VALUATIONS, VALUATIONS BY SCHOOL DISTRICTS AS EQUALIZED BY DEPARTMENT OF TAXATION, TAXES, PAID, WHEN PAID, SPECIAL TAXES, TOTAL TAXES, MARCH SETTLEMENT, JUNE SETTLEMENT, PENALTY, NOVEMBER SETTLEMENT, COLLECTIONS TO FIRST MONDAY IN JANUARY 1960, DELINQUENT ON FIRST MONDAY IN JANUARY 1960, TOTAL DELINQUENT TAX AND PENALTY, REMARKS.









