

ASSESSMENT & TAX LIST

Hiram

1943

NAME OF OWNER

Treasurer's Office, Cass County, Minnesota

RECEIVED this, the first Monday (being the 3rd) day of January, A. D. 1944, of S. G. Peterson, Auditor of said County, Minnesota, the Tax List of all Taxable Real and Personal Property in the Township of Hiram in said County for the year A. D. 1943, as specified above and amounting to six thousand three hundred eighty five and $\frac{79}{100}$ dollars.

W. J. McKeown
County Treasurer.

Office of County Treasurer, Cass County, Minnesota

To S. G. Peterson, County Auditor:

Sir:—I herewith return to you the Tax List for the Township of Hiram in said County for the year 1943, heretofore received from you. I certify that I have compared the same with the duplicate receipts in your office, and have written opposite the amount of each tax so received the words "First Quarter Paid", "Second Quarter Paid", "Third Quarter Paid" or "Paid in full" as the case may be, and the number of my receipt given in discharge of said tax, and each tract or lot of real property against which the taxes remain unpaid is delinquent for said year.

Yours respectfully,
W. J. McKeown
County Treasurer.

Auditor's Office, Cass County, Minnesota

I, _____ Auditor of said County, and State of Minnesota, do hereby certify that the following is a correct list of the Taxes levied on the Real and Personal Property in the _____ of _____ for the year 1943.

WITNESS my hand and official seal, the _____ day of _____ 1944.

(SEAL) _____
County Auditor.

Auditor's Office, Cass County, Minnesota

I hereby certify that on the first Monday in January 1943, I received of _____ County Treasurer, the Tax List of the _____ of _____ in said County for the year 1943; that I have compared the said list with the Statements received for by said Treasurer, which are on file in my office, and that each tract or lot of real property therein against which the taxes, or any part thereof, remains unpaid are delinquent for said year.

(SEAL) _____
County Auditor.

Assessor's

COLLECTIONS OF TAXES OF 1913, Township of Hiram, CASS COUNTY, MINNESOTA

FORM 34

NAME OF OWNER

FUNDS	MARCH SETTLEMENT 1913	JUNE SETTLEMENT 1913	NOV. SETTLEMENT 1913	Amount Collected from Nov. 1st 1912 to First Monday 1st 1913	REDUCTIONS	Projected Cancellations	Total Reductions and Collected	BALANCE UNCOLLECTED	ADDITIONS	Total Uncollected to First Monday in January, 1913
State Revenue, State School, Teachers Insurance, State Debt—Non-Homestead, State Debt—Homestead,	2504 812	5637 2232	1510 671	35 19						
County Revenue, County Road and Bridge, County Welfare, County Bond and Interest, <i>Sever</i>	14688 3046 23824 13131 406	40265 8371 65477 26087 1116	12114 2512 14651 10831 335	322 67 523 288 09						
Town Revenue, Town Road and Bridge, Town Drag, Town State Loan,	3384 8790 677	9300 24182 1860	2771 7257 557	74 193 5						
School Local 1 Mill, School Special, School State Loan, <i>Deficiency</i> <i>B. J.</i>	678 22005 6768 6768 5414 2030	1860 53316 18602 18602 14880 5580	558 14569 5582 5583 4466 1674	15 574 148 148 119 45						
Money and Credits										
	114934	307467	90743	2594	13880	17430			3934	96460

School District No.	LOCAL 1 MILL.	SPECIAL	STATE LOAN	Deficiency	B. J.	TOTALS
MARCH SETTLEMENT	252 425	5068 16927	2524 4234	2524 4234	2027 3387	760 1270
Totals	678	22005	6768	6768	5414	2030
JUNE SETTLEMENT	1054 806	21090 32226	10545 8057	10545 8057	8435 6445	2163 2417
Totals	1860	53316	18602	18602	14880	5580
NOVEMBER SETTLEMENT						112840
NOVEMBER to JANUARY	15	574	148	148	119	45
Totals	15	574	148	148	119	45
ADDITIONS						2594
Totals						2594
REDUCTIONS						
Totals						

Assessment Roll and Tax List of Unplatted Real Property in the of Cass County, Minnesota, for Taxes for the Year 1943.

Cass County, Minnesota, for Taxes for the Year 1943.

Table with columns: IN WHOSE NAME ASSESSED, TO WHOM TRANSFERRED, DESCRIPTION OF PROPERTY, ASSESSOR'S VALUATION, EQUALIZED VALUES, VALUATIONS BY SCHOOL DISTRICTS AS EQUALIZED BY DEPARTMENT OF TAXATION, SPECIAL TAXES, TOTAL GENERAL TAX, PAID, WHEN PAID, Number of Receipt, March Settlement 1944, June Settlement 1944, Penalty, November Settlement 1944, Penalty, Collections to First Monday in January 1945, Penalty, Delinquent on First Monday in January 1945, Total Delinquent Tax and Penalty, REMARKS.

Assessment Roll and Tax List of Unplatted Real Property in the of Cass County, Minnesota, for Taxes for the Year 1943.

Table with columns: IN WHOSE NAME ASSESSED, TO WHOM TRANSFERRED, DESCRIPTION OF PROPERTY, ASSESSOR'S VALUATION, EQUALIZED VALUES, VALUATIONS BY SCHOOL DISTRICTS AS EQUALIZED BY DEPARTMENT OF TAXATION, Rate and Tax Less Homestead Exemption, State Tax on Non-Homestead, TOTAL GENERAL TAX, SPECIAL TAXES, TOTAL TAXES, PAID, WHEN PAID, Number of Receipt, March Settlement 1944, June Settlement 1944, Penalty, November Settlement 1944, Penalty, Collections to First Monday in January 1945, Delinquent on First Monday in January 1945, Total Delinquent Tax and Penalty, REMARKS.

Assessment Roll and Tax List of Unplatted Real Property in the of Cass County, Minnesota, for Taxes for the Year 1943.

Table with columns: IN WHOSE NAME ASSESSED, TO WHOM TRANSFERRED, DESCRIPTION OF PROPERTY, ASSESSOR'S VALUATION, EQUALIZED VALUES, VALUATIONS BY SCHOOL DISTRICTS AS EQUALIZED BY DEPARTMENT OF TAXATION, SPECIAL TAXES, TOTAL TAXES, PAID, WHEN PAID, Number of Receipt, March Settlement 1941, June Settlement 1941, Penalty, November Settlement 1941, Penalty, Collections to First Monday in January 1945, Penalty, Delinquent on First Monday in January 1945, Total Delinquent Tax and Penalty, REMARKS.

Assessment Roll and Tax List of Unplatted Real Property in the of Cass County, Minnesota, for Taxes for the Year 1943.

Table with columns: IN WHOSE NAME ASSESSED, TO WHOM TRANSFERRED, DESCRIPTION OF PROPERTY, ASSESSOR'S VALUATION, EQUALIZED VALUES, VALUATIONS BY SCHOOL DISTRICTS AS EQUALIZED BY DEPARTMENT OF TAXATION, Rate and Tax Less Homestead Exemption, State Tax on Non-Homestead, TOTAL GENERAL TAX, SPECIAL TAXES, TOTAL TAXES, PAID, WHEN PAID, Number of Receipt, March Settlement 1941, June Settlement 1944, Penalty, November Settlement 1944, Penalty, Collections to First Monday in January in 1945, Penalty, Delinquent on First Monday in January in 1945, Total Delinquent Tax and Penalty, REMARKS.

Roy C Murray

Chas. Murray

Mary A. Horsfall

Everett + Lucille Laugham

Fred + Minnie Schweibert

Leabelle H. Johnstone

Victor E. Marton

State of Minnesota (Cont to Wilbert Johnson)

Victor E. Marton

State of Minnesota

Adam M. Smith + Helen Barigues Smith

Victor E. Marton

Leabelle H. Johnstone

1468

Assessment Roll and Tax List of Unplatted Real Property in the _____ of _____
Unplatted Real Estate Assessed at 33 1/2 Per Cent of True and Full Value; Attached Machinery at 33 1/2 Per Cent of True and Full Value; Homesteads, up to True and Full Value of \$4000, Assessable at 20 per Cent, Class 3B; Remainder at 33 1/2 Per Cent, Class 3.

Form 4 CD (MAY 1935 EDITION)

IN WHOSE NAME ASSESSED	TO WHOM TRANSFERRED	DESCRIPTION OF PROPERTY				No. School District	Indicate Homestead	ASSESSOR'S VALUATION						EQUALIZED VALUES			SOLD FOR TAXES		
		SUBDIVISION	Sec. or Lot	Town or Block	Range			Number of Acres of Land	True and Full Value of Land and Improvements	STRUCTURES & IMPROVEMENTS		Total True and Full Value of Land Including all Structures, Improvements and Machinery	Assessed Value of Homesteads up to \$4,000 at 20 per cent Class 3B	Assessed Value of Remainder at 33 1/2 per cent Class 3	Total Assessed Value of Land Including all Structures, Improvements and Machinery	Total Assessed Value as Equalized by the Board of Review		Total Assessed Value as Equalized by the County Board	Total Assessed Value as Equalized by the Department of Taxation
										Dollars	Dollars								
State of Minnesota		1	NE 1/4 of NE 1/4	20	40	31													
State of Minnesota		2	NW 1/4 of NE 1/4																
Byron Silvers		3	SW 1/4 of NE 1/4		40														
State of Minnesota		4	SE 1/4 of NE 1/4																
		5																	
Byron Silvers		6	NE 1/4 of NW 1/4		40														
Chas. H. Hood & Belle Hood		7	NW 1/4 of NW 1/4		40														
"		8	SW 1/4 of NW 1/4		40														
Byron Silvers		9	SE 1/4 of NW 1/4		40														
		10																	
Jerry & Amelia Kramer		11	NE 1/4 of SW 1/4		40														
"		12	NW 1/4 of SW 1/4		40														
"		13	SW 1/4 of SW 1/4		40														
State of Minnesota		14	SE 1/4 of SW 1/4																
		15																	
State of Minnesota		16	NE 1/4 of SE 1/4																
Byron Silvers		17	NW 1/4 of SE 1/4		40														
State of Minnesota		18	SW 1/4 of SE 1/4																
State of Minnesota		19	SE 1/4 of SE 1/4																
		20																	

360

Cass County, Minnesota, for Taxes for the Year 1943.

VALUATIONS BY SCHOOL DISTRICTS AS EQUALIZED BY DEPARTMENT OF TAXATION	Rate and Tax Less Homestead Exemption	State Tax on Non-Homestead	TOTAL GENERAL TAX	SPECIAL TAXES					TOTAL TAXES	PAID	WHEN PAID	Number of Receipts	March Settlement 1944	June Settlement 1944	November Settlement 1944	Penalty	Collections to First Monday in January 1945	Penalty	Delinquent on First Monday in January 1945	Total Delinquent Tax and Penalty	REMARKS
				District No.	District No.	District No.	District No.	District No.													
				Rate	Rate	Rate	Rate	Rate													
1																					
2																					
3	67		1030	28			1058			PAID IN FULL MAR 6 1944	2245	1058									
4																					
5																					
6	67		1030	28			1058			PAID IN FULL MAR 6 1944	2245	1058									
7	87		1336	36			1372														
8	87		1336	36			1372													1372	
9	67		1030	28			1058			PAID IN FULL MAR 6 1944	2245	1058									
10																					
11	61		936				936			PAID IN FULL MAR 6 1944	2245	1892									
12	61		936				936			PAID IN FULL MAR 6 1944											
13	61		936				936			PAID IN FULL MAY 29 1946	5330	936									
14																					
15																					
16																					
17	67		1030	28			1058			PAID IN FULL MAR 6 1944	2245	1058									
18																					
19																					
20																					

183
442
625

9600 184

9784

2744

Assessment Roll and Tax List of Unplatted Real Property in the of Cass County, Minnesota, for Taxes for the Year 1943.

Form 4 CD

Cass County, Minnesota, for Taxes for the Year 1943.

Table with columns: IN WHOSE NAME ASSESSED, TO WHOM TRANSFERRED, DESCRIPTION OF PROPERTY, ASSESSOR'S VALUATION, EQUALIZED VALUES, VALUATIONS BY SCHOOL DISTRICTS AS EQUALIZED BY DEPARTMENT OF TAXATION, SPECIAL TAXES, TOTAL GENERAL TAX, PAID, WHEN PAID, Number of Receipt, March Settlement 1944, June Settlement 1944, Penalty, November Settlement 1944, Penalty, Collection to First Monday in January 1945, Penalty, Delinquent on First Monday in January 1945, Total Delinquent Tax and Penalty, REMARKS.

State of Minnesota 1 NE 1/4 of NE 1/4 21 140 31

Albert Majerus 2 NW 1/4 of NE 1/4 40

State of Minnesota 3 SW 1/4 of NE 1/4

State of Minnesota 4 SE 1/4 of NE 1/4

State of Minnesota 5

State of Minnesota 6 NE 1/4 of NW 1/4

State of Minnesota 7 NW 1/4 of NW 1/4

State of Minnesota 8 SW 1/4 of NW 1/4

State of Minnesota 9 SE 1/4 of NW 1/4

State of Minnesota 10

State of Minnesota 11 NE 1/4 of SW 1/4

Herbert Johnson 12 NW 1/4 of SW 1/4 40

State of Minnesota 13 SW 1/4 of SW 1/4

State of Minnesota 14 SE 1/4 of SW 1/4

State of Minnesota 15

State of Minnesota 16 NE 1/4 of SE 1/4

State of Minnesota 17 NW 1/4 of SE 1/4

State of Minnesota 18 SW 1/4 of SE 1/4

State of Minnesota 19 SE 1/4 of SE 1/4

State of Minnesota 20

80

N.W. 146

2244 60

2304

PAID IN FULL JUN 22 1944 6575

PAID IN FULL JUN 1 1944 5411

Assessment Roll and Tax List of Unplatted Real Property in the _____ of _____
Unplatted Real Estate Assessed at 33 1/2 Per Cent of True and Full Value; Attached Machinery at 33 1/2 Per Cent of True and Full Value. Homesteads, up to True and Full Value of \$4000. Assessable at 20 per Cent, Class 3B; Remainder at 33 1/2 Per Cent, Class 3.

Form 4 CD

IN WHOSE NAME ASSESSED	TO WHOM TRANSFERRED	DESCRIPTION OF PROPERTY				No. School District	Indicate Homestead	ASSESSOR'S VALUATION					EQUALIZED VALUES			SOLD FOR TAXES	
		SUBDIVISION	Sec. or Lot	Town or Block	Number of Acres of Land			True and Full Value of Land Exclusive of Structures and Improvements	STRUCTURES & IMPROVEMENTS		Total True and Full Value of Land Including all Structures, Improvements and Machinery	Assessed Value of Homesteads up to \$4,000 at 20 per cent Class 3B	Assessed Value of Remainder at 33 1/2 per cent Class 3	Total Assessed Value as Equalized by the Board of Review	Total Assessed Value as Equalized by the County Board		Total Assessed Value as Equalized by the Department of Taxation
									True and Full Value of Buildings and Other Structures	True and Full Value of Machinery Permanently Attached to Real Estate							
William H. Dering	State of Minnesota	N E 1/4 of N E 1/4	30	140 31	40												
	State of Minnesota	N W 1/4 of N E 1/4															
William H. Dering		S W 1/4 of N E 1/4															
		S E 1/4 of N E 1/4 less 1 ac. school			39												
	State of Minnesota	N E 1/4 of N W 1/4															
	State of Minnesota	N W 1/4 of N W 1/4	Lot 1														
	State of Minnesota - Dept. Rur. Cr.	S W 1/4 of N W 1/4	" 2														
	State of Minnesota - Dept. Rur. Cr.	S E 1/4 of N W 1/4															
Walter R. Hoopman		N E 1/4 of S W 1/4			40												
"		N W 1/4 of S W 1/4	" 3		39 98												
State of Minnesota		S W 1/4 of S W 1/4	" 4														
"		S E 1/4 of S W 1/4			40												
State of Minnesota (Cont to Herman Kestner)		N E 1/4 of S E 1/4			40												
Federal Land Bank, St Paul, Florence & Walter R. Hoopman		N W 1/4 of S E 1/4			40												
"		" S W 1/4 of S E 1/4			40												
"		" S E 1/4 of S E 1/4			40												
					358 98												

SOLD FOR TAXES date 3-30-68

Cass County, Minnesota, for Taxes for the Year 1943.

VALUATIONS BY SCHOOL DISTRICTS AS EQUALIZED BY DEPARTMENT OF TAXATION	Rate and Tax Less Homestead Exemption	State Tax on Non-Homestead	TOTAL GENERAL TAX	SPECIAL TAXES								TOTAL TAXES	PAID	WHEN PAID	Number of Receipt	March Settlement 1944	June Settlement 1944	Penalty	November Settlement 1944	Penalty	Collections to First Monday in January 1945	Penalty	Delinquent on First Monday in January 1945	Total Delinquent Tax and Penalty	REMARKS							
				District No.	District No.	District No.	District No.	District No.	District No.	District No.	District No.																					
				Rate	Rate	Rate	Rate	Rate	Rate	Rate	Rate																					
1	87		1336 36										1372	1	PAID IN FULL	MAR 8 1944	2366	1372														
2														2																		
3														3																		
4	85		1306 36											4	PAID IN FULL	MAR 8 1944	2366	1342														
5														5																		
6														6																		
7														7																		
8														8																		
9														9																		
10														10																		
11	61		936											11	2nd Half Paid	OCT 24 1944	10406															
12	61		936											12	1st Half Paid	MAY 4 1944	4205	936			936											
13														13																		
14	108		1658											14	2nd Half Paid	OCT 24 1944	10406															
15														15	1st Half Paid	MAY 4 1944	4205	829			829											
16	714		1136											16	2nd Half Paid	OCT 24 1944	10406															
17	87		1336											17	1st Half Paid	MAY 4 1944	4205	568			568											
18	87		1336											18	2nd Half Paid	OCT 24 1944	10406															
19	87		1336											19	1st Half Paid	MAY 4 1944	4205	2058			2058											
20	330		12084											20	2nd Half Paid	OCT 24 1944	10406															
	557																															
	787																															

8.20 abated

Assessment Roll and Tax List of Unplatted Real Property in the of Cass County, Minnesota, for Taxes for the Year 1943.

Table with columns: IN WHOSE NAME ASSESSED, TO WHOM TRANSFERRED, DESCRIPTION OF PROPERTY, ASSESSOR'S VALUATION, EQUALIZED VALUES, VALUATIONS BY SCHOOL DISTRICTS AS EQUALIZED BY DEPARTMENT OF TAXATION, Rate and Tax Less Homestead Exemption, State Tax on Non-Homestead, TOTAL GENERAL TAX, SPECIAL TAXES, PAID, WHEN PAID, Number of Receipt, March Settlement 1944, June Settlement 1944, Penalty, November Settlement 1944, Penalty, Collections to First Monday in January 1945, Penalty, Delinquent on First Monday in January 1945, Total Delinquent Tax and Penalty, REMARKS.

State of Minnesota 1 N E 1/4 of N E 1/4 36 1/4 31
State of Minnesota 2 N W 1/4 of N E 1/4
State of Minnesota 3 S W 1/4 of N E 1/4
State of Minnesota 4 S E 1/4 of N E 1/4
5
State of Minnesota 6 N E 1/4 of N W 1/4
State of Minnesota 7 N W 1/4 of N W 1/4
State of Minnesota 8 S W 1/4 of N W 1/4
State of Minnesota 9 S E 1/4 of N W 1/4

Magnus M. Craff State of Minnesota 11 N E 1/4 of S W 1/4 40
State of Minnesota 12 N W 1/4 of S W 1/4 40
State of Minnesota 13 S W 1/4 of S W 1/4
Magnus M. Craff State of Minnesota 14 S E 1/4 of S W 1/4 40

State of Minnesota 16 N E 1/4 of S E 1/4
State of Minnesota 17 N W 1/4 of S E 1/4
State of Minnesota 18 S W 1/4 of S E 1/4

State of Minnesota 19 S E 1/4 of S E 1/4 6.1167 acs. of SE 1/4 SE 1/4
David S. Bunke 20 28.33 acs. of SE 1/4 SE 1/4 28 33
148 33
Total Acreage 7139 40

11 73 1122 30 1152 11 } For. to State 1152 Come
12 73 1122 30 1152 12 }
13
14 73 1122 30 1152 14 } For. to State 1152 Come
15
16
17
18
19
20 62 952 76 978 20
74.381 4318 114 978
76809 351394 6720 4134
73875 358114

Assessment Roll and Tax List of Platted Real Property in the of Cass County, Minnesota, for Taxes for the Year 1943.

Table with columns: IN WHOSE NAME ASSESSED, TO WHOM TRANSFERRED, DESCRIPTION OF PROPERTY, ASSESSOR'S VALUATION, EQUALIZED VALUES, VALUATIONS BY SCHOOL DISTRICTS AS EQUALIZED BY DEPARTMENT OF TAXATION, SPECIAL TAXES, PAID, WHEN PAID, Number of Receipt, March Settlement 1944, June Settlement 1944, November Settlement 1944, Collections to First Monday in January 1945, Delinquent on First Monday in January 1945, Total Delinquent Tax and Penalty, REMARKS.

Jean E. Sigveland
M.B. + Lou Lathrop

Long Beach
Lots 1-4

M.B. Lathrop
M.B. + Lou Mae Lathrop

Lots 5-10 incl
" 1-8 "

Julia Danville

That part of Blk. 3, Plat of Long Beach, lying n. of center line of lot 17, Blk. 3, Plat of Long Beach, as extended to the E. line of said Blk. 3.

Benton C. Ford

Lot 1 - Blk 3

SOLD FOR TAXES
SOLD FOR TAXES

74234

4064 96

4160

Assessment Roll and Tax List of Platted Real Property in the of Cass County, Minnesota, for Taxes for the Year 1943.

Table with columns: IN WHOSE NAME ASSESSED, TO WHOM TRANSFERRED, DESCRIPTION OF PROPERTY, ASSESSOR'S VALUATION, EQUALIZED VALUES, VALUATIONS BY SCHOOL DISTRICTS AS EQUALIZED BY DEPARTMENT OF TAXATION, Rate and Tax Less Homestead Exemption, State Tax on Non-Homestead, TOTAL GENERAL TAX, SPECIAL TAXES, TOTAL TAXES, PAID, WHEN PAID, Number of Receipt, March Settlement 1944, June Settlement 1944, Penalty, November Settlement 1944, Collections to First Monday in January 1945, Delinquent on First Monday in January 1945, Total Delinquent Tax and Penalty, REMARKS.

H. P. Juanita Kilander Mrs. Mrs. A. B. Hertzman

Mrs. Julia Aasen

Katherine J. Hartzell

R. P. Johnson Katherine J. Hartzell

Katherine J. Hartzell

John A. Mull

Mabel Sigeland Margaret M. & Jane A. Mull

Joe & Sigeland

Mrs. M. Berry

Claude & Margaret Sheldon

White Pine Beach Part of Lot 2 - Sec. 14 - 140-31

House Johnson

House Johnson

For Lot 19 see Rearrangement of Lot 19 - Page 12

JUN 16 1944

JUN 10 1944

JAN 17 1944

JAN 17 1944

JAN 17 1944

JAN 17 1944

JAN 17 1944

JAN 17 1944

MAY 11 1944

MAY 11 1944

JUN 22 1944

FEB 15 1944

FEB 15 1944

MAY 29 1944

MAY 29 1944

JUN 16 1944

JUN 12 1944

PAID IN FULL

PAID IN FULL

PAID IN FULL

PAID IN FULL

PAID IN FULL

PAID IN FULL

PAID IN FULL

PAID IN FULL

PAID IN FULL

PAID IN FULL

PAID IN FULL

PAID IN FULL

PAID IN FULL

PAID IN FULL

PAID IN FULL

PAID IN FULL

PAID IN FULL

6584

6104

261

7986

4337

7158

1225

21260

5314

6250

5699

1940

1940

352

1014

178

178

Stamond

Sea Hall

Smest Beach

White Fire Beach

White Fire Beach

White Fire Beach

Assessment Roll and Tax List of Platted Real Property in the of Cass County, Minnesota, for Taxes for the Year 1943.

Table with columns: IN WHOSE NAME ASSESSED, TO WHOM TRANSFERRED, DESCRIPTION OF PROPERTY, ASSESSOR'S VALUATION, EQUALIZED VALUES, VALUATIONS BY SCHOOL DISTRICTS AS EQUALIZED BY DEPARTMENT OF TAXATION, Rate and Tax Less Homestead Exemption, State Tax on Non-Homestead, TOTAL GENERAL TAX, SPECIAL TAXES, TOTAL TAXES, PAID, WHEN PAID, Number of Receipt, March Settlement 1944, June Settlement 1944, November Settlement 1944, Penalty, Collections to First Monday in January 1945, Delinquent on First Monday in January 1945, Total Delinquent Tax and Penalty, REMARKS.

Joe Velech
Clarence Fox
Geo. D. Page, Jr. Res. S. + Clara B. Pages
Geo. L. Page
Chas. L. Page
Frank A. Bigelow W.H. Fry
Margaret Carlsson
George Benish
Christina McPhillip
Oscar B. + Caroline Babben

Plainville Beach
Part of Lot 1 - Sec. 15 - 140. 3A

SOLD FOR TAXES

4 116
7 116
654

11356 1224

11580

Strom

Sea Hall

Sunset Beach

White Pine Beach

Lot 19 on Beach

Assessment Roll and Tax List of Platted Real Property in the of

Cass County, Minnesota, for Taxes for the Year 1943.

Table with columns: IN WHOSE NAME ASSESSED, TO WHOM TRANSFERRED, DESCRIPTION OF PROPERTY, ASSESSOR'S VALUATION, EQUALIZED VALUES, SOLD FOR TAXES. Includes handwritten entries like 'Nels Anfelt' and 'The Ice Hall'.

Table with columns: VALUATIONS BY SCHOOL DISTRICTS AS EQUALIZED BY DEPARTMENT OF TAXATION, Rate and Tax Less Homestead Exemption, State Tax on Non-Homestead, TOTAL GENERAL TAX, SPECIAL TAXES, TOTAL TAXES, PAID, WHEN PAID, Number of Receipt, March Settlement 1944, June Settlement 1944, November Settlement 1944, Collections to First Monday in January 1945, Delinquent on First Monday in January 1945, Total Delinquent Tax and Penalty, REMARKS. Includes handwritten notes like 'Abatement # 2491' and 'Refund with 76297'.

Assessment Roll and Tax List of Platted Real Property in the of Cass County, Minnesota, for Taxes for the Year 1943.

Cass County, Minnesota, for Taxes for the Year 1943.

Table with columns: IN WHOSE NAME ASSESSED, TO WHOM TRANSFERRED, DESCRIPTION OF PROPERTY, ASSESSOR'S VALUATION, EQUALIZED VALUES, VALUATIONS BY SCHOOL DISTRICTS AS EQUALIZED BY DEPARTMENT OF TAXATION, Rate and Tax Less Homestead Exemption, State Tax on Non-Homestead, TOTAL GENERAL TAX, SPECIAL TAXES, TOTAL TAXES, PAID, WHEN PAID, Number of Receipt, March Settlement 1944, June Settlement 1944, Penalty, November Settlement 1944, Penalty, Collections to First Monday in January 1945, Penalty, Delinquent on First Monday in January 1945, Total Delinquent Tax and Penalty, REMARKS.

Nils Angfeldt

The Sea Hall

Abatement #2491

2140-65 Refund #76692 1/4/45

10.80 rec'd
10.80 abated

SHINGOBEE TOWNSHIP
HIRAM TOWNSHIP

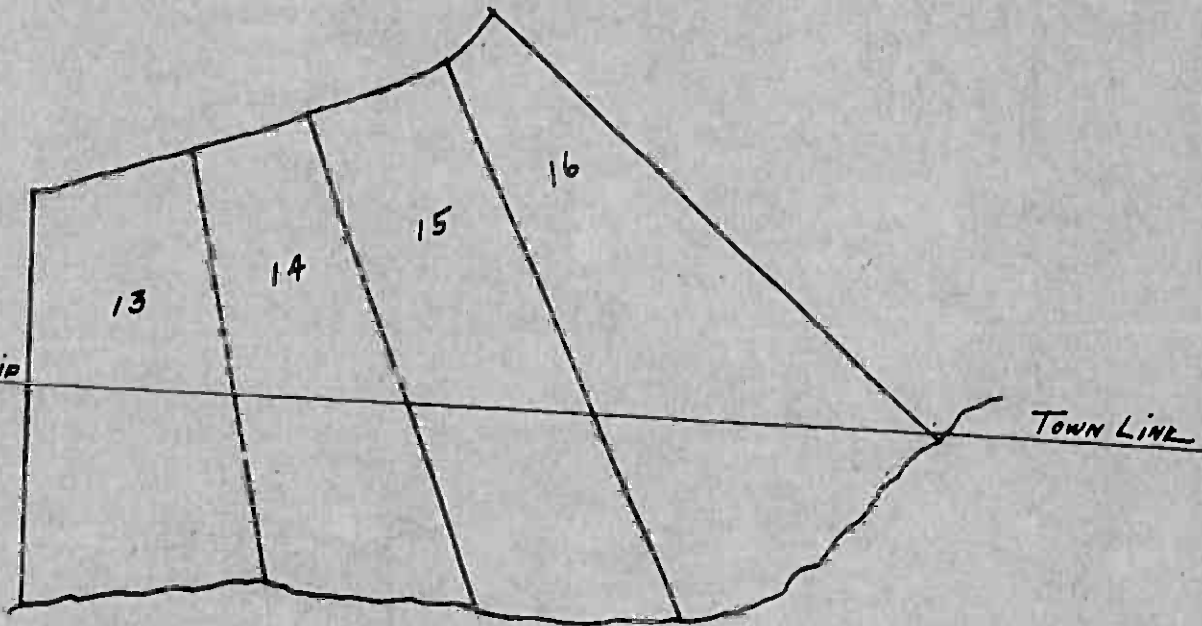

TEN MILE LAKE

LOTS 13-14-15-16 @ CHARITON BEACH