

Assessment & Tax List - 1961  
Deerfield

INDEX TO SECTIONS

SECTION PAGE

Sec. 1.	
" 2.	
" 3.	
" 4.	
" 5.	
" 6.	
" 7.	
" 8.	
" 9.	
" 10.	
" 11.	
" 12.	
" 13.	
" 14.	
" 15.	
" 16.	
" 17.	
" 18.	
" 19.	
" 20.	
" 21.	
" 22.	
" 23.	
" 24.	
" 25.	
" 26.	
" 27.	
" 28.	
" 29.	
" 30.	
" 31.	
" 32.	
" 33.	
" 34.	
" 35.	
" 36.	

For Convenience of Auditor in Showing Boundaries of School Districts

Township No. 139 Range No. 31 Mer. P. M.

	0	5	10	15	20	25	30	35
	4	9	14	19	24	29	34	39
	8	13	18	23	28	33	38	43
	12	17	22	27	32	37	42	47
	16	21	26	31	36	41	46	51
	20	25	30	35	40	45	50	55
	24	29	34	39	44	49	54	59
	28	33	38	43	48	53	58	63
	32	37	42	47	52	57	62	67

Returns Showing Grain Received in or Handled by Elevators, Warehouses and Mills in the \_\_\_\_\_ of \_\_\_\_\_ in the County of \_\_\_\_\_ for the Year Ending May 1, 1961.

NAMES OF OWNERS	ADDRESS	Bushels of Wheat	Bushels of Soy Beans	Bushels of Flax	Total No. of Bushels of Wheat, Soy Beans and Flax	★ Tax of 1/4 Mill per Bushel		Bushels of Corn	Bushels of Barley	Bushels of Rye	Bushels of Oats	Bushels of Buckwheat	Bushels of all Other Grains	Total No. Bushels Corn, Barley, Rye, Oats, Buckwheat and all Other Grains	★ Tax of 1/4 Mill Per Bushel		★ Total Tax		REMARKS		
						Dollars	Cts.								Dollars	Cts.	Dollars	Cts.			

Note ★ Assessors will not fill these Columns

REAL PROPERTY BECOMING SUBJECT TO TAXATION SINCE THE LAST PREVIOUS ASSESSMENT OR OMITTED FROM ASSESSMENT ROLLS THE PREVIOUS YEARS.  
**Assessment of Taxable Real Property in the \_\_\_\_\_ of \_\_\_\_\_, County of \_\_\_\_\_, Minn., for the Year 19\_\_.**  
\* Indicate Type of Property: R - Residential, C - Commercial, I - Industrial, U - Utility, F - Farm, L - Lakeshore, T - Timber, M - Mineral

NAME OF OWNER	School District	DESCRIPTION OF PROPERTY						Number of Acres of Land	Indicate Home- stead Tax or No	Indicate Agri- cultural Use or No	Indicate Type of Prop- erty	BY WHOM VALUED	TRUE AND FULL VALUATIONS				ASSESSED VALUATIONS					FINAL EQUALIZED VALUE			
		SUBDIVISION	Sec. or Lot	Twp. or Block	Rng.	Acres	100ths						LAND Exclusive of Structures and Improvements	BUILDINGS and Other Structures	MACHINERY Permanently Attached to Real Estate	TOTAL True and Full Value	RURAL		ALL OTHER		MACHINERY Permanently Attached to Real Estate		TOTAL ASSESSED VALUE		
																	Homestead Up to \$4,000 20%	Over \$4,000 and Non-Homestead 33 1/3 %	Homestead Up to \$4,000 25%	Over \$4,000 and Non-Homestead 40%				Dollars	Dollars
												Dollars	Dollars	Dollars	Dollars	Dollars	Dollars	Dollars	Dollars	Dollars	Dollars	Dollars	Dollars		
1																									
2																									
3																									
4																									
5																									
6																									
7																									
8																									
								Total No. of Acres														State			
								Total Value as Equalized by														County			
								Total Value as Assessed by														Local Bd.			
																				Assessor					

**SUMMARY OF TAX COLLECTION**

Original Levy	- - - - -	\$ <u>250.42</u>
Additions	- - - - -	\$ <u>10.43</u>
		\$ <u>260.85</u>
Abatements	- - - - -	\$ <u>14.36</u>
		\$ <u>3176.49</u>

**COLLECTIONS**

March Settlement	- - - - -	\$ <u>676.54</u>	
June Settlement	- - - - -	\$ <u>1063.04</u>	
November Settlement	- - - - -	\$ <u>1017.66</u>	
January Settlement	- - - - -	\$ <u>62.56</u>	\$ <u>2819.80</u>
		\$	
Over Collected	- - - - -	\$	
Under Collected	- - - - -	\$	
Delinquent	- - - - -	\$ <u>356.69</u>	\$ <u>356.69</u>
Total	- - - - -	\$ <u>3176.49</u>	

NAME OF OWNER

TABULAR SCHEDULE OF VALUATIONS, RATES AND TAXES

LEVIED IN THE Town OF Deerfield

COUNTY OF CASS, STATE OF MINNESOTA

Main table with columns for School District No., Valuation by School Districts, Rate of State Taxes, Rate of County Taxes, Rate of Town Taxes, School Taxes, Taxes Levied (Local 1 Mill and Special School Taxes, All Other Taxes), and Amounts.

Witness my hand and official seal, this 29th day of December, A. D. 1961. L. C. Peterson, County Auditor. By Helen Billow, Deputy.

Total Taxes Real Estate 2440.72, Pers. Prop. 709.70, Total 3150.42

Assessment of T

COLLECTIONS OF TAXES OF 1961 *Town* OF *Deerfield*, CASS COUNTY, MINNESOTA

NAME OF OWNER	FUNDS	MARCH SETTLEMENT	JUNE SETTLEMENT	NOV. SETTLEMENT	Amount Collected from Nov. 1962 to First Monday in Jan. 1963	REDUCTIONS	Total Reductions and Collected	BALANCE UNCOLLECTED	ADDITIONS	Total Uncollected to First Monday in January, 1963
		1962	1962	1962						
	State-Non-Homestead	17 46	22 74	22 73	1 98					
	State-Homestead	14 43	23 49	21 50	1 59					
	County Revenue	85 83	135 50	129 89	8 05					
	County Road and Bridge	46 57	73 52	70 48	4 36					
	County Welfare	133 42	210 63	201 92	12 50					
	County Bond and Interest	2 54	4 00	3 84	2 3					
	PERA	13 20	20 84	19 98	1 23					
	C.H. Bldg.	4 66	7 35	7 05	4 3					
	Agri. Bldg.	1 16	1 84	1 76	1 0					
	Town Revenue	23 28	36 76	35 24	2 17					
	Town Road and Bridge	58 21	91 90	88 10	5 46					
	Town State Loan									
	<i>Fire</i>	23 28	36 76	35 24	2 17					
	School Local 1 Mill									
	School Special	70 69	110 68	104 79	5 46					
	School State Loan									
	Deficiency	72 46	114 40	109 66	6 50					
	Tuition C.O.	73 02	115 28	110 52	6 85					
	Transportation									
	PERA	9 44	14 89	14 28	8 8					
	<i>Welf. Def.</i>	25 36	40 03	38 37	2 36					
	<i>Civ. Def.</i>	1 53	2 43	2 31	1 4					
		676 54	1063 04	1017 66	62 56					

MARCH SETTLEMENT	School District No.	LOCAL 1 MILL.	SPECIAL	STATE LOAN	Deficiency	C.O.	PERA	TOTALS
	114a		45 74		56 93	57 37	242	167 46
	114 71a		24 95		15 53	15 65	202	58 15
	Totals		70 69		72 46	73 02	944	225 61
	114a		73 12		91 02	91 72	1185	267 71
	114 71a		37 56		23 38	23 56	304	89 54
	Totals		110 68		114 40	115 28	1489	355 25
	114a		76 38		88 86	89 56	1157	261 37
	114 71a		33 41		20 80	20 96	271	77 88
	Totals		104 79		109 66	110 52	1428	339 25
	114a		5 46		6 80	6 85	88	19 99
	Totals		5 46		6 80	6 85	88	19 99
	Totals							
	Totals							

Assessment Roll and Tax List of Real Property in the Town of Peerfield,  
 \* Indicate Type of Property: R-Residential, C-Commercial, I-Industrial, U-Utility, F-Farm, L-Lakeshore, T-Timber, M-Misceral

Cass County, Minnesota, for Taxes for the Year 1961.

Real Estate

IN WHOSE NAME ASSESSED	DESCRIPTION OF PROPERTY				No. School District	Indicate Homestead Yes or No	Agricultural or Non-Agricultural Yes or No	Indicate Type of Property	TRUE AND FULL VALUATIONS							Total Assessed Value as Equalized by the Board of Review	FINAL EQUALIZED VALUE	SOLD FOR TAXES	VALUATIONS BY SCHOOL DISTRICTS AS EQUALIZED BY DEPARTMENT OF TAXATION						Tax Including State Homestead	State Tax on Non-Homestead	SPECIAL TAXES	SPECIAL TAXES	TOTAL TAXES	PAID	WHEN PAID	Number of Receipt	March Settlement 1961	June Settlement 1961	Penalty	November Settlement 1961	Penalty	Collections to First Monday in January 1961	Penalty	Delinquent on First Monday in January 1961	Total Delinquent Tax and Penalty	REMARKS						
	SUBDIVISION	Sec. or Lot	Town or Block	Reg. No.					Number of Acres of Land	LAND Exclusive of Structures and Improvements	BUILDINGS and Other Structures	MACHINERY Permanently Attached to Real Estate	TOTAL True and Full Value	RURAL					ALL OTHER			TOTAL ASSESSED VALUE	District No.	Rate																			District No.	Rate	District No.	Rate	District No.	Rate
														Homestead Up to \$4,000 20%	Over \$4,000 and Non-Homestead 33 1/3%				Timber Land Class 3e 20%	Homestead Up to \$4,000 25%	Over \$4,000 and Non-Homestead 40%																											
State of Minnesota					1																																											
State of Minnesota					2																																											
Oscar Johnson					4		NO	YES	T																																							
State of Minnesota					6																																											
State of Minnesota					7																																											
State of Minnesota					8																																											
State of Minnesota					9																																											
State of Minnesota					11																																											
State of Minnesota					12																																											
State of Minnesota					13																																											
State of Minnesota					14																																											
State of Minnesota					16																																											
State of Minnesota					17																																											
State of Minnesota					18																																											
State of Minnesota					19																																											
					20																																											

40  
 60  
 16.68  
 54  
 172.2  
 1722

1722  
 1894  
 16.42  
 18.71















Assessment Roll and Tax List of Real Property in the Town of Deerfield, Cass County, Minnesota, for Taxes for the Year 1961.

Cass County, Minnesota, for Taxes for the Year 1961.

INDICATE TYPE OF PROPERTY: R-Residential, C-Commercial, Industrial, U-Utility, F-Farm, L-Lakeshore, T-Timber, M-Mineral

Table with columns: IN WHOSE NAME ASSESSED, DESCRIPTION OF PROPERTY, TRUTH AND FULL VALUATIONS, ASSESSED VALUATIONS, VALUATIONS BY SCHOOL DISTRICTS AS EQUALIZED BY DEPARTMENT OF TAXATION, TAXES, PAID, WHEN PAID, Number of Receipt, March Settlement 1962, June Settlement 1962, November Settlement 1962, Collections to First Monday in January 1963, Delinquent on First Monday in January 1963, Total Delinquent Tax and Penalty, REMARKS.











Assessment Roll and Tax List of Real Property in the Town of Deerfield, Cass County, Minnesota, for Taxes for the Year 1961.

\* Indicate Type of Property: R-Residential, C-Commercial, Industrial, U-Utility, F-Farm, L-Lakeshore, T-Timber, M-Mineral

Form 500—MILNER-DAVIS CO., MINNEAPOLIS

Table with columns: IN WHOSE NAME ASSESSED, DESCRIPTION OF PROPERTY, TRUE AND FULL VALUATIONS, ASSESSED VALUATIONS, FINAL EQUALIZED VALUE.

Cass County, Minnesota, for Taxes for the Year 1961.

Table with columns: VALUATIONS BY SCHOOL DISTRICTS AS EQUALIZED BY DEPARTMENT OF TAXATION, TAXES, PAID, WHEN PAID, Number of Receipt, March Settlement 1962, June Settlement 1962, November Settlement 1962, Delinquent on First Monday in January 1963, Total Delinquent Tax and Penalty, REMARKS.







Assessment Roll and Tax List of Real Property in the Town of Deerfield

\* Indicate Type of Property: R-Residential, C-Commercial, I-Industrial, U-Utility, F-Farm, L-Lakeshore, T-Timber, M-Mineral

Table with columns: IN WHOSE NAME ASSESSED, DESCRIPTION OF PROPERTY, TRU AND FULL VALUATIONS, ASSESSED VALUATIONS, and FINAL EQUALIZED VALUE.

Cass County, Minnesota, for Taxes for the Year 1961.

Table with columns: VALUATIONS BY SCHOOL DISTRICTS AS EQUALIZED BY DEPARTMENT OF TAXATION, Tax Including State Homestead, State Tax on Non-Homestead, SPECIAL TAXES, TOTAL TAXES, PAID, WHEN PAID, Number of Receipt, March Settlement 1962, June Settlement 1962, Penalty, November Settlement 1962, Collections to First Monday in January 1963, Delinquent on First Monday in January 1963, Total Delinquent Tax and Penalty, REMARKS.

Assessment Roll and Tax List of Real Property in the Town of Deerfield

\* Indicate Type of Property: R-Residential, C-Commercial, I-Industrial, U-Utility, F-Farm, L-Lakeshore, T-Timber, M-Mineral

Cass County, Minnesota, for Taxes for the Year 1961.

Table with columns: IN WHOSE NAME ASSESSED, DESCRIPTION OF PROPERTY, TRUE AND FULL VALUATIONS, ASSESSED VALUATIONS, VALUATIONS BY SCHOOL DISTRICTS AS EQUALIZED BY DEPARTMENT OF TAXATION, TAXES, PAID, WHEN PAID, Number of Receipt, March Settlement 1962, June Settlement 1962, Penalty, November Settlement 1962, Penalty, Collections to First Monday in January 1963, Penalty, Delinquent on First Monday in January 1963, Total Delinquent Tax and Penalty, REMARKS.









Assessment Roll and Tax List of Real Property in the Town of Deerfield, Cass County, Minnesota

Cass County, Minnesota, for Taxes for the Year 1961.

Table with columns: IN WHOSE NAME ASSESSED, DESCRIPTION OF PROPERTY, TRUE AND FULL VALUATIONS, ASSESSED VALUATIONS, VALUATIONS BY SCHOOL DISTRICTS AS EQUALIZED BY DEPARTMENT OF TAXATION, TAXES, PAID, WHEN PAID, Number of Receipts, Settlements, Penalties, Collections, Delinquency, Total Delinquent Tax and Penalty, REMARKS.



Assessment Roll and Tax List of Real Property in the Town of Deerfield of Cass County, Minnesota

\* Indicate Type of Property: R-Residential, C-Commercial, I-Industrial, U-Utility, F-Farm, L-Lakeshore, T-Timber, M-Mineral

Table with columns: IN WHOSE NAME ASSESSED, DESCRIPTION OF PROPERTY, TRU: AND FULL VALUATIONS, ASSESSED VALUATIONS, and FINAL EQUALIZED VALUE. Includes entries for Jean McRowell, Seth & Agnes Smith, Samuel & Katie L. Hartwell, and Vallie Stone.

Cass County, Minnesota, for Taxes for the Year 1961.

Table with columns: VALUATIONS BY SCHOOL DISTRICTS AS EQUALIZED BY DEPARTMENT OF TAXATION, Tax including State Homestead, State Tax on Non-Homestead, SPECIAL TAXES, TOTAL TAXES, PAID, WHEN PAID, Number of Receipt, March Settlement 1962, June Settlement 1962, Penalty, November Settlement 1962, Collections to First Monday in January 1963, Delinquent on First Monday in January 1963, Total Delinquent Tax and Penalty, REMARKS. Includes summary rows at the bottom.

Assessment Roll and Tax List of Real Property in the

\* Indicate

Gov't Lot 4 of *Pine Mountain Lake*  
Sec. 25-139-31

Timber, M-Mineral

Cass County, Minnesota, for Taxes for the Year 1961.

IN WHOSE NAME ASSESSED	DESCRIPTION OF PROPERTY				No. School District	Indicate Homestead Yes or No	Agricultural Rec. Yes or No	Indicate Type of Property	LAND EXCLUSIVE STRUCTURE AND IMPROVEMENT	VALUATIONS BY SCHOOL DISTRICTS AS EQUALIZED BY DEPARTMENT OF TAXATION				Tax Including State Homestead	State Tax on Non-Homestead	SPECIAL TAXES	SPECIAL TAXES	TOTAL TAXES	PAID	WHEN PAID	Number of Receipt	March Settlement 1962	June Settlement 1962	Penalty	November Settlement 1962	Penalty	Collections to First Monday in January 1963	Penalty	Delinquent on First Monday in January 1963	Total Delinquent Tax and Penalty	REMARKS		
	SUBDIVISION	Sec. or Lot	Town or Block	Number of Acres of Land						Seasonal and Recreational Cabins 33 1/3%	TOTAL ASSESSED VALUE	Total Assessed Value as Equalized by the Board of Review	FINAL EQUALIZED VALUE																			District No.	District Rate
			25 139 31	114																													
<i>N. &amp; Josephine Cahill</i>			Gov't lot 1	1660	Yes	No	R						2180				2180	PAID IN FULL	MAY 31 1962	15790												7621	
<i>Forest &amp; Violet Cundy</i>			Gov't lot 2	20	No	Yes	T						948	30			948															18625	
<i>Clifford L. Roy &amp; Helen M. Christopheron</i>			N. 50' of S. 215' of Gov't Lot 3		No	"	L						834	28			862	PAID IN FULL	AUG 3 1962	16634					8 62	21						18626	
<i>R. H. &amp; Margaret Finney</i>			Gov't Lot 3 less S. 215'	2150	No	"	"						4196	138			4334	PAID IN FULL	APR 18 1962	6711												7625	
<i>Harry W. Schaffer</i>			Gov't lot 4 less N. 1000'	3890	No	No	L						4180	126			4306	2nd Half Paid	OCT 3 1 1962	2076												2153	21307
<i>Clifford L. Roy &amp; Helen M. Christopheron</i>			S. 1000' less N. 3200' of Gov't Lot 3	1	No	"	"						302	08			1310	1st Half Paid	MAY 3 1 1962	15785												18626	
<i>August J. &amp; Esther Mae Hansen</i>			N. 800' of Gov't Lot 4	6	No	Yes	"						2168	72			2240	PAID IN FULL	APR 2 1962	5105												7642	
<i>Jay R. &amp; Beatta Schmidtke</i>			S. 600' of N. 800' of Gov't Lot 4	20	No	No	C						6240	188			6428	2nd Half Paid	OCT 3 1 1962	20763												21308	7622
<i>Ronald V. &amp; Esther Bartholomew</i>			S. 100' of N. 400' of Gov't Lot 4	150	Yes	"	L						212				212	1st Half Paid	MAY 3 1 1962	13723												21306	7623
<i>" " "</i>			S. 100' of N. 1000' of Gov't Lot 4		Yes	"	"						5664				5664	2nd Half Paid	OCT 3 1 1962	20699													
<i>Clifford L. Roy &amp; Helen M. Christopheron</i>			S. 1000' of N. 3200' of Gov't Lot 3	2	No	Yes	"						2390	78			2468	PAID IN FULL	AUG 3 1962	16694													18626
				12750									18778				29952															948	

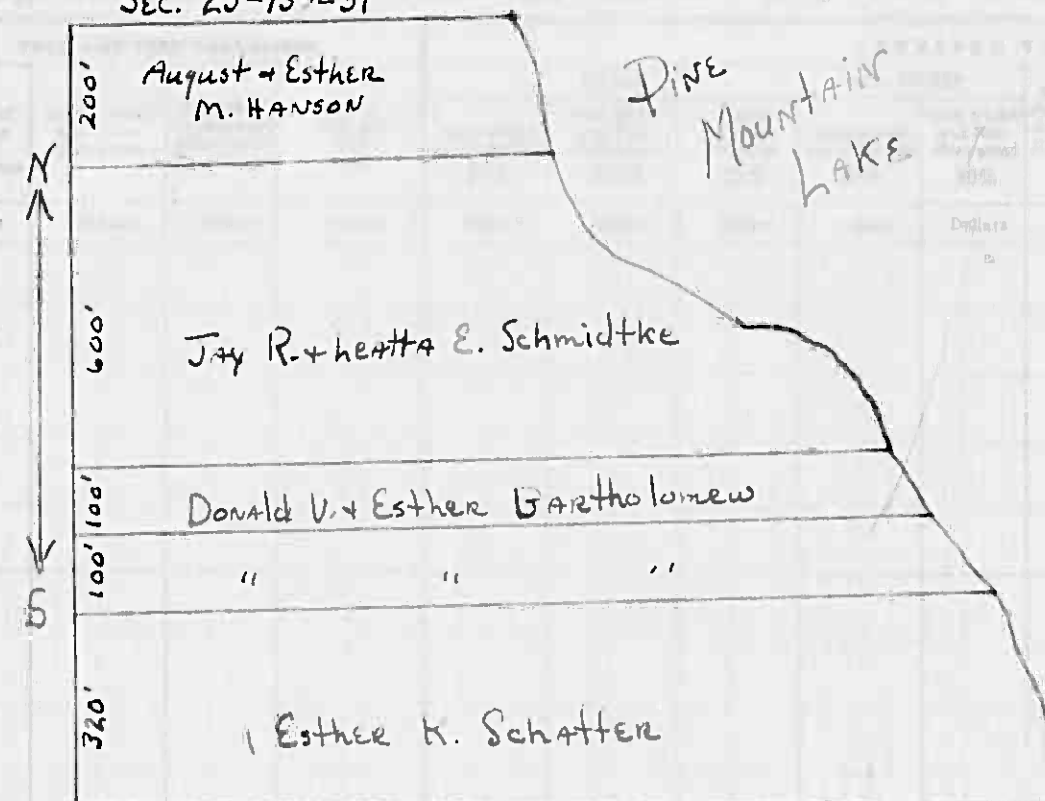

Assessment Roll and Tax List of Real Property in the Town of Deerfield

\* Indicate Type of Property: R-Residential, C-Commercial, I-Industrial, U-Utility, F-Farm, L-Lakeshore, T-Timber, M-Mineral

Form 501 MILLER-DAVIS CO-MINNEAPOLIS

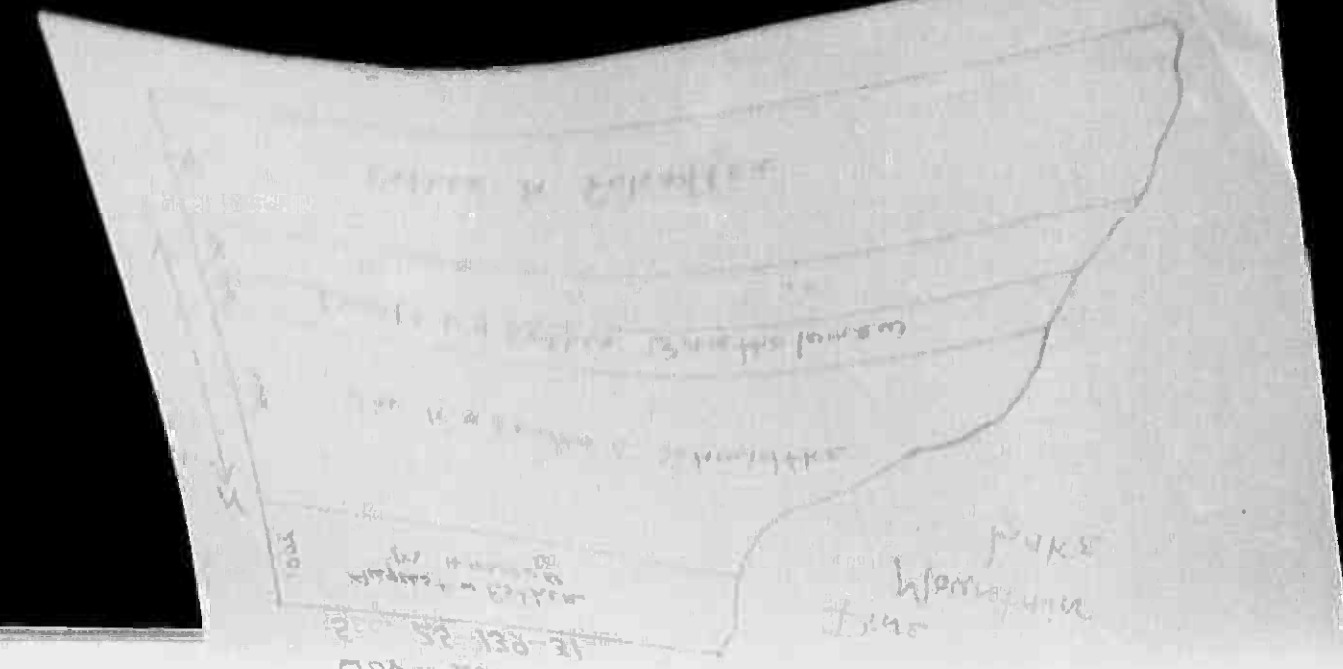

Table with columns: IN WHOSE NAME ASSESSED, SUBDIVISION, Number of Acres, TRUE AND FULL VALUATIONS (RURAL, ALL OTHER, MACHINERY, etc.), TOTAL ASSESSED VALUE, and FINAL EQUALIZED VALUE.

Handwritten entries for property owners: N.P. & Josephine Cahill, Ernest & Violet Bundy, Clifford Kelly & Helen M. Christopher, etc.

Cass County, Minnesota, for Taxes for the Year 1961.

Table with columns: VALUATIONS BY SCHOOL DISTRICTS AS EQUALIZED BY DEPARTMENT OF TAXATION, TAXES (SPECIAL, TOTAL), PAID, WHEN PAID, Number of Receipt, and REMARKS.

Handwritten entries for tax payments and dates: PAID IN FULL, MAY 31 1961, AUG 3 1962, APR 18 1962, etc.









Assessment Roll and Tax List of Real Property in the Town of Deerfield

\* Indicate Type of Property: R-Residential, C-Commercial, Industrial, U-Utility, F-Farm, L-Lakeshore, T-Timber, M-Mineral

FORM 500 - MILLER-DAYE CO., MINNEAPOLIS

Table with columns: IN WHOSE NAME ASSESSED, SUBDIVISION, DESCRIPTION OF PROPERTY, TRUE AND FULL VALUATIONS, ASSESSED VALUATIONS, and FINAL EQUALIZED VALUE.

Cass County, Minnesota, for Taxes for the Year 1961.

Table with columns: VALUATIONS BY SCHOOL DISTRICTS AS EQUALIZED BY DEPARTMENT OF TAXATION, TAXES, PAID, WHEN PAID, Number of Receipt, and various settlement and penalty dates.

Assessment Roll and Tax List of Real Property in the Town of Deerfield, Minnesota

\* Indicate Type of Property: R-Residential, C-Commercial, I-Industrial, U-Utility, F-Farm, L-Lakeshore, T-Timber, M-Mineral

Table with columns: IN WHOSE NAME ASSESSED, DESCRIPTION OF PROPERTY, TRUE AND FULL VALUATIONS, ASSESSED VALUATIONS, and FINAL EQUALIZED VALUE. Includes handwritten entries for Roy Holden, Erin A. & Margaret E. Holden, The Northwest Paper Company, and Janice Laurel Nickmann.

Cass County, Minnesota, for Taxes for the Year 1961.

Table with columns: VALUATIONS BY SCHOOL DISTRICTS AS EQUALIZED BY DEPARTMENT OF TAXATION, TAX INCLUDING STATE HOMESTEAD, SPECIAL TAXES, TOTAL TAXES, PAID, WHEN PAID, and REMARKS. Includes handwritten entries for tax amounts and payment dates.

Assessment Roll and Tax List of Real Property in the Town of Deerfield

\* Indicate Type of Property: R-Residential, C-Commercial, I-Industrial, U-Utility, F-Farm, L-Lakeshore, T-Timber, M-Mineral

Table with columns: IN WHOSE NAME ASSESSED, DESCRIPTION OF PROPERTY, TRUE AND FULL VALUATIONS, ASSESSED VALUATIONS, and FINAL EQUALIZED VALUE. Includes entries for Warren Holden Jr., George R. Hickman, Bonnie Denning, John + Lorna M. Grove, Margaret Francis Smith, and Harry + Vivian Jensen.

Cass County, Minnesota, for Taxes for the Year 1961

Table with columns: VALUATIONS BY SCHOOL DISTRICTS AS EQUALIZED BY DEPARTMENT OF TAXATION, TAX INCLUDING STATE HOMESTEAD, SPECIAL TAXES, TOTAL TAXES, PAID, WHEN PAID, Number of Receipt, March Settlement 1962, June Settlement 1962, November Settlement 1962, Collections to First Monday in January 1963, Delinquent on First Monday in January 1963, Total Delinquent Tax and Penalty, and REMARKS. Includes entries for Warren Holden Jr., George R. Hickman, Bonnie Denning, John + Lorna M. Grove, Margaret Francis Smith, and Harry + Vivian Jensen.

Assessment Roll and Tax List of Real Property in the *Town* of *Pearfield*

\* Indicate Type of Property: R-Residential, C-Commercial, I-Industrial, U-Utility, F-Farm, L-Lakeshore, T-Timber, M-Mineral

Form 300 MILLER-GARRETT CO. MINNEAPOLIS

Table with columns: IN WHOSE NAME ASSESSED, DESCRIPTION OF PROPERTY, TRUE AND FULL VALUATIONS, ASSESSED VALUATIONS, FINAL EQUALIZED VALUE.

Cass County, Minnesota, for Taxes for the Year 1961.

Table with columns: VALUATIONS BY SCHOOL DISTRICTS AS EQUALIZED BY DEPARTMENT OF TAXATION, Tax Including State Homestead, State Tax on Non-Homestead, SPECIAL TAXES, TOTAL TAXES, PAID, WHEN PAID, Number of Receipt, March Settlement 1962, June Settlement 1962, November Settlement 1962, Collections to First Monday in January 1963, Delinquent on First Monday in January 1963, Total Delinquent Tax and Penalty, REMARKS.











Assessment Roll and Tax List of Real Property in the Town of Deerfield

\* Indicate Type of Property: R-Residential, C-Commercial, I-Industrial, U-Utility, F-Farm, L-Lakeshore, T-Timber, M-Mineral

Form SCD - MILLER-DAVIS CO., MINNEAPOLIS

IN WHOSE NAME ASSESSED

DESCRIPTION OF PROPERTY

Table with columns: SUBDIVISION, Sec. or Lot, Town or Block, Rng., Number of Acres of Land, Acres 100ths

TRUE AND FULL VALUATIONS

Table with columns: LAND Exclusive of Structures and Improvements, BUILDINGS and Other Structures, MACHINERY Permanently Attached to Real Estate, TOTAL True and Full Value

ASSESSED VALUATIONS

Table with columns: RURAL (Homestead Up to \$4,000 20%, Over \$4,000 and Non-Homestead 33%), ALL OTHER (Homestead Up to \$4,000 25%, Over \$4,000 and Non-Homestead 40%), MACHINERY Permanently Attached to Real Estate 33%, Seasonal and Recreational Cabins 33%, TOTAL ASSESSED VALUE, Total Assessed Value as Equalized by the Board of Review, FINAL EQUALIZED VALUE

VALUATIONS BY SCHOOL DISTRICTS AS EQUALIZED BY DEPARTMENT OF TAXATION

Table with columns: District No., District Rate, District No., District Rate, District No., District Rate, District No., District Rate

Tax including State Homestead, State Tax on Non-Homestead, SPECIAL TAXES, SPECIAL TAXES, TOTAL TAXES

PAID, WHEN PAID, Number of Receipt, March Settlement 1962, June Settlement 1962, November Settlement 1962, Penalty, Collections to First Monday in January 1963, Delinquent on First Monday in January 1963, Total Delinquent Tax and Penalty, REMARKS

Main assessment table grid with 20 rows and 16 columns for valuation and tax data.

Tax and payment table grid with 20 rows and 11 columns for tax rates, payments, and delinquency.