

TAX LIST PAYABLE 1973
BULL MOOSE

INDEX TO SECTIONS

SECTION	PAGE
Sec. 1	
" 2	
" 3	
" 4	
" 5	
" 6	
" 7	
" 8	
" 9	
" 10	
" 11	
" 12	
" 13	
" 14	
" 15	
" 16	
" 17	
" 18	
" 19	
" 20	
" 21	
" 22	
" 23	
" 24	
" 25	
" 26	
" 27	
" 28	
" 29	
" 30	
" 31	
" 32	
" 33	
" 34	
" 35	
" 36	

For Convenience of Auditor in Showing Boundaries of School Districts

Township No. 138 Range No. 31 Mer. P. M.

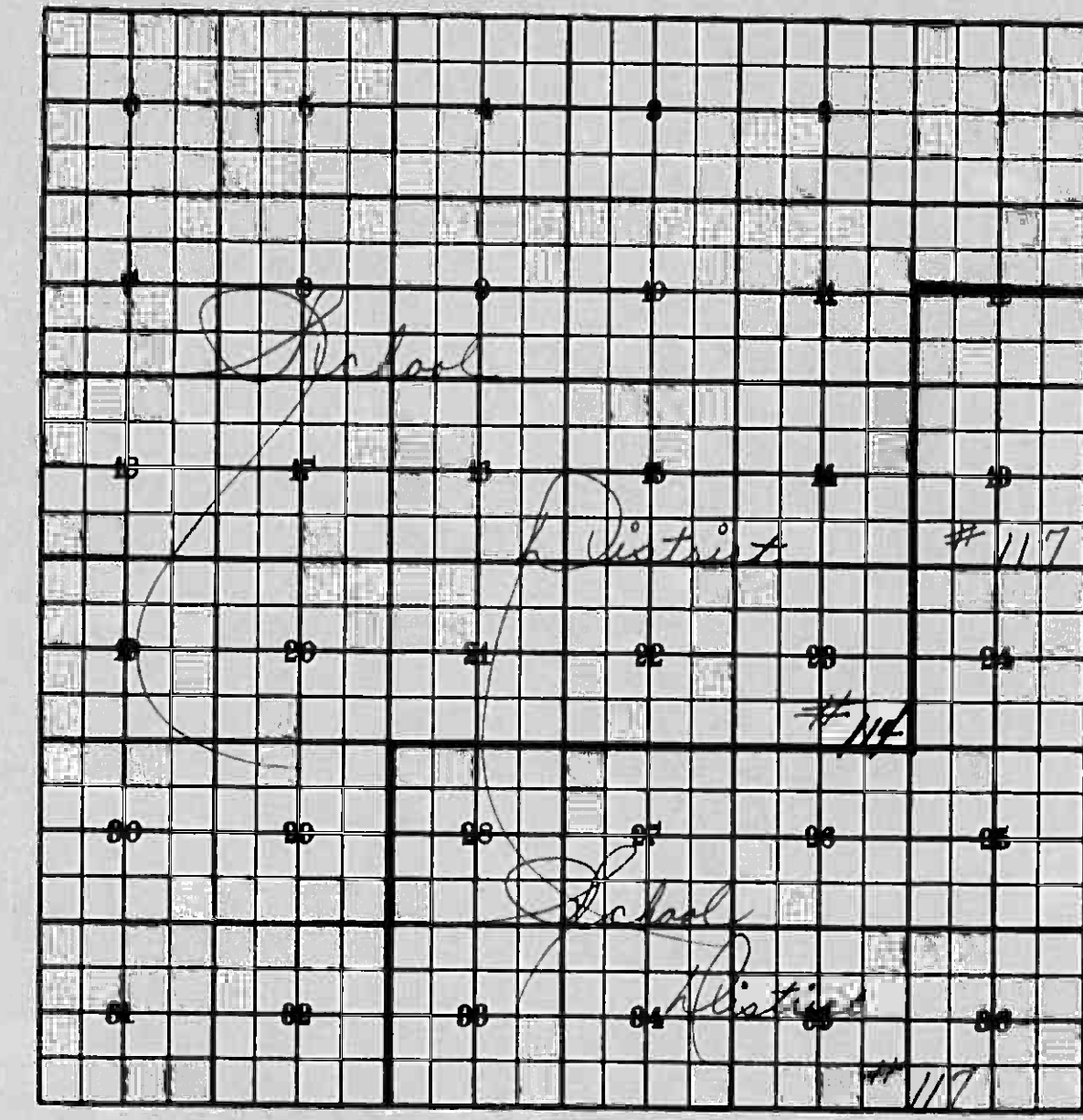

SUMMARY OF TAX COLLECTION

Original Levy	- - - -	\$ 5206.38	
Additions	- - - -	\$ 48.84	<i>Mobile Homes</i>
Abatements	- - - -	\$	
		\$	
		\$ 5255.22	

COLLECTIONS

March Settlement	- - - -	\$ 108.64	
June Settlement	- - - -	\$ 777.17	
November Settlement	- - - -	\$ 3,201.61	
January Settlement	- - - -	\$ 100.90	\$ 4,188.32
Over Collected	- - - -	\$	
		\$	
Under Collected	- - - -	\$	
Delinquent	- - - -	\$ 347.06	
Total	- - - -	\$	\$ 5,255.22

35% Repay. 719.84

TABULAR SCHEDULE OF VALUATIONS,

LEVIED IN THE Town OF Bull Moose

RATES AND TAXES

COUNTY OF CASS, STATE OF MINNESOTA

School District No.	VALUATION BY SCHOOL DISTRICTS				RATE OF STATE TAXES	RATE OF COUNTY TAXES										RATE OF TOWN TAXES										RATE OF SCHOOL TAXES			TAXES LEVIED									
	Agricultural Lands	Non-Agricultural Lands	Personal Property	Total Value of all Property		Rev.	R. & B.	Welfare	Bonds and Int.	Transportation	P. E. R. A.	Total Rate of County Tax	Rev.	R. & B.	Bonds & Int.	Tuition	P. E. R. A.	Total Rate of Town Tax	Special	Deficiency	Bonds & Int.	Tuition	P. E. R. A.	Total Rate of Sch'l Tax	Total Rate of all Taxes	Special	Deficiency	Bonds & Interest	P. E. R. A.	G. O. Transp.	Total School Taxes	FUNDS	Rate	Amount				
114	35168	6632	-	41800	H.	.78	8.26	20.70			29.74	4.73	4.47	3.16			12.36	8.33	16.50	14.46			3.94	5.65	53.52	95.66	29295	58309	50853	30034	19870	188361	State-Non-Homestead,					
117	13814	2527	-	16341														16.41					7.03	3.52	61.90	104.00	11056	10996	9590	5664	3747	41053	State-Homestead,					
	48982	9159	-	58121	N. H.													19.39					34.49	76.59	27.41	69.51	8717	-	14574	9711	4863	37865	County Revenue,	4556				
																																		County Road and Bridge,	48008			
																																			County Welfare,	120311		
																																			Bonds and Interest,			
																																			Transportation			
																																			P. E. R. A.			
Assessed Value	Rural	All Other	Personal Property	Total																																		
Homestead	19005	9159	-	28164																																		
Non-Homestead	29927	-	-	29927																																		
Total	48982	9159	-	58121																																		

Total Number of Acres 6901
 State of Minnesota, ss. Albert R. Packson
 COUNTY OF CASS Auditor of said County and State aforesaid, do hereby certify that the foregoing is a true and correct Schedule, showing the valuation of all the taxable property, in the Town of Bull Moose, in said County, the several rates of Taxation and Totals of the several Tax Funds levied thereon for taxes payable in the year A. D. 1973.
 Witness my hand and official seal, this 2 day of January A. D. 1973.
 SEAL
Albert R. Packson County Auditor.

Total Taxes Real Estate 5206.38
 Pers. Prop. -
 Total 5206.38

Real Estate

COLLECTIONS OF TAXES PAYABLE IN 1973, *Town* OF *Pull Moose*, CASS COUNTY, MINNESOTA

FUNDS	MARCH SETTLEMENT 1972	JUNE SETTLEMENT 1973	NOV. SETTLEMENT 1973	Amount Collected from Nov. 1972 to First Monday in Jan. 1973	REDUCTIONS	Total Reductions and Collected	BALANCE UNCOLLECTED	ADDITIONS	Total Uncollected to First Monday in January, 1973
State-Non-Homestead, State-Homestead,									
County Revenue, County Road and Bridge, County Welfare, County Bond and Interest, Transportation P. E. R. A.	78 836 2082	601 6351 15916	2656 28113 70453	107 1136 2845					
<i>Courthouse Bldg. Civil Defense Agri. Assn.</i>									
Town Revenue, Town Road and Bridge, Bonds & Interest <i>Fire</i>	476 450 318	3636 3436 2431	1697 15214 10755	650 615 434					
School Special, Deficiency Bonds & Interest Tuition P. E. R. A. <i>Co. Transp. E.A.R.C. Bldg. Un. Fund.</i>	1677 1668 1857 859 568	12175 9505 13467 6271 3928	29398 50383 55547 23660 17883	868 1984 967 484					
	110864	77717	320261	10090					

	School District No.	LOCAL 1 MILL	SPECIAL	STATE LOAN	Deficiency	Co.	Co.	Transp.	E.A.R.C.	Bldg.	TOTALS
MARCH SETTLEMENT	114 & 70		1677		1668	859	1857	568			6630
	117 & 70										
	Totals		1677		1668	859	1857	568			6630
JUNE SETTLEMENT	11470		9556		9505	4896	10827	3239			38023
	117		2619			1375	2640	689			7323
	Totals		12175		9505	6271	13467	3928			45346
NOVEMBER SETTLEMENT	114 & 70		44644		42933	23660	27765	15054			
	117 & 70		4754		4450		7782	2229			
	Totals		29398		50383	23660	55547	17883			176671
NOVEMBER to JANUARY	1170		848			967	1984	484			4303
	Totals		868			967	1984	484			4303
	School District No.										
ADDITIONS											
REDUCTIONS											

Rec'd From

DESCRIPTION OF PROPERTY				ESTIMATED MARKET VALUE	ASSESSED VALUE				SOLD FOR TAXES	VALUATIONS BY SCHOOL DISTRICTS AS EQUALIZED BY DEPARTMENT OF TAXATION						Non-Homestead General Tax Ex. Bonds	Homestead General Tax Ex. Bonds	33% Homestead Credit	Rate & Tax Bonds & Int. (Mills)	SPECIAL TAXES	SPECIAL TAXES	TOTAL TAXES	PAID	WHEN PAID	Number of Receipt	March Settlement 1973	June Settlement 1973	Penalty	November Settlement 1973	Penalty	Collections to First Monday in January 1974	Penalty	Delinquent on First Monday in January 1974	Total Delinquent Tax and Penalty	REMARKS		
IN WHOSE NAME ASSESSED	SUBDIVISION	Sec. or Lot	Town or Block		As. Acres	Total	Homestead Tax Credit	Agr.		Non Agr.	District No. Mills	District No. Mills	District No. Mills	District No. Mills	District No. Mills																					District No. Mills	District No. Mills
3391 State of Minnesota	Gov. Lot 1	3	138 31	114																																	
3391 State of Minnesota	Gov. Lot 2	3	138 31	114																																	
3391 State of Minnesota	SW 1/4 of NE 1/4	3	138 31	114																																	
3391 Sam M. & Florence Ar Johnson	SE 1/4 of NE 1/4	3	138 31 40	114	2444	611	611	611		HG 11																											
3391 State of Minnesota	Gov. Lot 3	3	138 31	114																																	
3391 State of Minnesota	Gov. Lot 4	3	138 31	114																																	
3391 State of Minnesota	SW 1/4 of NW 1/4	3	138 31	114																																	
3391 State of Minnesota	SE 1/4 of NW 1/4	3	138 31	114																																	
3391 State of Minnesota	NE 1/4 of SW 1/4	3	138 31	114																																	
3391 State of Minnesota	NW 1/4 of SW 1/4	3	138 31	114																																	
3391 State of Minnesota	SW 1/4 of SW 1/4	3	138 31	114																																	
3391 State of Minnesota	SE 1/4 of SW 1/4	3	138 31	114																																	
3391 State of Minnesota	NE 1/4 of SE 1/4	3	138 31	114																																	
3391 State of Minnesota	NW 1/4 of SE 1/4	3	138 31	114																																	
3391 State of Minnesota	SW 1/4 of SE 1/4	3	138 31	114																																	
3391 State of Minnesota	SE 1/4 of SE 1/4	3	138 31	114																																	

114

40

2444 611 611 611 HG 11

5470 1914 884 4440

1503

WALL

4440

OR WHOSE NAME ASSESSED	SUBDIVISION	DESCRIPTION OF PROPERTY			No. School District	Assessed Value	ESTIMATED MARKET VALUE	ASSESSED VALUE				SOLD FOR TAXES	VALUATIONS BY SCHOOL DISTRICTS AS EQUALIZED BY DEPARTMENT OF TAXATION						Non-Homestead General Tax Exc. Bonds	Homestead General Tax Ex. Bonds	2% Homestead Credit	Rate & Tax Bonds & Int. (Mills)	SPECIAL TAXES	SPECIAL TAXES	TOTAL TAXES	PAID	WHEN PAID	Number of Receipt	March Settlement 1973	June Settlement 1973	Penalty	November Settlement 1973	Penalty	Collections to First Monday in January 1974	Penalty	Delinquent on First Monday in January 1974	Total Delinquent Tax and Penalty	REMARKS																					
		Sec. or Lot	Town or Block	Rng.				No. of Acres	Total	Homestead Ex. Credit	Agr.		Non Agr.	District No. 114	District No. 114	District No.	District No.	District No.																					District No.	Non-Homestead General Tax Exc. Bonds	Homestead General Tax Ex. Bonds	2% Homestead Credit	Rate & Tax Bonds & Int. (Mills)	SPECIAL TAXES	SPECIAL TAXES	TOTAL TAXES	PAID	WHEN PAID	Number of Receipt	March Settlement 1973	June Settlement 1973	Penalty	November Settlement 1973	Penalty	Collections to First Monday in January 1974	Penalty	Delinquent on First Monday in January 1974	Total Delinquent Tax and Penalty	REMARKS
														Mills	Mills	Mills	Mills	Mills																					Mills																				
4391 State of Minnesota	1	Gov. Lot 1	4	138	31	114																																																					
4391 State of Minnesota	2	Gov. Lot 2	4	138	31	114																																																					
4391 State of Minnesota	3	SW 1/4 of NE 1/4	4	138	31	114																																																					
4391 State of Minnesota	4	SE 1/4 of NE 1/4	4	138	31	114																																																					
4391 State of Minnesota	5	Gov. Lot 3	4	138	31	114																																																					
4391 State of Minnesota	6	Gov. Lot 4	4	138	31	114																																																					
4391 State of Minnesota	7	SW 1/4 of NW 1/4	4	138	31	114																																																					
4391 State of Minnesota	8	SE 1/4 of NW 1/4	4	138	31	114																																																					
4391 State of Minnesota	9	NE 1/4 of SW 1/4	4	138	31	114																																																					
4391 State of Minnesota	10	NW 1/4 of SW 1/4	4	138	31	114																																																					
4391 John P. Sullivan	11	SW 1/4 of SW 1/4	4	138	31	40	114	No. T	243	81	81	81			658																																												
4391 John P. Sullivan	12	SE 1/4 of SW 1/4	4	138	31	40	114	No. T	306	122	122	122			990																																												
4391 State of Minnesota	13	NE 1/4 of SE 1/4	4	138	31	114																																																					
4391 State of Minnesota	14	NW 1/4 of SE 1/4	4	138	31	114																																																					
4391 State of Minnesota	15	SW 1/4 of SE 1/4	4	138	31	114																																																					
4391 State of Minnesota	16	SE 1/4 of SE 1/4	4	138	31	114																																																					
4391 State of Minnesota	17																																																										
4391 State of Minnesota	18																																																										
4391 State of Minnesota	19																																																										
4391 State of Minnesota	20																																																										
									80	609	208	203			1048																																												

114

81.20

81

122

81

990

122

1048

1048

203

1048

294

1948

848

1942

1942

1942

1942

1942

1942

1942

1942

1942

1942

1942

1942

1942

1942

1942

1942

PAID IN FULL MAR 8 1973

PAID IN FULL MAR 9 1973

PAID IN FULL MAR 9 1973

PAID IN FULL MAR 9 1973

PAID IN FULL MAR 9 1973

PAID IN FULL MAR 9 1973

PAID IN FULL MAR 9 1973

PAID IN FULL MAR 9 1973

PAID IN FULL MAR 9 1973

PAID IN FULL MAR 9 1973

PAID IN FULL MAR 9 1973

PAID IN FULL MAR 9 1973

PAID IN FULL MAR 9 1973

Assessment Roll for the Year 1972 and Tax List of Real Property in the Township of Bull Moose

Cass County, Minnesota, for Taxes Payable in the Year 1973.

114

IN WHOSE NAME ASSESSED	DESCRIPTION OF PROPERTY	Sec. or Lot	Town or Block	Rng. or Block	No. of Acres	No. School District	No. of Homestead Tax or Int.	Type of Property	ESTIMATED MARKET VALUE	ASSESSED VALUE				SOLD FOR TAXES	VALUATIONS BY SCHOOL DISTRICTS AS EQUALIZED BY DEPARTMENT OF TAXATION						Non-Homestead Tax Ex. Bonds	Homestead General Tax Ex. Bonds	35% Homestead Credit	Rate & Tax Bonds & Int. (Mills)	SPECIAL TAXES	SPECIAL TAXES	TOTAL TAXES	PAID	WHEN PAID	Number of Receipts	March Settlement 1973	June Settlement 1973	Penalty	November Settlement 1973	Penalty	Collections to First Monday in January 1974	Penalty	Delinquent on First Monday in January 1974	Total Delinquent Tax and Penalty	REMARKS							
										Total	Homestead Tax Credit	Agr.	Non Agr.		District No. 1114	District No. 1114	District No. 1114	District No. 1114	District No. 1114	District No. 1114																											
										Dollars	Dollars	Dollars	Dollars		Mills	Mills	Mills	Mills	Mills	Mills																											
5391 State of Minnesota	Gov. Lot 1	5	138	31	114																																										
5391 State of Minnesota	Gov. Lot 2	5	138	31	114																																										
5391 State of Minnesota	SW 1/4 of NE 1/4	5	138	31	114																																										
5391 State of Minnesota	SE 1/4 of NE 1/4	5	138	31	114																																										
5391 Robert & Shirley Vaughn	Gov. Lot 3	5	138	31	114																																										
5391 Duane Dr & Edith B. Enger	Gov. Lot 4	5	138	31	37	114	No SR		1065	355		355																																			
5391 State of Minnesota	N 1/2 of SW 1/4 of NW 1/4	5	138	31	114		No T		360	120		120																																			
5391 State of Minnesota	S 1/2 of SW 1/4 of NW 1/4	5	138	31	114																																										
5391 State of Minnesota	SE 1/4 of NW 1/4	5	138	31	114																																										
5391 State of Minnesota	NE 1/4 of SW 1/4	5	138	31	114																																										
5391 State of Minnesota	NW 1/4 of SW 1/4	5	138	31	114																																										
5391 State of Minnesota	SW 1/4 of SW 1/4	5	138	31	114																																										
5391 State of Minnesota	SE 1/4 of SW 1/4	5	138	31	114																																										
5391 State of Minnesota	NE 1/4 of SE 1/4	5	138	31	114																																										
5391 State of Minnesota	NW 1/4 of SE 1/4	5	138	31	114																																										
5391 State of Minnesota	SW 1/4 of SE 1/4	5	138	31	114																																										
5391 State of Minnesota	SE 1/4 of SE 1/4	5	138	31	114																																										
									475			475																																			
					74				1498	475		475																																			

114

Table with columns: IN WHOSE NAME ASSESSED, DESCRIPTION OF PROPERTY, ASSESSED VALUE, VALUATIONS BY SCHOOL DISTRICTS AS EQUALIZED BY DEPARTMENT OF TAXATION, Non-Homestead General Tax, Homestead General Tax, 2 1/2% Homestead Credit, Rate & Tax Bonds & Int. (Mills), SPECIAL TAXES, TOTAL TAXES, PAID, WHEN PAID, Number of Receipt, March Settlement 1973, June Settlement 1973, Penalty, November Settlement 1973, Penalty, Collections to First Monday in January 1974, Delinquent on First Monday in January 1974, Total Delinquent Tax and Penalty, REMARKS.

Table with columns: IN WHOSE NAME ASSESSED, DESCRIPTION OF PROPERTY (Subdivision, Sec or Lot, Town or Block, Rng, No. of Acres), ASSESSED VALUE (Total, Homestead Tax Credit, Agr., Non Agr.), VALUATIONS BY SCHOOL DISTRICTS AS EQUALIZED BY DEPARTMENT OF TAXATION (District No., District No., District No., District No., District No., District No.), Non-Homestead General Tax, Homestead General Tax, 2% Homestead Credit, Rate & Tax Bonds & Int. (Mills), SPECIAL TAXES, SPECIAL TAXES, TOTAL TAXES, PAID, WHEN PAID, Number of Receipt, March Settlement 1973, June Settlement 1973, Penalty, November Settlement 1973, Penalty, Collections in First Monday in January 1974, Penalty, Delinquent on First Monday in January 1974, Penalty, Total Delinquent Tax and Penalty, REMARKS.

D. J. B. 3/11/73

Assessment Roll for the Year 1972 and Tax List of Real Property in the Township of Bull Moose

Cass County, Minnesota, for Taxes Payable in the Year 1973.

Table with columns: IN WHOSE NAME ASSESSED, DESCRIPTION OF PROPERTY, ASSESSED VALUE, VALUATIONS BY SCHOOL DISTRICTS AS EQUALIZED BY DEPARTMENT OF TAXATION, Non-Homestead General Tax Ex. Bonds, Homestead General Tax Ex. Bonds, 25% Homestead Credit, Rate & Tax Bonds & Int. (Mills), SPECIAL TAXES, TOTAL TAXES, PAID, WHEN PAID, Number of Receipt, March Settlement 1973, June Settlement 1973, Penalty, November Settlement 1973, Penalty, Collections to First Monday in January 1974, Delinquent on First Monday in January 1974, Total Delinquent Tax and Penalty, REMARKS.

IN WHOSE NAME ASSESSED	DESCRIPTION OF PROPERTY				ESTIMATED MARKET VALUE	ASSESSED VALUE				SOLD FOR TAXES	VALUATIONS BY SCHOOL DISTRICTS AS EQUALIZED BY DEPARTMENT OF TAXATION						Non-Homestead Gen. Tax Exc. Bonds	Homestead Gen. Tax Exc. Bonds	3% Homestead Credit	Rate & Tax Bonds & Int. (Mills) Co. Sch. Vill. Tot.	SPECIAL TAXES	SPECIAL TAXES	TOTAL TAXES	PAID	WHEN PAID	Number of Receipt	March Settlement 1973	June Settlement 1973	Penalty	November Settlement 1973	Penalty	Collections to First Monday in January 1974	Penalty	Delinquent on First Monday in January 1974	Total Delinquent Tax and Penalty	REMARKS	
	SUBDIVISION	Sec. or Lot	Town or Block	Rng. No. of Acres		No. School District	Type of Property	Total	Homestead Tax Credit		Agr.	Non Agr.	District No.	District No.	District No.	District No.																					District No.
													114	114	114	114																					114
23391 State of Minnesota	NE 1/4 of NE 1/4	23	138	31	114																																
23391 State of Minnesota	NW 1/4 of NE 1/4	23	138	31	114																																
23391 State of Minnesota	SW 1/4 of NE 1/4	23	138	31	114																																
23391 State of Minnesota	SE 1/4 of NE 1/4	23	138	31	114																																
23391 State of Minnesota	NE 1/4 of NW 1/4	23	138	31	114																																
23391 State of Minnesota	NW 1/4 of NW 1/4	23	138	31	114																																
23391 State of Minnesota	SW 1/4 of NW 1/4	23	138	31	114																																
23391 State of Minnesota	SE 1/4 of NW 1/4	23	138	31	114																																
23391 State of Minnesota	NE 1/4 of SW 1/4	23	138	31	114																																
23391 State of Minnesota	NW 1/4 of SW 1/4	23	138	31	114																																
23391 State of Minnesota	SW 1/4 of SW 1/4	23	138	31	114																																
23391 John & Mario W. Spillano	SE 1/4 of SW 1/4	23	138	31-40	114																																
23391 John & Mario W. Spillano	NE 1/4 of SE 1/4	23	138	31	114																																
23391 John & Mario W. Spillano	NW 1/4 of SE 1/4	23	138	31-40	114																																
23391 John & Mario W. Spillano	SW 1/4 of SE 1/4	23	138	31-40	114																																
23391 John & Mario W. Spillano	SE 1/4 of SE 1/4	23	138	31-40	114																																
					160																																
					330	110																															
					110																																
					110																																
					890																																
					890																																
					1046																																

114

3120

114

114

114

114

114

114

114

114

114

114

114

114

114

114

114

114

114

114

114

114

114

13447

13447

162

1046

1322

1322

1046

Assessment Roll for the Year 1972 and Tax List of Real Property in the Township of Bull Moose

Cass County, Minnesota, for Taxes Payable in the Year 1973.

Table with columns: IN WHOSE NAME ASSESSED, DESCRIPTION OF PROPERTY, ASSESSED VALUE, VALUATIONS BY SCHOOL DISTRICTS AS EQUALIZED BY DEPARTMENT OF TAXATION, and various tax and payment columns. Includes entries for 28391 Charles K. & Edna Large, 28391 State of Minnesota, and 28391 Glacier Park Hotel.

Assessment Roll for the Year 1972 and Tax List of Real Property in the Township of Bull Moose

Table with columns: IN WHOSE NAME ASSESSED, DESCRIPTION OF PROPERTY, ASSESSED VALUE, VALUATIONS BY SCHOOL DISTRICTS AS EQUALIZED BY DEPARTMENT OF TAXATION. Includes rows for Violet Bundy, Ellsworth Hagberg, and State of Minnesota.

Cass County, Minnesota, for Taxes Payable in the Year 1973.

Table with columns: Non-Homestead General Tax, Homestead General Tax, 35% Homestead Credit, Rate & Tax Bonds & Int. (Mills), SPECIAL TAXES, TOTAL TAXES, PAID, WHEN PAID, Number of Receipt, March Settlement 1973, June Settlement 1973, Penalty, November Settlement 1973, Penalty, Collections to First Monday in January 1974, Penalty, Delinquent on First Monday in January 1974, Total Delinquent Tax and Penalty, REMARKS. Includes handwritten entries like 'PAID IN FULL FEB 15 1973'.

Main assessment table with columns: IN WHOSE NAME ASSESSED, DESCRIPTION OF PROPERTY, ASSESSED VALUE (Total, Homestead, Agr., Non Agr.), VALUATIONS BY SCHOOL DISTRICTS AS EQUALIZED BY DEPARTMENT OF TAXATION, SPECIAL TAXES, TOTAL TAXES, PAID, WHEN PAID, Number of Receipt, March Settlement 1973, June Settlement 1973, November Settlement 1973, Penalty, Collection to First Monday in January 1974, Delinquent on First Monday in January 1974, Total Delinquent Tax and Penalty, REMARKS.

114

A114

2580

7740 2580

203

24678

20948

3730

20948

2580

Table with columns for: IN WHOSE NAME ASSESSED, DESCRIPTION OF PROPERTY (Subdivision, Sec. or Lot, Town or Block, Rng., No. of Acres, No. School District, Estimated Market Value, Assessed Value (Total, Homestead Tax Credit, Agr., Non Agr.), Sold for Taxes, Valuations by School Districts as Equalized by Department of Taxation (District No., Mills), Non-Homestead General Tax Ex. Bonds, Homestead General Tax Ex. Bonds, 25% Homestead Credit, Rate & Tax Bonds & Int. (Mills), SPECIAL TAXES, SPECIAL TAXES, TOTAL TAXES, PAID, WHEN PAID (Month, Day, Year), Number of Receipt, March Settlement 1973, June Settlement 1973, November Settlement 1973, Penalty, Collections to First Monday in January 1974, Delinquent on First Monday in January 1974, Total Delinquent Tax and Penalty, REMARKS.

Table with columns: IN WHOSE NAME ASSESSED, DESCRIPTION OF PROPERTY, ASSESSED VALUE, VALUATIONS BY SCHOOL DISTRICTS AS EQUALIZED BY DEPARTMENT OF TAXATION, TAXES (Non-Homestead, Homestead, 35% Homestead Credit, Rate & Tax Bonds & Int.), SPECIAL TAXES, TOTAL TAXES, PAID, WHEN PAID, Number of Receipt, March Settlement, June Settlement, Penalty, November Settlement, Penalty, Collections to First Monday in January, Delinquent on First Monday in January, Total Delinquent Tax and Penalty, REMARKS.

Assessment Roll for the Year 1972 and Tax List of Real Property in the Township of Bull Moose

Cass County, Minnesota, for Taxes Payable in the Year 1973.

Table with columns: IN WHOM NAME ASSESSED, DESCRIPTION OF PROPERTY (SUBDIVISION, Sec. or Lot, Town or Block, Rng., No. of Acres, No. School District, Tract, Subdiv., Type of Property), ESTIMATED MARKET VALUE, ASSESSED VALUE (Total, Homestead Tax Credit, Agr., Non Agr.), VALUATIONS BY SCHOOL DISTRICTS AS EQUALIZED BY DEPARTMENT OF TAXATION (District No. A117, B117, C117, D117, E117, F117), Non-Homestead General Tax Ex. Bonds, Homestead General Tax Ex. Bonds, 25% Homestead Credit, Rate & Tax Bonds & Int. (Mills), SPECIAL TAXES, SPECIAL TAXES, TOTAL TAXES, PAID, WHEN PAID, Number of Receipt, March Settlement 1973, June Settlement 1973, Penalty, November Settlement 1973, Penalty, Collections to First Monday in January 1974, Penalty, Delinquent on First Monday in January 1974, Total Delinquent Tax and Penalty, REMARKS.

Assessment Roll for the Year 1972 and Tax List of Real Property in the Township of Bull Moose

Cass County, Minnesota, for Taxes Payable in the Year 1973.

ENGINEER'S PINE MOUNTAIN BEACH

Main table with columns: IN WHOSE NAME ASSESSED, DESCRIPTION OF PROPERTY, ASSESSED VALUE (Total, Homestead Tax Credit, Agr., Non Agr.), VALUATIONS BY SCHOOL DISTRICTS AS EQUALIZED BY DEPARTMENT OF TAXATION, Non-Homestead General Tax, Homestead General Tax, 2% Homestead Credit, Rate & Tax Bonds & Int., SPECIAL TAXES, TOTAL TAXES, PAID, WHEN PAID, Number of Receipt, March Settlement, June Settlement, Penalty, November Settlement, Penalty, Collections to First Monday in January, Delinquent on First Monday in January, Total Delinquent Tax and Penalty, REMARKS.

115

Engis Pine Mountain Beach
SUBDIVISION
Part of the Site

T-74 Orlando A. & Janice A. Nordmoier
1-1 Duane D. & Edith E. Enger
2-1 William E. & Mary Ann Blako
T-74 Duane D. & Edith E. Enger
3-1 Lester W. & Helen I. Olson
T-74 Duane D. & Edith E. Enger
6-1 Arthur & Mario E. Ylinen
7-1 Duane D. & Edith E. Enger
8-1 Duane D. & Edith E. Enger
9-1 Duane D. & Edith E. Enger
10-1 Duane D. & Edith E. Enger
11-1 Duane D. & Edith E. Enger
12-1 Duane D. & Edith E. Enger
13-1

Part of 1 138 91
Part of 2 1
Part of 3 1
Part of 4 1
Part of 5 1
Part of 6 1
Part of 7 1
Part of 8 1
Part of 9 1
Part of 10 1
Part of 11 1
Part of 12 1
Part of 13 1

114
No SR
No SR
No SR
No SR
Yes R
No SR
No SR
No SR
No SR
No SR
No SR
No SR
No SR

ESTIMATED MARKET VALUE
Dollars
30
18
26
36
1044
36
45
36
27
27
27
27
27

10
6
12
12
H 261
12
15
12
9
9
9
9
9

82
48
98
98
2336
98
122
98
74
74
74
74

14
08
18
18
378
18
22
18
14
14
14
14

96
56
116
116
1896
116
144
116
88
88
88
88

1 PAID IN FULL APR 28 1973 1541
2 PAID IN FULL MAY 31 1973 1344
3 PAID IN FULL MAY 31 1973 1164
4 PAID IN FULL OCT 31 1973 19283
5 PAID IN FULL MAY 24 1973 5413
6 PAID IN FULL OCT 31 1973 19285
7 PAID IN FULL MAY 31 1973 1102
8 PAID IN FULL MAY 25 1973 5553
9 PAID IN FULL MAY 31 1973 12333
10 PAID IN FULL MAY 25 1973
11 PAID IN FULL MAY 25 1973 5551
12 PAID IN FULL MAY 25 1973
13 PAID IN FULL MAY 25 1973

1416 385 261 134 261
124 H 261 = 124
124 261 385

A114
A114

1014
1014 2336 818 569

8096

1510

1536

ENDER'S PINE MOUNTAIN BEACH

IX WHOSE NAME ASSESSED	DESCRIPTION OF PROPERTY					ESTIMATED MARKET VALUE	ASSESSED VALUE				SOLD FOR TAXES	VALUATIONS BY SCHOOL DISTRICTS AS EQUALIZED BY DEPARTMENT OF TAXATION						Non-Homestead General Tax Ex. Bonds	Homestead General Tax Ex. Bonds	3% Homestead Credit	Rate & Tax Bonds & Int. (Mills) Co. Sch. VIII. Tot.	SPECIAL TAXES	SPECIAL TAXES	TOTAL TAXES	PAID	WHEN PAID	Number of Receipt	March Settlement 1973	June Settlement 1973	Penalty	November Settlement 1973	Penalty	Collection to First Monday in January 1974	Penalty	Delinquent on First Monday in January 1974	Total Delinquent Tax and Penalty	REMARKS
	SUBDIVISION	Sec. or Lot	Town or Block	Rdg.	No. of Acres		Total	Homestead Tax Credit	Agr.	Non Agr.		District No. A114 Mills	District No. A114 Mills	District No. A117 Mills	District No. A117 Mills	District No. A117 Mills	District No. A117 Mills																				
1																																					
2																																					
3																																					
4																																					
5																																					
6																																					
7													20989	8988																							
8													13182	3346																							
9													41488	4768																							
10				6901		218642	58121	226167	48982	9139			35168	6692	13814	25075	58121																				
11																																					
12																																					
13																																					
14																																					
15																																					
16																																					
17																																					
18																																					
19																																					
20																																					

114 117

Rate & Tax Bonds & Int. (Mills) Co. Sch. VIII. Tot.

14.46 10.53

SPECIAL TAXES

SPECIAL TAXES

TOTAL TAXES

PAID

WHEN PAID

Number of Receipt

March Settlement 1973

June Settlement 1973

Penalty

November Settlement 1973

Penalty

Collection to First Monday in January 1974

Penalty

Delinquent on First Monday in January 1974

Total Delinquent Tax and Penalty

REMARKS