

ASSESSMENT & TAX LIST

**Barclay**

1947



DIRECTIONS TO ASSESSOR

OFFICE OF COUNTY AUDITOR, APR 15 1947.

George Bailey, Assessor of the Town of Barclay, delivering to you the Assessment Books for the year 1947, according to the requirements of law, I herewith deliver to you the Assessment Books for the year 1947, containing a list of all Real Estate that has become subject to taxation since the Assessment of May 1, 1946, so far as the same have come to my knowledge from any source, and I hereby direct you to assess all Personal Property, and to make such changes in Real Estate as are required in the odd-numbered year, and make return thereof to me as required by the law prescribing your duties hereto annexed.

A form of the return to be signed by you is appended to this book.

Extracts from Laws Relating to the Listing of Personal Property.

(Section Numbers Refer to Minnesota Statutes 1945)

Sec. 272.01. PROPERTY SUBJECT TO TAXATION. All real and personal property in this state, and all personal property of persons residing therein, and all taxable, except such as is by law exempt from taxation.
WHEN LISTED AND ASSESSED
Sec. 272.01. Personal Property shall be listed and assessed annually on the first day of May...

Sec. 272.46. False statement regarding taxes. Every person who, in making any statement, oral or written, which is required to be made by this chapter, makes a statement which is false or untrue, shall be guilty of a misdemeanor...
Sec. 272.47. Lists to be verified. Every person required to list property for taxation shall make certain divisions of all personal property owned by him on May 1 of the current year...

Section 273.03. Minnesota Statutes 1945. Assessment; Mode. The county auditor shall annually provide the necessary assessment books and blanks at the expense of the county, for and to correspond with each assessment district. He shall make out, in the real property assessment book, complete lists of all lands or lots subject to taxation, showing the names of the owners, if to him known, and, if unknown so stated opposite each tract or lot, the number of acres, and the lots or parts of lots or blocks, included in each description of property.

The assessors shall meet at the office of the county auditor on a day to be fixed by the Commissioner of Taxation for the purpose of receiving instructions as to their duties under the laws of the state.





List of Lands in the Town of Barclay, County of Cass, Minn., for the Year 1947, Which have Become Homesteads or Ceased to be Homesteads  
 SINCE THE LAST REAL ESTATE ASSESSMENT DATE

LANDS BECOMING HOMESTEADS						LANDS CEASING TO BE HOMESTEADS					
NAME OF OWNER	School District	DESCRIPTION OF PROPERTY SUBDIVISION	Sec.	Town	Number of Acres of Land	NAME OF OWNER	School District	DESCRIPTION OF PROPERTY SUBDIVISION	Sec.	Town	Number of Acres of Land
			or Lot	or Block	or Range				or Range	or Range	or Range
Wesley R. Grund, Pine River, Minn.	19	White Pine Point Addition Lots 36-37-38				Cyrus Amundson Backus Minn.	19	N.E. 1/4 of N.E. 1/4	19	138	29 40
Chas. De Boer, Pine River Minn.	19	N.E. 1/4 of S.E. 1/4 N.W. 1/4 S.E. 1/4	29	138	29 40	Mark Westfall	unorg	S.W. 1/4 of N.E. 1/4 N.E. 1/4 of N.E. 1/4	6	"	" 40
Mabel Prohmet Pine River Minn.	19	acre of lot 6	31	"	" 1	"	"	N.W. 1/4 " " " "	5	"	" 37 90
Melvin Amundson Backus Minn.	19	N.E. 1/4 of S.W. 1/4	18	"	" 40	"	"	S.W. 1/4 " " " "	5	"	" 40
Cyrus Amundson Backus Minn.	19	N.W. 1/4 of S.W. 1/4	18	"	" 45 86	Mal Hong	"	S.E. 1/4 " " " "	5	"	" 40
E. C. Miller Pine River Minn.	unorg	S.W. 1/4 of N.E. 1/4 Lot 2	9	"	" 40	"	"	N.W. 1/4 of S.E. 1/4	4	"	" 38 28
			9	"	" 39 40	"	"	N.W. 1/4 of N.W. 1/4	4	"	" 40
						"	"	S.E. 1/4 of N.W. 1/4	4	"	" 40

Oldham Book  
 Horwood  
 Pine  
 Gillette's Adm.  
 Brady Pol.















Assessment of

Form 312, MILES-GALE COMPANY, MINNEAPOLIS

NAME OF OWNER

1  
2  
3  
4  
5  
6  
7  
8

Treasurer's Office, Cass County, Minnesota

RECEIVED this, the first Monday (being the 5th day) of January, A. D. 1948, of L. C. Peterson, Auditor of said County, Minnesota, the Tax List of all Taxable Real and Personal Property in the Town of Barclay in said County for the year A. D. 1947, as specified above and amounting to 100 Dollars  
Paula Jewell  
County Treasurer.

Auditor's Office, Cass County, Minnesota

I, \_\_\_\_\_ Auditor of said County, and State of Minnesota, do hereby certify that the following is a correct list of the Taxes levied on the Real and Personal Property in the \_\_\_\_\_ of \_\_\_\_\_ for the year 1947.  
WITNESS my hand and official seal, the \_\_\_\_\_ day of \_\_\_\_\_ 1948.  
(SEAL) \_\_\_\_\_ County Auditor.

JAN-3 1949 194

Office of County Treasurer, Cass County, Minnesota

To L. C. Peterson, County Auditor:  
Sir: I herewith return to you the Tax List for the Town of Barclay in said County for the year 1947, heretofore received from you. I certify that I have compared the same with the duplicate receipts in your office, and have written opposite the amount of each tax so received the words "First Quarter Paid", "Second Quarter Paid", "Third Quarter Paid" or "Paid in full" as the case may be, and the number of my receipts given in discharge of said tax, and each tract or lot of real property against which the taxes remain unpaid is designated for said year.  
Yours respectfully,  
Paula Jewell  
County Treasurer.

Auditor's Office, Cass County, Minnesota

\_\_\_\_\_ 194  
I hereby certify that on the first Monday in January 1949, I received of \_\_\_\_\_ County Treasurer, the Tax List of the \_\_\_\_\_ of \_\_\_\_\_ in said County for the year 1947; that I have compared the said list with the Statements received for by said Treasurer, which are on file in my office, and that each tract or lot of real property therein against which the taxes, or any part thereof, remains unpaid are delinquent for said year.  
(SEAL) \_\_\_\_\_ County Auditor.

Chickawa Beach  
Norwood  
The Pine  
Gillispie's Addn.  
Shady Point  
Shore







Assessment Roll and Tax List of Real Property in the Town of Barclay

IN WHOSE NAME ASSESSED	TO WHOM TRANSFERRED	DESCRIPTION OF PROPERTY			TRUE AND FULL VALUATIONS					ASSESSED VALUATIONS					FINAL EQUALIZED VALUE			
		SUBDIVISION	Sec. or Lot	Town or Block	Rng.	Number of Acres of Land	LAND Exclusive of Structures and Improvements	BUILDINGS and Other Structures	MACHINERY Permanently Attached to Real Estate	TOTAL True and Full Value	RURAL		ALL OTHER			MACHINERY Permanently Attached to Real Estate	TOTAL ASSESSED VALUE	Total Assessed Value as Equalized by the Board of Review
											Acres	100ths	Homestead Up to \$4,000 20%	Over \$4,000 and Non-Homestead 33 1/3%				
Clifford Le Roy Anderson + Alice Florence Anderson		1 NE 1/4 of NE 1/4	4	138 29		37 78												
Patricia + Julia B. Anderson		2 NW 1/4 of NE 1/4				37 95												
Wm. C. Stephen		3 SW 1/4 of NE 1/4				40												
Clifford Le Roy Anderson + Alice Florence Anderson		4 SE 1/4 of NE 1/4				40												
George + Rhoda A. Sieck		5 W. 50' of E 1/2 of Lot 6				50												
Glen Olson		6 NE 1/4 of NW 1/4				38 11												
Mae Haug		7 NW 1/4 of NW 1/4				38 28												
"		8 SW 1/4 of NW 1/4				40												
"		9 SE 1/4 of NW 1/4				40												
Clarence + Olga Florence Duncan		10 E. 300' of Lot 6 less W. 50' of E 1/2				2 50												
Henry Nelson		11 NE 1/4 of SW 1/4				40												
"		12 NW 1/4 of SW 1/4				40												
"		13 SW 1/4 of SW 1/4				40												
"		14 SE 1/4 of SW 1/4 W 1/2 of Lot 5				18 30												
H.H. + Helen E. Dabke		15 Lot 6 less E. 570'				5												
Henry Nelson		16 N. 300' of Lot 4				30												
Carl + Ingeborg Johnson		17 NW 1/4 of SE 1/4 E 1/2 of Lot 5				26 75												
"		18 SW 1/4 of SE 1/4				18 30												
"		19 SE 1/4 of SE 1/4																
"		20 W 1/2 of N 1/2 of Lot 6				100												

(Continued on next page)

SOLD FOR TAXES	VALUATIONS BY SCHOOL DISTRICTS AS EQUALIZED BY DEPARTMENT OF TAXATION						Tax Including State Homestead	State Tax on Non-Homestead	SPECIAL TAXES	TOTAL TAXES	PAID	WHEN PAID	Number of Receipt	March Settlement 1948	June Settlement 1948	Penalty	November Settlement 1948	Penalty	Collections to First Monday in January 1949	Penalty	Delinquent on First Monday in January 1949	Total Delinquent Tax and Penalty	REMARKS	
	District No.	District No.	District No.	District No.	District No.	District No.																		
	Rate	Rate	Rate	Rate	Rate	Rate																		
1						4 38			6 86	6 86	1	PAID IN FULL	MAY 3 1948	6 248										
2						4 58			10 48	10 48	2	PAID IN FULL	MAY 14 1948											
3						4 40			7 22	7 22	3	PAID IN FULL	MAY 14 1948	5 60										
4						4 80			14 44	14 44	4	PAID IN FULL	JUN 3 1948	6 248										
5						8 2			14 80	15 14	5	PAID IN FULL	JUN 3 1948	6 815										
6	SOLD FOR TAXES					6 3			11 38	11 64	6	PAID IN FULL	MAR -4 1948	3 002	11 64									
7						9 5			23 46	23 46	7	PAID IN FULL	FEB -2 1948	11 67	23 46									
8						13 3			17 14	17 52	8	PAID IN FULL	OCT 2 1948	9 234										
9						13 3			24 00	24 54	9	PAID IN FULL	OCT 29 1948	12 998										
10						9 3			16 78	17 16	10	PAID IN FULL	JUN 29 1948	9 114										
11						7 5			13 54	13 84	11	PAID IN FULL	JUN 29 1948											
12						6 7			12 10	12 38	12	PAID IN FULL	JUN 17 1948											
13						6 7			12 10	12 38	13	PAID IN FULL	JUN 17 1948	8 134										
14						6 7			12 10	12 38	14	PAID IN FULL	JUN 17 1948											
15						3 1			5 60	5 72	15	PAID IN FULL	JUN 17 1948											
16						W 1 24			24 24	24 24	16	PAID IN FULL	JAN 30 1948	8 06	24 24									
17						5 0			9 02	9 22	17	PAID IN FULL	AUG 9 1948	11 18										
18						5 4			9 74	9 96	18	PAID IN FULL	OCT 18 1948	6 260										
19						3 6			6 50	6 64	19	PAID IN FULL	MAY 22 1948	6 360										
20											20													
									W 4 770	4 770														
									W 20 380	20 380														
									W 25 150	25 150														

Oldcama Beach, Norwood, Full, 6111eple's Addn., Shady Point







































































Form 4 (E) 1-1-47

IN WHOSE NAME ASSESSED

*Douglas + Virgin*  
*Lyle E. + Lorraine*  
*Pearl + Jane Cowan*  
*Otto + Stella Haack*  
*Harold E. Hanson*  
*Leon Went*  
*Herman H. + LeVina B.*  
*Mary Louise Renn*  
*Isabelle + Arthur Hoke*  
*Elmer B. Anderson*  
*Halvor Olson*  
*Glen + Hazel Basore*  
*Elmer A. + Ruth R. Nething*

Leon Went - N 16 rds of W 10 rds of SE 1/4 of NE 1/4  
 Herman G. Claussen - W 20 rds of SE 1/4 of NE 1/4 less N 16 rds of W 10 rds  
 Harold E. Hanson - E 10 rds of W 30 rds of SE 1/4 of NE 1/4  
 Mary Louise Renn - E 10 rds of W 40 rds of SE 1/4 of NE 1/4  
 Isabelle & Arthur Hoke - E 10 rds of W 50 rds of SE 1/4 of NE 1/4  
 Elmer B. Anderson - E 10 rds of W 60 rds of SE 1/4 of NE 1/4 & S 100' of E 330' of SE 1/4 of NE 1/4  
 Halvor Olson - N 300' of S 400' of E 330' of SE 1/4 of NE 1/4  
 Glen & Hazel Basore - N 920' of E 330' of SE 1/4 of NE 1/4  
 Elmer A. & Ruth R. Nething - E 10 rds of W 60 rds of SE 1/4 of NE 1/4

20 p. 10 rds of W 60 rds of SE 1/4 of NE 1/4

(Continued on next page)

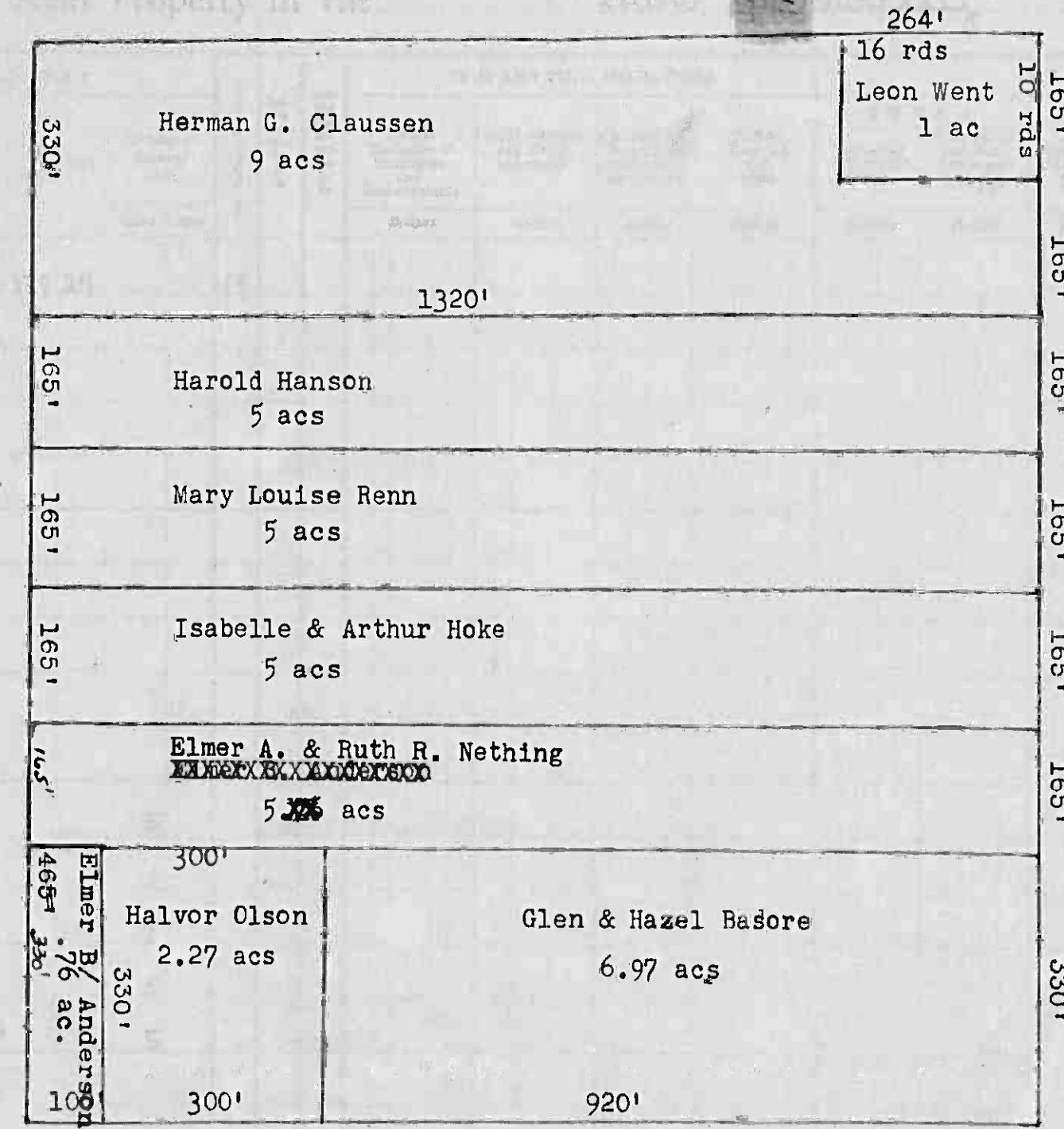

SE 1/4 OF NE 1/4 SEC. 31-138-29

QUANTITIES	TOTAL ASSESSED VALUE	Total Assessed Value as Equalized by the Board of Review	FINAL EQUALIZED VALUE
Dollars	Dollars	Dollars	Dollars

SOLD FOR TAXES	VALUATIONS BY SCHOOL DISTRICTS AS EQUALIZED BY DEPARTMENT OF TAXATION						Tax including State Homestead	State Tax on Non-Homestead	SPECIAL TAXES	TOTAL TAXES	PAID	WHEN PAID	Number of Receipt	March Settlement 1948	June Settlement 1948	Penalty	November Settlement 1948	Penalty	Collections to First Monday in January 1949	Penalty	Delinquent on First Monday in January 1949	Total Delinquent Tax and Penalty	REMARKS
	District No. Rate	District No. Rate	District No. Rate	District No. Rate	District No. Rate	District No. Rate																	
1																							
2																							
3																							
4																							
5																							
6																							
7																							
8																							
9																							
10								222	04		226	10	PAID IN FULL MAR 30 1948										
11								776			776	11	PAID IN FULL JAN - 9 1948										
12								288			288	12	PAID IN FULL APR 22 1948										
13								2108			2108	13	PAID IN FULL MAY 22 1948										
14								1442			1442	14	PAID IN FULL JUN 3 1948										
15								998			998	15	PAID IN FULL APR 23 1948										
16																							
17								1110	20		1130	17	PAID IN FULL APR - 6 1948										
18								266			266	18	PAID IN FULL FEB 5 1948										
19								1442			1442	19	2nd Half Paid 1st Half Paid										
20								8657	24		8676	20											

Oldcama Beach  
 Norwood  
 Price  
 Gillepie's Adm.  
 Shady Point







Assessment Roll and Tax List of Real Property in the Town of Barclay

IN WHOSE NAME ASSESSED	TO WHOM TRANSFERRED	DESCRIPTION OF PROPERTY	Acres	TRUE AND FULL VALUATIONS				ASSESSED VALUATIONS					FINAL EQUALIZED VALUE		
				LAND Exclusive of Structures and Improvements	BUILDINGS and Other Structures	MACHINERY Permanently Attached to Real Estate	TOTAL True and Full Value	R U R A L		ALL OTHER		MACHINERY Permanently Attached to Real Estate		TOTAL ASSESSED VALUE	Total Assessed Value as Equalized by the Board of Review
								Homestead Up to \$4,000 20%	Over \$4,000 and Non-Homestead 33 1/3%	Homestead Up to \$4,000 25%	Over \$4,000 and Non-Homestead 40%				
State of Minnesota		1 acre of Lot 6	1												
S.P. Hanson		20.5 acs of SW 1/4 of NE 1/4	20.50												
Amelia Fields		12 acs of SW 1/4 of NE 1/4	12												
David E. + Wilma Rohr		1/2 ac of SW 1/4 of NE 1/4	1/2												
Herald + Anita Deaton		1/2 ac of SW 1/4 of NE 1/4	1/2												
Lulu Harten		1/2 ac of SW 1/4 of NE 1/4	1/2												
Bernice A. Teisher		1/2 ac of SW 1/4 of NE 1/4	1/2												
David E. + Wilma Rohr		1/2 ac of SW 1/4 of NE 1/4	1/2												
Betha Robideau		1/2 ac of SW 1/4 of NE 1/4	1/2												
Chas. A. Sharpe		1/2 ac of SW 1/4 of NE 1/4	1/2												
Paul J. + Doris P. Gahn		1/2 ac of SW 1/4 of NE 1/4	1/2												
John H. + Julia Hunter		1/2 ac of SW 1/4 of NE 1/4	1/2												
Tony + Sophis Koubal		1/2 ac of SW 1/4 of NE 1/4	1/2												
Edgar + Sophia		1/2 ac of SW 1/4 of NE 1/4	1/2												
Allen + Beeda Fields		1/2 ac of SW 1/4 of NE 1/4	1/2												
Annie Anyon		1/2 ac of SW 1/4 of NE 1/4	1/2												

Cass County, Minnesota, for Taxes for the Year 1947.

SOLD FOR TAXES	VALUATIONS BY SCHOOL DISTRICTS AS EQUALIZED BY DEPARTMENT OF TAXATION						Tax Including State Homestead	State Tax on Non-Homestead	SPECIAL TAXES	TOTAL TAXES	PAID	WHEN PAID	Number of Receipt	March Settlement 1948	June Settlement 1948	Penalty	November Settlement 1948	Penalty	Collections to First Monday in January 1949	Penalty	Delinquent on First Monday in January 1949	Total Delinquent Tax and Penalty	REMARKS
	Rate	Rate	Rate	Rate	Rate	Rate																	
	Dollars	Dollars	Dollars	Dollars	Dollars	Dollars																	
1																							
2	108						2396	44		2440		PAID IN FULL	OCT 13 1948										
3	57						1264	24		1288		PAID IN FULL	MAR 30 1949										
4	152						3374			3374		PAID IN FULL	MAY 24 1948										
5	28						622			622		PAID IN FULL	JUN 1 1948										
6																							
7	48						1066			1066		PAID IN FULL	MAY -6 1948										
8	76						1686			1686		PAID IN FULL	MAR 17 1948										
9	9						214			214		PAID IN FULL	MAY 24 1948										
10																							
11	80						1776			1776		PAID IN FULL	JAN 30 1948										
12	72						1598			1598		PAID IN FULL	APR 23 1948										
13																							
14	7						156	02		158													
15	317						4704	86		4790		PAID IN FULL	MAR 16 1948										Refund W. # 86971 1972 5-12-48 19.72 Abated
16																							
17																							
18																							
19																							
20																							

Chickama Beach, Normood, Plus, Gillette's Addn., Shady Point



Assessment Roll and Tax List of Real Property in the Town of Barclay

Table with columns: IN WHOSE NAME ASSESSED, TO WHOM TRANSFERRED, DESCRIPTION OF PROPERTY, TRUE AND FULL VALUATIONS, ASSESSED VALUATIONS, FINAL EQUALIZED VALUE.

Cass County, Minnesota, for Taxes for the Year 1947.

Table with columns: VALUATIONS BY SCHOOL DISTRICTS AS EQUALIZED BY DEPARTMENT OF TAXATION, TAXES, PAID, WHEN PAID, March Settlement 1948, June Settlement 1948, November Settlement 1948, Collections to First Monday in January 1949, Delinquent on First Monday in January 1949, Total Delinquent Tax and Penalty, REMARKS.

Alice M. Amy
Fred Kaseberg
Neil W. Anderson
J.A. + Inessa Baranson
Henning E. + Evelyn C. Olson
Carl D. + Alma Schultz

1 H 146 3240 3240 PAID IN FULL MAY 26 1948
2 H 96 2130 2130 PAID IN FULL MAY 26 1948
3 200 4438 82 4520 2nd Half Paid OCT 29 1948
4 134 2974 54 3028 1st Half Paid JUN 29 1948
6 H 80 1776 1776 PAID IN FULL JUN 12 1948
7 H 96 2130 2130 PAID IN FULL JUN 12 1948
8 H 236 5238 5238 PAID IN FULL JUN 12 1948
9 H 80 1776 1776 PAID IN FULL JUN 12 1948
11 H 96 2130 2130 PAID IN FULL JUN 12 1948
12 H 80 1776 1776 PAID IN FULL JUN 12 1948
13 243 5392 98 5490 PAID IN FULL JUN 17 1948
14 160 3550 66 3616 PAID IN FULL JUN 17 1948
16 H 124 5770 -106 5876 Part Paid JUL 14 1948
17 H 160 2130 66 3616 Part Paid JUL 14 1948
18 H 236 5238 5238 PAID IN FULL OCT 29 1948
19 H 96 2130 2130 PAID IN FULL OCT 23 1948
20 H 124 5770 472 5370

Old Camp Beach
Norwood
Galleple's Addn.
Shady Point



Assessment Roll and Tax List of Real Property in the Town of Barclay

ON WHOSE NAME ASSESSED	TO WHOM TRANSFERRED	DESCRIPTION OF PROPERTY				TRUE AND FULL VALUATIONS										FINAL EQUALIZED VALUE	
		SUBDIVISION	Sec. or Lot	Town or Block	Number of Acres of Land	LAND Exclusive of Structures and Improvements	BUILDINGS and Other Structures	MACHINERY Permanently Attached to Real Estate	TOTAL True and Full Value	RURAL		ALL OTHER		MACHINERY Permanently Attached to Real Estate	TOTAL ASSESSED VALUE		Total Assessed Value as Equalized by the Board of Review
										Homestead Up to \$4,000 20%	Over \$4,000 and Non-Homestead 33 1/3%	Homestead Up to \$4,000 25%	Over \$4,000 and Non-Homestead 40%				
Arne + Marion Hemness		1 NE 1/4 of NE 1/4	33	138	29	40	19									Abate. \$ 3354	
Chris L. Hoffman	Henry W. Jokela	2 NW 1/4 of NE 1/4			40												
Geo. Walkenhauer		3 SW 1/4 of NE 1/4			40												
"		4 SE 1/4 of NE 1/4			40												
Joseph E. + Marjorie W. Bimberg		6 NE 1/4 of NW 1/4			40												
"		7 NW 1/4 of NW 1/4			40												
George F. Walkenhauer		8 SW 1/4 of NW 1/4			40												
"		9 SE 1/4 of NW 1/4			40												
"		11 NE 1/4 of SW 1/4			40												
Erroy D. + Olive D. Davis		12 NW 1/4 of SW 1/4			40												
"		13 SW 1/4 of SW 1/4			40												
"		14 SE 1/4 of SW 1/4			40												
Mabel Cromett		16 NE 1/4 of SE 1/4			40												
Geo. Walkenhauer		17 NW 1/4 of SE 1/4			40												
John R. + Clara Pettis		18 SW 1/4 of SE 1/4			40												
"		19 SE 1/4 of SE 1/4			40												
		20															

1657.94

Cass County, Minnesota, for Taxes for the Year 1947.

SOLD FOR TAXES	No. 19	VALUATIONS BY SCHOOL DISTRICTS AS EQUALIZED BY DEPARTMENT OF TAXATION					Tax including State Homestead	State Tax on Non-Homestead	SPECIAL TAXES	TOTAL TAXES	PAID	WHEN PAID	Number of Receipt	March Settlement 1948	June Settlement 1948	Penalty	November Settlement 1948	Collections to First Monday in January 1949	Penalty	Delinquent on First Monday in January 1949	Total Delinquent Tax and Penalty	REMARKS
		District No.	District No.	District No.	District No.	District No.																
		Rate	Rate	Rate	Rate	Rate																
1	H 60					1332			1332	1 PAID IN FULL	JUN 12 1948	1448										
2	H 90					1998			1998	2 PAID IN FULL	MAY 26 1948	2061										
3	H 84					1864			1864	3 PAID IN FULL	OCT 30 1947											
4	H 84					1864			1864	4 PAID IN FULL	OCT 30 1947	13090										3728 130
5																						
6	H 80					1776			1776	6 PAID IN FULL	JUN 29 1948	7123										4774
7	H 136					3018			3018	7 PAID IN FULL	JUN 29 1948											
8	H 84					1864			1864	8 PAID IN FULL	OCT 30 1947											
9	H 144					3196			3196	9 PAID IN FULL	OCT 30 1947	13090										5060 177
10																						
11	H 64					1420			1420	11 PAID IN FULL	OCT 30 1947	13090										1420 50
12	H 96					2130			2130	12 2nd Half Paid	OCT 19 1947											3750
13	H 146					3240			3240	13 1st Half Paid	JUN 3 1948											
14	H 96					2130			2130	14 2nd Half Paid	OCT 19 1947	1204 50										
15																						
16	134					2974		54	3028	16												3028 3331
17	H 80					1776			1776	17 PAID IN FULL	OCT 30 1947	13090										
18	H 80					1776			1776	18												1776 1954
19	H 80					1776			1776	19												1776 1954
20	H 140 134 1538					#19 34134		54	34188	20												

Chloasma Beach, Norwood, Gillepie's Addn., Shady Point



Assessment Roll and Tax List of Real Property in the

Town of Barclay

Cass County, Minnesota, for Taxes for the Year 1947.

Chicoma Beach

IN WHOSE NAME ASSESSED	TO WHOM TRANSFERRED	DESCRIPTION OF PROPERTY				TRUE AND FULL VALUATIONS					ASSESSED VALUATIONS					FINAL EQUALIZED VALUE
		SUBDIVISION	Sec. or Lot	Town or Block	King.	Number of Acres of Land	LAND Exclusive of Structures and Improvements	BUILDINGS and Other Structures	MACHINERY Permanently Attached to Real Estate	TOTAL True and Full Value	RURAL Homestead Up to \$4,000 20%	Over \$4,000 and Non-Homestead 33 1/3%	ALL OTHER Homestead Up to \$4,000 25%	Over \$4,000 and Non-Homestead 40%	MACHINERY Permanently Attached to Real Estate 33 1/3%	
		Chicoma Beach														
Lena Wahl, Annie, Martha & Matilda Harbach			1	1												
" " " " " "			2													
" " " " " "			3													
R. J. + Marguerite Johnson			4													
"			5													
"			6													
"			7													
"			8													
"			1	2												
"			2													
Chas. L. + Anna E. Thompson			3													
"			4													
"			5													
"			6													
Eric K. + Helen E. Lange			7													
David A. + Florence L. Anderson			8													
"			9													
Jacob E. Kunz		Part of	9													
H. J. Cromett + Ethel Cromett		100' of	9													
Robert Campbell		7 1/2 of	9													
			20													

SOLD FOR TAXES	VALUATIONS BY SCHOOL DISTRICTS AS EQUALIZED BY DEPARTMENT OF TAXATION					Tax Including State Homestead	State Tax on Non-Homestead	SPECIAL TAXES	TOTAL TAXES	PAID	WHEN PAID	Number of Receipt	March Settlement 1948	June Settlement 1948	Penalty	November Settlement 1948	Penalty	Collections to First Monday in January, 1949	Penalty	Delinquent on First Monday in January 1949	Total Delinquent Tax and Penalty	REMARKS
	District No. 19	District No. 19	District No. 19	District No. 19	District No. 19																	
1						2180	38		2218	✓	PAID IN FULL FEB 21 1948											
2						284	04		288	✓	PAID IN FULL FEB 21 1948											
3						1706	30		1736	✓	PAID IN FULL FEB 21 1948											
4						284	04		288	✓	PAID IN FULL MAR 18 1948											
5						284	04		288	✓	PAID IN FULL MAR 18 1948											
6						284	04		288	✓	PAID IN FULL MAR 18 1948											
7						1232	22		1254	✓	PAID IN FULL MAR 18 1948											
8						1232	22		1254	✓	PAID IN FULL MAR 18 1948											
9						2180	38		2218	✓	PAID IN FULL MAR 18 1948											
10						284	04		288	✓	PAID IN FULL MAR 18 1948											
11						142			142	✓	PAID IN FULL JUL 13 1948											
12						1920			1920	✓	PAID IN FULL JUL 13 1948											
13						1184	20		1204	✓	PAID IN FULL JUL 13 1948											
14						1184	20		1204	✓	PAID IN FULL JUL 13 1948											
15						1184	20		1204	✓	PAID IN FULL FEB 18 1948											
16						1184	20		1204	✓	PAID IN FULL FEB 18 1948											
17						94	02		96	✓	PAID IN FULL FEB 27 1948											
18						94	02		96	✓	PAID IN FULL APR 12 1948											
19 SOLD FOR TAXES						94	02		96													
20																						

Dutch Town

Norwood

Shady Point

Shady Point



















Assessment Roll and Tax List of Real Property in the Town of Barclay

Cass County, Minnesota, for Taxes for the Year 1947.

Chicoma Beach  
Norwood  
Gillespie's Adm.

IN WHOSE NAME ASSESSED	TO WHOM TRANSFERRED	DESCRIPTION OF PROPERTY				TRUE AND FULL VALUATIONS										FINAL EQUALIZED VALUE	
		Subdivision	Sec. of Lot	Town or Block	No. of Acres of Land	LAND Exclusive of Structures and Improvements	BUILDINGS and Other Structures	MACHINERY Permanently Attached to Real Estate	TOTAL True and Full Value	RURAL		ALL OTHER		MACHINERY Permanently Attached to Real Estate	TOTAL ASSESSED VALUE		Total Assessed Value as Equalized by the Board of Review
										Homestead Up to \$1,000 20%	Over \$1,000 and Non-Homestead 33 1/3%	Homestead Up to \$4,000 25%	Over \$4,000 and Non-Homestead 40%				
Gillespie's Addition to Pine River																	
Violet Marie			9	2	19												
"		Cottage 10															
Gladys + Erma Erick																	
"				12													
Claude Bell			1	3													
Morris W. Thareson			2														
Frances C. + Louise M. Jones			3														
Francis E. Jones			4														
"			5														
"			6														
Bachus State Bank			7														
"			8														
"			9														
"			10														
"			11														
"			12														
"			13														
"			14														
"			15														
"			16														
"			17														
"			18														
"			19														
"			20														

SOLD FOR TAXES	VALUATIONS BY SCHOOL DISTRICTS AS EQUALIZED BY DEPARTMENT OF TAXATION						Tax including State Homestead	State Tax on Non-Homestead	SPECIAL TAXES	TOTAL TAXES	PAID	WHEN PAID	Number of Receipt	March Settlement 1948	June Settlement 1948	Penalty 1948	November Settlement 1948	Penalty 1948	Collections to First Monday in January 1949	Penalty 1949	Delinquent on First Monday in January 1949	Total Delinquent Tax and Penalty	REMARKS
	District No.	District No.	District No.	District No.	District No.	District No.																	
	Rate	Rate	Rate	Rate	Rate	Rate																	
1							88		88		1 PAID IN FULL OCT 29 1947												45
2							1198		1198		2 PAID IN FULL OCT 29 1947												
3							110		110		3 PAID IN FULL JUN 17 1948												
4							1220		1220		4 PAID IN FULL JUN 17 1948												
5							1220		1220		5												
6							182	04	182		6 PAID IN FULL JUL 15 1947												
7							110		110		7 2nd Half Paid OCT 30 1947												
8							110		110		8 1st Half Paid JUN 28 1947												
9							1776		1776		9 2nd Half Paid OCT 30 1947												
10							110		110		10 1st Half Paid JUN 28 1947												
11							110		110		11												
12							110		110		12												
13							1510		1510		13												
14							110		110		14												
15							110		110		15												
16							110		110		16												
17											17												
18											18												
19											19												
20											20												
							307		307														
							309		309														
							19		19														
							80		80														
							84		84														

Pleasant View  
Dutch Town  
White Pine Point  
H. F. Rhodes  
Shady Point































Assessment Roll and Tax List of Real Property in the Town of Barclay

IN WHOSE NAME ASSESSED	TO WHOM TRANSFERRED	DESCRIPTION OF PROPERTY				TRUE AND FULL VALUATIONS										FINAL EQUALIZED VALUE		
		SUBDIVISION	Sec. or Lot	Town or Block	Reg.	Number of Acres of Land	LAND Exclusive of Structures and Improvements	BUILDINGS and Other Structures	MACHINERY Permanently Attached to Real Estate	TOTAL True and Full Value	RURAL		ALL OTHER		MACHINERY Permanently Attached to Real Estate		TOTAL ASSESSED VALUE	Total Assessed Value as Equipped by the Board of Review
											Homestead Up to \$4,000 20%	Over \$4,000 and Non-Homestead 33 1/3%	Homestead Up to \$1,000 25%	Over \$1,000 and Non-Homestead 40%				
White Pine Point Addition																		
Ole B. + Anna S. Nargren			11	2														
"			12															
"			13															
"			14															
Wm. Burnson	Orville A. King		15															
"	"		16															
"	Winton + Shelma Caldwell		17															
"	Orville A. King		18															
"	"		19															
"	"		20															
Richard B. + Anna C. Holmstrom			21															
"			22															

SOLD FOR TAXES	VALUATIONS BY SCHOOL DISTRICTS AS EQUALIZED BY DEPARTMENT OF TAXATION						Tax including State Homestead	State Tax on Non-Homestead	SPECIAL TAXES	TOTAL TAXES	PAID	WHEN PAID	Number of Receipt	March Settlement 1948	June Settlement 1948	Penalty	November Settlement 1948	Penalty	Collections to First Monday in January 1949	Penalty	Delinquent on First Monday in January 1949	Total Delinquent Tax and Penalty	REMARKS
	District No.	District No.	District No.	District No.	District No.	District No.																	
	Rate	Rate	Rate	Rate	Rate	Rate																	
								4.07															
1							134			134	1	PAID IN FULL JUN 17 1948											
2							134			134	2	PAID IN FULL JUN 17 1948											
3							134			134	3	PAID IN FULL JUN 17 1948											
4							134			134	4	PAID IN FULL JUN 17 1948											
5							222	04		226											226	249	
6							222	04		226											226	249	
7							222	04		226											226	249	
8							222	04		226											226	249	
9							222	04		226											226	249	
10							222	04		226											226	249	
11							222	04		226											226	249	
12							1020			1020	12	PAID IN FULL MAY 20 1948 5219									1020		
13																							
14																							
15																							
16																							
17																							
18																							
19																							
20																							

Dutch Town  
White Pine Point  
Gillespie's  
Shady Point

Pleasant View  
B. F. Rhodes  
Norway North Shore











