

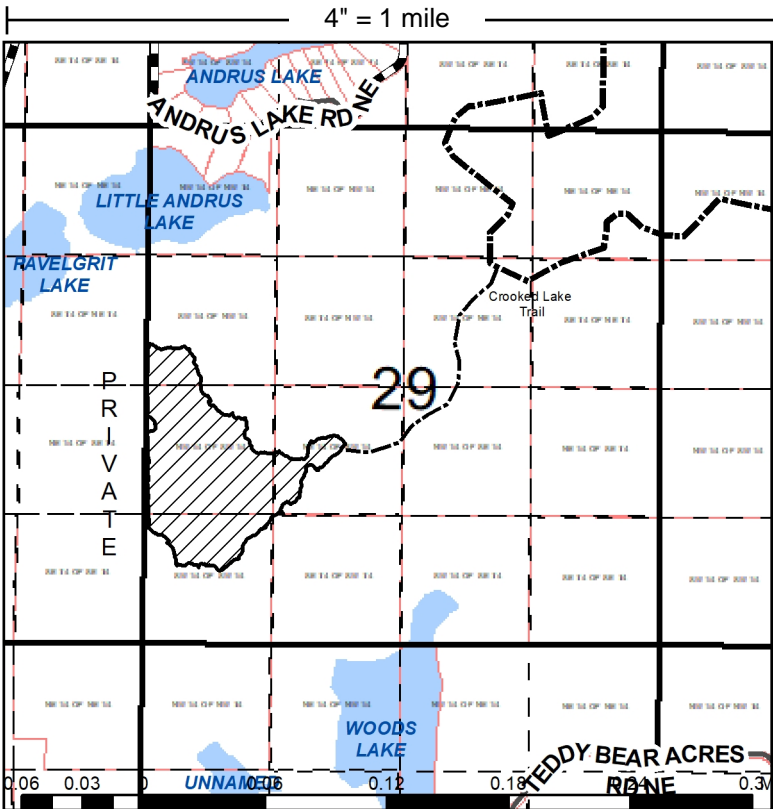

Permittee:	Sale Administrator:	Permit Number:
SAPPI FINE PAPER PRODUCTS	AMY RAND	123009
12260 RIVERVIEW RD.		Date Purchased: 1/26/2023
		Date Expires: 10/1/2024
		ExtendedTo:
BRAINERD MN 56401		Sale Type: REGULAR AUCTION SALE
		Season: Summer Access
		Access: Public Access

Legal Description: SWNW, NWSW, NESW, SESW, SWSW, Sect. 29, Twp. 139, Rng. 26.

Sale Acres		
ASPEN	52.82	
NORWAY PINE	0.16	
OAK	3.86	
PERMANENT WATER	0.03	
Total Sale Acres	56.87	
Block #	Latitude	Longitude
1	46° 49' 21.77"	-94° 0' 18.97"



STANDARD REGULATIONS Ref. ms282

- 1.This timber sale is not transferable.
- 2.Prior to any sale activity notify Sale Administrator.
3. Permittee responsible for following Minnesota Site-Level Forest Management Guidelines
4. Reserve all painted boundary trees.
5. Trees, slash and landings to be kept in sale area.
6. Permittee responsible for ensuring conformance with cutting regulations.
7. Roads and trails are to be left in as good or better than pre-sale condition.
8. All tipped or leaning trees are to be felled.
9. Dead and den trees may be left standing.
10. Do not leave garbage or waste on permit area.
11. All equipment and cut timber not removed from permit area within 30 days of permit expiration date, becomes the property of the County of Cass and removal of such will constitute trespass. (ms 282.04 Subd 2). All uncut timber becomes property of the County of Cass on the permit expiration date and removal of such will constitute trespass (MN 282.04 Subd 2).
12. Harvest operations will be halted if rutting occurs. Ask administrator for specific guidelines.
13. Tree damage exceeding 5% of the residual trees/acre on clearcuts and 3% of the residual trees/acre on thinnings will be charged as trespass. Ask administrator for specific guidelines.

SPECIAL REGULATIONS:

Reserve all bur oak, ash, red pine, white pine and white spruce. Cut all species listed in a progressive manner within sale area. Lop and scatter all slash to within 2' of ground on sale area. No skid trails, slash piles, landings or new roads allowed within 50 feet of any wetland to maintain filter strip integrity. All landings must be pre-approved by resource manager. 3-4 inches of snow must be left on GIA snowmobile trail to facilitate snowmobile traffic from December 1 - April 1. A single lane may be plowed to dirt if another lane, 10 feet in width, is left snow-covered to allow grooming and snowmobile traffic. Trucks hauling/Caution signs must be posted prior to the start of timber activities. Damage to 3% or more of residual trees shall be charged as trespass per Cass County tree damage guidelines. When harvesting biomass, retain all pre-existing coarse woody debris, the forest floor and the litter layer, all stumps and roots, 1/3 of all tops and limbs from harvested trees well-distributed across the site. No reentry into the general harvest area of a site for the purpose of harvesting biomass once regeneration or plantings have become established. Stabilize bare soil areas, especially where topography is rolling to hilly, with scattered slash to resource manager specifications. No biomass products piled on landings for more than one growing season. No activity from March 1st to June 1st or from October 1st thru December 1st due to soil conditions. No activity allowed in reserve areas indicated on map. Protect all corner monuments and signs.

APPRAISAL OF TIMBER

Code	Species	Volume	Unit	Price		Value	
				Appr.	Bid	Appr.	Bid
+	ASPEN	1,961.00	Cords	\$25.00	\$46.00	\$49,025.00	\$90,206.00
+	BIRCH	128.00	Cords	\$11.00	\$20.24	\$1,408.00	\$2,590.72
+	MAPLE	26.00	Cords	\$11.00	\$20.24	\$286.00	\$526.24
+	RED OAK	58.00	Cords	\$20.00	\$36.80	\$1,160.00	\$2,134.40
Total						\$95,457.36	

Codes + = area estimate

Receipt of payment on this permit is confirmation of agreement of terms between the permittee and Cass County. The permit holder agrees to and will abide by the terms and conditions set forth in this permit.

Report Date: 5/21/2025

Cass County Forest Lands are FSC Certified by NEPCon FSC-100% PBN-FM/COC-000117

Must be an equal opportunity employer, hire, supervise, pay, have adequate Worker's Compensation, Social Security, required insurance coverage for labor, and provide appropriate safety measures based on relevant OSHA Standards.