

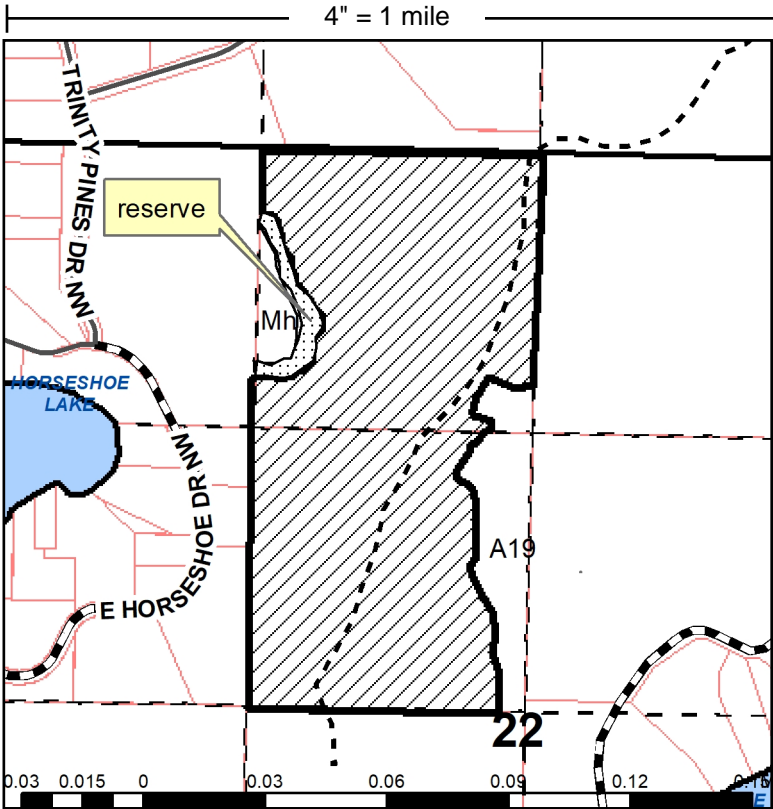

Permitee:	Sale Administrator:	Permit Number:
JUSTIN SAWYER	ELENA WILEY	120027
PO BOX 13		Date Purchased: 5/28/2020
		Date Expires: 3/1/2022
		ExtendedTo: 3/1/2023
BACKUS MN 56435		Sale Type: SEALED BID-REGULAR
		Season: Summer Access
		Access: Public Access

Legal Description: E1/2NW, Sect. 22, Twp. 139, Rng. 30.

Sale Acres		
ASPEN		69.65
Total Sale Acres		69.65
Block #	Latitude	Longitude
1	46° 50' 52.62"	-94° 27' 49.63"



STANDARD REGULATIONS Ref. ms282

- 1.This timber sale is not transferable.
- 2.Prior to any sale activity notify Sale Administrator.
3. Permitee responsible for following Minnesota Site-Level Forest Management Guidelines
4. Reserve all painted boundary trees.
5. Trees, slash and landings to be kept in sale area.
6. Permitee responsible for ensuring conformance with cutting regulations.
7. Roads and trails are to be left in as good or better than pre-sale condition.
8. All tipped or leaning trees are to be felled.
9. Dead and den trees may be left standing.
10. Do not leave garbage or waste on permit area.
11. All equipment and cut timber not removed from permit area within 30 days of permit expiration date, becomes the property of the County of Cass and removal of such will constitute trespass. (ms 282.04 Subd 2). All uncut timber becomes property of the County of Cass on the permit expiration date and removal of such will constitute trespass (MN 282.04 Subd 2).
12. Harvest operations will be halted if rutting occurs. Ask administrator for specific guidelines.
13. Tree damage exceeding 5% of the residual trees/acre on clearcuts and 3% of the residual trees/acre on thinnings will be charged as trespass. Ask administrator for specific guidelines.

SPECIAL REGULATIONS:

CUT ALL SPECIES LISTED IN A PROGRESSIVE MANNER WITHIN SALE AREA. RESERVE ALL BUR AND RED OAK, RED AND WHITE PINE. CUT ALL STEMS GREATER THAN 2" DBH. LOP & SCATTER ALL SLASH TO WITHIN 2' OF GROUND ON SALE AREA.

APPRAISAL OF TIMBER

Code	Species	Volume	Unit	Price		Value	
				Appr.	Bid	Appr.	Bid
+	ASPEN	1,879.00	Cords	\$24.00	\$46.85	\$45,096.00	\$88,038.50
+	BIRCH	141.00	Cords	\$11.00	\$21.47	\$1,551.00	\$3,027.93
+	MAPLE	3.00	Cords	\$10.00	\$19.52	\$30.00	\$58.57
Total						\$91,125.00	

Codes + = area estimate

Receipt of payment on this permit is confirmation of agreement of terms between the permittee and Cass County. The permit holder agrees to and will abide by the terms and conditions set forth in this permit.

Report Date: 5/9/2025

Cass County Forest Lands are FSC Certified by NEPCon FSC-100% PBN-FM/COC-000117

Must be an equal opportunity employer, hire, supervise, pay, have adequate Worker's Compensation, Social Security, required insurance coverage for labor, and provide appropriate safety measures based on relevant OSHA Standards.