

Cass County Land Department
PO Box 25
Backus, MN 56435



Permittee:	Sale Administrator:	Permit Number:
Andrew Haehnel	KIM OBERFELL	119009
60778 470th St		Date Purchased:
		2/28/2019
		Date Expires:
		3/1/2021
		ExtendedTo:
		9/1/2022
		Sale Type:
		SEALED BID-INTERMEDIATE
		Season:
		Winter Access Only
		Access:
		Public Access

Legal Description: SESE, SWSE, SESW, Sect. 15, Twp. 137, Rng. 31.

Sale Acres		
ASPEN		19.46
Total Sale Acres		19.46
Block #	Latitude	Longitude
1	46° 40' 30.44"	-94° 35' 6.76"

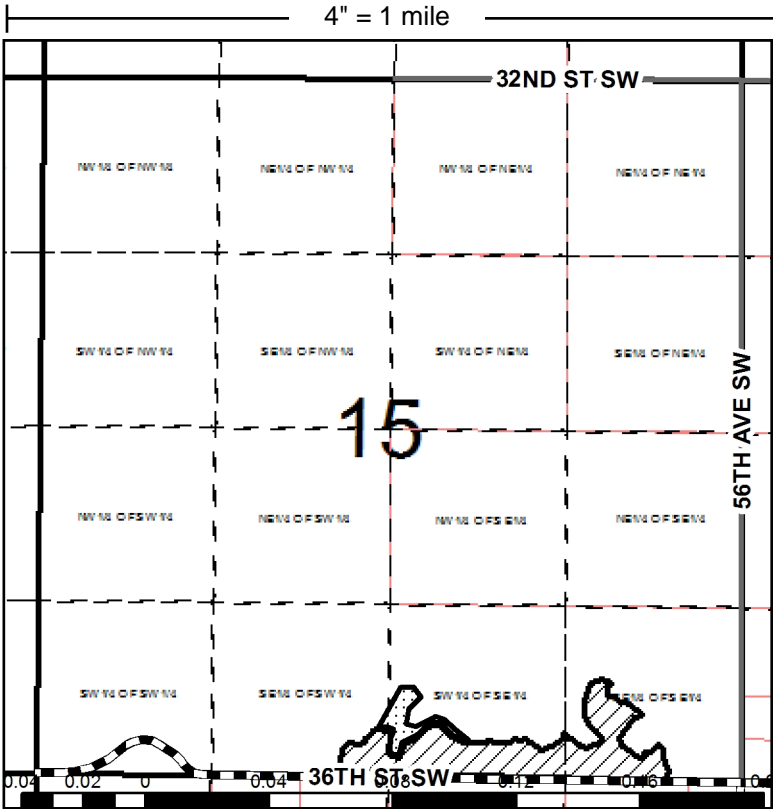

STANDARD REGULATIONS Ref. ms282

- 1.This timber sale is not transferable.
- 2.Prior to any sale activity notify Sale Administrator.
3. Permittee responsible for following Minnesota Site-Level Forest Management Guidelines
4. Reserve all painted boundary trees.
5. Trees, slash and landings to be kept in sale area.
6. Permittee responsible for ensuring conformance with cutting regulations.
7. Roads and trails are to be left in as good or better than pre-sale condition.
8. All tipped or leaning trees are to be felled.
9. Dead and den trees may be left standing.
10. Do not leave garbage or waste on permit area.
11. All equipment and cut timber not removed from permit area within 30 days of permit expiration date, becomes the property of the County of Cass and removal of such will constitute trespass. (ms 282.04 Subd 2). All uncut timber timber becomes property of the County of Cass on the permit expiration date and removal of such will constitute trespass (MN 282.04 Subd 2).
12. Harvest operations will be halted if rutting occurs. Ask administrator for specific guidelines.
13. Tree damage exceeding 5% of the residual trees/acre on clearcuts and 3% of the residual trees/acre on thinnings will be charged as trespass. Ask administrator for specific guidelines.

SPECIAL REGULATIONS:

RESERVE ALL ASH. LOP & SCATTER ALL SLASH TO WITHIN 2' OF GROUND ON SALE AREA. CUT ALL STEMS GREATER THAN 2" DBH.

APPRAISAL OF TIMBER

Code	Species	Volume	Unit	Price		Value	
				Appr.	Bid	Appr.	Bid
+	ASPEN	202.00	Cords	\$18.00	\$20.14	\$3,636.00	\$4,067.72
+	BIRCH	38.00	Cords	\$10.00	\$11.19	\$380.00	\$425.12
+	RED OAK	5.00	Cords	\$10.00	\$11.19	\$50.00	\$55.94
+	MAPLE	17.00	Cords	\$8.00	\$8.95	\$136.00	\$152.15
+	BUR OAK	40.00	Cords	\$8.00	\$8.95	\$320.00	\$357.99
+	JACKPINE	3.00	Cords	\$9.00	\$10.07	\$27.00	\$30.21
+	R.PINE BOLTS & PULP	56.00	Cords	\$80.00	\$89.50	\$4,480.00	\$5,011.93
+	BASSWOOD	1.00	Cords	\$8.00	\$8.95	\$8.00	\$8.95
				Total		\$10,110.00	

Codes + = area estimate

Receipt of payment on this permit is confirmation of agreement of terms between the permittee and Cass County. The permit holder agrees to and will abide by the terms and conditions set forth in this permit.

Report Date: 4/25/2025

Cass County Forest Lands are FSC Certified by NEPCon FSC-100% PBN-FM/COC-000117

Must be an equal opportunity employer, hire, supervise, pay, have adequate Worker's Compensation, Social Security, required insurance coverage for labor, and provide appropriate safety measures based on relevant OSHA Standards.